

Jebel Khalid

Field Record Book

AREA A
(ACROPOLIS)
TRENCHES 105 & 106
2010

Name.....	TIDMARSII
Trenches.....	ACROPOLIS
	A 105 A 106
Dates.....	4/5/10 -

ADVICE to TRENCH SUPERVISORS

1. Take a **new page** for each day. (Each day may take several pages).
2. Draw a **scale plan** of the trench **each day** on the graph paper (essential), with North at the top (if this is not convenient, mark North direction clearly).
Mark depth from surface at the beginning of each day, at designated points.
When starting a square, this plan may be nearly empty but draw it all the same and mark in emerging tumble.
3. Draw arrows on your plan to indicate **direction** in which you are excavating.
4. Every time you designate a new context, (on the occasion of a new spit, a new feature, a new soil colour) fill in the **Context Record Sheet** for that trench, as well as describing it in your report. Store the accumulated context record sheets in the plastic sleeve in your record book.
5. **Structures** . Measure carefully any structure (wall, doorway, threshold, ovens, pit, any large dressed stones or columns) and record exact location, height, width in your report as well as on the scale plan.
6. **Floors** - marked by very hard tough surface or layer of white crushed limestone. May be softer adjacent to wall. Record thickness of floor, if we decide to dig through it.
If your floor is particularly good, collect a few bags of surface material - there may be seeds.
7. **Objects**. e.g. glass, figurine or lamp fragments, metal, stucco, loomweights, spindle whorls, beads, graffito-ed sherds, coins, gold jewellery (some hope). Mark in the location and depth of any objects clearly and accurately. If necessary, draw another sketch plan as the day progresses. A quick sketch of the object in the report would be helpful, if it is too mysterious to name e.g. Mattie's metal blobs.
8. **Pottery**: label bags clearly in waterproof pen, with one label inside the bag and one outside. **Record daily the number of bags per context** . Be very careful to separate pottery from different contexts.
It is absolutely essential to double-bag the pottery. A broken bag of pottery without context is useless.
9. **Bone**: Collect all bone and label as for pottery. Record number of bags per context daily.
10. **Charcoal**: Collect all charcoal and label as for pottery. Record number of bags per context daily.
11. **Tile**: it is important to record the location and amount of tile.
12. **Very important**: at the completion of a trench, draw to scale:
 - i Draw a section of the exposed baulk, with details of stratigraphy clearly marked.
 - ii Draw a top plan of the completed trench, with contexts clearly marked.
 - iii Write a short summary with your interpretation of the trench.

Trench.....Initials.....Date..... Page.....

Locus.....Spit..... Locus..... Spit..... Feature/s

	No. of bags	Loc/spit	Loc/spit
Pottery			
Bone			
Charcoal			
Plaster			
Tile			

No.	Object	Loc/Spit

Photographs:

Context	Report
	INDEX
Page	TRENCH A 105
4	Introduction
5	Locus / Level Index
6-18	Excavation Notes
	Levels
106	Coin List
Sleeve	Small Finds
18	Final Photographs
	TRENCH A 106
20	Introduction
21	Locus / Level Index
22-42	Excavation Notes
51	Level
106	Coin List + Stamped Amphorae
Sleeve	Small Finds
50	Final Photography
55	N ^d section

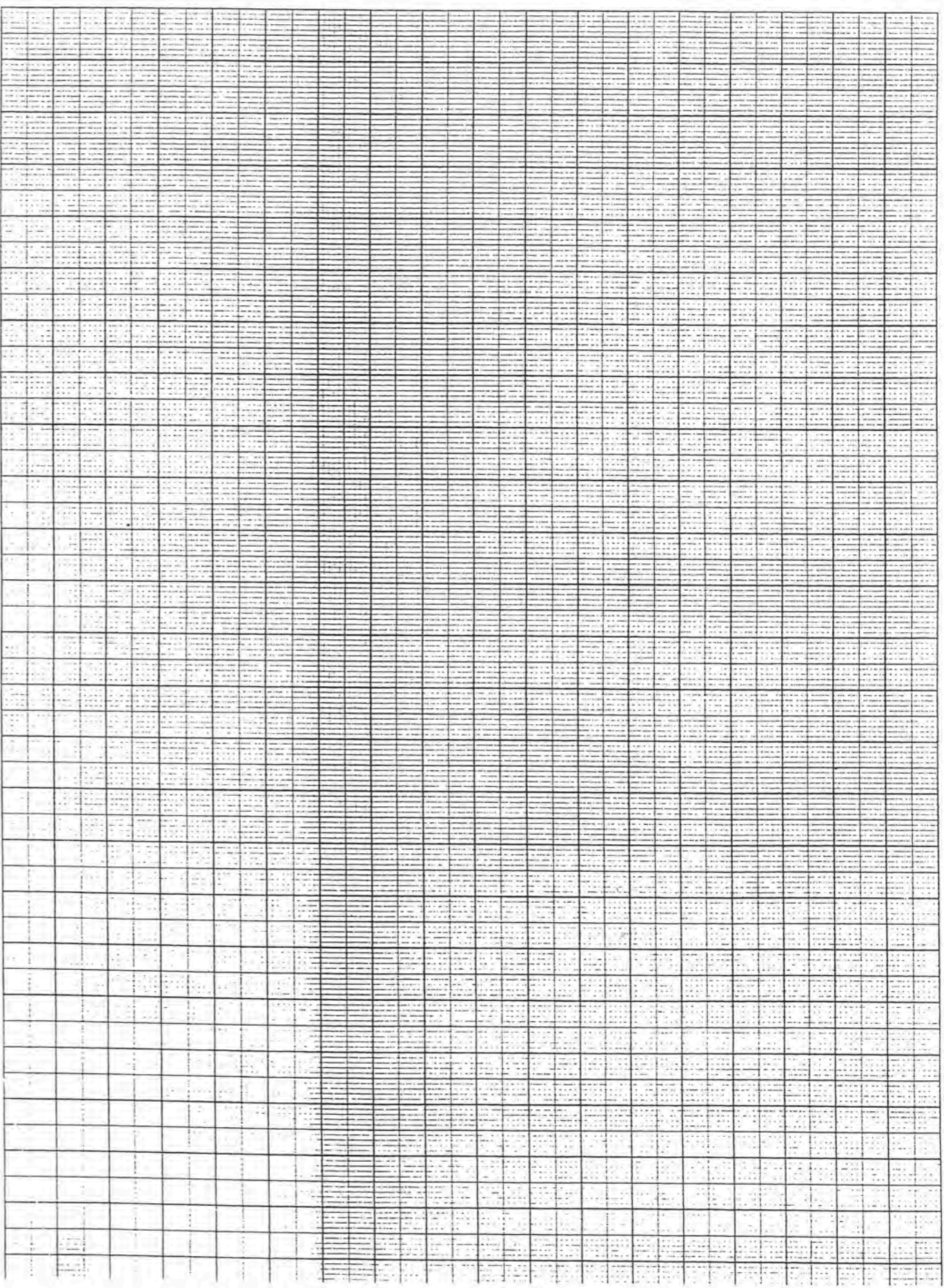

Trench..... A 105Initials.....Date.....Page.....

Locus.....Spit..... Locus.....Spit..... Feature/s

	No. of bags	Loc/spit	Loc/spit
Pottery			
Bone			
Charcoal			
Plaster			
Tile			

No.	Object	Loc/Spit

Photographs:

Context	Report
	<u>INTRODUCTION</u>
	Trench 105 was laid out to the west of the Old Trench 101.
	Dimensions 5 x 5m
	The aim was to see whether the later phase structures uncovered in Trenches 100-101-102, and what would appear (from the ground lines) to be similar structures further to the west, were separated by a N-S street.
	Also important was to see whether any earlier phase structures existed in the same area.

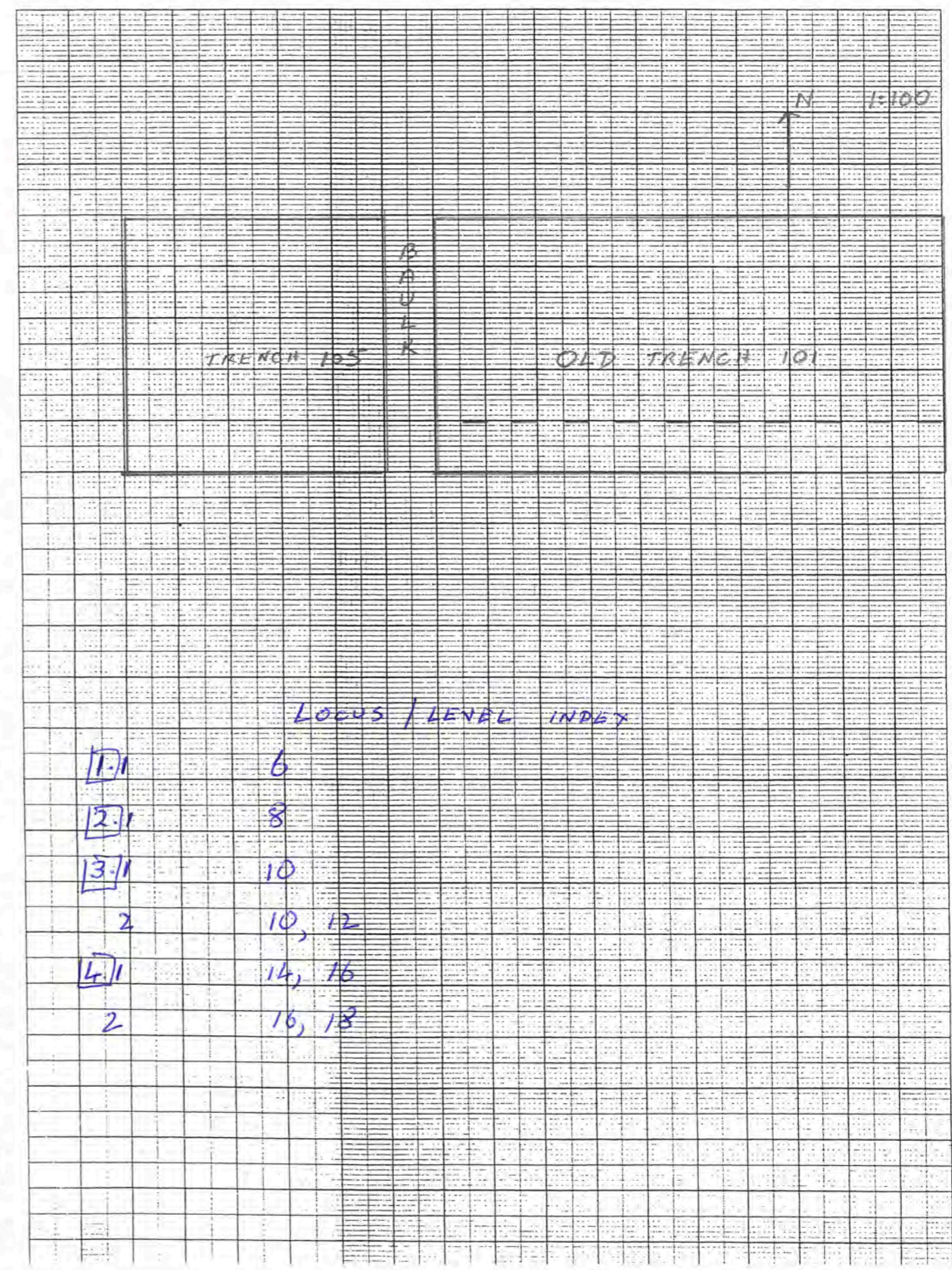

Trench... *A 105* Initials..... Date... *5/5* Page.....
Locus... *2* Spit... *1* Locus..... Spit..... Feature/s

	No. of bags	Loc/spit	Loc/spit
Pottery			
Bone			
Charcoal			
Plaster			
Tile			

No.	Object	Loc/Spit

Photographs:

Context	Report
<i>5/5</i>	<i>[2.1] Topsoil: SE Quadrant</i>
	<i>It is above</i>
	<i>It is below: 1.1</i>
	<i>Further removal of topsoil. However it is clear that even this quadrant is likely to be too large to produce meaningful results</i>
	<i>∴ have decided to extend trench eastward to join up with old Trench 101 so that we can expose the external face of Wall 3 and ascertain whether Wall 6 continues to west or whether a street (N-S) existed west of Wall 3.</i>

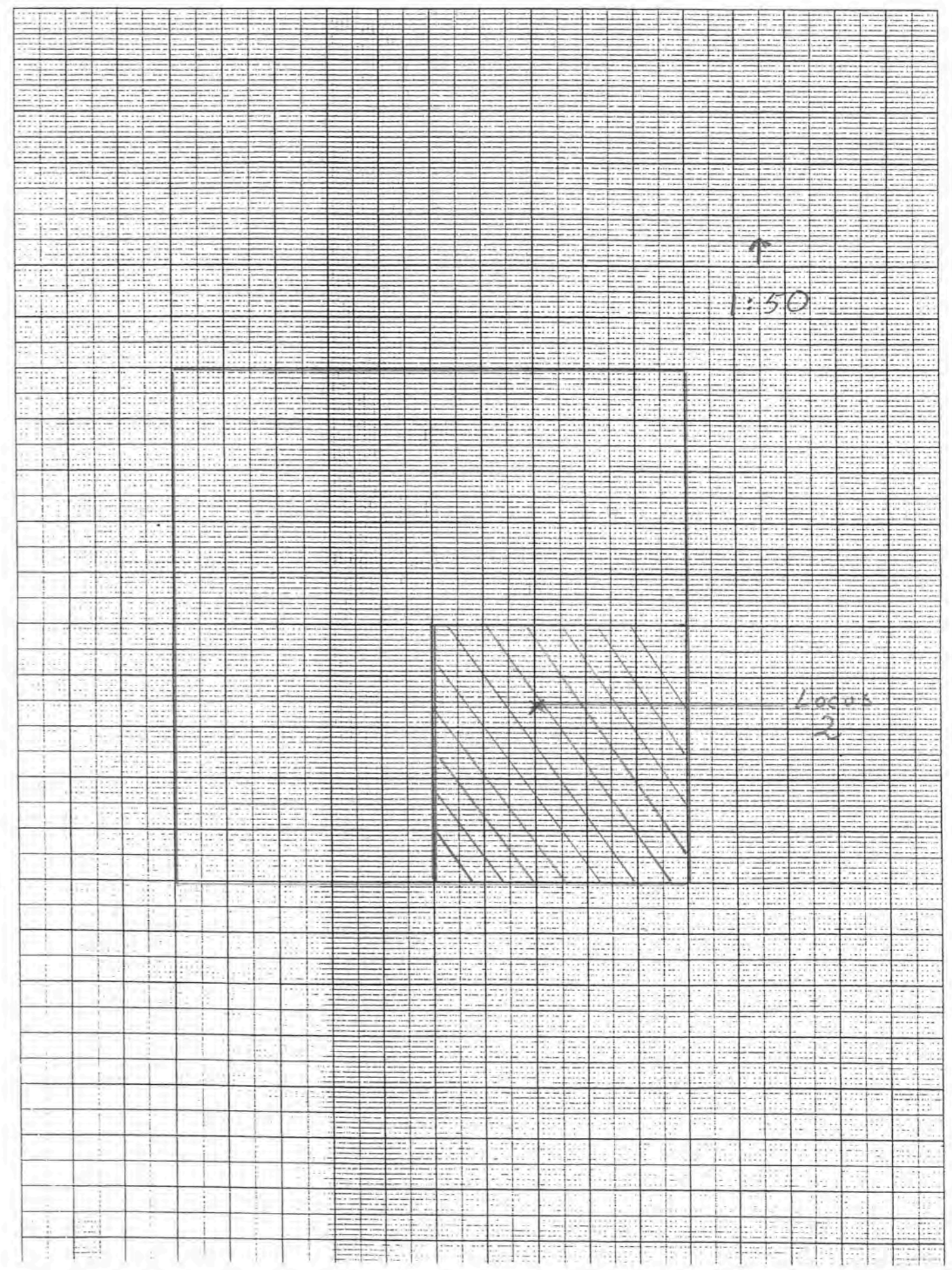

Trench... A 105 ... Initials... Date... 8/5 / 6/5 ... Page...
 Locus... 3 ... Spit... 1 ... Locus... Spit... Feature/s

	No. of bags	Loc/spit	Loc/spit
Pottery			
Bone			
Charcoal			
Plaster			
Tile			

No.	Object	Loc/Spit

Photographs:

Context	Report
6/5	<u>3.1</u> Topsoil / Tumble It is above 3.2 It is below
	Removal of topsoil of Eastern extension to Wall 3 as discussed Also tumble encountered throughout area Pillars not retained.
	<u>3.2</u> Ash It is above It is below 3.1
	On to the ashly level which is encountered below the tumble all over the site.
8/5	Possible continuation of Wall 6 in Trench 101 picked up - to continue to explore

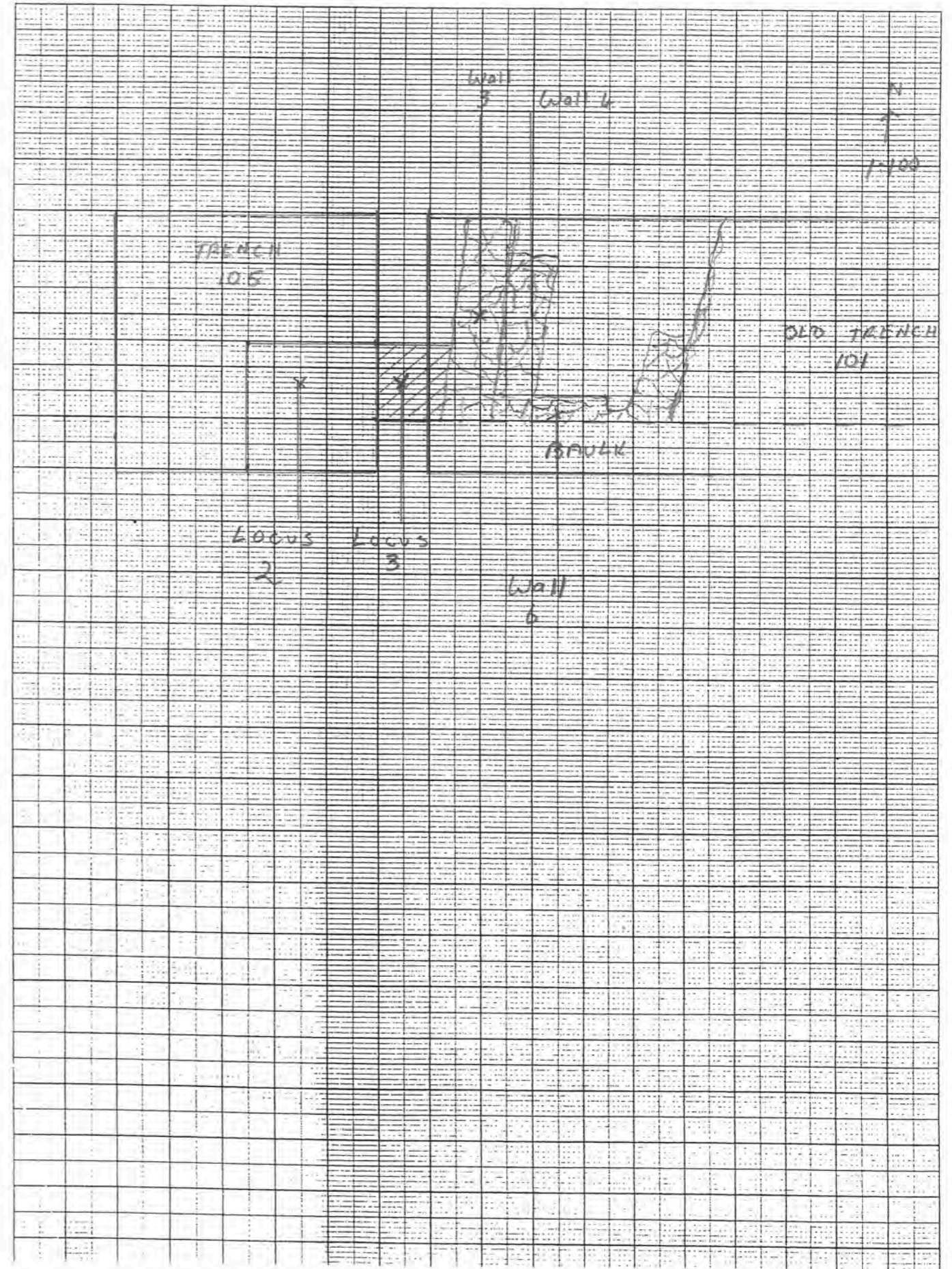

Trench... A 105 Initials..... Date... 8/5 Page.....
Locus... 3 Spit... 2 Locus..... Spit..... Feature/s

	No. of bags	Loc/spit	Loc/spit
Pottery			
Bone			
Charcoal			
Plaster			
Tile			

No.	Object	Loc/Spit
1	Lamp frag 10.351	3.2
	Med - 2 nd c	

Photographs:

Context	Report
8/5	<u>3.2</u> - continued
	Will need to enlarge locus by 0.5m to North in order to explore further the possible continuation of Wall 6
	* <u>Object 1</u> - Lamp frag
	Still under rubble there is a westward extension of Wall 6.
	Now starting to see the typical hard yellow (prob top surface of this is floor of later phase) seen in earlier phase occupation.
9/5	Initial back strengthening ∴ pullay not retained. Also clearing bottom of trench. Plan is then to dig yellow (probably early phase) North of possible wall to define it.

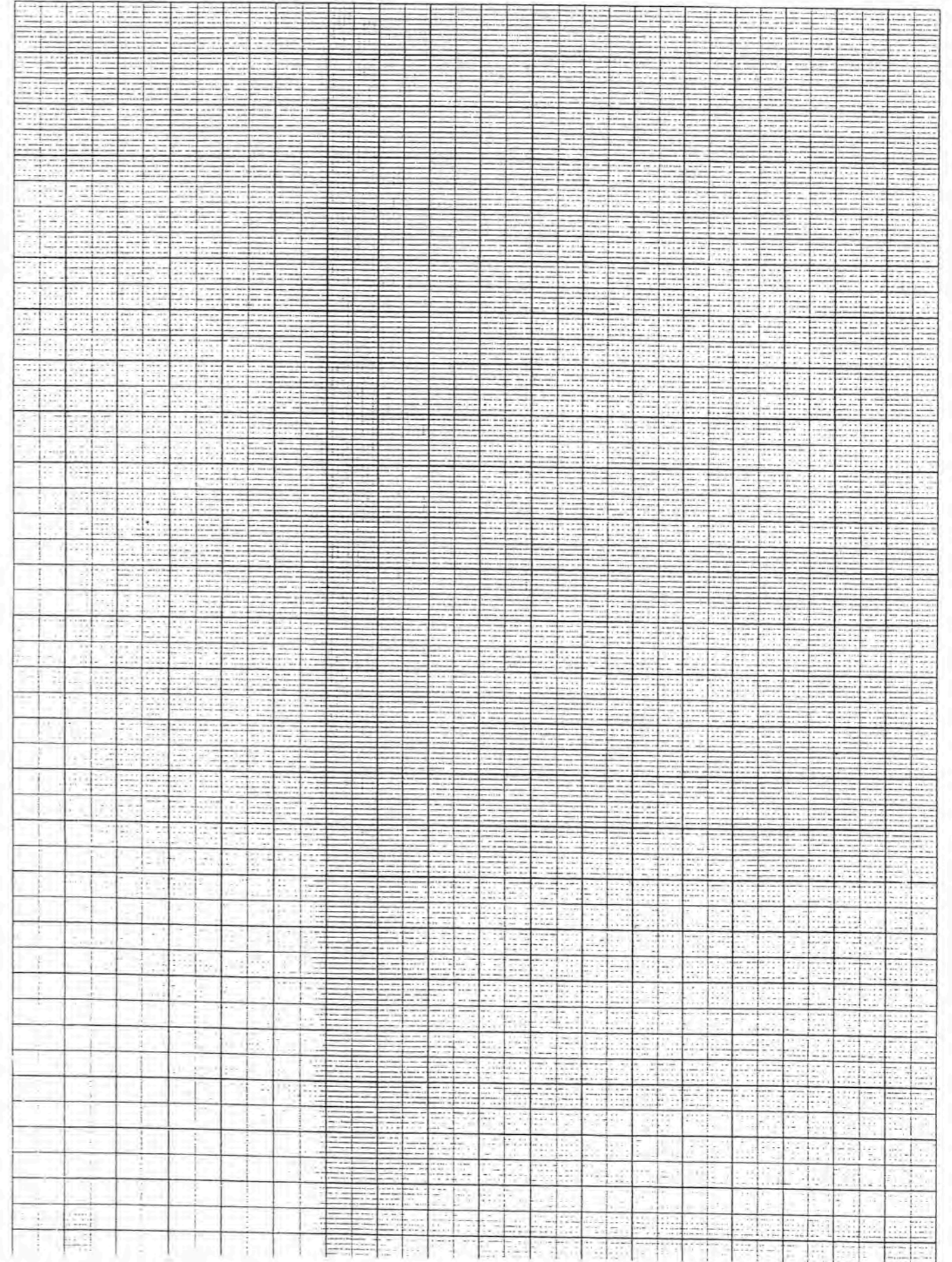

Trench... A105 Initials..... Date... 9/5 Page.....

Locus... 4 Spit... 1 Locus..... Spit..... Feature/s

	No. of bags	Loc/spit	Loc/spit
Pottery		<u>4.1</u>	
Bone		<u>1</u>	
Charcoal		<u>1</u>	
Plaster			
Tile			

No.	Object	Loc/Spit
<u>2</u>	<u>Bronze Bead</u>	<u>4.1</u>

Photographs:

Context	Report
<u>9/5</u>	<u>4.1</u> Hard yellow (North of Wall Initially)
	It is above : <u>4.2</u>
	It is below <u>3.2</u>
	Excavation of hard yellow ("earls phase") deposit north of presumed "Wall"
	* <u>Object 2</u> - Bronze Bead
	Now becomes clear that there is NO wall but just tumble ∴ stones removed from above the same hard yellow level across all the trench
	Appear to be coming down on to jebel
	Quite a few bones and one degenerated lion weight (clay, spherical).

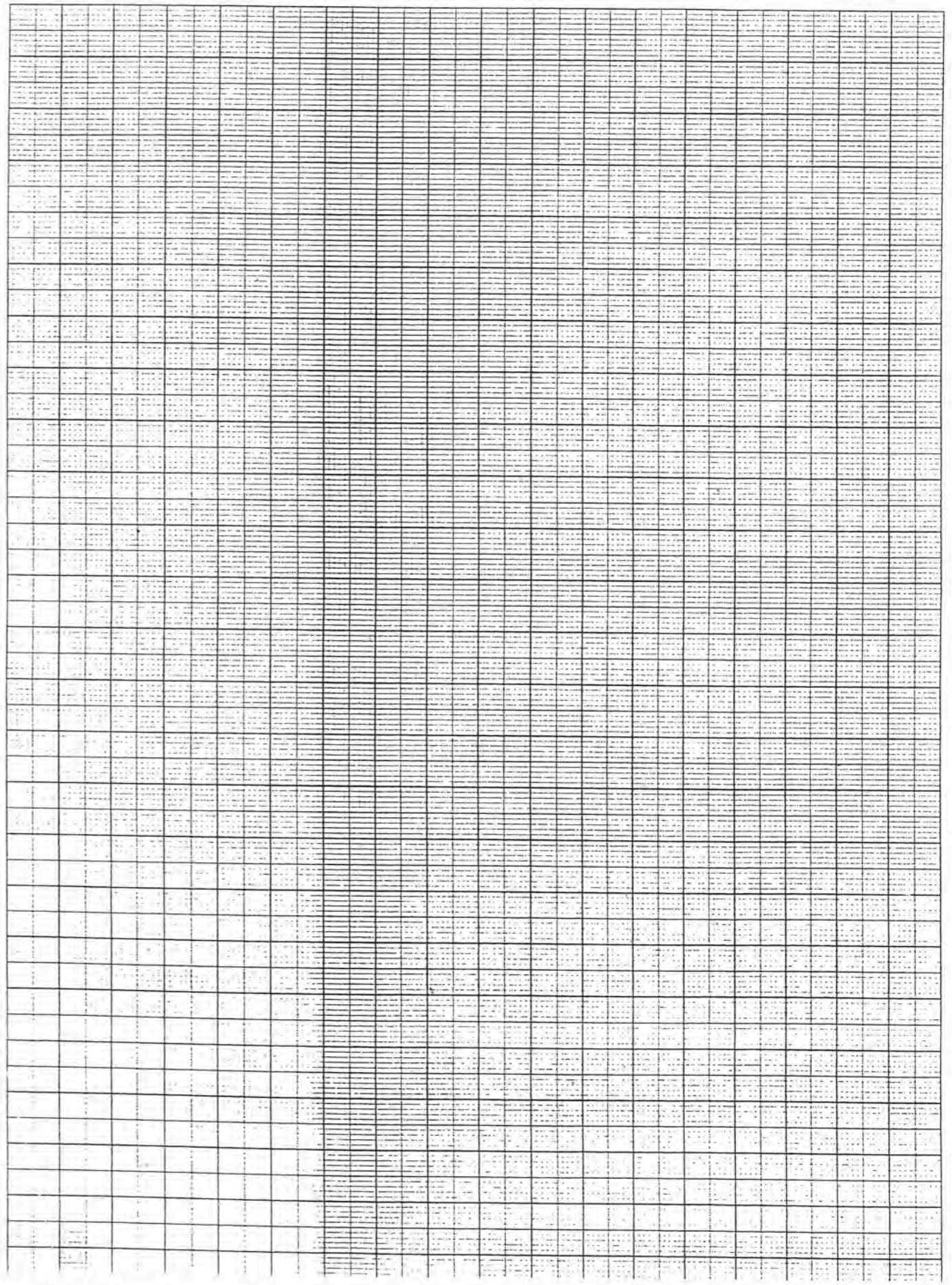

Trench... A 105 Initials..... Date... 10/5 Page.....
Locus... 4 Spit... 1 Locus..... Spit..... Feature/s

	No. of bags	Loc/spit 4.1	Loc/spit
Pottery		1	
Bone		1	
Charcoal			
Plaster			
Tile			

No.	Object	Loc/Spit
3	AE coin 10.458	4.1/2
	Unidentified Seal	

Photographs:

Context	Report
10/5	<u>4.1</u> continued
	Continued removal of hard yellow just above jebel
	There seem to be an even frame surface below hard yellow — coin
	* Object 3 on this surface (although may have fallen) should be approx. 1.55m below top of Wall 3 in Tr 101
	<u>4.2</u>
	It is above Jebel
	It is below 4.1
	In hard yellow which should be very close to jebel

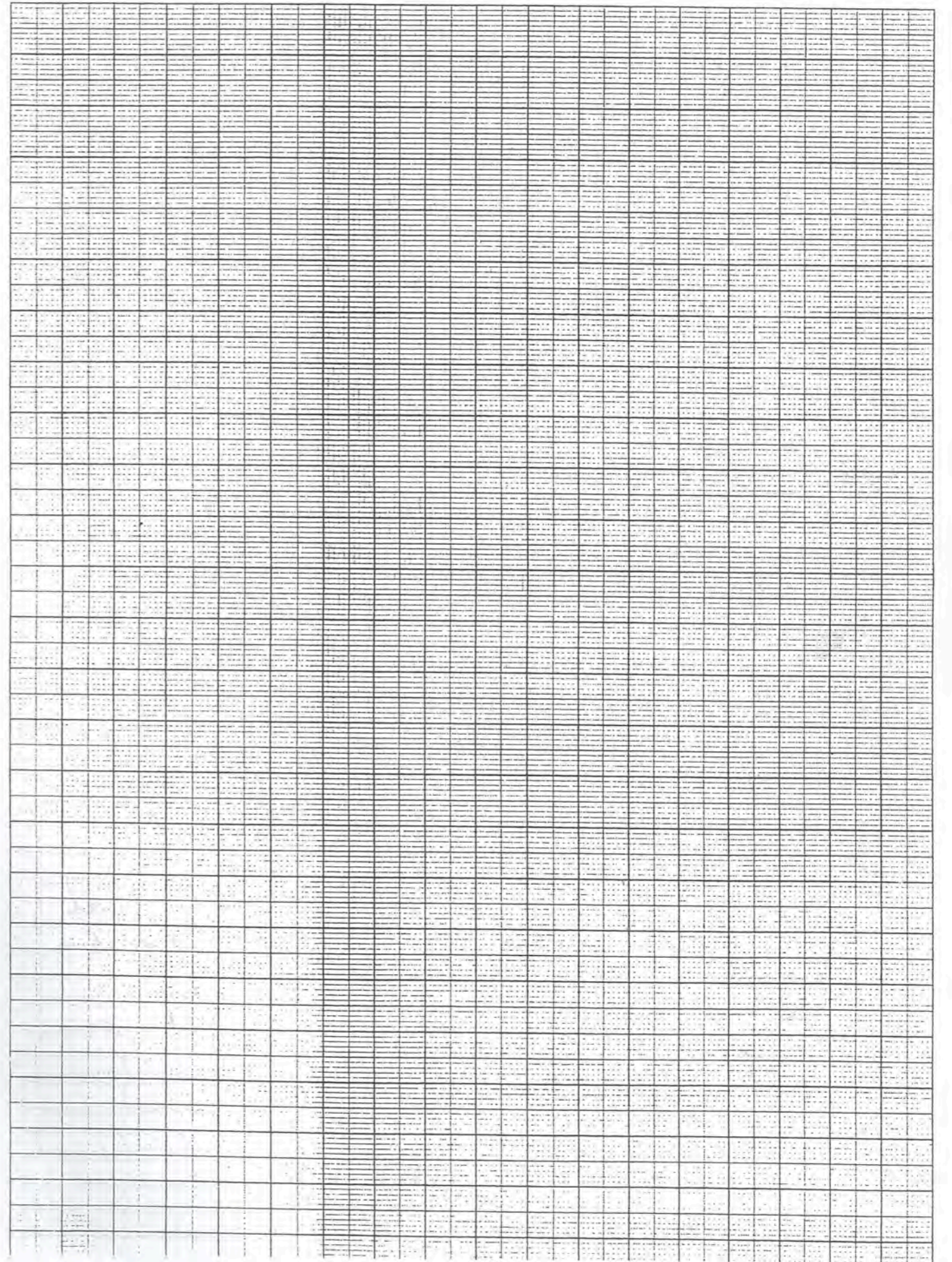

Trench A 105 Initials JCT Date 11/5 Page

Locus 4 Spit 2 Locus Spit Feature/s

	No. of bags	Loc/spit	Loc/spit
Pottery		1	
Bone		≠	
Charcoal			
Plaster			
Tile			

No.	Object	Loc/Spit

Photographs: 940-944

Context	Report
11/5	<u>4.2</u> - contd
	Continued removal - have reached jebel ∴ cease.
12/5	Photos external face of Wall 3 (ie from West) 940-944
	But note face of probable Wall on south bank which runs East-West. This is named Wall 12 & is probably early phase wall as rests on jebel.

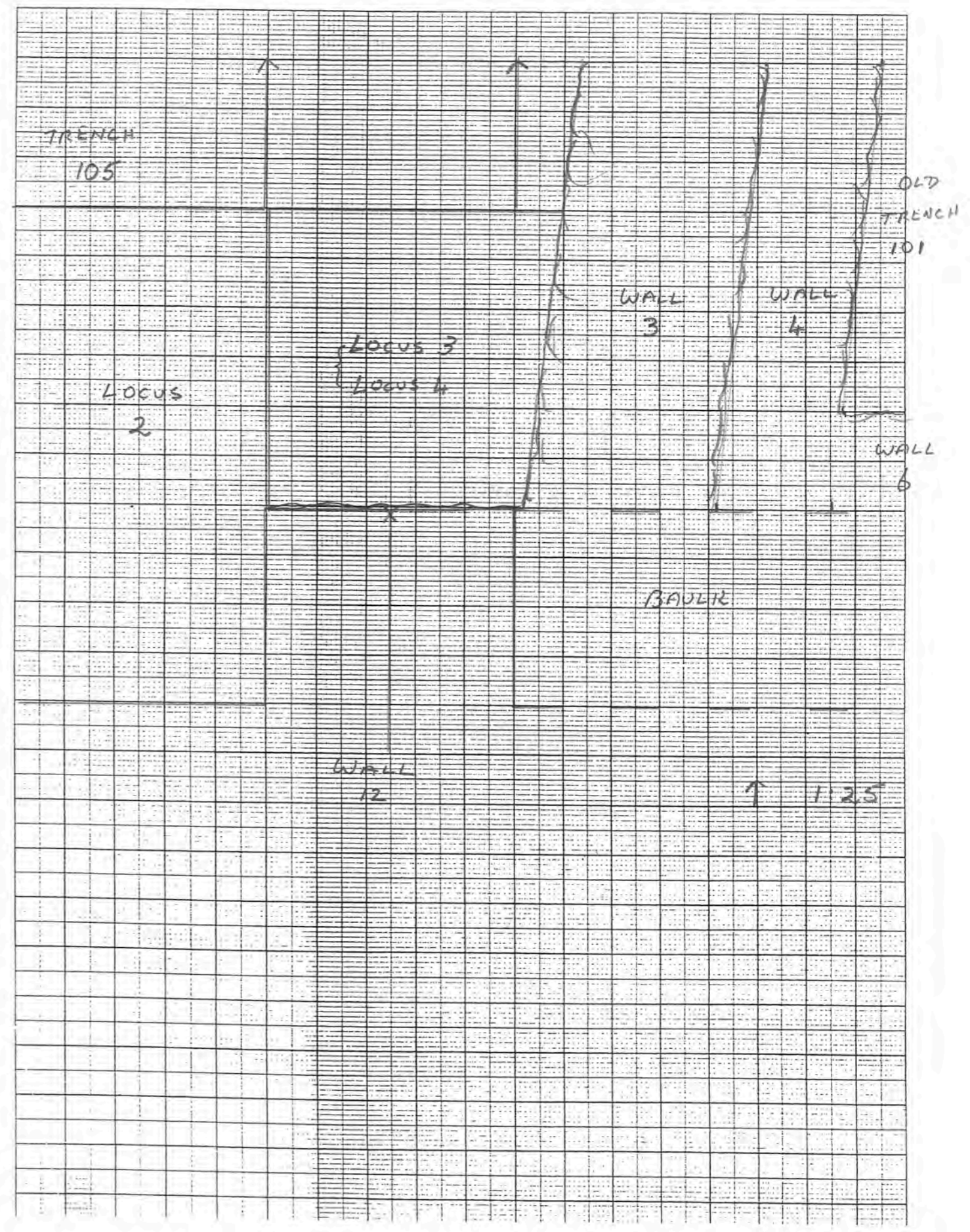

Trench A 106 Initials Date Page

Locus Spit Locus Spit Feature/s

	No. of bags	Loc/spit	Loc/spit
Pottery			
Bone			
Charcoal			
Plaster			
Tile			

No.	Object	Loc/Spit

Photographs:

Context	Report
	<u>INTRODUCTION</u>
	A further trench - A 106 - was opened further to the west of A 105 and straddling the North-south wall lines clearly visible before excavation. There were also very obvious before work on the southern acropolis commenced in 2006
	The trench is separated by a 2.0m bank from A 105 and its dimensions are 5m (N-S) x 10m (E-W).
	Bathymetry 18.6
	NE 19.2
	SE 22.8
	NW 11.6
	SW 0.79

	LOCUS / LEVEL	INDEX
[1.1]	22, 24, 28	
2	24, 26	
[2.1]	30, 36, 38, 40	
[3.1]	32, 34	
[4.1]	42	

Trench A 106 Initials Date 11/5 / 10/5 Page
 Locus 1 Spit 1 Locus Spit Feature/s

	No. of bags	Loc/spit	Loc/spit
Pottery			
Bone			
Charcoal			
Plaster			
Tile			

No.	Object	Loc/Spit
1	FE Coin	1.1 Surface
	10.468	10.468
	Archaeological second reign	
	NO-109	

~~Archaeological second reign~~
~~NO-109~~
 STET
 ANT 17
 110-109

Photographs:

Context	Report
	<u>1.1</u> Topsoil / Tumble It is above It is below -
	Commence removal of topsoil on eastern half (5x5m) of trench. Very very dense stone tumble from beginning - presumably from the north-south walls. Virtually NO pottery <u>Object 1</u> - FE Coin No wall detected as yet
11/5	Continued - will continue to dig a narrow (~1m) strip from west to east to try to pick up wall. Fit about 50 cm below ground level start to get usual ash layer (below dense tumble). Will change levels soon.

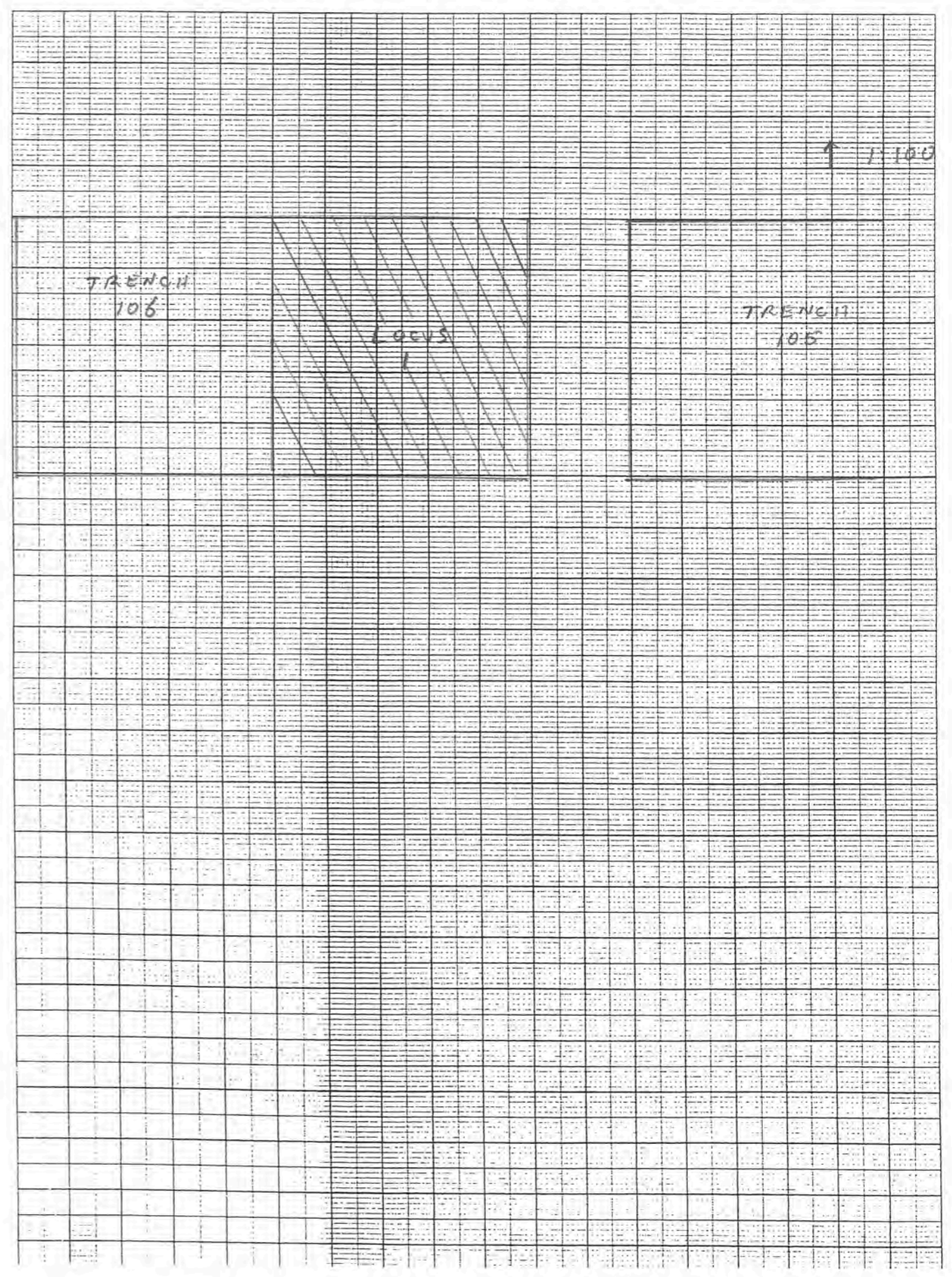

Trench...106.....Initials...JST Date 12/5..... Page.....
 Locus...1.....Spit...2..... Locus.....1..... Spit...1..... Feature/s

	No. of bags	Loc/spit 1.2	Loc/spit
Pottery		11	
Bone		1	
Charcoal			
Plaster			
Tile			

No.	Object	Loc/Spit
2	Megarian bowl fr	1.2
3	" " "	1.1

Photographs:

Context	Report
12/5	<u>1.2</u> Ashy - to West of Presumed Wall It is above It is below 1.1 Futile digging in attempt to locate N-S wall which should be present. * <u>Object 2</u> - megarian fr (as is often the case in this ash level) Very ashy indeed - *sample taken* much fuller - gas mainly → p 26
	<u>1.1</u> continues Also continuation of 1.1 in S ^d half of trench across all E-W. Very large black layers N-S located <u>Object 3</u> - megarian fr Soon will change loc / level to west of "wall" & ashy.

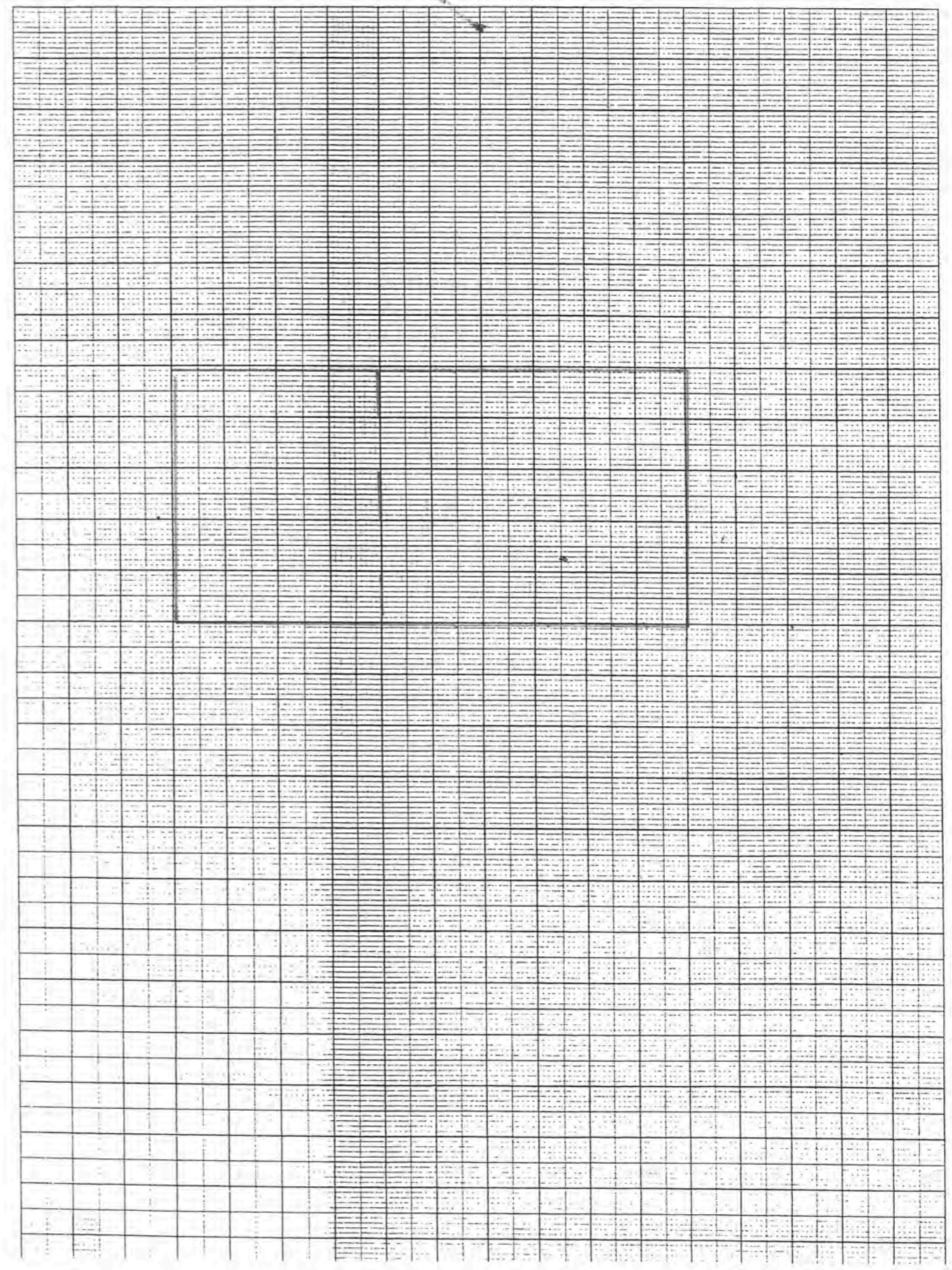

Trench..... A 106 Initials JG Date 13/5 Page.....
 Locus..... 1 Spit..... 2 Locus..... Spit..... Feature/s

	No. of bags	Loc/spit	Loc/spit
Pottery			
Bone			
Charcoal			
Plaster			
Tile			

No.	Object	Loc/Spit

Photographs:

Context	Report
12/5 (cont)	<u>1.2</u> - cont Ashy
	Much removed pottery - mainly jars & probably amphora. Still probably fill & refuse from Governor's Palace above.
	But not many bones. As definitely on west of Wall 1 will arbitrarily change to 2.1
13/5	Baulk straightening - N ^d & west in north sector.
	Continue removal of Topsoil / Tumble (1.1) in 5 th sector.
	<u>NB</u> North & south sectors are divided by arbitrary temporary E-W baulk which is 1.10 m to the south of the northern boundary of the trench & finishes at 2.80 m to the south ∴ 1.70 m broad but will be partially removed soon.
16/5	Cleaning top of level & recovered.

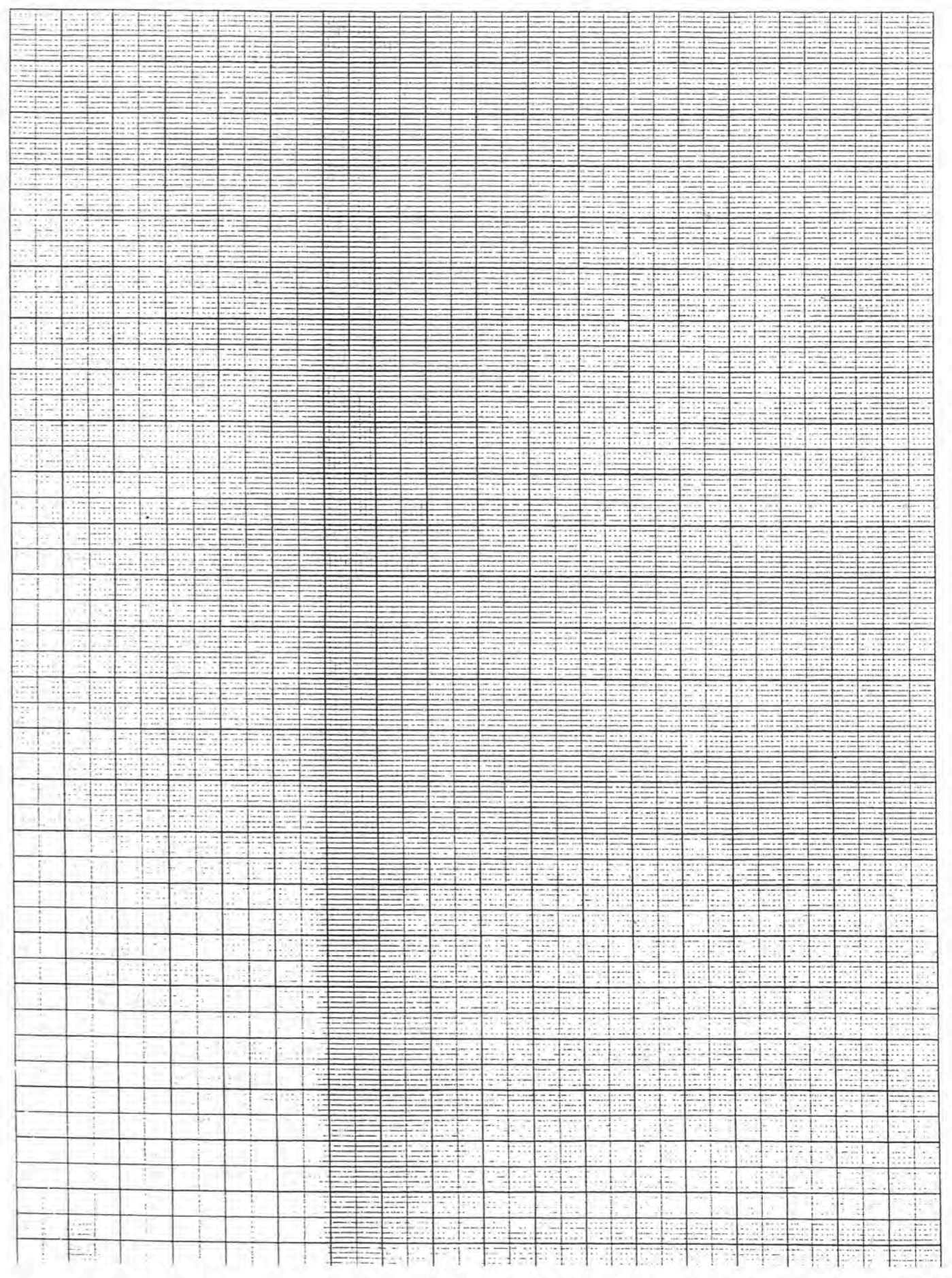

Trench... A. 106 Initials. JCF Date. 13/5 Page.....
 Locus..... 1 Spit..... 1 Locus..... Spit..... Feature/s

	No. of bags	Loc/spit	Loc/spit
Pottery			
Bone			
Charcoal			
Plaster			
Tile			

No.	Object	Loc/Spit
4	AE bangle	1.1

Photographs:

Context	Report
13/5	<u>1.1</u> - contd
	Continue to remove ^{tumble} topsoil to East of Wall 1 and west of Wall 1 in N th section & S th section respectively
	No pottery kept
	Now ashy level appeared in N th section to East of Wall 1 - no doubt equivalent to 1.2/2.1 but make 3.1
	<u>Object 4</u> - AE bangle - west of Wall 1 (in south sector)
15/5	Continued removal of ^{tumble} topsoil from rest of trench - Eastern face of Wall 1 picked up - there appear to be several very large well cased blocks (chert? stone?) in south part of wall
16/5	* CE In Eastern 5 metres

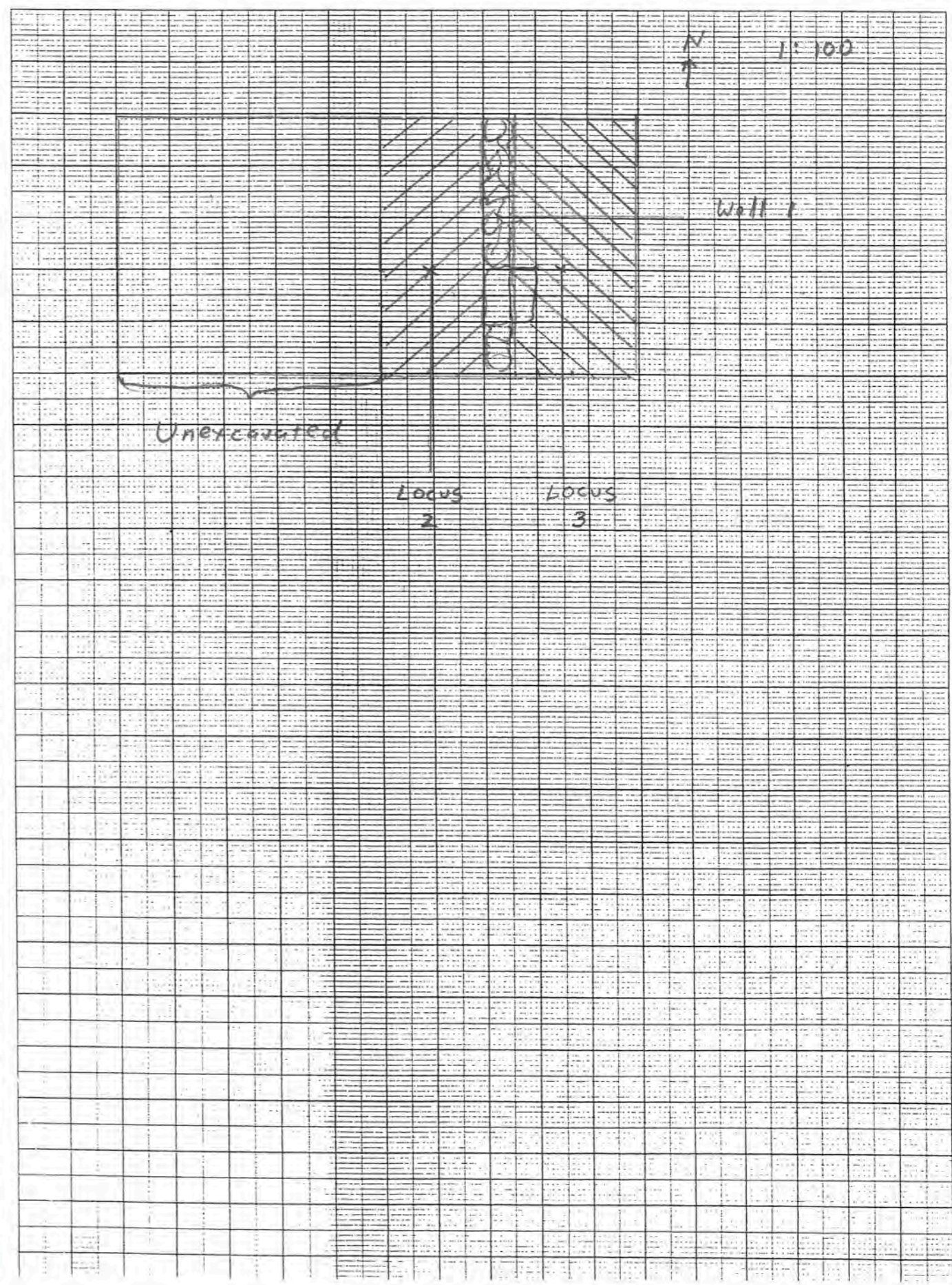

Trench... A 106 Initials... JCT Date... 15/5 Page.....
 Locus... 2 Spit... 1 Locus..... Spit..... Feature/s

	No. of bags	Loc/spit 2.1	Loc/spit
Pottery		11	
Bone		11	
Charcoal			
Plaster			
Tile			

No.	Object	Loc/Spit
5	mezaman bowl / 12	2.1
6	Fe nail	2.1
12	Lamp frag	2.1
27	Fe chert pin	2.1
28	Fe point	2.1
29	metal point	2.1
30	metal frag	2.1

Photographs:

NO INV

Context	Report
15/5	<p>as yet — "2nd C"</p> <p><u>2.1</u> Ashy level west of Wall 1 It is above It is below (& same as): 1.2</p> <p>This includes the ashy level in both north & south sections of trench Again much pottery similar to 1.2 (the ashy level in N^d section). The ash is mixed with soil</p>
16/5	<p>Continuation</p> <p>In south section a further east-west wall (Wall 2) is starting to be revealed ∴ will soon change loc & dig to south of it.</p> <p>* Object 5 - mezaman bowl fr 12 * Object 6 - Fe nail</p> <p>Wall 2 is probably earlier than Wall 1 which seems to cut it. Ash seem to have covered Wall 2 & then was cut through by Wall 1.</p>

→ page 36

* Object 12 - Lamp frag

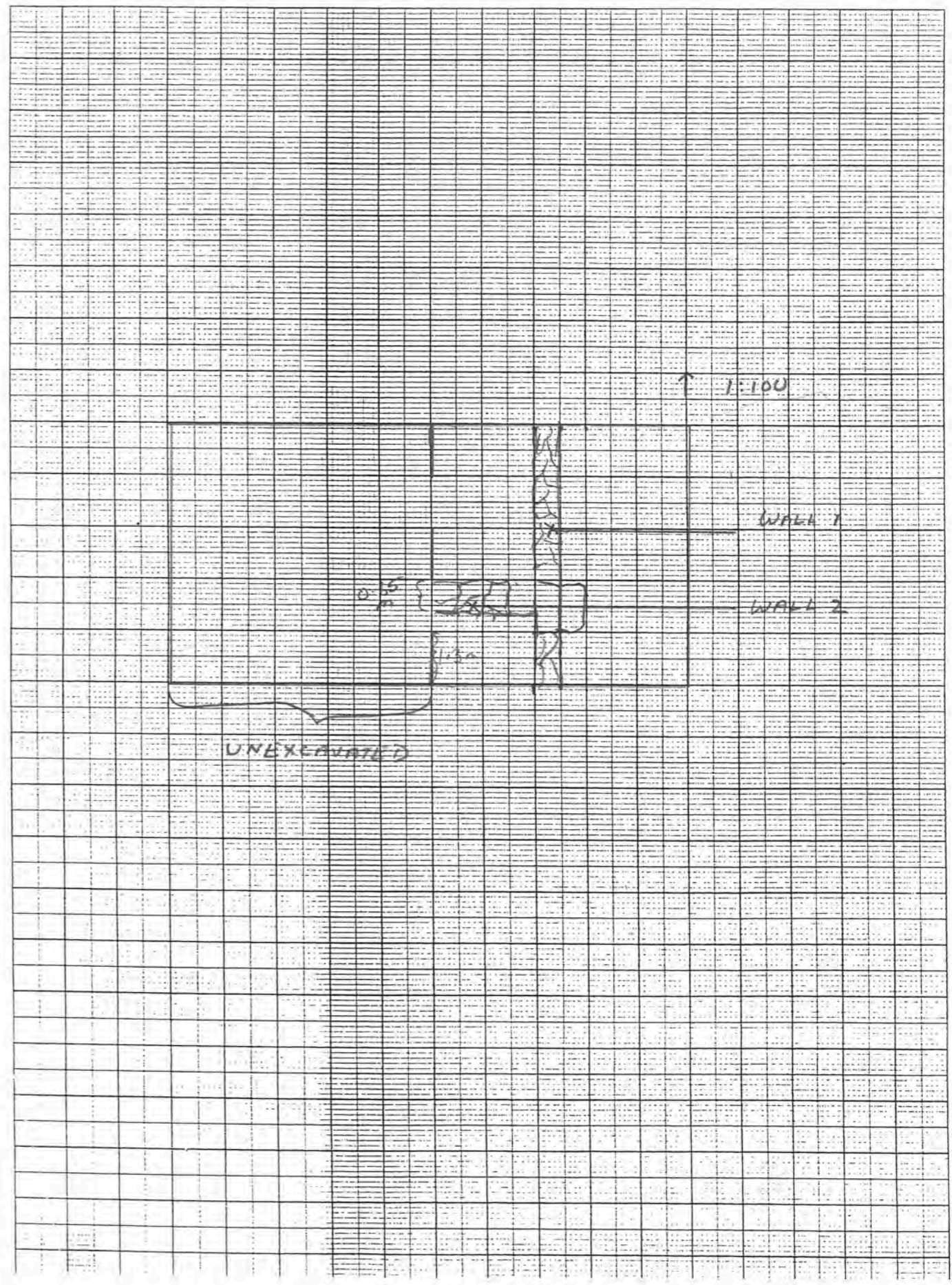

Trench... A 106 Initials... JH Date... 16/5 Page... 13/5
 Locus... 3 Spit... 1 Locus... Spit... Feature/s

	No. of bags	Loc/spit	Loc/spit
Pottery		11	
Bone		11	
Charcoal			
Plaster			
Tile			

No.	Object	Loc/Spit
4	Mezaran fr	3.1
5	Mezaran fr	3.1
7	Mezaran fr	3.1

Photographs:

Context	Report
13/5	<u>3.1</u> Ashy level ^{East} of Wall 1
	It is above
	It is below: 1.1
	* <u>Object 5</u> - Mezaran fr.
	Thick ash level continues - much pottery but only moderate bone. Mixed with soil
16/5	Continues in central & smaller section to back down to same depth as 3.1 in N th section
	* <u>Object 7</u> - Mezaran fr.

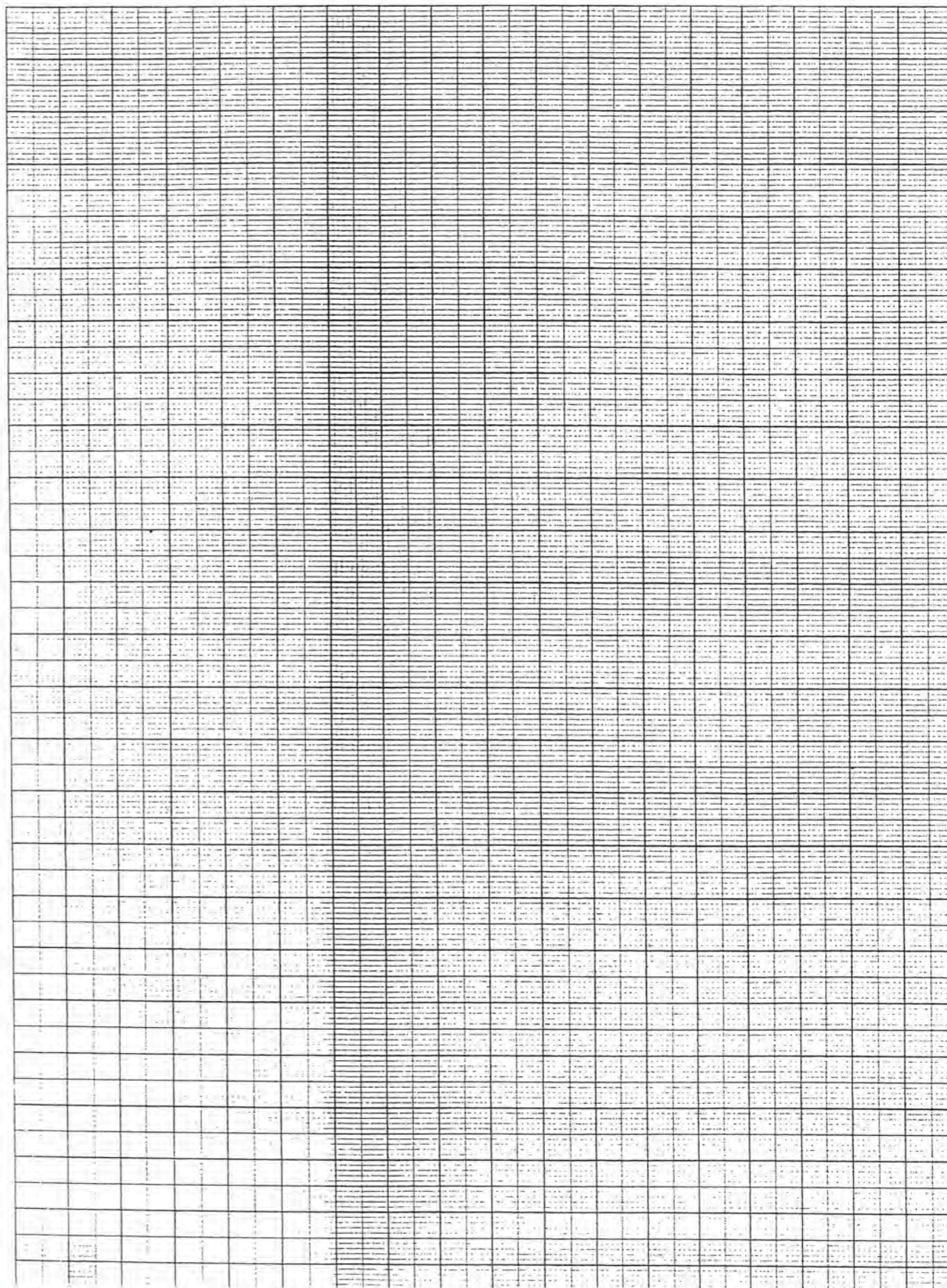

Trench... A 106 Initials... J+ Date... 18/5 Page.....
 Locus... 3 Spit... 1 Locus..... Spit..... Feature/s

	No. of bags	Loc/spit 3.1	Loc/spit
Pottery		11	
Bone		11	
Charcoal			
Plaster			
Tile			

No.	Object	Loc/Spit
13	Fe Nail	31

Photographs:

Context	Report
17/5	<u>3.1</u> - contd
	Further encasement in middle & S ^d section to get down to same depth as N ^d section
	Patches of more ashy areas inter-mixed with less ashy - comment until being washed down from above?
	Also patches of small stone chips in ash.
18/5	Continuation in ashy level * <u>Object 13</u> - Fe nail

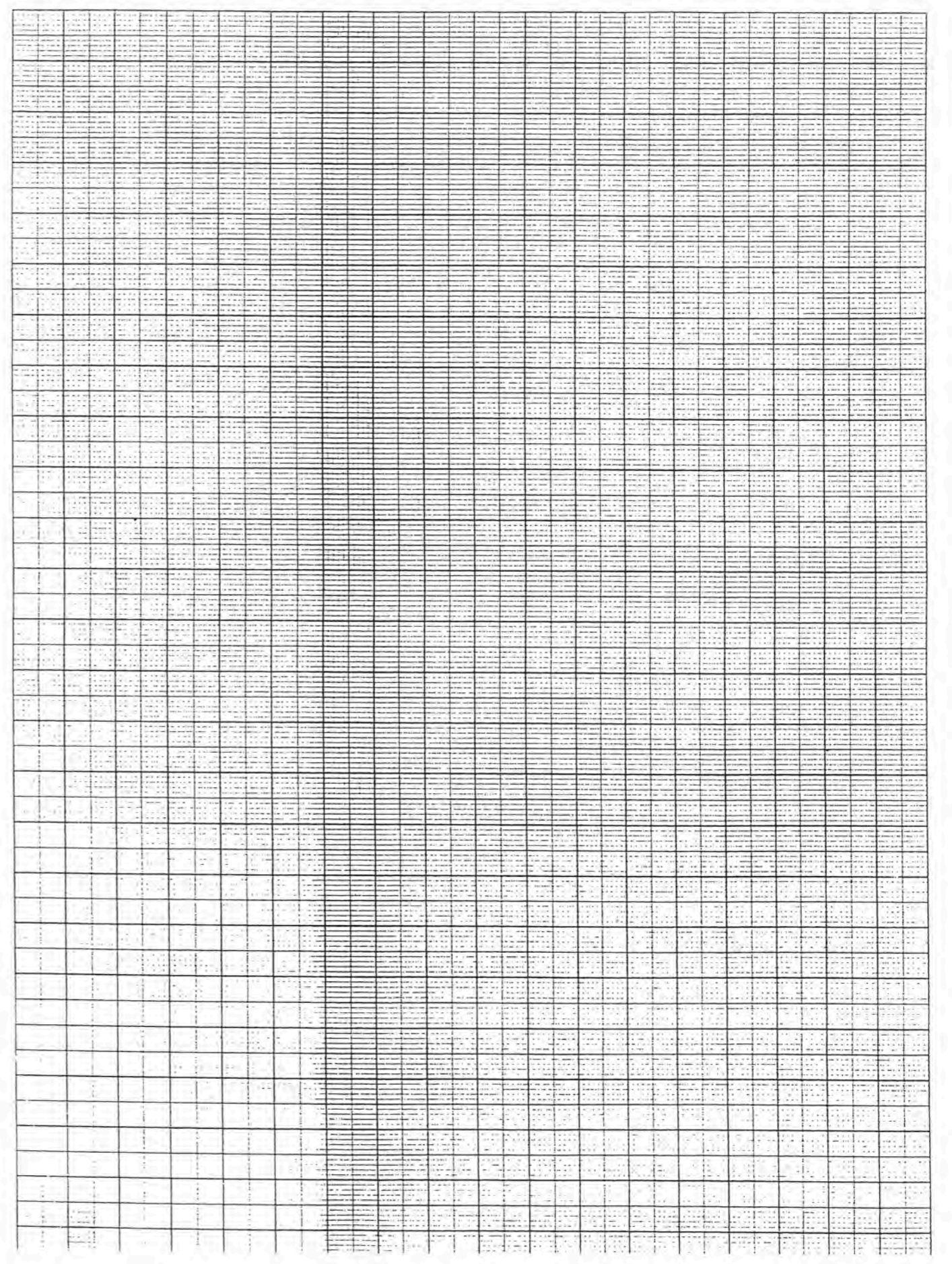

Trench...106.....Initials. JCT...Date. 17/5..... Page.....

Locus.....2.....Spit...1..... Locus..... Spit..... Feature/s

	No. of bags	Loc/spit 2.1	Loc/spit
Pottery		1	
Bone		1	
Charcoal			
Plaster			
Tile			

No.	Object	Loc/Spit
9	Mezarian fr	2.1
10	Fe Nail	2.1
11	Mezarian fr	2.1
22	Sharped amphora handle 10.977	2.1

21/2/75

Photographs:

Context	Report
17/5	[2.1] - context
	Continuation of the level over southern sector. In section, seem to be here surface which has been partially dug through. !: care required!
	* Object 9 - Mezarian fr.
	* Object 10 - Fe Nail
	Further careful digging has not found definite surface or, if so, very marked up!
	Although part of ashy level, at different depth there is more stone tumble from walls.
	* Object 11 - mezarian fr.
	* Object 22 - Sharped amphora handle

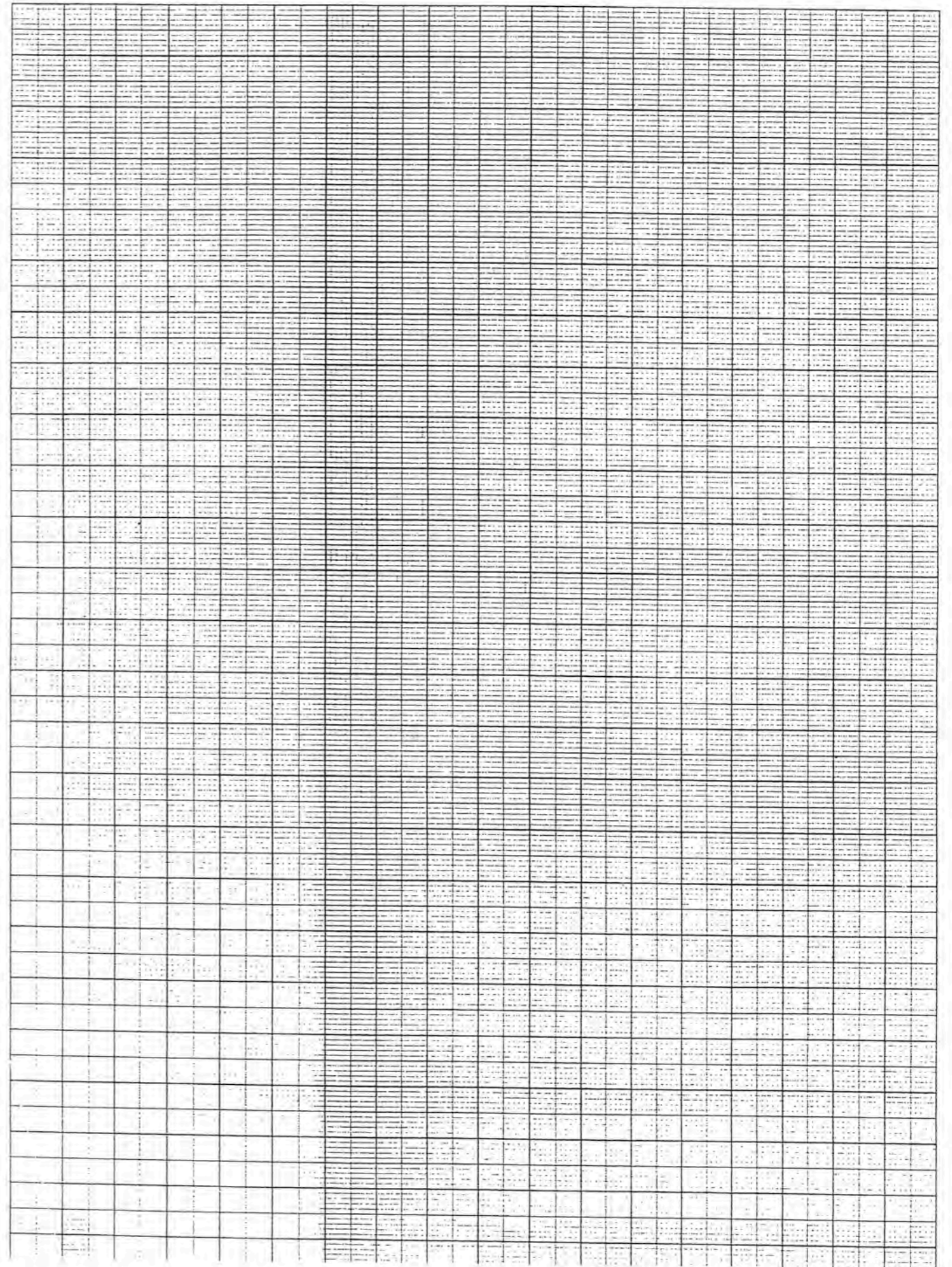

Trench.....106.....Initials...J.C.....Date...18/5..... Page.....
Locus.....2.....Spit.....1..... Locus..... Spit..... Feature/s

	No. of bags	Loc/spit	Loc/spit
Pottery		1	
Bone		1	
Charcoal			
Plaster			
Tile			

No.	Object	Loc/Spit
14	Fe nail	2.1
15	Fe nail	2.1
16	West slope f.	2.1
17	Glass frag	2.1
18	Fe ring	2.1
19	Fe nail	2.1
20	Glass bead	2.1
21	Glass frag	2.1
31	Inclusion WSW	2.1

Photographs:

Context	Report
18/5	[2.1] - cont'd
	Continuation in ashes level
	* Object 14 - Fe nail
	* Object 15 - Fe nail
	* Object 16 - WSW frag
	* Object 17 - Glass frag
	* Object 18 - Fe ring
	* Object 19 - Fe nail
	* Object 20 - Glass bead
	* Object 21 - Glass frag
	* Object 31 - inclusion WSW
	One dozen or so clay beam weights recorded

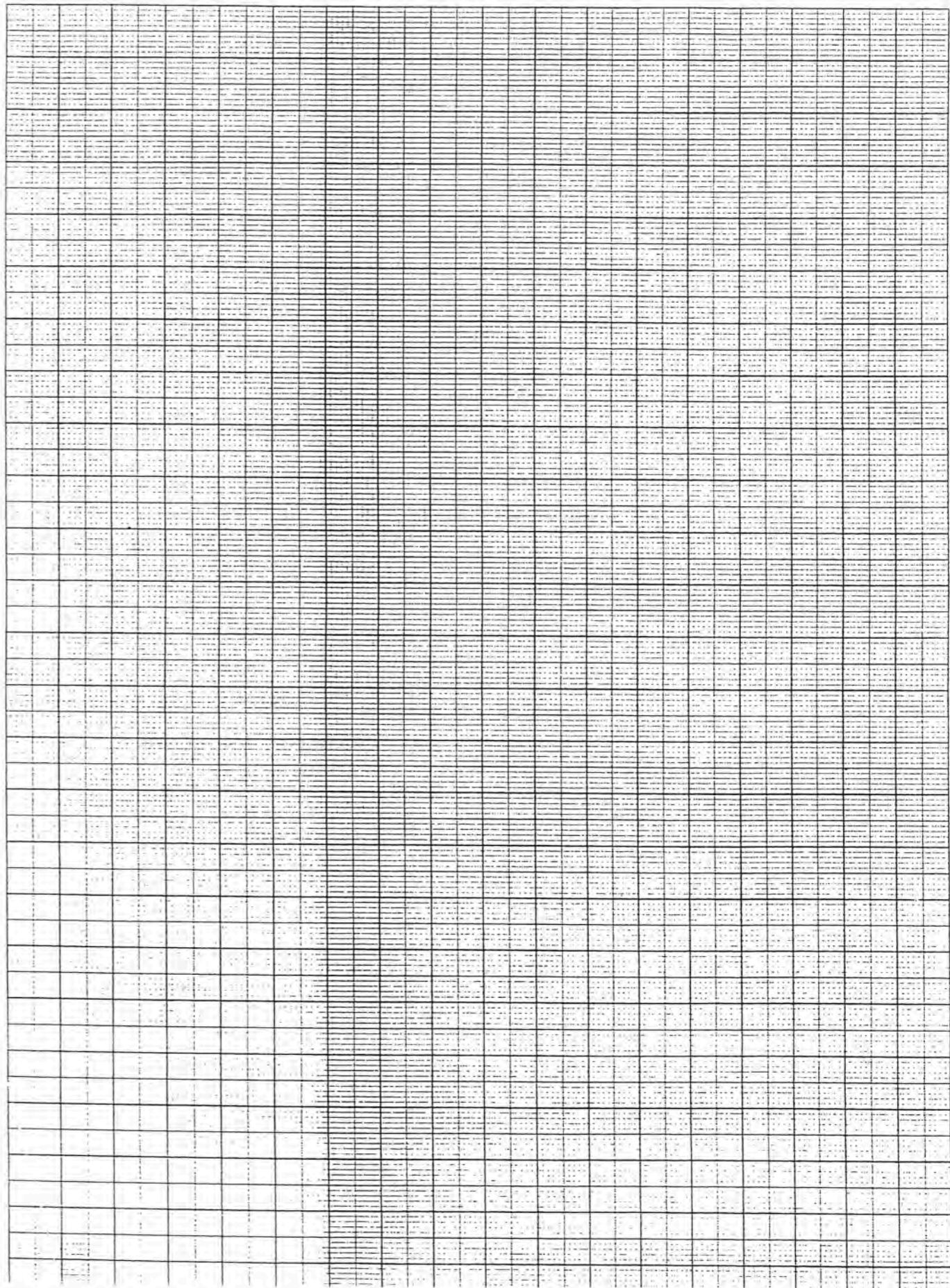

Trench... *A 106*Initials... *JCT*Date... *19/5* Page.....

Locus... *2*Spit... *1* Locus..... Spit..... Feature/s

	No. of bags	Loc/spit <i>2.1</i>	Loc/spit
Pottery		<i>1</i>	
Bone		<i>1</i>	
Charcoal			
Plaster			
Tile			

No.	Object	Loc/Spit
<i>23</i>	<i>AE First lead</i>	<i>2.1</i>
<i>24</i>	<i>Shrapnel lead weight</i>	<i>2.1</i>
<i>25</i>	<i>Glau frit</i>	<i>2.1</i>
<i>26</i>	<i>Glau frit</i>	<i>2.1</i>
<i>32</i>	<i>Lamp frit cleaning</i> →	

Photographs:

↳ NO INV as yet "2nd e"

Context	Report
<i>19/5</i>	<i>[2.1] - Conch removal of thick deposit of ash soil</i>
	<i>+ Object 23 - AE first lead</i>
	<i>+ Object 24 - shrapnel lead weight</i>
	<i>+ Object 25 - Glau frit</i>
	<i>+ Object 26 - Glau frit</i>
	<i>+ Object 32 - lamp frit - cleaning for photog</i>

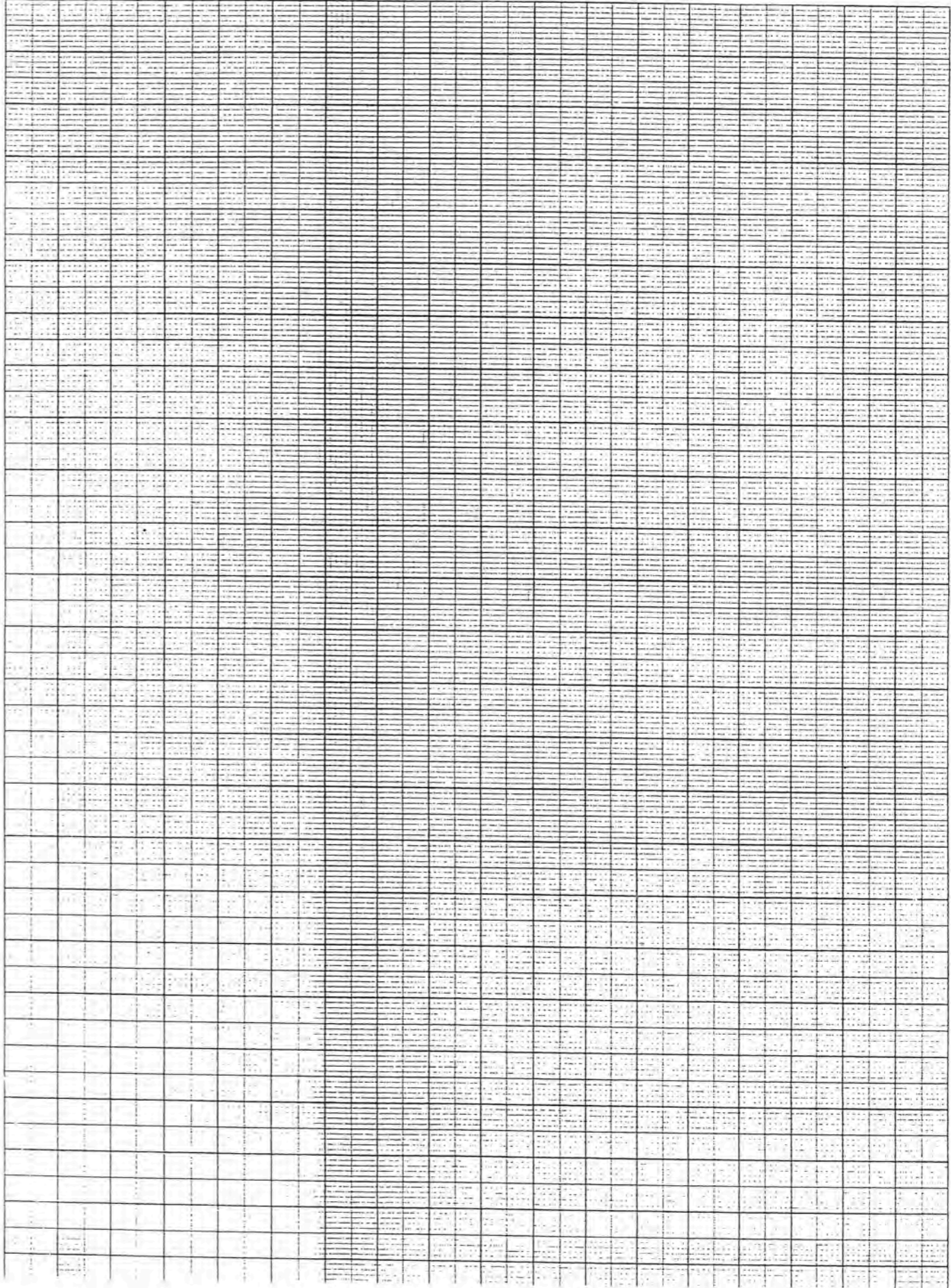

Trench... *A. 106* Initials... *JF* Date... *42* Page.....

Locus... *4* Spit... *1* Locus..... Spit..... Feature/s

	No. of bags	Loc/spit <i>4.1</i>	Loc/spit
Pottery		<i>1</i>	
Bone		<i>1</i>	
Charcoal			
Plaster			
Tile			

No.	Object	Loc/Spit

Photographs:

Context	Report
	<i>4.1 Ashy - South of Wall 2</i>
	<i>It is above</i>
	<i>It is below : 2.1</i>
	<i>Dug ~ 10 cms & then stopped because of wind & dust</i>

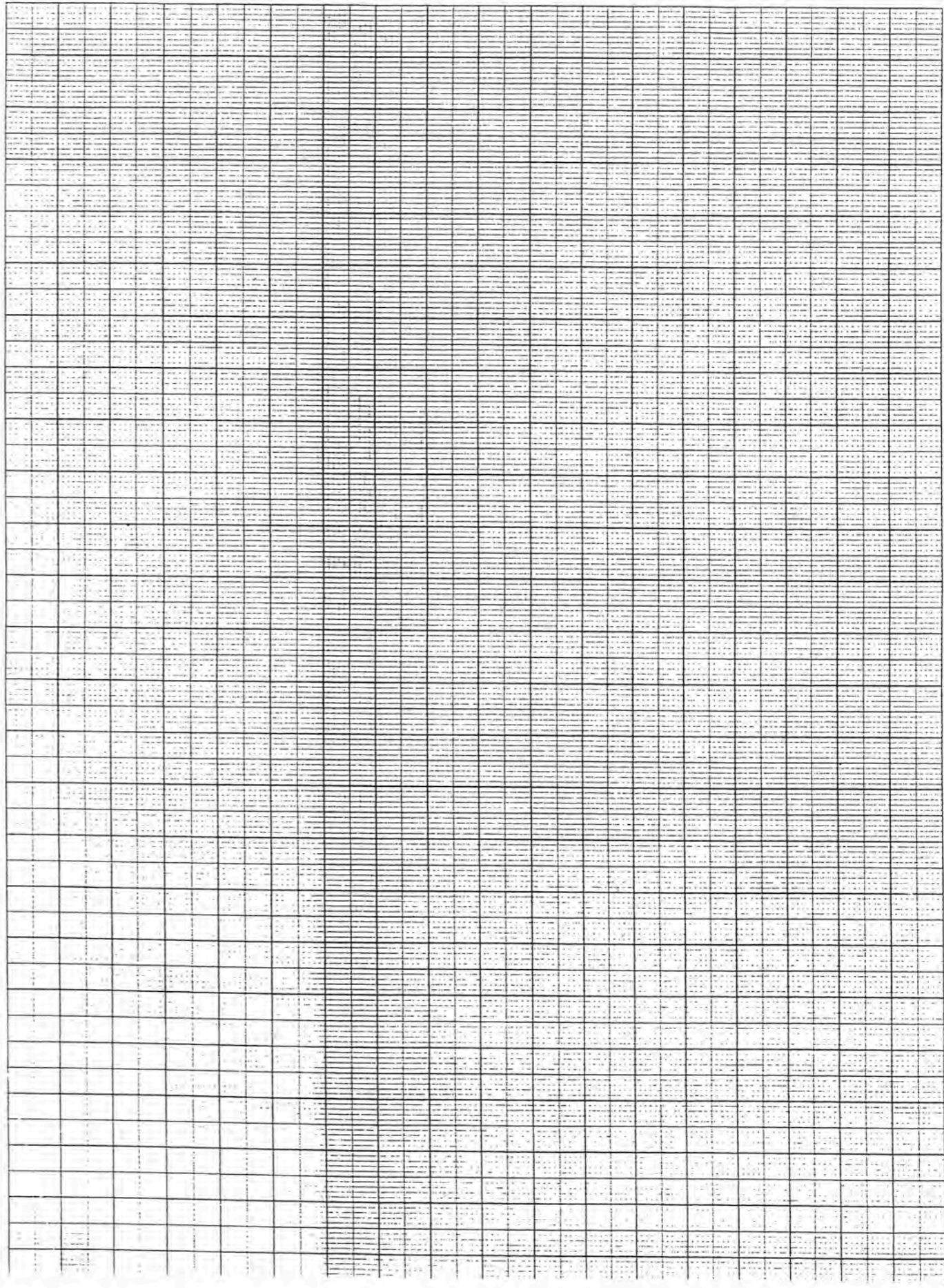

Trench.....Initials.....Date..... Page.....

Locus.....Spit..... Locus..... Spit..... Feature/s

	No. of bags	Loc/spit	Loc/spit
Pottery			
Bone			
Charcoal			
Plaster			
Tile			

No.	Object	Loc/Spit

Photographs:

Context	Report
	15 downy v late plan ~ Wall 3 in old level
	Then harder surface in loc 3 may have been "plaster" NE level of hollow of debris
	Threshold ~ 30 cm by 15 cm
	Wall 1 cuts wall 2

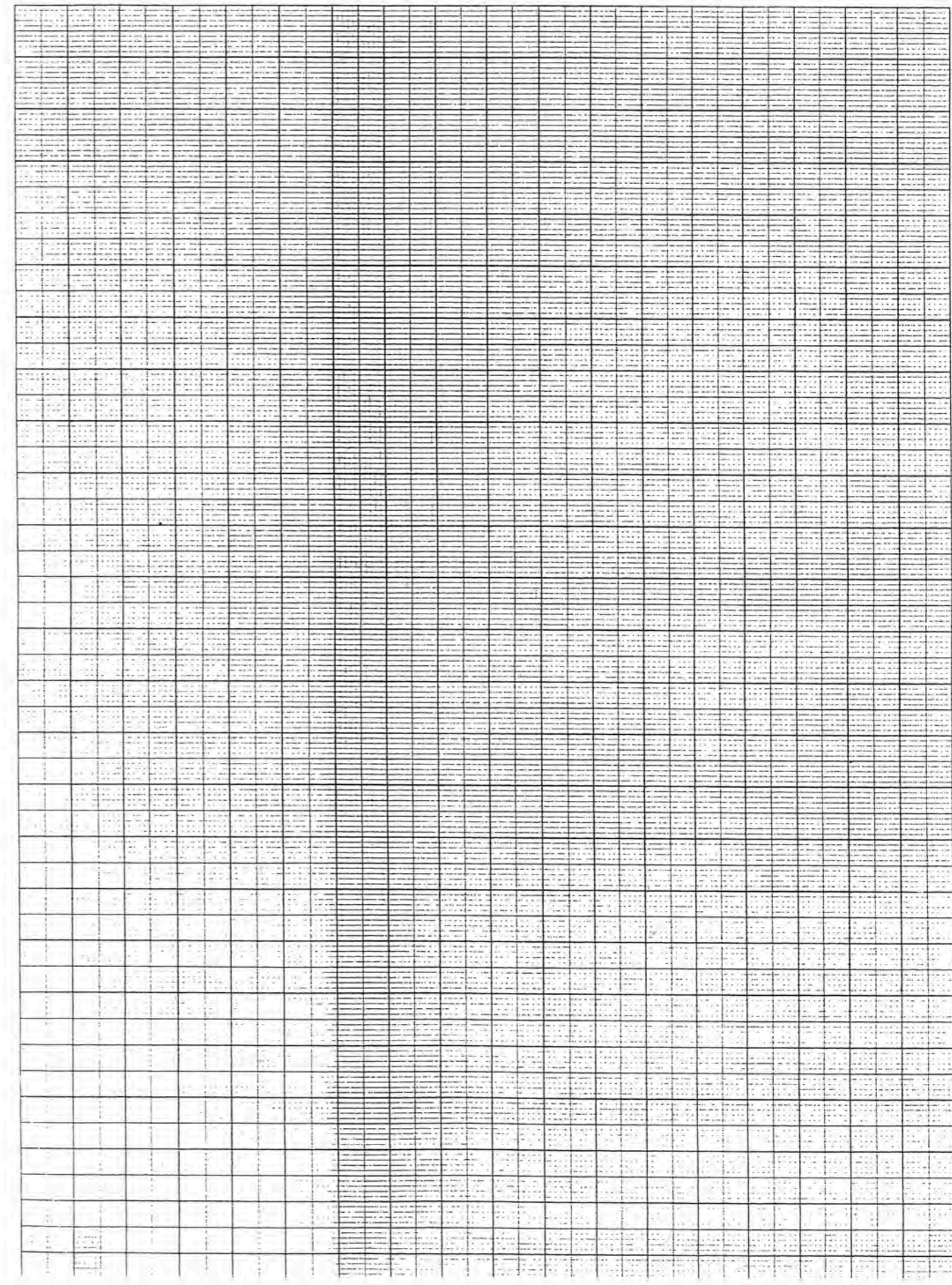

Trench.....Initials.....Date..... Page.....

Locus.....Spit..... Locus..... Spit..... Feature/s

	No. of bags	Loc/spit	Loc/spit
Pottery			
Bone			
Charcoal			
Plaster			
Tile			

No.	Object	Loc/Spit

Photographs:

Context	Report										
	<u>COIN LIST</u>										
	<u>TRENCH 105</u>										
	<table border="1"> <thead> <tr> <th>Page</th> <th>Obj</th> <th>Context</th> <th>Inv</th> <th>Description</th> </tr> </thead> <tbody> <tr> <td>16</td> <td>3</td> <td>401</td> <td>10.458</td> <td>Selenites unidentified</td> </tr> </tbody> </table>	Page	Obj	Context	Inv	Description	16	3	401	10.458	Selenites unidentified
Page	Obj	Context	Inv	Description							
16	3	401	10.458	Selenites unidentified							
	<u>TRENCH 106</u>										
	<table border="1"> <thead> <tr> <th>Page</th> <th>Obj</th> <th>Context</th> <th>Inv</th> <th>Description</th> </tr> </thead> <tbody> <tr> <td>22</td> <td>1</td> <td>Surfau</td> <td>10.468</td> <td>Anteuch 1x [c III/110]</td> </tr> </tbody> </table>	Page	Obj	Context	Inv	Description	22	1	Surfau	10.468	Anteuch 1x [c III/110]
Page	Obj	Context	Inv	Description							
22	1	Surfau	10.468	Anteuch 1x [c III/110]							
	<u>STAMPED AMPHURAL</u>										
	<table border="1"> <thead> <tr> <th>Page</th> <th>Obj</th> <th>Context</th> <th>Description</th> </tr> </thead> <tbody> <tr> <td>36</td> <td>22</td> <td>2.1</td> <td>Sokratos II (fabr) c212-175</td> </tr> </tbody> </table>	Page	Obj	Context	Description	36	22	2.1	Sokratos II (fabr) c212-175		
Page	Obj	Context	Description								
36	22	2.1	Sokratos II (fabr) c212-175								

6

