

Jebel Khalid

2008

ANAS

Field Record Book

Name.....	BRUCE ANLARDICE
Trenches.....	22,
Dates.....	27-4-08 →

ADVICE to TRENCH SUPERVISORS

1. Take a **new page** for each day. (Each day may take several pages).
2. Draw a **scale plan** of the trench **each day** on the graph paper (essential), with North at the top (if this is not convenient, mark North direction clearly).
When starting a square, this plan may be nearly empty but draw it all the same and mark in emerging tumble. The graph paper can also be used for sketching objects etc.
3. Mark **depth** from surface at the beginning of each day, at designated points. Also record, each day, the depths taken on the sheet provided (kept in the back of your field record book)
4. Draw arrows on your plan to indicate **direction** in which you are excavating.
4. Every time you designate a new context, (on the occasion of a new spit, a new feature, a new soil colour) fill in the **Context Record Sheet** for that trench, as well as describing it in your report. Store the accumulated context record sheets in the plastic sleeve in your record book.
5. **Structures** . Measure carefully any structure (wall, doorway, threshold, ovens, pit, any large dressed stones or columns) and record exact location, height, width in your report as well as on the scale plan.
6. **Floors** - marked by very hard tough surface or layer of white crushed limestone. May be softer adjacent to wall. Record thickness of floor, if we decide to dig through it.
If your floor is particularly good, collect a few bags of surface material - there may be seeds.
7. **Objects**. e.g. glass, figurine or lamp fragments, metal, stucco, loomweights, spindle whorls, beads, graffito-ed sherds, coins, gold jewellery (some hope). Mark in the location and depth of any objects clearly and accurately. If necessary, draw another sketch plan as the day progresses. A quick sketch of the object in the report would be helpful, if it is too mysterious to name e.g. Mattie's metal blobs.
8. **Pottery**: label bags clearly in waterproof pen, with one label inside the bag and one outside. Record daily the number of bags per context . Be very careful to separate pottery from different contexts.
It is absolutely essential to double-bag the pottery. A broken bag of pottery without context is useless.
9. **Bone**: Collect all bone and label as for pottery. Record number of bags per context daily.
10. **Charcoal**: Collect all charcoal and label as for pottery. Record number of bags per context daily.
11. **Tile**: it is important to record the location and amount of tile.
12. **Very important**: at the completion of a trench,
 - i DRAW (TO SCALE) a section of the exposed baulk, with details of stratigraphy clearly marked.
 - ii DRAW (TO SCALE) a top plan of the completed trench, with contexts clearly marked.
 - iii WRITE a short summary with your interpretation of the trench.

List of equipment for Trench Supervisors

- Dig bag
- Water
- Clip board and spare clips for windy days
- Pens (water proof only - black or blue), pencils, ruler, eraser
- Measuring tape
- Plumb bob
- String
- Spirit level (may be shared)
- Supply of labels
- Supply of different-sized plastic bags
- Toilet paper (for wrapping delicate objects as well as for personal use!)
- Small cartons/boxes for objects. When available
- Band-aids and aspirin for the vapours (yours or the workers')

Useful words

All	kull
All of you	kullkum
All even (same)	kull sawa-sawa
Bedrock	jebel
Big	kabeer
Black	aswad
Bone	az'm
Boy	walad
Brush	forshay
Charcoal	fah'm
Cleaning	tanzeef
Dead	mowt
Eating!	mangariyya
Floor	ardth

From	min
Girl	bint
Glass	azeez
Half	nuss
Here	hona
I	ana
Iron	hadeed
Little, small	sagheer
Man	rajul
Maybe, perhaps	mumkin
Must	laazim
Must not!	mu laazim
My (my son)	-ee e.g. walad-ee
Pick	kazma
Pottery	fachaar
Photo (picture)	soora
Red	ahmar
Rock	hajir
Room	gurfa
Sick	mareedth
Soil	trab
Slowly	shway, shway
Supervisor	mudeer
There is.. there is not	fi...maa fi
This	hadtha
To, for	ila, li
Today	al yowm
Tomorrow	bukra
Trowel	mustareen
Wall	jidaar
Water	mayy
Wheelbarrow	darraaja
White	abyad
Yesterday	imbaarih
You (sing. m/fanta,	anti
You (pl.)	antum

Broken
dark pen
Remove - still

Workseer
forshay

6stert
q. hawrah 1/2 han mangoria
11 Isriaha 10 uin
12 home

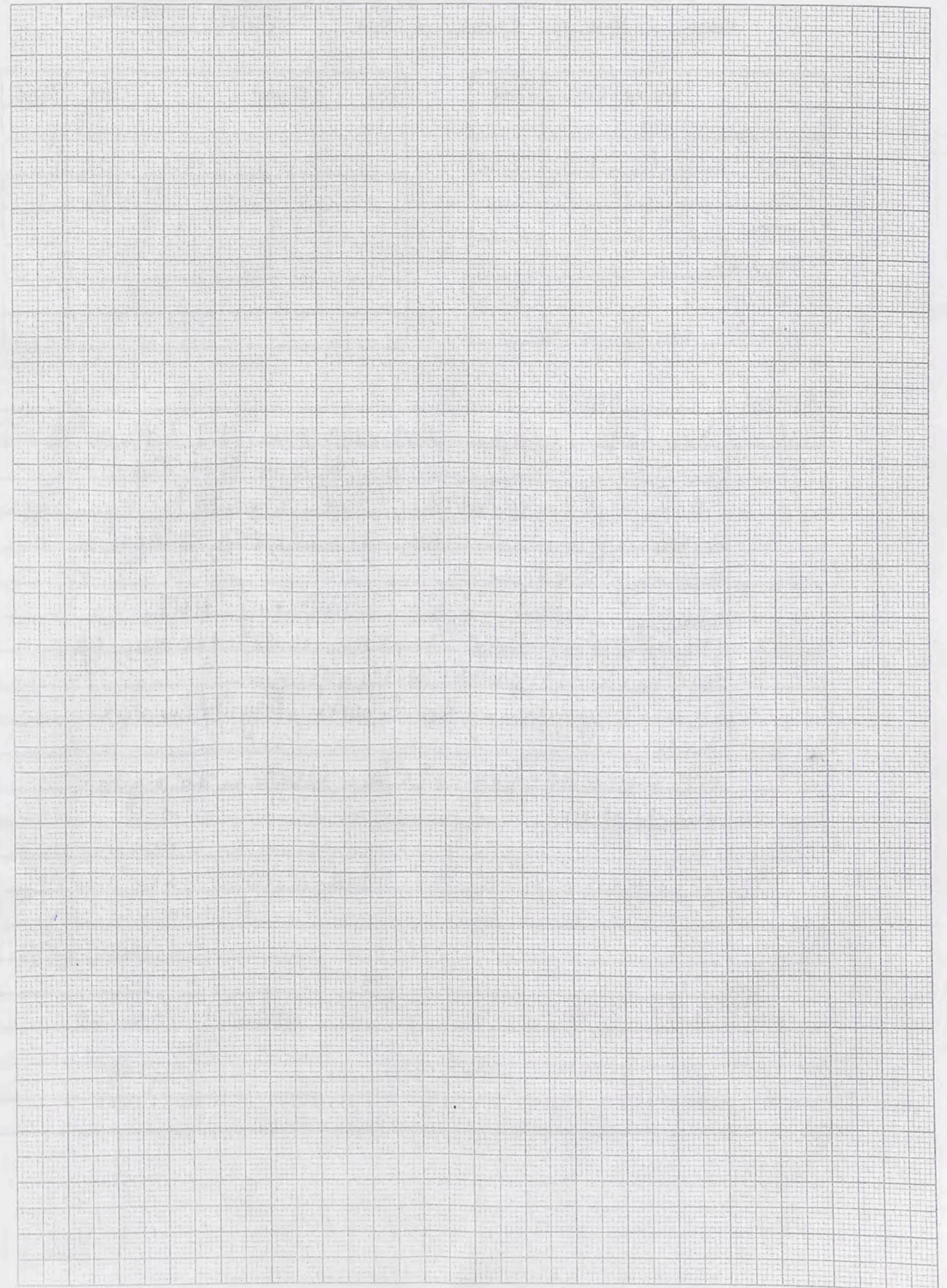

Trench 22 Initials BA Date 27/4/08 Page 1
 Locus 1 Spit 1 Locus 1 Spit 1 Feature/s

	No. of bags	Cont	Cont
Pottery	1	1.1	
Bone			
Charcoal			
Other (Tile)			
Photos bw			
Photos col.	1705-1706		

No.	Object	Cont	Cont

Context Report

1.1	Surface clear 400x400cm <input type="checkbox"/> Stk of T 15 as an extension without Nth Back. Soil light grey dusty, flat - Could be open area? Little vegetation. Few blades, Fed, shoppers amongst them. Levels: Back Sight 1.930 ref HNS. At start of 2nd session c 50-100mm of top soil cleared. No features. Soil beginning to turn light brown to Nth. At end of day rocks begin to appear in N+E.

TRENCH 22 END OF 27.4.08

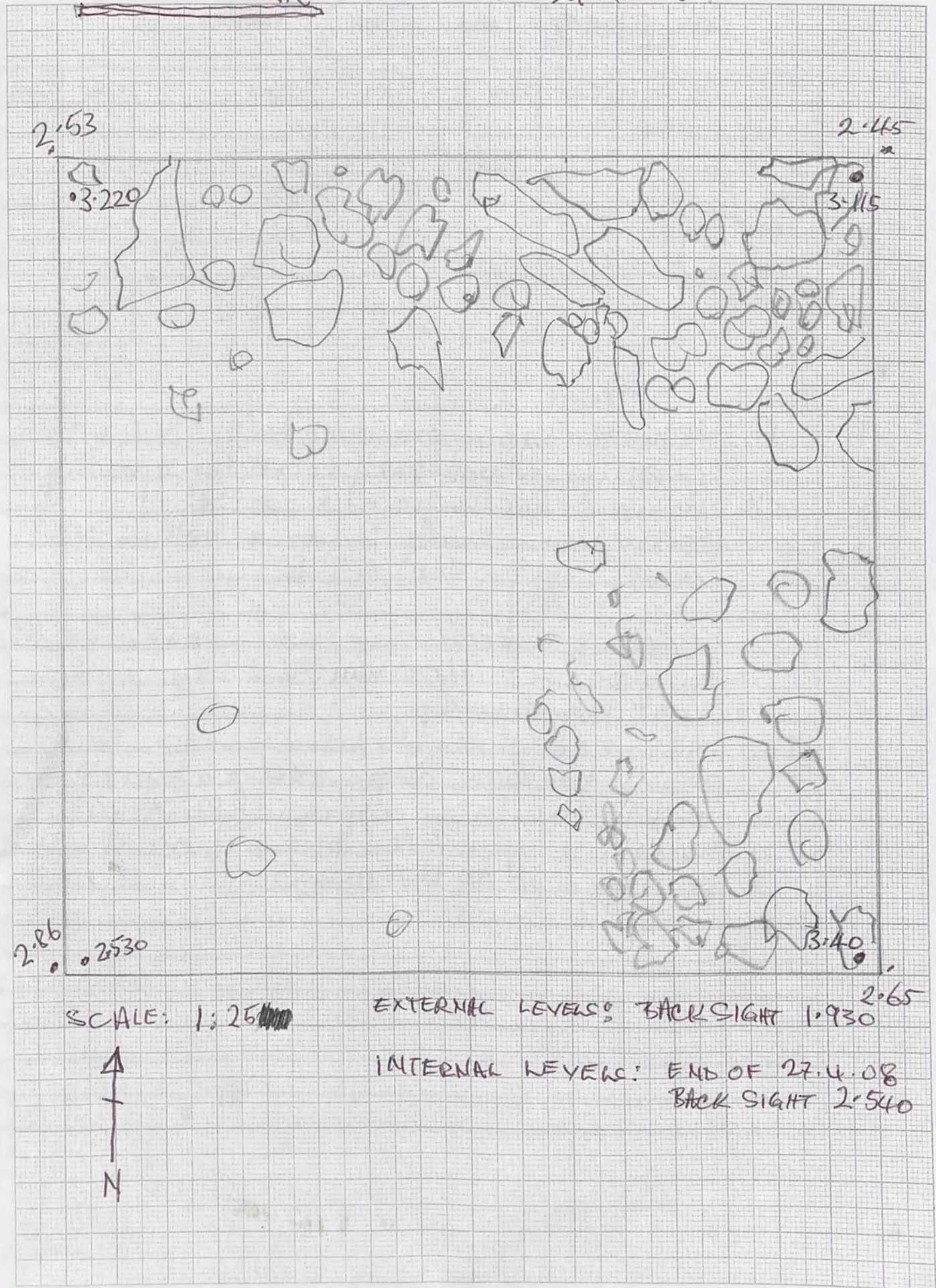

Trench..... 22 Initials... BA Date 28.4/08 Page 2
Locus..... 1 Spit..... 2 Locus..... Spit..... Feature/s.....

	No. of bags	Cont	Cont
Pottery	1	1.2	
Bone			
Charcoal			
Other (Tile)			
Photos bw			
Photos col.			

No.	Object	Cont	Cont

Context Report

Context	Report
1.1	Resumed clearing around rocks. clearing preparatory to photographing
1.2	Remove Rocks from N → Sth darker brown soil. Perhaps a well in NE corner. Few shalts.
	little change except increased depth. c. 600mm - 1600mm. Soil drying to light grey & dusty.
1.3	An area clear of rocks in the SW corner has been separated as spit 3 to test if this is a room. If so it will remain separate locus, if not it will be rejoined to the whole.

TRENCH 22 28.4.08 END OF 1.2

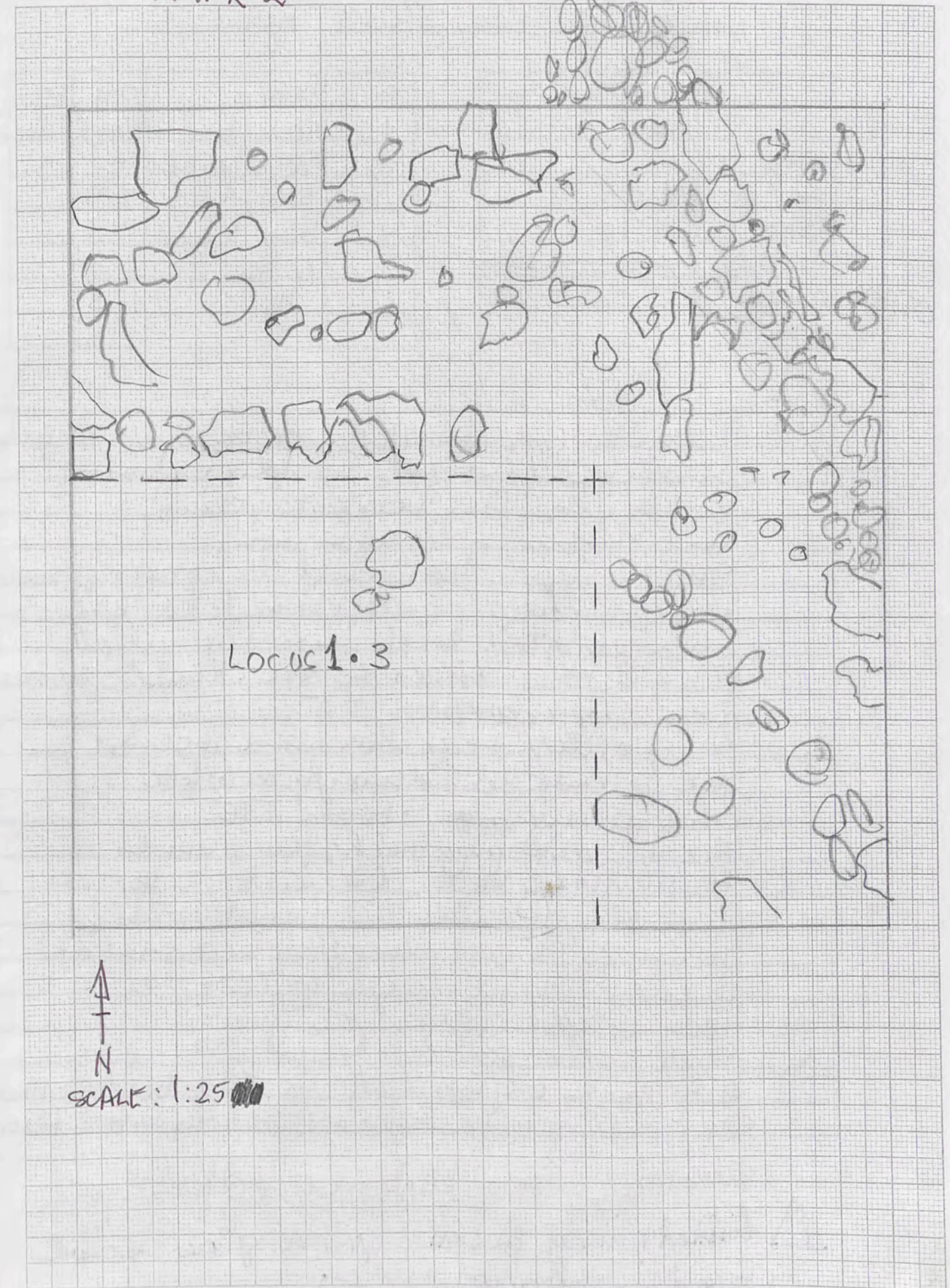

Trench 22 Initials BA Date 29.4.83 Page 3
 Locus 1 Spit 3 Locus 2 Spit 3 Feature/s.....

	No. of bags	Cont	Cont
Pottery			
Bone	1	2.3	
Charcoal	1	2.3	
Other (Tile)	2.3 GLASS		
Photos bw			
Photos col.			

No.	Object	Cont	Cont
1	Figurine frag	Road (surface)	
2	loom weight	"	"
3	Bell holes	2.3	
4	loom weight	2.3	
5	GLASS	2.3	
6	"	1.3	

OTHER

Context Report

1.3	Began to clear in 10cm layer. Soil light grey, barren of finds - color. Seemingly exposing nothing yet. Fine to coarse grains. Soil becoming light brown. GPIT 3 in its confined SW corner provided no evidence of separate room. It has been incorporated back into the whole. Clearing continues to NE. Tumble, perhaps from upper floor(s) of T15.
2.3	A separate Locus has been opened in NE corner to identify a wall continuing from S from T15. Densy light grey soil; few clods
ⓑ	Small stone ball with 2 holes on the other side ⓐ another hole found ≈ 106 cm above floor in T15 which should follow through to T22.2.2
Ⓐ	loom weight clay
ⓐ	Small frag GLASS
	Now down to floor level, a 68cm below surface @ N & c. 40cm below surface @ S. It is an uneven floor

Tomorrow, clean, photograph & draw:

Ⓐ lined rim of intense green glass bowl

ⓐ found in pottery shards

2.3 -  Fig frag x pottery.  Lamp frag x pottery

TRENCH 22

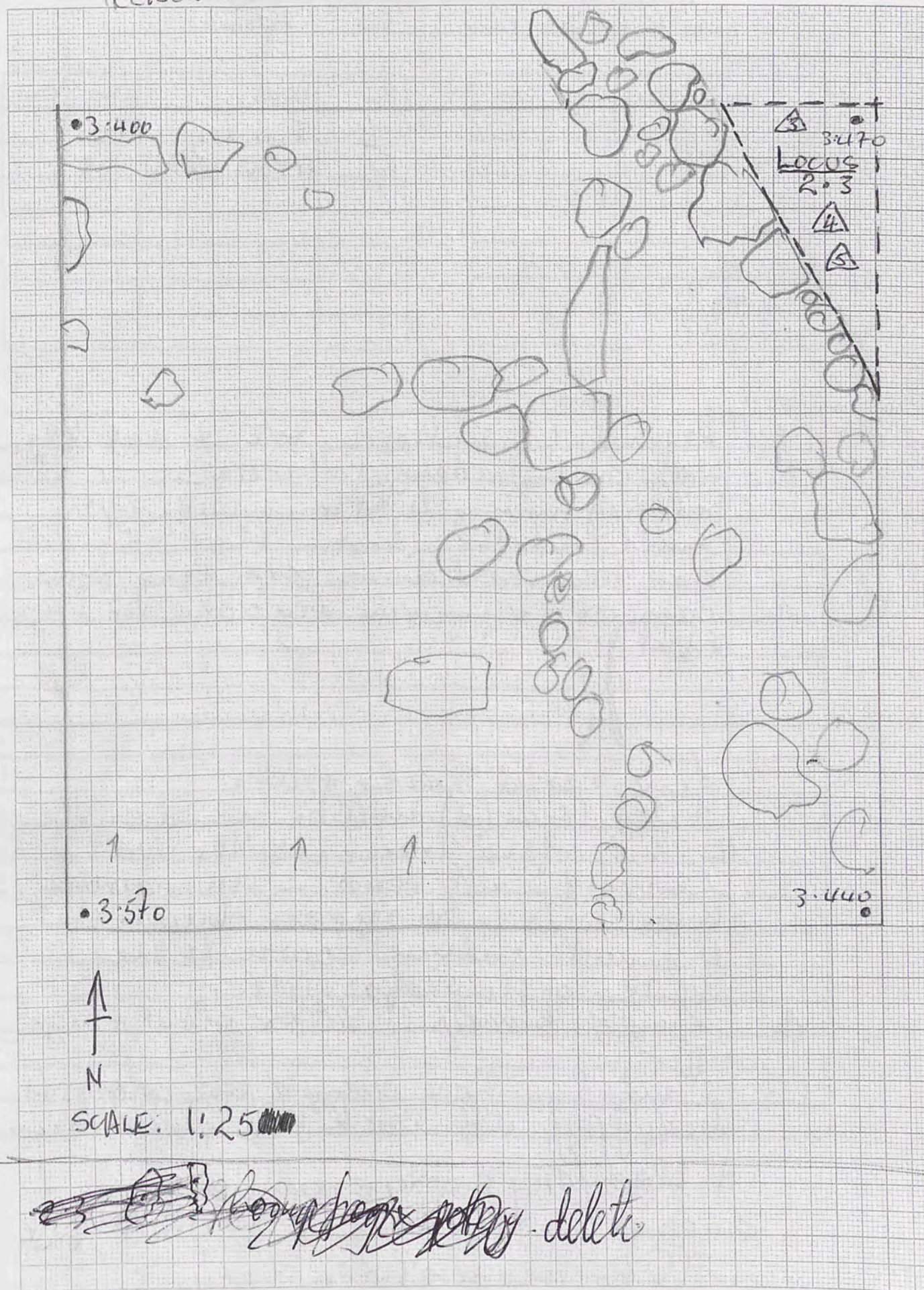

~~long frag pottery delete~~

Trench 22 Initials BA Date 30/4/08 Page 4
 Locus 1 Spit 3 Locus Spit Feature/s

	No. of bags	Cont	Cont
Pottery			
Bone	1	1.3	
Charcoal			
Other (Tile)			
Photos bw			
Photos col.			

No.	Object	Cont	Cont
7	1 Fig. Leg	1.3	
8	2 GLASS FRAG ^{TS}	1.3	

Context Report

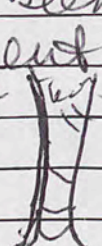
1.3	Resumed L1.3 clearing to E to meet the wall on boundary of Locus 2. Soil grey turning light brown with depth lined sherds indicating that this fill has been laid down for a long time.
△	Fragment of a figurine leg broken at knee & foot 
	Lime coated sherds & rocks. A New locus (3) will be opened on the E. side of the trench to the wall. Locus 1 will remain unexcavated below spit 3. It appears obvious that L. 1 will continue down to the level of the plane floor.
△	Lump of beautiful yellow glass & frogs
1.3	Wind & Sun have changed soil colour to dusky grey with rock fill inclusions

A black/grey sooty area has been exposed in N. adjacent to wall, but will be excavated in locus 3 tomorrow.

1mm Squares

TRENCH 22 30.4.08.

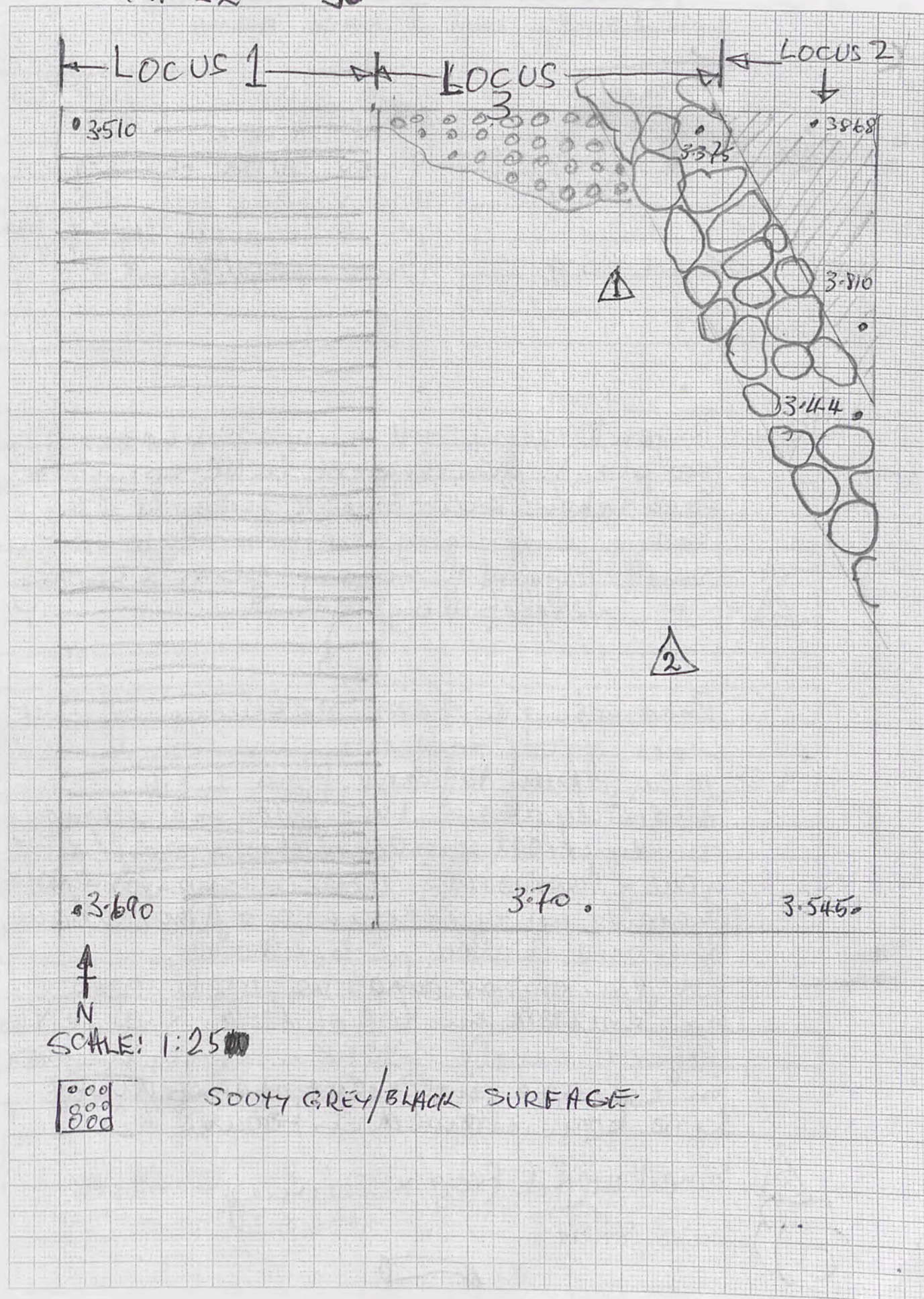

Trench 22 Initials BA Date 1.5.08 Page 5
 Locus 3 Spit 4 Locus 3 Spit 5 Feature/s.....

	No. of bags	Cont	Cont
Pottery			
Bone		3.4	
Charcoal			
Other etc	1	3.4	
Photos bw			
Photos col.			

No.	Object	Cont	Cont
9	1 Glass	3.4	
10	2 Metal obj	3.4	
11	3 Metal frag	3.5	
14	4 wheel made lamp	3.4	frag
15	5 pottery date pit	3.4	

ASH

Context Report
 3.4. Begon to clear spit 4, in new locus 3 (see plan). Ash deposit in Nth sampled & level taken (3.615 - 3.630) [back night 3.350]. Soil on surface grey dust; below light brown.
 A small fragment of silvery glass & sewing
 B " metal fitting
 Excavating to floor extension of T15 soil grey to brown
 3.5. 14 cm down to floor from L3.4. Immediately above the floor is a layer of unconsolidated small stones as if a new floor level was being prepared. There is no evidence of a floor above the one below 3.5, however. It does appear that the well was constructed on top of level 3.4, i.e. the layer of small stones. Perhaps the floors in L2 are indicative of what might have been planned in locus 3

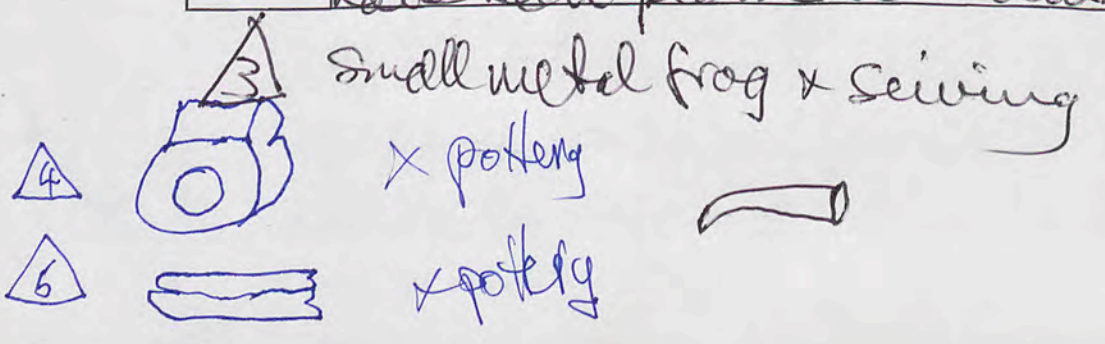

TRENCH 22 1.5.08

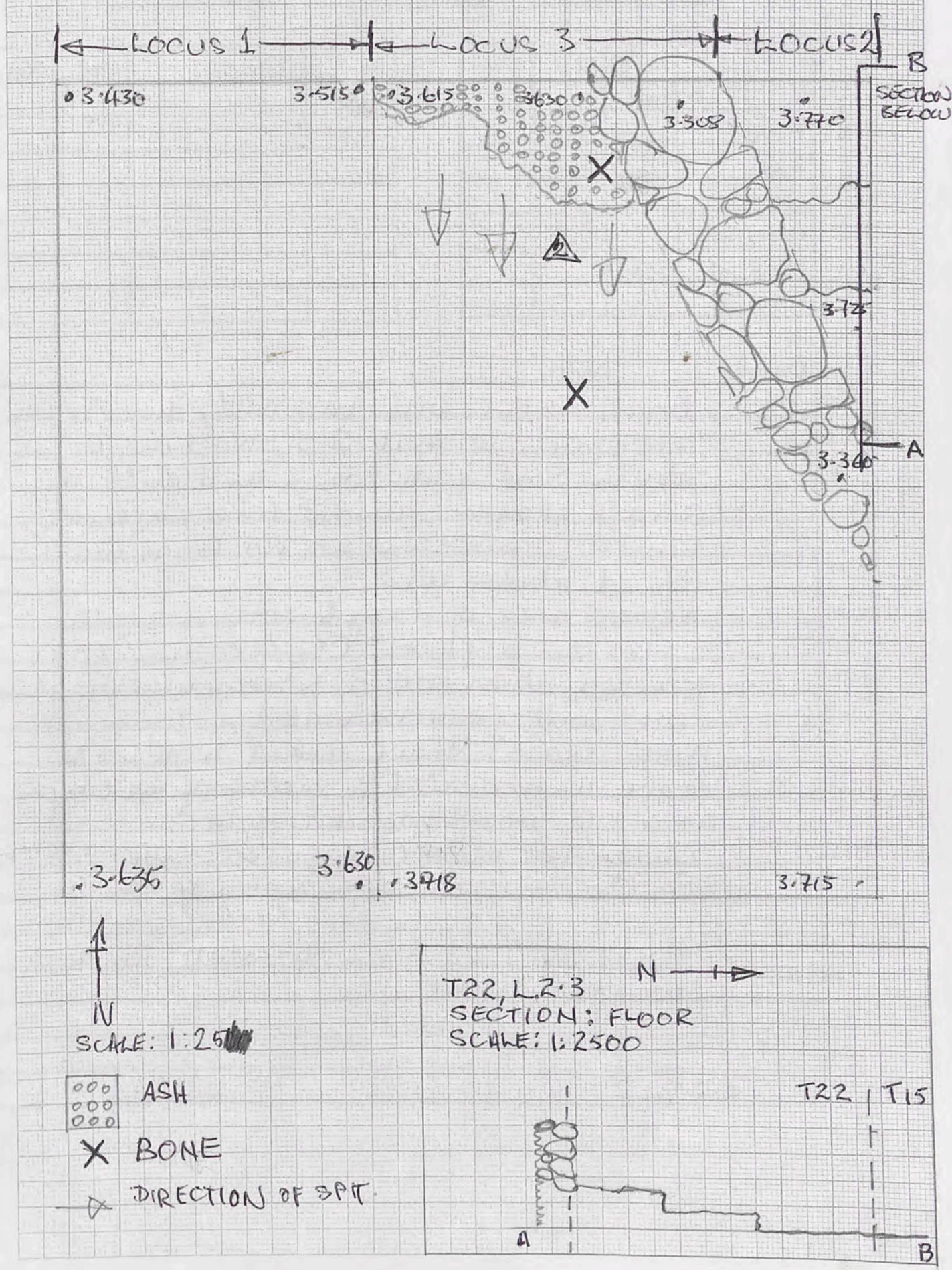

HJ for
 Trench.....22.....Initials.....BA.....Date.....3/5/08.....Page.....6
 Locus.....3.....Spit.....5..... Locus.....Spit..... Feature/s.....

	No. of bags	Cont	Cont
Pottery	1	3-5	
Bone			
Charcoal			
Other (Tile)			
Photos bw	1758-64		
Photos col.			

No.	Object	Cont	Cont
1763			

Context Report

Context	Report
3-5	Bruce absent with bad cold flu. Team are continuing spit 3-5, working to south. Soil quite tough and full of small stones, almost like packing which is puzzling as no floor was found above this.
7.00am	Noticed area of tough soil in south - was this a floor? (higher than level reached at base of 3-5 which is roughly level with floor excavated in trench to north (2006). Have asked workers to leave unexcavated a section of the tough area, to record possible floor.
	Cleaned for photography - see images 1758-64 Note: 1763-64 display photography of wall.
	Moved to T28 - aim to locate northern boundary wall.

T22
 [3.76 outside floor 2006]

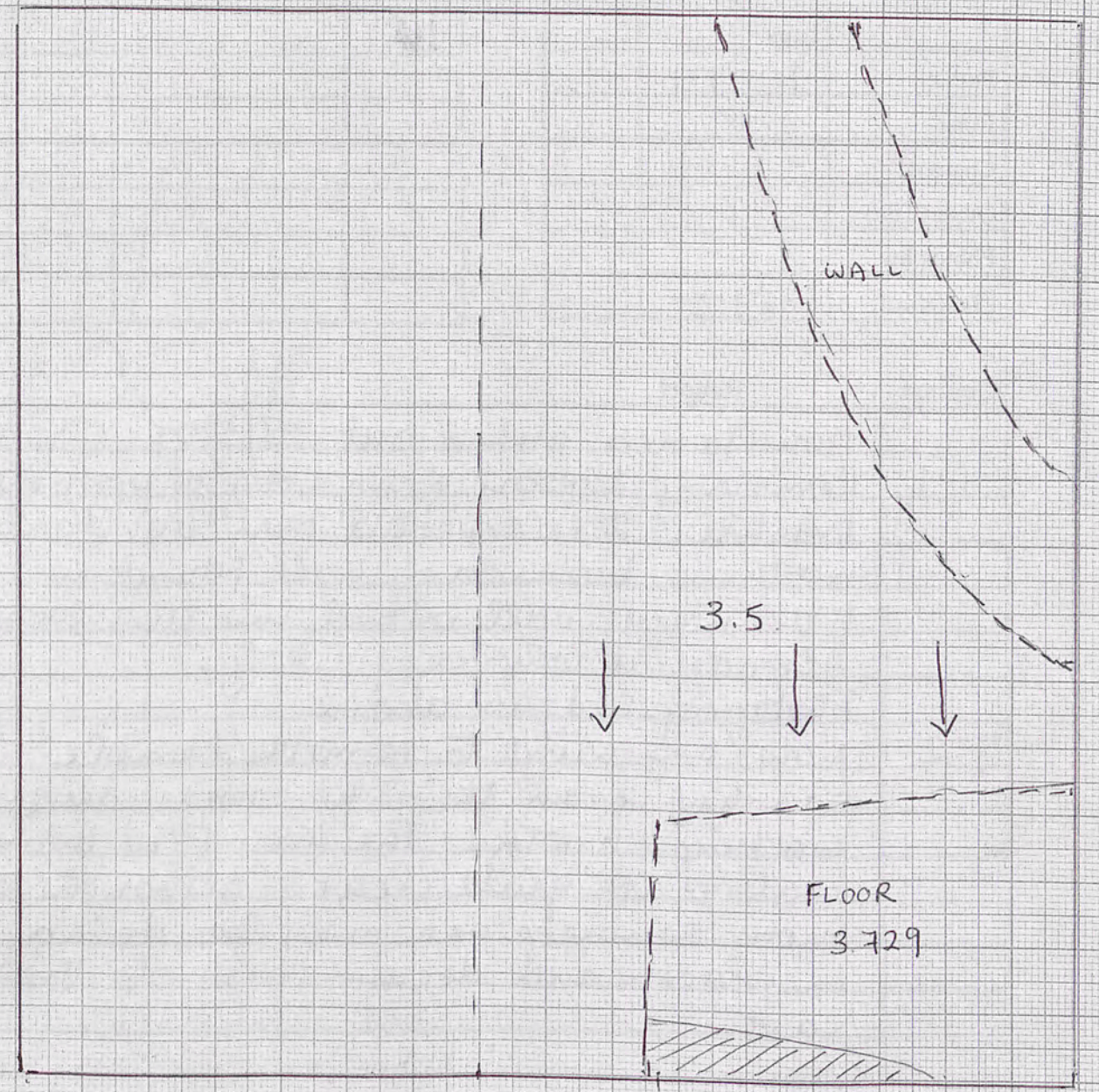

3/5/08

SE corner outside	3.230
Floor 3/5/06	3.729
Floor 2006	3.76

Trench.....28.....Initials.....HJ for HA.....Date.....4/5/01.....Page.....7
 Locus.....1.....Spit.....1..... Locus.....Spit..... Feature/s.....

	No. of bags	Cont	Cont
Pottery	1	1.1	
Bone			
Charcoal			
Other (Tile)			
Photos bw			
Photos col.	1787-8		

No.	Object	Cont	Cont
14			

Context Report

Context	Report
1.1	Boundaries picked out 3/5/01 Removing topsoil from area of prominent tumble. It is expected that the double northern boundary wall found in T25 to the west will extend into this trench. Already it looks very likely. Photographed as above.
1.2	Now beginning to remove tumble starting from the SW corner and working north. The two E/W boundary walls are quite clear, although the more southern one may be damaged in places and decay towards the east.

T 28
 4/5/01

0.875
 0.175

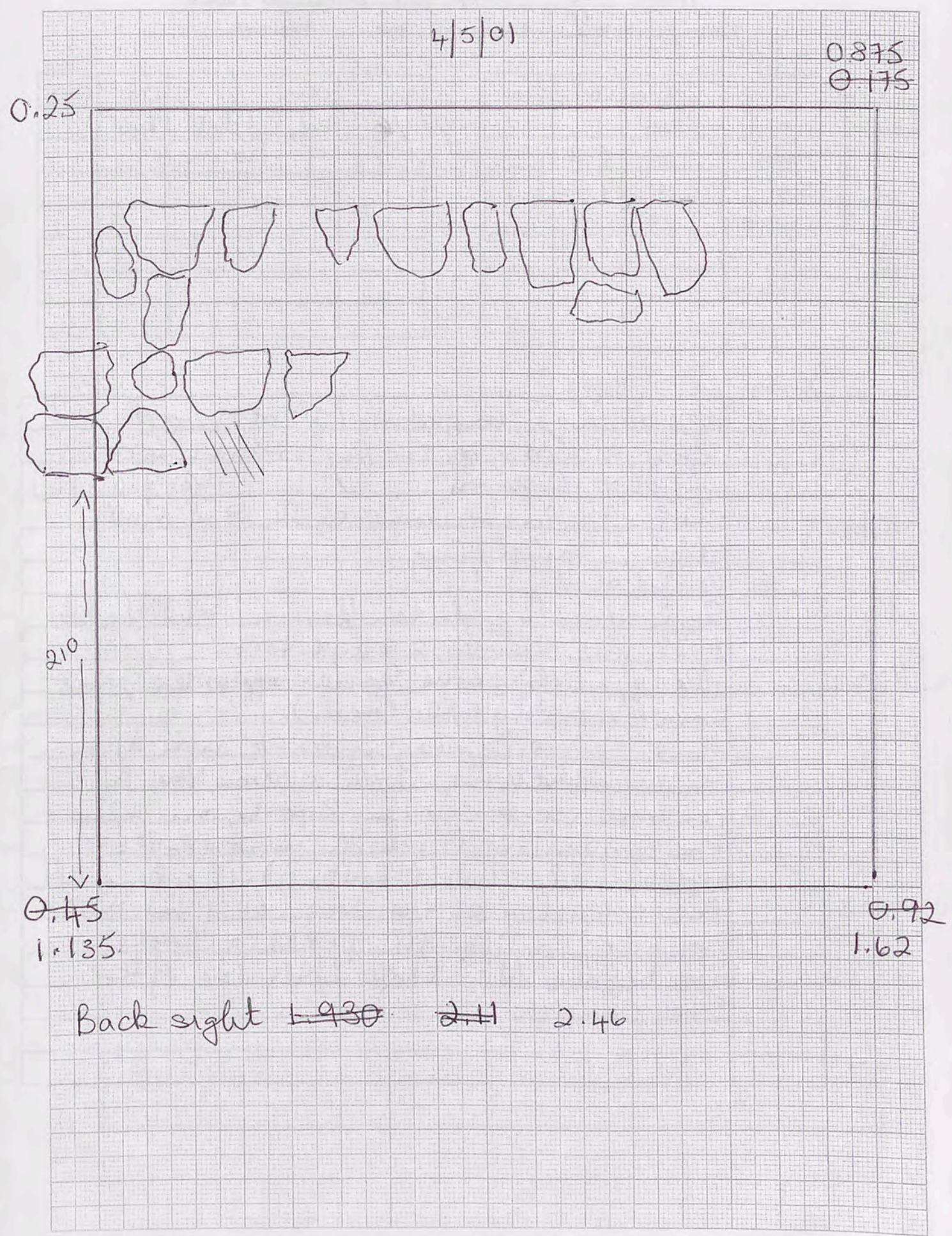

Trench 28 Initials BA Date 5/5/07 Page 8
 Locus f Spit 2 Locus Spit Feature/s

	No. of bags	Cont	Cont
Pottery	1	1.2	
Bone	1	1.2	
Charcoal			
Other (Tile)			
Photos bw			
Photos col.			

No.	Object	Cont	Cont
<u>16</u>	<u>Patrifid shell (no lease)</u>	<u>1.2</u>	

Context	Report
1.2	Clearing in front (S) of wall. Few sherds, grinding stone. Soil light brown. (for pounder)
10.00am	still clearing + rubble & fill S of wall, which is emerging.
	▲ Patrifid shell
	Soil during light tan/brown. Still rubble & fill, few sherds, 2 amph toes
11.30am	Along with some bones appeared a goat horn (according to the locals).
	But S well may indicate earth tremor. It seems that the well crosses the N central sector in 2 parts; on inner & on outer wall which parallels the walls in the trench to the W. Checking all the trenches on the N side of the STDA complex, confirms this pattern all the way to the N-S road to the W. of the STDA Complex.

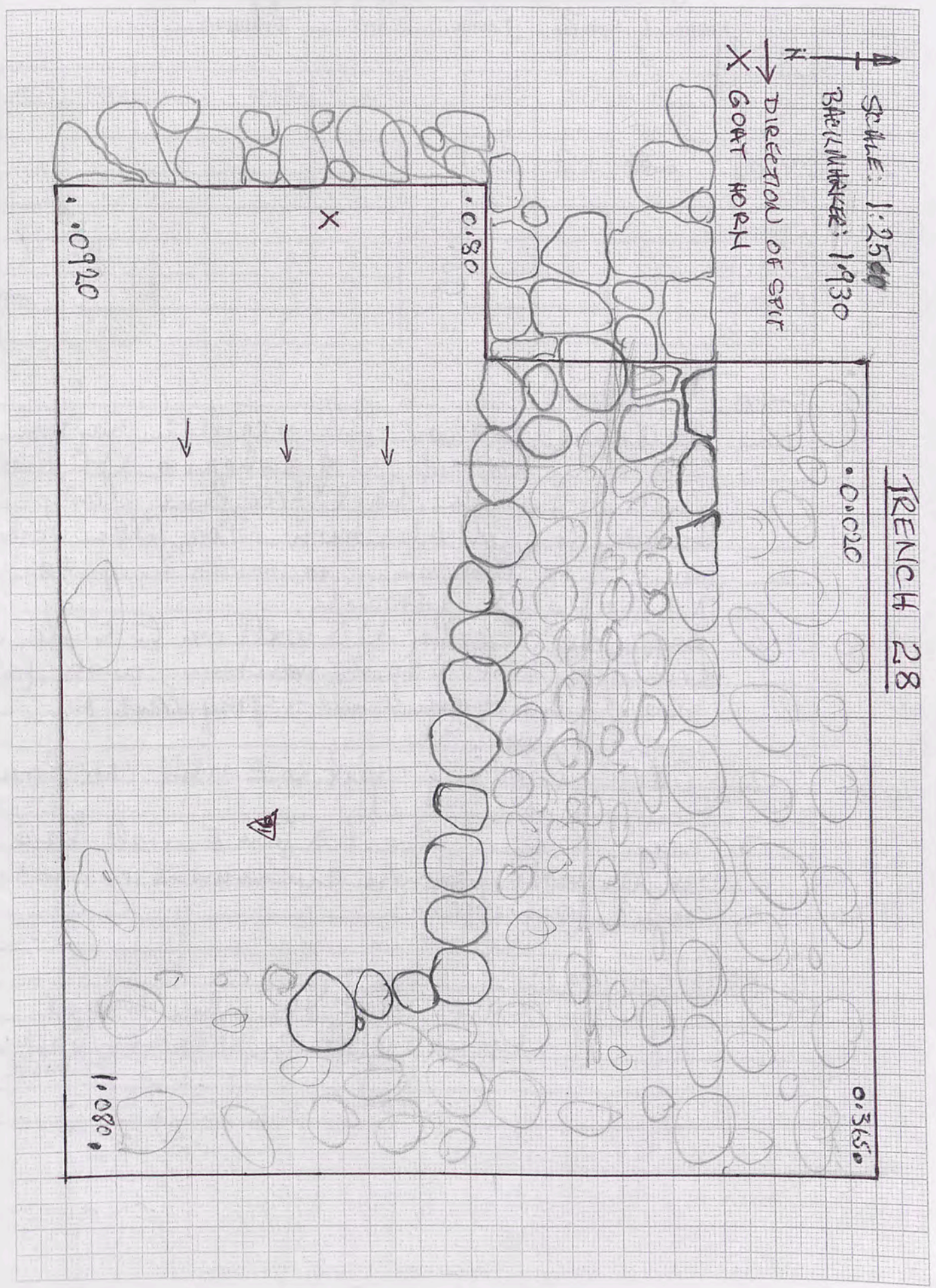

Trench 28 Initials BA Date 6/5/88 Page 9
 Locus 1 Spit 2 Locus Spit Feature/s

	No. of bags	Cont 1	Cont 2
Pottery	2	1.2	1.3
Bone			
Charcoal			
Other (Tile)			
Photos bw			
Photos col.			

No.	Object	Cont	Cont

Context Report

	1.2	Continued to clear fill & spill in section S of E-W wall & W of perhaps a N-S wall in E of trench. Soil grey fine dusty turning to light brown. Many fallen rocks few sherds. Progressing towards suspected N-S wall in E of trench.
8-30	1.2	Began to clarify N-S wall on E side of trench. Till & spill continue with few sherds. Soil continues grey dust to light brown.
10-30	1.2	Still clearing spit to E wall - no change from above.
	1.3	Began clearing spit 3 from E wall back to W wall. Same environment as above.
11-30	1.3	Same as before.

CLARIFICATION:

LOCUS 1.1 = the whole trench
 LOCUS 1.2/3 = the S section S of EW wall

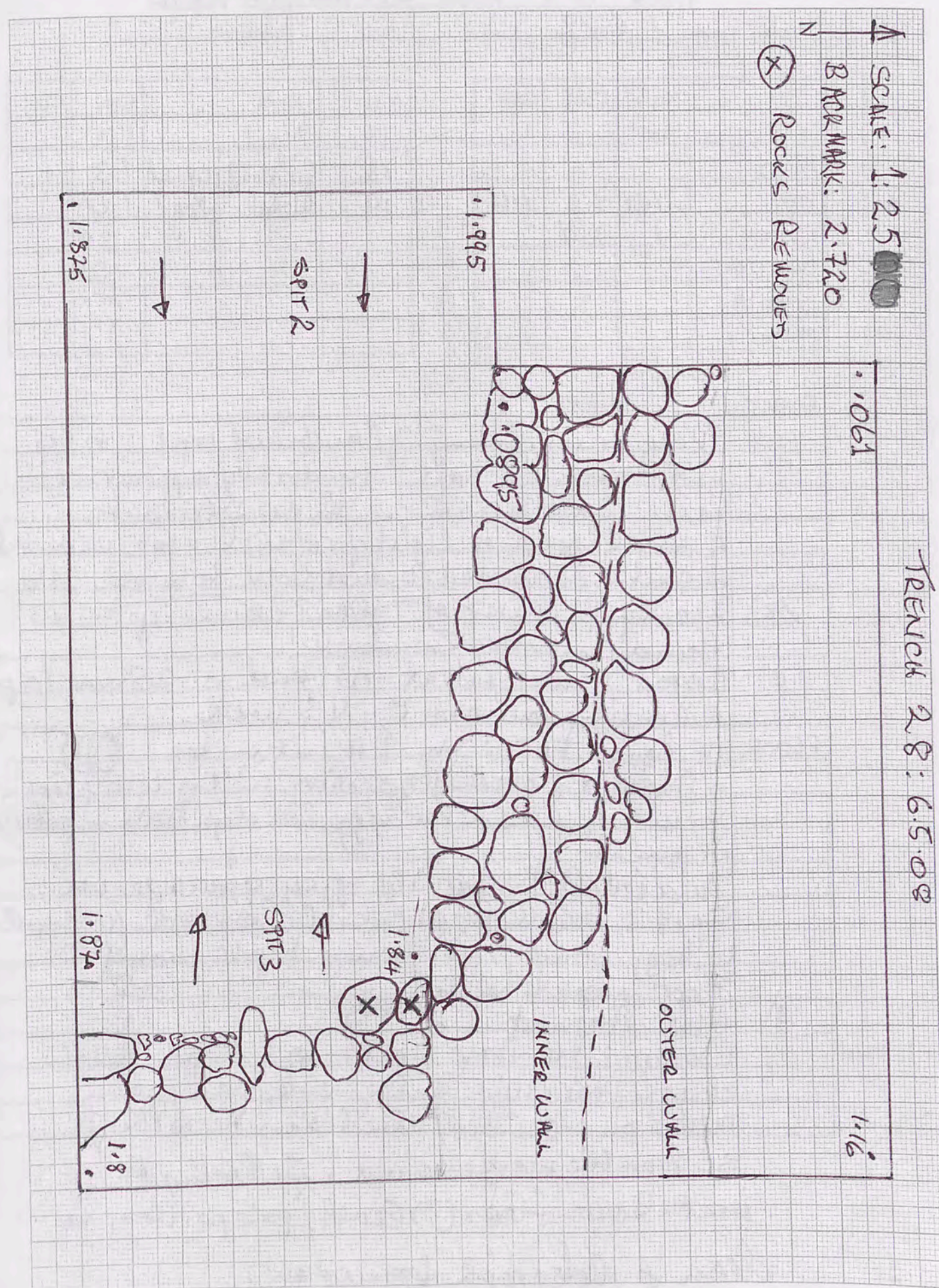

Trench 28 Initials BA Date 8.5.08 Page 11
 Locus 1 Spits 1 Locus 2 Spits 5 Feature/s Floor? @ W.

	No. of bags	Cont	Cont	# of bags	No.	Object	Cont	Cont
Pottery	2	1.4	2.5	1	20	Stone Coom weight	2.5	
Bone	1	1.4	2.5	1	21	Stone? plumb	2.5	
Charcoal	1	1.4	2.5	1				
Other (Tile)								
Photos bw								
Photos col.								

Context Report

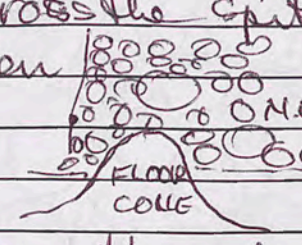
1.4 Continued to clear 1.4 to just above floor at E end of locus. The floor discovered yesterday in the NW corner of the locus 1.4 is now being used to fix as the focus for tracing the floor across the spit. It is, as mentioned quite uneven  and at this point is shaped like a radiating cone. As it becomes exposed, it steps in some places. More detail will be drawn on completion. Bone continues to be exposed in this area. The floor is very uneven - undulating - so as to dig under, fall steeply to S. Some small rock debris in NE. Still difficult to determine floor level. Having completed a pass to E wall, I helped the loces to create L 2.5. W of E wall (including wall) & up to the floor in W. This locus has a high cone floor (see above) which dips to the South wall but stops & disappears at the W. end of locus 2.5.

CREATE

Stone Coom weight??



white

black

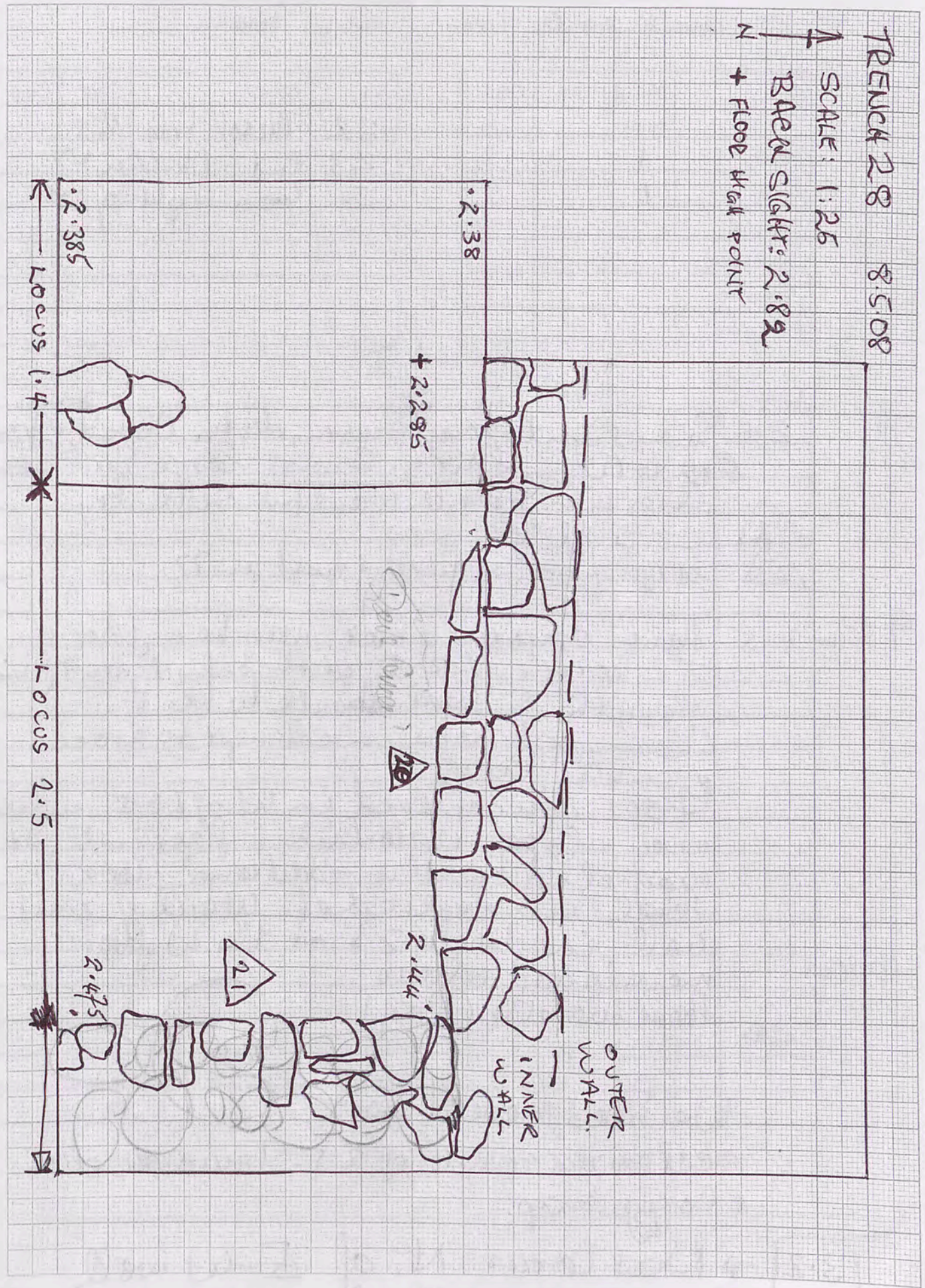

Trench 28 Initials BA Date 10.5.08 Page 12
 Locus 2 Spit 5 Locus.....Spit..... Feature/s.....

	No. of bags	Cont	Cont
Pottery	1		
Bone	1		
Charcoal			
Other (Tile)			
Photos bw			
Photos col.			

No.	Object	Cont	Cont
22	Metal frog	2.5	
23	Flint or Obsidian	2.5	
24	Loom weight clay	2.5	

Context Report

2.5	Sail light gray/brown, dense. Clearing from E to W in spit 5. Several large spill stones otherwise sterile. Beautiful still day
22	Metal frog
23	large flint or piece of obsidian??
9.50am 2.5	Have exposed what may be a floor in SE corner of 2.5 with ash deposit (thin) along the S. wall back to the E. Clearing to E now in attempt to trace possible floor. Floor uncovered in W of 2.5 which may slope up to link i floor in E. It may also be on additional floor. Jewel uncovered at W end of E-W well in locus 2.5 at the W floor mentioned above
10.30am	loom weight (clay)

We now have floor across the whole of 2.5. Tomorrow, clean & diggy snap.

[3.2] → New Locus N. of E-W well clearing surface rock fall @ 3.2.

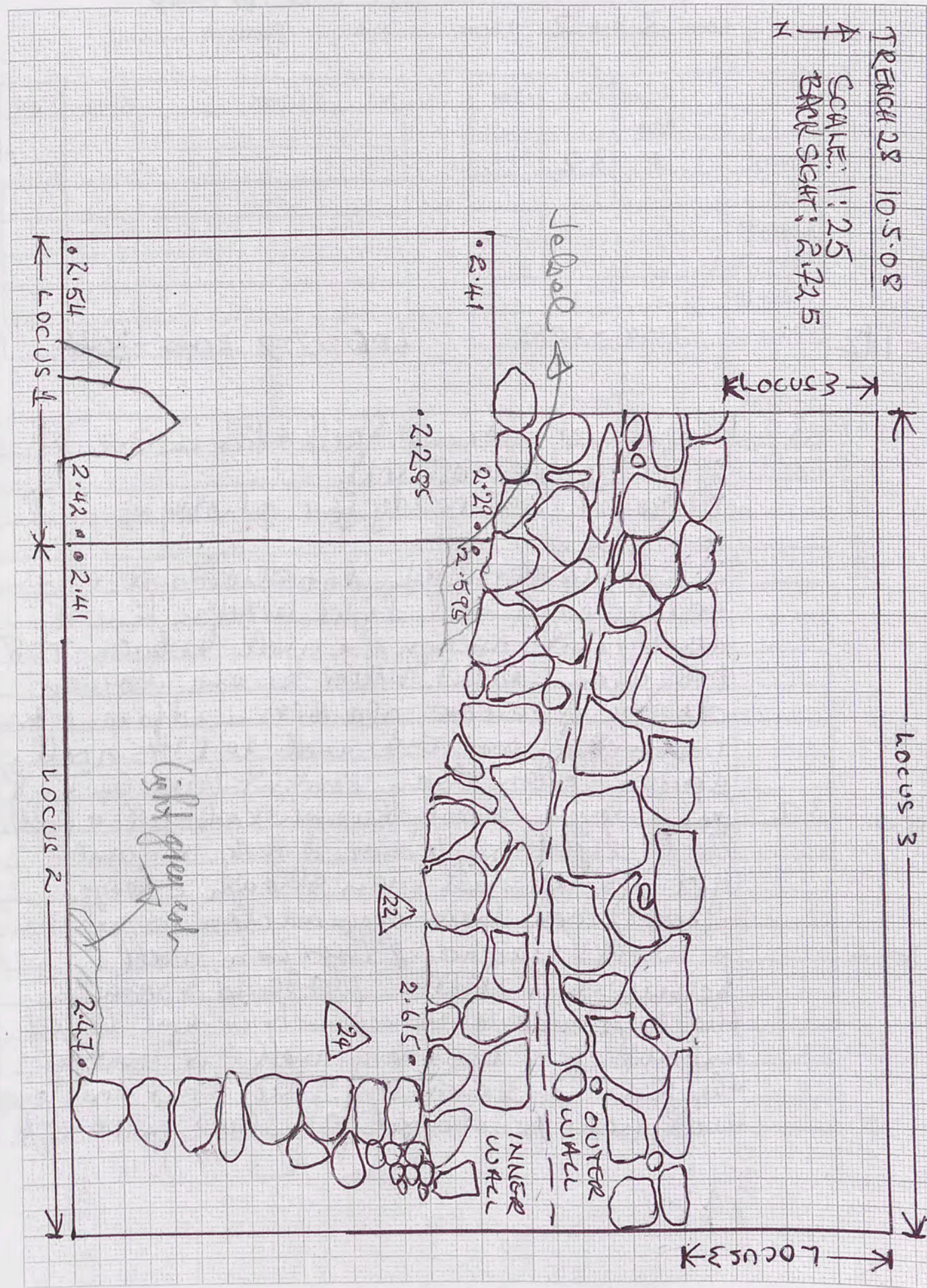

Trench... 28 ... Initials... BA ... Date... 12.5.80 ... Page... 15
Locus... 4 Spit... 6 ... Locus... Spit... Feature/s.....

	No. of bags	Cont	Cont
Pottery	1	4.6	
Bone	1	4.6	
Charcoal	1	4.6	
Other (Tile)			
Photos bw			
Photos col.	2079 - 2085		

No.	Object	Cont	Cont
25	hook (broken)	4.6	
26	comp frog nozzle	4.6	

Context	Report
4.6	Began digging through floor. Soil light grey/brown, solid, hard
25	broken metal hook Have reached level almost immediately. In mid section small stones formed floor bases they down S. section While the E-W wall is built on bedrock the N-S wall to the E appear to be built on the floor level & is not keyed into the E-W wall to the N.
26	comp nozzle very beaut! 3rd century cleaning up ready for photography levels of level still to be take.

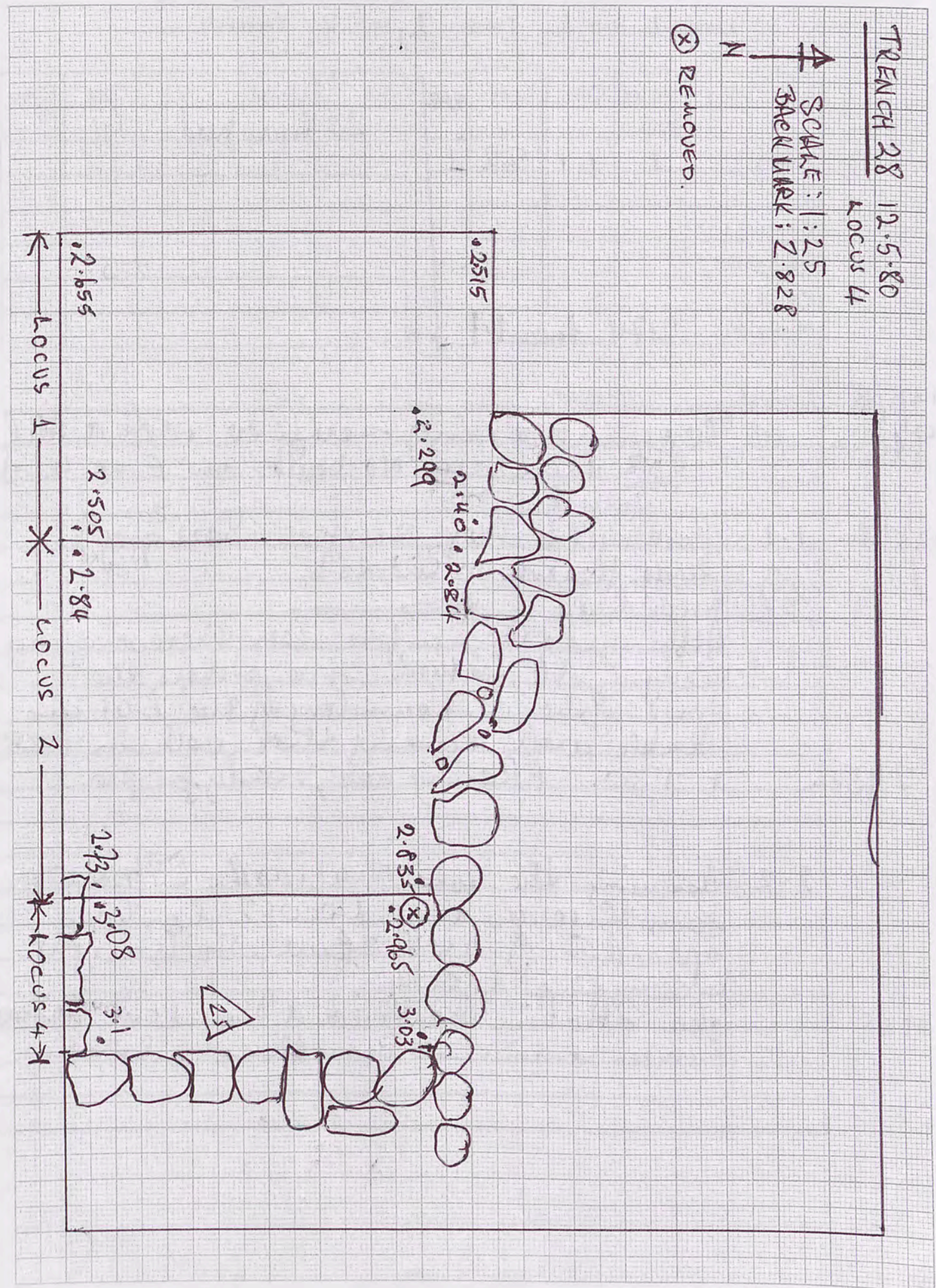

Trench 34 Initials BA Date 13/5/08 Page 16
 Locus 1 Spit 1 Locus 2 Spit 2 Feature/s.....

	No. of bags	Cont	Cont	BAG	No.	Object	Cont	Cont
Pottery	1	1.1	2.2	1	27	Arrow head	1.1	
Bone								
Charcoal								
Other (Tile)								
Photos bw								
Photos col.	2174	locus 1.1						

12/5/08
9.40 am

Context Report
 1.01 Began clearing surface rock & soil.
 NB there are no baulks on E or W of trench.

13/5/08

1.1 continued to clear surface. Soil grey, fine, lumpy. Almost no sherds!
 27 Arrow head 

7.45 am

At the end of the surface clear there are no recognizable features, save perhaps the trace of the N. boundary of the E-W wall double wall linking that wall in T28 & T30. clearing now, ready for pic.

9.05

2.2 Assessing the ~~two~~ E-W walls in T28 & T30 join through T34. LOCUS 2 has been opened up by wall line. Soil light brown fine & rocky.
 Abu Ibrahim has died & I've lost Ahmad. Further continuing young Ahmad substituting.

TRENCH 34

13.5.08
 BACKSIGHT: 2.80
 SCALE: 1:25
 N ↑

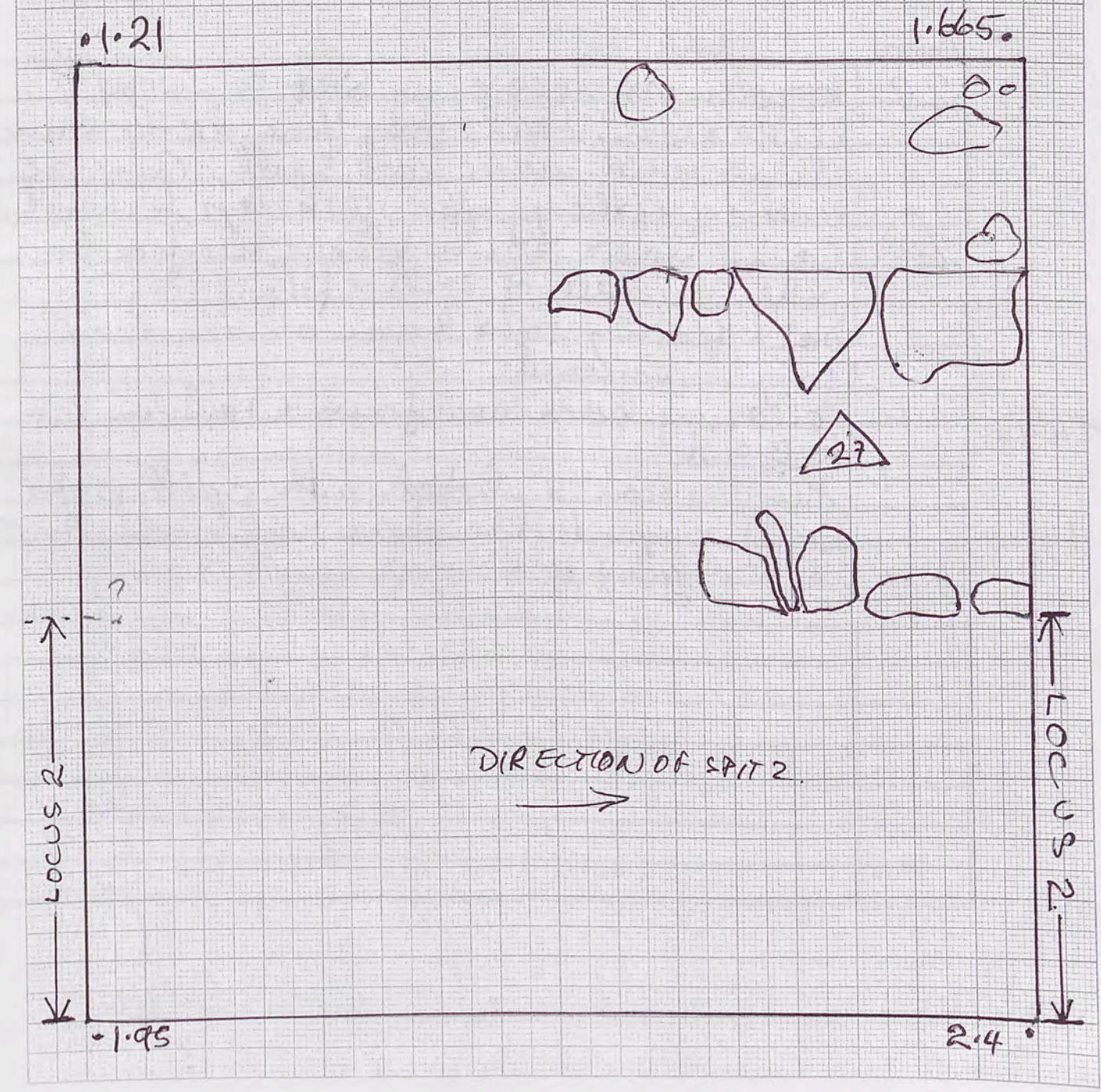

Trench 34 Initials BA Date 14/8/88 Page 17
 Locus 2 Spit 2 Locus.....Spit..... Feature/s.....

	No. of bags	Cont	Cont
Pottery			
Bone			
Charcoal			
Other (Tile)			
Photos bw			
Photos col.			

No.	Object	Cont	Cont
28	COIN	2.2	

Context	Report
2.2	Continued clearing Spit 2 in W. direction. Soil grey fine dusty, some sherd and much rock spill. General levels of lethargy after yesterday's funeral.
28	Coin about 20cm below surface in the middle of spill & fill. Soil turning light brown as sand and grey is removed.
2.2	Clearing back now from wall in 2.2 to E end. This section is choked with spill rocks.
	No change to the above soil or sherds. Still digging to E end.

4.45am
11.45am

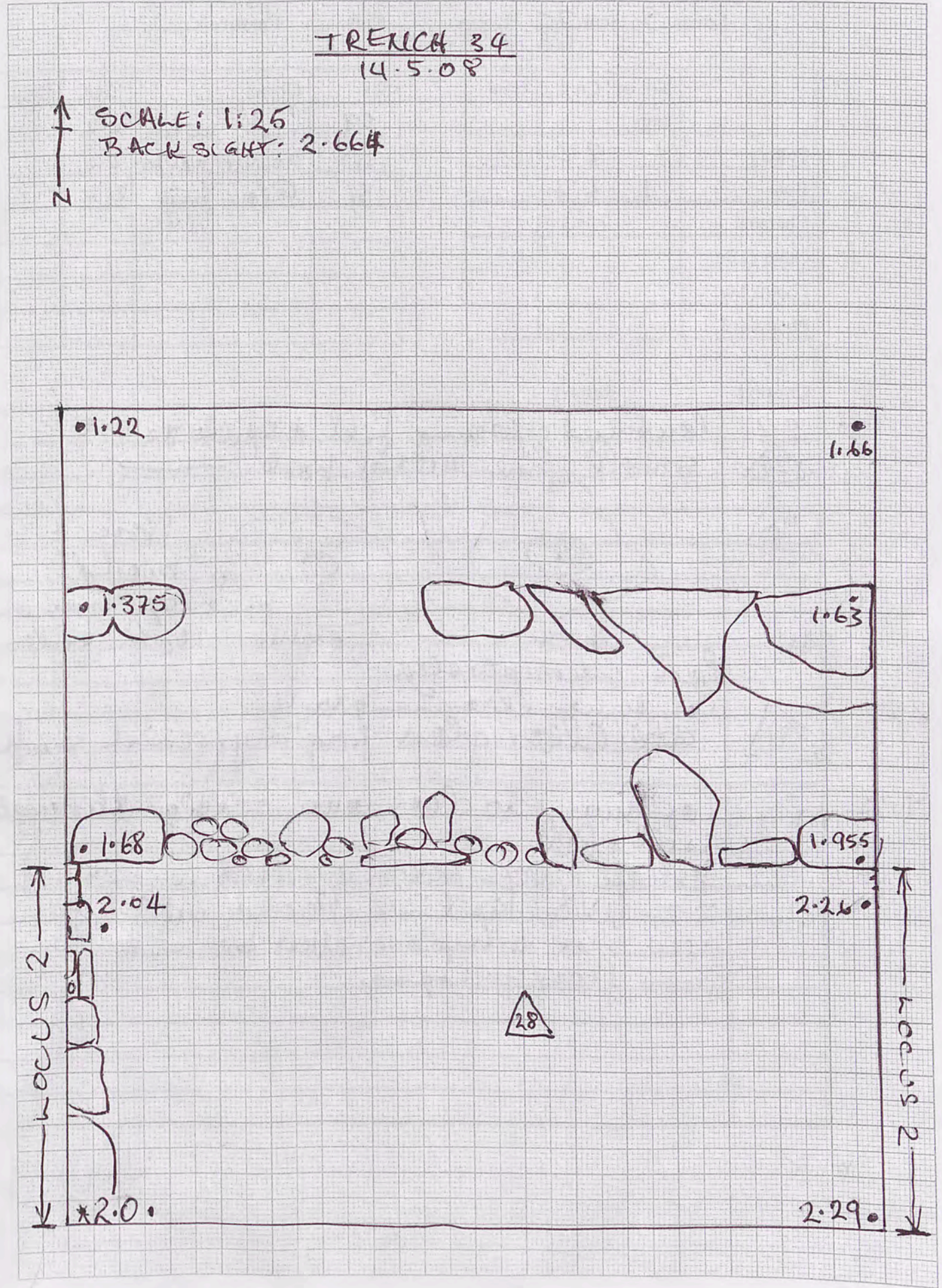

Trench 34 Initials BA Date 15/5/08 Page 18
 Locus 2 Spit 2 Locus.....Spit..... Feature/s.....

	No. of bags	Cont	Cont
Pottery	1	2.2	
Bone	1	2.2	
Charcoal			
Other (Tile)			
Photos bw			
Photos col.			

No.	Object	Cont	Cont
29	hook metal	2.2	
30	double washer	2.2	
31	Glass frog	2.2	

Context Report

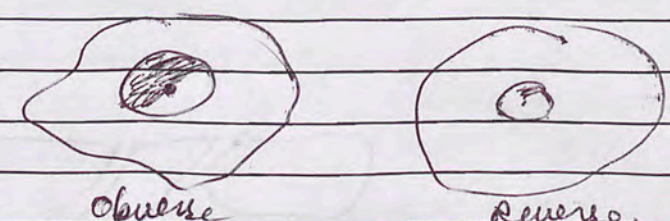
Context	Report
2.2	Continued clearing fill & spill to → E.
29	small fine metal hook →
30	 Stone is avoided depression on both sides
	Rain interrupts play.
8:30	Continue clearing to W.
31	Clear glass frog is greenish surface
9:30	Continuing to clear down slowly through spill & fill.
	Small grey patch appeared in centre of 2.2. When spit 2.2 cleared, will begin new spit to explore. Must be c. 20-30c from floor perhaps.

TRENCH 34
15.5.08

SCALE: 1:25
BACKSIGHT: 1.45

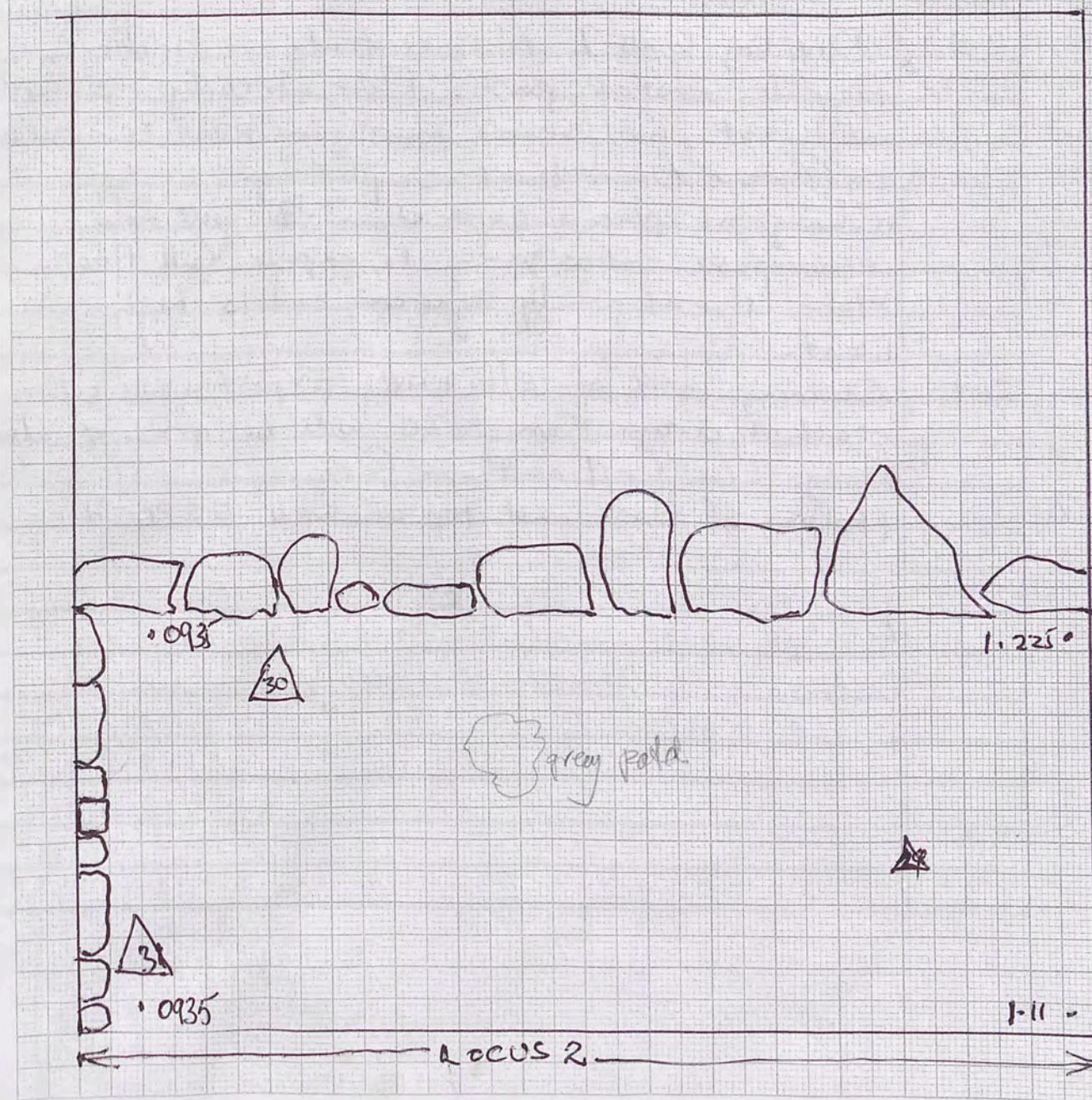

Trench 34 Initials LC Date 17/5/68 Page 19
 Locus.....Spit..... Locus.....Spit..... Feature/s.....

	No. of bags	Cont	Cont
Pottery		2.3	
Bone		2.3	
Charcoal			
Other (Tile)			
Photos bw			
Photos col.	3.1	2286-7	

No.	Object	Cont	Cont

Context Report

Context	Report
2.3	Dividing locus 2 to concentrate on finding floor in eastern part. Floor already reached at west, but seems lower in east, or perhaps different floor level completely. *Change of plan - context 2.3 will now encompass entire area to expose full floor. Floor is extremely uneven, and is higher in west.
3.1	Cleaning north of E/W wall. Expect when bottom reached drain from t.30 will be present also along E/W wall northern face. photos of floor and top of wall 2286-7

Trench 34 Backsight: 0.763 ①
 1.792 ②

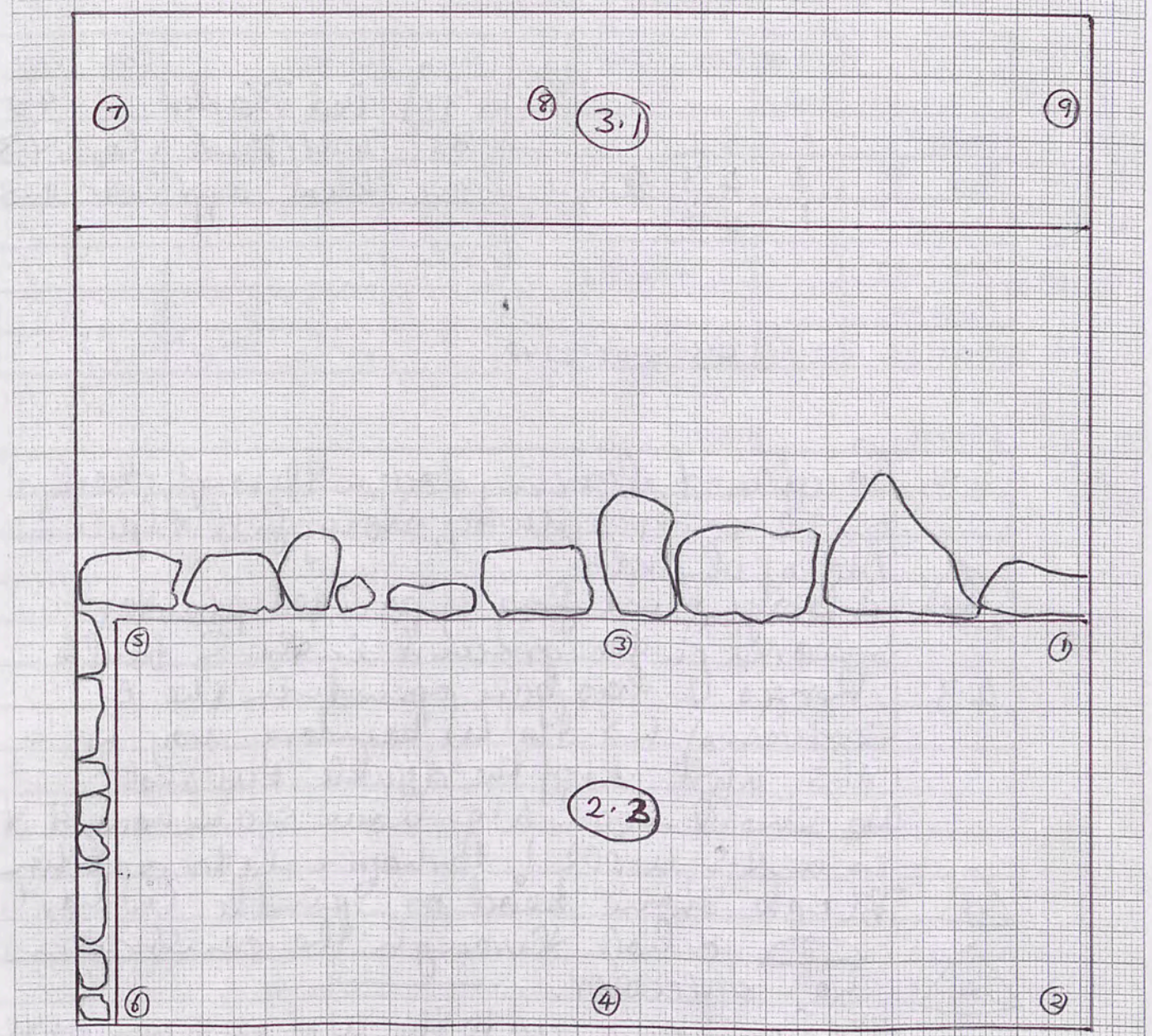

Levels

backsight ①	① 0.977	
	② 0.847	
	③ 0.660	end
	④ 0.976	2.3
backsight ②	⑤ 1.561	Floor.
	⑥ 1.658	
	⑦ 0.488	before
	⑧ 0.631	cleaning
	⑨ 0.802	3.1

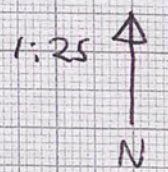

Trench 34 Initials BA Date 18.5.08 Page 20
 Locus 3 Spit 2 Locus Spit Feature/s

	No. of bags	Cont	Cont	BAGS	No.	Object	Cont	Cont
Pottery	1	3.2			32	Red plaster		4.3
Bone	1	4.3			33	Black stone head or spindle whorl	4.3	
Charcoal	1	4.3			34	Khaf applicator	4.3	
Other (Tile)								
Photos bw								
Photos col.		4.3	2342-2348					

Context Report

3.2	Continued clearing down through damp soil to grey dusty, stony fill @ spill. Many chords
32	A bright red frag of painted plaster appeared on the ground in the S flank.
4.3	Locus 4 has been opened in the E section of L3. Its W boundary may be a N-S well N of the double E-W well. We shall see! We have seen now & it is a N-S well! Perhaps a later addition.
33	Black stone head or spindle whorl
34	Khaf applicator. #34 has come up to the W of an oven at the extreme boundary of 4.3 (E end). Oven to be cleared, (samples taken) & photographed.

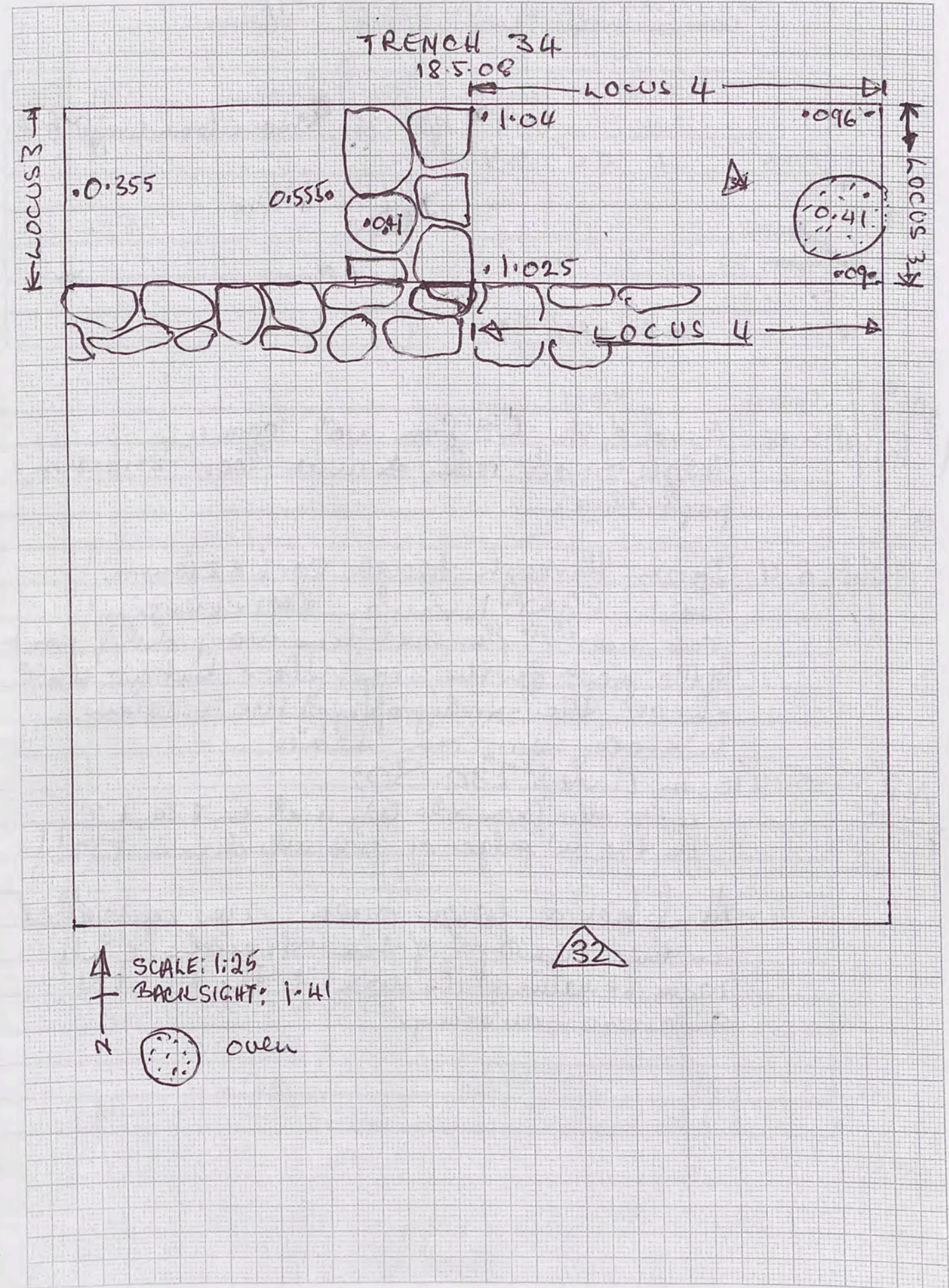

Trench 34 Initials BA Date 19/5/08 Page 21
 Locus 5 Spit 4 Locus.....Spit..... Feature/s.....

	No. of bags	Cont	Cont	No.	Object	Cont	Cont
Pottery	1	5.4	5.4	35	Stone loom weight	6.4	
Bone							
Charcoal							
Other (Tile)							
Photos bw							
Photos col.		BA 255-257	504				

11.30cm
18/5/08

Context	Report
5.04	End of str L2 from wall 100cm W. Tough, small rocks, (under-floor structure) preparation.
5.4	Down through tough soil & stones. Soil light brown. Floor emerging! 20cm under 1st floor level this was probably part of the prop for the upper floor but we shall check the stratigraphy of the section. We are near on Telhel...
5.4	is in Linda's T30 SO: 4.70 Mbs from the W. wall in T34, L2 in the W edge of 5.4 which is in T30!!
	At Telhel a large oven was unearthed in the centre of the trench. Only 10cm remains at its base & the NE & N sides are missing.

NB:

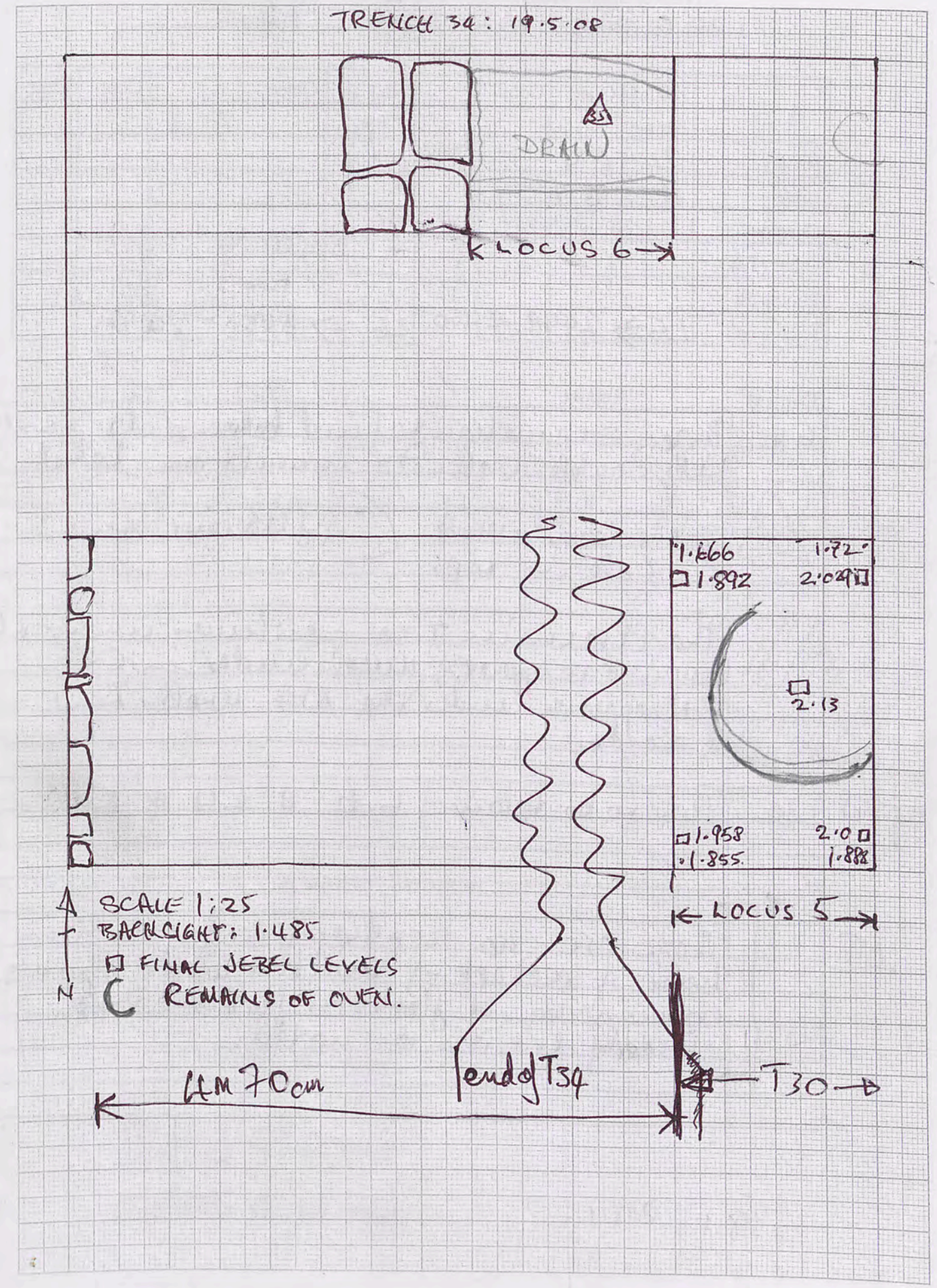

Trench 34 Initials BT Date 4/5/08 Page 22
 Locus 4 Spit 4 Locus 4 Spit 4 Feature/s

	No. of bags	Cont	Cont
Pottery	2	6.4	
Bone	1	6.4	
Charcoal			
Other (Tile)			
Photos bw			
Photos col.	L5 →	2449-2450	

No.	Object	Cont	Cont
L6 →	2451-2455		

Context	Report
6.4	Began excavation to find bottom of N-S wall N of double wall. It is built on level.
35	Stone from weight flat river stone & hole in top.
	The drain in T30 continues under the oven & reappears, much under in 6.4 & disappears under the N-S wall. Bone & sherds.
20/5/08 T34	Pics to be taken of L6 & L4 & L5
AB	There are no sections, so far in this book. A sketch of boulders & walls shows no evidence of floors or features not already drawn or noted.

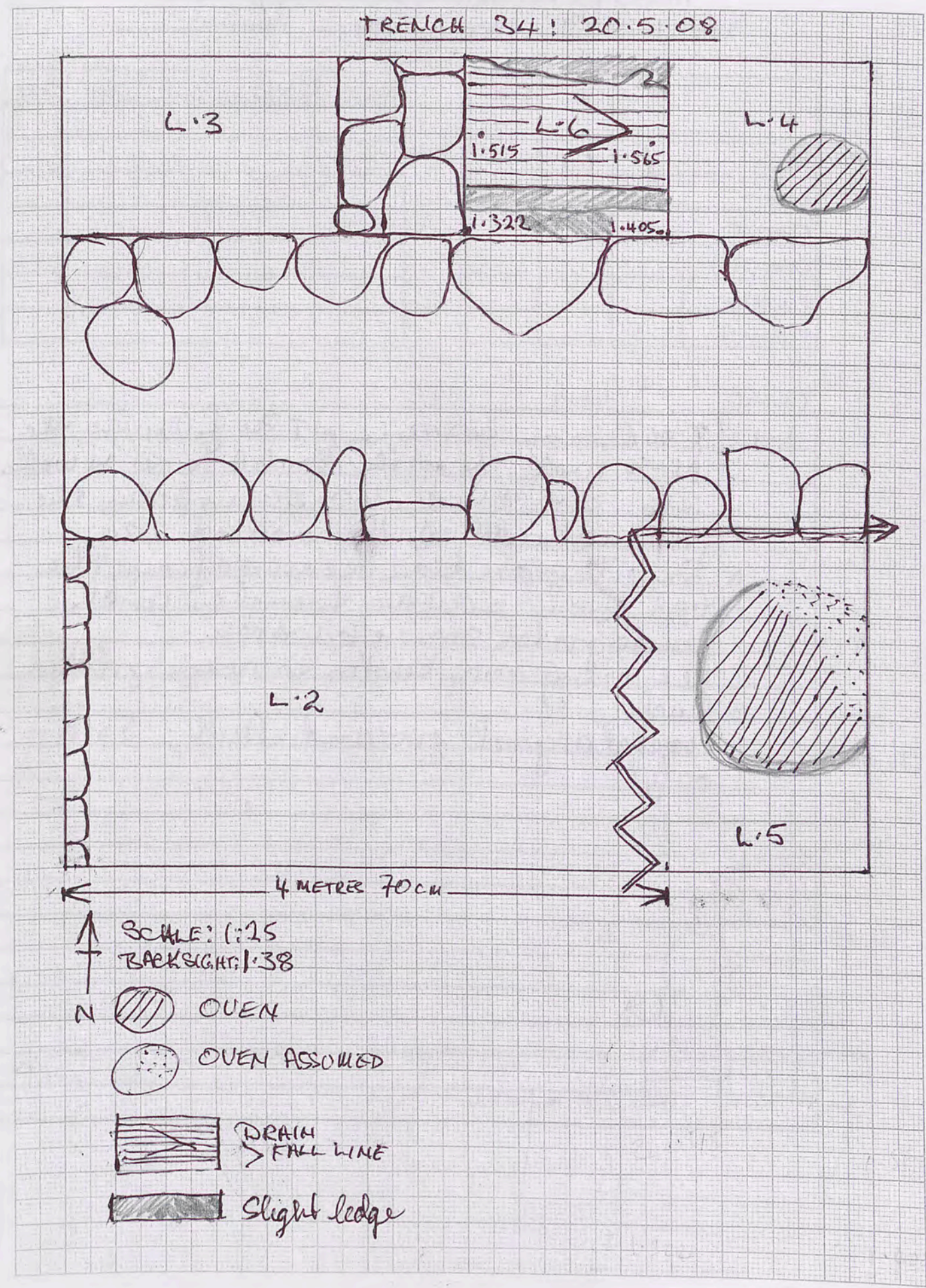

Trench...34A...Initials...BA...Date...20/5/08...Page...24
 Locus.../...Spit.../... Locus...Spit... Feature/s.....

	No. of bags	Cont	Cont
Pottery	2	1.1	
Bone			
Charcoal			
Other (Tile)			
Photos bw			
Photos col.			

No.	Object	Cont	Cont
36	COIN	1.1	
37	STRAINER	1.1	seeing
38	bead	1.1	

Context Report

Context	Report
1.1	Continuing down, soil light brown & many rocks, large & small.
36	Coin, close to wall, upper level
37	Frag of pottery & strainer x seeing 
	Now appears as if there is an E-W well in the N of the trench crossing(?) the N-S wall!
	Spit now using 6th & light grey ash appearing towards S end of trench.
	Tomorrow, will complete spit & begin new spit.

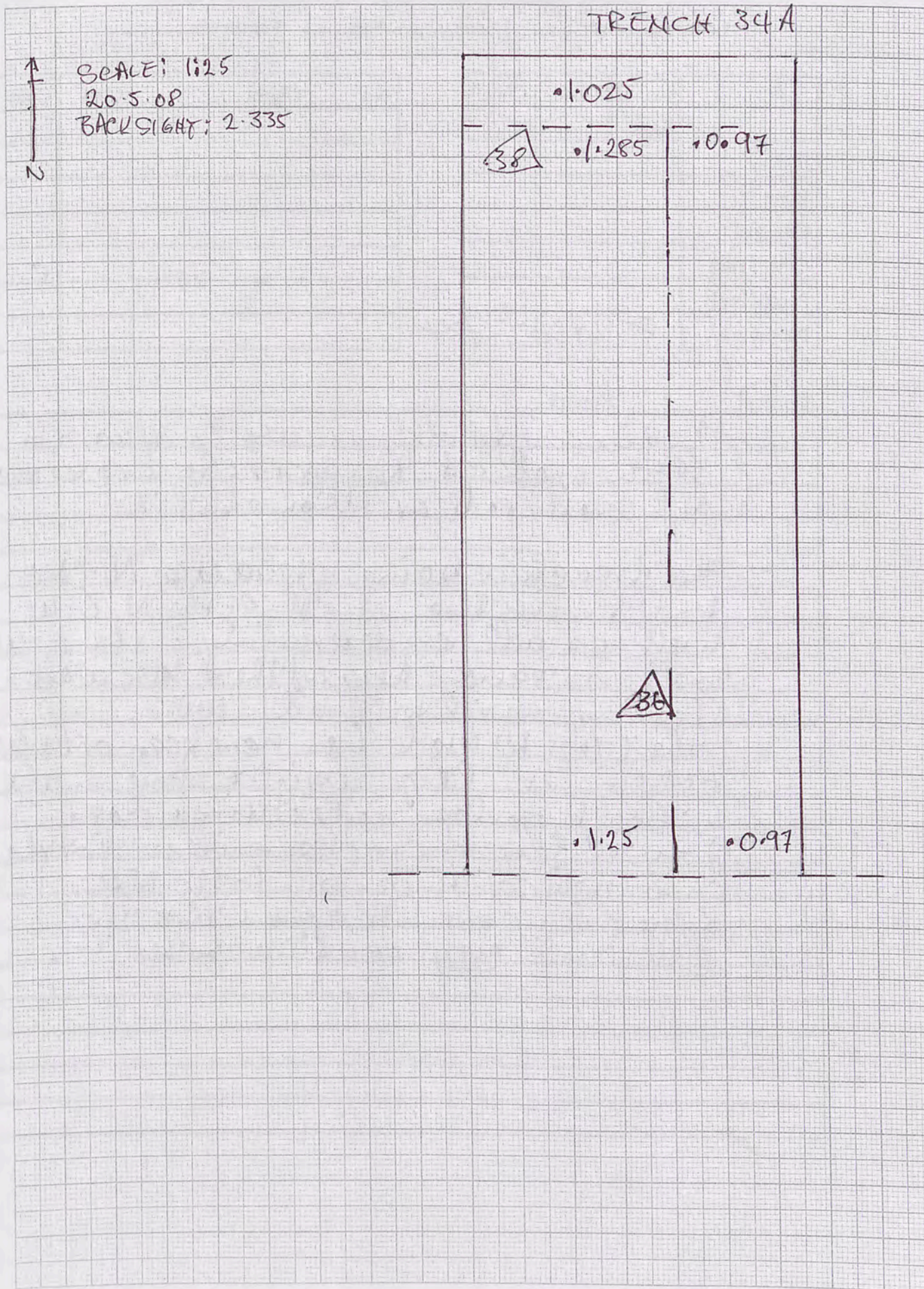

Trench 34A Initials BA Date 2/2/08 Page 25
 Locus 1 Spit 1 Locus 1 Spit 1 Feature/s

	No. of bags	Cont	Cont
Pottery			
Bone			
Charcoal			
Other (Tile)			
Photos bw			
Photos col.			

No.	Object	Cont	Cont

Context Report

1.1 Beginning to define walls this am. N-E-W wall at W appears to cross the N-S wall rather than abut it.

The trench is being extended to N & NE to determine the width of the N, E-W wall as well as determining if the E-W wall extends beyond the N-S wall.

Clearing spoil to wall level.

The E-W wall has now been articulated & there is a large upright stone in the W bank perhaps indicating a door jamb. There is also clear evidence that the N-S wall continues on to the NW toward the cone. It appears that the E-W wall may continue to the E.

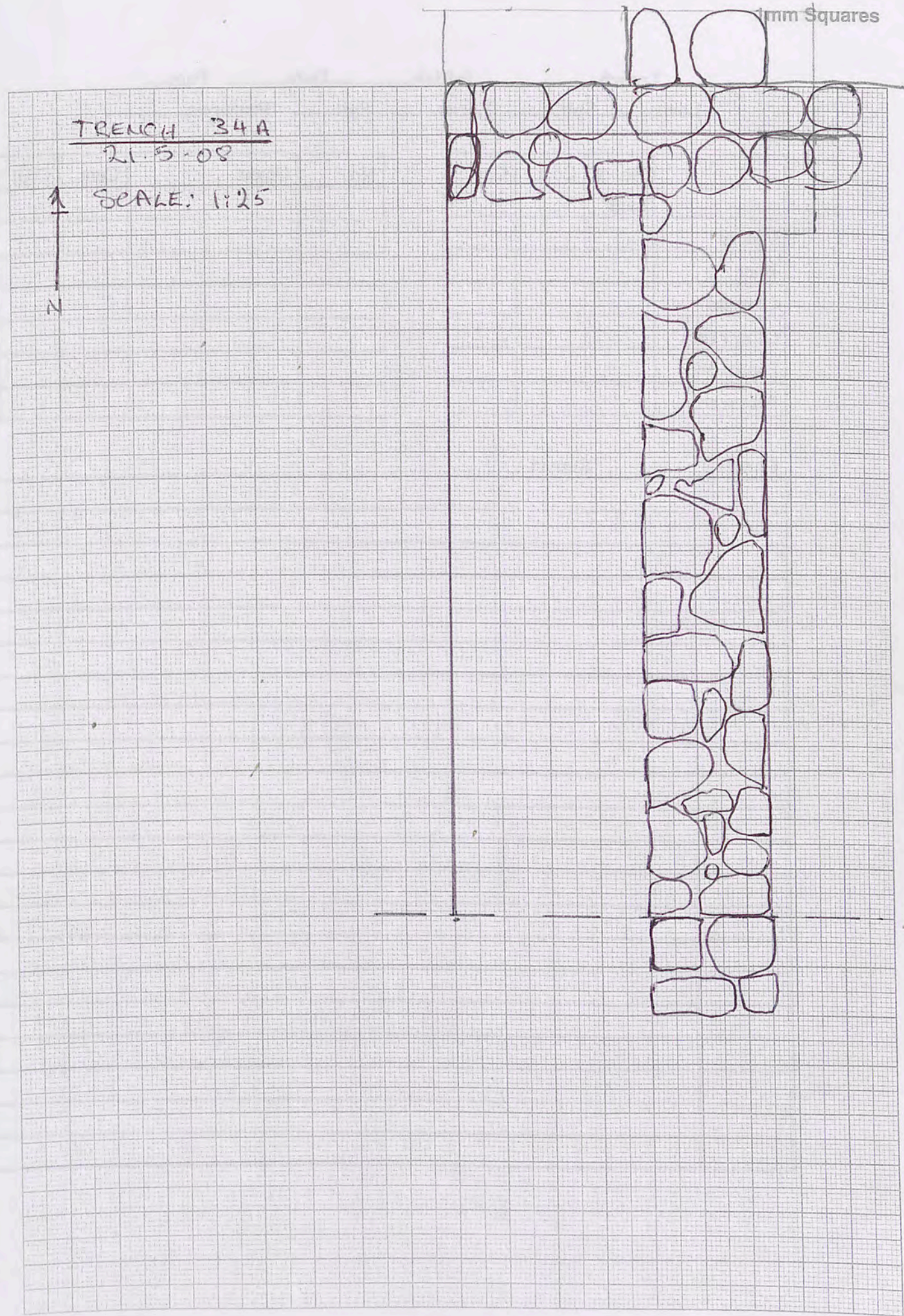

SURVEYOR:

DATE:

Backsight	Inter.	Foresight	Rise	Fall	Reduced Levels	Chainage	REMARKS
14.5.08	2.664	T342.2	NW 2.00				
		SW 2.0					
		NE 2.24					
		SE 2.29					
		NW 1.375					
		SW 1.68					
		NE 1.63					
		SE 1.955					
15.5.08	1.45	2.2	NW -0.935				
			SW 1.0935				
			NE 1.225				
			SE 1.11				
			NE 0.977				
			SE 0.847				
			CN 0.66				
			CS 0.926				
			NW 1.56				
			SW 1.658				
18.5.08	1.41	3.2	W 0.355				
			E 0.41				

JOB No.:

SURVEYOR:

DATE:

Backsight	Inter.	Foresight	Rise	Fall	Reduced Levels	Chainage	REMARKS
5.5.08	1.930	L 1.2	NW 0.80				
			SW 0.92				
			SE 1.08				Top of wall
			NW 0.02				" fill & spill
			NE 0.365				" " fill & spill
6.5.08	2.720		NW 1.995				
			SW 1.875				
			NE 1.84				
			SE 1.87				TOPOG WATER SE 1.8
7.5.08	2.665	L 1.3	NW 1.95				
			NW 2.09				
			SW 1.88				
			SW 2.07				
			NE 2.17				
			SE 2.17				
8.5.05	2.82	L 1.4	NW 2.38				
			SW 2.385				
			2.285				
			NE 2.44				
			SE 2.475				
							HIGH POINT OF FLOOR LOCUS 1.4

Trench: 22 Initials: BA Date started: 26/4/08 Date finished:

Trench Context Record

Context	Location (below, beside, on)	Structure (tumble, fill, floor, wall, pit, oven)	Soil colour	Soil texture	Depth	Thick	Page/s
1.1	Sk of T15	Scraped floor to back	grey	fine to med	50-150		1
1.2	"	Red rubble? walls N-S					
1.3	below 1.2	?	grey	fine	10-15		2
2.3	beside (E) of 1.3 & wall	Floor, uneven surface	grey	fine	40		3
1.3	W. of wall	tumble?			20		3
3.4	Middle section of T22	tumble, oak deposit N			25		4
3.5	"	below 3.4	light brown		45		5
3.5	concrete floor	floor					5
3.5	additional floor to see						6
1.1	New Trench Rd of 29	cleared surface	grey	fine	20		7
1.2	below 1.1	remains tumble			20		7
1.3	"	open space - room	grey brown	fine	20		8
1.4	"	"					
2.5	E. of 1.4	"					
3.2	N of EW wall	open space (room?)			50		12
4.6	E of 1.2	known floor to label			130c. 25		15
1.1	Scraped floor	structure					16
2.2	S of E-W wall	"					16-17

PL 41

1

2

3

3

4

5

6

7

7

8

12

13

15

16

x S. wall

JOB No.:

SURVEYOR:

DATE:

079

Backsight	Inter.	Foresight	Rise	Fall	Reduced Levels	Chainage	REMARKS	
10.5.08	2725	L1.4	NW 2.41					
			SW 2.54					
			NE 2.29					
			SE 2.42					
			NW 2.59					
			SW 2.41					
			NE 2.615					
			SE 2.47					
11.5.08		L3.2	NW .84				See plan pg. 13 for walls & final levels of h1 & 2 floors.	
			SW .85					
			NE 1.43					
			SE 1.52					
			NW 2.965					
			NE 3.03					
			SW 3.08					
			SE 3.1					
			NW 1.21					
			NE 1.665					
12.5.08	2.828	L4.6	NW 2.965				} of level	
			NE 3.03					
			SW 3.08					
			SE 3.1					
			NW 1.21					
			NE 1.665					
			SE 2.4					
			SW 1.95					
12/13/5/08	2.80	39 (1.1)	NW 1.21					} external rubble ie. outside edge of trench.
			NE 1.665					

Trench.....Initials.....Date started.....Date finished.....

Trench Context Record

Context	Location (below, beside, on)	Structure (tumble, fill, floor, wall, pit, oven)	Soil colour	Soil texture	Depth	Thick	Page/s
34 2.3	Below 2.2						
3.1	N of NW E-W wall						19
3.2	" "	Spill field + N/S wall	grey	fine blocky			20
4.3	E wall (us border: wall)	of 3.2 wall in 3.2	"	"			20
5.4	SE of T 34 impact	in T30	L. brown	tough blocky			21
6.4	N of E-W double wall	between L3 & L4	grey	fine			22
34A 1.1	N of N/S wall	N of Double E-W wall in T34	L. brown	fine & rocks			23-4