

# Jebel Khalid 20002

## Field Record Book

B 21  
B 22 ext W  
B 23

Name..... Ed Clarke.....  
Trenches..... T21 (Area B), Western Bank, Southern Bank, Expansion into B22.....  
..... B23, B22 exp W.....  
Dates..... 14 April 2002 - 23 ~~Apr~~ May 2002.....



**List of equipment for Trench Supervisors**

Dig bag  
 Water  
 Clip board and spare clips for windy days  
 Pens (water proof only - black or blue), pencils, ruler, eraser  
 Measuring tape  
 Plumb bob  
 String  
 Spirit level (may be shared)  
 Supply of labels  
 Supply of different-sized plastic bags  
 Toilet paper (for wrapping delicate objects as well as for personal use!)  
 Small cartons/boxes for objects. When available  
 Band-aids and aspirin for the vapours (yours or the workers')

**Useful words**

All	kull
All of you	kullkum
All even ( same)	kull sawa-sawa
Bedrock	jebel
Big	kabeer
Black	aswad
Bone	az'm
Boy	walad
Brush	forshay
Charcoal	fah'm
Cleaning	tanzeef
Dead	mowt
Eating!	mangariyya
Floor	ardth
From	min
Girl	bin't

Glass	zujaaj
Half	nuss
Here	hona
I	ana
Iron	hadeed
Little, small	sagheer
Man	rajul
Maybe, perhaps	mumkin
Must	laazim
Must not!	mu laazim
My (my son)	-ee e.g. walad-ee
Pick	kazma
Pottery	fachaar
Photo (picture)	soora
Red	ahmar
Rock	hajir
Room	gurfa
Sick	mareedth
Soil	trab
Slowly	shway, shway
Supervisor	mudeer
There is.. there is not	fi....maa fi
This	hadtha
To, for	ila, li
Today	al yowm
Tomorrow	bukra
Trowel	mustareen
Wall	jidaar
Water	mayy
Wheelbarrow	darraaja
White	abyad
Yesterday	imbaarih
You (sing. m/f anta,	anti
You (pl.)	antum



### ADVICE to TRENCH SUPERVISORS

1. Take a **new page** for each day. (Each day may take several pages).
2. Draw a **scale plan** of the trench **each day** on the graph paper (essential), with North at the top (if this is not convenient, mark North direction clearly).  
Mark depth from surface at the beginning of each day, at designated points.  
When starting a square, this plan may be nearly empty but draw it all the same and mark in emerging tumble.
3. Draw arrows on your plan to indicate **direction** in which you are excavating.
4. Every time you designate a new context, (on the occasion of a new spit, a new feature, a new soil colour) fill in the **Context Record Sheet** for that trench, as well as describing it in your report. Store the accumulated context record sheets in the plastic sleeve in your record book.
5. **Structures** . Measure carefully any structure (wall, doorway, threshold, ovens, pit, any large dressed stones or columns) and record exact location, height, width in your report as well as on the scale plan.
6. **Floors** - marked by very hard tough surface or layer of white crushed limestone. May be softer adjacent to wall. Record thickness of floor, if we decide to dig through it.  
If your floor is particularly good, collect a few bags of surface material - there may be seeds.
7. **Objects**. e.g. glass, figurine or lamp fragments, metal, stucco, loomweights, spindle whorls, beads, graffito-ed sherds, coins, gold jewellery ( some hope). Mark in the location and depth of any objects clearly and accurately. If necessary, draw another sketch plan as the day progresses. A quick sketch of the object in the report would be helpful, if it is too mysterious to name e.g. Mattie's metal blobs.
8. **Pottery**: label bags clearly in waterproof pen, with one label inside the bag and one outside. **Record daily the number of bags per context** . Be very careful to separate pottery from different contexts.  
**It is absolutely essential to double-bag the pottery. A broken bag of pottery without context is useless.**
9. **Bone**: Collect all bone and label as for pottery. Record number of bags per context daily.
10. **Charcoal**: Collect all charcoal and label as for pottery. Record number of bags per context daily.
11. **Tile**: it is important to record the location and amount of tile.
12. **Very important**: at the completion of a trench, draw to scale:
  - i Draw a section of the exposed baulk, with details of stratigraphy clearly marked.
  - ii Draw a top plan of the completed trench, with contexts clearly marked.
  - iii Write a short summary with your interpretation of the trench.



Area B Trench.....21.....Initials EC.....Date 14/4/2002 Page..1

Locus.....1.....Spit.....1,2,3,4 Locus.....Spit..... Feature/s.....

	No. of bags	Cont Locus	Cont Spits
Pottery	1	1	1-4
Bone	1	1	3
Charcoal	1		
Other (Tile)			
Photos bw			
Photos col.			

No.	Object	Cont	Cont
1	Nail	1	1

NB: Soil Sample from Ashy Deposit (Locus 1, Spit 2).

Context Report

1/1	* Began removing grass from trench and loose stones. Trench appears to be very disturbed (GWC pers com. believes that there was extensive robbing of stone etc. in the surrounding area and most of this soil was deposited during that process). Trench slopes sharply downhill from the west, and spit 1 comprises an area of approximately 4 m <sup>2</sup> in the southwest corner. A number of roof tiles and a few coarse pottery sherds emerging. Spit 1: ~15cm. Square: 7 metres (N/S), 6m. (E/W). * Possible wall running east-west ~30cm in south of northern bank.
1/2	* Began Spit 2: ~15cm. Pottery bagged with spit 1 (GWC) as there was no context change. Approximately same area as Spit 1. * #1: nail found 1 m north <sup>east</sup> of southwest corner (depth 30cm). * Ashy Deposit 3 metres north of, 1 metre east of south west corner. * Some fragments of worked stone removed.
1/3	* Began Spit 3 ~15cm. Again pottery bagged with Spit 1 * Broken piece of worked basalt located under/within ashy deposit. (Depth ~35cm) Also here were some bone fragments (mandible sheep?), probably a modern campfire/hearth.
1/4	* Spit 4 continued in the same area as Spit 3. (southwest corner). Northern and eastern parts of the trench are still at least 2 metres below this spit. Finds bagged with Spit 1. (Much roof tile!). 2 very full zambels of roof tile removed to pile in western section of Area B.

PTD







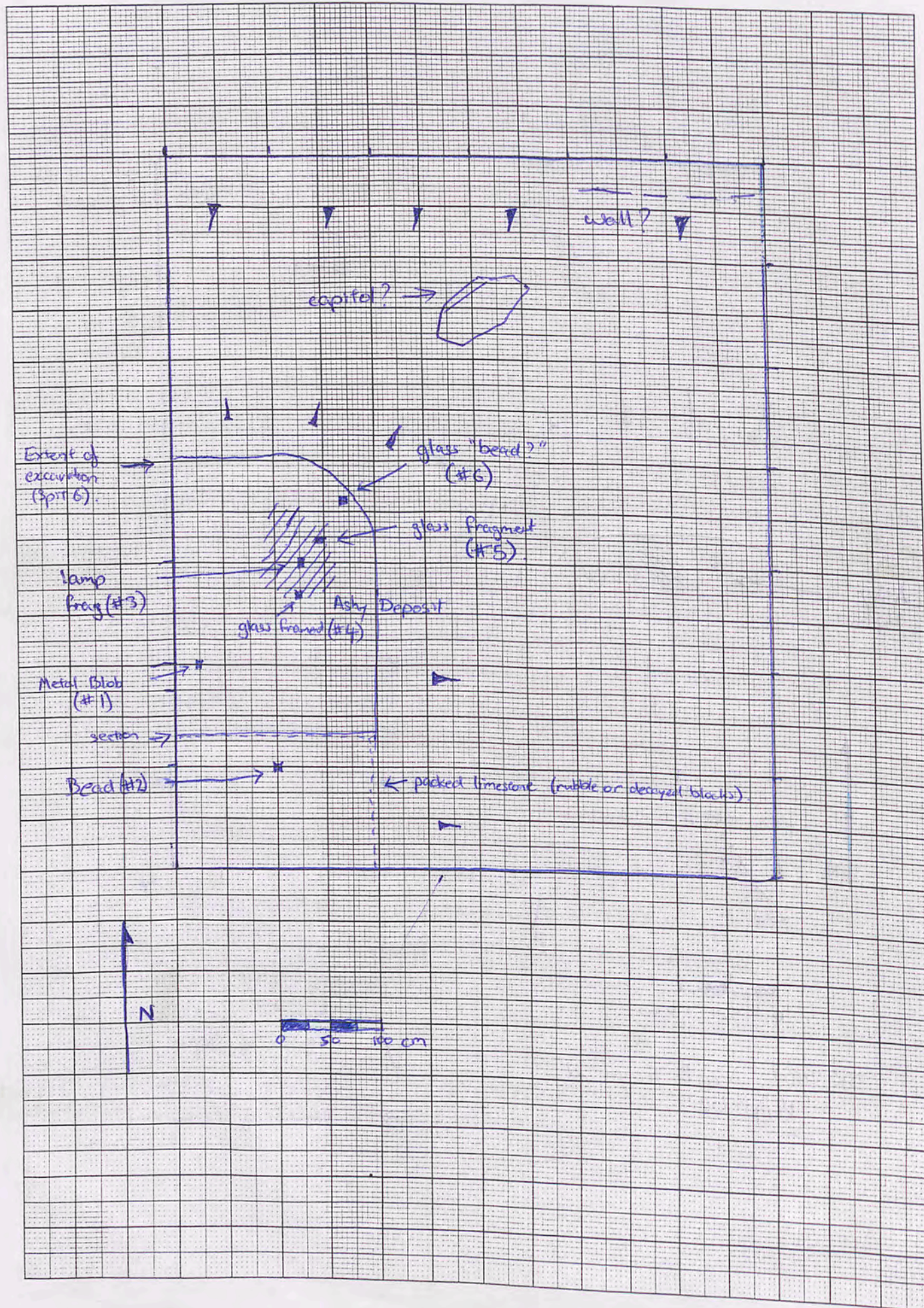

Area B Trench...21.....Initials...EC.....Date...15/4/02 Page...3  
 Locus...1.....Spit...5,6,7 Locus.....Spit..... Feature/s.....

	No. of bags	Cont Locus	Cont Spits
Pottery	1	1	5-7
Bone	1	1	5-7
Charcoal			
Other (Tile)			
Photos bw			
Photos col.			

No.	Object	Cont	Cont
1	Metal Blob	1	5
2	Bead	1	5
3	Lamp Frag	1	5
4	Glass Frag	1	5
5	<del>Possible Bead</del>	1	7
6	Glass 'Bead?'	1	7

Context Report

1/5 \* Began Spit 5 (depth 90cm from south-west corner), approximately 15cm deep. Area slightly expanding with drop of slope to the north and east, Area still very disturbed. Some pottery + roof-tile emerging amid very broken stone and soil. Small piece of worked basalt located at base of spit 5.

\* Metal 'blob' found also ~~in~~ of Spit 5, 2m North of SW corner (depth 90cm), ID#1. In conjunction with a great deal of 'smashed' and decayed limestone and a piece of base. Small bead found at base of Spit 5 (depth 105cm) ID#2, 1m NE of SW corner.

\* Lamp fragment found at base of ashy deposit. (ID #3) depth 105cm from SW corner. Small shell, possibly from the limestone, bagged with bone. Glass fragment also found in this area (ID#4).

1/6 \* Began Spit 6, left a section of packed limestone in southwest corner; probable packing underlying original floor which has been robbed; could also be very decayed floor blocks. Ashy Deposit continues but is less dense and broken up.

1/7 \* Began Spit 7 (Depth 120cm) in same section leaving the packed limestone. Part of western bank collapsed into trench; this material was searched but was artefact free. Remaining part of spit comprises rubble and soil with large gaps i.e. very loosely packed and certainly modern spoil. Possible pieces of marble removed at depth 125cm (~~2~~) (3). They Conjoin!

\* Glass fragment found at base of ashy layer Depth c. 125cm. (ID #5)

\* 2 Zambels of roof tile removed. Glass 'Bead?' (ID#6) Located at base of spit 7 near eastern<sup>NE</sup> end of section.



Area B Trench 21 Initials EC Date 16/4/2002 Page 4  
 Locus 1 Spit 89 Locus Spit Feature/s

	No. of bags	Cont Locus	Cont Spits
Pottery	1	1	8-10
Bone	1		
Charcoal			
Other (Tile)			
Photos bw			
Photos col.			

No.	Object	Cont	Cont
1	Lamp Frag	1	8
2	Mageirian Bowl Frag?	1	9
3	Small thick coin	1	10
4	Metal bit	1	10

Context Report

1/8	* Began spit 8 (Depth 130 cm from SW corner). Still very loose rubble and soil. The south bank shows a definite secondary robbing (line of grass) which is undoubtedly modern (c. 25 cm deep) compared with probable Byzantine earlier robbing. Left section of packed limestone shows that the 'floor' was overlying well packed stone and rubble.
1/9	* Began Spit 9. (Depth 145 cm from SW corner). Found 'pressed bowl frag' (Magierium?) adjacent to ribbed pottery (ID #2) 3 m NE of SW corner, depth 145 cm. Being in the same context, though temporally 6 centuries apart supports the very disturbed hypothesis! * Rolled "capitol" over for B. Rowney to draw. It is believed to have come out of northern bank or thereabouts and rolled in. (has 3 'dentates', but is weathered). Some associated burned bone and ash. Some large worked stone pieces removed.
1/10	Removed stones/rubble with the exception of large rectangular stone block. (Depth 160 cm from SW corner) After rock removal spit depth was approx. 20 cm. * Small thick (greek?) coin located 50 cm North and 310 cm east of SW corner depth 180 cm. ID #3 * Piece of metal found (depth 180 cm from SW corner).

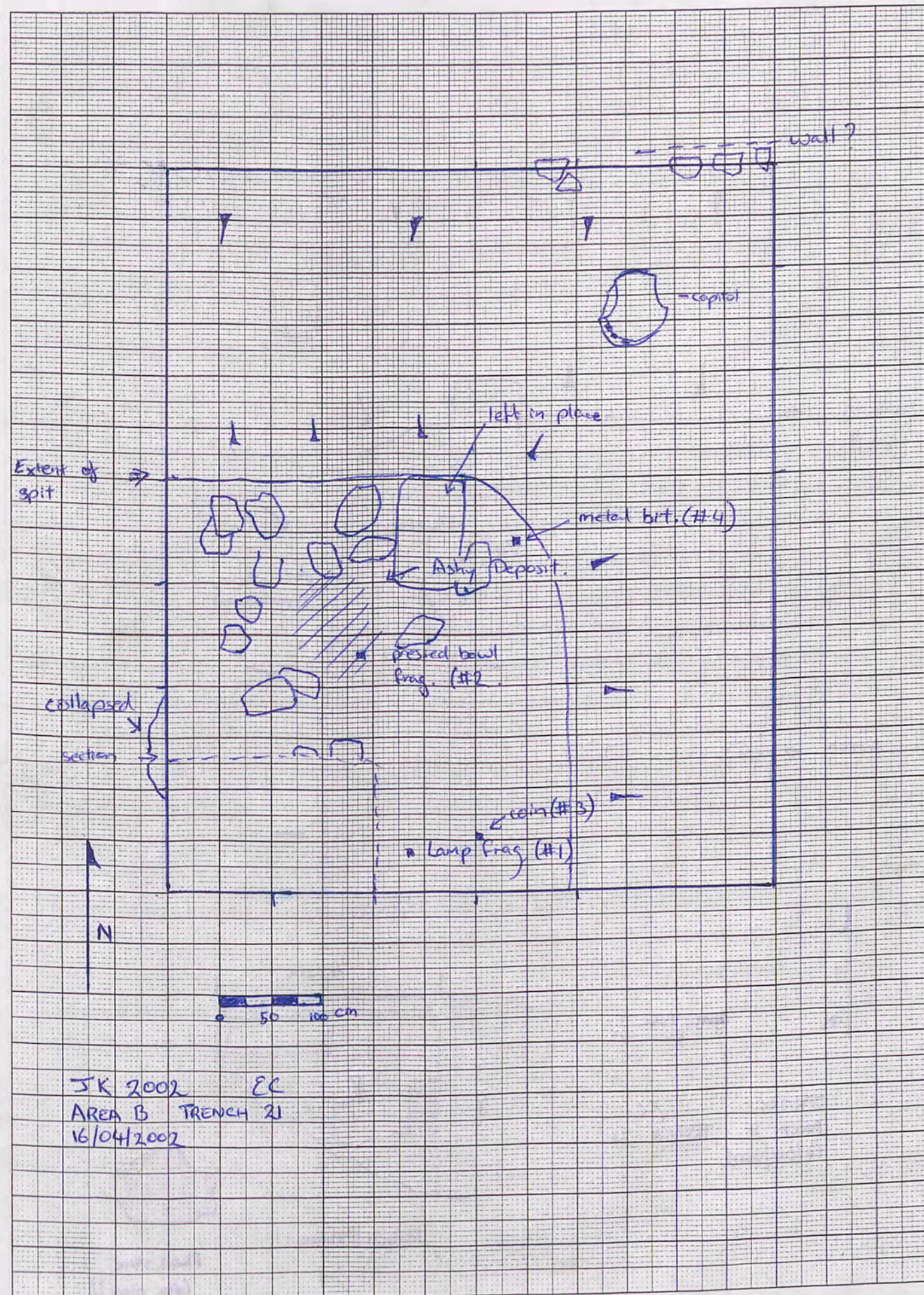

JK 2002 EC  
 AREA B TRENCH 21  
 16/04/2002

NB. External Spring replaced by B. Rowney in roughly the correct position. Northern wall appears to have moved to mostly outside the trench.







Area B Trench...21.....Initials EC.....Date 18/4/2002 Page 6  
 Locus...1.....Spit...11..... Locus.....Spit..... Feature/s.....

	No. of bags	Cont	Cont
Pottery	1	1	11-12
Bone	1	1	12
Charcoal			
Other (Tile)			
Photos bw			
Photos col.			

No.	Object	Cont	Cont
1	Coin	1	11
2	Nail	1	12
3	Coin	1	11
4	Moulded Bowl frag	1	12

Context Report

Context	Report
1/11	* Continued Spit 11, working west. Found small coin (#1) depth ≈ 190cm from SW corner in centre of trench. Packing still quite loose; stone (very broken/rubble) intermixed with soil and some pottery and roof-tile. * Large worked stone (510 x 550 x 810mm) was worked around and was sitting on loose rubble (skewed + tilted) ∴ out of original context. Coin (ID #3) found at base of Spit 11 (depth 190cm)
1/12	* Began Spit 12 from eastern section. Nail located 5.8m E and 0.5m N of SW corner. * Line of stones (foundations?) emerging; running north-south - Very fine worked blocks in situ. Worked stone (420 x 550 x 190mm) shifted to clear spit - Out of context as it was skewed and sitting on soil. 1 zambel of roof tiles removed. * The lined blocks were overlain by extremely decayed/crushed limestone gravel. Course of stone are 1100mm wide. Northernmost stone is 1000mm long, 2nd is 1100mm. Rather than one course of stones, they could be actually 3 courses wide ∴ After subsequent they appear to be very big, possibly 1100 x 1100 blocks. * Moulded Bowl frag. found in pottery bag.

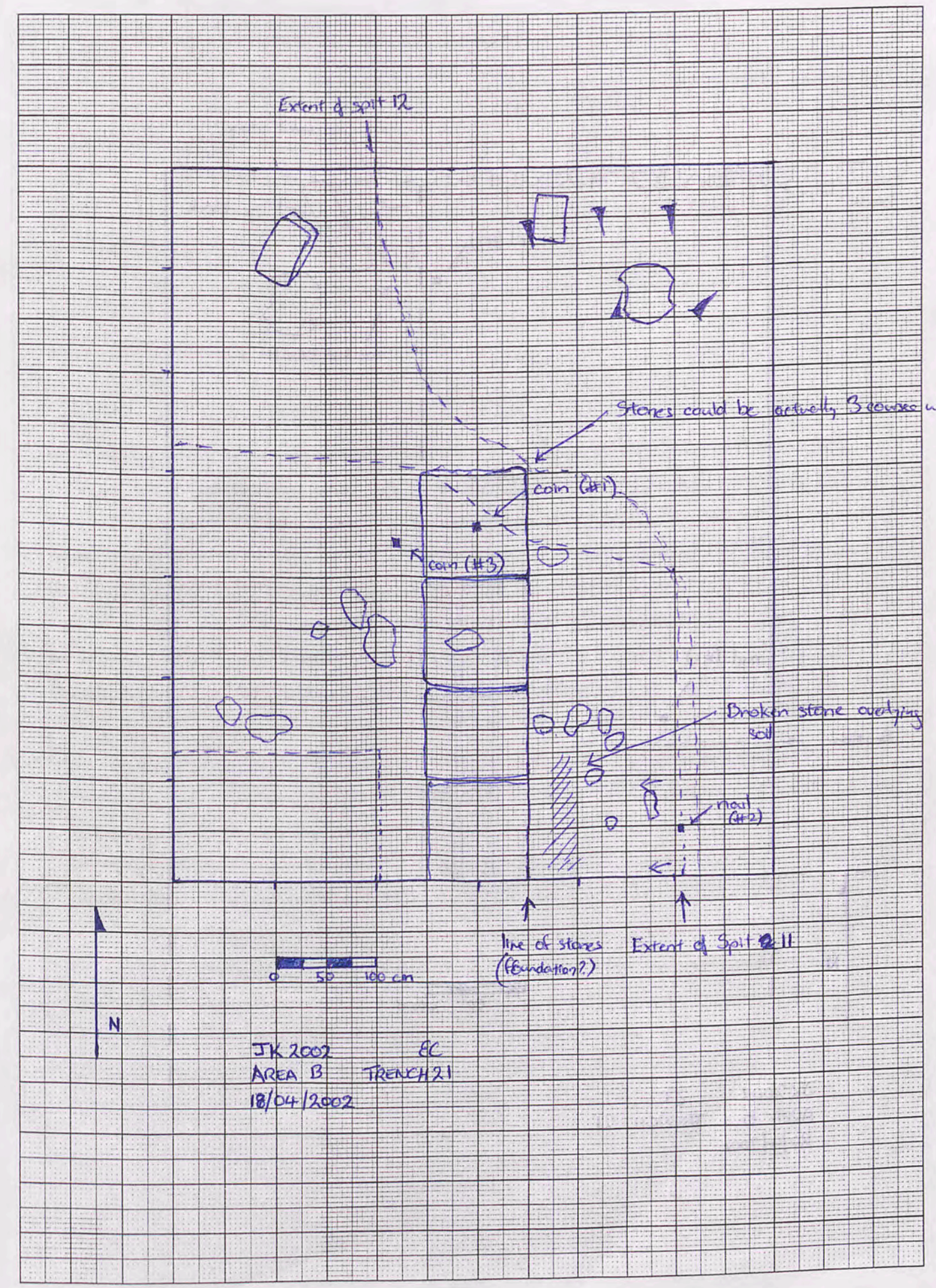















Area B Trench...21.....Initials...EC.....Date 23/4/2002 Page 10  
 Locus...1.....Spit...14..... Locus.....Spit..... Feature/s.....

	No. of bags	Cont	Cont
Pottery	1	1	14
Bone	1	1	14
Charcoal			
Other (Tile)			
Photos bw			
Photos col.			

No.	Object	Cont	Cont
1	Glass fragment	1	14
2	Metal blob (broken)	1	14
3	Figure head	1	14
4	Glass fragment	1	14
5	Lamp frag?	1	14

52,224

Context Report

Context	Report
1/14	* Continued Spit 14 in northeast corner. Moved 'capitol' and 'roofing piece' to bedrock of northwest corner. 'Roofing piece' was broken and fractured into five pieces. Retaining wall appears to drop off or disappear as we dig east.
	* Foundation stones in the eastern section appear to be based on loose rubble instead of being placed on loose bedrock. (possibly because they are not load-bearing?). Bedrock is def. shaped around 'sticky outy bit' in central west part of foundation blocks. Some pottery and roof-tile emerging.
	* Small glass fragment (ID#1) found in northeast corner near base of spit 14.
	Basalt quern fragment and metal blob (broken, ID#2) found in similar location.
	* Figure head and glass fragment (ID#3, ID#4) also found in northeast corner.
	* Lamp frag? (ID#5), painted red & black found in same locality.
	* <del>Small</del> Several "Delta" figures on another of the 2nd course foundation stones.

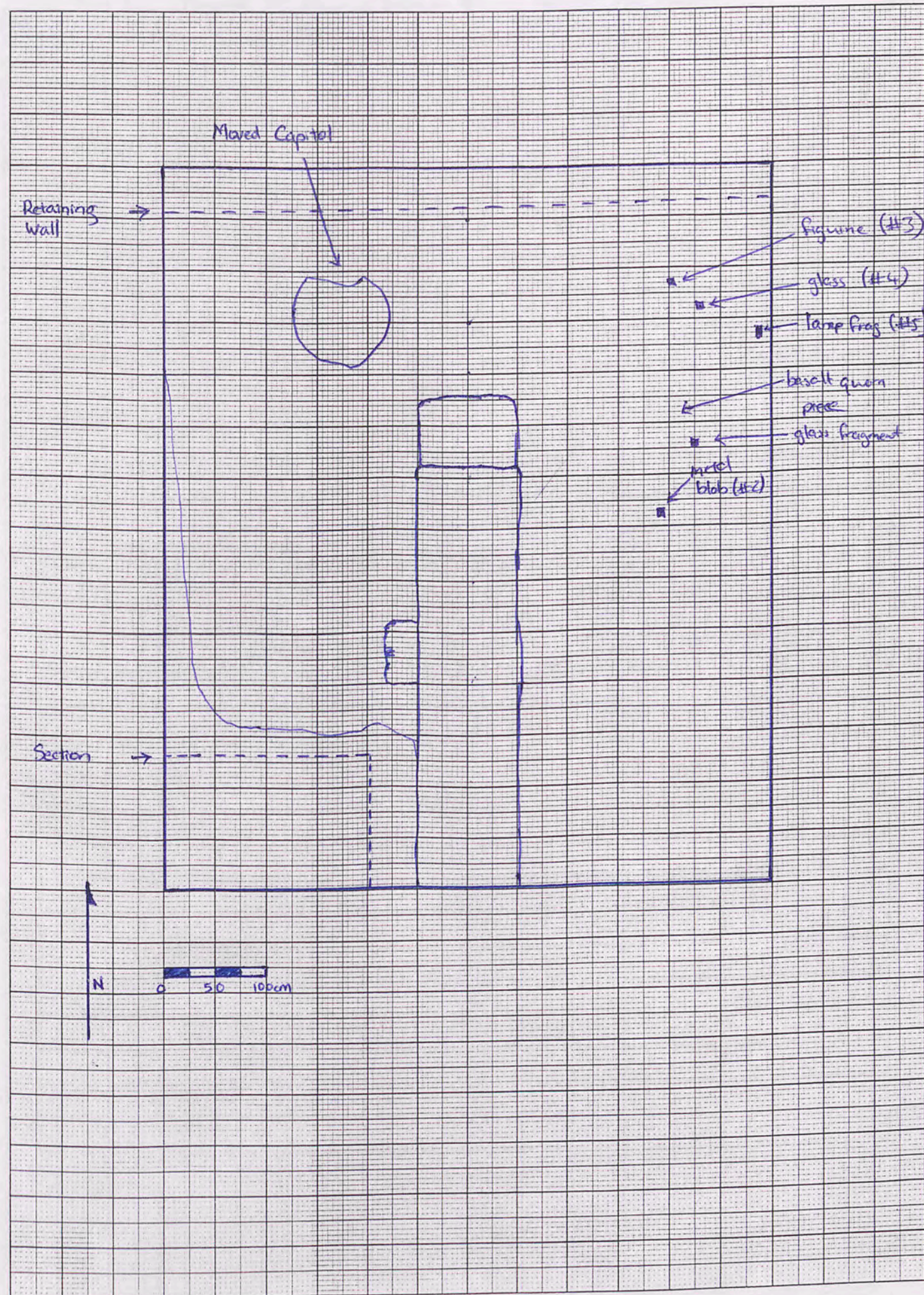
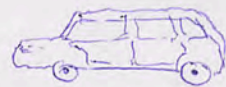







Area B Trench.....21.....Initials...EC.....Date 25/4/2002 Page 12

Locus.....Spit..... Locus.....Spit..... Feature/s.....

	No. of bags	Cont	Cont
Pottery	1	1	14
Bone	1	1	14
Charcoal	1	1	14
Other (Tile)			
Photos bw			
Photos col.			

No.	Object	Cont	Cont
1	Coin	1	14
2	Bronze piece with hook	1	14
3	Odd pottery bit	1	14
4	Figure fragment	1	14

Context Report

Context	Report
1/14	<ul style="list-style-type: none"> <li>* Continued working in SE corner. Blocks which appeared to be in situ were not! One block; 720 x 520 x 410 mm was rolled over so as to get to soil beneath. Stone was cracked and broke in two during the moving process. Some pottery, roof tiles, bone and charcoal fragments emerging.</li> <li>* Also continued slowly in muddy northeast corner.</li> <li>* Coin found 2m N and 1m east of SE corner (ID #1).</li> <li>* Broken block and stone block below it became loose as soil surrounding them was removed so they were moved.</li> <li>* Third tier of foundation stones is 'rusticated', (NE end)</li> <li>* The two very large blocks sticking out east from centre part of foundation <sup>still</sup> appear to be sitting on loose rubble and may not be in situ.</li> <li>* Figure fragment (ID #4)? found in pottery.</li> </ul>
	ANZAC DAY! Windy but nice and sunny after days of wet weather.

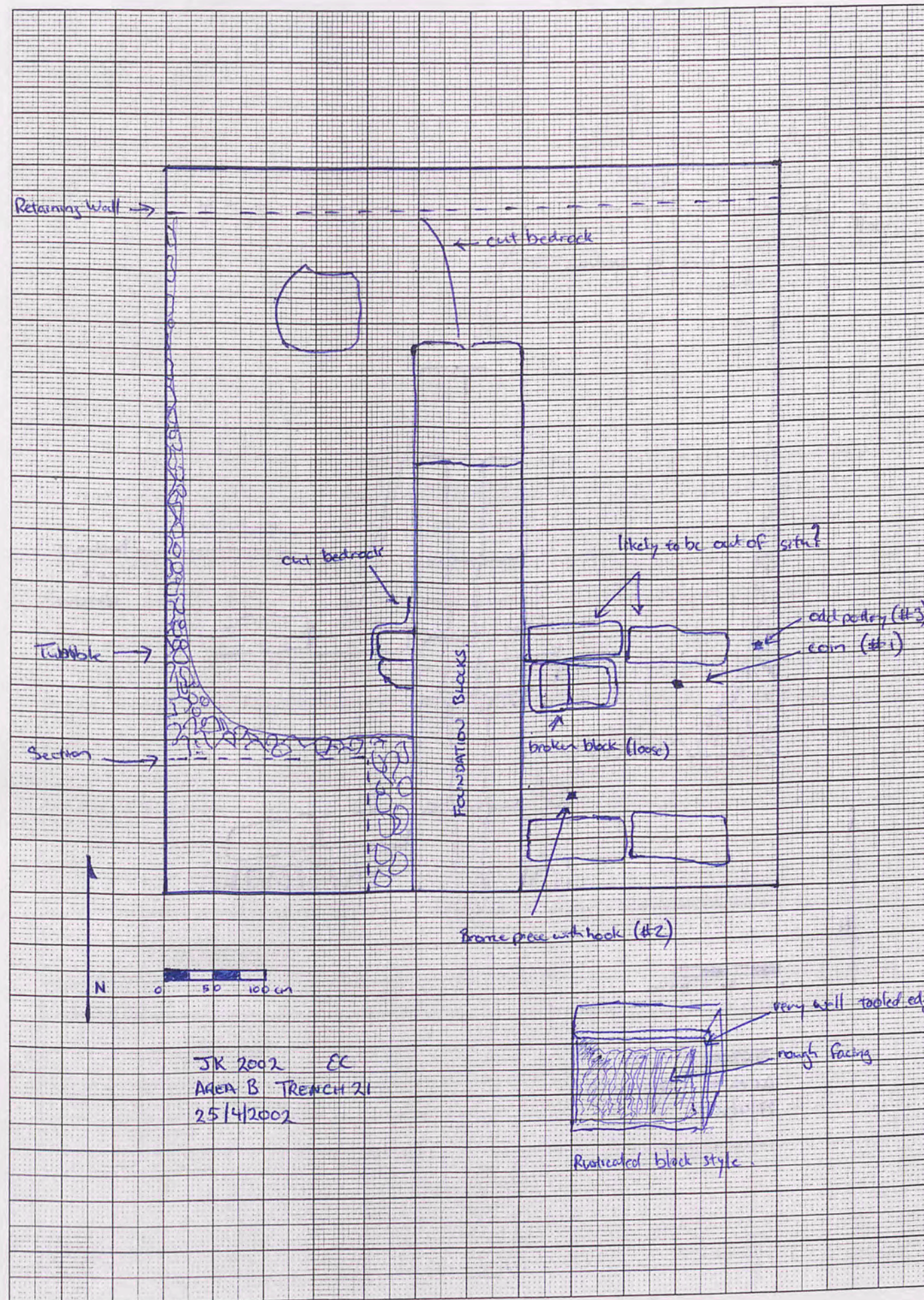



















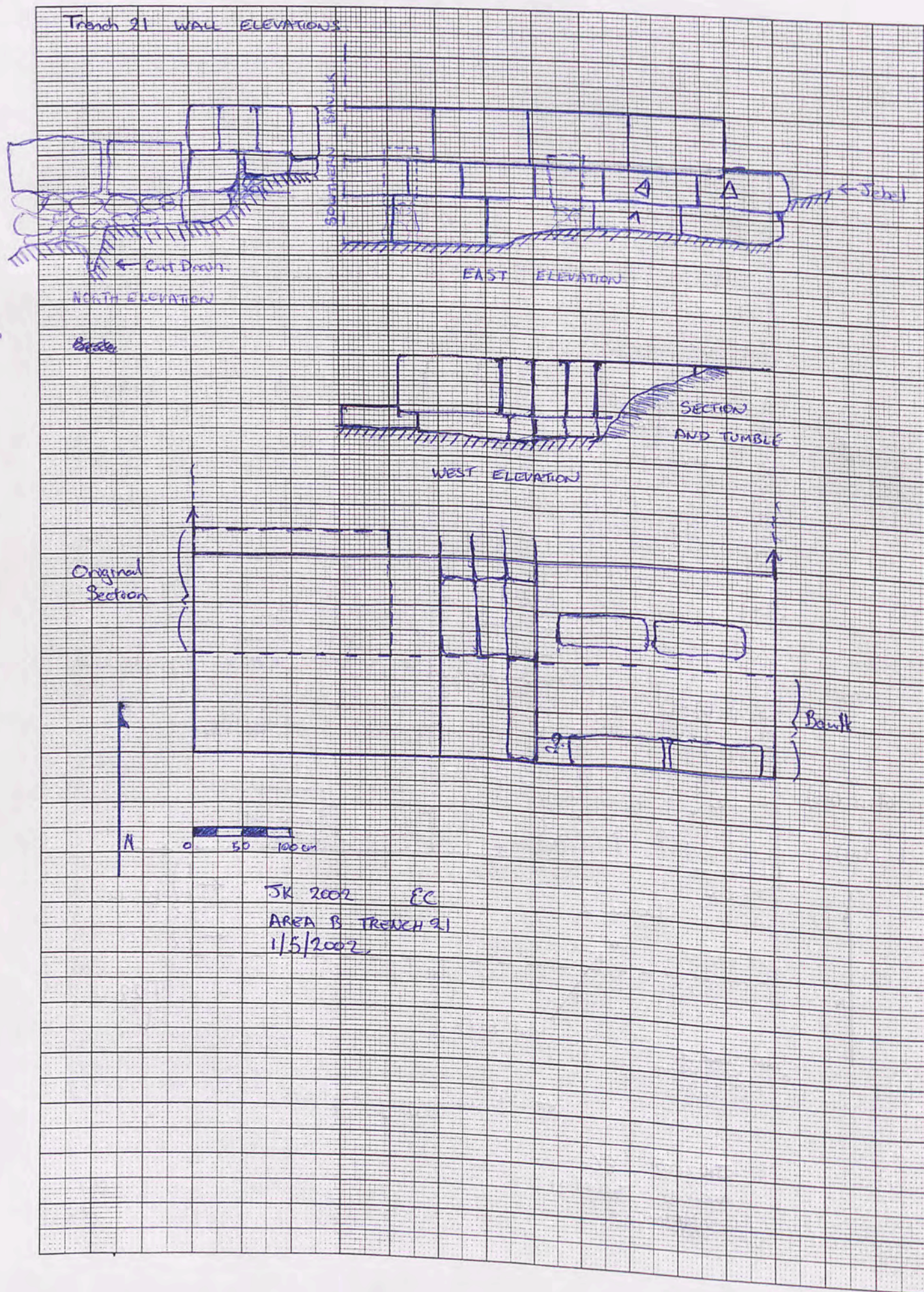

Area B Trench 21 Initials EC Date 1/5/2002 Page 17  
Locus 2 Spit 3 Locus Spit Feature/s

	No. of bags	Cont	Cont
Pottery	1	2	3
Bone	1	2	3
Charcoal			
Other (Tile)	1 Zambesi (full)		2/3
Photos bw			
Photos col.			

No.	Object	Cont	Cont
1	Seed (date?)	2	3
2	Bronze applicator?	2	3
3	Possible figurine frag?	2	3

Context Report

2/3	<p>* Begin Spit 3 in baulk and sections working simultaneously in these areas. We think it is likely that the east-west blocks were placed there to contain the packing or fill which would underlie the original floors.</p> <p>→ * Seed (ID#1) possibly from a date? found in built area in eastern side associated with a quantity of bone (temur 5).</p> <p>* Block emerging in SW section which is coated and may be in situ possibly an internal wall/more foundations.</p> <p>* Bronze applicator? (ID#2) found 2 metres in from east baulk on top of foundation wall which <sup>is beginning</sup> emerges to emerge from eastern side.</p> <p>* Possible figurine fragment? (ID#3) found over wall but it is very worn (could be tile?).</p> <p>* The possible internal wall blocks are becoming isolated and are increasingly unlikely to be in situ.</p> <p>Wardah lezzim niver!</p> <p>NB. Apparently May 1st is a holiday so the workers will get double pay.</p>
-----	--











Area B Trench...21.....Initials...EC.....Date...7/5/2002 Page 20  
 Locus...2.....Spit...5..... Locus...4.....Spit...1..... Feature/s.....

	No. of bags	Cont	Cont
Pottery	2	2/5	4/1
Bone	1	2	5
Charcoal	1	2	5
Other (Tile)			
Photos bw			
Photos col.			

No.	Object	Cont	Cont
1	Plaster (white)	4	1

Context Report

Context	Report
2/5	<ul style="list-style-type: none"> <li>Continue clearing rubble and soil from southern bank and SW section. This spit may encounter bedrock but it depends on whether it steps up to the south as the rest of T21 does! Lots of small limestone chips overlying clayey layer which is characteristic of the lens above bedrock. It's becoming increasingly unlikely that we'll be able to complete all the excavation trenches and soundings given the amount of soil etc left to move in T20 and T22, but we'll see. We'll also encounter issues in terms of where we'll work next as T22 will be working too close to T21 workers. The suggestion is that T22 work in the southern area outside the foundation while we expand into their trench. Will probably remove some of western bank adjoining T19.</li> <li>Bedrock to western side of foundation wall is levelled and cut. Some charcoal, bone and an amphora handle (plain) with other pottery emerging.</li> <li>Cleared to bedrock and began removing the southern 2 metres of western bank adjoining T19. Labelled Locus 4.</li> </ul>
4/1	<ul style="list-style-type: none"> <li>Pushed some of the bank down and began removing rubble. Some roof tile amongst it.</li> <li>Piece of white plaster removed from top part of bank. The first 60cm is predominantly soil and grass roots which overlies two layers of fine degraded limestone in line with the top and bottom of the highest course of stone in T22.</li> </ul>

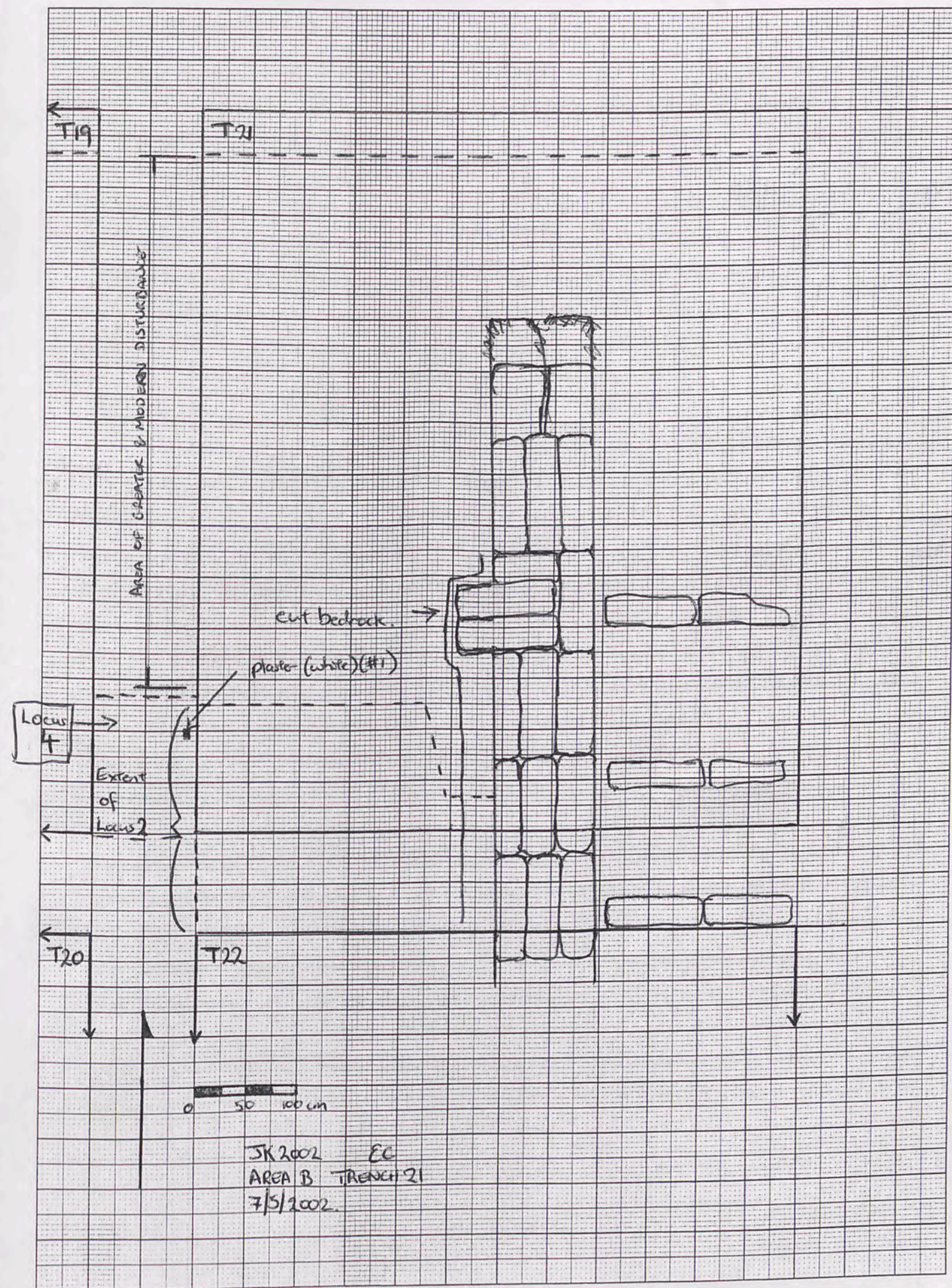



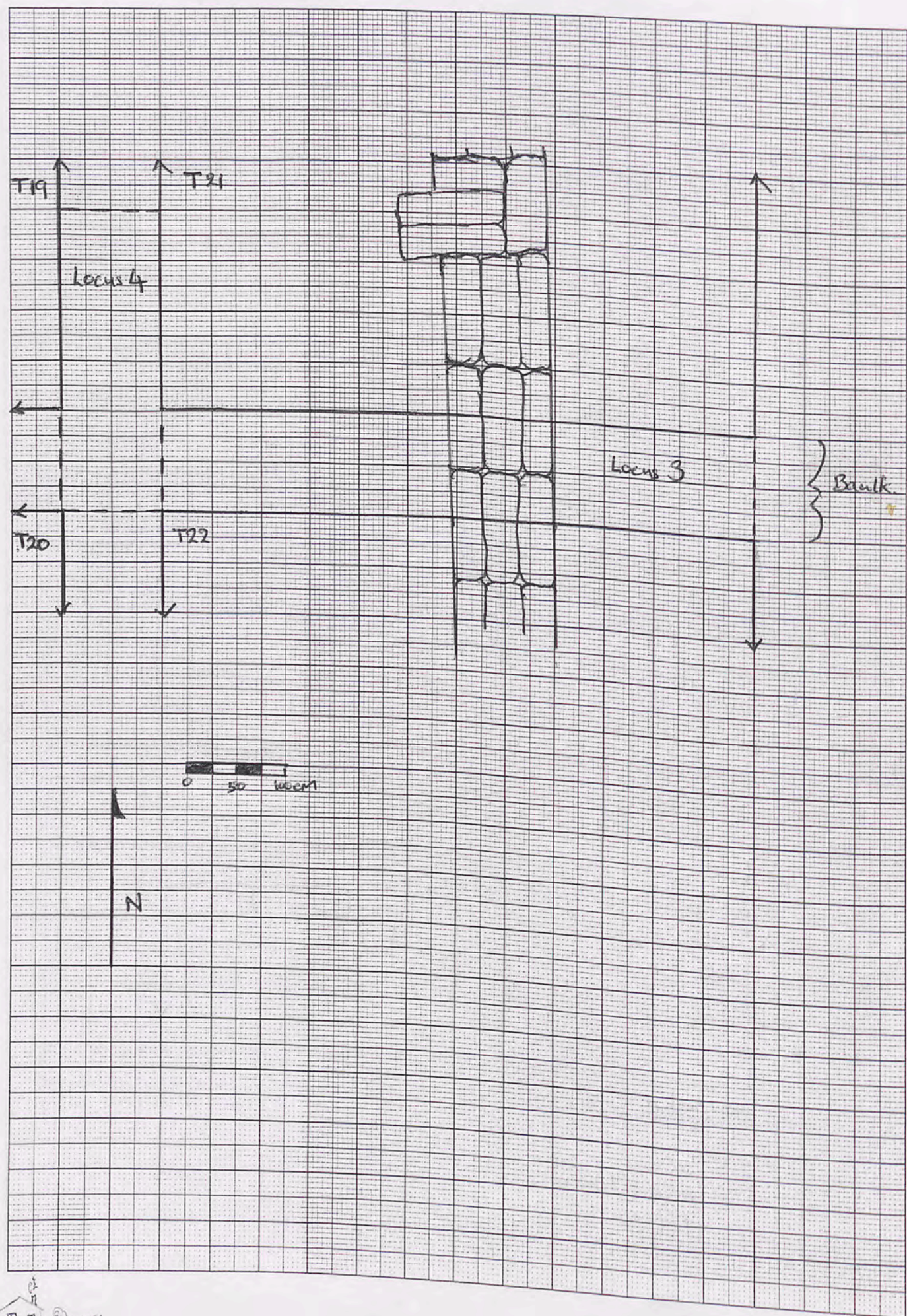

Area B Trench.....21.....Initials...P.C.....Date...3/5/2002 Page...21  
 Locus...4...Spit...2... Locus.....Spit..... Feature/s.....

	No. of bags	Cont	Cont
Pottery	1	4/2	
Bone	1	4/2	
Charcoal	1	4/2	
Other (Tile)	1	Zambeel.	
Photos bw			
Photos col.			

No.	Object	Cont	Cont
1	Worked limestone (hair/rope?)	4	2
2	fossilised shells (sorry)	4	2
3	glass with hole	4	2
4	Iron blob	4	2
5	Small bronze frag	4	2
6	Broken iron nail	4	2
7	lamp frag	4	2

Context Report

Context	Report
4/2	Began spit 2 in western baulk. A small piece of worked limestone possibly from a statue (ID#1), & if it is, it could be part of a robe or hair? (could also be shell fossilised (suppose). Suggestion is that it is actually a decorative piece perhaps from above, part of a leaf? Slow dig so bagged fossilised shells (ID#2), also, a small piece of worked basalt from area just above the first layer of crushed limestone. Simultaneously a piece of glass with a hole in it (ID#3) emerged. Iron blob (ID#4) emerged at base of spit 2 along with a small bronze frag (#5) Broken nail (ID#6) found. Modern break into two pieces. A small amount of burnt bone and charcoal also emerging. Lamp frag. (ID#7) found in base rubble.
	NB. Will leave the remainder of locus 4 for Victoria in T19 to complete. We will probably move to the south into T22 or east into the area outside the foundation wall in the baulk adjoining T22.
	→ Zurkiya Abdullah Lassim shuggal Saate Jaiza.

mia-tez. excellent.  
 nehas - bronze





Area B Trench.....21.....Initials...EC.....Date...9/5/2009 Page...22

Locus...3.....Spit!..... Locus...5.....Spit!..... Feature/s.....

	No. of bags	Cont	Cont
Pottery	2	5/1	3/1
Bone	2	5/1	3/1
Charcoal	1	5/1	
Other (Tile)			
Photos bw			
Photos col.			

No.	Object	Cont	Cont
1	Iron (clamping?)	3/1	

Context Report

3/1	<ul style="list-style-type: none"> <li>Began removing material from eastern area between east-west blocks in southern bank.</li> <li>While some roof-tile was found it appears (along with some pottery) to have come from above.</li> <li>A small amount of bone found near wall.</li> <li>Piece of bent iron, possibly clamping (ID#1) found near wall, depth <math>\approx</math> 1m from top of wall.</li> </ul>
5/1	<ul style="list-style-type: none"> <li>Opened new locus in T22. (Locus 5) inside foundation walls. Primarily clearing loose fill to bedrock. Have to 'camber' the bank a bit to prevent the large stones from falling.</li> <li>Small charcoal and bone fragments found near bedrock.</li> <li>Very broken stones, some of which are very large. Two worked blocks found but forms part of the tumble, the other may be in situ.</li> </ul>

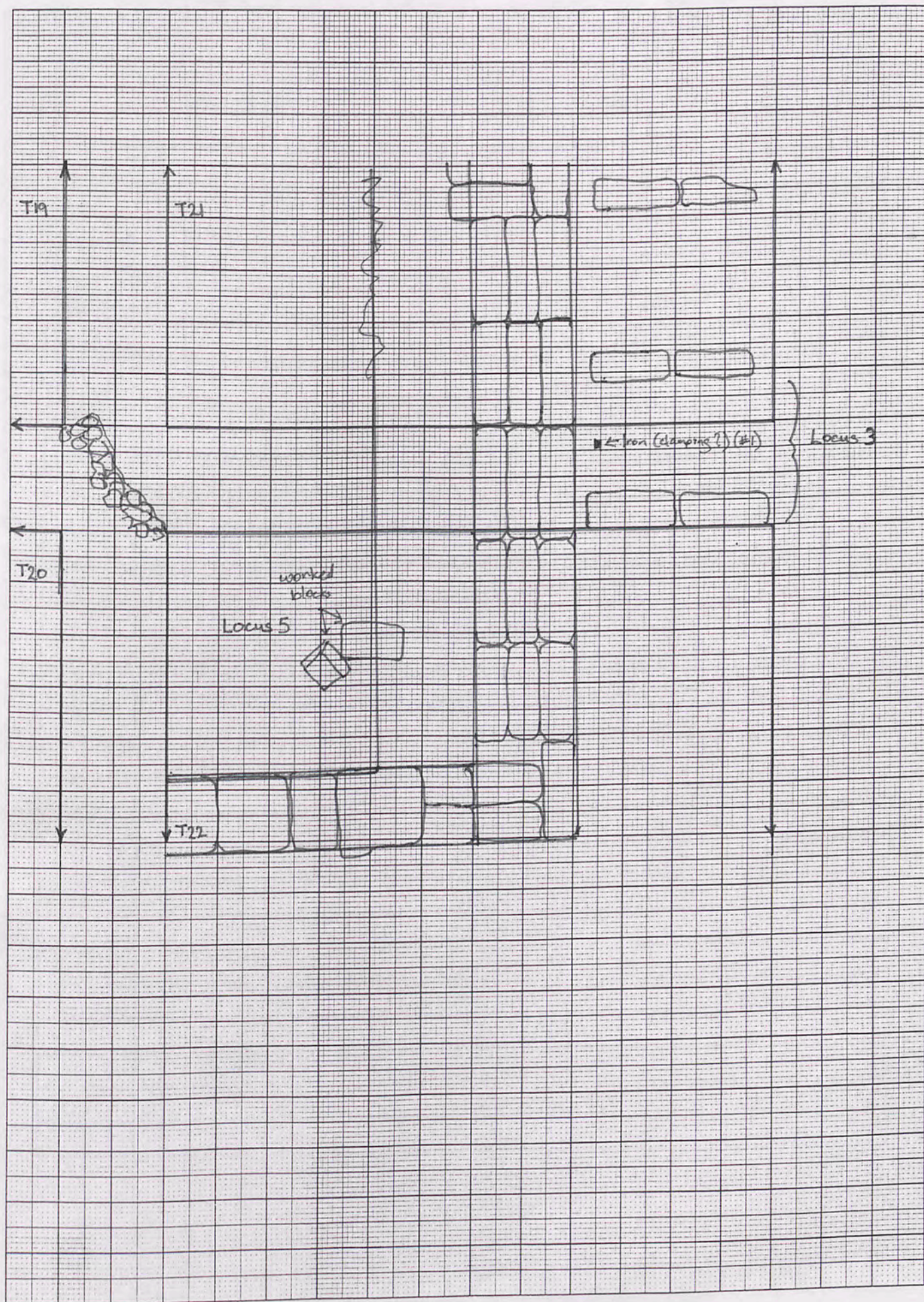























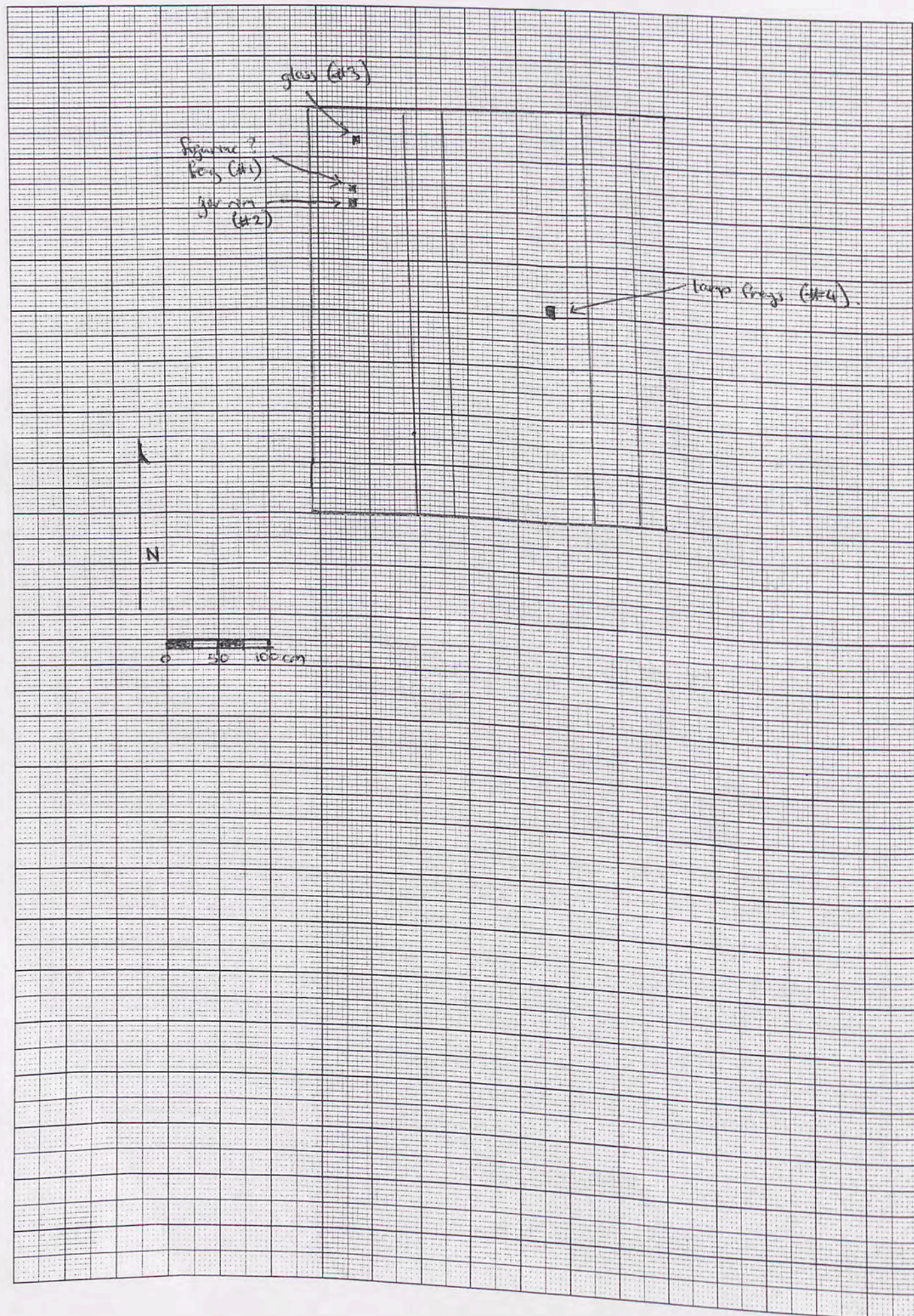

Area B Trench...23.....Initials...CC.....Date...15/9/2012 Page...4  
 Locus.....Spit...4..... Locus.....Spit..... Feature/s.....

	No. of bags	Cont	Cont
Pottery	1	1/4	
Bone	1	1/4	
Charcoal	1	1/4	
Other (Tile)	2 tile	fragments	from bank.
Photos bw			
Photos col.			

No.	Object	Cont	Cont
1	figurine? frags	1/4	
2	jar rim with possible residue	1/4	
3	glass rim	1/4	
4	3 lamps frags (conjoin)	1/4	

Context Report

Context	Report
1/4	<ul style="list-style-type: none"> <li>Continued spit 4; in comparison with the 3 large blocks remaining on the western side of the retaining wall, a fourth block to the north appears to be emerging. The reason why the retaining wall appears to be faced only on the eastern side is almost certainly a function of robbing, where the faced side on the west was removed when the blocks were removed.</li> <li>A possible figurine frag. (ID#1) and jar rim with potential residue (ID#2) found in northern end in the area where the foundation blocks are missing.</li> <li>Area between the retaining wall and eastern blocks contains with tightly packed crushed limestone.</li> <li>Clearing down to bedrock on western side. No further blocks emerging in all robbing.</li> <li>A large broken block amongst the rubble on the western side, ex situ, 1 complete dimension of 570mm.</li> <li>A fragment of glass (rim) (ID#3) found in robbed area.</li> <li>3 conjoining lamp frags (ID#4) found between the retaining wall and the blocks to the east. There appear to be several lenses of dense clay with some bone + pottery (including the lamp frags) within one of these. The clay + chipped limestone wadules regularly at <math>\approx 1.5</math> m intervals, approximately in line with the east west blocks jutting out from foundation wall in T21.</li> </ul>



Area B Trench 23 Initials EC Date 16/5/2002 Page 5  
 Locus 3 Spit 1 Locus 2 Spit 1 Feature/s

	No. of bags	Cont	Cont
Pottery		3/1	
Bone		3/1	
Charcoal			
Other (Tile)			
Photos bw			
Photos col.			

No.	Object	Cont	Cont
1	Iron Nail	3/1	
2	Iron Nail	3/1	
3	Quartzite whetstone	2/1	
4	Shell	2/1	
5	Lamp frag?	3/2	
6	Bronze frags	2/1	
7	Broken Nail	3/2	
8	Lamp frag	2/1	
9	Lamp frag	3/1	

Context Report

Context	Report
2/1	<ul style="list-style-type: none"> <li>Area <del>is</del> east of retaining wall and line of blocks is designated as locus 2. While this is actually spit 5 (starting at depth of 1000mm from height of blocks) began numbering from 1.</li> <li>Quartzite whetstone (ID#3) fragment found in centre of locus, along with a piece of worked basalt and a shell fragment (ID#4)</li> <li>3 small broken bronze frags (ID#6) found in centre of locus.</li> <li>Lamp frag (ID#2) found in pottery.</li> </ul>
3/1	<ul style="list-style-type: none"> <li>Expanded trench 1m to the east as the remaining area between the blocks and the side of the trench was too narrow to work deeply in. Moved some blocks out of trench. It is hoped that this area will encounter some remains of the spherule (N/S).</li> <li>An iron nail (bar) (ID#1) found 1m from western end. A very large amount of very mixed pottery emerging along with bone. Another nail from same location (ID#2)</li> </ul>
3/2	<ul style="list-style-type: none"> <li>Spit 2 continues with very loamy soil with very mixed pottery and bone. A possible lamp frag (ID#5) found in centre of locus.</li> <li>Lamp frag (ID#9) found in pottery.</li> </ul>

pen : III  
 nibs : IIIII  
 cigarettes : 1 doken  
 red nail polish hammer.  
 5 sheets green s.  
 8 blinet.

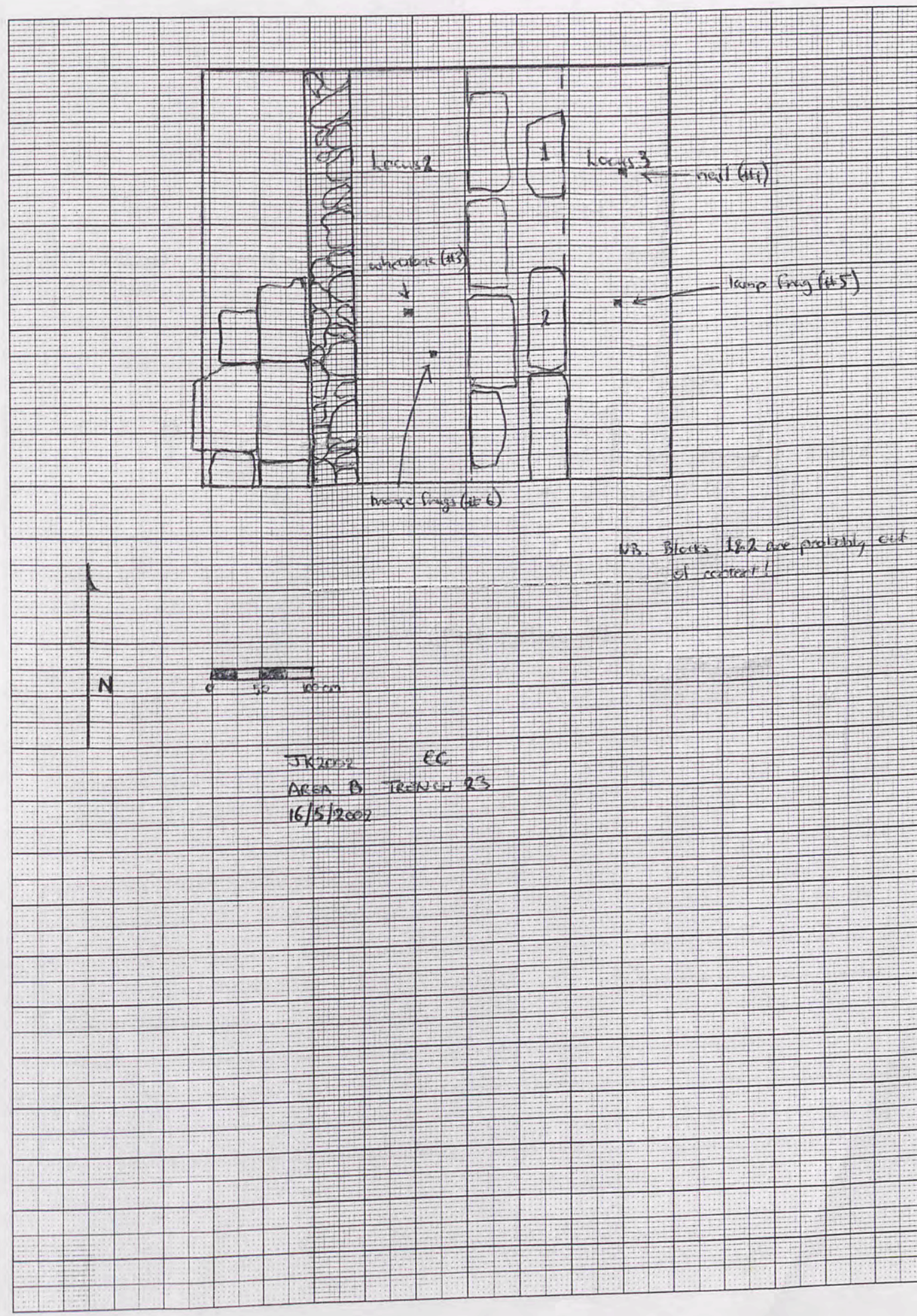



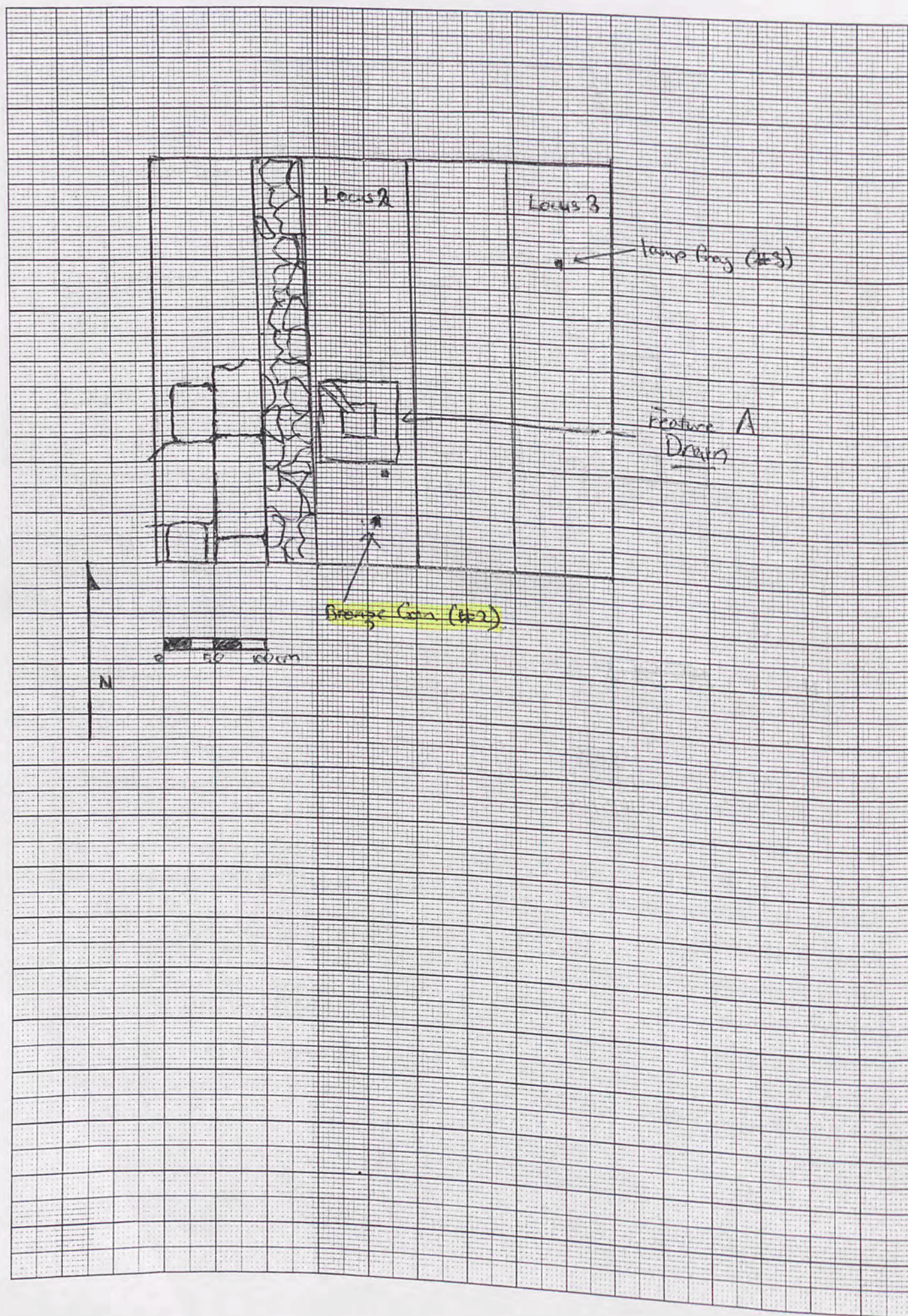

Area B Trench... 23..... Initials... CC..... Date... 12/5/2002 Page... 6  
 Locus... 2..... Spit... 2..... Locus... 3..... Spit... 3... Feature/s... A (Drain)

	No. of bags	Cont	Cont
Pottery	5	3/3, 3/4	2/2, 2/3, 2/3
Bone	4	2/3, 2/4	2/2, 2/3
Charcoal	4	2/3, 3/4	2/2, 2/3
Other (Tile)			
Photos bw			
Photos col.			

No.	Object	Cont	Cont
1	Bronze frag.	2/2	
2	Bronze coin	2/2	
3	Lamp frag	3/4	02559
4	Iron blob	2/3	3/4

Context Report

Context	Report
2/2	Continue trenching between retaining wall and line of blocks on the surface. Deposit has ceased being limestone rubble and is now dominated by just brown soil. A small bronze frag (ID#1) found in remnant of soil from this spit. Small thick bronze coin found 40cm from southern end, depth 105mm (ID#2) from top of retaining wall.
2/3	Began spit 3 depth $\approx$ 1050 mm from top of retaining wall, some large stones emerging in the soil. A "drain" emerges in centre of locus with pottery and bone $\Rightarrow$ Labelled Feature A. Soil sample to 20cm taken. There appears to be stones lying at the base of the drain, however these may not be deliberately placed.
3/3	Continue trenching east of the line of blocks. Deposit continues to be soil with very broken pottery and bone (700mm from top of blocks)
3/4	Much the same as spit 3, but breaking through a very dense clay layer. Spit begins 860mm from top of blocks. Lamp frag (ID#3) found at depth 900mm.
A Great Deal of wind today following last night's terrific lightning storm. Tobacco for Ahmed	



Area B Trench.....<sup>23</sup>.....Initials.....<sup>CC</sup>.....Date.....<sup>11/10/02</sup>.....Page...<sup>7</sup>  
 Locus.....<sup>2</sup>.....Spit.....<sup>4</sup>..... Locus.....<sup>3</sup>.....Spit.....<sup>4</sup>..... Feature/s.....

	No. of bags	Cont	Cont
Pottery		3/4, 3/5	3/6, 2/4
Bone		3/4, 3/5	3/6, 2/4
Charcoal		3/4, 3/5	2/4
Other (Tile)			
Photos bw			
Photos col.			

No.	Object	Cont	Cont
1	Stone artefacts	3/5	
2	bgw pottery?	2/4	
3	Lamp Frag	2/4	
4	Fig Frag	2/4	
5	lamp frag	<del>2/4</del>	3/4

Context Report

Context	Report
2/4	<ul style="list-style-type: none"> <li>Begin new spit working around drain feature</li> <li>A strange looking piece of bgw found south of drain</li> <li>Pedrock? encountered 1400mm from top of retaining wall in southern area.</li> <li>Very flat, could be a block? or a stone floor?</li> <li>Lamp (#3) and Fig (#4) frags found in pottery, as with #5.</li> </ul>
3/4	<ul style="list-style-type: none"> <li>Continue to remove mixed pottery and overlying clay layer. Cleared to clay layer.</li> <li>Depth 1000mm from northern end and 500mm from southern end - lamp frag found in pottery (#5)</li> </ul>
3/5	<ul style="list-style-type: none"> <li>Began cutting through clay layer, which is very hard.</li> <li>Decided to section the locus in half and just worked in the southern area as the clay is very hard, and is almost certainly a floor.</li> <li>A stone artefact (flake) (ID#1) found at depth 600mm.</li> <li>Another floor level at depth 900mm from southern end located.</li> </ul>
3/6	<ul style="list-style-type: none"> <li>Began spit 6 at this floor, sectioning trench again and working in the southern 700mm.</li> </ul>

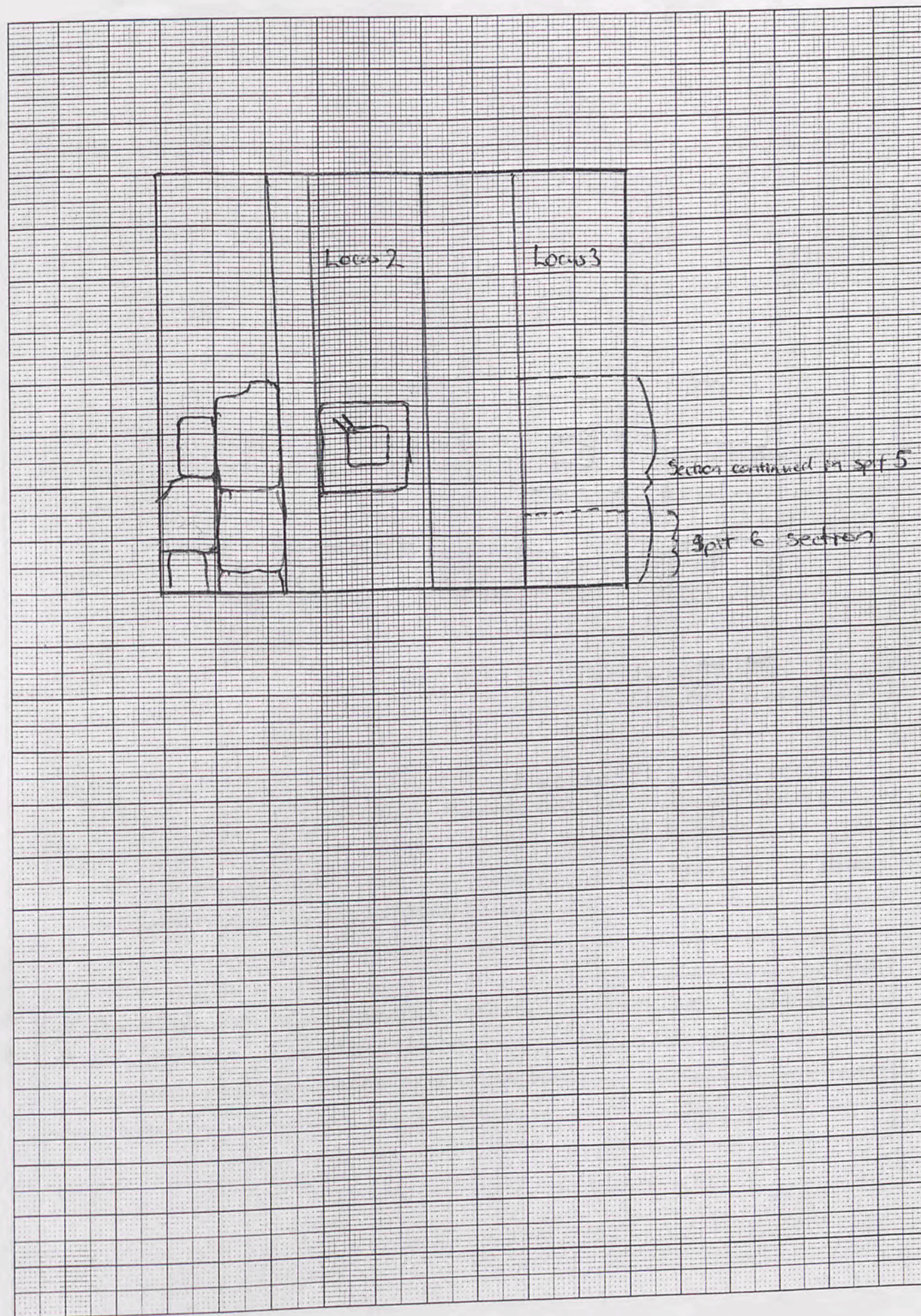



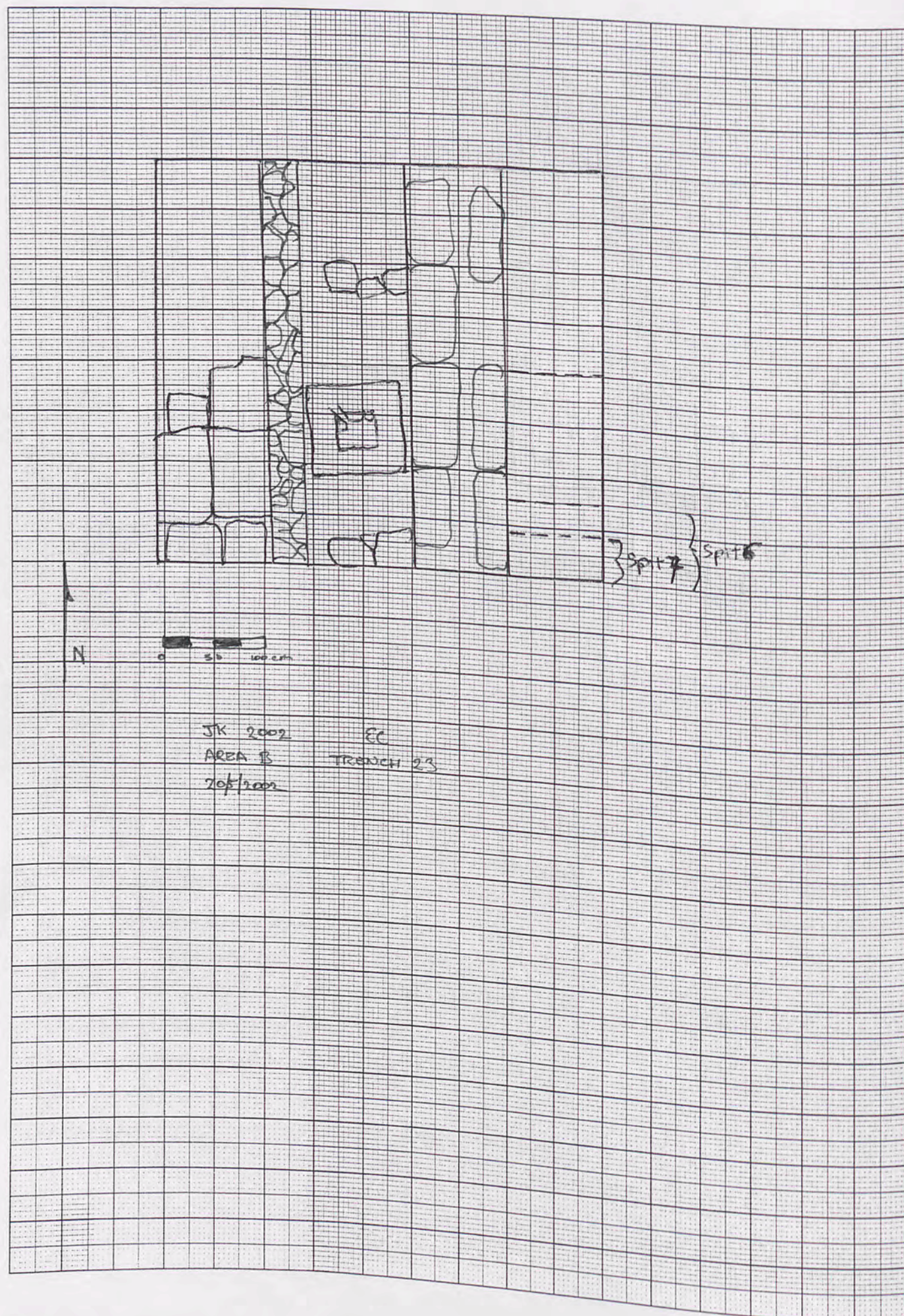

Area B Trench 23 Initials EC Date 20/1/02 Page 5

Locus 3 Spit 6 Locus 2 Spit 5 Feature/s  
+ 3/7

	No. of bags	Cont	Cont
Pottery	2	3/6	2/5
Bone	2	3/6	2/5
Charcoal	1	3/6	
Other (Tile)			
Photos bw	BW13 B20	25-29	
Photos col.			

No.	Object	Cont	Cont
251	Fig frag	2/5	

Context Report

3/6	<ul style="list-style-type: none"> <li>Cleared to another floor/very hard packed clay level (1200mm down from eastern side). Lots of very mixed pottery emerging.</li> </ul>
3/7	<ul style="list-style-type: none"> <li>Sectioned locus to trench further and on now existing in southern 40cm. We will try and take this to bedrock if possible, but with only tomorrow to dig and then Wednesday to clean we may not be able to.</li> <li>We've encountered very hard cracked/crumbled limestone packing which presumably overlies bedrock.</li> <li>Unable to trench to bedrock due to time constraints and will now begin removal of the bank between B20 and B22.</li> </ul>
2/5	<ul style="list-style-type: none"> <li>What appeared to be bedrock is just a very hard clay floor level, upon which the blocks for the drain lie. We will leave this floor to the south of the drain and work on in the north.</li> <li>Fig frag. (10cm) found in pottery.</li> </ul>
Note!	<p>It is likely that the <u>hard floor levels in locus 3</u> are from the time of construction, i.e. a staging/working floors, <u>before the body of the temple was built, and then the frontage was put in place.</u></p>



















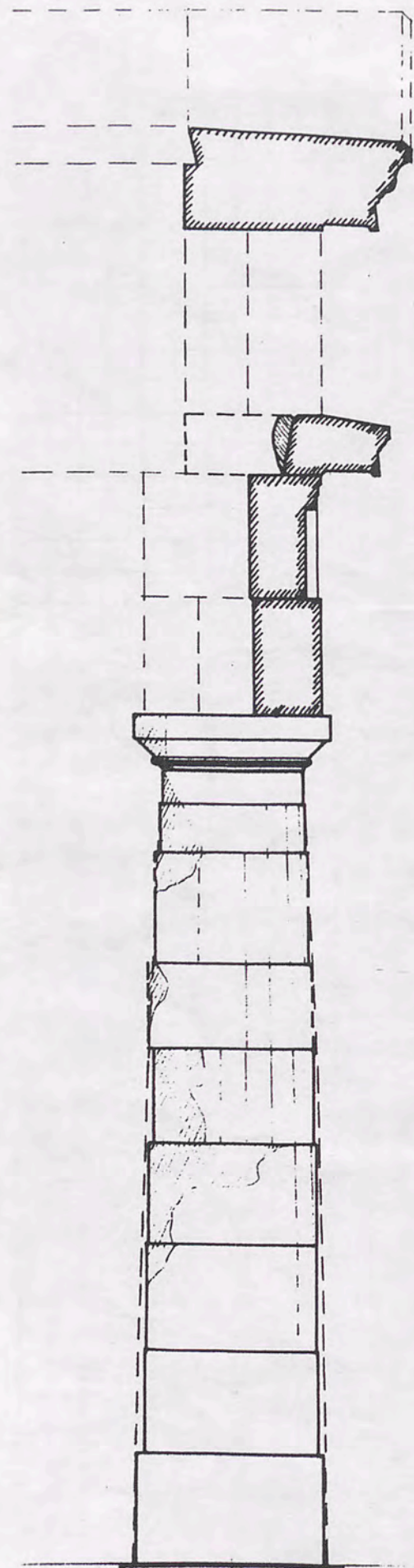

SECTION

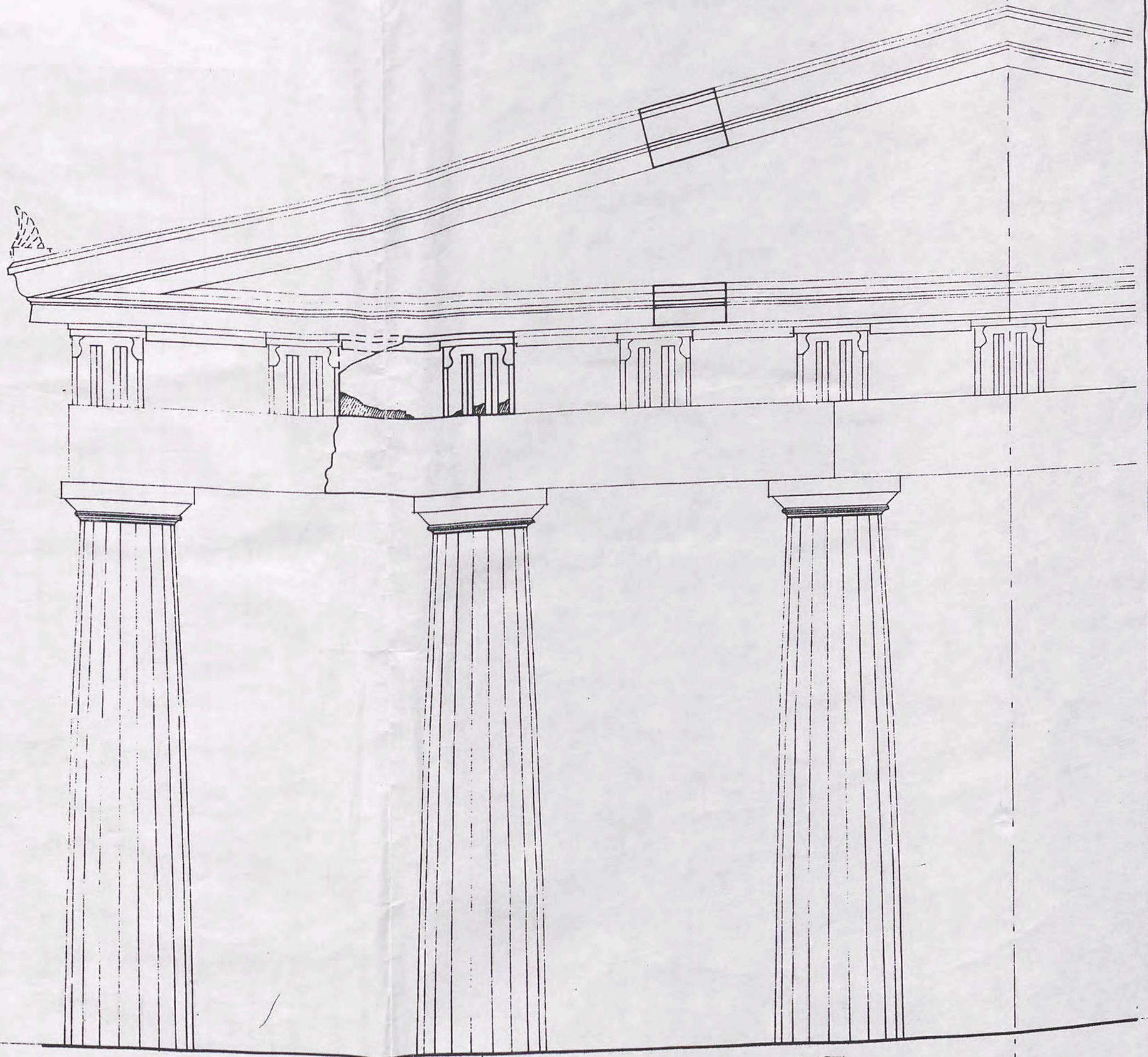

ELEVATION ~ RECONSTRUCTION

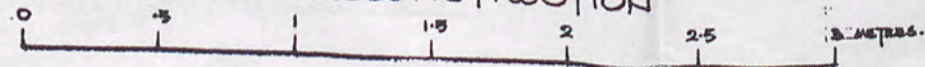

AREA B JEBEL KHALID

AUGUST 2000



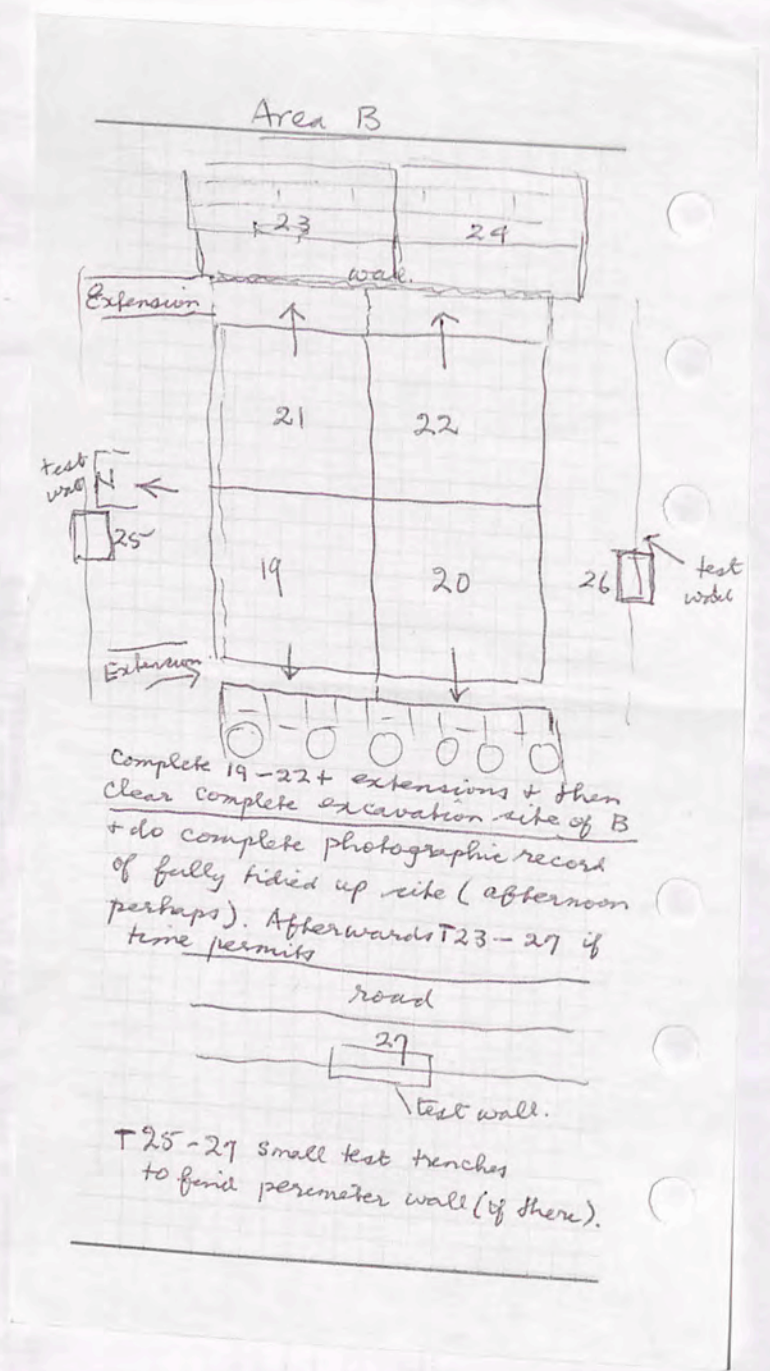

Complete 19-22 + extensions + then  
 clear complete excavation site of B  
 + do complete photographic record  
 of fully tidied up site (afternoon  
 perhaps). Afterwards T23-27 if  
 time permits

T25-27 small test trenches  
 to find perimeter wall (if there).

HUMANITIES RESEARCH CENTRE  
 THE AUSTRALIAN NATIONAL UNIVERSITY  
 GPO BOX 4, CANBERRA ACT 2601 AUSTRALIA  
 TELEPHONE (06) 249 2700, FAX (06) 248 0054

Thanks, Ed, for taking  
 over the direction of  
 "Area B" & have a good  
 day on your birthday.

Much love  
 X Dad X



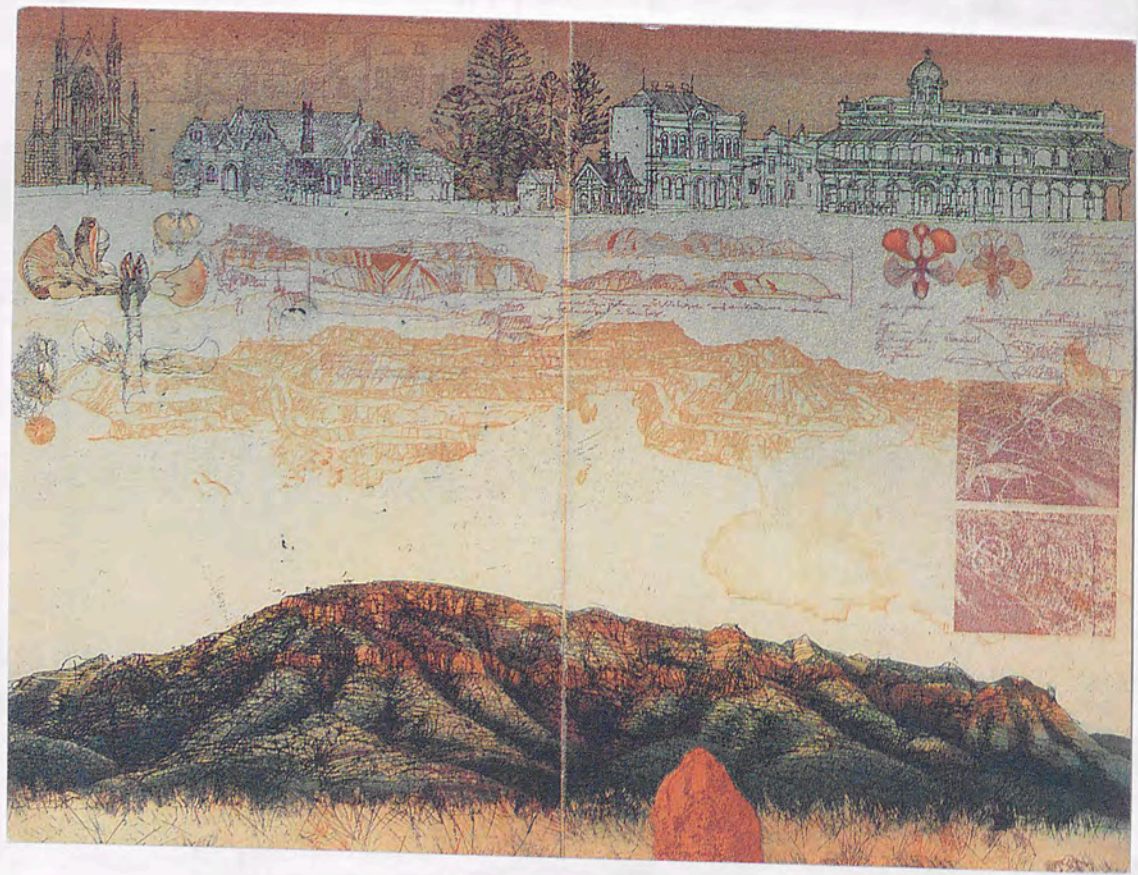
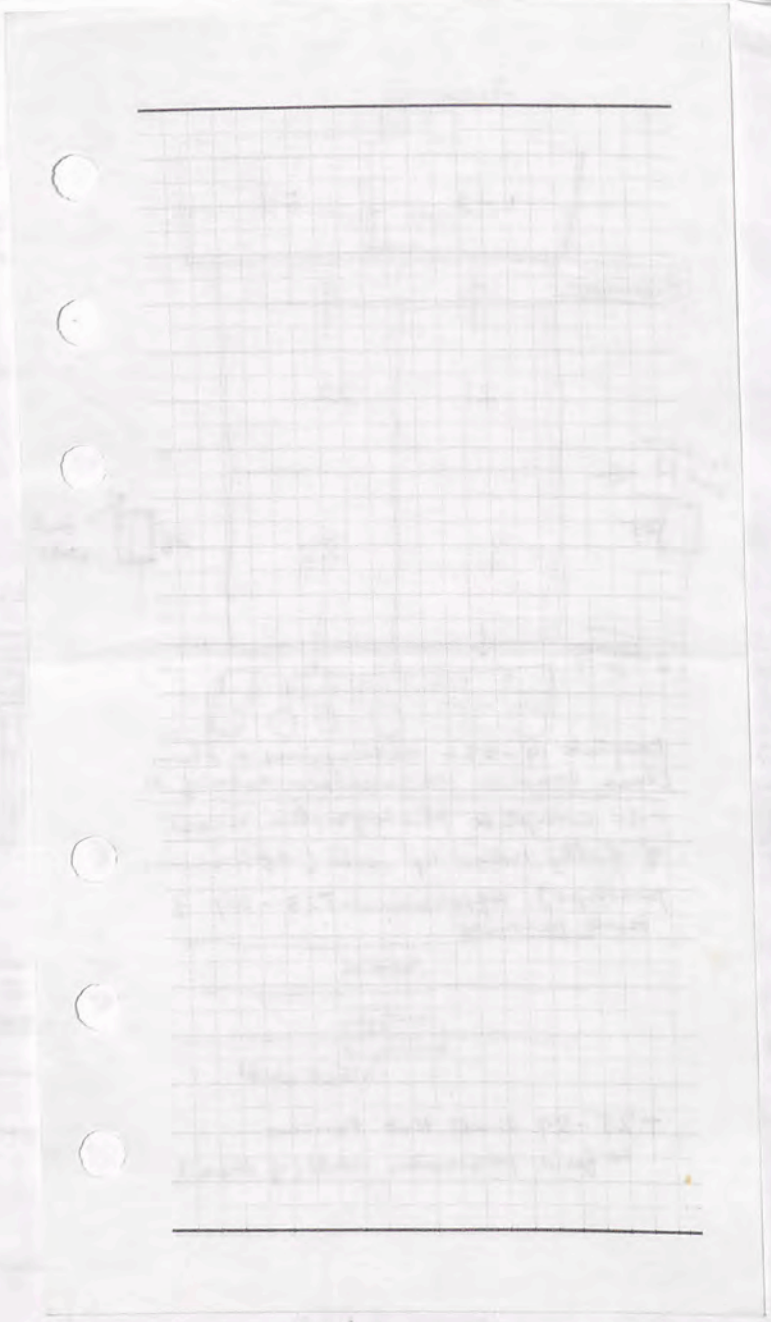



Faint, illegible text, possibly a list or index, located in the upper portion of the left page. The text is arranged in several columns and is mostly obscured by fading and the texture of the paper.

