

Bauk 100/1,4
 Trench: 25/3,6 Initials: R.S. Date: 27/5/01 Page: 91
 Locus: Spit: Locus: Spit: Feature/s:

	No. of bags	Cont	Cont
Pottery	2	1:1	
Bone			
Charcoal			
Other (Tile)			
Photos bw			
Photos col.			

No.	Object	Cont	Cont
4	Nail Frag	1:1	

Context Report

Context	Report
1:1 (east side of wall 100/4)	Continued removal of bank on east side of wall dividing trenches 100/1 & 100/4. Soil clump pale brown. Nail frag found during excavation. Ashy deposit discovered (position located on plan) against the wall & at the same level as the floor in the north of trench 100/1 - cm. As excavation continues it is becoming apparent that there are two lines of parallel rocks - the wall that we were searching the bank for & immediately to the east & lower down a series of large rocks. Re-inforcement? Primary wall? It appears as though a gap in the wall is emerging in the north - doorway?

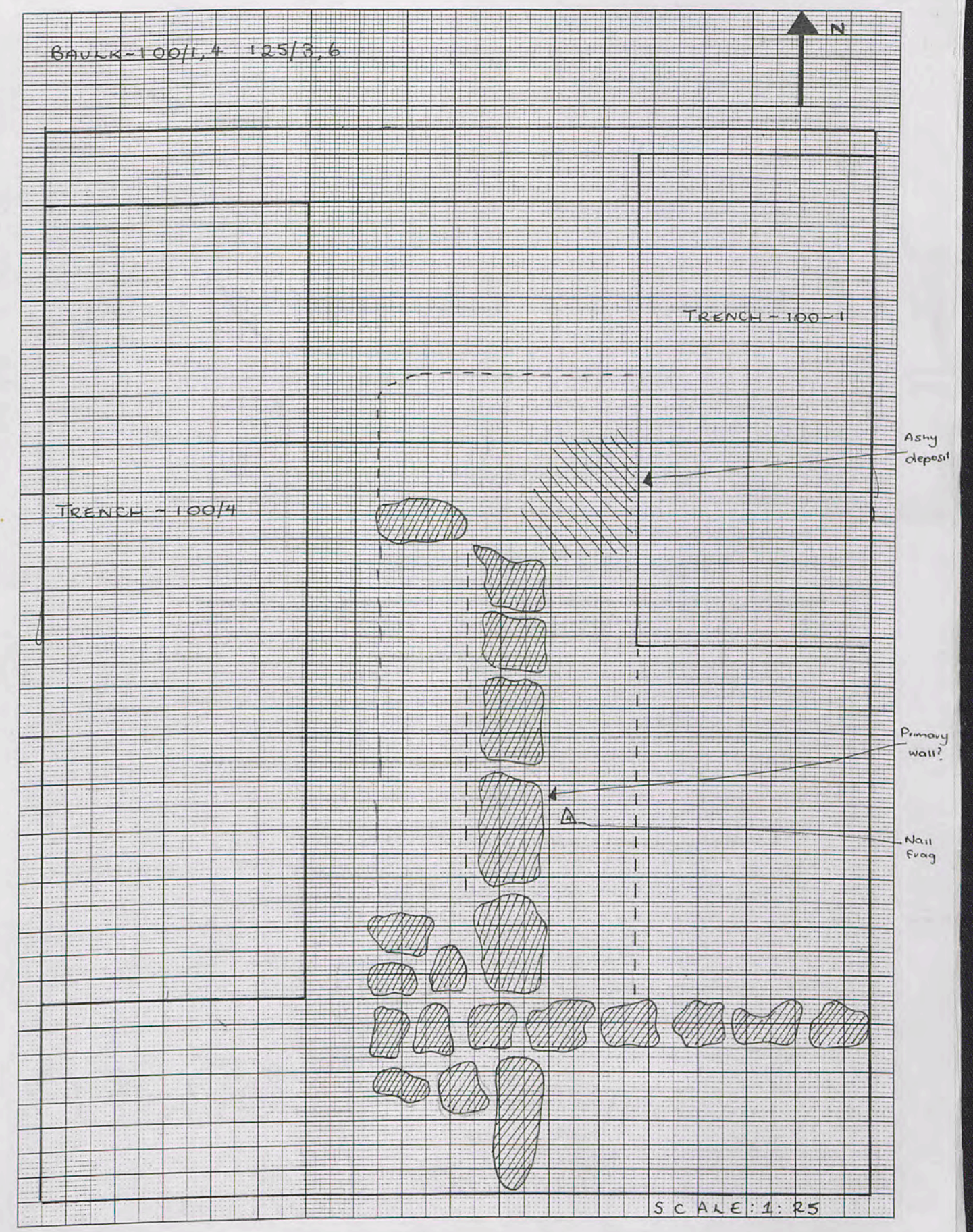

1 or 8aukL

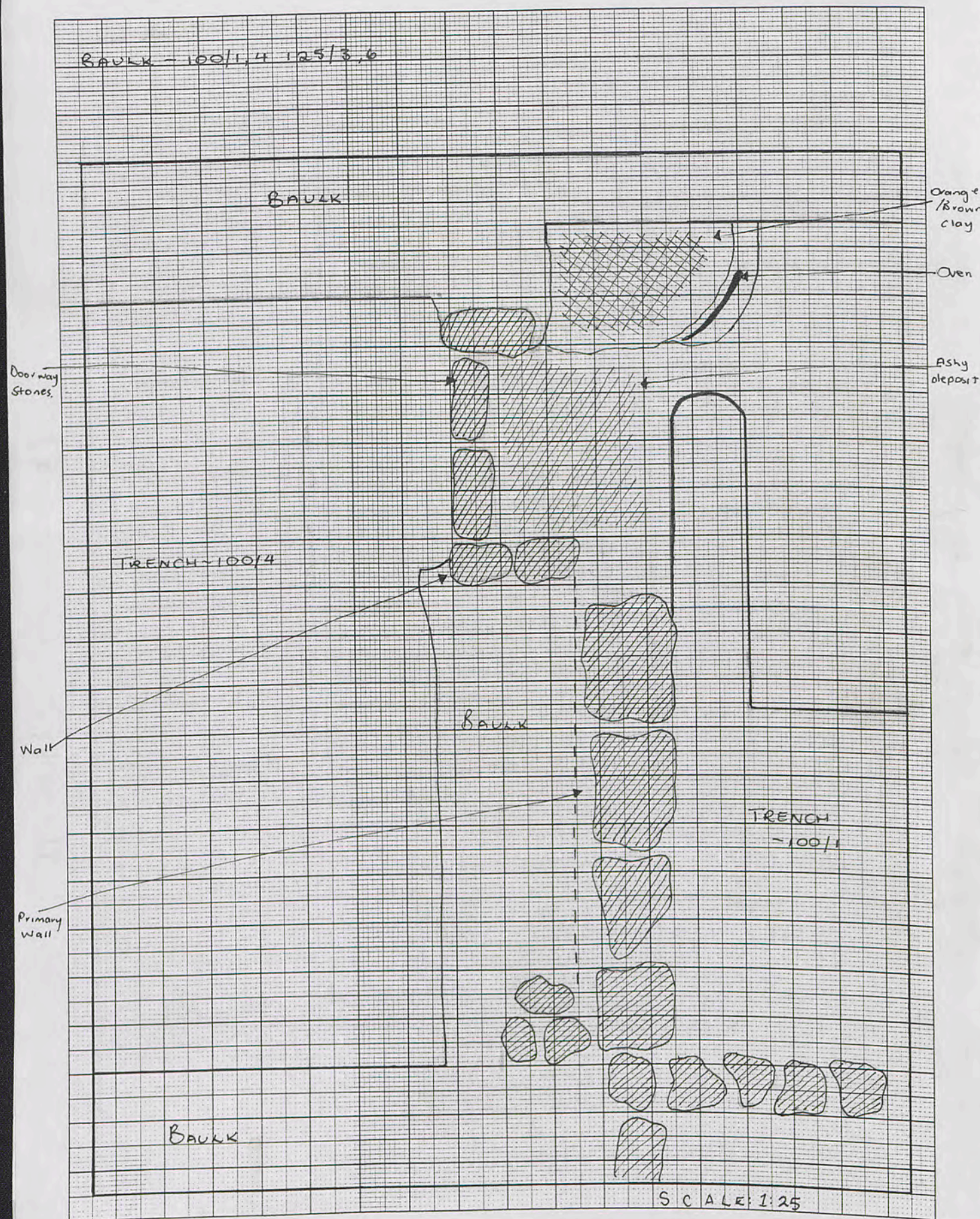

Trench ^{125/3,6} 100/1,4 Initials... Date 8/5/01 Page 94
 Locus... Spit... Locus... Spit... Feature/s...

	No. of bags	Cont	Cont
Pottery	1	1:1	
Bone			
Charcoal			
Other (Tile)			
Photos bw	15/15-16		
Photos col.	cs 5/33		

No.	Object	Cont	Cont

Context Report

1:1 Baulk excavation continuing. Work concentrating around doorway discovered yesterday. Doorway space between trenches 100/1 & 100/4 cleared entirely. Large ashy deposit present in the east side of the doorway.

Further excavation in the north/south baulk has revealed the presence of an oven in the NW corner of 100/1. The oven, the remnants of which are clearly visible has been covered with rocks which appear deliberately placed. Interestingly on top of the rock an orange/brown clay layer, associated with ovens was found. At this stage the decision has been made not to clear the rock covering the oven structure. Hopefully though time will permit later excavation. It would be interesting to try & determine why the oven may have been covered up. It is possible that another oven may have been built on top of the rock shelf.

Heights associated to baulk (in cm) (not to scale)

→ N

(all heights are to the top of adjacent wall or baulk)

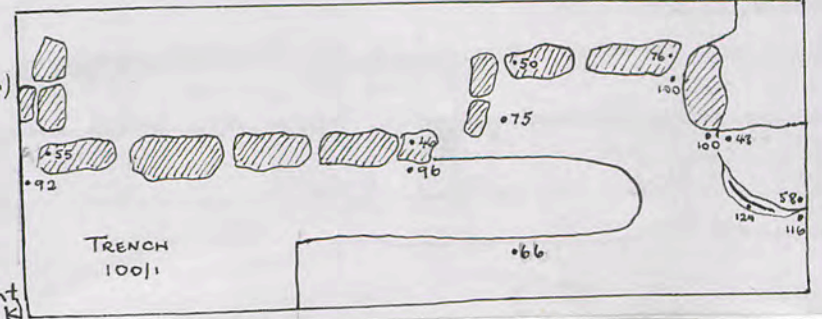

Trench ^{125/3} 100/1 Initials...RD... Date 28/5/01 Page 95
 Locus.....Spit..... Locus.....Spit..... Feature/s.....

	No. of bags	Cont	Cont
Pottery	1	1:1	
Bone			
Charcoal			
Other (Tile)			
Photos bw			
Photos col.			

No.	Object	Cont	Cont

Context Report

1:1	Excavation of a new baulk area begun. Hoping to gain a clearer view of the doorway if indeed it is a door. Well, it would appear as though the doorway idea was, unfortunately, up a wattle. It is in fact a drain. This may prove to be the shortest excavation of the dig.
	HJ. NOT a drain. Photograph shows clearly that it is a doorway, albeit badly eroded.
	Unfortunately the step of the door was interpreted as a drain. Door close against this. The square socket in the southern doorpost clearly indicates a doorway.
	Must remember to get proper dimensions next year: 150cm wide?

Reconstruction

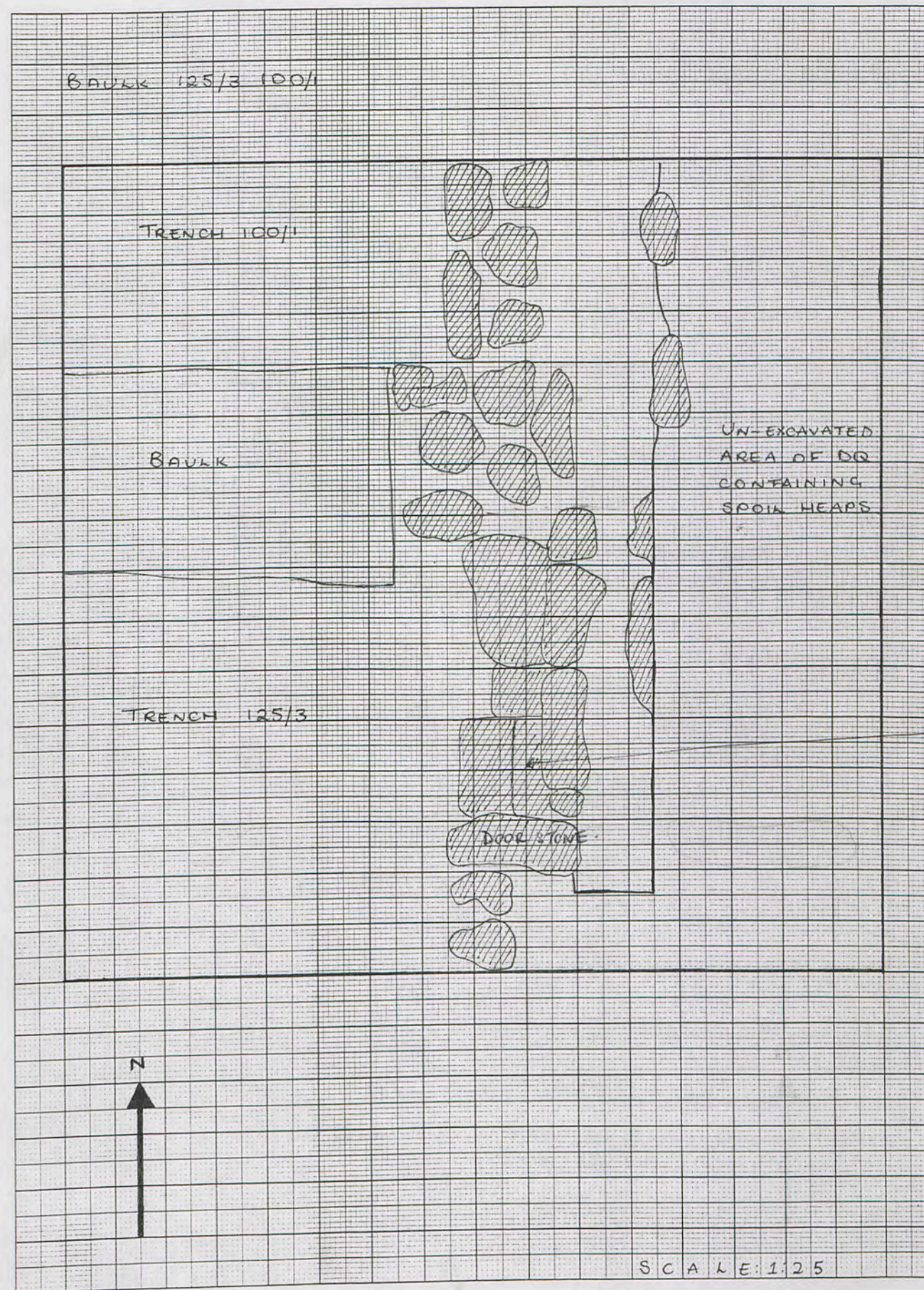
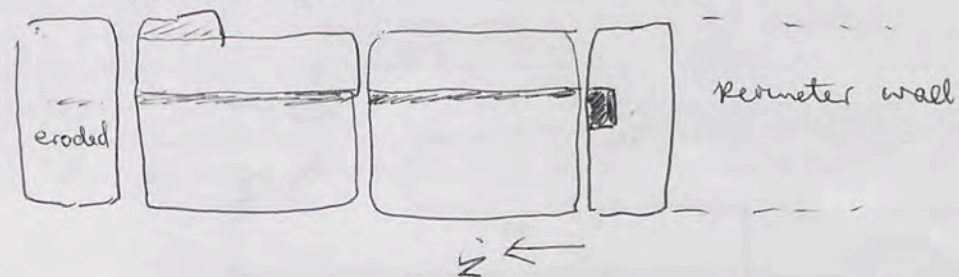

No!

Step

Trench.....99/7.8.....Initials..RD.....Date.29/5/01 Page...99

Locus.....Spit..... Locus.....Spit..... Feature/s.....

	No. of bags	Cont	Cont
Pottery	1	1:1	
Bone			
Charcoal			
Other (Tile)			
Photos bw			
Photos col.			

No.	Object	Cont	Cont

Context Report

Context	Report
1:1	More baulk excavation begun. This time in the east side of DQ. The search is on once again for a doorway. A large vertical stone is already clearly evident. But as proven the case in the past you can never really tell until you dig about.
	As excavation continues the doorway stone is becoming clearer.

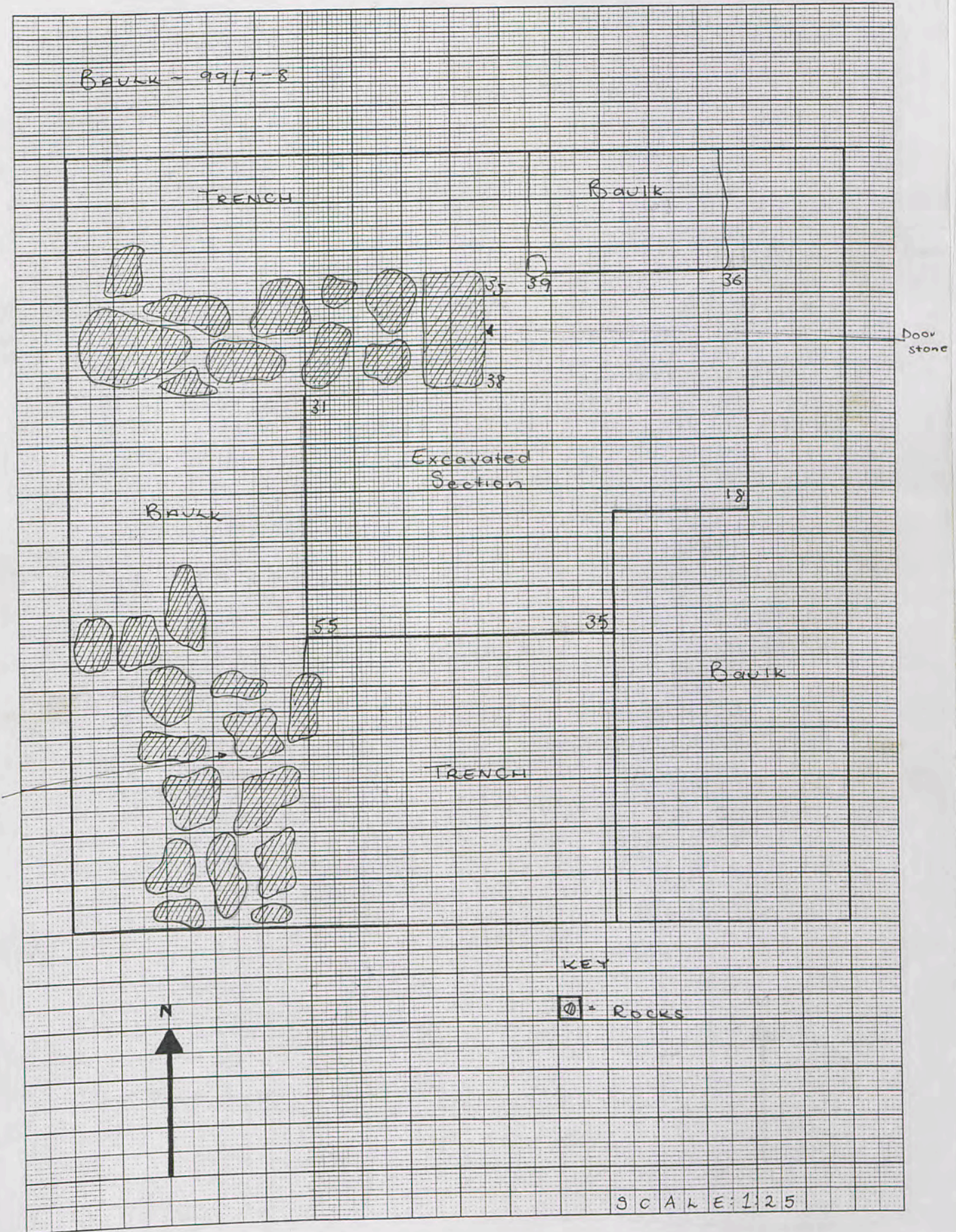

135
139

