



Trench cleaning NB wrongly labelled 150/2 No, 150/2  
 = 151/2. In nos to be changed  
 Trench 150/2 Initials HS Date 29/4 Page 1 2 days only  
 Locus 10 Spit 1 Locus Spit Feature/s LS 2000

	No. of bags	Cont	Cont
Pottery	1	10	1
Bone	1	10	2
Charcoal			
Other (Tile)			
Photos bw			
Photos col.			

No.	Object	Cont	Cont
1	iron	10	1
2	bronze piece	10	1
3	figurine piece	10	1
4	iron fragment	10	2
5	bronze fragment	10	2
6	red plaster	10	2
-	glass fragment	surface find.	

locus commenced at 10 to define new excavation of trench.

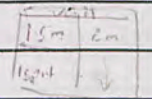
Context Report

7:15	Trench currently cleared to 3 different levels 
*	iron fragment approx 6cm long with groove running full length. NE corner soil clearance. NE quarter appears to have been originally cleared to bedrock. Minimal pottery in soil - from bank collapse?
*	Small bronze frag  10.1
	(A) bank showing large dark (ish) layer. Area E side of trench cleared, area B to be worked down to ash layer 30cm from current excavation level.
*	Figurine fragment - most of face. 4cm diam. (B) Found 100cm from back 80cm from E. 1m depth.
	Large amount of bone - some burnt coming from 10.1 soil layer in SE quarter of trench. Most very fragmentary. 1 well preserved / burnt finer fragments?
	Wall becoming evident parallel with 5th bank - extension of wall from 5th 151/8.
*	red plaster found against 5th wall





Trench 150/2 Initials LS Date 30/4 Page 2  
 Locus 10 Spit 3 Locus 11 Spit 1 Feature/s.....

	No. of bags	Cont	Cont
Pottery			
Bone			
Charcoal			
Other (Tile)			
Photos bw			
Photos col.			

No.	Object	Cont	Cont
1	shell (burnt?)	10	3
2	glass	11	1
3	bronze	11	1
4	glass small fragment	11	1
5	glass	11	1
6	glass splinters	11	1
7	bronze fragment	11	1

Context Report

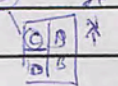
6:00	3rd spit of 150/2 locus 10.
*	SE corner - (burnt shell) against wall 10-7
	soil very dark + wet making it difficult to identify pottery + bone. Hitting bedrock from centre to NW part of trench in 10-3.
-	clearing area (C) of tumble from bank - 1 piece of black glass? 
	on clearance of soil from 10-3 - looks like a layer of yellow/orange clay against/in wall at SW of trench - original fill or washed in? No sign of plaster attached to wall. Wall level is below floor levels.
8:00	commenced locus 11 (C) NW quarter of trench.
	specie of bronze in 11-1
*	small pieces of crushed glass SE corner 11-1 pieces not big enough to be very useful. bagged but may not be accessioned/Inventoried.
*	bronze piece - twisted bronze wire? jewelry

LYLE 2000

125/1

Trench BANK Initials LS Date 21/4/00 Page 1  
 Locus 1 Spit 1 Locus 2 Spit 1 Feature/s.....

	No. of bags	Cont	Cont
Pottery	3		
Bone	3		
Charcoal	-		
Other (Tile)	-		
Photos bw	Bw1	frames 7	8
Photos col.	-	-	-

No.	Object	Cont	Cont
1	na.1	2-1	
2	glass	2-2	

Context Report

1-1	clearing E bank @ point of 205/5-6 bank.
2-1	large fragments of burnt at @ point of bank.
*	na.1
2-1-2-2	large amount of rubble - floor will probably not be found no evidence of floor in bank stratigraphy.
⊕	glass fragment 1.5m from W bank
2-2	floor evident in W corner - being excavated -> fairly broken up
	floor at 50cm from top of wall dividing 205/5-6 appears to be at same level as floor in 205/4-205/5 (SW) floor 20cm above floor to SW corner - extends full length of bank 205/5-205/6.
3-1	locus 3 - cutting from 1st to 2nd floor.
	large hole appearing in W bank 260cm from N wall.
*	photograph of floors - [Bw1 frame 7+8]















011 - white layer -  
chipped straw

1mm Squares

baulk section middle 206/2-3 baulk (2m)

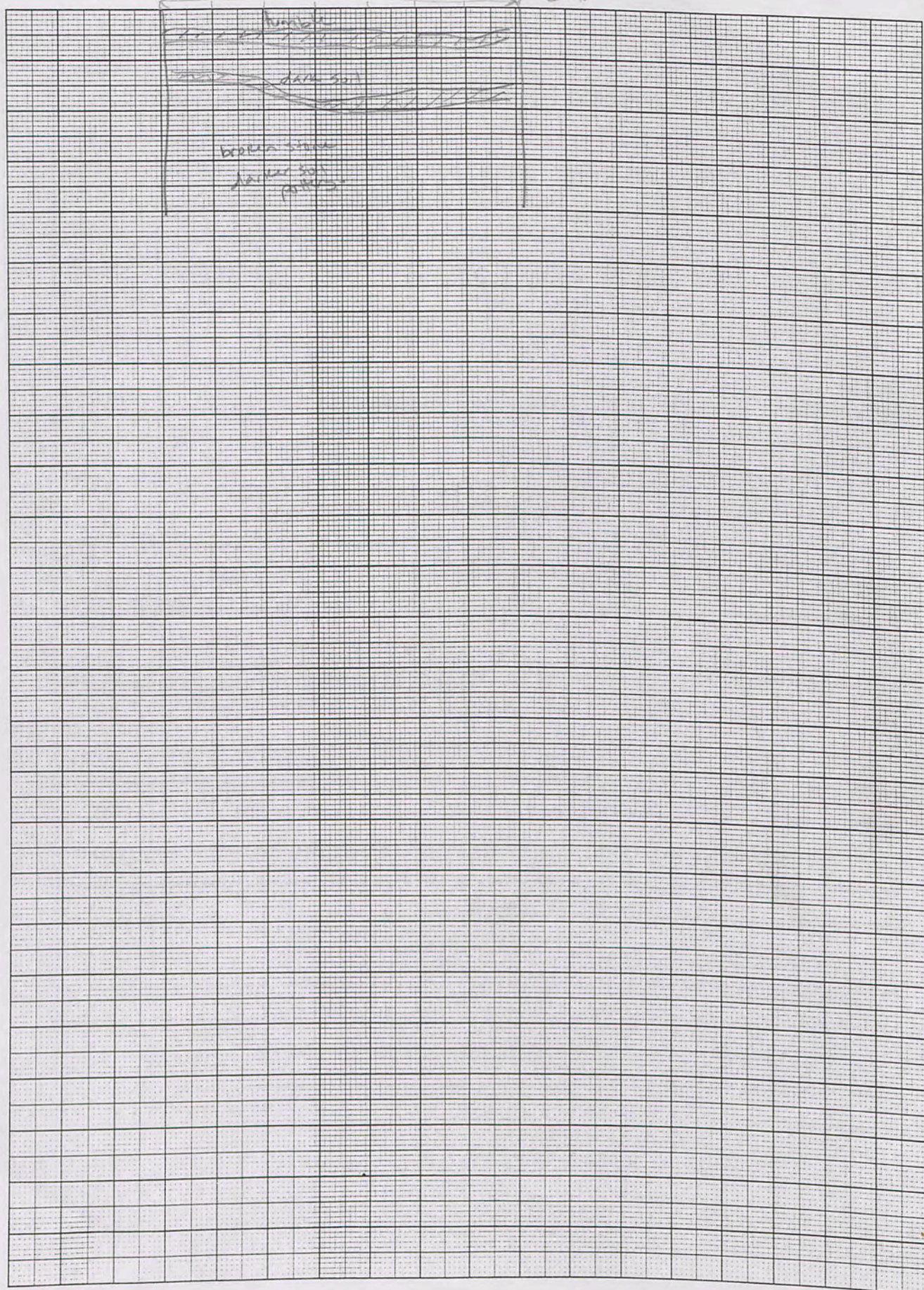

baulk

Trench 205/2-3 Initials L.S. Date 26/4 Page

Locus B Spit 32 Locus B Spit 3 Feature/s oven

	No. of bags	Cont	Cont
Pottery			
Bone			
Charcoal			
Other (Tile)			
Photos bw	BW1	17	oven
Photos col.		18 19	

No.	Object	Cont	Cont
1	lamp fragment	B	B2
2	large nail/iron magnesian oval frags	B	2
3	pan playing pipes	B	2
4	worked flint	B	2

Context Report

Turn 10

* 6:50	First piece of pottery this morning was the lamp fragment! found next to where bronze fragment found yesterday. Wall along with side of baulk seems better constructed than that in 205/5-6 - though is same wall.
* 6:50	large piece of iron + bone found in darker soil level approx middle of baulk. Soil layer appears to be quite deep in this section - possibly an oven/cooking pit. continuing clearing at beginning of soil level - next spit will clear darker soil.
7:30	black glaze magnesian bowl frag - pan playing pipes on frag. found in top of dark soil layer. 2m from E wall.
8:30	at wall junction NE corner of baulk - found + oven 76cm in diameter. most of clay is very eroded - only SW/SE part of oven clay is well preserved. Photographed at 9:45.
B3	clearing contents of oven. Base of oven made from fired pottery - maybe roof tile. Approx 15cm of oven walls preserved above floor. 2 photos taken of cleared oven.

Most pottery from oven is collapsed oven wall. no bone in oven. wall frags bagged separately to pottery.







N ↑

1mm Squares

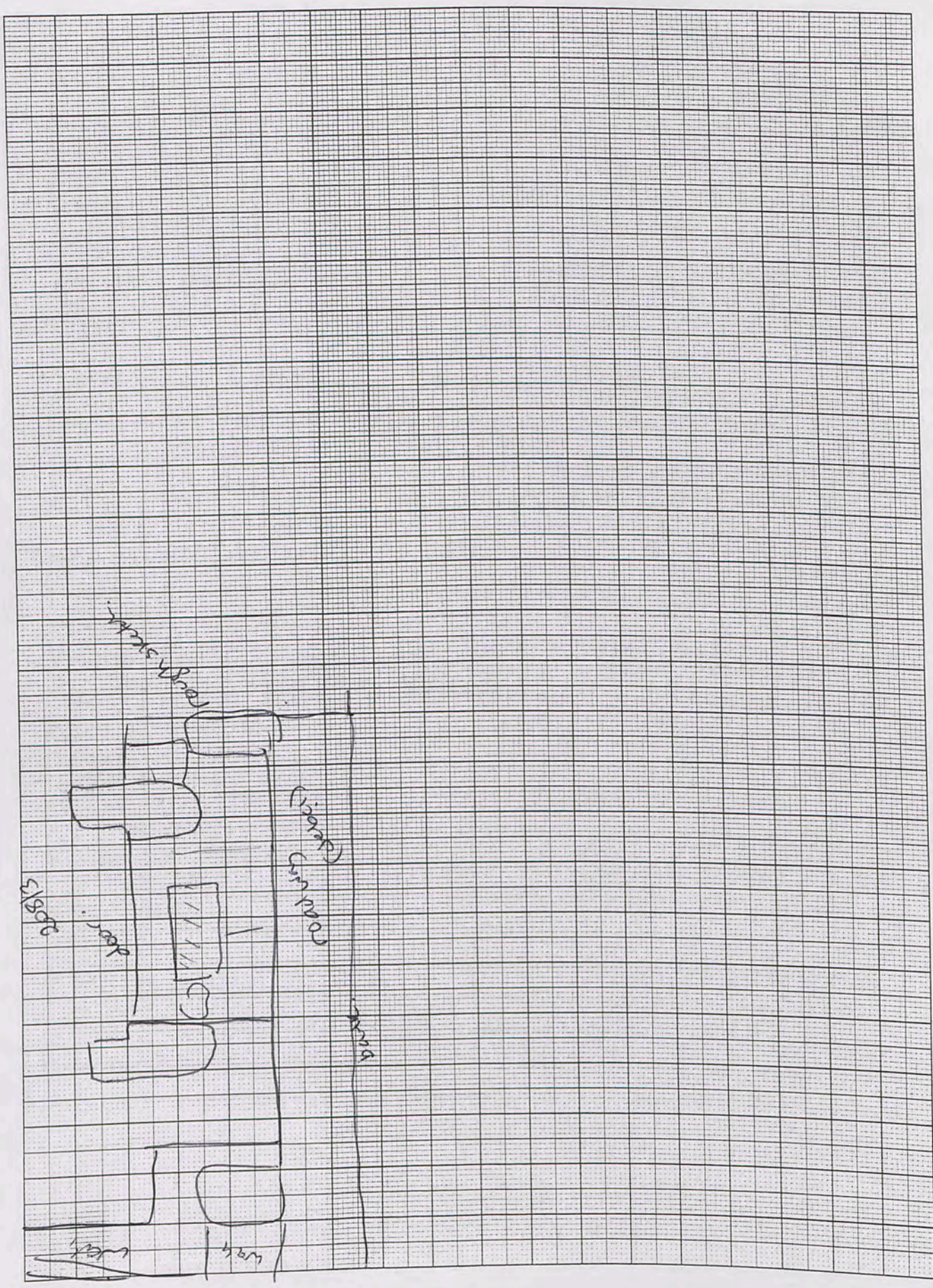

Trench <sup>door clearance</sup> C ..... Initials <sup>ws</sup> ..... Date 27/4/00 Page 1

Locus ..... Spit ..... Locus ..... Spit ..... Feature/s <sup>doorway</sup> .....

	No. of bags	Cont	Cont
Pottery			
Bone			
Charcoal			
Other (Tile)			
Photos bw	BW1	21 -	23
Photos col.			

No.	Object	Cont	Cont

Context Report

clearance of doorway in 208/3 - extended out to road in line with wall dividing 208/2-3. doorway flagstones finish - label / roadway starts photos taken of cleared doorway.

walls running N/S at doorway line up with end of flagstones / cut label.

Moving back to clear tertiary walls in 208/2 + 208/5

208/2











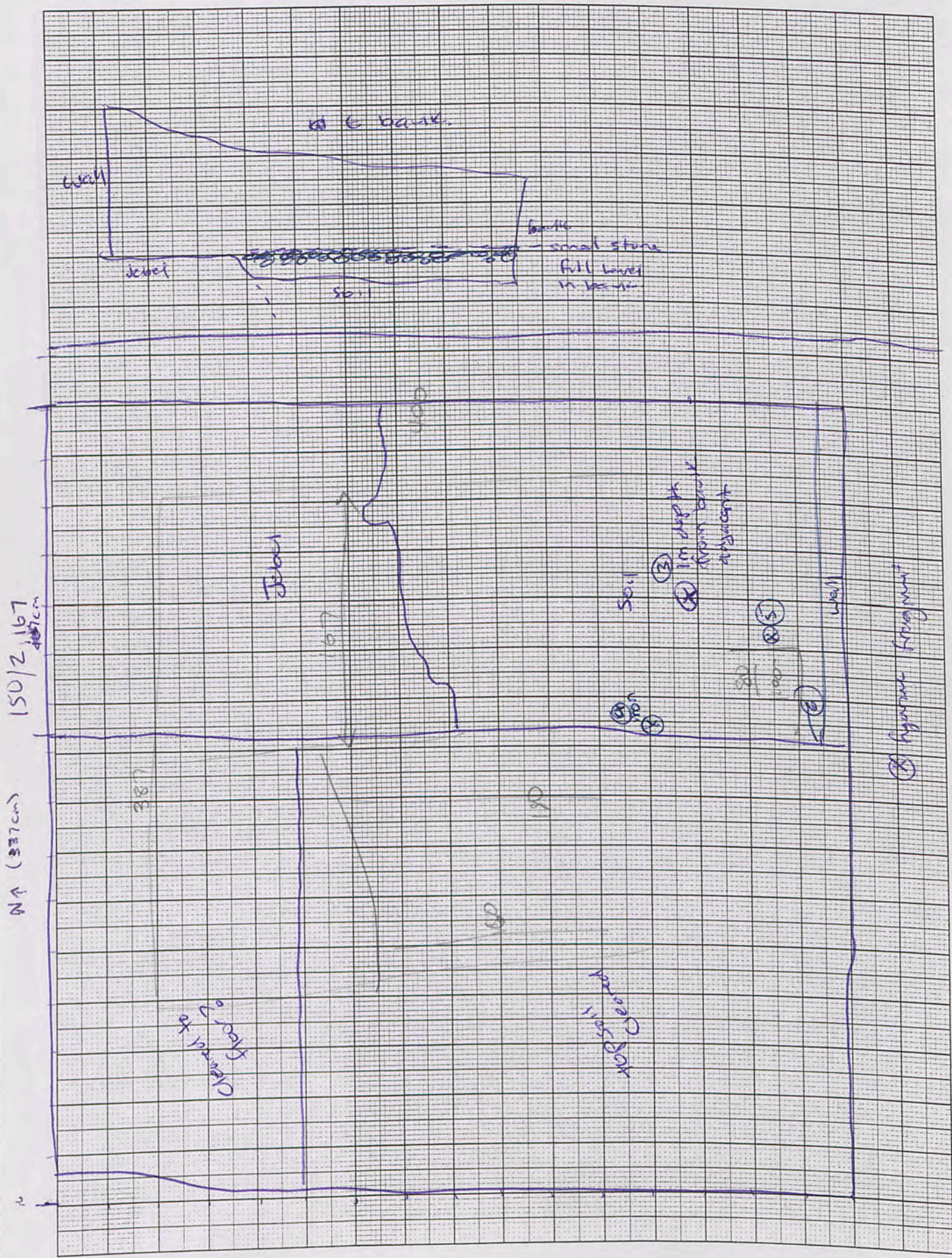

	No. of bags	Cont	Cont
Pottery			
Bone			
Charcoal			
Other (Tile)			
Photos bw			
Photos col.			

No.	Object <sup>00-191</sup>	Cont	Cont
8	glass plastic	11	1
9	glass rim large	11	1
10	iron nail	11	1
11	bronze spatia? frag	11	2

Context	Report
11.1	a lot of small glass fragments coming from locus
⊗	large glass bowl rim + nail found 11.1 - - 55cm W bank - 129 cm from Nth bank, 30cm in depth from soil clearance SW quadrant of trench 11.1 is above ash layer - but getting many cooking pot body sherds.
11.2 (10:50)	started next spit. large amount of tumble + very small round pebbles (green + black in soil) - all flat/round. 3-4cm across. very little pottery or bone.
⊗	bronze fragment found on floor level 25cm above level of debel. - embedded in floor.  very strong floor level

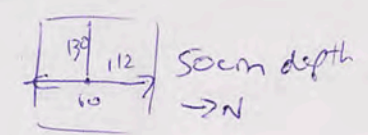













(A) Locus 2 Spit 1 Locus 3 Spit 1 Feature/s tumble!

	No. of bags	Cont	Cont
Pottery	1	2	1
Bone	1	3	1
Charcoal	-	-	-
Other (Tile)	-	-	-
Photos bw	-	-	-
Photos col.	-	-	-

No.	Object	Cont	Cont
1	bronze fragments	2	1
2	bronze chain links	2	1
3	bronze 	2	1
4	bronze tack	3	1

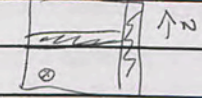
Context Report

	continuing to more tumble from area (A) locus 2.1. stones are getting bigger as we go deeper. No noticeably worked stone so far.
	bronze fragment found 1.4m from N/S wall, 35cm from E/W wall (A) (3cm long wire?) 
	bronze chain links  in trench just to right of other bronze frags
	E/W wall appears either secondary - or very thick with sth edge tumbled away. A more substantial / better constructed wall is appearing underneath with sth edge approx 40-50cm further out than top wall.
	bronze piece   (actual size)
10:00	most of <del>the</del> tumble cleared except for SW corner - to allow access into/out of trench. Now going down through soil layers by spits @ 3.1. Soil  reddish/clay in appearance very little pottery in soil.
	bronze tack found in spit 3.1 SE corner of trench area (A).

Locus 3 Spit 1 Locus 3 Spit 1 Feature/s

Area A bounded by N/S + E/W walls (SW corner).

	No. of bags	Cont	Cont
Pottery	1	3	1
Bone	1	3	1
Charcoal	-	-	-
Other (Tile)	1	3	1
Photos bw	-	-	-
Photos col.	-	-	-

No.	Object	Cont	Cont
1	bronze frags	3	1

Context Report

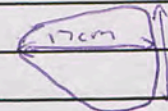
	continuing locus 3.1 very little pottery in soil, and tumble still appearing at 1m depth.
	N/S wall appears very rough at the top layers - many stones protruding from wall. Basins also quite messy due to stones. against E/W wall getting some amphora fragments + some burnt pottery. No any soil or charcoal.
	Basalt piece in 3.1.  17cm x 15cm small on one surface, rough on opposite 5cm thick.
	Tumble is still going down - now at 1.4m from top of E/W wall + finding substantial amounts of tumble - 50/50 Stone/soil.
	some plaster turning up in <del>SE</del> SE corner mostly red. 1 white fragment.
	Large pottery pieces deep red in colour against sth bank 1.4m in depth 80cm from <del>at</del> N/S wall extending approx 50cm along bank backfilled for photo Saturday.



Trench...125/1...Initials...LS...Date...6/5/00...Page...5  
 Locus...3...Spit...1...Locus...3...Spit...2...Feature/s...Pithos

	No. of bags	Cont	Cont
Pottery			
Bone			
Charcoal			
Other (Tile)			
Photos bw			
Photos col.	CS1 20+21		

No.	Object	Cont	Cont
# 1	rounded limestone pieces (2)	3	1

Context Report

Context	Report
	cont clearing 3.1 leaving pithos in situ 5th bank - pending photo. pithos is a very strong brick-red colour
	photos CS1 20+21 taken of pithos on flow - pithos fragments removed - no base, appears to extend under 5th bank. removing SW corner soil/rocks to level all of trench at bottom of 3.1
	large fragments of rounded base jar found in SW corner clearance, + amphora fragments in 5th bank. most likely this was a storage room. Some charcoal fragments + a few clay pieces - resembling oven wall have been turned up at bottom of 3.1.
	N/S wall is partially collapsing along the top courses - leaning into trench. Some of top course will be removed for safety. Floor being bricked off at 1.1m depth at 5th bank - end of 3.1.
#	round limestone pieces - marble size - possibly children's game - at least the workers think so!

oven

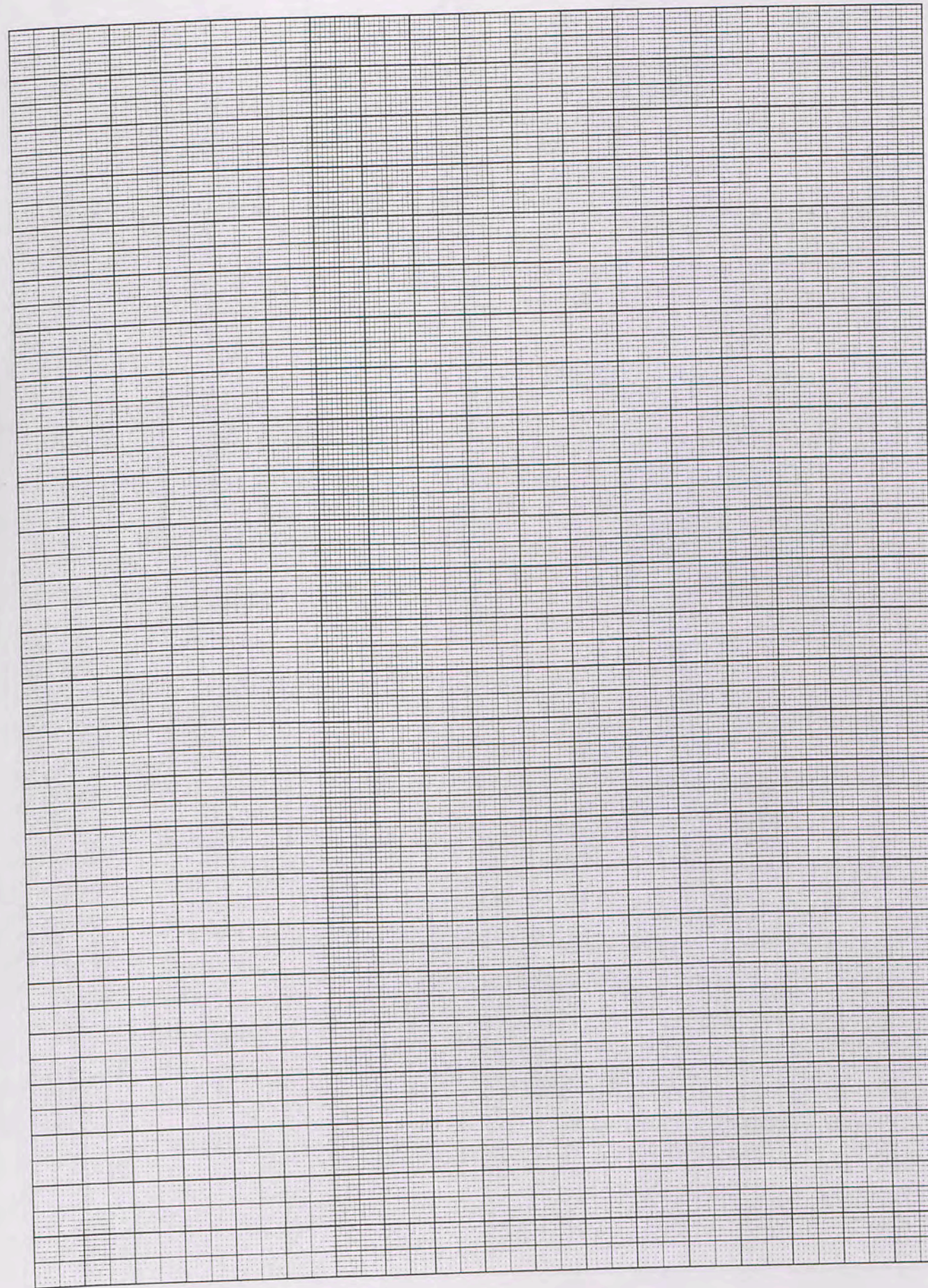



1m = 40mm

1mm Squares

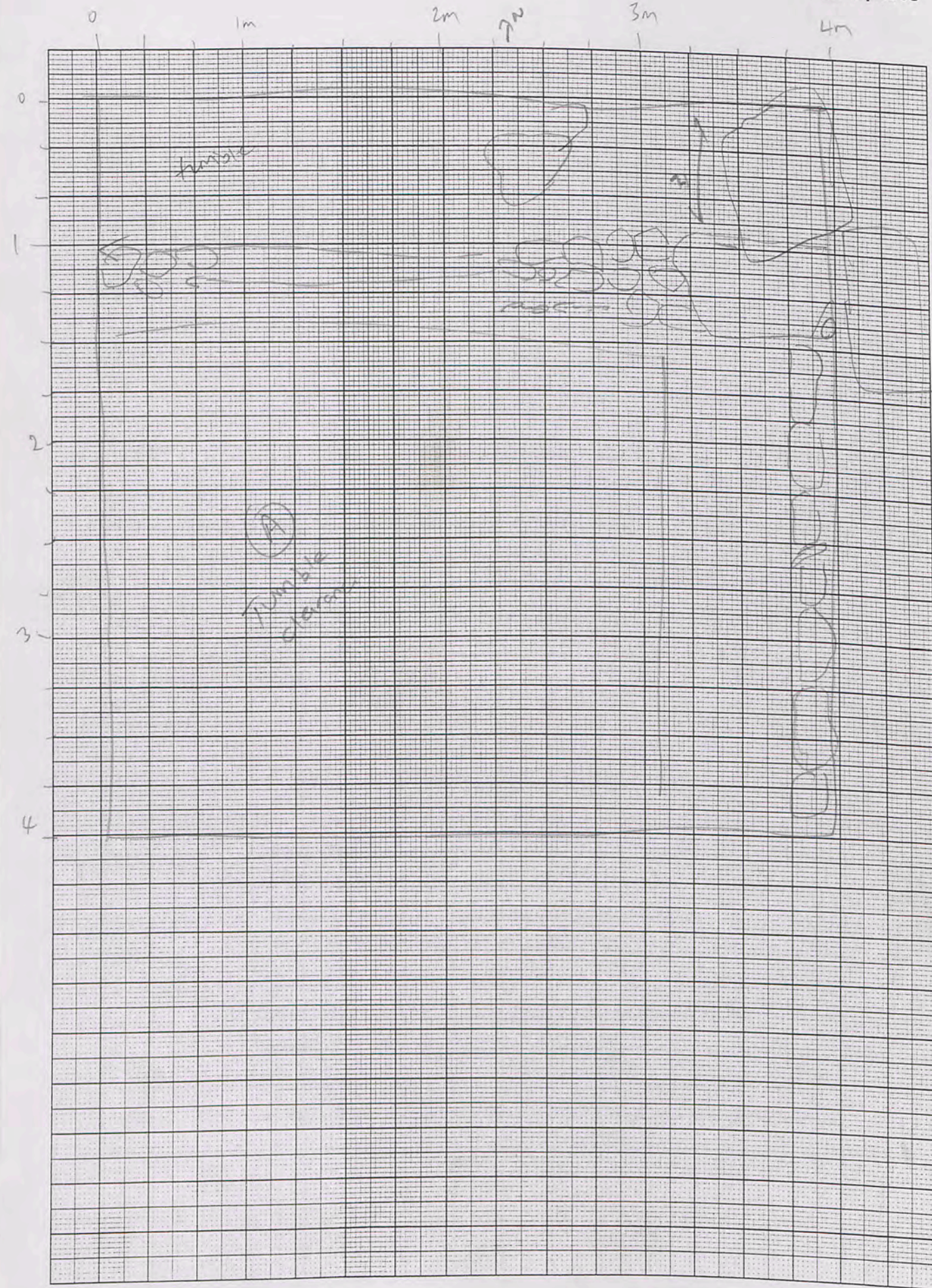

12511

415100

↑ N

1m = 40mm

1mm Squares

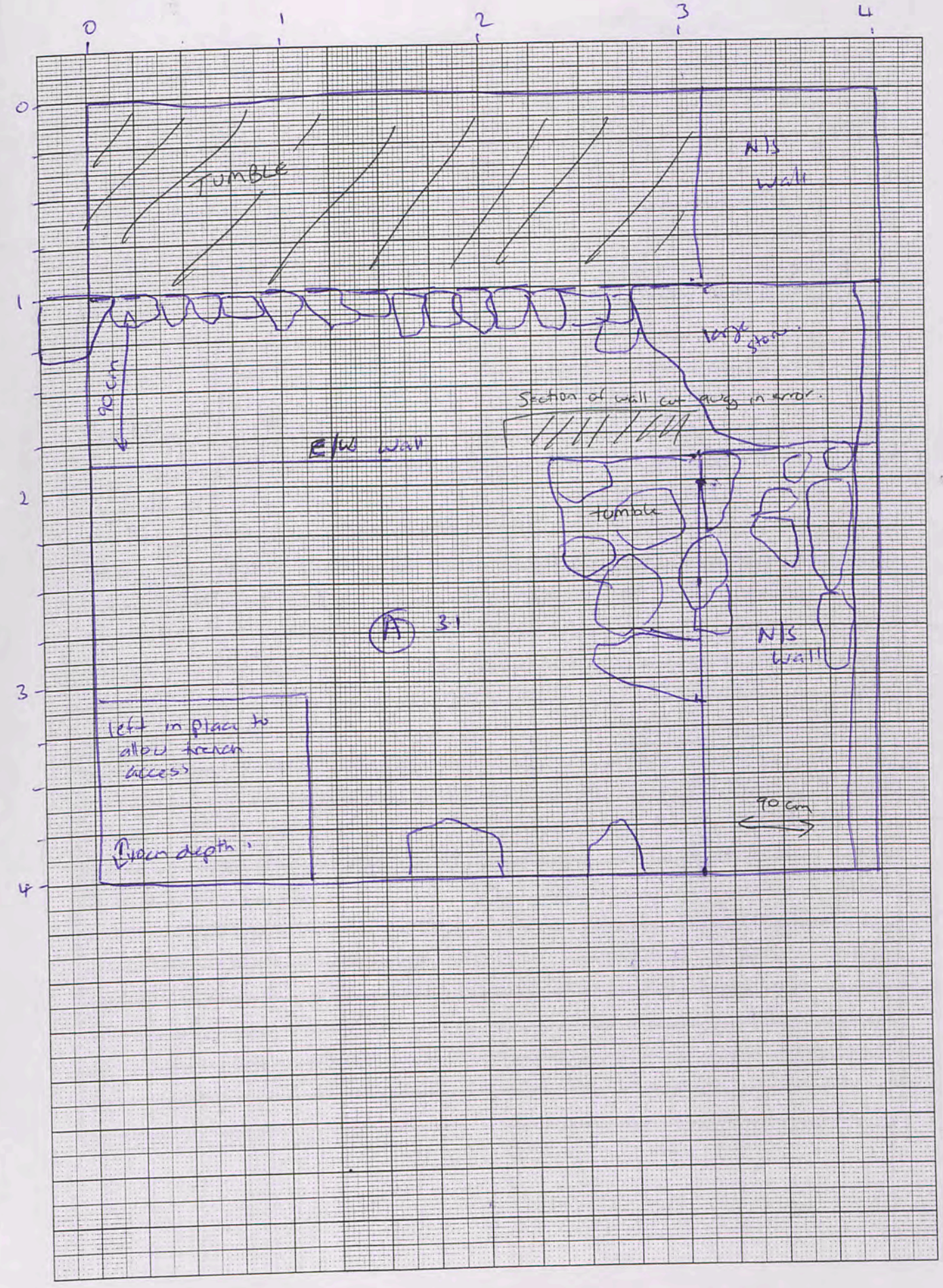







Trench 12511 Initials LS Date 7/5/00 Page...  
 Locus 4 Spit 1 Locus B Spit 1 Feature/s floor - n<sup>th</sup> of E/W wall.

	No. of bags	Cont	Cont
Pottery	1	8	1
Bone	1	4	1
Charcoal	1	4	1
Other (Tile)	-	-	-
Photos bw	2+3 taken of amphora		Roll 7
Photos col.			

No.	Object	Cont	Cont
1	iron (nail?)	4	1
2	iron -	4	1
3	burnt shell frag	4	1

1 bag - for amphora fragments. ~~diagnostic~~ - too rim or handles rim found in W bank - complete/fragmented

Context Report

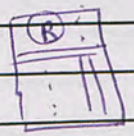
Area A being spit with SW side being cleared below floor level - locus 4.1
SW corner possible oven - very ashy/dark soil + burnt pottery fragments.
 4.1 cutting through floor
x oven? ashy soil - no sign of clay around oven but soil ashy + a lot of small charcoal fragments.
cleared 1 spit of 4.1 - no evidence of further floors - very little pottery for a floor level large ashy deposit in W bank 1m from SW bank.
Finishing spit + moving to area n <sup>th</sup> of E/W wall (B)
 This will be cleared to approx 0.5 - 1m to get wall definition + to determine if walls interlocked or abutting. Not clear from corner in (A)
* Iron nail from ashy soil in W bank. ashy soil cuts through floor level where amphora found.
11:00 begun clearing area (B) little pottery - some bone

Trench 12511 Initials LS Date 8/5 Page 7  
 Locus 1 Spit 1 Locus 2 Spit 1 Feature/s area B - n<sup>th</sup> of E/W wall.

	No. of bags	Cont	Cont
Pottery	1	8	1
Bone	+ (3)	8	1
Charcoal	(3)		
Other (Tile)	stack (2)		
Photos bw	-		
Photos col.	-		

No.	Object	Cont	Cont
1	worked stone/flint	B 1	1
2	bronze	B 2	1
3	nail (modern?)	B 2	1
4	moulded bowl frag	B 2	2
5	flint flake	B 2	2

Context Report

Topsoil in n <sup>th</sup> part of trench area (B) seems to have a reasonable amount of pottery in it. Very little tumble in area B - mostly soil at 30cm depth after surface scatter of stones removed. 2.1 some fine pottery is turning up + a frag of jar rim + jug/butter. Very little bone in 2.1
1.1 still clearing soil surface tumble
2.1 more soil some small stones.
2.2 ->
Wall definition clear on E/W but not clear at this stage on N/S. appears to <del>begin</del> be out of line with wall in (A) but this may be just surface tumble/collapse. NO, I was wrong - all tumble. Wall runs as it should!
11:15 commencing 2.2.

27  
26  
25  
24  
23  
22  
21  
20  
19  
18  
17  
16  
15  
14  
13  
12  
11  
10  
9  
8/5



Trench... 125/11 ..... Initials... LS ..... Date... 9/15/00 Page... 8

Locus... 2 Spit... 2 Locus... 2 Spit... 3 Feature/s... (B)

	No. of bags	Cont	Cont
Pottery	1	B2	2
Bone	1	B2	2
Charcoal	1	B2	2
Other (Tile)	1	B2	2
Photos bw			
Photos col.	CS3	31 + 32	

taken at B. 10/5

No.	Object	Cont	Cont
1	coin	B 2	2
2	lamp fragment	B 2	2
3	moulded bowl frag	B 2	2
4	2 moulded bowl frags	B 2	3
5	large figurine frag	B 2	3

Context Report

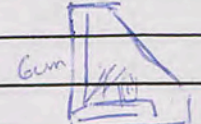
-	completing spit 2 of loc 2. coin found at 6:05 1.6m from W base. 30cm from Nth base. lamp + moulded bowl fragments found more to the west of the same spit
7m	- starting spit 3 - will then clean walls when done to get better definition on Nth side. No stone at all in soil levels being cleared.
*5-	big frag ← base with foot/drapery
	
	commenced spit 4 but only 6m under spit 3, hit a very compact floor. Floor swept + walls cleaned for photograph tomorrow.
	moved to complete (shit pans!) 125/3

125/1 10/5/00 ↑ N44

1mm Squares

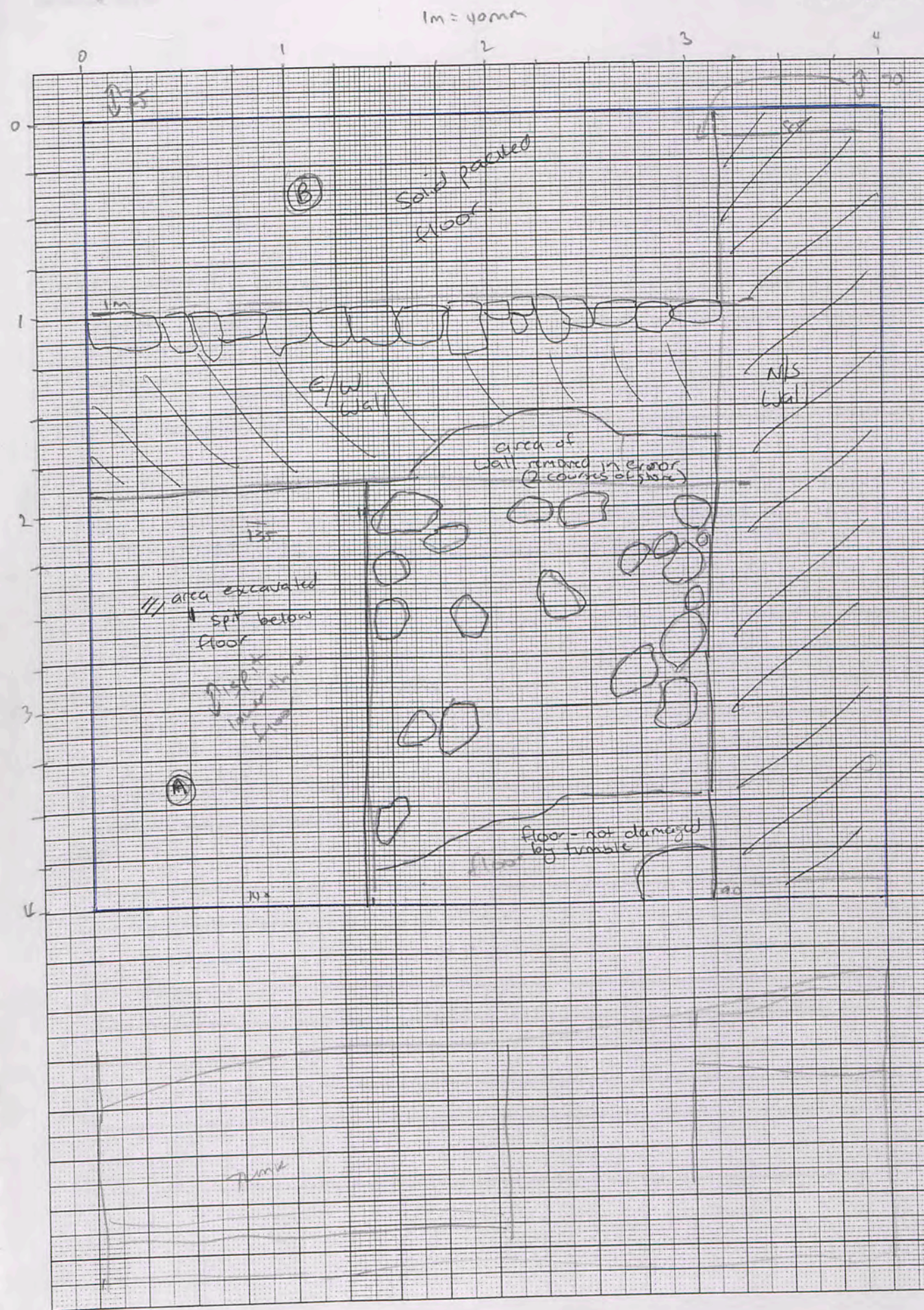



125/3

10/5/00

↑ N<sup>th</sup>

1m = 40mm

1mm Squares

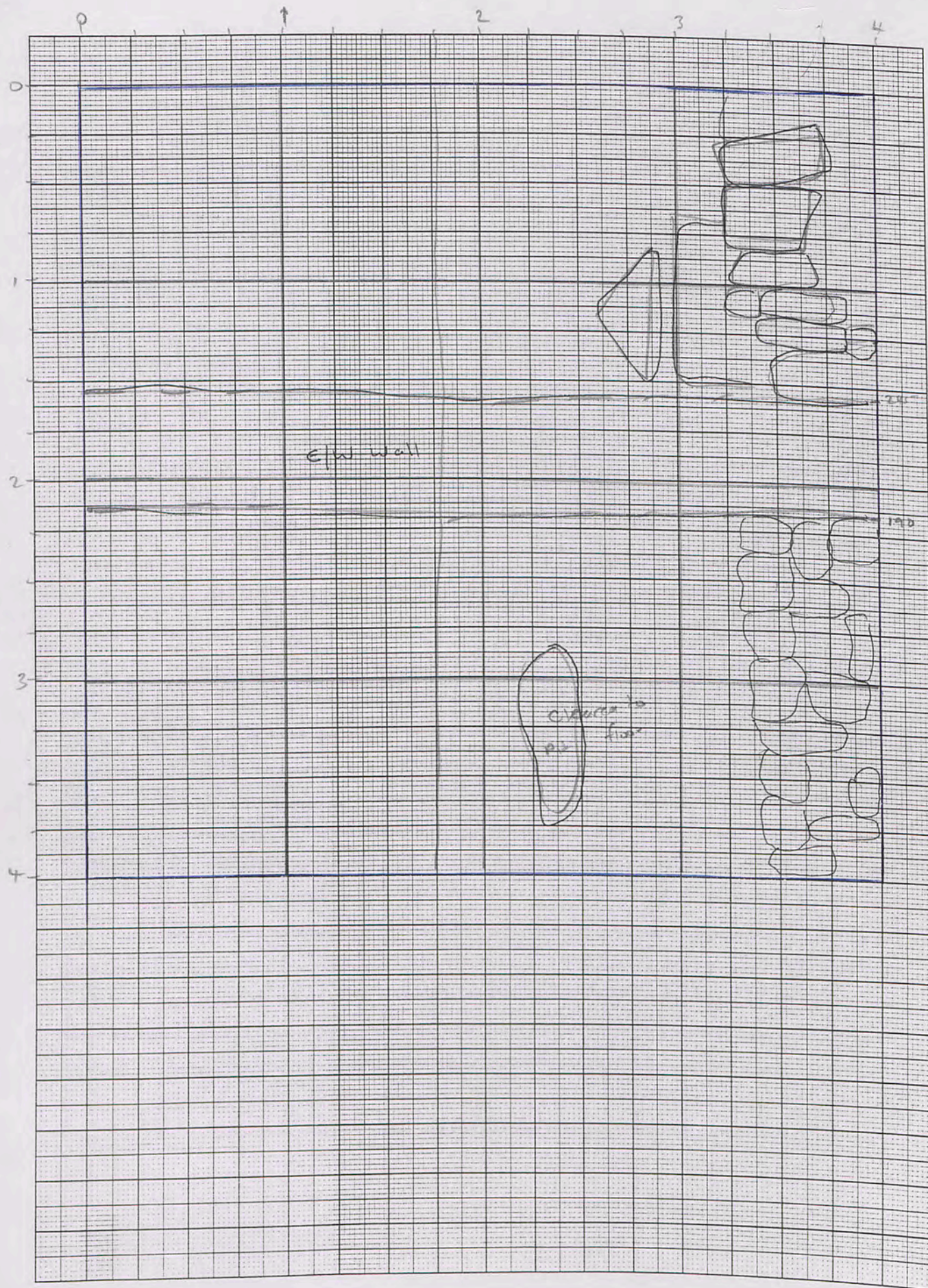

Trench.....125/3.....Initials.....LS.....Date.....9/5.....Page.....①  
 Locus.....10.....Spit.....1.....Locus.....Spit..... Feature/s.....

	No. of bags	Cont	Cont
Pottery	1	10	1
Bone			
Charcoal			
Other (Tile)			
Photos bw			
Photos col.			

No.	Object	Cont	Cont

**Context**                      **Report**

10:45 commenced 125/3. Trench has been partially excavated in 1992<sup>1996</sup> season. Trench is split roughly in 2 by E-W wall with a possible doorway to street on E bank to N<sup>th</sup> of E/W wall.

not excavated = E/W wall

clearing topsoil + small stones from W half of trench to get full E/W wall definition. commencing at locus 10



Trench...12513.....Initials...LS.....Date...10/5.....Page...2  
 Locus...11.....Spit...1..... Locus...12.....Spit...1..... Feature/s.....

(A)

	No. of bags	Cont	Cont
Pottery	3	11.1 12.1	12.2
Bone			
Charcoal			
Other (Tile)			
Photos bw			
Photos col.			

No.	Object	Cont	Cont
1	fig frag	11	1

Context Report

Removing tumble from trench - Had previously been cleaned to tumble layer.		
figurine fragment - lower leg/groove found NW quarter of trench		
Floor level in NW or SW corner should only be 50-70cm below surface, and approx 1m below in SW corner.		
splitting trench in 2 <table border="1" style="display: inline-table; vertical-align: middle;"> <tr> <td>B</td> </tr> <tr> <td>A</td> </tr> </table> working area (A) - much deeper so tumble - very little control over spits. Area B has soil at quite shallow depth.	B	A
B		
A		
spits/locus change to (A) 12.1 soil colour is quite dark but not ashy - windblown - Floor levels appear quite shallow in baulks. Only a small amount of pottery coming from spits in (A)		
1 small fragment of oven wall in (A) 12.2		

A = 61  
 B = 62

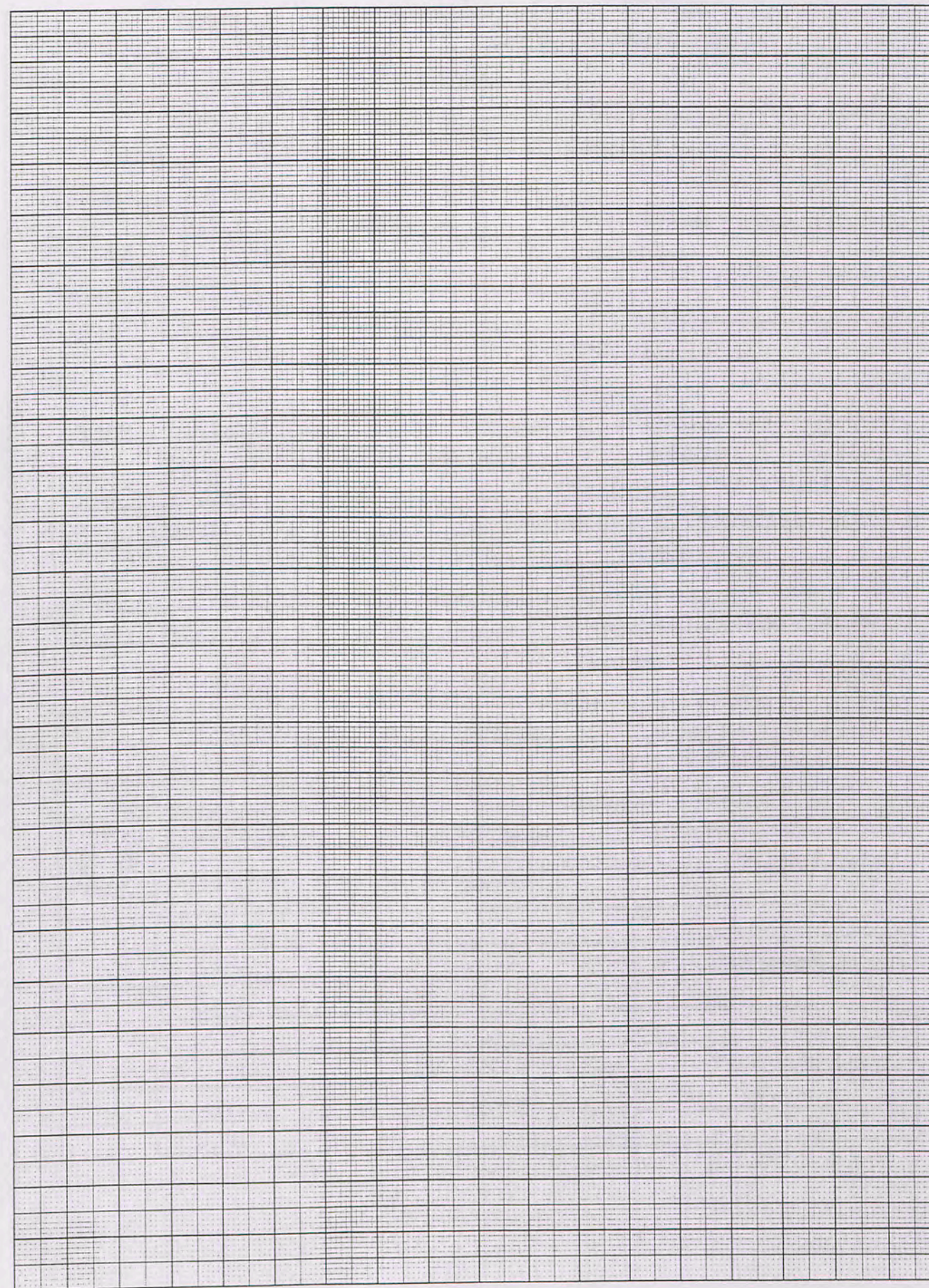



1mm Squares

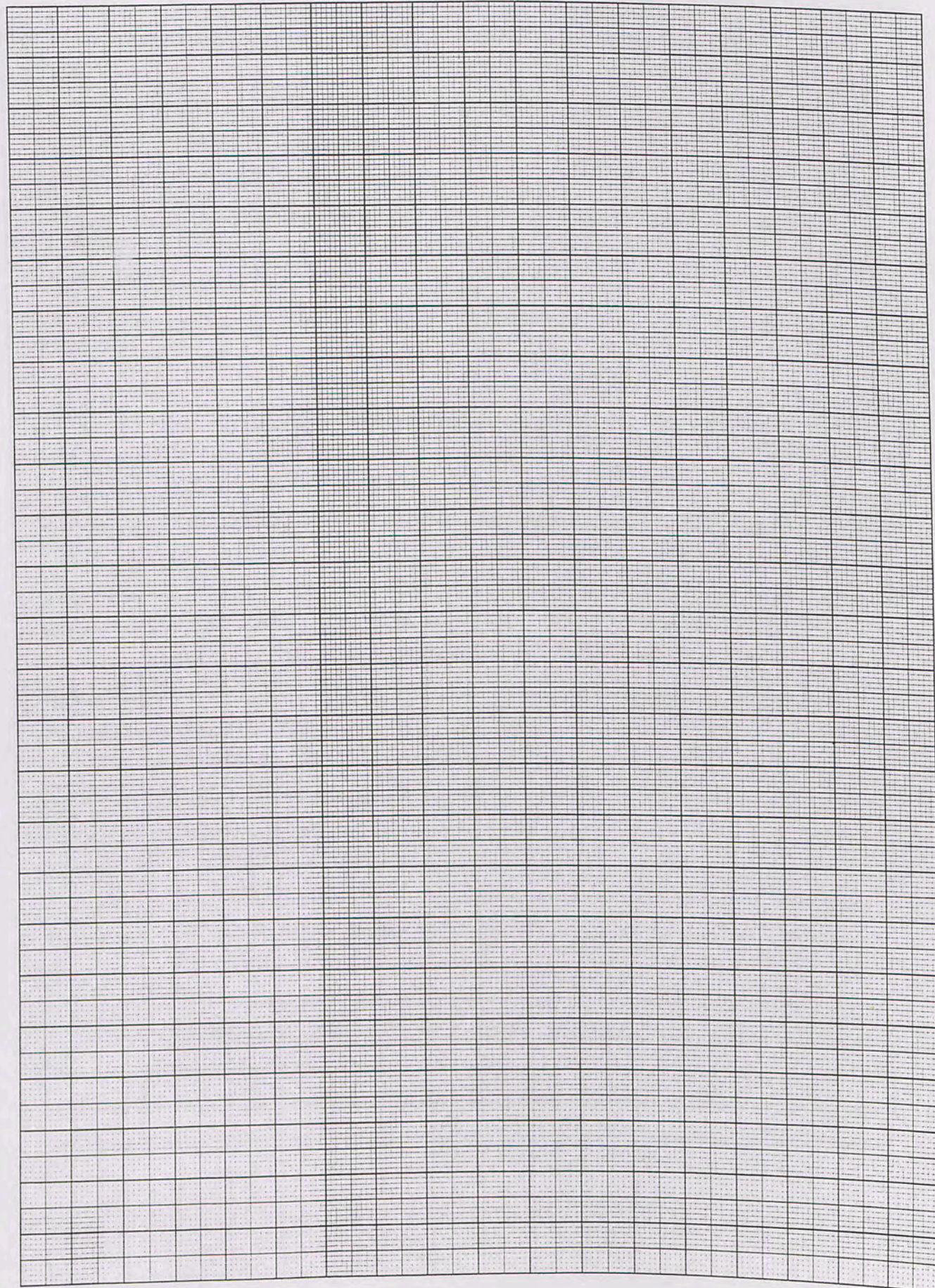

① Trench...12/13.....Initials...LS.....Date...11/5/00 Page...3  
 Locus...12 Spit...2..... Locus...12.....Spit...3..... Feature/s...floor? Pit

① 13.1 →

	No. of bags	Cont	Cont
Pottery			
Bone			
Charcoal			
Other (Tile)			
Photos bw			
Photos col.			

No.	Object	Cont	Cont
1	Lamp frag	① 12	2

SE corner

Context Report

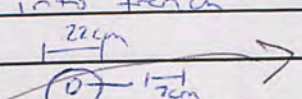
	Floor in area A may not be very good - appears to be timber at level of "floor" in quarter of trench prev. excavated (SE corner) - very small amount of pottery coming out of the rest of A 12.2 - just above floor.
8:00	locus ① 12.3 stone "pipe" exposed in (W) bank extending 36cm into trench  exposed from bank = door post holder hole does not extend through stone - issa thinks it is a roller for raising floors. looks like there may be a very weak floor at level of that excavated in SE quarter - much timber on floor - so only really visible against the wall where it was protected. → will need to remove to see if other end has same hole drilled. Pit in floor near SW corner - cuts into 5th bank excavating pit, then rest of floor, so 1 becoming darker in the pit

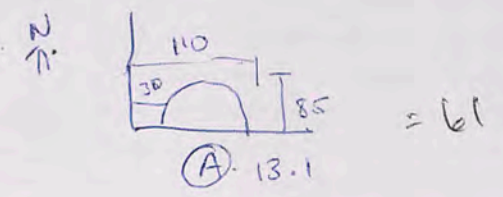







N ↑ 125/3 15/5/00 1m = 40mm  
 125/3 15/5/00 ↑ N  
 1m = 40mm 1:25 Scale.

1mm Squares

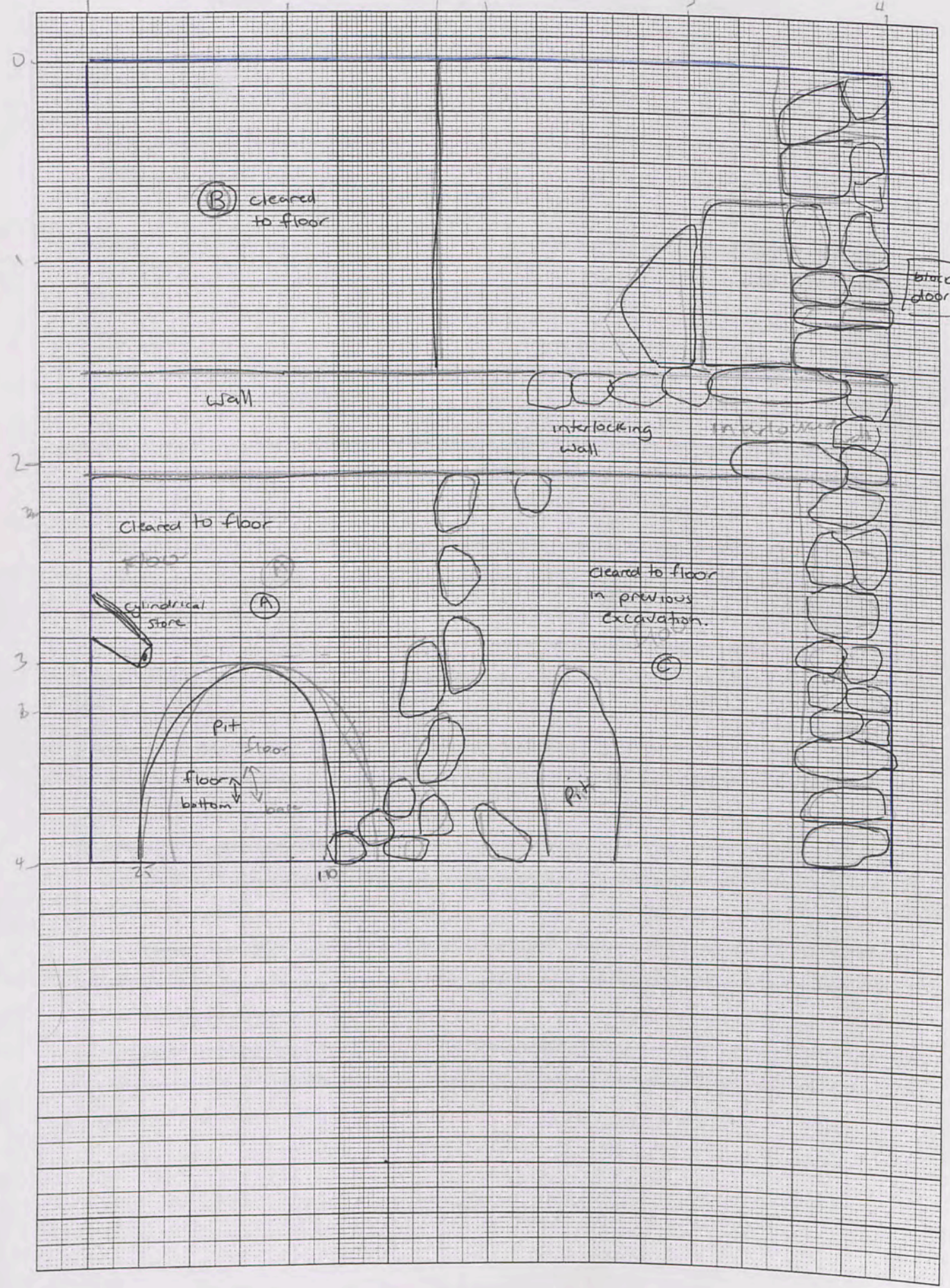

Trench 125/3 Initials 13 Date 15/5 Page...

(A) Locus 13 Spit 1 Locus (B) 11 Spit 1 Feature/s Pit / Floor / Tumble (A) (B)

	No. of bags	Cont	Cont
Pottery	1 (A) (B)		(B)
Bone	1 (A) (B)		(B)
Charcoal			
Other (Tile)			
Photos bw			
Photos col.			

No.	Object	Cont	Cont

Context Report

Continuing clearance of pit A 13.1. All tools have following break!
Floor found in pit at depth of 46cm - moving to area B to establish floor level.
B 11.1 clearing of tumble/soil down to floor level. Floor should appear at approx level of doorway in E bank.
Basalt piece in B 11.1
11.1 has been cut as a very deep spit - 15cm/20cm!! Still not at floor level
crushed jar/amphora B 11.1 - only 1 wall of vessel - does not appear to be resting on floor. No diagnostic features visible -

vessel is a cooking pot. 1 handle with body on large sherd. V/coarse fabric + quartz inclusions - bagged separately for possible reconstruction.



Trench 125/3 Initials LS Date 15/5 Page 2  
 Locus 10 Spit 1 Locus 10 Spit 1 Feature/s

	No. of bags	Cont	Cont
Pottery	2	C 10	1
Bone	1	C 10	1
Charcoal	-	-	-
Other (Tile)	-	-	-
Photos bw	9	12+13	
Photos col.			

No.	Object	Cont	Cont
1	iron	C 10	1
2	lamp frag	C 10	1

Context Report

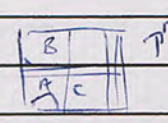
cooking pot removed, but none of pot appears to be in corner of E/W wall against W bank - cleaned to floor level with rest of pot in situ (photo)  
 Floor appears to be at level of flatstones in doorway on E bank. cleaned at floor.  
 moving to SE quarter to look for Jebel  
 (C) -  

 Commencing at locus 10 = 61  
 Soil in area (C) wet + clay. In the pit prev excavated in (C), plastic bags etc were found. Large amount of pottery in top layer / floor clearance.  
 Pit prev totally excavated - very shallow.  
 (10/5) bank exposed in 10.1 shows a very dark ashy layer 10cm under floor level prev excavated. Levelling off 10.1 at this layer.

Trench 125/3 Initials LS Date 16/5 Page  
 Locus 10 Spit 1 Locus 10 Spit 2 Feature/s

	No. of bags	Cont	Cont
Pottery	5	10.1 x 1 10.3 x 2	10.4 x 1
Bone	3		
Charcoal			
Other (Tile)	1	C 10	2
Photos bw			
Photos col.			

No.	Object	Cont	Cont
1	small flint flakes (2)	C 10	1
2	figurine frag	C 10	2
3	lamp frag	C 10	3
4	flint blade frag	C 10	4

Context Report

Ashy layer not seen in yesterday's light - area C being cleared to top of ashy layer - SE corner already cut into this layer.  
 limited amounts of pottery in clay layer / floor - ashy deposit has a far higher amount  
 (10.3) 8:15 10.3 area C - soil still dark - ashy / wet  
 stores /  
 - fumble on floor level running NW in sth part of trench appeared at first to be a wall / shelf next to pits. Does not extend below floor level  
 10.3 Soil still ashy - no sign of any charcoal - minimal bone in spit  
 2 flint nodules - 8-10cm across in 10.3. no sign of use as cores or as pounders 1 large quartz cobble also no sign of use.  
 10.4 hitting solid packed clay / stone - maybe Jebel.



Trench 125/3 Initials LS Date 17/5/00 Page...  
 (C) Locus 10 Spit 4 Locus... Spit... Feature/s. ash, soil layer.  
 \*OB 1 profile bagged separately @ 10.5

	No. of bags	Cont	Cont
Pottery	2	10	4
Bone	1	10	5
Charcoal			
Other (Tile)			
Photos bw			
Photos col.			

No.	Object	Cont	Cont
1	flint (2)	C	10
2	worked bone	C	10
3	flint	C	10
4	flint (2)	C	10

(A) 5th bank - good stratigraphy / section

Context Report

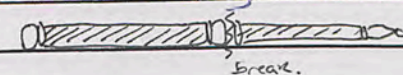
	Continuing c 10.4 to level. Ashy soil layer continues to next spit in part of area c - some areas have packed clay/stone which is possibly just above level.
	10.5 more clay based - less ash - bone-carved found in spit at W edge of (C).
obj#2	piece was broken during excavation.  9cm long. break.
obj#3	large flint piece - does not appear deliberately worked - sharp edged. 10.5 - some firewares / good diagnostics.
	10.6 still large amounts of pottery - soil quite wet. No sign of level yet. More flint - 1 well worked piece - retouched on all cutting surfaces.

125/3 175100

area A/B/C completed.  
 1m = 40mm  
 1:25 scale.

1mm Squares

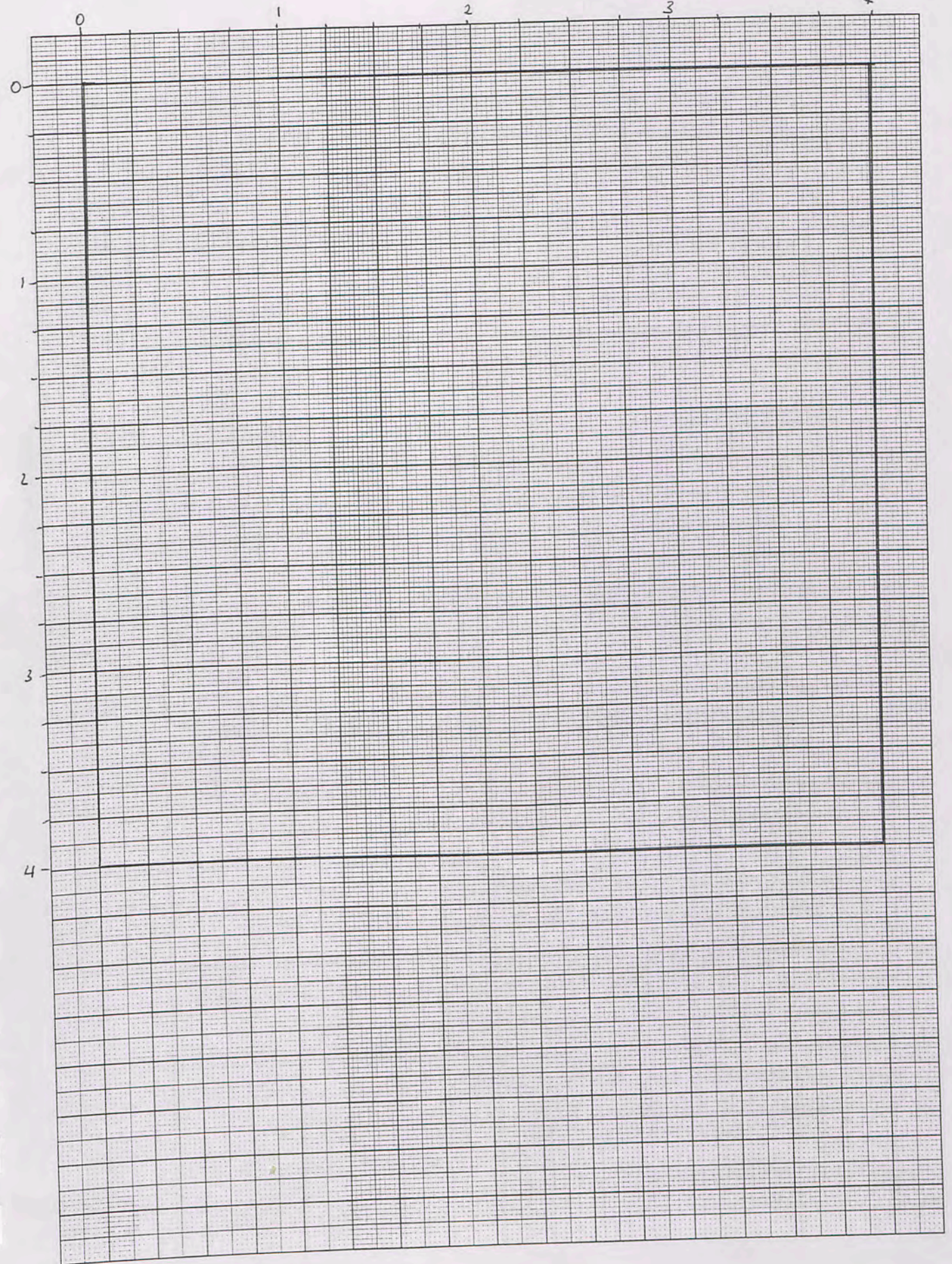



1mm Squares

5th bank 21/5/00

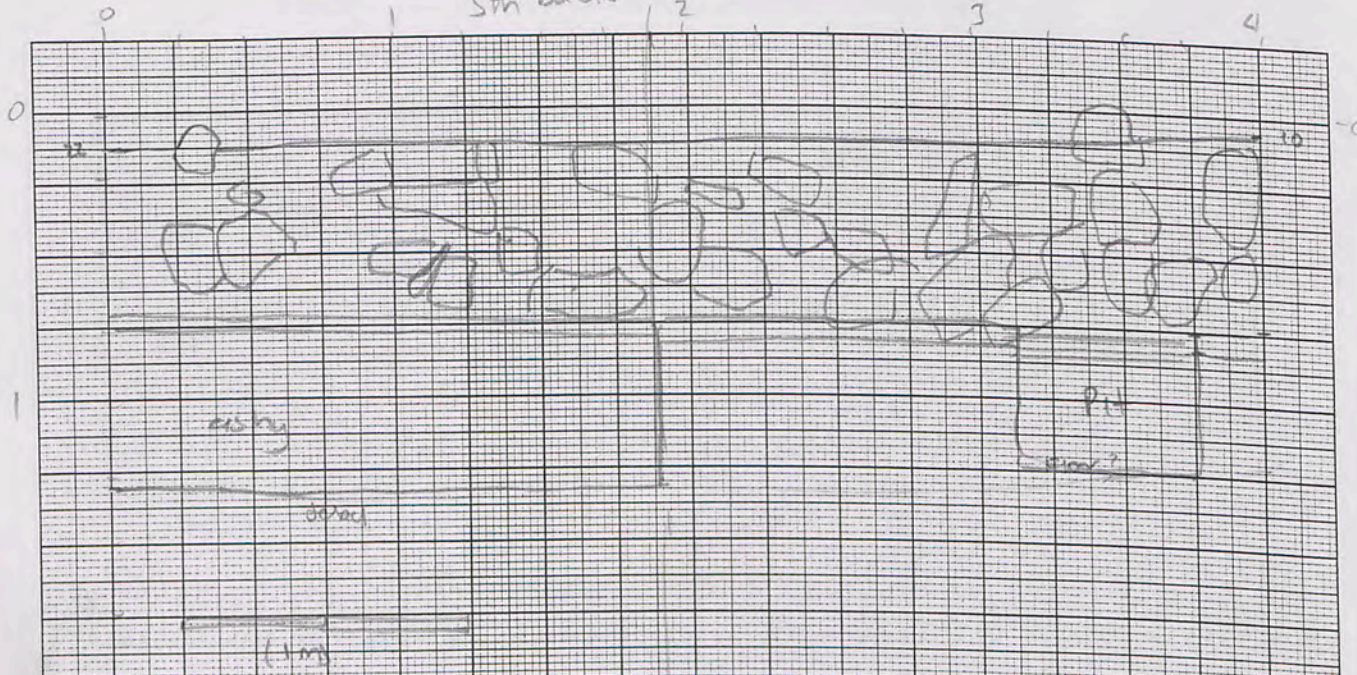

6th bank 21/5/00

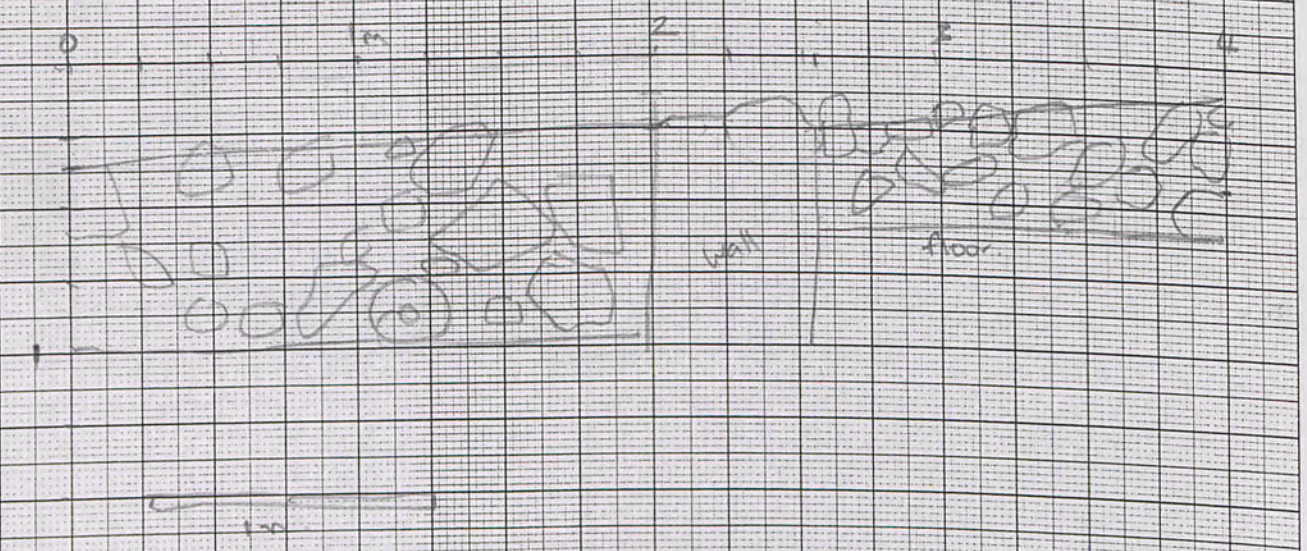

Trench 125/3 Initials LS Date 18/5/00 Page...  
 Locus Spit Locus Spit Feature/s  
 clean-up-

	No. of bags	Cont	Cont
Pottery			
Bone			
Charcoal			
Other (Tile)			
Photos bw	9 35+36		
Photos col.	CS 1		

No.	Object	Cont	Cont

Context	Report
	cleaning of all levels of trench for photo.
	<p>Halas!</p> <p>(Summary)</p> <p>n<sup>th</sup> half of trench - well defined floor + doorway.</p> <p>s<sup>th</sup> half - deep ash deposit to Jebel - good floor above ash level with large pit in SW corner. Jebel very level at this point, so may have been a floor itself. No floors visible in ashy soil layer - approx 70cm thick - ashy layer held large amounts of pottery + some bone. No charcoal. 2ndery wall/shelf next to pit - probably not a wall - stores cut into floor by a few cm. Stores were removed to uncover all of floor in that area.</p> <p>No signs of secondary occupation unless Jebel taken as floor level. No floors visible in bank below or above floors cleared in trench.</p>

Very deep ashy layer below floor levels.



Trench.....<sup>5</sup>12/16.....Initials.....<sup>ls</sup>.....Date 18/5.....Page...1  
Locus.....1.....Spit.....1.....Locus.....Spit..... Feature/s.....<sup>Topsoil</sup>.....

	No. of bags	Cont	Cont
Pottery	1	1	-
Bone			
Charcoal			
Other (Tile)			
Photos bw			
Photos col.			

No.	Object	Cont	Cont

**Context Report**

	clearing topsoil + small stones. E/W wall continuing from 125/3. No other structure visible at surface.
	Trench occupies a shallow depression which may be a courtyard area.
	Topsoil very hard packed - which may be due to rain/runoff in depression. Small amounts of very fragmentary pottery in soil.
	E/W wall not very clear at W-end. large stone possibly marking end or doorway? <del>stone</del> wall? <sup>AN</sup>
	Large amount of rubble exposed (under topsoil) - Soil fill from runoff had left surface flat with little stone visible.

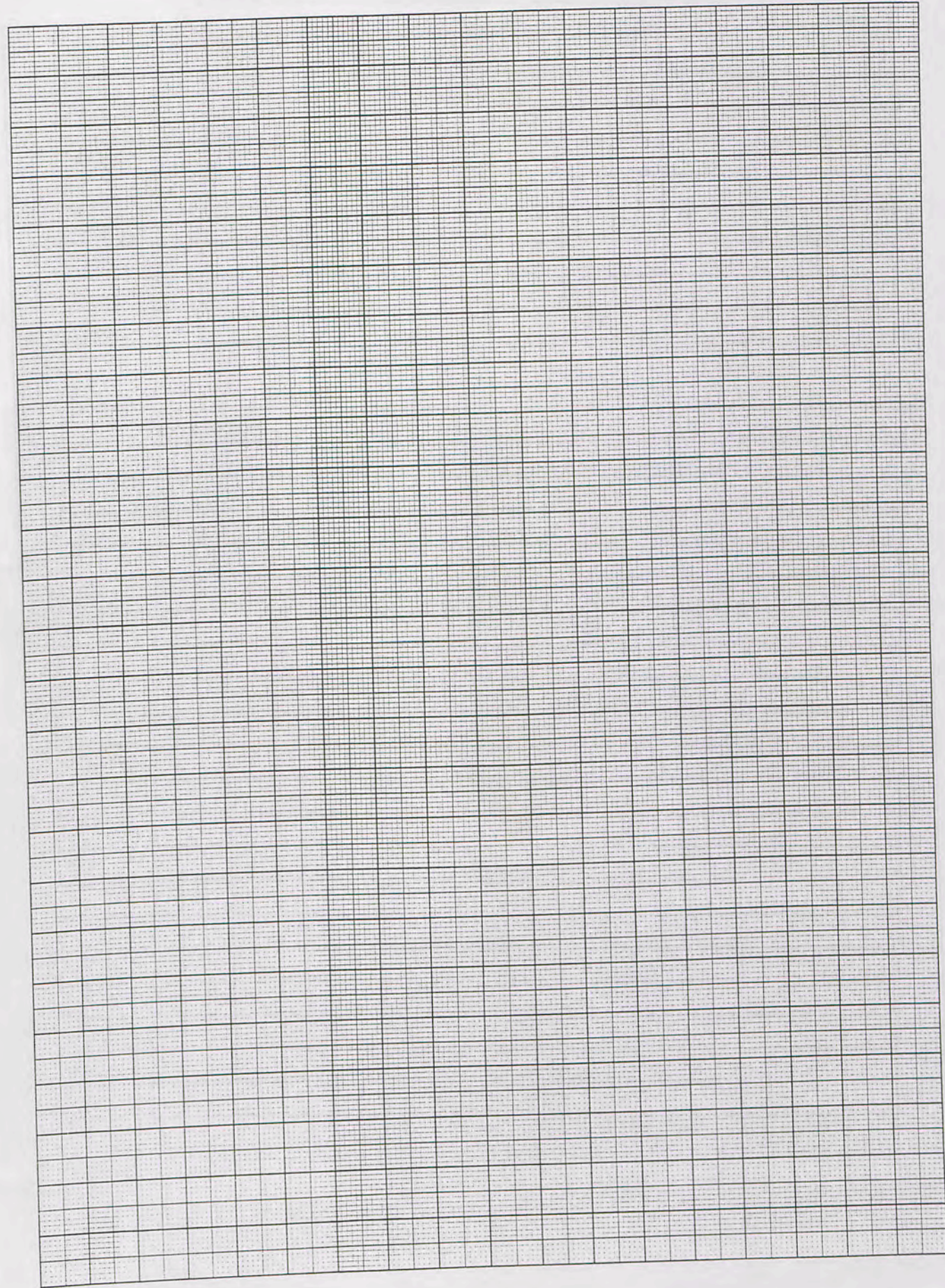







Trench 125/6 Initials LS Date 2/5 Page...  
 Locus 2 Spit 1 Locus... Spit... Feature/s Tumble.

	No. of bags	Cont	Cont
Pottery	2	2	1
Bone	1	2	1
Charcoal	-	-	-
Other (Tile)	1	2	1
Photos bw	-	-	-
Photos col.	-	-	-

No.	Object	Cont	Cont
1	lamp frag	2	1
2	" "	2	1

Context Report

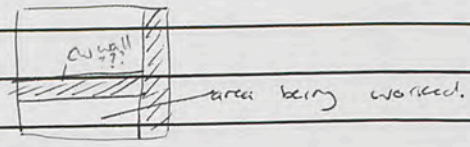
Soil has been cleared to below first level of tumble in 5th section of trench - 5th of EW wall. A N/S wall appears to be running along E bank

Large worked stone moved from tumble and broken yesterday 50x40x20 cm block. Not in wall.
The EW wall extension does not look very convincing - may well terminate on N/S wall against E bank - courtyard? Some worked stone in tumble. ve. lime pottery coming from tumble.
tumble layer not very deep in 5th end of trench - reaching mostly soil layer 40cm depth.
another large worked stone in centre of locus - resting in a possible floor/courtyard level
Reached a floor/courtyard level (1/2 courses of stone down (N/S wall) not very level. EW wall not there at all.

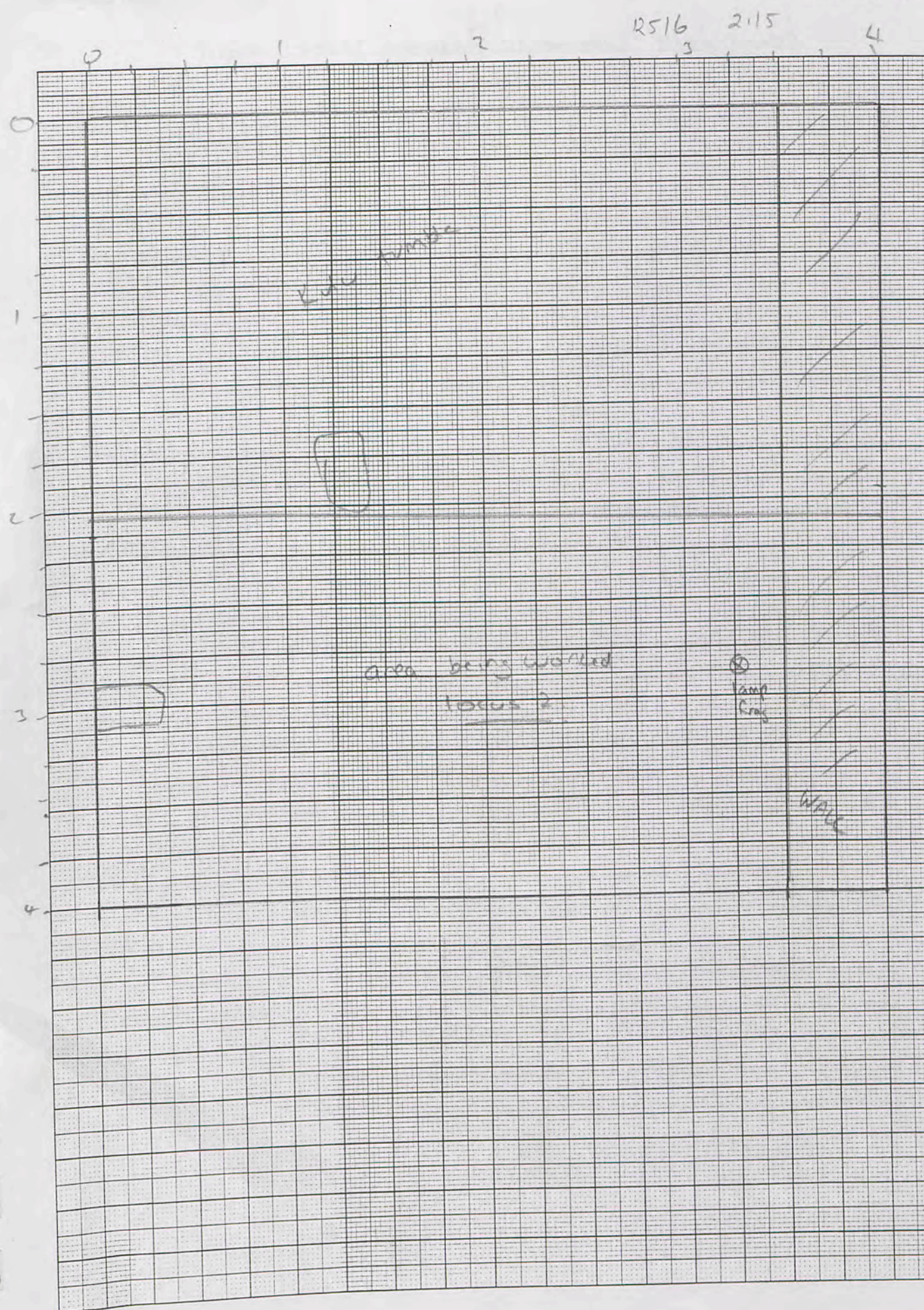
clearing all tumble to floor level across trench.





125/6 22/5/00

1mm Squares

Courtyard - cleared to floor level

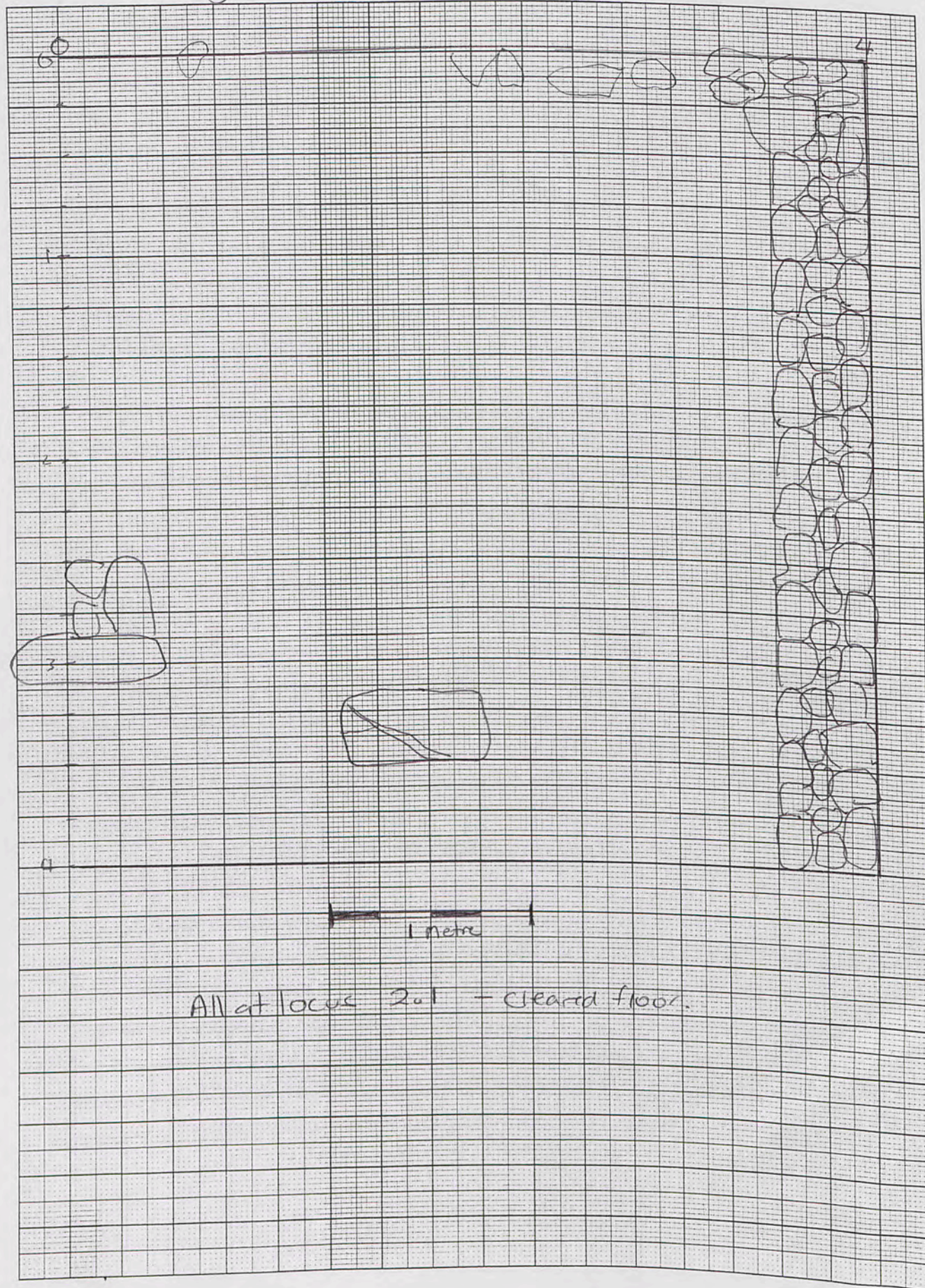

Trench.....125/6.....Initials...LS.....Date...22/5..... Page...

Locus.....2.....Spit.....1..... Locus.....Spit..... Feature/s.....Floor.....

Tumble all resting on floor ∴ all as locus 2 - 1 spit.

	No. of bags	Cont	Cont
Pottery	2	2	1
Bone	1	2	1
Charcoal	-	-	-
Other (Tile)	-	-	-
Photos bw	-	-	-
Photos col.	-	-	-

No.	Object	Cont	Cont
1	coin	2	1

Context Report

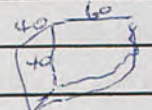
Context	Report
	cont'd clearance of tumble from floor level.
	Floor slopes down from E → W. Highest at edge along wall. continuing to get very heavy pottery in tumble layer/on floor.
	1 worked stone - broken removed from tumble - 60 x 40 x 40
	
	Floor completely cleared - no fill - structure except N.W. wall on E bank. Several stones sitting in floor in SW quarter of trench.
	floor/wall exposed whole trench for photo.

00 61 2 62515264  
. 71 7 770107E



