



**A4  
NOTE BOOK**

No. 595

TINA NAPIER  
JK. DR. 1996





by the lake

DQ

Trench 149/2

28/9/96

Surface spoil previously cleared when trench laid out.

Commenced trench 149/2 this morning.

Began by removing light brown topsoil from the surface. Soil matrix is loose + a light brown, containing scatters of minute (< 5mm diameter) nautilus shells. Called this layer spit ①, in context 1.

By 9 am the distribution of rock scattered across the trench was visible, as workers removed soil from between the rubble.

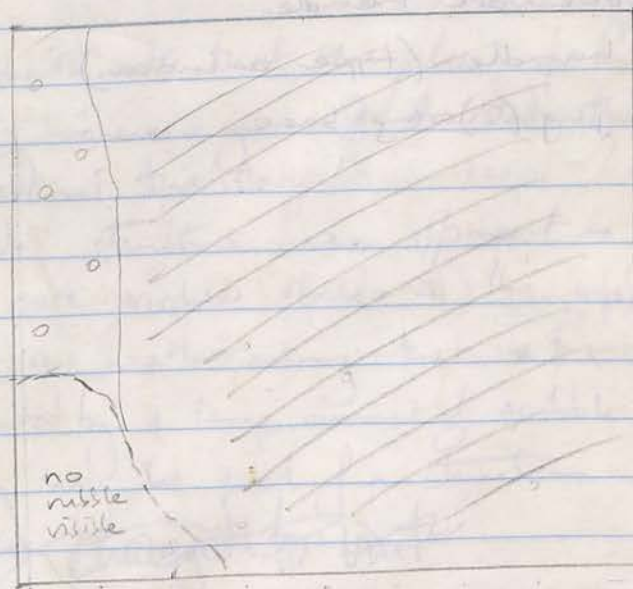

↑ N

Scale: 0 1m

○ ○ ○ - light scattering of partially protruding rock

▨ - dense distribution of protruding and large rubble (stones average around 25/30 cm in diameter)

Although no structures are visible at this stage, from looking at trench 149/3 immediately to the N, we will most probably find a wall running E-W across the middle of 149/2. On the eastern wall of this trench there may also be another wall running N-S.

Few artefacts found + all pottery sherds.

Work a bit slow as we adjust to each other.

~~Depth of soil removed from the trench~~



Pottery Analysis for 28/9/96

Trench 149/2. Spit 1 (1) (Content 1)

Body Shards: 19

- Diagnostics:
- 1 jar rim
  - 1 cookware handle
  - 1 handle (type unknown)
  - 1 jug (?) w/ base

Messiah - Jake

OR SQUARE 149/2

29/9

Supervised by MK on 29/9. Decided to call this ~~unit~~ <sup>unit</sup> we began excavating today - ~~unit~~ <sup>content 1, spit</sup> (2). This decision was based on the fact that excavation yesterday appeared to stop into a distinct definable level which was being cleared up for a photo. This level was the topsoil. Unit (2) however, was much the same consistency + texture to unit (1). Unit (2) was a light/brown/tan soil, mostly compacted with a 50/50 ratio of ~~large~~ <sup>small</sup> stones. Stone was integrated into rest of the unit.

I should note that the clean up for the photo yesterday became slightly unnecessary as I decided that the photo itself was not required at this stage.

No structure was apparent in the formation of the large and more visible stones in the square.

It is worth noting that at the centre of the trench was dominated by a large amount of rubble (mostly large pieces) which may be part of a structure.

~~AB~~ changed to unit

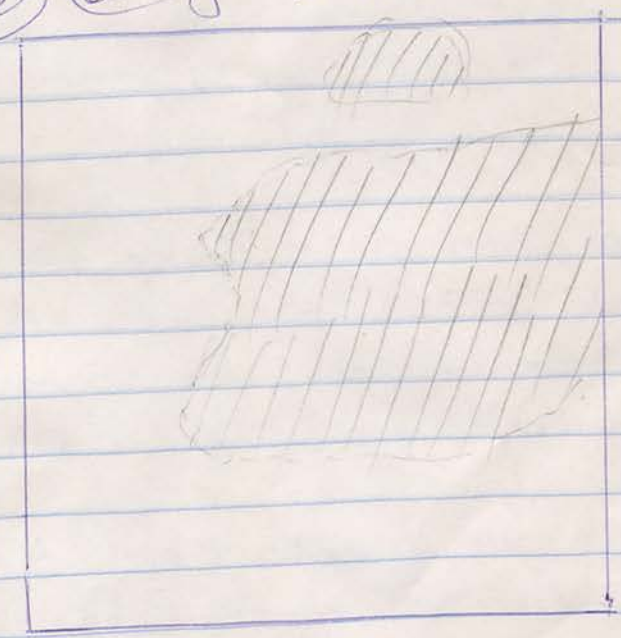

 areas of a greater density of large rubble.

Photo Roll 2: 4+5

taken from E end w/ ends

final photo for 149/2 (2).



AB after some consideration unit 149/2 (2) should be merged with 149/2 (1) (22/9) to form a single unit. Thus unit 149/2 (3) is effectively the 2nd unit stratigraphically.

(Context 2, spit 3)  
Commenced unit 149/2 (3) on 29/9 post-morning break. ~~Removal commenced~~ Work commenced with the removal of the stones only from the N<sup>th</sup> 1m strip of the square, in a bid to open a window into trench.

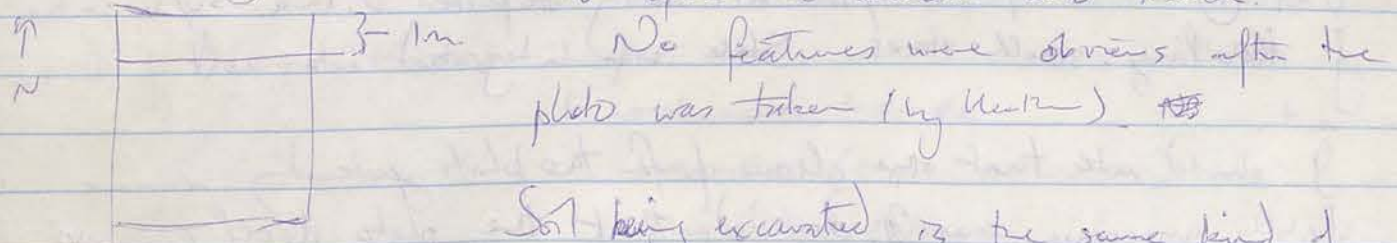

Soil being excavated is the same kind of compacted light brown/tan coloured matrix with a lot of stone remaining - mostly well sized. The boundary of the 1m strip was defined (roughly) by a few large blocks. - Jonas believes they represent a wall.

Pottery Analysis for 29/9/96

Trench 149/2 Spit (2) (Context 1)

1 small bag of pottery

Body Shards: 21

- Diagnostics:
- 1 jar rim
  - 1 possible jar rim
  - 1 pythos rim
  - 1 amphora handle
  - 1 other handle
  - 1 amphora neck



Pottery Analysis for 30/9/96

Trench 149/2 Spit (3) (Context 2)

1 medium bag of pottery

Body Shards: 36, including a small fragment of BOV

Diagnostics: 1 jar rim  
1 bowl rim  
1 small amphora handle (?)  
4 ring bases

DQ 149/2 (3) context 2 30/9

Continued excavating spit (3), finishing the 1m cut strip before manganite. The soil at this level essentially the same as (2) and (1), although a slightly darker brown. Small rock chips scattered throughout.

Decided to continue removing loose stones from the rest of the trench, still to be called spit (3).

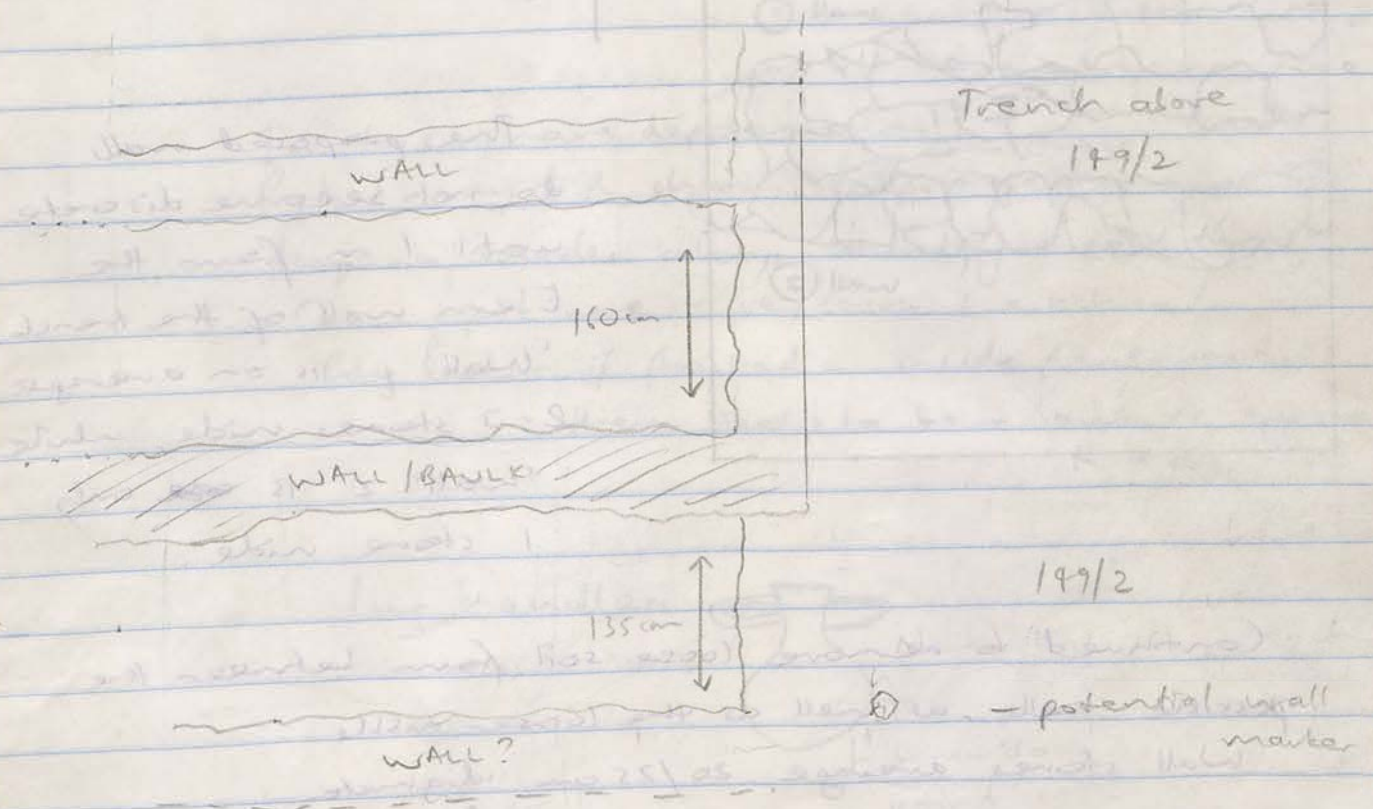

The trench above 149/2, 149/3 has a 50 cm wider cut than the present E'ern boundary of 149/2. This means that the continuation of the E'ern wall will not be definite until more spits have been removed.

A large piece of rock outside the trench on the E side could indicate the starting point of a wall from outside 149/2, as shown in diagram. The spacing between the wall + baulk wall in 149/3, and that between the wall baulk + proposed wall in 149/2



is not appreciably different.

By 10 pm further work on spit 3 progressing. I had further defined the proposed wall, and added the possibility of a second wall.

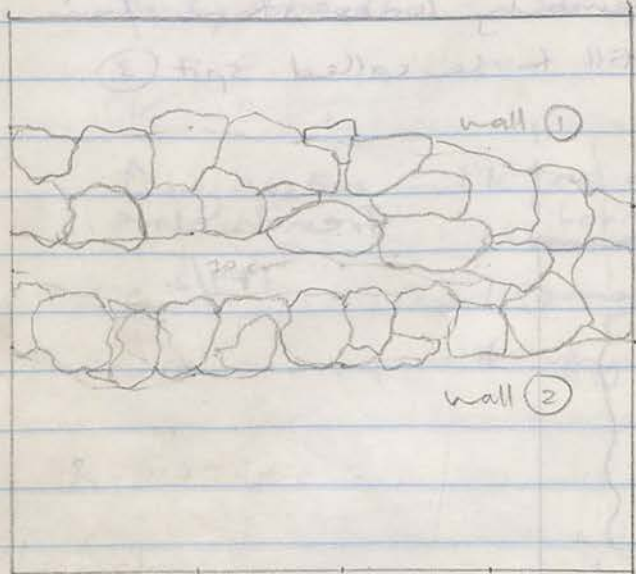

The proposed walls do not become discrete until 1 m from the E'ern wall of the trench. 'Wall' 1 is on average 2-3 stones wide, while 'wall' 2 is only 1 stone wide.

Continued to remove loose soil from between the possible walls, as well as the looser rubble. Wall stones average 20/25 cm diameter.

~~Expected to find bases~~

RIMS  
HANDLES  
BASES  
OTHERS

TINA

MAHMOUD

Tina

Mahmoud

MOUSSA

Moussa

Tar tops have depressions. 3'  
Pythos - very thick, chunky, tall storage jar  
Amphora handles always round & solid through  
Cooking pot ware - very coarse & a rich red  
Rhy bases - if finished on inside (ie exposed) then likely to be a bowl as opposed to a jug.

lug handle





Pottery Analysis for ~~1/10/96~~ 1/10/96

Spit (3) (Context 3)

1 medium bag of pottery

Body Shards: 33; including some 80v

Diagnostics: 1 jar rim  
1 roughedged rim  
1 amphora handle  
2 rhy bases

1/10/96  
~~3/1~~

DQ 149/2

Continuation of regularity of spit (3) if not below 'wall' 2.  
Discovery of a piece of opalescent material around  
tree (i.e. trench) (3) ~~Tree~~ - so far an  
isolated find. Marked

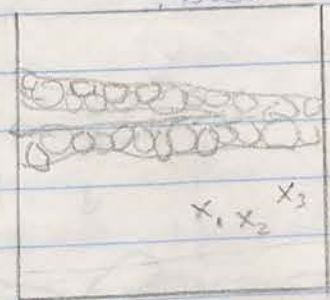

↑ #1 : already known the map  
(artefacts found  
within 20 cm width. Note that by the  
width of each  
other) area being  
excavated to the

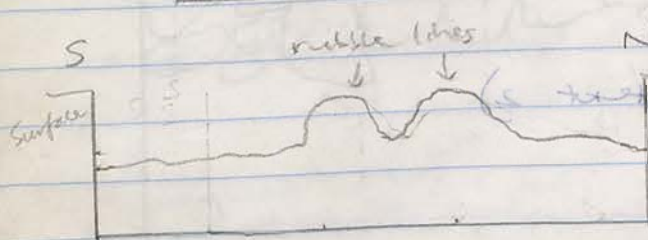

depth of excavated to the  
end of context 3 spit (3).  
1/10/96  
Although still not  
sure if this

represents a wall -  
boulders are an irregular shape, size and not  
uniformly positioned but they do represent a straight line  
and may be associated with different artefacts than <sup>scatter</sup> surrounding  
Another opalescent artefact - Tuma says ~~found~~ <sup>glass -</sup> found  
at 8am. Marked as X<sub>2</sub>.

Small bone scatter through loose soil marked at X<sub>2</sub>.

Post marginia swapped drills for hammers and  
cleaned up ~~the~~ along the proposed wall line (2)  
Clearly below the wall ~~was~~ further exposed  
some rubble jutting out as a potential side wall  
in the SE corner of the trench. ~~the rubble~~

Soil still contains scattered shell fragments,  as well  
as large amounts of hornet (?) nests among the rocks.  
~~Today but depths remain from trench to east of~~  
~~today. It is marked as above diagram.~~



Pottery Analysis for 2/10/96

2 v. small bags of pottery

Spit (3) (context 3) cont.

Body Shards: 14

Diagnostics: 1 jar rim

Spit (4) (context 2)

Body Shards: 6

Diagnostics: 1 jar rim  
1 eroded rim  
1 eroded ring base  
1 ring base  
1 ring base minus the core

ΔQ

149/2

2/10/96

Can 3, spit (3)

(Continuation of removal of ~~spit 3~~) Split team

↑ N into 2 groups; first to continue

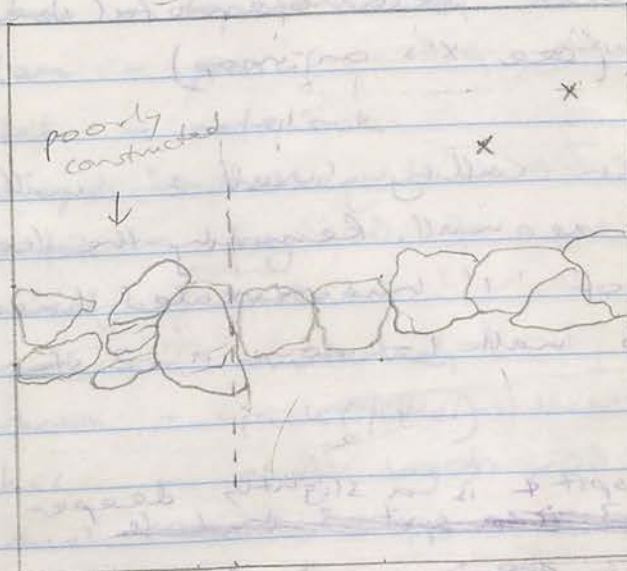

with 3 and the second to remove the middle line that I have noted as wall 1' with progressively more of the

first layer of loose rubble removed from the trench it was clear that it was not a wall. The removal of the rubble took a few hours, and no artefacts were found associated with it. However, a base of flatter rocks, <sup>roughly</sup> beneath 'wall 1' were left standing, as they presented a possible other wall.

Post removal of 'wall 1' we commenced removing a second layer of loose rubble and soil, starting in the NW corner. This has been named ~~spit 4~~ (Context 2, spit 4). This clearly up + the removal of 'wall 1' accentuated the 'wall-like' character of wall '2'; the N'ern face now being revealed + is vertically aligned as the S'ern face. ~~the~~ 'Wall 2' appears to have 2 distinct sections; a well constructed aspect on E'ern and a less aligned, more discordant rubble the W (see diagram).



Perhaps the shoddier part is representative of an extension, ~~at~~ a poor repair job, or collapsed rubble filling a doorway.

Post mangani, 2 small pieces of metal were found - 1 a coin. (see X's on map)

What I have been calling 'wall 2' will now be referred to as a wall. Remarking the loose, more irregular blocks of '1' has revealed base stones connected to wall 1 - now a 2 stone wide wall.

Soil in ~~context 2, spit 4~~ context 2, spit 4 is a slightly deeper ~~soil in context 2, spit 4~~ brown than previous spits. Not distinctly different to show up in a cross section, but I feel there has been a slow gradation. Otherwise soil same composition as before.

ARABIC DICTIONARY

Tools

Objects

- |  |                           |
|--|---------------------------|
| metah - tape measure                     | faham - charcoal          |
| allam - pencil                           | jedar - wall              |
| kiteb - notebook                         | hajir - stone             |
| mahayah - rubber                         | trab - soil               |
| shuntah - bag                            | aziz - glass              |
| zambeel - basket                         | hadid - nail              |
| trawl - mustah                           | masari - coin             |
| netkoosh - pick (little)                 | tannour - oven            |
| kis - plastic bag                        | bas - doorway / threshold |
| mustah - milk                            | fakhār - pottery          |
|  | azm - bone                |
|  | jidar - wall              |
|  | gornah - corner           |
|  | arth - floor              |
| shway shway - go slow, stop              | lazem - must do           |
| shugel - work                            | shugel - work             |
| tanzire - cleaning                       | yeller - get to it!       |
| leeish - why?                            | mafi - haven't got        |
| kroof - glove                            | shtanner sway - wait      |
| afwan - you're welcome                   | gouee - strong            |
| hafir hona - dig here                    |                           |
| min hona illa honak - from here to there |                           |
| abi zambeel - fill the zambeel           |                           |
| abi zambeel trab - " " " with soil       |                           |
| kateer - a lot of                        |                           |
| minfadlak - please                       |                           |



Pottery Analysis for 3/10/96

Spit 10

Spit

Spit (4) (Context 2)

1 medium bag pottery

Body shreds: 80+ including several

Diagonals: jar top rim

1 BOV rim

3 other rims

1 amphora handle fragment

1 handle root

1 ring base

1 red slipped, finely grooved piece of BOV

1 BOV rim

3 other rims

1 amphora handle fragment

1 handle root

1 ring base

1 red slipped, finely grooved piece of BOV

1 BOV rim

3 other rims

1 amphora handle fragment

1 handle root

1 ring base

1 red slipped, finely grooved piece of BOV

1 BOV rim

3 other rims

1 amphora handle fragment

1 handle root

1 ring base

1 red slipped, finely grooved piece of BOV

DR

147/3, part A method

3/10/96

Continuation of removal of spit 4, context 2; the second layer of the wall.

Several interesting items found to light today.

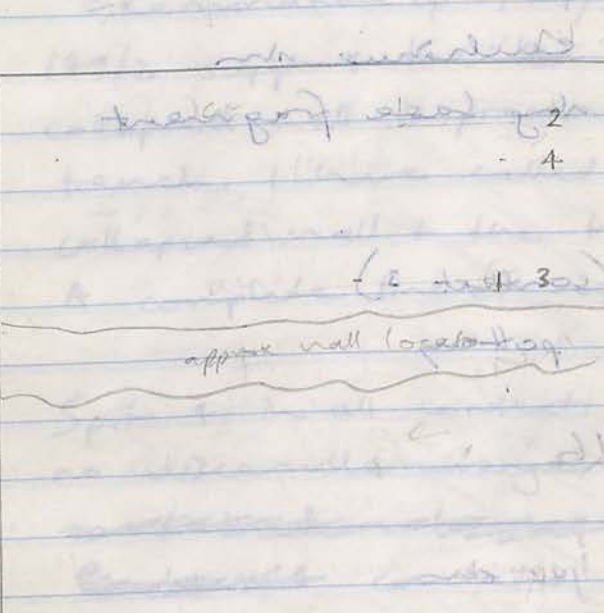

- ① - metal object
- ② - 2 small silt glass
- ③ - loom weight
- ④ - poss. 2 pondering weights

All these artefacts found at a depth between 120 - 125 cm below soil level. By end of day had cleared spit 4 from <sup>North</sup> half of context 2.

At this stage smears of grey ash were visible - at this stage too scattered to be considered a floor but will reexamine this next week. A few prods with the trowel indicate we are within approx 5cm of bedrock.

Also today removed the looser, poorly constructed top layer of rocks on the western end of the wall.



Pottery Analysis for 7/10/96

1 small bag pottery

Spit ⑦ (context 2)

Body sherds: 27

Diagnostics: 1 eukhine rim  
1 rhy base fragment

Spit ④ (context 3)

1 small bag pottery

Body Sherds: 16

Diagnostics: 1 jar rim  
2 jar rims with red slips  
1 partial rhy base

Spit ④ (context 4)

1 ~~small~~ bag pottery  
med.

Body Sherds: 33

Diagnostics: 1 jar top rim  
2 unknown rims  
1 handle root  
1 round base  
1 rhy base  
2 pieces of pottery  
with an opalescent green glaze

DQ

149/2

7/10/96

Continuation of removal of spit 4, context 2.  
Also commenced removal of spit 4, context 3, and  
spit 4, context 4. (see diagram)

Examination of 149/3 + of others to the S of  
149/2 support the hypothesis that a semi-  
collapsed wall is present in the SE corner of the  
trench. I have called the area between the  
collapsed wall + the trench border context 4.  
A complete line of rocks is not yet discernible.

Spit 4 in all contexts consisted of loose rubble in  
no discernible arrangement. In context 4 it also  
~~contained a large quantity of charcoal~~  
contains charcoal flecks and smears  
of grey ash. Removal of spit 4 in all  
contexts revealed patches of grey ash also.

By late afternoon spit 4 was removed in all  
contexts and excavation of a non rubble layer  
commenced - spit 5.

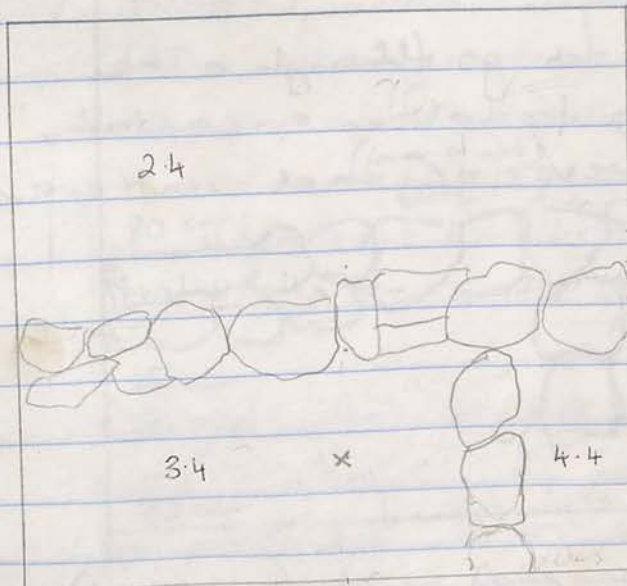

map indicates  
location of 2  
coils found in  
spit 5, and  
also the  
position of  
the small side  
wall.  
X - coils  
found  
at 100 cm depth



Notified today of official numbering system of contexts + spits - vertical + horizontal. Have adjusted notes and artefact tags to correspond to this system. Below is a representation of current contexts.

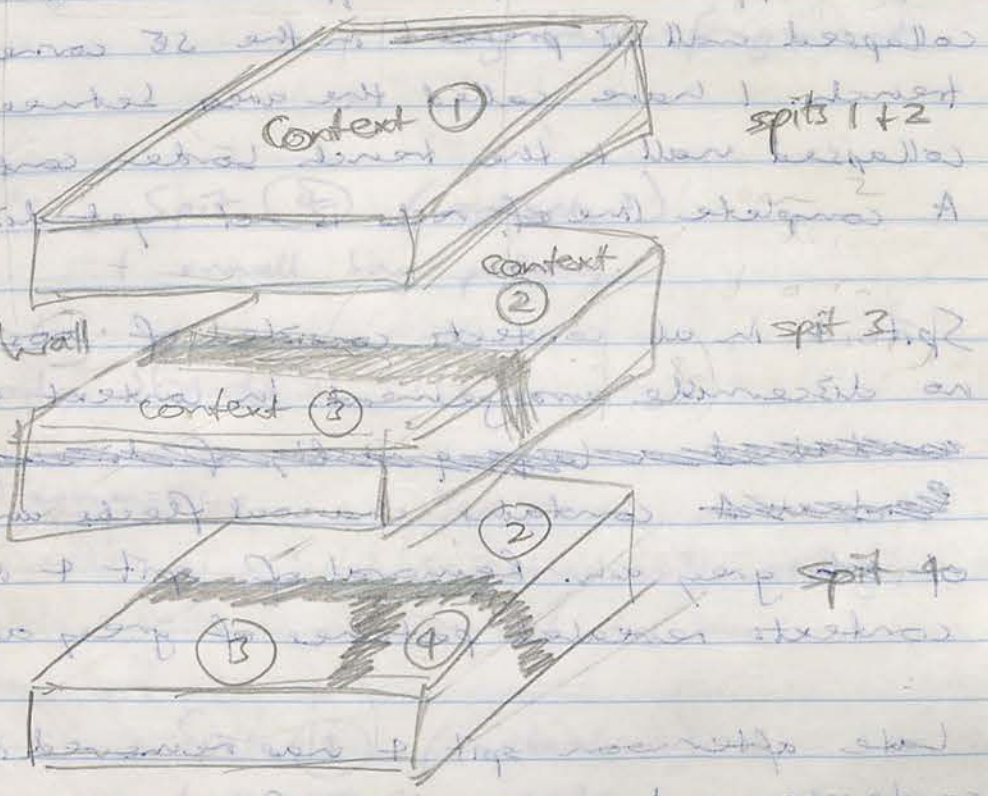

...decided to go through a new ... is grey ... + cartab, ... small pieces of red ...  
 ... 2-tigs ...  
 ... contexts

This morning revealed that spit 5 was associated with a potential floor. A compacted light brown soil with smears of grey was identified in both context 2 + 3. Area 5T456

Context 2 at this level also showed a patch of deep red soil adhering to the floor, possibly an indication of approaching bedrock.

Context 4 area showed the greatest density of charcoal flakes. At this time I had also ascertained that the SE small wall ~~was not~~ stopped short of the 51cm trench boundary.

Whole trench cleared up for photo (roll 2, CP33). ~~Another reason for~~ A piece of glass was found on the edge of context 3 + 4 during this process.

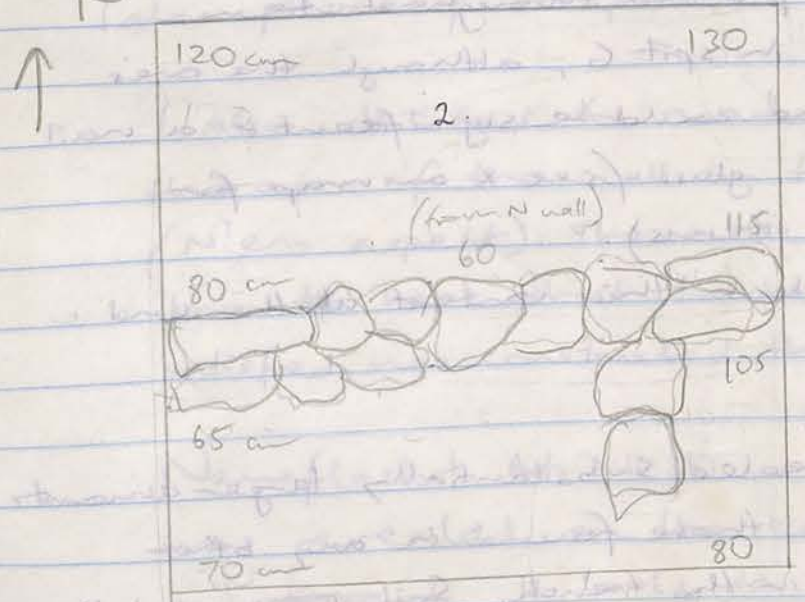

(depth levels taken from nearest trench wall)

At three of photo the depth levels were as indicated. Variability in cm below surface level largely due to the angle of the trench, rather than irregularity of the floor surface.



27/01/8

S/P/P/1

2/10

While leaving part of the floor surface intact, backup started excavating 2 further contexts.  
 At this stage it looks as if the main wall may be sitting on bedrock below the floor.

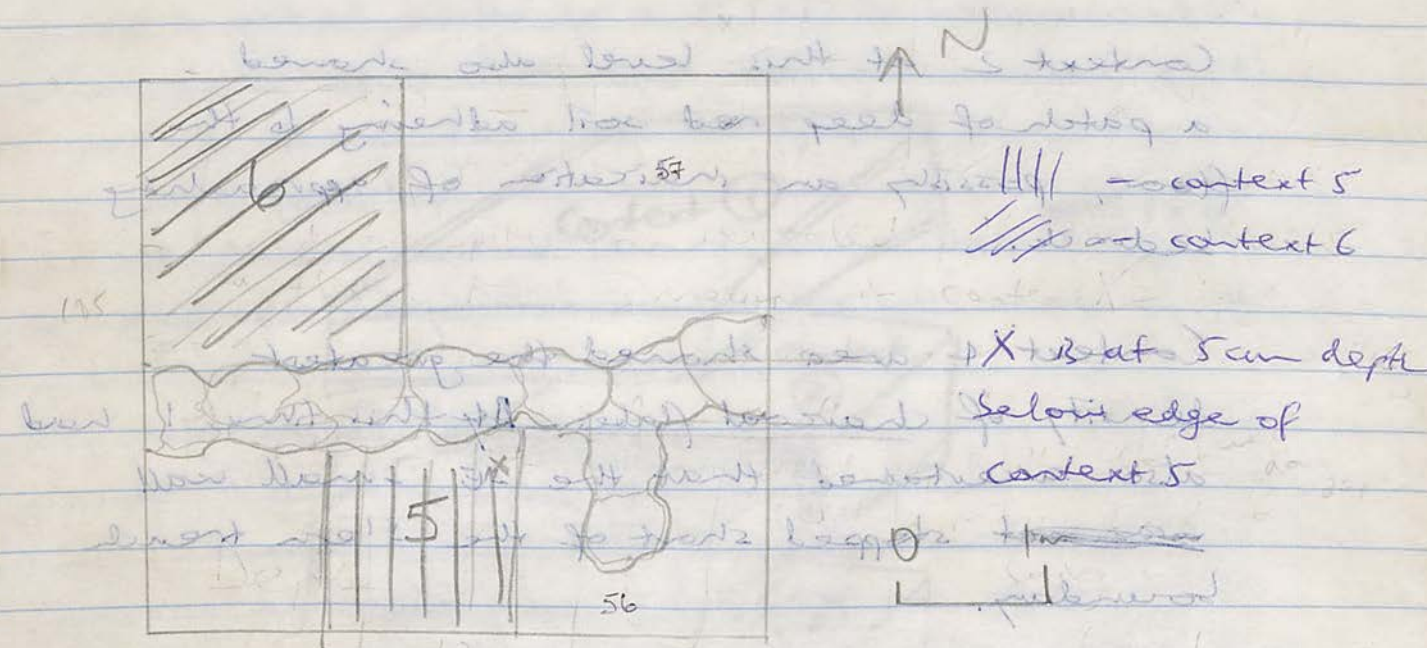

Context 5 contains a yellow aged, mid-brown soil with grey patches throughout. Few artefacts found in spit 6, although the ones that were found could be significant - a nail and 2 pieces of glass (see X on map for position of these items).

Revealed bedrock in this context at the end of the day.  
 Spit 6 of Context 6 revealed substantially larger amounts of pottery than those found in any other spits or contexts in the trench. Soil is a slightly deeper brown than context 5 contains scattered

charcoal flecks + more grey patches. Also a red smear of soil - either indicating closeness to bedrock or perhaps the remains of a disintegrated piece of cookware ~~given~~ given the patches of ash which may be linked to cooking activities. Reexamined what I have referred to as the more makeshift section of the central wall. From the S'ern aspect of the wall there are

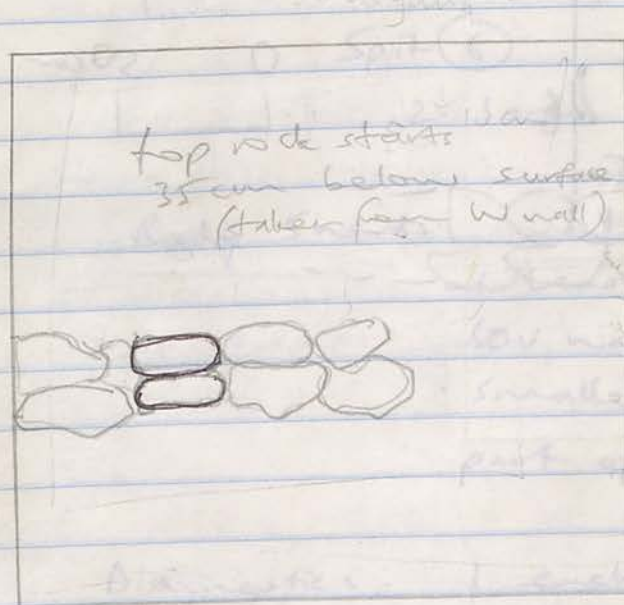

now visible. 2 rectangular blocks atop of one another (diagram). These rocks are more carefully shaped than any other ~~stone~~ stone.

~~The wall~~ ~~was~~ ~~made~~ ~~of~~ ~~these~~ ~~stones~~ ~~to~~ ~~make~~ ~~the~~ ~~wall~~, and I believe may represent threshold stones from a later phase of occupation. DOORWAY?

I also decided to move some rocks from this area of the wall on the other side (N'ern aspect). There is still an irregular line ~~to~~ here that I am not completely satisfied was constructed that way.

Newflesh! At 11:30 a tannour (oven) was revealed on the edge of context 6. ~~sp~~ ~~is~~ ~~it~~ ~~looks~~ ~~in~~ ~~poor~~ ~~condition~~ - I imagine only a  $\frac{1}{4}$  remains of the whole oven.



perhaps most of the pottery recovered from this context is related to food preparation - maybe when the oven fell into disuse it was filled in with broken bowls, and perhaps other household refuse.

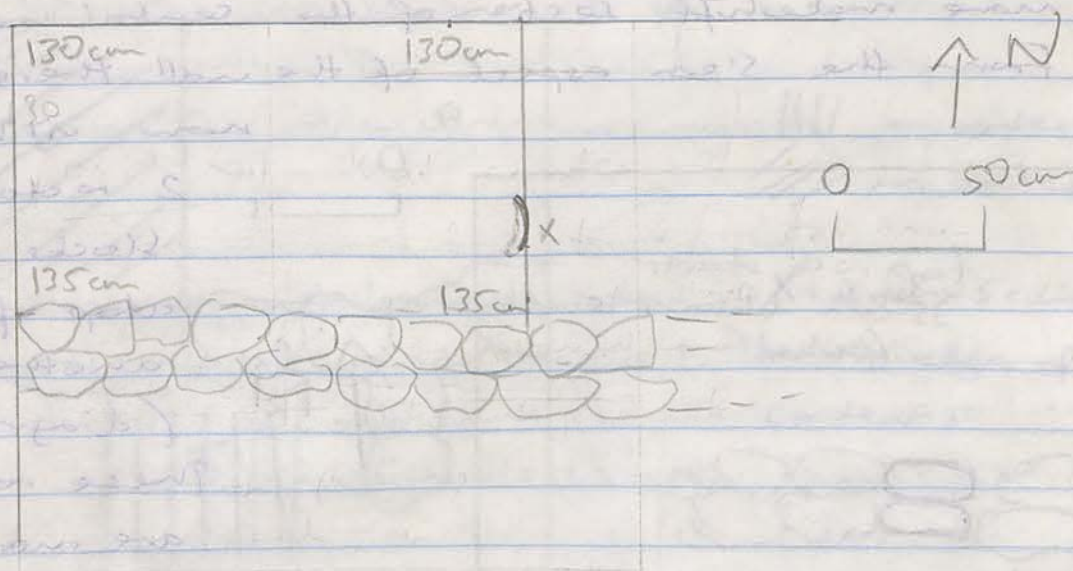

X - tannour

Levels taken at end of context 6, spit (6).

Pottery Analysis for 2/10/96

Spit (5) (Context 2)

1 small bag

Body Shards: 3

Diagnostics: 1 roof tile

Spit (6) (Context 6)

2 large bags - pydirt!

Body Shards: 148

at least a third of these are KOV ware. Some of the smaller fragments may form part of the tannour. Also pythos ware.

Diagnostics: 1 eukhinos rim

1 jar rim

1 red slipped jar? rim

1 burnt jar rim

1 amphora handle

2 jar strap handles fragment

1 jar strap handle + matching roof

1 amphora base

1 rhyg base

Spit (5) (Context 3)

1 small bag

Body Shards: 14

~~14~~



Pottery Analysis for 8/10/96 - continued

- (5) Diagnostics: 2 rhy bases
- 1 small fragment of a rhy base (red slipped)
  - 2 other red slipped pieces, one with flattened river pebble (thrown out)

(2 + 2) (2) 1/2

Pottery Analysis for 9/10/96

with pottery recovered.

Trench 149/2

9/10/96

Cleaned up tannow for a photo (Roll 3, 1+2)

Have not yet reached bedrock in context 6, but as we are otherwise close to finishing the trench Heather has requested an extension of the western boundary of the trench. This will tie line up 149/2 with 149/3 to the N, and reveal the continuation of a N/S wall from 149/3. It will also hopefully reveal whether the north wall has collapsed rubble as part of it. Have put the excavation of another spit in context 6 on hold until we have moved a few spits from this new addition to the trench - otherwise I feel falling rubble and soil will risk the integrity of the spit.

Context 1, Spit 1 of the western extension consists of the removal of topsoil with loose small fragments of rubble.

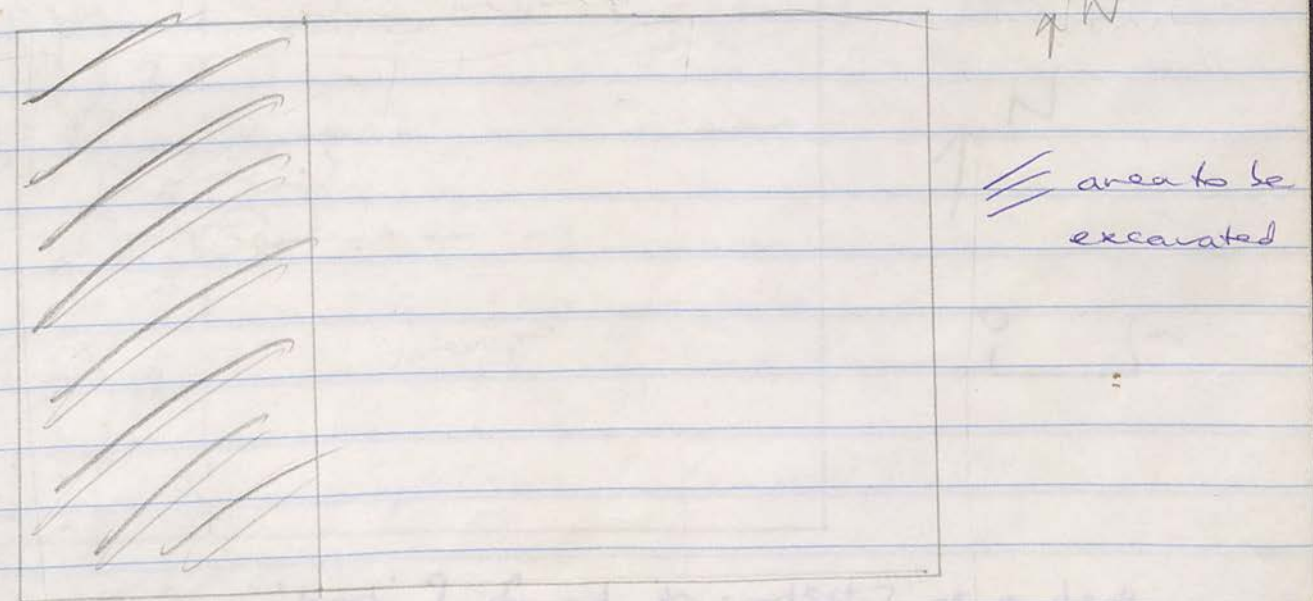



10/10/96

post mangaria which I had at the Acropolis,  
the N/S wall was visible amongst the rubble  
of the topsoil. Have ~~renamed~~ renamed spit 1 <sup>as</sup> spit 1/2,  
as the topsoil was divided into 2 spits in the  
rest of the trench. I feel this is unnecessary  
but have made the name change so the next  
spit, spit 3, will correspond with spit 3 in the  
rest of the trench.

20/01/01

149/2

10/10/96

Continuation of removal of W'ern section cont. 1,  
spit 1/2. All tags and comments relating to  
the W'ern extension from now on will have a  
(W) next to the context/spit no. to distinguish it  
from the rest of the trench.

Soil in spit 1/2 same as for spits 1 + 2 in the  
rest of the trench. Light brown with ~~scattered~~ Scatters of  
pebbles throughout. Reached a depth of 10cm below  
surface level across (W). ~~Started~~  
Started removing spit 3 (W) just after 7am. This  
involves removing the loose larger pieces of rubble  
contained in the soil of spit 1/2.

As the N/S wall and the continuation of the E-W  
wall can be seen, I have decided to break up  
spit 3 into separate contexts. Context <sup>2</sup> spit 3 (W) is  
a continuation of <sup>spit 3</sup> cont. 2 and context <sup>3</sup> <sup>spit 3 (W)</sup> of ~~cont. 3~~ cont. 7,  
spit 3.

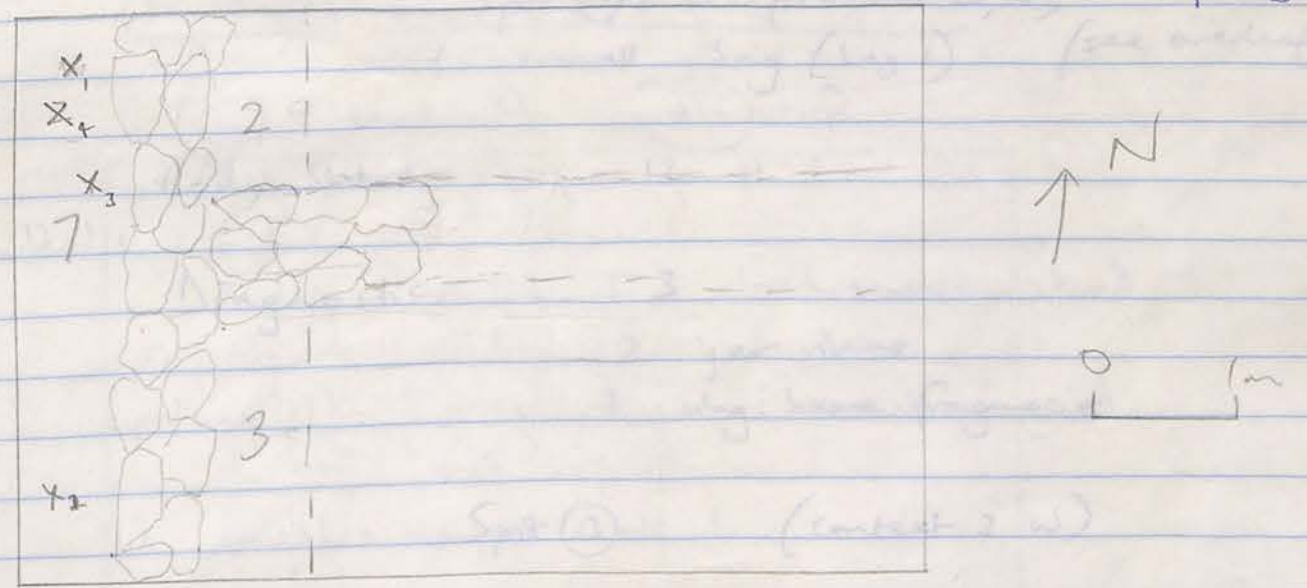

a metal 'hook' found in context 7 at a depth  
of 30 cm, 40 cm from the N/S wall. (X<sub>1</sub> on map)

7/1/96



10/10/96

A corroded square of metal also found in context 7 at a depth of 10cm (X<sub>1</sub> on map)

Also another metal object (X<sub>2</sub>), and a very large nail (X<sub>4</sub>). Both found at 10cm depth.

Another metal hook/nail in 2 fragments found at 7 position.

Two lines of rock layers now visible on the Wern face of the NS wall. It is much better constructed than the EW wall; the stones are more uniformly shaped and aligned - perhaps an indication that it is an external/structurally supportive wall, rather than a less important interior wall.

Pottery Analysis for 10/10/96

12/10/96

Spit (3) (context 7)

1 medium bag

Body Shards: 33  
a few pieces with red slip

Diagnostics: 20

- 1 large jar rim
- 2 smaller jar rims
- 4 eukhinos rim fragments
- 4 other rim fragments
- 1 thickened handle
- 1 jug handle
- 3 ring base fragments
- 2 amphora bottoms
- 1 amphora holder fragment
- 1 embossed + red slipped shard

Spit (3/4) (context 2, w)

1 small bag (bag 1) (see overleaf)

Body Shards: 13

Diagnostics: 3  
2 jar rims  
1 ring base fragment

Spit (3) (context 3, w)

Body Shards: 2

Diagnostics: 1 eukhinos rim  
2 ring bases  
1 engraved pottery fragment

PTD



Pottery Analysis for 12/10/96

10/10/96

Spit (5) (Cont. 7)

1 tiny bag

Body Shards : 2

Diagnostics : 1 bowl rim

also 1 loom weight

Pottery Analysis for 10/10/96 (continued)

Spit (3/4) (Context 2 (w))

1 tiny bag (bag 2)

Body Shards : 27

Diagnostics : 2

1 jar rim

1 black slipped euclyneus rim

199/2

12/10/96

Spit 3, the first layer of rubble, has been removed from context 7. Spit 3 in contexts 2 + 3 (w) progressively more slowly, as the E face of the N/S wall is proving harder to define.

8:30 am - have decided to combine spits 3 and 4 in the (w) section as there has been no level at which rubble is not present, however briefly. The division of rubble layers into spits 3 + 4 in the rest of the trench may be viewed as unnecessary.

Few artefacts have been recovered from contexts (2) + (3) at spit 3/4, which is another reason why the distinction between the 2 spits is unnecessary.

A tiny fragment found in context 3, spit 3/4 at a depth of 75 cm below <sup>surface of S trench boundary</sup> ~~surface of S trench boundary~~.

A nail found in context 2, spit 3/4, at a depth of 100 cm below surface of N trench boundary.

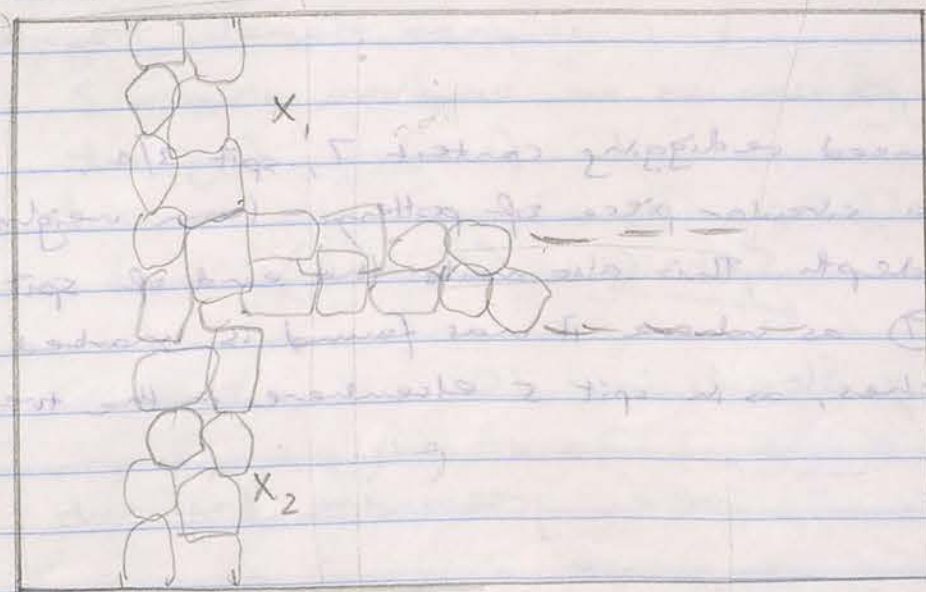

X1 - nail

X2 - tiny



By mangaria have hit bedrock in context 2 (w) spit 3/4. Unlike ~~the rest of~~ the rest of context 2, spit 3/4 was not followed by a ~~mix~~ mix of ash pattern in the soil + a floor. Instead we moved straight to bedrock at approximately depth of the floor in the rest of context 2.

The absence of floor adjacent to the N/S wall could mean construction occurred post floor establishment. No floors often near wall.

Levels at end of spit 3/4, context 7.

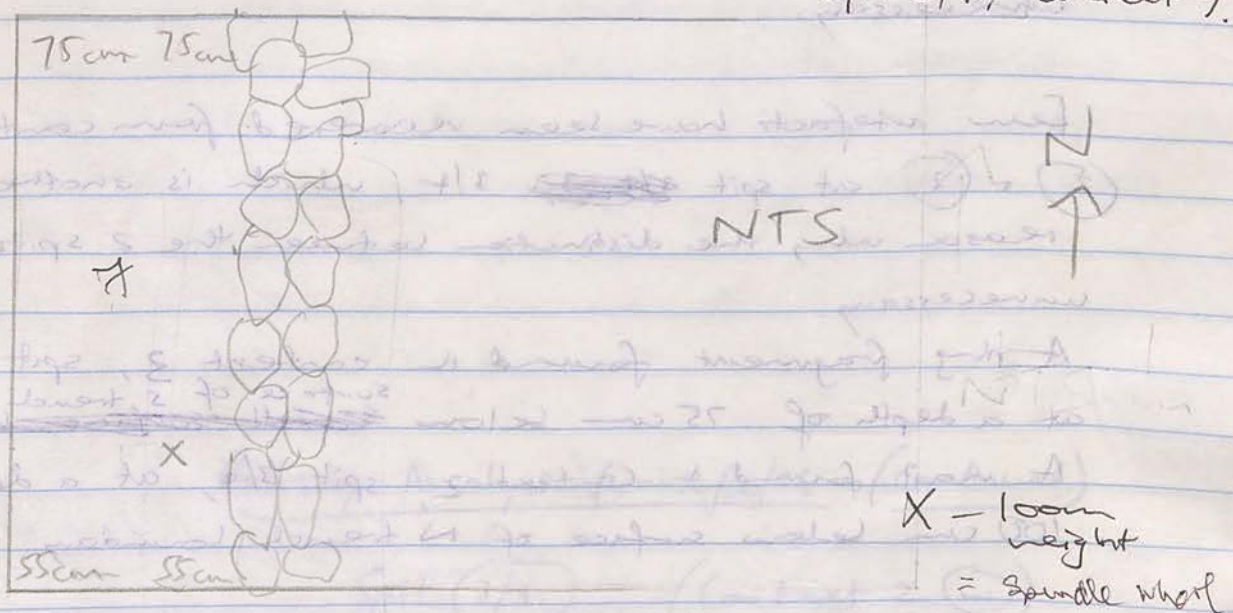

Commenced redigging context 7, spit 3/4.

Found a circular piece of pottery - (loam weight/?) at 50cm depth. This also marks the end of spit 3/4 in cont. (7) as where it was found is marked by ashy patches, as in spit 5 elsewhere in the trench.

loam - X  
pottery - X

Also commenced excavation of spit (6), context 4.

Just before knock off what seems to be an intact small bowl (fish bowl?) atop part of a flatter piece of pottery was located in the corner <sup>North or South?</sup> between the NS + the SW walls in the trench. Have covered it up for now but will photograph tomorrow - because it is wedged between rubble it is likely to break when it is removed.

Context 3 (w) has ~~now reached~~ now reached spit 5 and the floor surface found in the rest of this context will not excavate this section further as jebel has already been reached in the adjacent context 5.



Spit 3/4 (Cont. 3)  
1 small bag

Body Shards : 17  
a few burnt pieces

Diagnostics : 1 rhy base

Spit 5 (Cont. 7)  
1 med. bag

Body Shards : 11

Diagnostics : 10  
 3 jar rims  
 1 piecrust rim fragment  
 1 pythos ware rim  
 2 jar handles  
 1 amphora handle  
 1 amphora handle fragment  
 reuse as an amphora stopper?  
 1 flat base fragment

Spit 6 (Cont. 4)

Body Shards : 10

some greenware fragments

no diagnostics

Continued excavation of spit (5), context 7. Hoping to find evidence of the road surface that can be glimpsed in other trenches to the N.

\* The torso of a figurine discovered early this morning, at a depth of 80cm below the W. wall of the trench. (X<sub>1</sub>)

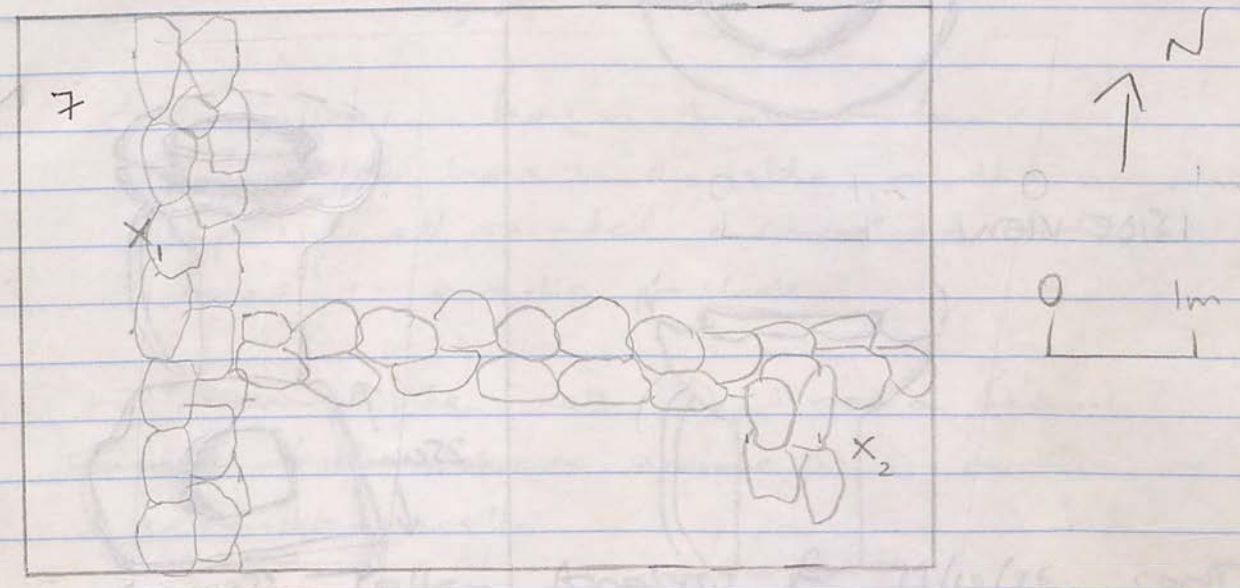

A small glass lead found in spit (6), context 4, at a depth of 115cm. (X<sub>2</sub>)

Cleaned up the soil discovered late yesterday for a photo, with careful brushing it now seems to be a bowl atop a jug. The squarish shoulder sitting in front of it ~~was~~ has been revealed as a quern. Cf. vol 3, shots 16, 17 + 18.



The presence of the quorn <sup>is presumably</sup> ~~is~~ linked to the pounding stones discovered in an earlier spit.

AERIAL VIEW

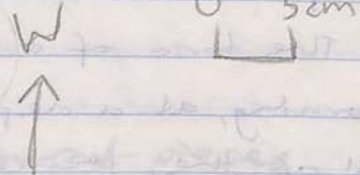
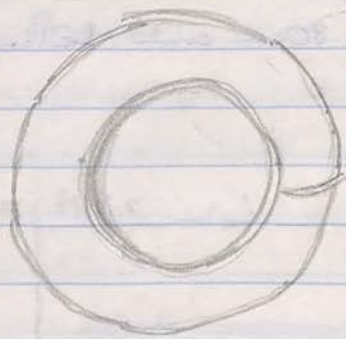

SIDE VIEW



Hole - 15cm diameter

Commenced excavating spit ⑦, context 6.

Had stopped excavating this context previously when the tannour had been discovered, in ~~the same spit~~ ~~to dig~~ ~~between~~ ~~spit~~ spit ⑥.

Continued tidying up the NE surface of the NS wall. The wall has collapsed in this section, and there are ~~large~~ boulders from the wall at its base.

13/10/96

Finished spit ⑤, context 7 which led to bedrock. No trace of the roadway at all.

14/10/96 : Photos taken of finished trench 149/2  
RW: 18: 13-16

- the NS + EW walls are primary -  
sitly on bedrock

- the quorn has a hole on top + a smaller hole in the side - the one on top is well rounded + smoothed but not deep - maybe posthole?

- the small side wall (?) is not a bedrock - unsure if remains or assume it is remains of a secondary wall.

Pottery Analysis for 13/10/96 cont...

- clearing up of NE surface of NS wall. Face did not Spit 7 the (Cont. 6) wall. In this section / on this face the wall has body sherds ~~of~~ 14 top. Base wall still appear to be intact.

No Diagnostics



TRENCH 149/2 -

SECTION HALFWAY BETWEEN EW WALL AND SOUTHERN TRENCH BULK.

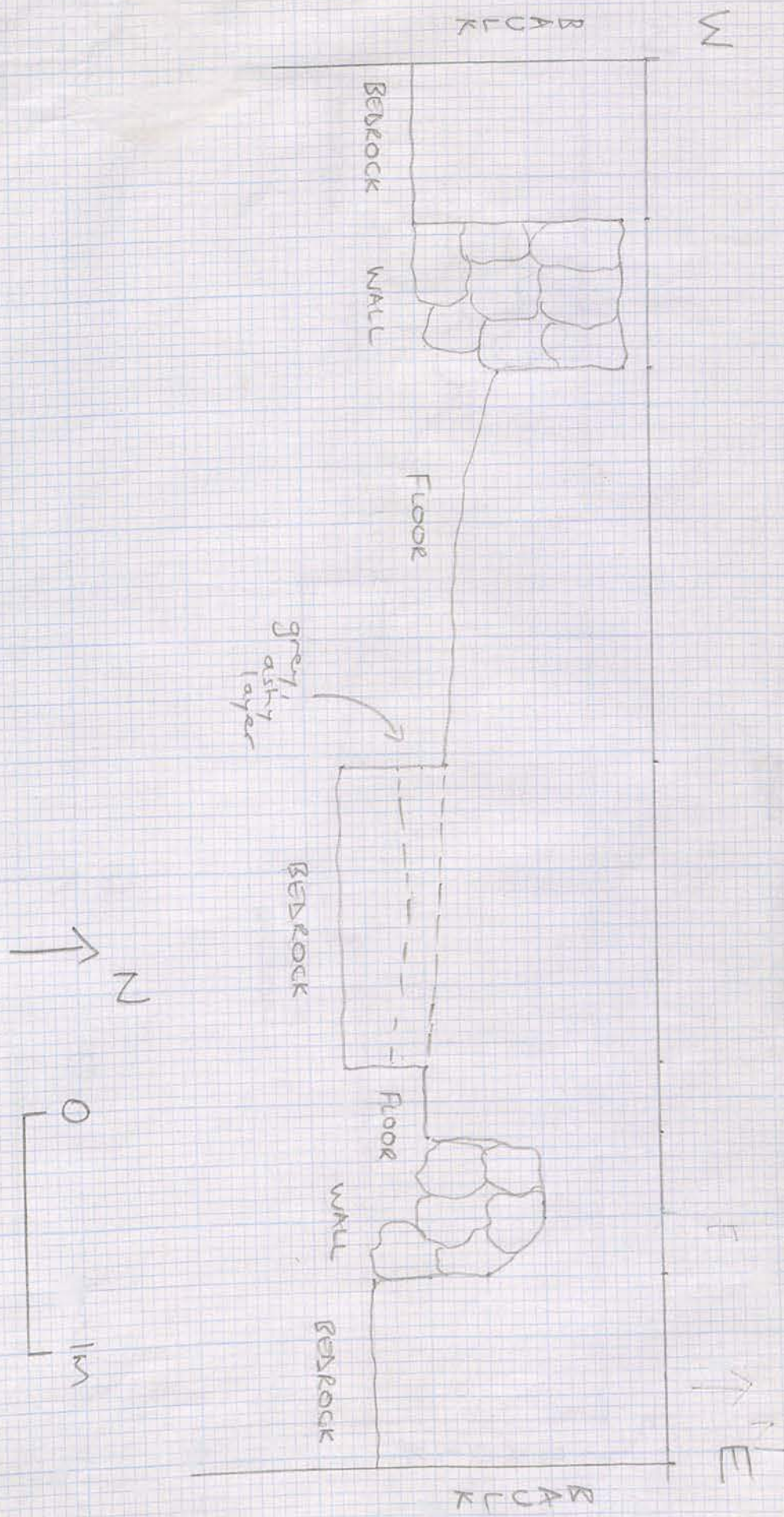

Arch 50.

12/10/92

No trace of the ... of the ...

14/10/92: Photos taken of finished trench 149/2  
18:13-16

Pattern analysis for 10/10/92 cont.

Fig 3 (cont.)

1/11/92



TRENCH 149/2

SECTION HALEWAY BETWEEN END WALL  
AND NORTHERN TRENCH BAULK

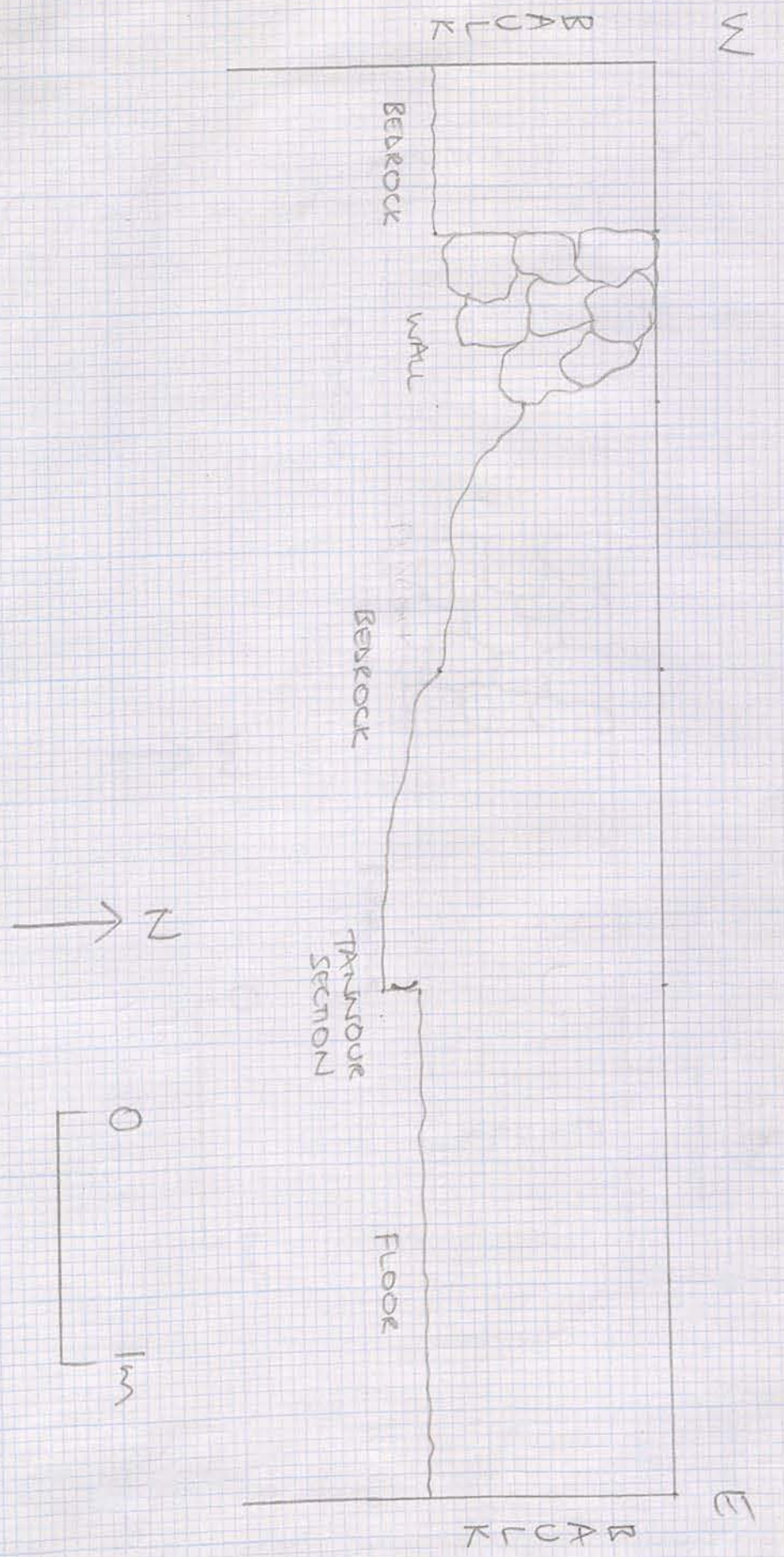

AREA 57

TRENCH 149/2

SECTION HALEWAY BETWEEN END WALL  
AND NORTHERN TRENCH BAULK

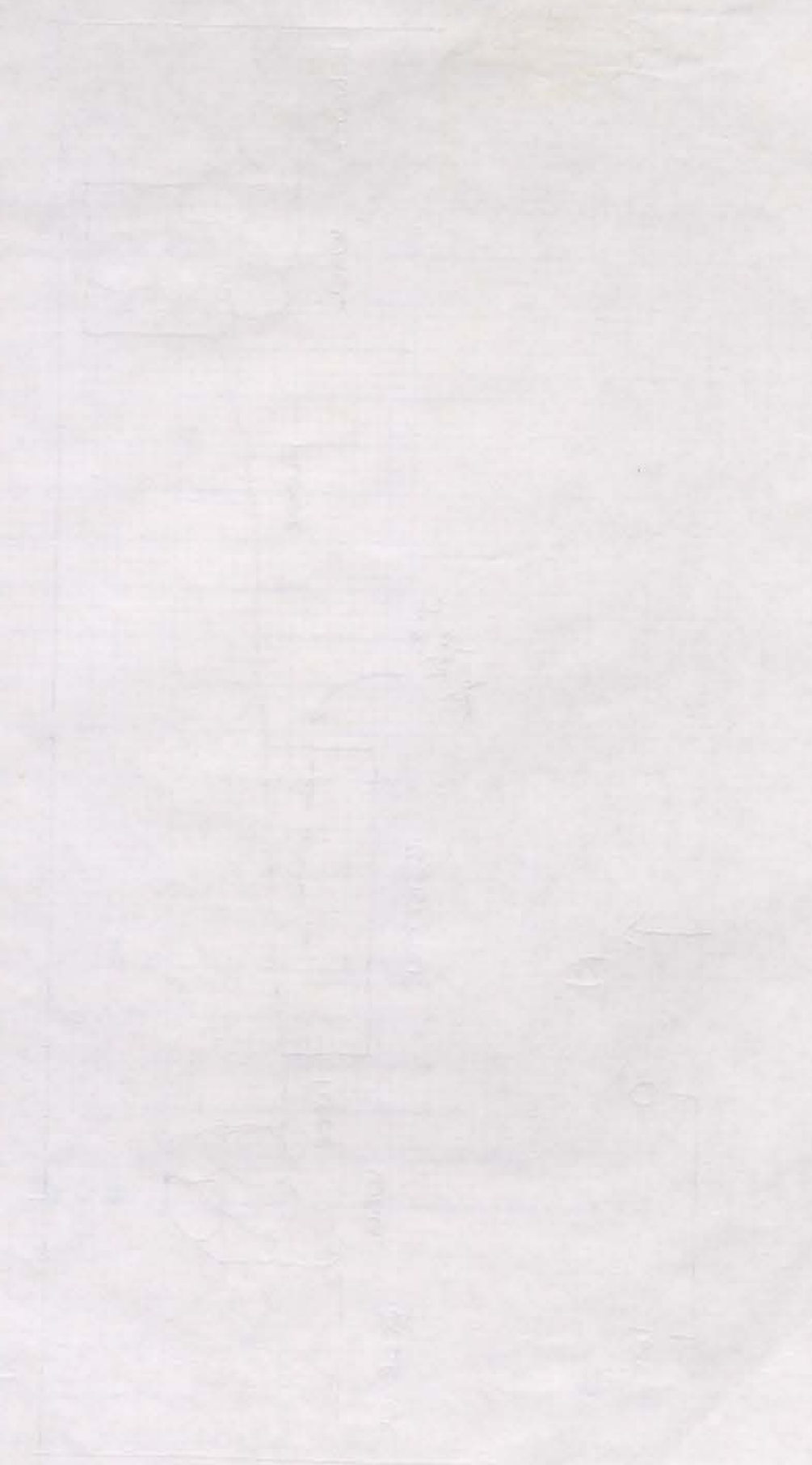



TRENCH 149/2

SECTION HALFWAY BETWEEN NORTHERN AND SOUTHERN TRENCH BANKS

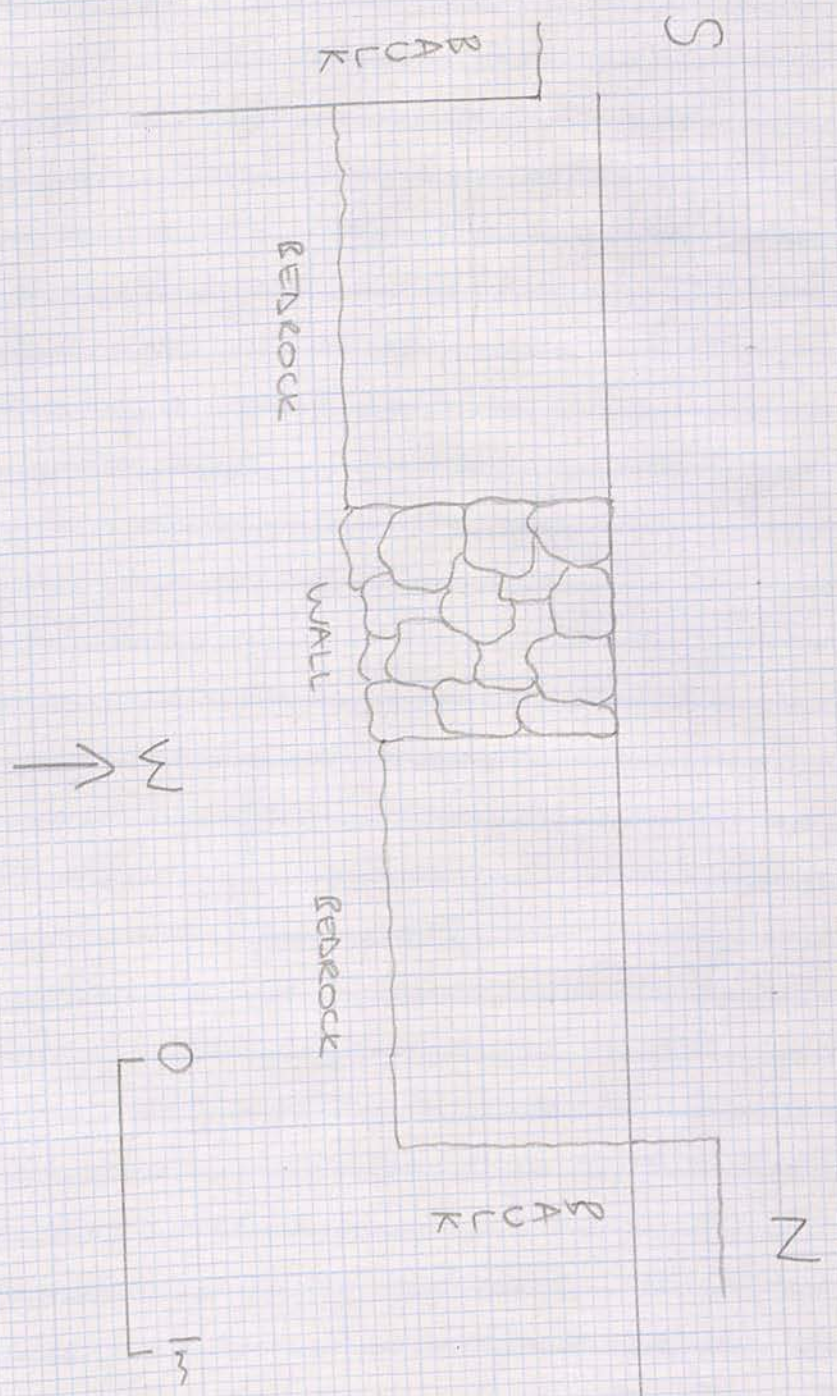

TRENCH 141/3

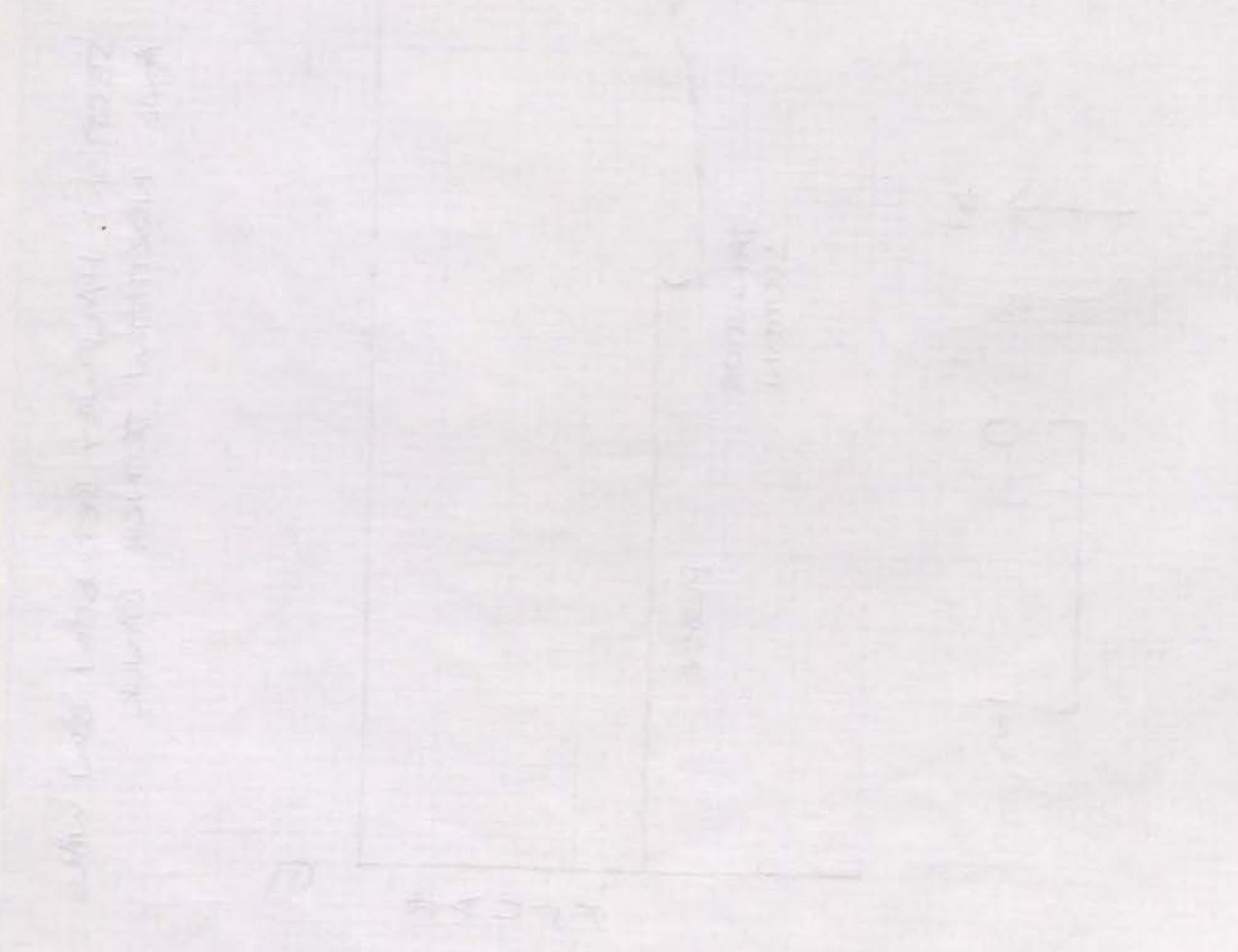



Pottery Analysis 14/10/96 150/4

Spit ① (Context 1)  
1 medium bag

Body Shards : 38

Diagnostics : 2

- 1 jar rim with red slip
- 1 flat base fragment

Trench 150/4

14/10/96

Started to remove some of the spoil heap atop trench 150/4 late yesterday afternoon. Continued to remove spoil today. As there is a large spoil heap sitting against the trench boundaries to the ~~N+W~~<sup>N+W</sup>, will spend some time removing spoil from the bank area to prevent spillage later on.

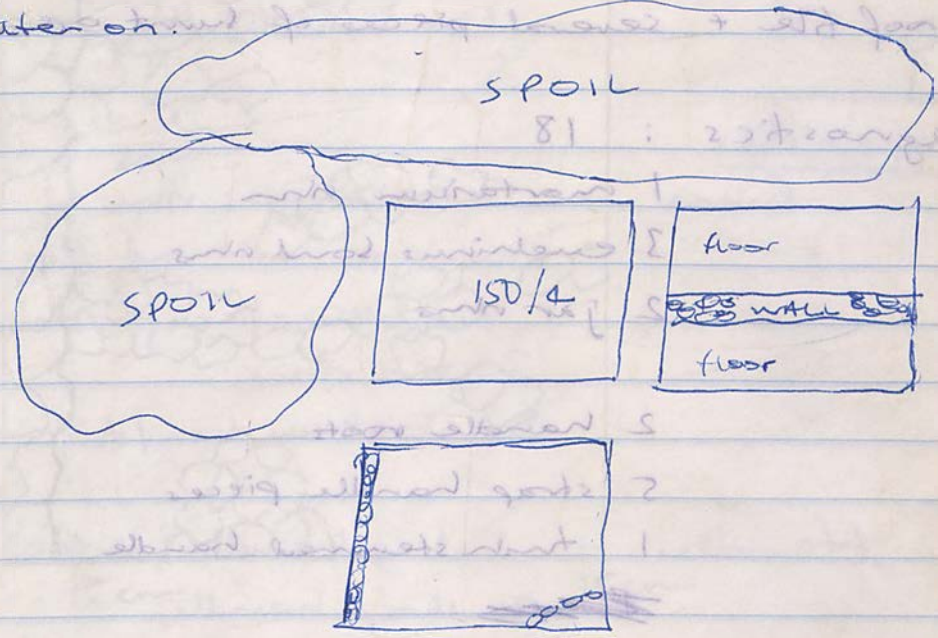

Only clue as to the contents of the trench is a possible wall running E/W, and another N/S in the far W of the trench. Two floors in the trench to the (E). Commenced removing topsoil post mangonia. Soil is pale brown <sup>with</sup> scattered shells, and small pieces of rubble. Called the topsoil spit ①, context 1.

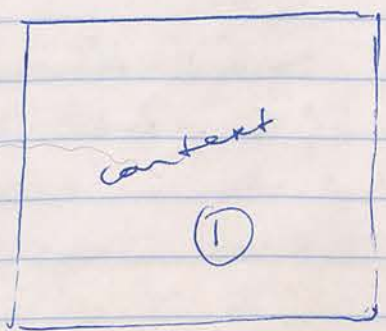



Pottery Analysis for 15/10/96

Spit ① (Context 1)

Body Shards

Including large pieces of pythware,  
1 roof tile + several pieces of burnt ovenware

Diagnostics : 18

1	marianum rim
3	euchinus bowl rims
2	jar rims
2	handle roots
5	strap handle pieces
1	thin stemmed handle

2 ring base pieces

③ and 4 lamp fragment bagged for objects

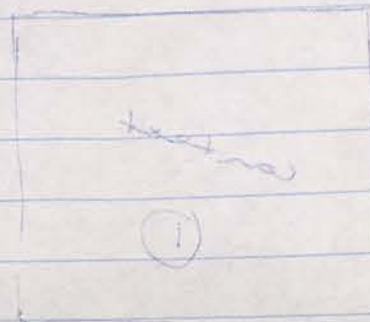

28/10/150/4

15/10/96

Continued to remove topsoil (spit ①).

An outline ~~of a wall~~ of a wall is starting to take shape along the Wern trench boundary, in line with the trench below.

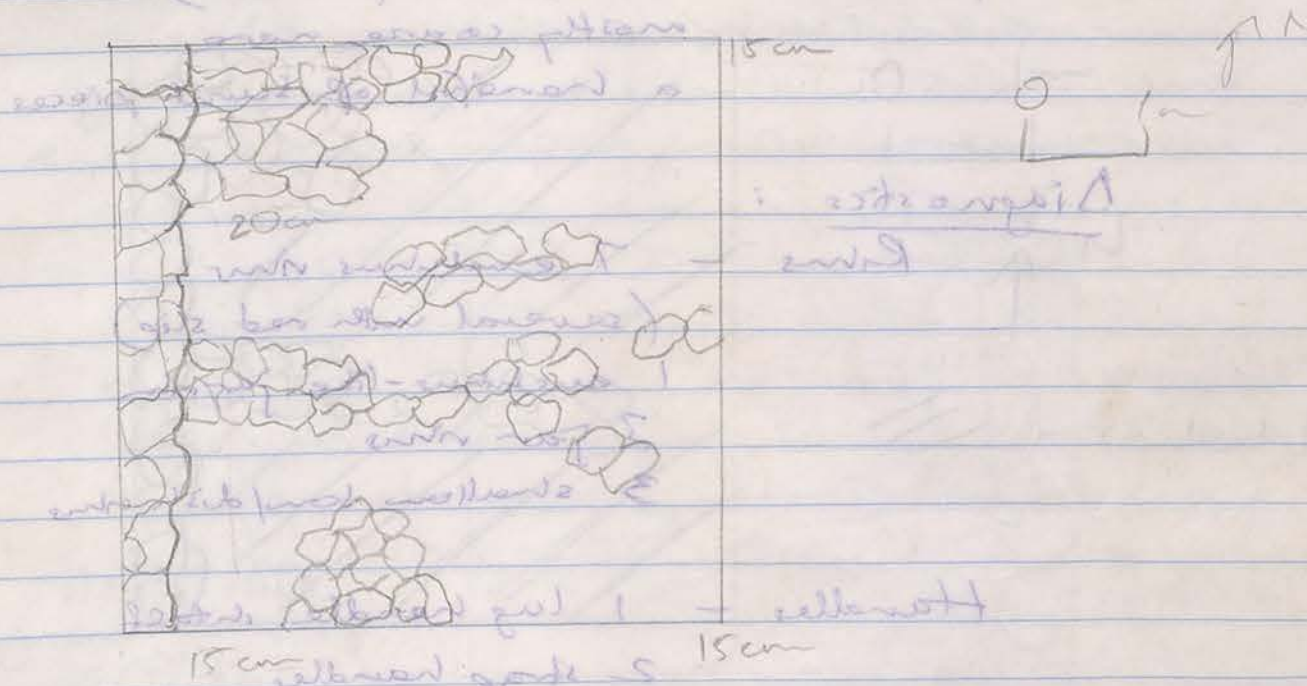

By the end of the day the relative position of rubble piles to each other resembled the diagram above. Only the NS wall appears constructed; will start to remove some of the rubble tomorrow.

Depths of soil at end of spit ① as marked on diagram

295



16/10/96

Pottery Analysis for 16/10/96

(1) Spit (2) (cont. 1)

2 large lugs

Body sherds: 118 including  
1 roof tile (chucked)  
mostly coarse ware  
a handful of burnt pieces

Diagnostics:

- Rims - 7 everted rims  
(several with red slip)
- 1 everted-like jar rim
- 3 jar rims
- 3 shallow bowl/dish rims

Handles - 1 lug handle intact  
2 strap handles

Bases - 2 intact nby bases  
7 nby base fragments

150/4

16/10/96

Commenced making larger pieces of rubble today; context 1, spit (2). Soil is the same colour/consistency etc as topsoil - however at this depth we are not encountering dead plants.

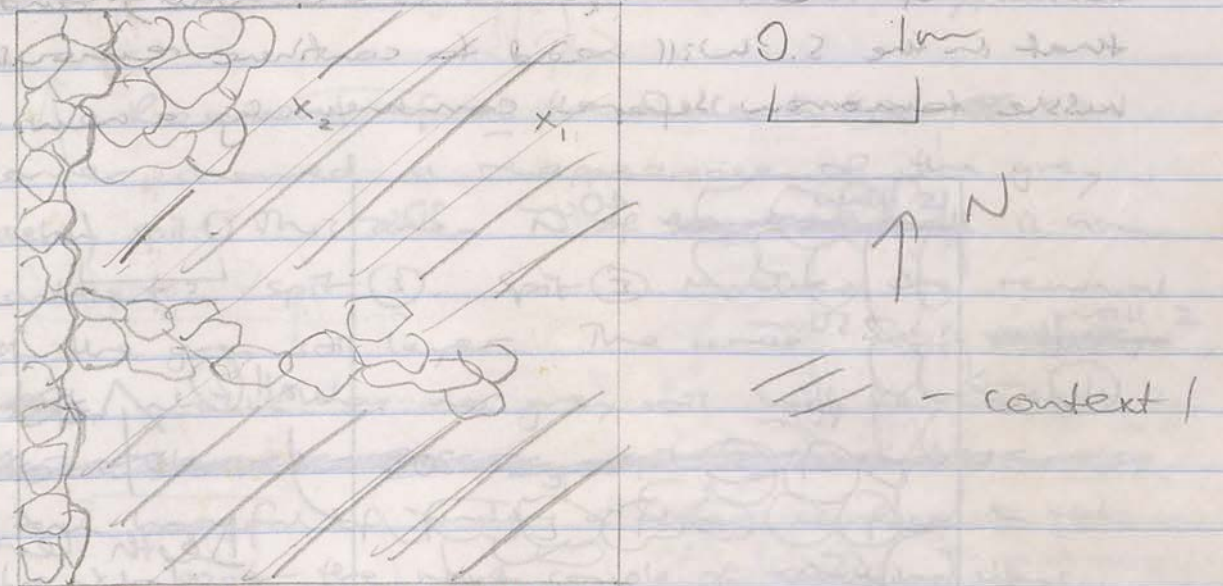

Will aim for photo possibly after mangania or tomorrow, by which time further structures may be revealed beneath the rubble.

X<sub>2</sub> - an opalescent glazed piece of pottery gr. glz. at a depth of 40 cm below N south line

X<sub>1</sub> - a figurine fragment at a depth of 25 cm from ELEM south line.

Post mangania a change in soil colour was evident. Soil changed from light brown to an ash colour - will keep removing soil to see if this is an isolated patch restricted to N corner or if it represents a new



soil type overall.

By close of day it was evident that the ashly smear was restricted to the ~~the~~ <sup>Niem section</sup> of the trench. No sign of a tannour or cooking pot - maybe pottery fragments will assist interpretation.

Have removed the majority of rubble in the NW corner of the trench (next to the wall), and that in the S. Will need to continue removing rubble tomorrow before commencing a new spit.

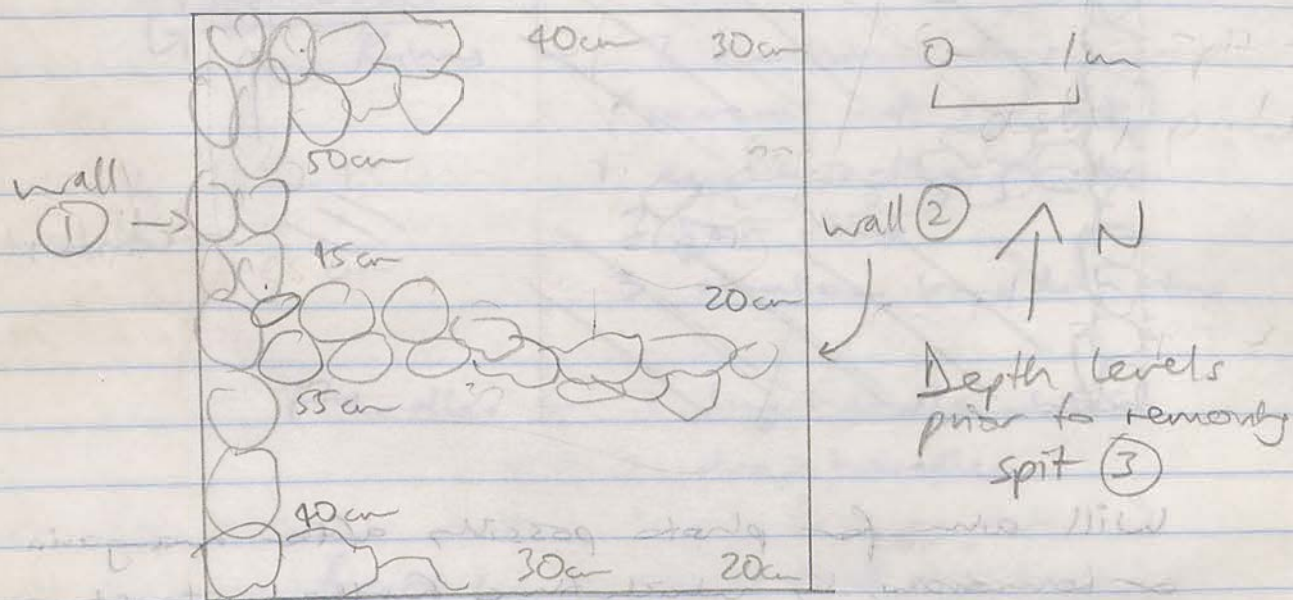

The EW wall, <sup>on its S face</sup> well defined at the Niem end to a depth of 2 boulders, although this definition tapers out after 2m. The presence of this wall and the ashly smear in the N part of the trench, has indicated a change in context for the next spit.

N/S wall - now referred to as wall 1  
E/W wall - now referred to as wall 2

150/4

17/10/96

Continuation of spit (2); removal of rubble + associated soil in the NW and SW sections of the trench.

Possibility that a wall runs through the Niem trench (wall 2) was raised today.

Removal of all the rubble in the NW corner showed a reappearance of the grey ashly soil. This area N of ~~the~~ <sup>wall 2</sup> wall is now context 2, spit (3). Spit (3) involves the removal of the grey soil layer. The area S of ~~the~~ <sup>wall 2</sup> wall, which has no grey soil, will be context 2. ~~Spit (3) involves the removal of the grey soil layer.~~

Am hopeful of finding a floor surface in the trench over the next couple of working days, judging by the trench to the right of 150/4.

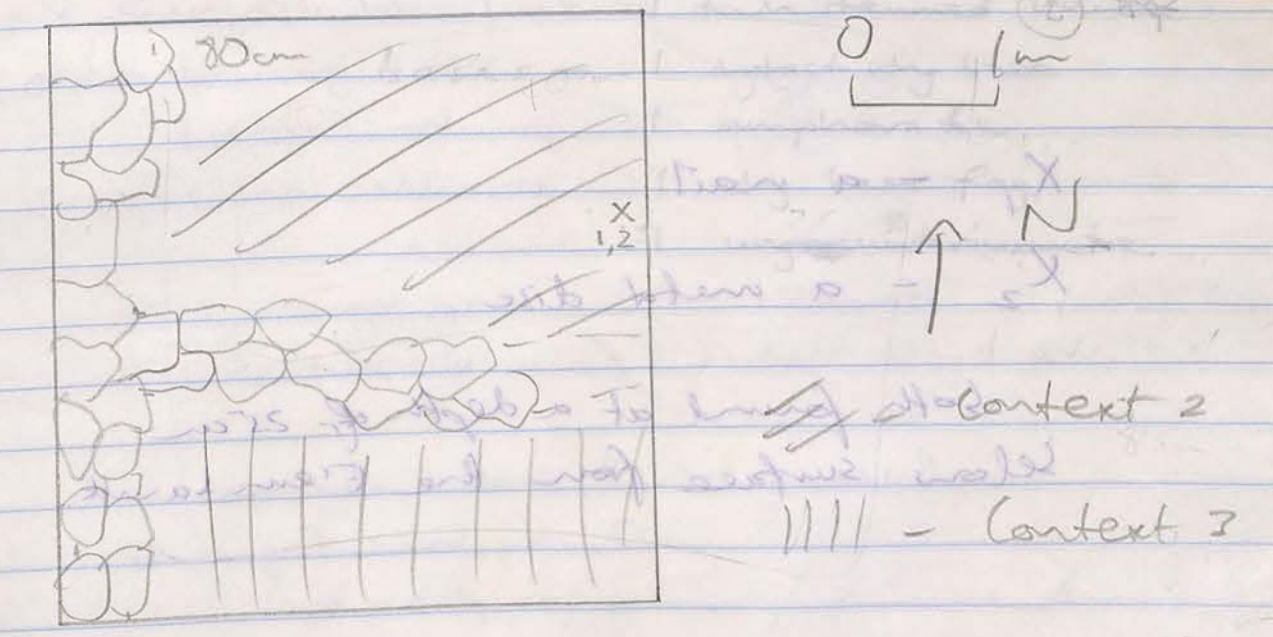

80cm - depth of top of spit (3) after rubble removal.

(wall 2) at depth of 80cm



The grey ashy soil is fine + powdery in consistency when compared to the gritty, coarser topsoil.

Remarkably spit (3) in context 2 has outlined the second layer of rock on the W. face of the EW wall. While the top of the EW wall still looks slightly uneven with miscellaneous rubble at the E. end, ~~the~~ the second layer of stones have provided a sharp boundary for the wall that pulls it in line with the trench.

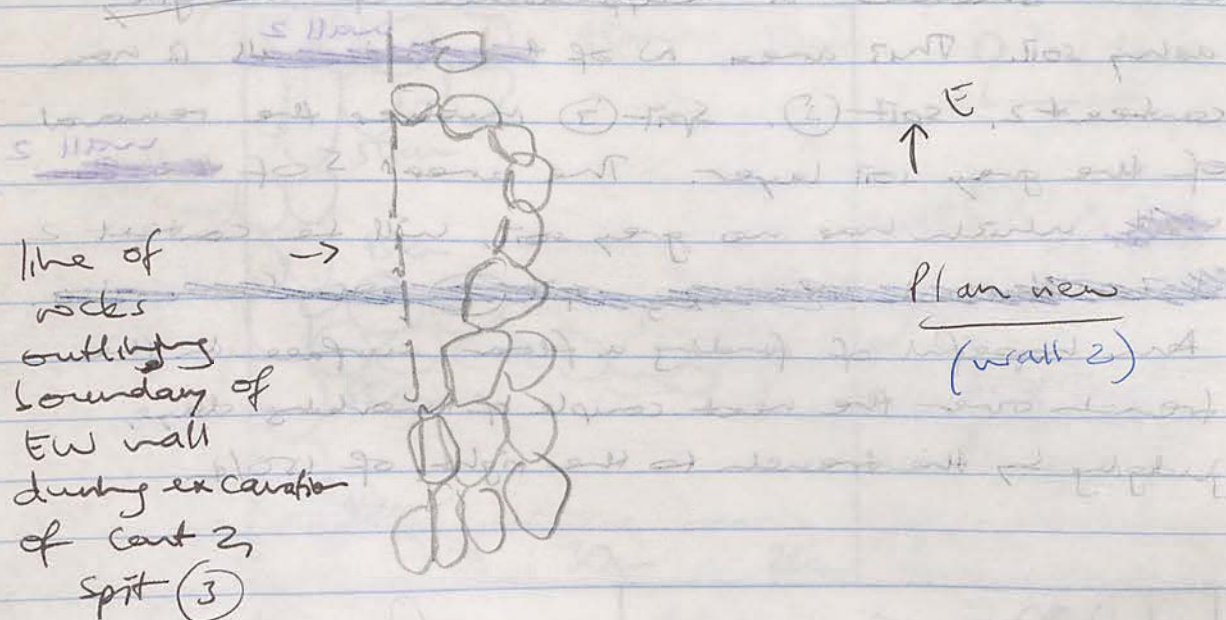

X<sub>1</sub> - a nail

X<sub>2</sub> - a metal disc

Both found at a depth of 25cm below surface from the E. end bank.

150/4 Rotten Analysis for 17/10/76

(5 + Spit (2)) (Cont. 1) (1.0A)  
1 medium bag

Body Shards 61 including: -  
1 roof tile  
pythos ware  
a few yellow + red slipped fragments  
basic grooved fragments

Diagnostics : 15

Rims - 3 eukhrus rim

3 jar rims

~~1 small bowl rim fragment~~

1 small bowl rim frag

1 shallow dish frag

Handles - 2 amphora handles

1 twin stemmed handle

Bases - 1 intact rim base

1 amphora base

1 rim base frag

1 unguentarium base



Pottery Analysis for 17/10/96 cont...

BAG (1) Spit (3) (Cont. 2)  
~~Excavation by H. J. ...~~

Body Sherds: 78 including:-  
2 roof tile fragments (chucked)  
Several pieces remain coated  
in ash despite washing  
some red slipped pieces  
pythos ware

Diagnostics: 31  
Rims - 8 shallow bowl/platter  
rim fragments  
(some with red slip)  
10 eukhrus rim frags; some  
with red slip  
1 eukhr. rim frag with black  
slip & grooved markings  
1 jar rim fragment  
1 shoulder/rim fragment  
Handles - 2 strap handles with red slip  
(may be part of 1 handle)  
Bases - 3 intact rhy bases  
3 rhy base fragments  
1 amphora toe  
1 unguitarium toe

Pottery Analysis for 17/10/96 cont...

BAG (2) Spit (3) (Context 2)

Body Sherds: 97 including -  
approx 10 pieces  
~~of BOV~~ (of BOV)  
some red slipped fragments  
mostly ordinary, occasionally  
grooved pieces.

Diagnostics: 46  
Rims - 6 shallow bowl/platter  
fragments, all with slips  
23 eukhrus rim frags; 3  
sharply sun traces  
3 jar rim  
Handles - 1 amphora handle  
2 rim + handle fragments  
1 rim of jar \*  
21 rhy amphora handle  
2 lug handles  
Bases - 3 intact rhy bases  
3 rhy base fragments  
1 rhy base wot  
1 lamp fragment/figure fragment



19/10/96 analysis ~~19/10/96~~

Spit ② (Context 2)

2 large lags

⑤ JAJ

Body Shards : PP80 : mostly coarse pythos ware pieces still coated in ash a few burnt pieces  
EBA? a few red slipped pieces of floor sherds

Diagnostics :

31P

Rims - 9 everted rim fragments (some red slipped, some burnt)  
8 shallow dish/bowl rim fragments

2 jar rim fragments

Handles - 1 possible lug handle + root

Bases - 1 unguitarian base - intact but burnt

3 intact rhy bases

15 ring base fragments

21 rhy base with an opalescent

black glaze and grooves

1 amphora base

(see next page to continue)

150/4

19/10/96

Continuation of removal of spit ③, context 2.

Also started to remove spit ③, context 3.

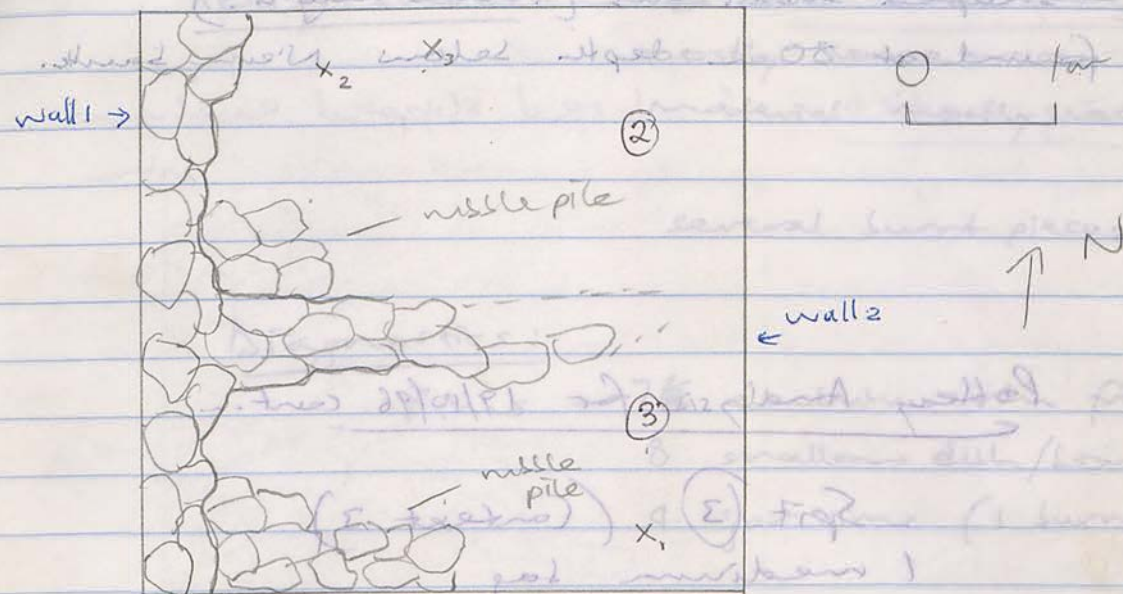

The rubble piles depicted in the ~~drawing~~ drawing became visible during the removal of spit 3. They seem to have no definite form and I anticipate removing them in the next few days. Wall 2 needs to be cleared of rubble also, but as this is less straightforward will let further excavation shed light on which spit blocks on the S. face need to be shifted.

X<sub>1</sub> - nail found in spit 3, context 3.

Great excitement - a stamped amphora handle discovered! X<sub>2</sub> - depth of 95cm below N na bank (Area 40)



Grey soil finally showing signs of thinning out across context 2. Only about half the depth of ashy soil remained in this context & marked on the Niern bank.

X<sub>3</sub> - shaped Lavett slab (100m height?)  
found at 80m depth below Niern bank.

Pottery Analysis for 19/10/96 cont...

Spit (3) (Context 3)  
1 medium bag

Body Shards - 1: 45, slightly helically  
mostly coarse ware type

Diagnostics - 10

Rims - 1 pythos (?) jar rim  
3 shallow bowl/platter rims  
1 enclitus rim with red slip

Handles - 1 handle fragment (jar?)

Bases - 1 intact flat base  
1 fragment rim base  
1 amphora base

1 fragment of pottery with a  
burnt green glaze

Pottery Analysis for 20/10/96

Spit (3) (Context 2)  
1 large bag

Body Shards - 93, helically,  
mostly coarse ware  
material mostly coated in grey ash  
several burnt pieces

Diagnostics

Rims - 7 enclitus rim fragments  
8 shallow dish/bowl fragments  
4 jar rims (1 burnt)

Bases - 2 intact rim bases  
2 rim base fragments

1 possibly pythos rim? / handle  
1 pottery sherd with green glaze

Spit (3) (Context 3)  
1 small bag

Body Shards - 9  
none with slip or detail

Diagnostics - 4  
Rims - 1 jar rim  
1 shallow bowl/platter rim

Bases - 2 rim base fragments



Pottery Analysis for 20/10/96

Spit (4) (Context 2)

1 v. small bag

~~Body Shards~~

Body Shards 4

Diagnostics 1 red slipped enochus

general burnt pieces

Diagnostics:

1 fragment of enochus

1 shallow bowl / foot fragment

(Context 1) - (Context 2)

1 fragment of enochus

1 fragment of enochus

1 fragment of enochus

1 fragment of enochus

(Context 2) - (Context 3)

1 fragment of enochus

Body Shards:

1 fragment of enochus

Diagnostics:

1 fragment of enochus

1 fragment of enochus

1 fragment of enochus

150/4

20/10/96

Continuation of removal of spit (3), context 2, and more slowly in context 3 as well.

Scattered rubble is slowing down the removal of spit 3 in context 3, as the \* 5cm boundary of wall 2 is still unclear.

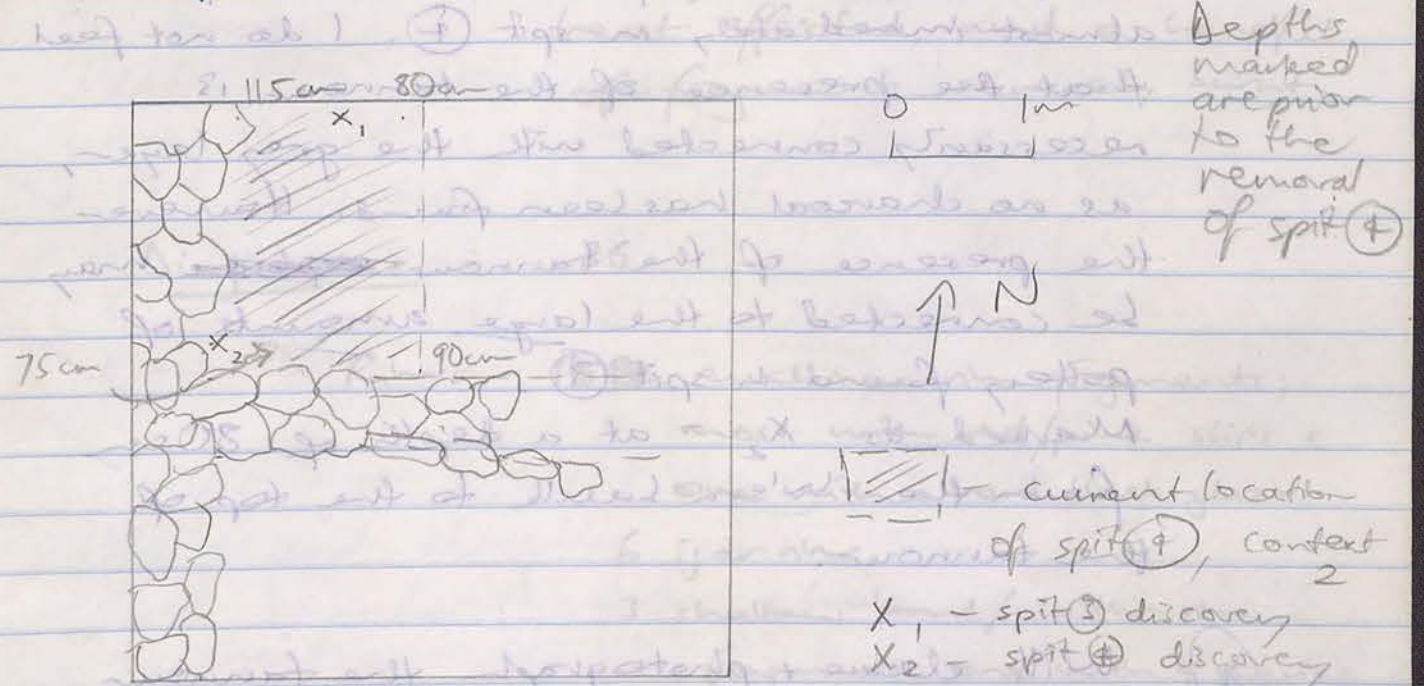

Depths marked are prior to the removal of spit (4)

X - a nail at 80cm depth from N bank

Have now reached the end of the ash grey layer (~~context 2~~) in the west half of context 2.

Have set half the team to remove the next spit of material in this area.

Spit (4), context 2 is a red brown soil, clearly distinguishable from the grey.

Other half of the team will remove the remaining grey layer from the other half of context 2.



4/10/96

The positioning of ~~the~~ spit (4) is marked on the ~~excavation~~ diagram, along with the levels taken before starting to excavate spit (4).

A possible tannour/bread oven(?) found almost immediately in spit (4). I do not feel that the presence of the tannour is necessarily connected with the grey layer, as no charcoal has been found. However the presence of the tannour ~~plate~~ may be connected to the large amounts of pottery found in spit (3).  
Marked as X<sub>2</sub> - at a depth of 30cm from the Wern bank to the top of the tannour.

(\*) Will clean + photograph the tannour tomorrow, as dig camera not on site today.

Found a shaped 'hole' in the NW corner of the trench loosely packed with soil. Probing of the contents reveals that it passes under part of wall (1) - the hole has a supporting wall on one side which I assume helps to buttress wall (1) - maybe a drainage ditch?

Small scatterings of charcoal lagged from spit (4) - found approx 1m E of the tannour/pot warmer.

Pottery Analysis for 2/10/96

Spit (3) (Context 2)

1 large bag

Body Shards: 108 (includes majority of which are heat affected, and a handful of fragments severely burnt)

Diagnostics: 36

- Rims - 15~~3~~ including rim fragments; most with red/pink slips + one with a hard black glaze
- 6 jar rims
- 3 shallow bowl/platter rim fragments; one with a series of fine parallel grooves
- 1 hard black glazed tightly folded rim fragment



- Handles - 1 amphora-handle frag
- 1 lug handle fragment
- 1 strap handle fragment (?)

- Bases - 3 intact nbg bases
- 5 nbg base fragments

1 green glazed pottery fragment



Moulded stone/purri quorn? lagged and put in object box for analysis (from spit 3, cont. 3)

Commenced with continued clearance of (2) (3).

Tannaw cleaning proceeds for photography. Loom weight bag from tannaw - bagged (X1). Assorted shreds removed from same. Some zone from (2) (3) - ? association in tannaw.

Metal/iron ovoid piece bagged (X2) from NE corner. Also possible drainage passage in this section on Nth bank. Will leave till later once all of (2) cleared.

(2) (3) Fine grey ashly earth persists below brown soil (2) (4).

Probable floor evident about (2) (4). Seems this to end abruptly btw 110cm and 140cm from East boundary. Excavation ceased about this spit at depth 70 to 90cm from Nth boundary. Plan: excavation to continue about (2) (3) to dividing wall.

\* Roll 4 33 + 34 - photography of tannaw completed.

\*\* Likely that drain in NW corner consists in drain in NE end of Nth boundary. Will leave to Bethina to decide on excavation possibilities i.e. whether "duct" should be revealed.



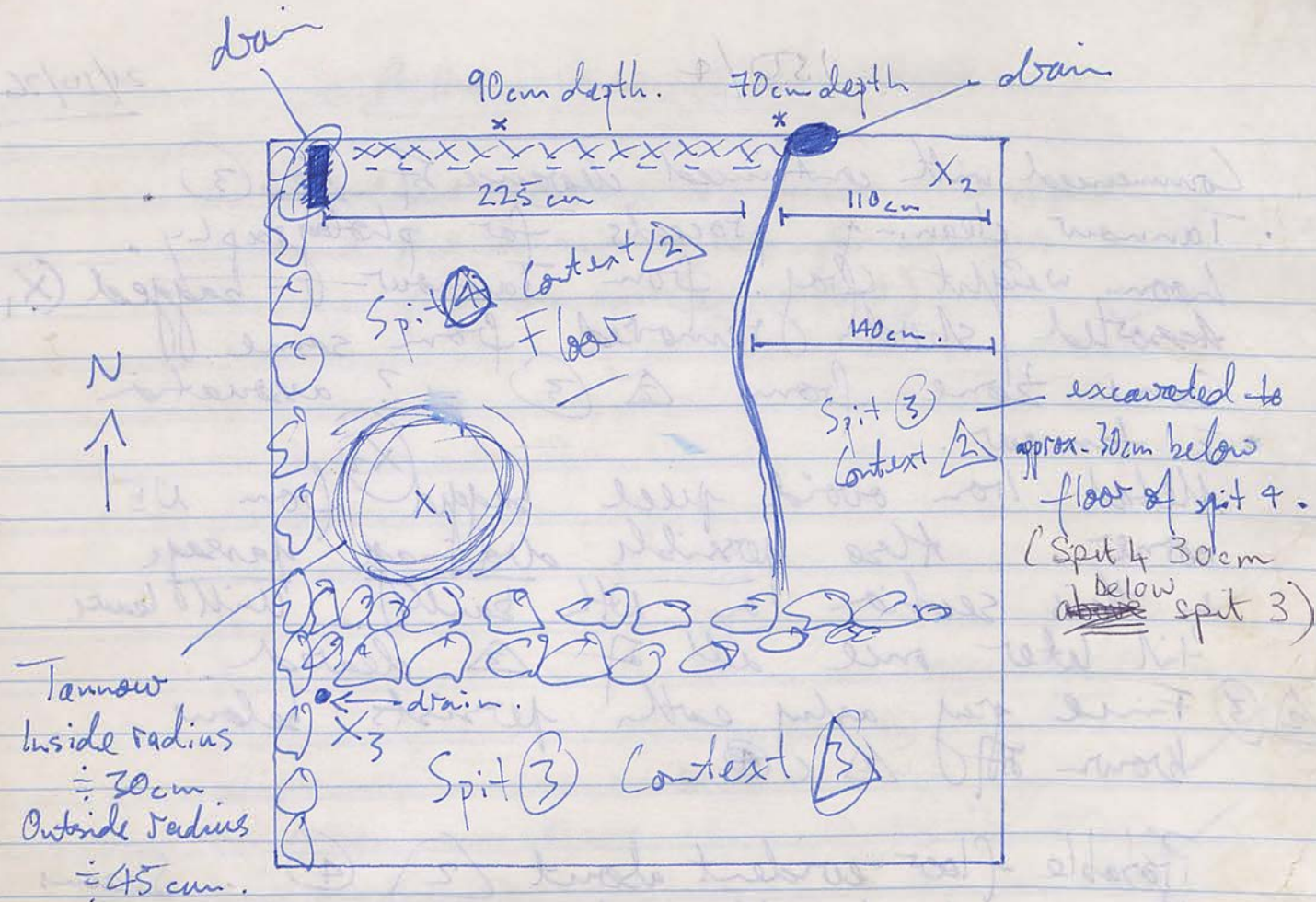

Tannour  
 Inside radius  
 = 30cm  
 Outside radius  
 = 45cm.

XXXXX Indicates possible drainage duct beneath existing floor.

\* Work commenced in Context 3 Spit 3.  
 Small Worked stone (possibly grinding stone) found + bagged X3  
 Possible drain exposed in NW corner of context 3. - is this correct?  
 Possible wall coming up West of midline.

{ Bark in 2 3 - metal bag - nonsp. i. Bagged }  
 = X2

Confusion re drain - in northern Coors, yes but also in southern? No further mention of latter.

Pottery Analysis for 22/10/96

Context 2 spit 3 = Area 40  
 Bases: 1 round  
 Rims: 3 edrims  
 Other: 1 b/shed = handle root.

Context 3 spit 3 = Area 39  
 Bases: 3 ring, 1 small, flat base  
 Rims: 4 edrims, 1 jar, 1 large bowl, 1 mortar, 1 footplate, 1 antkened plate,  
 Other: 1 b/shed = horizontal scissor, 2 b/shed = handle roots, 1 strap handle.



*[Faint handwritten notes, possibly describing site details or measurements.]*

THIS PAGE  
INTENTIONALLY  
LEFT BLANK

*[Faint handwritten notes on the left page, including phrases like "Context 1", "Context 2", and "Context 3".]*

150/4

dearly - rasmus  
unitly - keatell  
22/10/96

Reexamined trench after absence yesterday.  
The tannour in spit (4), context 2 has been  
revald as intact, and of a reasonable size

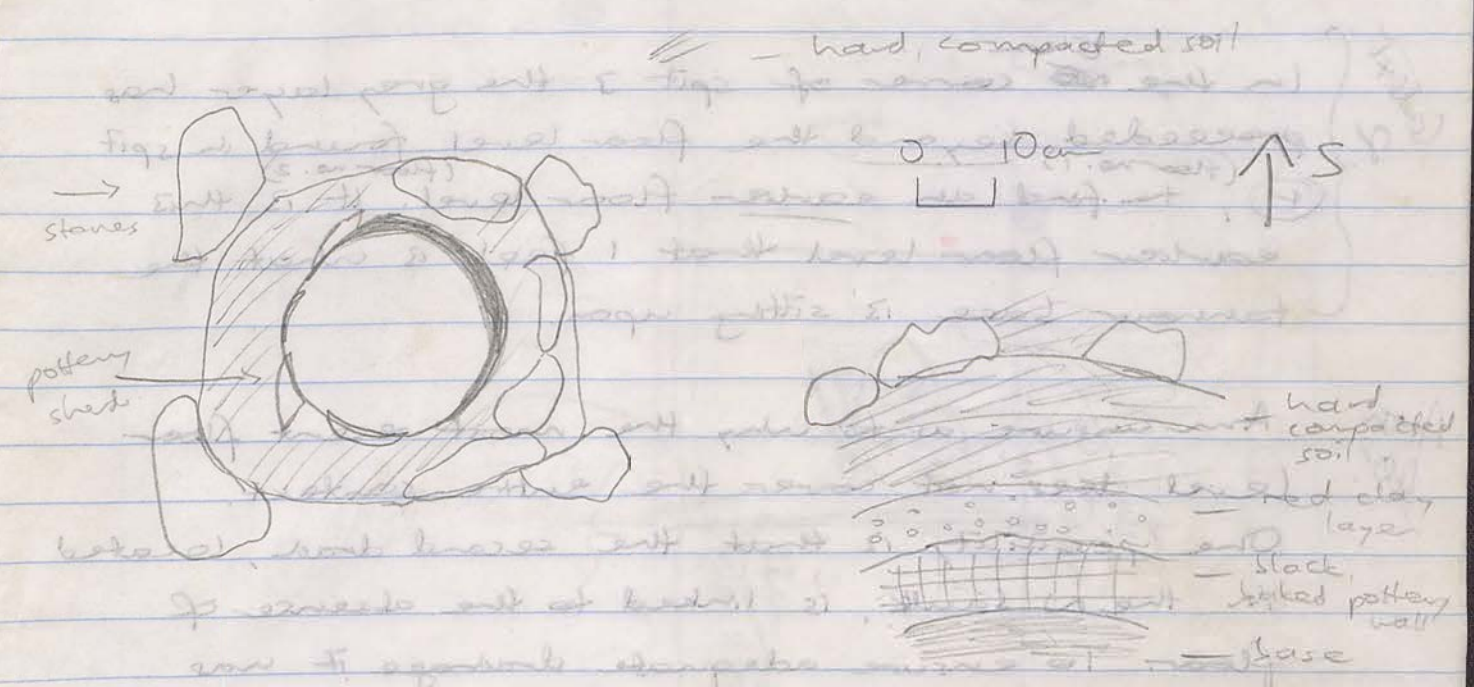

Continuation of removal of spit (3), context (3).

Some indicators of grey soil appear - possibly a

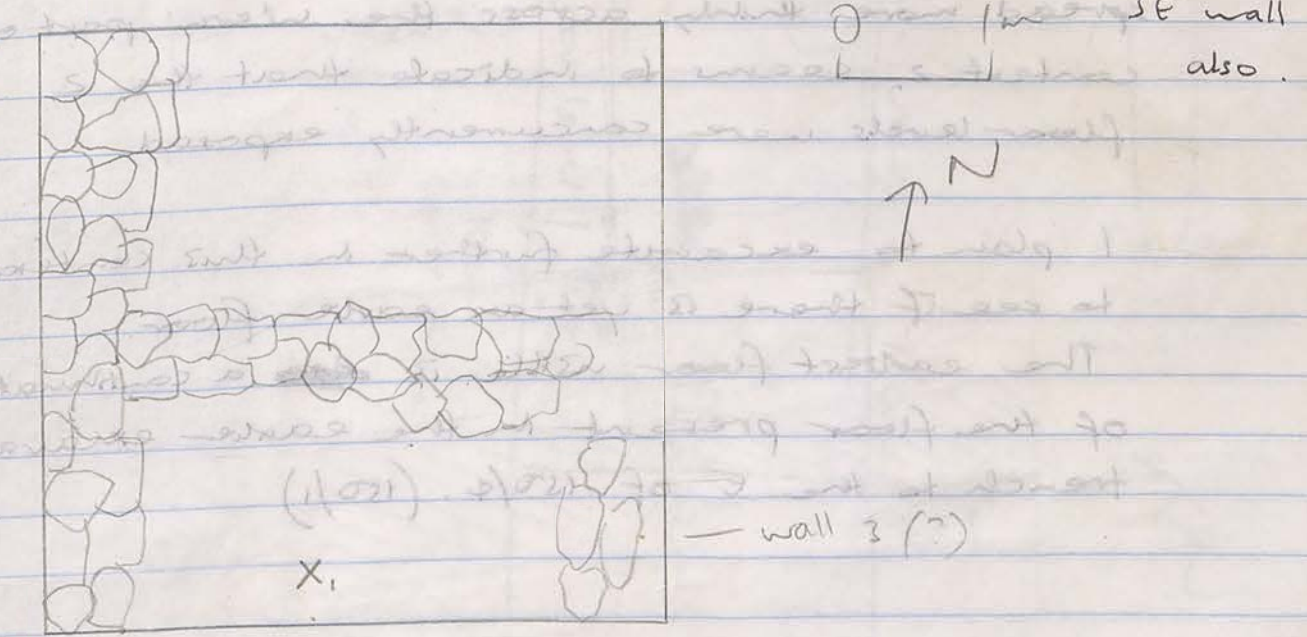

X - nail found at a depth of 70 cm below  
Siem bank



150/4

Finished excavating spit (j), context 3 today.  
Below the grey soil was a sharply contrasting red brown, stronger than that revealed in spit (i) in the same context.

Context 2  
In the <sup>W</sup> corner of spit 3 the grey layer has proceeded beyond the floor level found in spit (i) (floor no. 1) to find an earlier floor level (floor no. 2). It is this earlier floor level that I feel is what the tannour base is sitting upon.

Area 40?  
Am unsure as to why the most recent floor level does not cover the entire context.  
One possibility is that the second drain, located in the N bank, is linked to the absence of floor. To ensure adequate drainage it was necessary for there at least to be a slope in the floor surface. The bulk of the grey soil, having settled in this lower area, and spread more thinly across the W part of context 2, seems to indicate that the 2 floor levels were concurrently exposed.

I plan to excavate further in this context to see if there is yet an earlier floor.

The earliest floor visible is ~~also~~ a continuation of the floor present in the earlier excavated trench to the E of 150/4. (150/1)

Pottery Analysis for 23/10/96

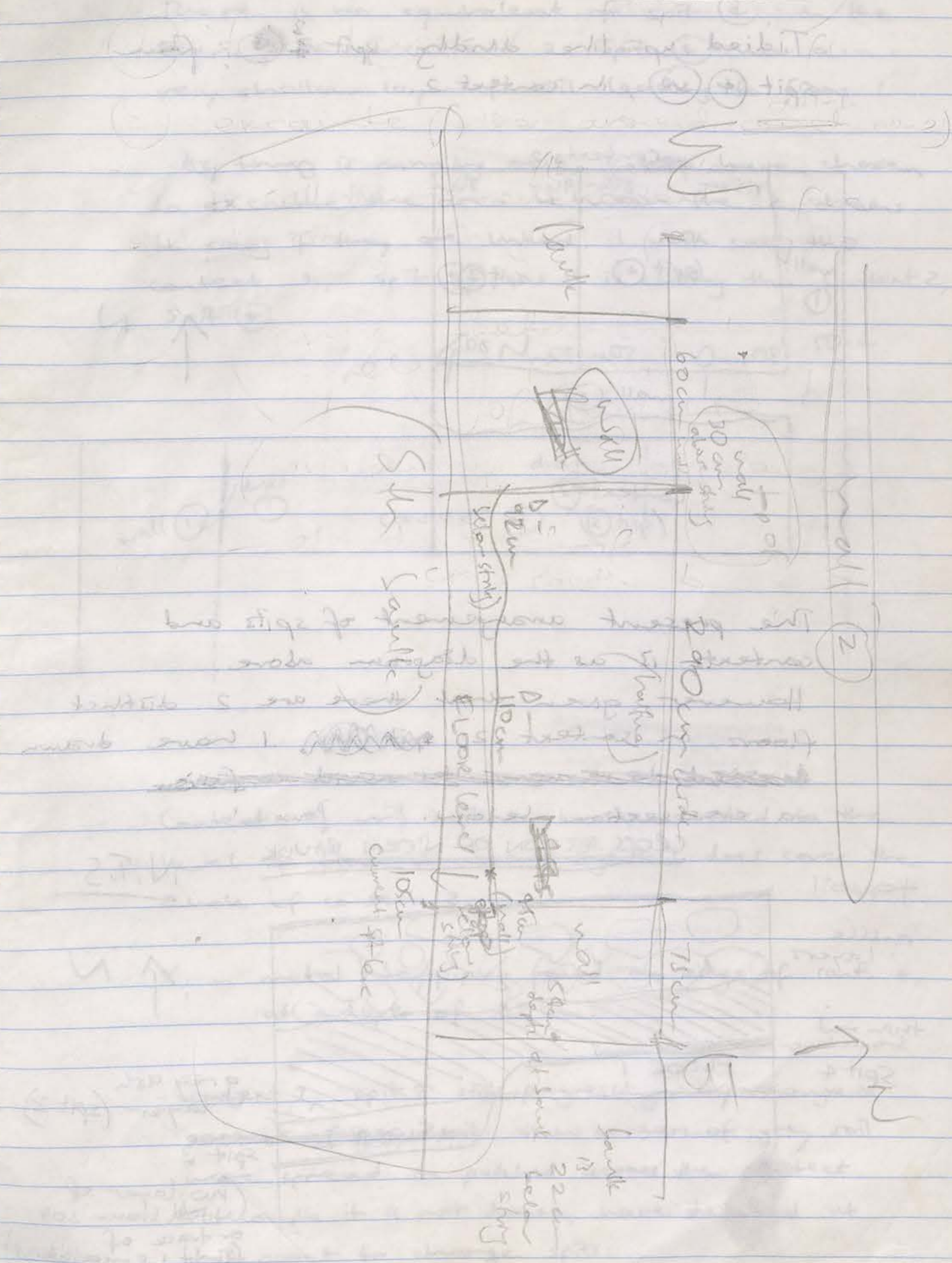



23/10/96 150/4 23/10/96

Tidied up the dodgy spit ~~4~~<sup>3</sup> (E), from spit (4) (W), in context 2.

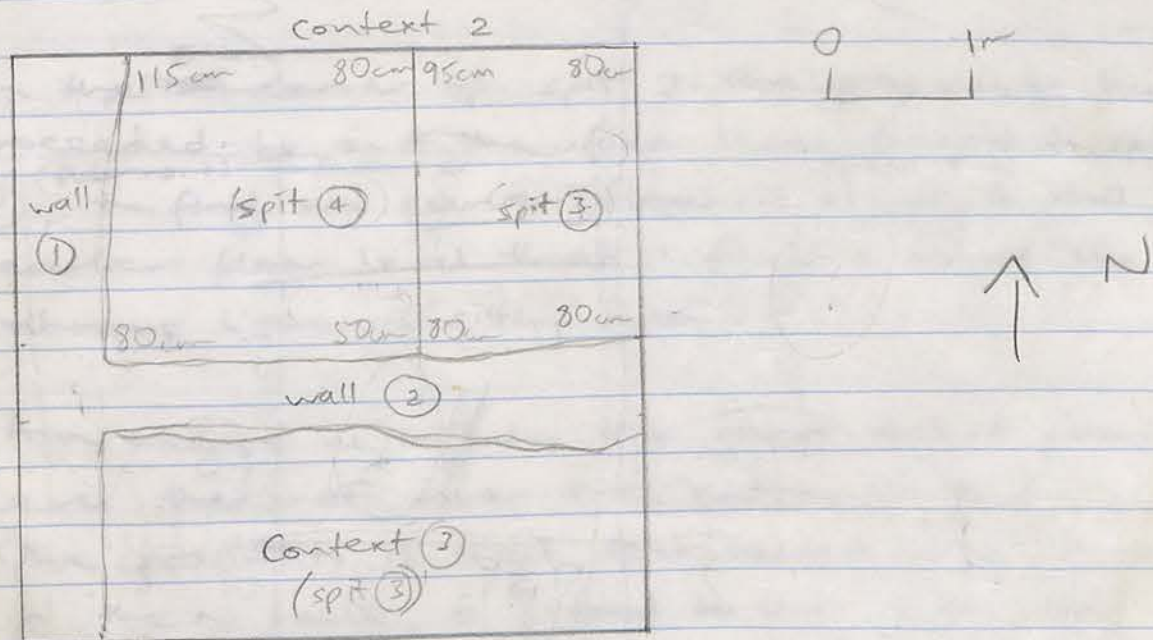

The present arrangement of spits and contexts is as the diagram above.

However, given that there are 2 distinct floors in context 2, ~~spit (4) (W)~~ I have drawn ~~spit (4) (W) to remain to avoid confusion~~ a cross section below. Praise be!

CROSS SECTION OF NERN BAULK

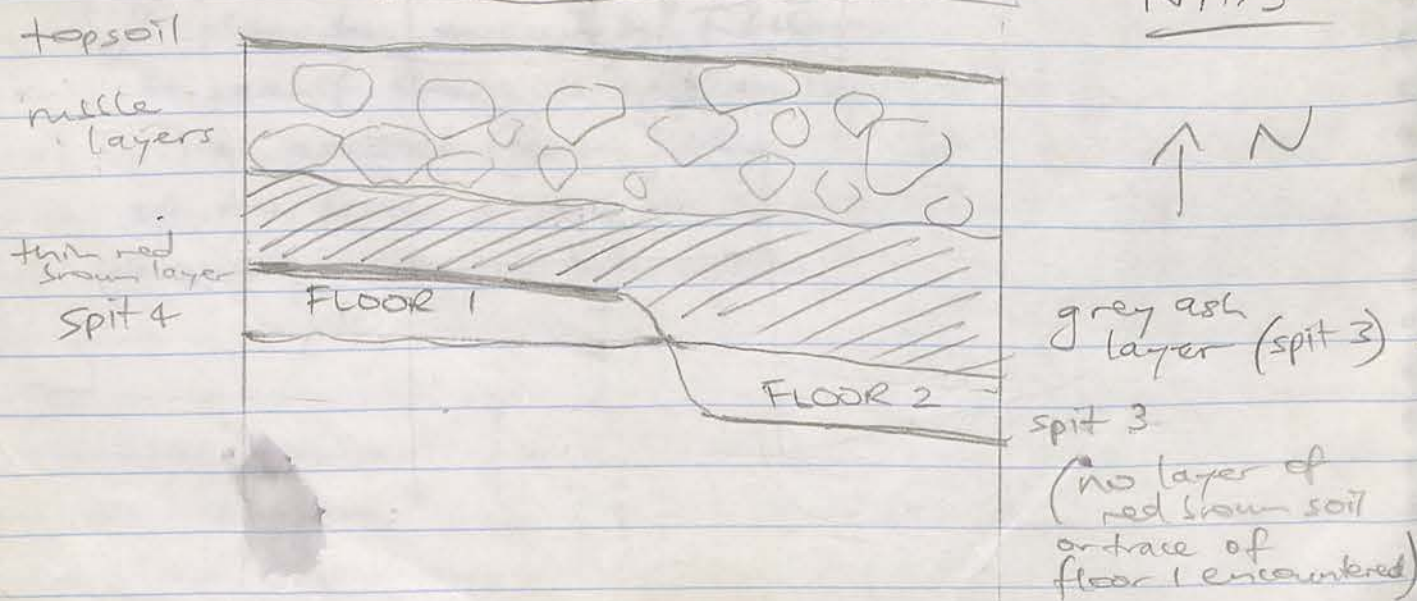

23/10/96

There is no equivalent of spit (4) in the Etern part of context 2. Spit (4) was a very shallow layer of soil leading to floor 1.

As time is running out, I ~~will~~ have chosen to excavate the area between the 2 drains to see if they are linked. I will call this context 4, spit (5), as it is cutting thru Context 2, spit (4).

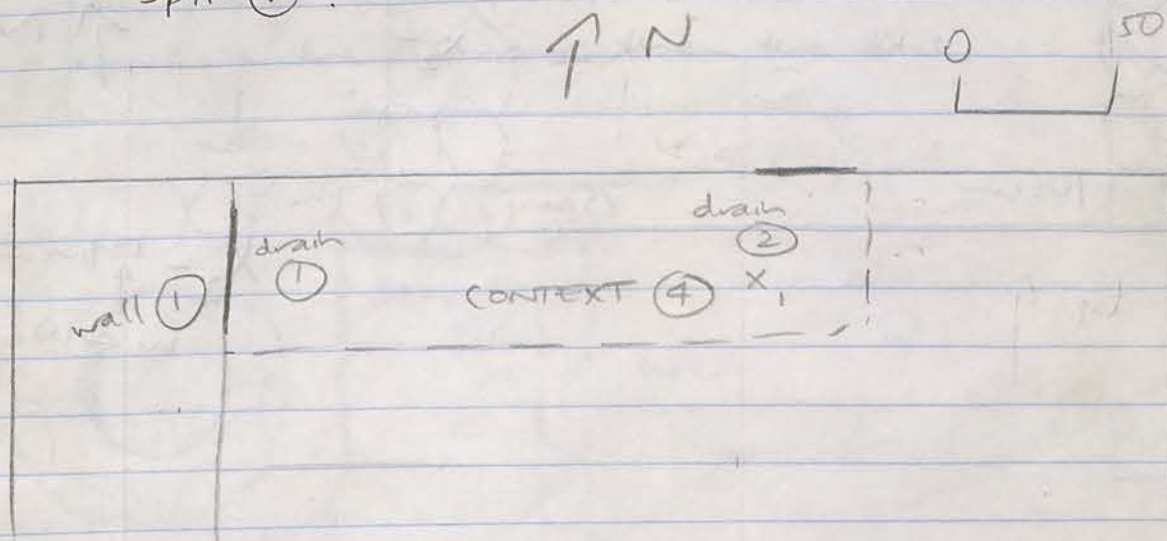

Context 4, will initially be excavated to the level of floor 2, assuming this does cover the whole of context 2.

X<sub>1</sub> - metal tube/piping found on edge of cont. 4, at a depth of 85cm.

Context 3, spit 3 still progressing. By manuring ~~spit 3~~ this smear of grey soil were spread in patches across the context. Although it is not dense, have decided at this point to change spits.



23/10/96

Sketched below are the levels at the end of spit 3, context 3.

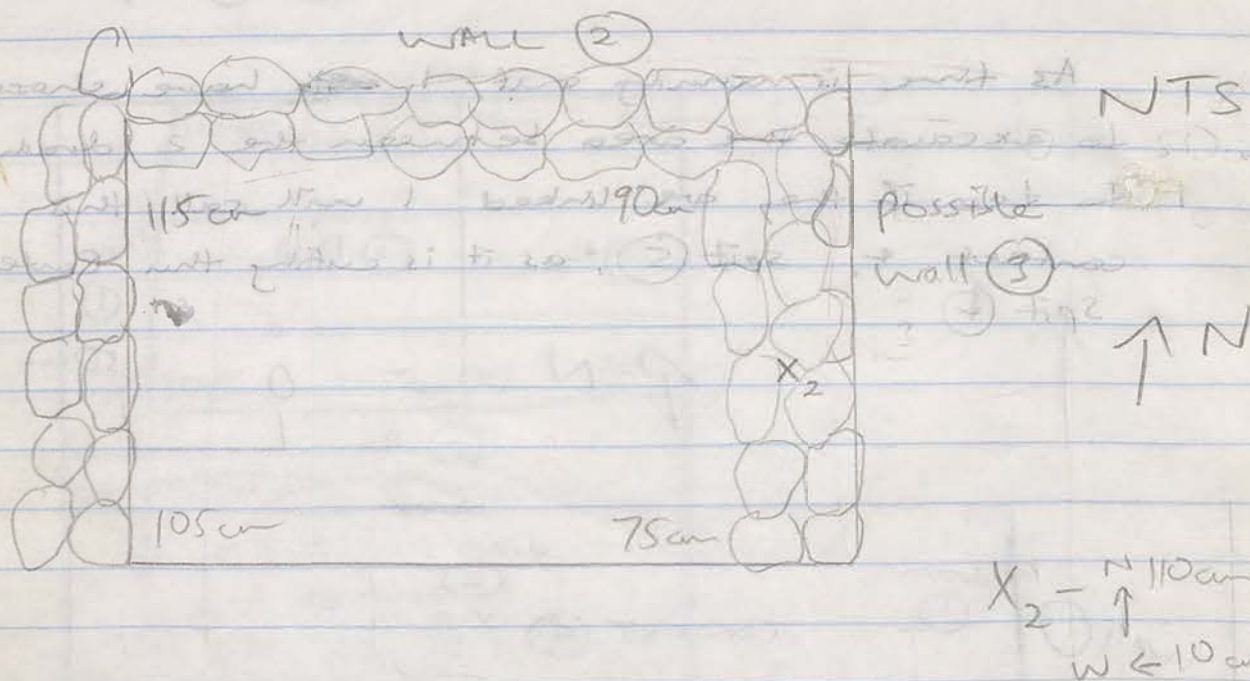

As you can see from the diagram, a 3rd wall is ~~in the SE corner of the trench~~ in the SE corner of the trench. It is tabby shape.

X<sub>2</sub> - a piece of metal found at a depth of 45cm when clearing the 3rd wall.

Excavation of spit 4 in context 3 will reveal whether there is a drain in the NW corner of this context, which is presently unclear.

Before we commence spit 4, we will define wall 2 on its SE face more clearly. Pottery etc recovered from this process will be labelled wall clearing - correlate with spit 3, context 3.

As previously mentioned, a couple of days ago, ~~the~~ ~~ditch~~ ditch no. 1 has a wall running alongside between it + the tannour. ~~It~~ It was the line of this wall that I took as the boundary of context 4, assuming that it may run most of the length between ditches 1 + 2.

However, partial excavation of spit 5 in cont. 4 has shown that the stone wall seems rather to encircle the tannour than the ditch.

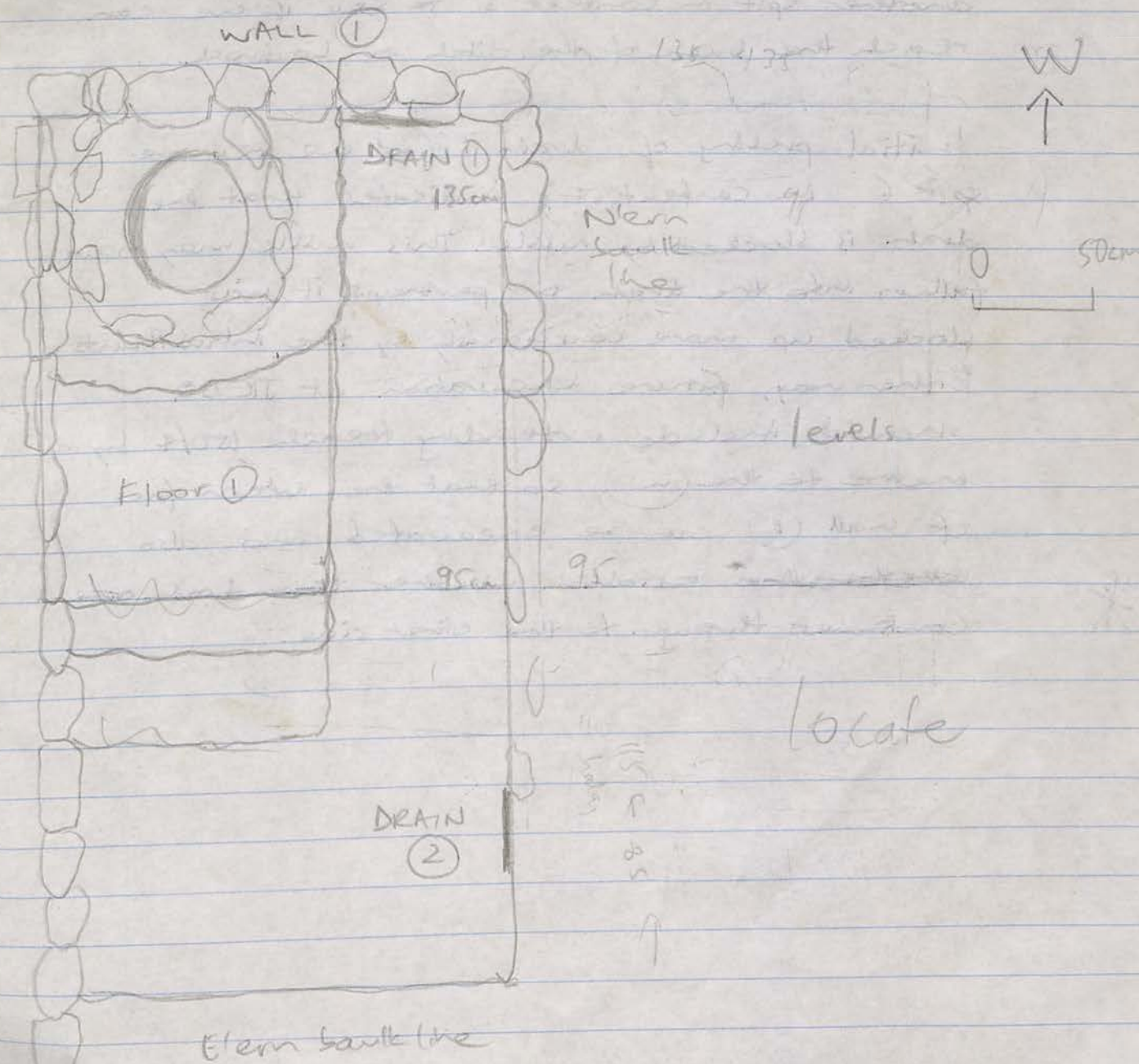



150/4

29/10/96

Due to heavy rain last night a lot of loose mud has been washed into the trench. I had planned to partially excavate spit 4, context 3, but feel cleaning up this context + both wall ② and wall ③ will take up our time.

Finished off context 4, spit 5 this morning. As expected, floor 2 appears to underlay floor 1 across context 2. Will take out another spit in context 5 to see if we can reach the base of the ditch or bedrock.

Initial probing of drain 1 (as we remove spit 6 in context 4) indicates that the drain is blocked by rubble. This rubble may have fallen into the drain or perhaps it was blocked up more consciously by the inhabitants. Either way, future excavation at JK02 should include extending trench 150/4 by a metre to the (W), so that the worn face of wall ① can be excavated and also ~~whether~~ establish whether the drain ~~is~~ continues through to the other side.

\*

R  
H  
S  
C