

D.Q. MR. 296



A4 NOTE BOOK

No. 595

128114
\$2.75
9 312828 005954

For 151/9 (MR)
see LL's ch book

FIELD NOTES - JEBEL KHAUD '96 - M. ROWNEY.
CONTENTS.

cont
ad were all

FIELD NOTES - JEBEL KHAND '96
 M. BROWN
 CONTENTS

(2)

Trench 178/9 = Commenced on 28/9/96

Perched on quite a slope with a lot of spoil already dumped on top of it. The removal of the spoil became the first task.

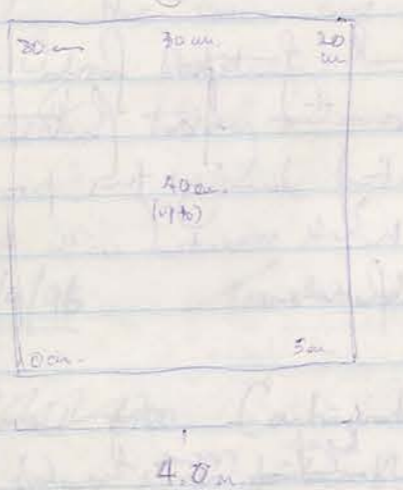

Spoil depths across the square requiring initial removal.

No pottery was kept from this layer, although 3 coins were found and kept, marked as unstratified. They were within 15cm of the surface in the center of the N end. (see below)

Spoil was understandably loose and generally of the same beige/tan color as is typical of the topsoil on the Jebel. Contained little or no vegetation although the process was started last week by Kestie and may have had those veg. Rocks of varying sizes ~~and~~ were found throughout the trench, although their density was reasonably low.

Looking at the Nth wall of the adjacent trench to the south I note that a wall extends along the western half (of this Nth wall). The eastern end of this wall is quite oblique and does not end with a defined stone edging. The continuation of this wall is unknown / a complete mystery - at least of this wall lies within the Sth bank of trench 178/9.

A suggestion has been made that this wall may in fact end 1/2 way through the trench to the Sth and turn towards the Sth in a defined corner. The possibility of this being the case will be determined from excavation = Trench 178/9 to show an N-S aligned wall ~~the~~ most likely to be located within the bank (western side).

FINDS

Although it seems somewhat irrelevant to me to point out that location of the finds it can be noted that the 3 coins + 1 bead were all

(1)

①

found within 1m of the Nth wall of the trench. 2 at the E end, 1 at the centre and the head at the W end. As noted above - all within 15cm of surface. Bear in mind still that this is spoil we are removing!

②

* Also commenced this day was the removal of spoil from square 150/7. This was done only in preparation for future work in this area. No artefacts were collected during this process and no trench boundaries were observed. Work connected with this clearing may not necessarily begin in the near future.

29/9/96 Continuation with removal of spoil ^{heap} over the top of both squares 178/9 and 150/7. Consistent remains the same as yesterday. Overall depth up to c.50 cm along N wall of 178/9 and remains at yesterday's depth at the Sth end of this square.

Removal of spoil heap completed today. Depths of spoil (finally) were as follows:

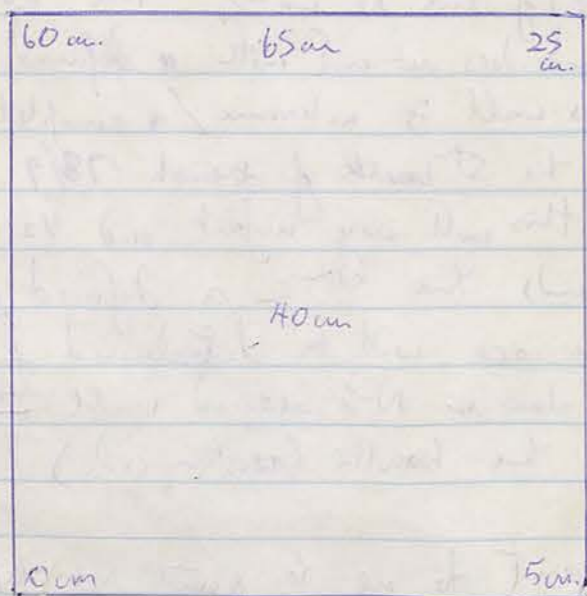

With the top of the level surface revealed we will commence unit 178/9 ① which is due to spoil between the upper units of rubble.

③

29/9 POTTERY

Unit 178/9 ①. Compacted light brown/tan soil with little or no remaining remnant grasses. Found among a plethora of flint nodules/stones (and rubble). So far all of the rubble appears to be roughly the same size with nothing large standing out as probably part of a structure. It is unlikely that this unit will be completed today.

30/9/96 Trench under supervision by B. Napier.

Continuation of excavate of soil of unit ① leaving in larger stones to be photographed at end. A small pile of bones (dark?) was found in the following location:

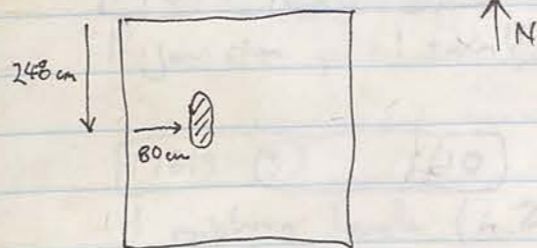

Covering a total area of 80 mm x 240 mm at a depth of 40 cm. These bones were bagged. Further clearing revealed more bones under some rocks in the same position. These were in situ and were photographed by Bromley [B/W R4 F 29] 4.21

- Finished removal of all of spoil ① leaving rocks in situ.
 - Photographed by Member J. Roll 2 CP FR. 8+9.
- Depths for final levels.

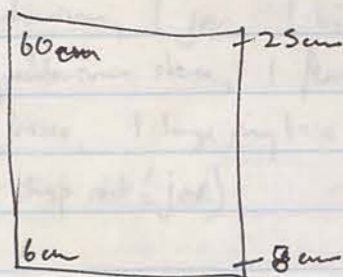

At the end of this process a possible "wall" was noted along the southern edge of the trench. - to be investigated tomorrow.

P. J. V.

30/9/96

4

Commenced excavation of spot ② in 2nd part of work day (read as "exploratory window trench!").

Began removal of spot ② in NW corner over a trench of 2.5m.

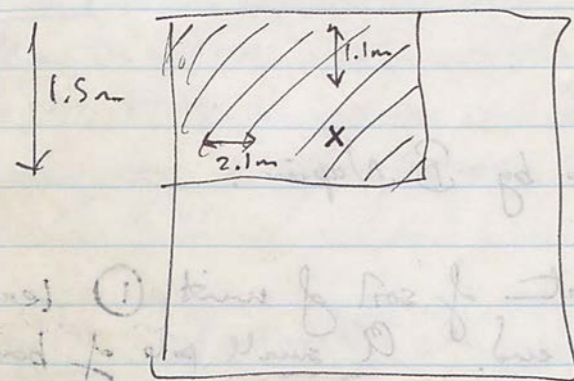

No structures noted by end of day.

X = location of 'pin' added to inventory objects box.

POTTERY

5

178/9 ① 29/9

Body sherds: 1 med. bag (c.45 pieces)

Rims: 1 echinus, 1 small bowl, 1 shallow bowl, 1 big jar, 1 little jar.

Bases: 4 ring bases (various), 1 rounded base, 1 amphora toe,

Other: 1 strap handle, 1 body sherd shoulder profile.

178/9 ① 30/9

Body sherds: 1/2 med. bag - 36 pieces

Rims: 2 small jar, 2 med. jar, 1 nectarium

Bases: 1 pedestal (fine R/S ware), 1 clw ring, 2 amphora toes, 10 ring (various)

Other: 1 double strap handle with root.

178/9 ② 30/9

1 jar rim, 1 small handle, 20 body sherds.

178/9 ③ 1/10

1 amphora handle (in 2 pieces), 1 strap handle with root. 15 body sherds.

178/9 ④ 1/10

Body sherds: c 40 - 1 med. bag

Rims: 2 fine bowls (1 red), 1 nectarium, 1 jar, 1 big bowl.

Bases: 2 amphora toes, 1 clw nectarium stem, 1 flat base, 2 partial foot-plates

Other: 1 complete fish plate, 5 ring bases, 1 large ring base with decoration.

Other: 1 double rounded (round) strap, 1 strap root (jar)

178/9 ② 1/10

Body sherds: 22 pieces.

Rims: 2 jars

Bases: 2 ring, 1 small fine R/S base with concentric grooves, 1 amphora toe,

Other: 2 strap handles to root, 1 round handle, 1 incised body sherd.

1/10/96 178/9 [3] spt ② 1 large body sherd.

178/9 [2] spt ② 2/10/96 c. 45 body sherds.

Bases: 1 small amphora toe, 3 ring, 1 fish plate.

Rims: 5 jar rims (1 large, 1 med, 3 small), 1 echinus, 2 small r/s bowl.

Other: 1 strap handle (complete), 1 part strap handle + root, 1 double reeded handle, 1 ribbed sherd, 1 small stone loomweight (bagged separately in accessories).

178/9 [5] spt ② 3/10/96 c. 60 body sherds.

Bases: 3 ring, 1 amphora toe, 1 lamp base (bagged separately in accessories).

Rims: 5 jar, 1 metanion, 1 echinus,

Other: 3 strap handles, 2 leg handle roots,

178/9 [2] spt ② 3/10/96 c. 35 body sherds.

Bases: 1 complete amphora toe, 1 fragmentary toe, 5 Ring bases,

Rims: 1 echinus, 1 small r/s bowl, 1 small bowl, 1 metanion, 1 fish plate, 1 jar, 2 plain, straight rims (jar?).

Other: 1 strap handle, 1 r/s ribbed body sherd.

178/9 [4] spt ② 3/10/96 10 body sherds. 1 red ring base, 1 strap handle root.

1 large bit of roof tile (bagged separately).

177/3 [1] spt ① 2/10/96 c. 25 body sherds.

Bases: 2 small ring,

Rims: 2 small jar, 1 echinus,

Other: 1 strap handle + root.

1 lamp frag. (bagged separately in accessories).

177/3 [1] spt ① 3/10/96 c. 25 body sherds.

Bases: 1 amphora toe, 2 ring bases, 1 small bowl ring base,

Rims: 1 echinus, 1 small bowl - outflared, 1 jar, 1 straight sided bowl.

Other: 1 strap handle, 1 strap handle root, 1 round handle root, 1 stone loom weight (bagged separately in accessories).

⑥

1/10

Trench 178/9 continued.

Context ② was begun yesterday by BN. The area of context ② covered yesterday was a 2.5m x 1.5m rectangle in the NW corner of the Square.

The removal of material here consisted of light brown/tan compacted soil and some of the smaller rocks. Larger rocks were being left for viewing later.

Today the removal of context ② continued towards the Sth end of the trench, but not towards the Eastern side.

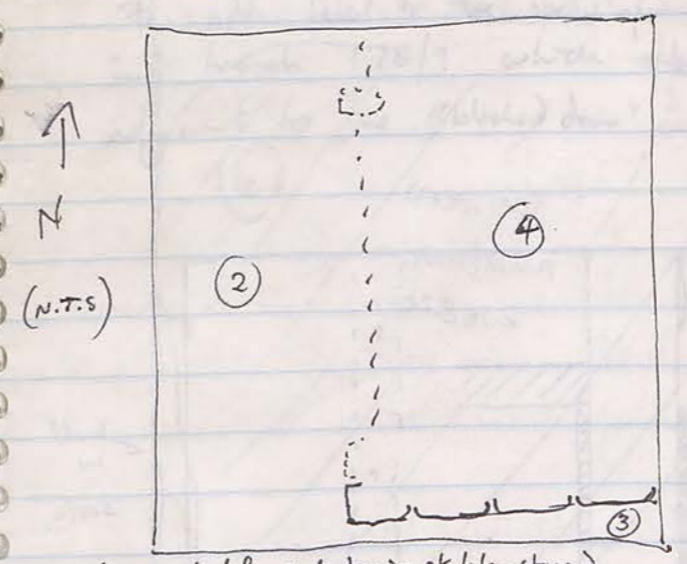

(see overlaid for scale drawing at later stage.)

Nth end of the trench suggests that an N-S aligned wall may be present here. On this basis - a number of new contexts have been created.

Based on the notion that it is safer to split now + lump later context ② was continued down the Western side or what would be the "outside" of any likely N-S aligned wall. Context ④ covers the area to the East of this possible wall and context ③ is the area outside the E-W aligned wall on the Sth side of the trench.

⑦

2/10/96
(line 10/20/20/20)

8

Udda - tools
(square the 'u' sand)

Shakar - water

PLAN VIEW

The Context ③ covers an area of to a depth of approx. 20 cm. with one bag of pottery (a small one) and no special finds. OK here's a drawing:

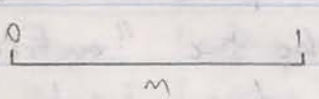
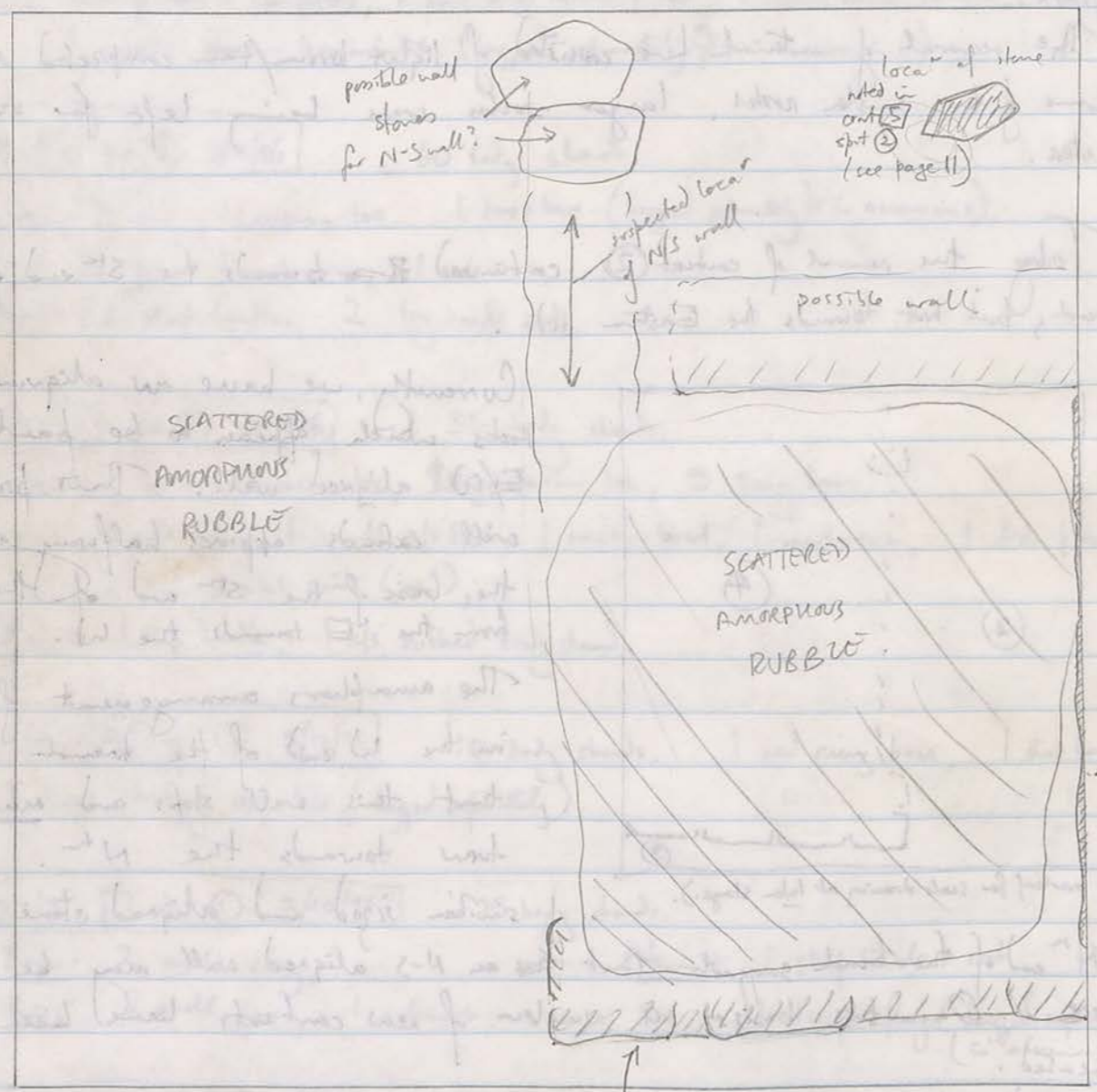
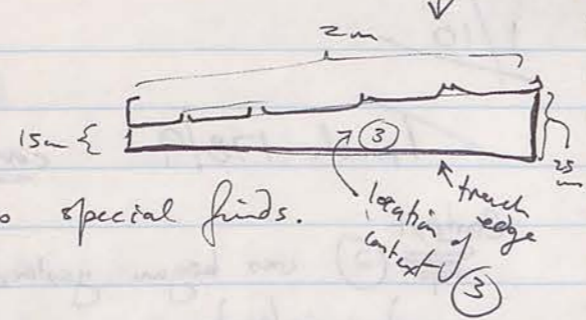

9

A few notes to be made about the relationship between trench 178/9 and its eastern neighbor 178/6.

- 178/6 has a wall along the W side in the bank, extending 1.40m from the E/W aligned wall in the S end, towards the N. What appears to be a blocked door is adjacent to this (c. 85cm) and then another 60cm of wall.

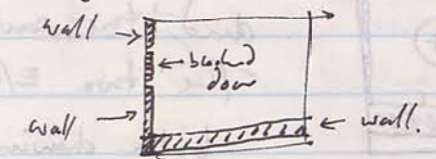

The point of noting this is that in the adjacent square 178/9 there appears to be a wall in the East bank which suggests that the bank contains either 1 very wide wall or approx. 1m thick or 2 thinner walls adjacent to each other.

To add fuel to the speculation there is another E/W aligned wall in trench 178/9 which appears to lead out from the point adjacent to the 'blocked door' in 178/6.

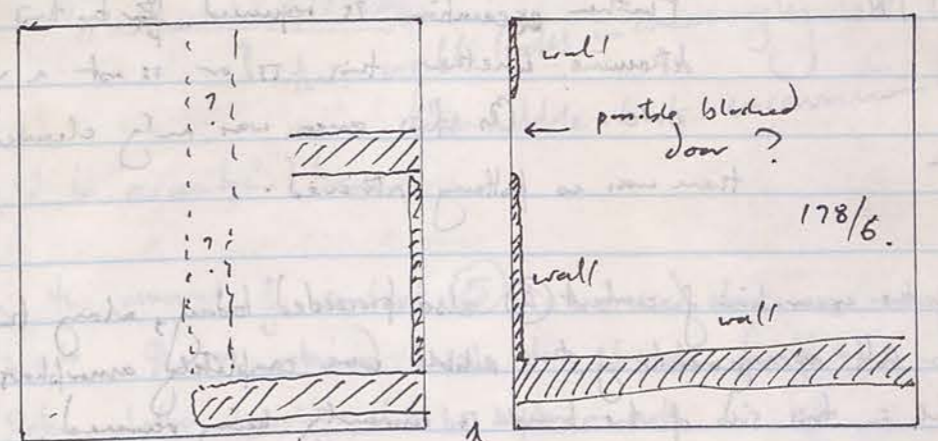

(N/S aligned wall not determined for sure at 1/10/96)

This area could prove to be crucial to the interpretation of these adjoining trenches, which based on the information above, do not appear to provide consistent information.

NOTE ON CONTEXT ④

A change to the area covered by context ④. This context was previously located along the East side of the possible wall area in the centre of the trench, however, the appearance

Katuba - write
 haryeh - snake
 medina - town.

(10)

of the 2nd E/W aligned wall has resulted in ~~area~~ context (4) being reduced to the area between the two "walls". and bounded to west by the possible NS aligned wall.

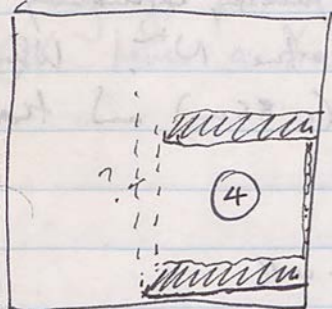

This area was approx. 1.5m x 1.5m and the context was temporarily finished. The two E/W aligned walls are quite apparent - both showing a distinctive Southern face - neither of them have a defined Northern face.

The eastern side wall in the bank is clearly defined. Excavation of this area has not been completed yet because of the total lack of definition in the rubble aligned down the centre of the trench which was left in situ temporarily because part of it appeared to be a wall. Hence, the area is not clearly bounded on the western side. Context (4) consisted of pale brown/grey/tan soil (read - sandy silt) and densely packed rubble.

Excavation of this context stopped at the following depths:

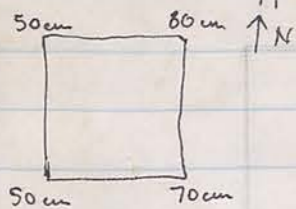

Further excavation is required in this area to determine whether this is or is not a walled area. As this area was only cleaned up today there was no pottery retrieved.

Continuation of the excavation of context (2) also proceeded today, along the western side of the trench. All arrangements of the rubble were completely unobscured and hence all material in this side of the trench is currently being removed. The southernmost E/W aligned wall appears to go no further than 1/2 way into the trench. A concentration of bone was found ^{close} to the NW of the trench and another on the central rubble alignment.

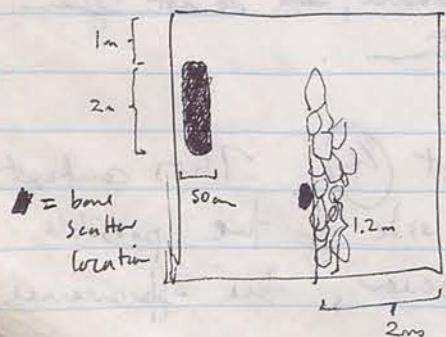

This spot won't be completed until tomorrow.

3/10/96

Zalem - angry!

(11)

Completed context (2) down to the following levels:

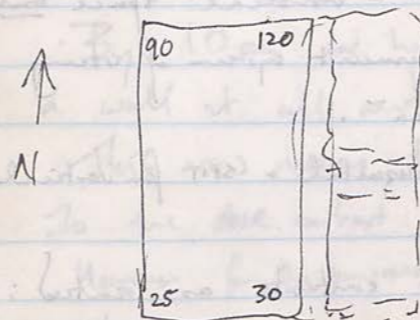

Some rubble remains in the NW corner vicinity.

Also, as new context has been created thru' the divisions of the walls. ~~help back to work~~

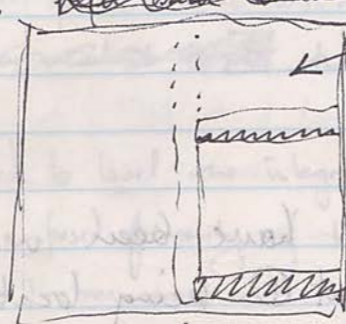

This wall looks increasingly less like a wall and more like rubble but, excavation at South will be req'd to ascertain this.

In the removal of context (5) a dressed stone was removed - note that it was not in situ. It was retained beside the trench, for future reference. I will check with Peter whether he wishes it to be kept or not.

photos: Roll 2 CP 26-27.

by Heather

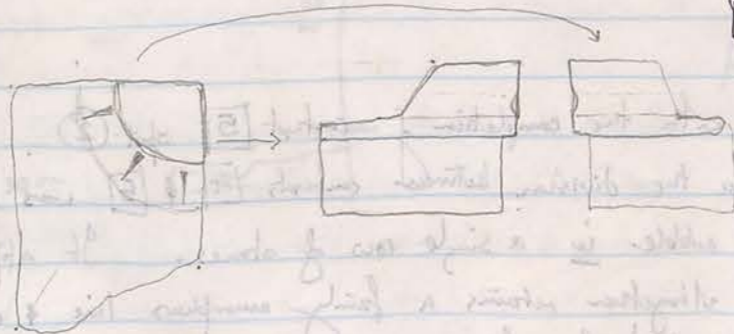

7/10/96

OK, news flash! A change to the numbering system is imminent.

So far contexts have been located in both horizontal + vertical space but this system is incompatible - what I believe is the current system of using loci for horizontal location + SPIT/LEVEL for vertical loca.

This system will now be adopted here using CONTEXT for horizontal + SPIT for vertical denoted by \square = context, \circ = spit.

Thus the trench 178/9 ~~contains~~ still contains 5 contexts as located:

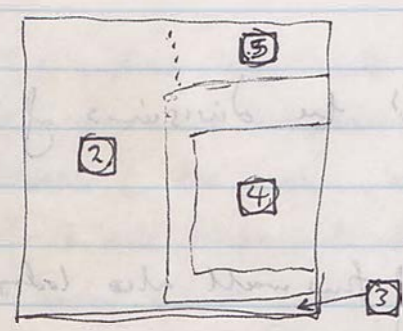

1 Covers all of the square - is also the vertical clean up of this square and contains only 1 spit in this case.

* UP TO THIS DATE ALL contexts have been vertically located in spit 2 only. With spit 1 being located only within context 1.

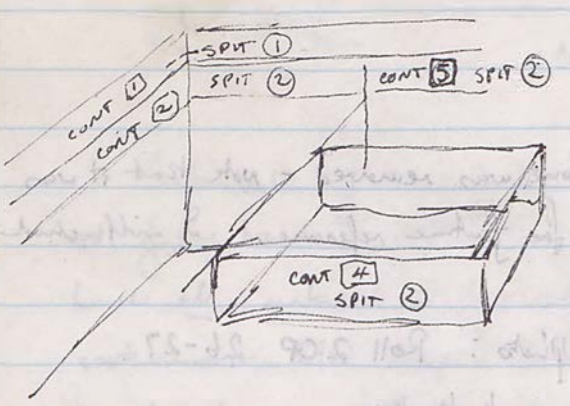

IF ALL PREVIOUS CONTEXT NUMBERS AFTER CONTEXT 1 SHOULD ACQUIRE A SPIT 2 SUFFIX UP UNTIL EXCAVATION ON THIS DAY!

Work on the 7/10/96 began with the completion of context 5 spit 2. The E/W "wall" which appeared to produce the division between contexts 4 + 5 was reduced to the thickness of a single course of rubble - ie a single row of stones. It appears to be vaguely like a wall but altogether retains a fairly amorphous line + curving. However, this single row will be retained for further investigation - as a thin wall. If it is not a wall - there is little doubt that the rubble in this area is extremely close packed - producing the visual effect of a wall.

edash - eleven. Kubla - before.
thruash - twelve.

to + for in the wall decision ->

If the northern most of these two "walls" is a wall then it extends due W of the blocked door in the adjacent trench - further fuel for suspecting that this "wall" is not a wall at all.

By 10 am we had ascertained that the N/S ^{also} "wall" was ^{in fact} not a wall at all and thus it was removed.

This now means that contexts 2, 4 + 5 can now all be integrated into the ~~other~~ context at spit 2 level and below. (Until further notice).

However, for the purposes of not re-doing the paperwork ^{areas} tags will remain separated until spit 3.

8/10/96

Does this bit make sense? Bags of stuff (like pottery etc) labelled as any of contexts 2, 4 or 5 at spit 2 level are all still labelled separately at the spit 2 level - at the spit 3 level all of the contexts 2, 4 and 5 will be subsumed under ~~the broader context 2~~. the broader context 2.

Proceeded to level the integrated context 2 to produce a flat, rubble-free surface composed primarily of loose beige/tan soil. The Nth most of the E-W "walls" now only 1 stone course wide has been left in tact for now and we will continue to investigate around + below this feature and the Sth most E-W "wall" until both of them are either clearly walls or clearly nothing.

Final levels of spit 2:

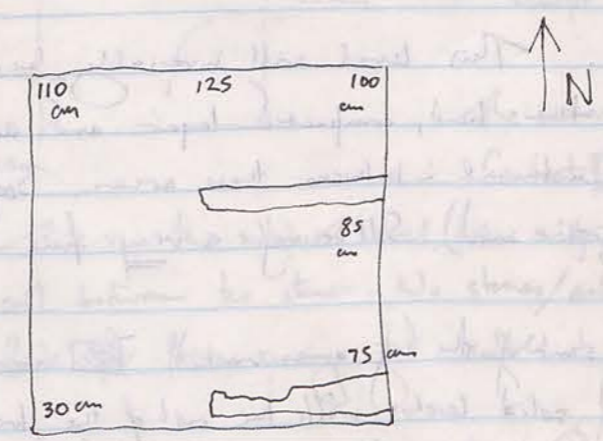

The spit to follow + thus give rise to the investigation of the walls will be context 2 spit 3.

10.30 began context 2 spit 3 in the area between the "walls" formerly occupied by context 4.

14
9/10/96

Continuation of context [2] spit [3]. Context [2] now encompasses all of the area of the trench except the small space immediately ^{at} west of the Southern wall.

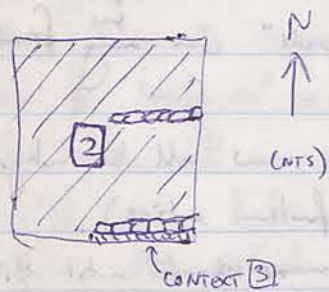

Note already that the Nth half of the southern wall is already looking very dodgy because of the amount of soil below the upper "course" of stones (upper level Nth side looks already as though it is not a definite wall).

Ops - change of plan! - Now (after another 10 mins.) it becomes apparent that there is more stone on the W side of the trench than previously visible. On this basis the whole she-bangy looks a little more like this:



So the new context to the Nth of this alignment of stone has been #1'd as context [6] until further notice. This context began at spit [3].

By the end of the day - a compacted, solid layer was found adjacent to the Sth wall "wall" - reminiscent of a floor.

10/10/96 Continuation of Context [2] spit [3]. This level will invariably become uneven because we have stopped excavating the hard, compacted layer and are continuing with the removal of the softer material in between these areas. Softer material is loose beige/tan silt (with grit & sand). Silt or maybe a very fine sand.

Approx. location of hard spots:



At the start of the day areas marked  were compacted, solid levels while the rest of the trench on the E side was still soft dirt.

Thus the end of this unit will invariably be very uneven and will slope to the E. On this basis I have my doubts at this stage about it being a floor or not!

TRENCH

177/3

48

Commenced on 1/10 with the removal of excess spoil above the Jebel surface. Depths of spoil noted:

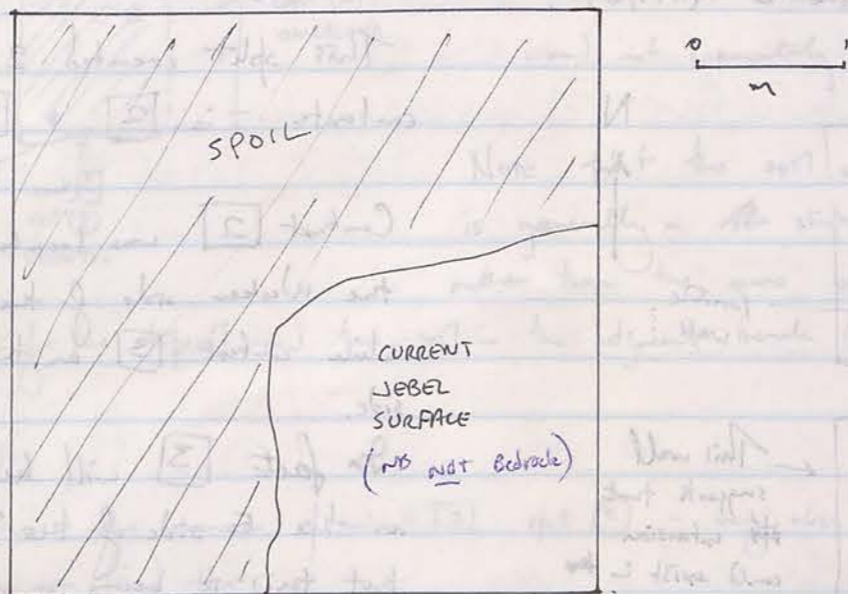

2/10/96 continued the removal of the spoil as per yesterday. This unit was completed by mid-morning to the following depths.

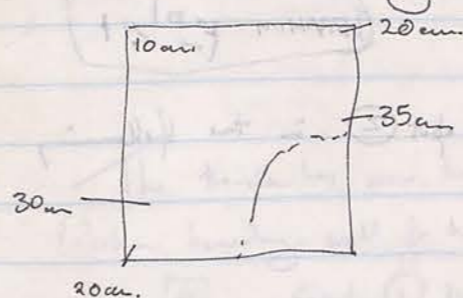

No material was kept from this process except an carrying which was bagged for inventory.

The removal of Context [1] was commenced mid-morning. This is the topsoil level (the original one) and is being excavated as the soil between the stones. No stones/rubble were removed - the aim being to look for foam among the rubble. This will be photographed when it is finished.

3/10/96 Completion of context [1] (SPIT [1]) excavation photo: Roll 2CP frames 28-29

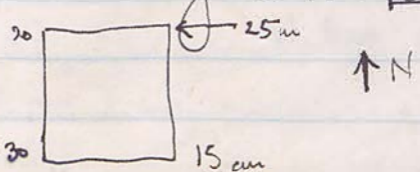
7/10/96 Commenced on the excavation of context [2] spit [2] at the following levels. 

16

sha - box = fish.

7/10/96 cont

Decided to split the square into halves in an attempt to locate some features of interest. The split was based primarily on the location of a wall in the trench to the immediate E^{th} (177/2).

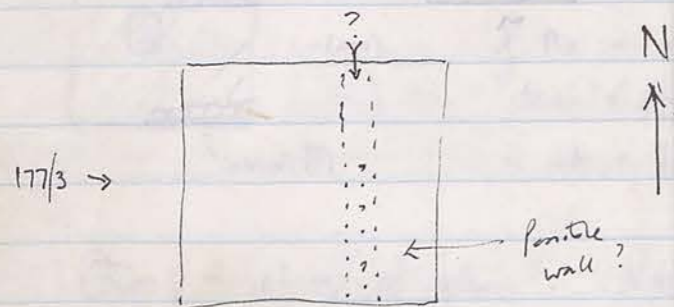

275

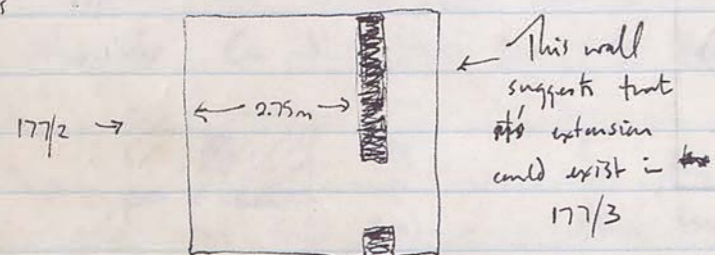

This split created 2 new contexts - ie [2] + [3]

Context [2] was located on the Western side of the square while context [3] on the E side.

In fact [3] will be located on the E side of the "wall" but this is being written in anticipation of the wall actually being there.

Should it be that the wall is not there then contexts [2] + [3] will be ~~the same context~~. Both of these contexts commenced at spit (2).

IBRAHIM عبدالله

A small cache of bones was located within ^{context} [2] spit (2) in the following location:

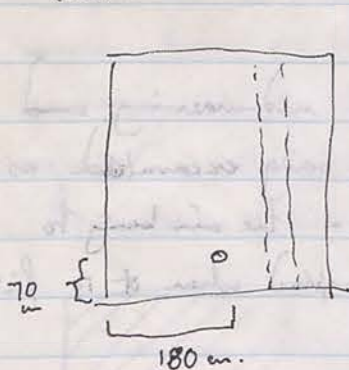

at a depth of 20m below the surface of this spit.

By approx. 10.30 today the line of a likely N/S aligned wall in the expected location was becoming visible.

17

amar: { build/builds... }
amar: { build/builds... }

8/10/96

Continued the clearance of context [2] spit (2): Progress to date:

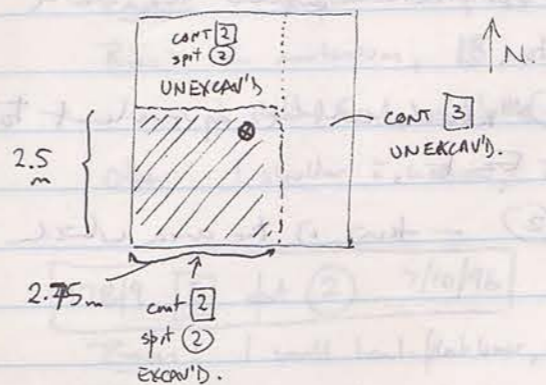

location of small bone cluster at c. 30cm deep co-ords at → 2.60m and ↑ 2.40m.

Bone was retained in a general bone bag and not separately.

Note that the soil which constitutes spit (2) is generally a ~~red~~ slightly reddish brown colour rather than the more beige/tan colour of the rest of the topsoil and the soil in the adjacent trench (178/9).

9/10/96

Continued the clearance of context [2] spit (2) - very close to the end.

A coin was found approx.

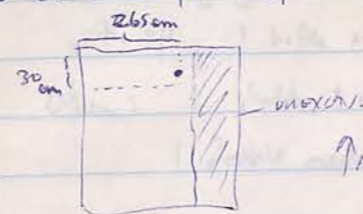

Depths at the end of spit (2) were as follows:

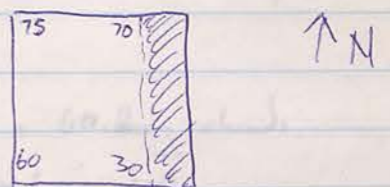

The trench has now been extended by 1.8m to the West in a bid to locate the Western boundary wall of the housing complex. This new area has been labelled as context [4]. Spit (1) is the removal of the topsoil only to reveal the emergence of stones so that the Western boundary wall can be seen (hopefully!).

which should be

At this stage the other N-S aligned wall (located at 1.25m from the E side) is not yet visible. No excavation has commenced on context [3] which is the context relating to this "wall".

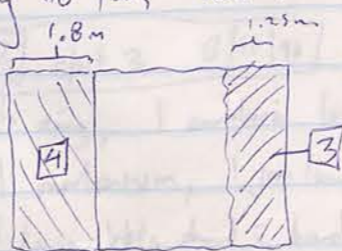

Context [4] spit (1) should be completed by the end of today (or at least close to completed).

10/10/96

The completion of context 4 spit 1 illuminated the NS aligned western boundary wall. For the continuation of this excavation around the wall the area will be further subdivided into 2 contexts.

East of the wall the context will be 2 spit 2 which will be equivalent to the context 2 material already removed to the East.

West of the wall will be context 5 spit 2 - this is the area which covers the boundary wall.

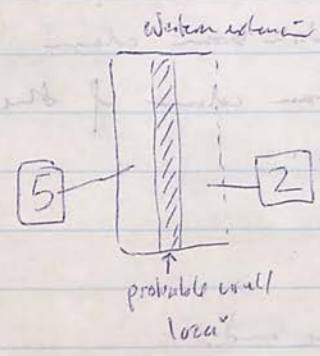

POTTERY

177/3 2 spit 2 7/10/96 c. 75 body sherds.

Bases: 1 amphora toe, 17 ring bases.

Rims: 2 mortarium, 15 medium sized jar rims, 2 echinus, 1 r/s bowl, 2 straight sided bowls, 1 shallow bowl, 1 bottle neck.

Other: 1 shoulder & incision, 2 strap handles.

178/9 5 spit 2 7/10/96 c. 50 body sherds.

Bases: 1 small bowl-flat base, 1 amphora toe, 4 ring, 1 fish plate.

Rims: 1 jar, 4 mortarium, 1 small bowl.

Other: 1 strap handle, 2 strap handle & root. 3 pieces of roof tile (bagged separately).

178/9 2 spit 2 7/10/96 c. 70 body sherds.

Bases: 5 ring, 1 small bowl-raised ring,

Rims: 1 large jar, 4 medium jar, 1 echinus, 2 straight sided bowls, 1 right angled straight sided bowl with r/s, 1 bottle neck, 2 plate.

Other: 1 shoulder & neck body sherd & horizontal & vertical incision, 1 strap handle & root, 1 double need handle.

177/3 2 spit 2 8/10/96 BAS 1 c. 60 body sherds.

Bases: 4 ring (1 large 3 med.), 1 center of ring base.

Rims: 3 jars (1 v. large), 2 straight sided bowls, 1 lipped plate, 1 echinus, 1 bottle, 1 jar/small bowl??

Other: 1 double need handle & root, 1 strap handle & root, 1 jar rim & handle, 1 handle root, 1 r/s body sherd with horizontal incision, 1 mid tongue-shaped object.

BAS 2 c. 60 body sherds.

Bases: 6 ring bases,

Rims: 7 jar, 1 fish plate, 3 straight sided bowl, 1 straight sided bowl & double incision, 4 echinus, 1 horiz. rimmed jar, 3 small plain jar,

Other: 7 strap handles (2 & root), 1 single need handle root, 3 body sherds & horiz. incision.

178/9 2 spit 3 8/10/96 c. 60 body sherds.

Bases: 6 ring, 1 amphora toe.

Rims: 1 mortarium, 1 jar (small), 1 jar & handle root, 1 blue glazed rim.

Other: 1 large body sherd & handle root & horiz. incision, 1 strap handle root, 1 roof tile (bagged separately)

178/9 cont 7 spit 4 12/10/96

2 adjoining pieces of amphora ~~including~~ toe.

178/9 cont 7 spit 4 12/10/96

c 60 body shards

Bases: 4 ring, 1 amphora toe

Rims: 6 jar rims, 2 eadims

Other: 1 body shard c 2 handle roots

POTTERY

178/9 CONT'D. 10/10/96

located within context 2 spit 3 was a piece of a stone vessel. This has been bagged separately for objects but ultimately may be considered to be junk.

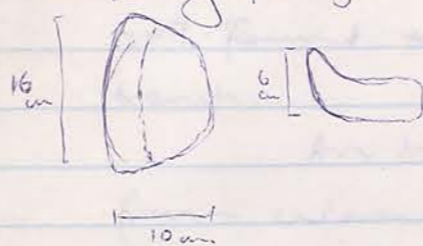

OK - further progress today was bloody slow. The extraneous rubble around the Sth "wall" area was removed to reveal a single line of vertical, & partly dressed stones - one of which appears to have been well dressed & redepicted - maybe a piece of door, roof or guttering which appears at this stage to have been incorporated into a rebuilt wall.

This element should be drawn next week.



The completion of context 2 spit 3 and context 6 spit 3 resulted in ~~the~~ a compacted surface being visible across all of the trench area.

While the diggers believed that this was a floor it is noticeably uneven with high corners and a sunken centre and does not appear to be a very convincing floor level.

To my eye the soil colour on the Nth side of the trench is quite noticeably ~~red~~ a more red/brown colour rather than the very plain tan/beige colour of the rest of the floor area in the centre.

[Faint handwritten notes, possibly bleed-through from the reverse side]

13/10/96

[Faint handwritten notes, possibly bleed-through from the reverse side]

[Faint handwritten notes at the bottom of the page]

26

(Esa)

178/9

13/10/96

Continuation of excavation of context 7, spit 4.
A fragment of a figurine was found at a depth of 58cm below S' wall of trench. (x)

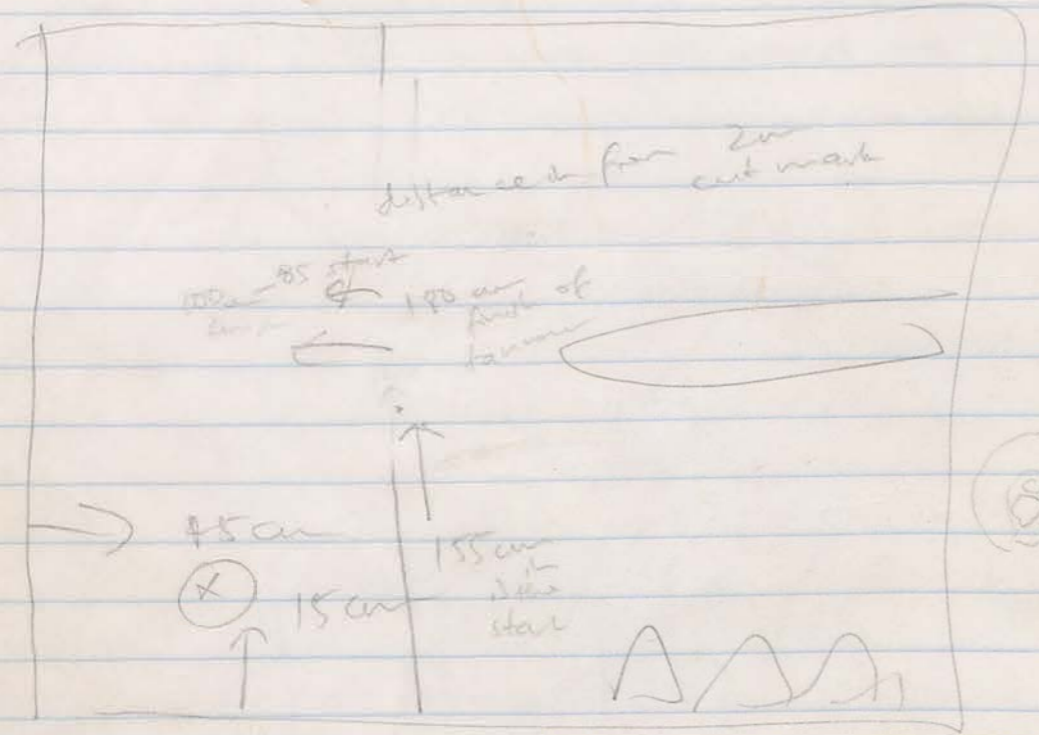

Soil still contains charcoal flecks. Also occasional bursts of colour - i.e. intense cream patches amidst the pale brown. River shells also scattered.

A tannour found at 8.30am, at a depth of 100cm below W' wall of trench.

At the base of the tannour, + inside it, is a deposit of dark brown soil. This layer appears to be associated with an earlier floor underlying the existing floor surface. Will continue removing spit 4, context 7 until this secondary floor surface is fully revealed. Photo - CP roll 3, 21.

An intact jug handle recovered from the SE corner of the cut.
CP roll 3, 21

27

13/10/96

177/3

Halted excavation of cont. 5, spit 2 as fragments of the road surface beneath the rubble blocks are now visible. Now remaining rubble to further define the E' end face of the N/S wall.

Also opened a window cut in trench along the E' end face of the NS wall. Several nails and metal pieces have been recovered from this spit - context

2 Spit 3

Change in pottery

178/9 cont....

13/10/96

A second potential tannour unearthed with a large concentration of ash half way along the W' end trench boundary - however there are no actual remains of the tannour beyond this.

A piece of basalt found near this which I am informed by the workers is used in making bread (?).

28

14/10/96

178/9

Observations after returning to work.

The alleged 'tannor' is quite small - approx 23 cm in diam and a similar looking unit was uncovered by Heather ~~Jones~~ nearby. She referred to this smaller type tannor as a "pot hole" which I find to be an adequately descriptive term as well - perhaps a smaller type tannor thing for heating/cooking with a single "pot".

Regarding the "floor" level noted on the 10th/10 and measured at 12/10 - Given that the "pot hole" was not visible on this level but very closely under it - i.e. within a few centimetres - it appears ~~that~~ likely that my earlier suspicions that the floor level was not quite right, were correct.

It appears as though had we taken more of the compacted soil from the W side of the trench we could have exposed the correct floor level and in doing so, we could have exposed the 'pot hole' on ~~the~~ ^{the} ~~level~~ ^{level} at which it was sheared off - adj. to the existing floor.

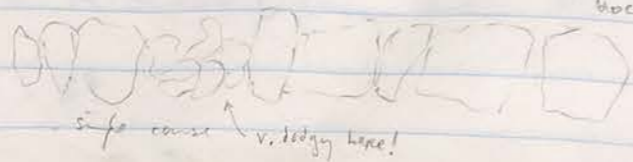
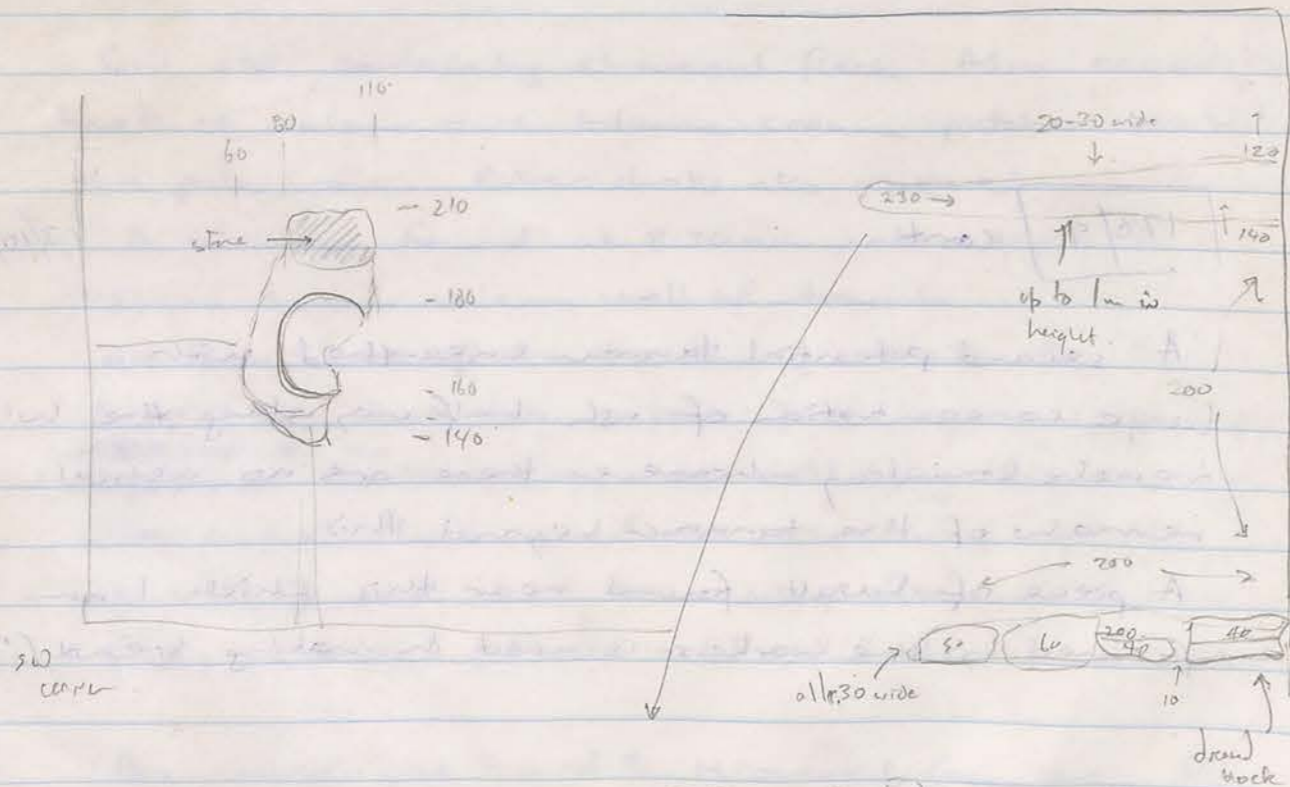

29

14/10/96

TRENCH
177/3

Western side of boundary wall has 1 large worked block of stone at the Nth end below which is a small section of compacted 'limestone' sherry looking surface - this surface is extremely hard and a light creamy colour it is approx. 22 cm below the top of the block.

Below this is a compacted grey/brown dirt layer which is not as hard as the 'limestone' sherry type layer. This compacted layer may have been a ~~second~~ primary road surface laid prior to the 'limestone' sherry as a secondary road surface. ~~Below~~ This layer was located c. 10 cm below the "secondary" 'limestone' sherry layer.

This "primary" compacted grey/brown dirt layer lay over a line of rock adjacent to the wall -

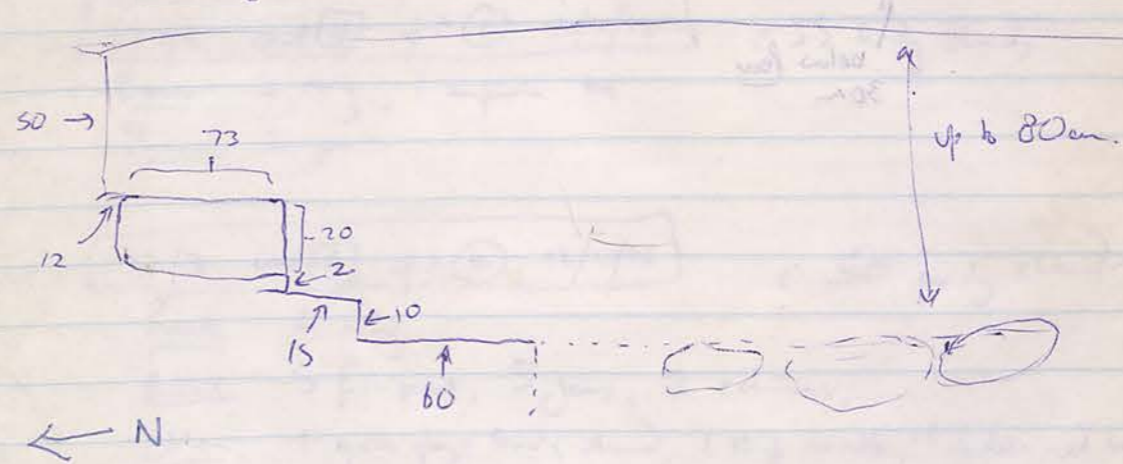

NOTE

Depth of cent. $\text{\textcircled{R}}$ spt $\text{\textcircled{2}}$ at the end was c. 70 cm below surface on Nth side + c. 35 cm on the Sth side.

30

~~178/9~~

178/9 cont'd.

Completed context [7] spit (4) to the following Spheres:

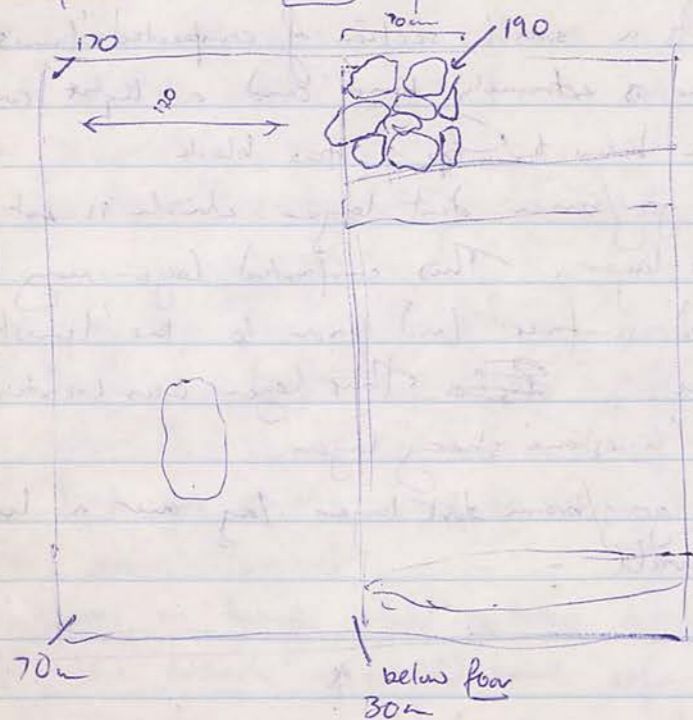

POTTERY

31

177/3 cont [4] spit (1) 9/10/96 - 74 body shands.

Bases: 6 ring

Rims: 1 jar, 2 wide shallow bowl/plate (one broken into 2 pieces).

178/9 cont [2] spit (2) 8/10/96 40 body shands.

Bases: 1 Ring

Rims: 1 jar, 1 echinus, 1 small shallow bowl/plate

Other: 1 amphora handle frag; 1 strap handle rest, 2 r/s body shands.

178/9 cont [5] spit (2) 8/10/96 83 body shands

Rims: 3 jar, 2 murtarium, 1 wide bottle rim.

177/3 cont [4] spit (1) 10/10/96 c 35 body shands

Bases: 2 ring, 1 amphora toe.

Rims: 2 jar.

177/3 cont [5] spit (2) 12/10/96 c 50 body shands?

Bases: 4 ring

Rims: 5 flat plate, 5 jars, 2 echinus,

Other: 1 green glaze body shand, 1 strap handle, 1 double ored handle frag.

178/9 cont [6] spit (3) 10/10/96

8 body shands, 1 jar rim.

178/9 cont [2] spit (2) 10/10/96

4 body shands, 1 amphora handle, 2 ring bases.

177/3 cont [5] spit (2) 12/10/96 RM 2 c 40 body shands

Bases: 2 amphora toes, 5 ring bases.

Rims: 1 ring coarse vessel, 2 echinus, 1 murtarium, 1 shallow plate.

Other: 2 amphora handle segments

POTTERY

32

178/9 cont 2 spit 3 10/10/96 c. 35 body sherds

Bases: 1 Ring, 1 amphora toe,

Rims: 1 small R/S cup, 1 jar

Other: 1 complete strap handle, 1 round handle frag, 1 strap handle frag, 1 body sherd shoulder and neck with horiz. mixed lines.

177/3 cont 5 spit 2 10/10/96 c. 60 body sherds

Bases: 7 ring base frags, 1 amphora toe frag.

Rims: 3 mortarium, 3 fish plate, 3 shallow plate, 3 bowl, 1 bottle neck frag,

8 jar (of various sizes), 6 echinus,

Other: 2 strap handle roots.

177/3 cont 5 spit 2 10/10/96 BAG 2 c. 40 body sherds

Bases: 1 ring

Rims: 3 jar, 1 cup.

Other: 1 strap handle, 1 twisted double reed handle frag.

177/3 cont 2 spit 2 9/10/96 c. 80 body sherds

Bases: 4 ring, 1 fish plate, 1 ring base with strap handle root.

Rims: 4 echinus, 1 mortarium, 7 jar rim frags (9 medium), 1 flat plate, 1 R/S cup, 1 R/S small bowl/cup.

Other: 1 strap handle.

178/9 cont 2 spit 3 9/10/96 c. 50 body sherds *

Bases: 2 fish plate, 9 ring bases (1 is R/S and raised).

Rims: 5 large jar, 6 medium jar, 2 mortarium, 1 small R/S bowl or cup, 3 fish plate, 3 echinus,

Other: 1 spat frag.

178/9 cont 6 spit 3 9/10/96 c. 35 body sherds

Bases: 3 ring, 1 amphora toe (with holes)

Rims: 4 jar, 2 mortarium, 1 echinus (black), 1 small cup/bowl R/S, 1 plate (R/S)

Other: 4 strap handle roots, 1 small strap handle, 1 big strap handle, 1 amphora handle.

33

Pottery

177/3 cont 2 spit 3 13/10/96 c. 60 body sherds

Rims: 9 jar, 1 straight sided bowl, 2 out-turned plates, 2 fish plates, 3 echinus,

Other: 1 strap handle frag, 2 strap handle + jar rim, 1 strap handle root, 1 applied decorat body sherd, 1 small spint (in 3 pieces).

178/9 cont 7 spit 4 13/10/96

Bases: 3 fish plates, 1 ring, 2 amphora toe frags.

Rims: 3 jar, 1 fish plate, 2 echinus, 2 wide shallow bowls/plates.

Other: 2 strap handle roots, 1 pitcher frag + handle root, 1 small handle root, 1 jar rim + strap handle root, 1 complete jar neck + handle, 1 amphora handle frag.

177/3 cont 2 spit 3 14/10/96 BAG 1 c. 80 body sherds

Bases: 2 amphora toes, 7 ring bases, 1 fish plate.

Rims: 2 mortarium, 2 straight sided bowls, 4 jars, 4 echinus, 1 out-turned jar rim, 1 out-turned plate,

Other: 1 handle root, 1 strap handle frag + root, 1 incised + striped body sherd.

178/9 cont 7 spit 4 14/10/96 c. 50 body sherds

Bases: 4 ring

Rims: 3 jar (2 large - one of which has a handle root), 1 out-turned cup/bowl, 4 echinus.

Other: 1 handle root, 1 round handle, 1 strap handle.

178/9 cont 8 spit 4 14/10/96 c. 20 body sherds

1 Ring base, 2 jar rims.

177/3 cont 2 spit 2 13/10/96 c. 30 body sherds

Bases: 6 ring.

Rims: 5 jar (1 is handle root), 3 echinus,

Other: 1 round handle, 1 handle root.

177/3 cont 2 spit 3 BAG 2 14/10/96 c 60 body shreds.

- Bases: 9 ring, 1 unguentarium, 1 rounded.
- Rims: 10 jar (1 huge, 1 i handle root), 2 mortarium, 1 small cup/bowl, 1 outturned bowl, 1 shallow plate, 1 echiurus,
- Other: 2 strap handles, 1 bottle neck i handle root.

178/9 cont 5 spit 3 14/10/96 c. 20 body frags.

- Bases: 3 ring
- Rims: 2 echiurus, 1 jar
- Other: 1 raised body frag.

177/3 cont 2 spit 2 14/10/96 BAG 3 c 30 body shreds.

- 1 ring base, 1 strap handle.

178/9 cont 7 spit 4 13/10/96 Tannare 1 - 1 bag of 12 tannar frags.

178/9 cont 7 spit 5 15/10/96 c 100+ body shreds.

- Bases: 2 amphora toes, 19 ring bases, 2 flat base (1 big, 1 small).
- Rims: 4 medium jar, 2 small jar, 5 small straight-sided bowls, 1 huge jar, 1 mortarium, 1 wobbly jar rim, 1 bottle neck, 7 echiurus, 1 unid. rim.
- Other: 1 amphora handle frag, 5 strap handle roots, 2 strap handle frags, 1 amphora handle root.

177/3 cont 2 spit 3 15/10/96 c 60 body shreds.

- Bases: 1 amphora toe, 1 green glazed footed base, 1 cord base, 9 ring.
- Rims: 2 straight sided jar, 1 outturned jar, 7 medium jar, 2 straight sided bowls, 1 outturned bowl, 7 echiurus.
- Other: 1 unguentarium stem frag, 1 strap handle.

177/3 cont 2 spit 2 15/10/96 c 80 body shreds

- Bases: 1 flat, 1 ring.
- Rims: 5 med. jars (1 i handle), 3 fish plate, 3 echiurus, 1 straight sided bowl, 1 small jar, 1 shallow bowl.

178/9 cont 7 spit 4 15/10/96 tannare 2 - 1 bag of 18 frags.

177/3 15/10/96.

Current trench status: continued progress of context 2 spit 3. No work done yet on context 3 context 4 spit 1 complete and context 5 spit 2 completed.

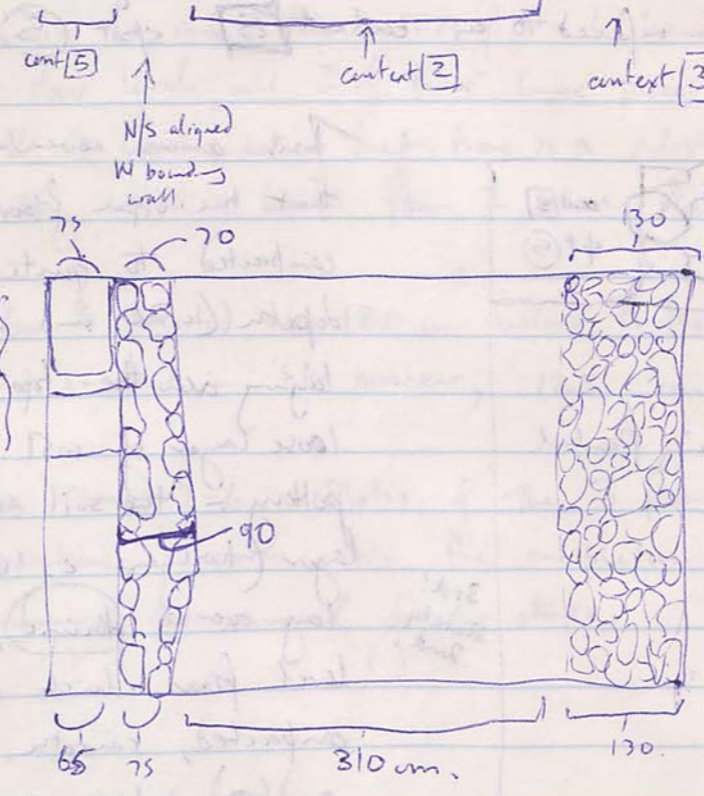
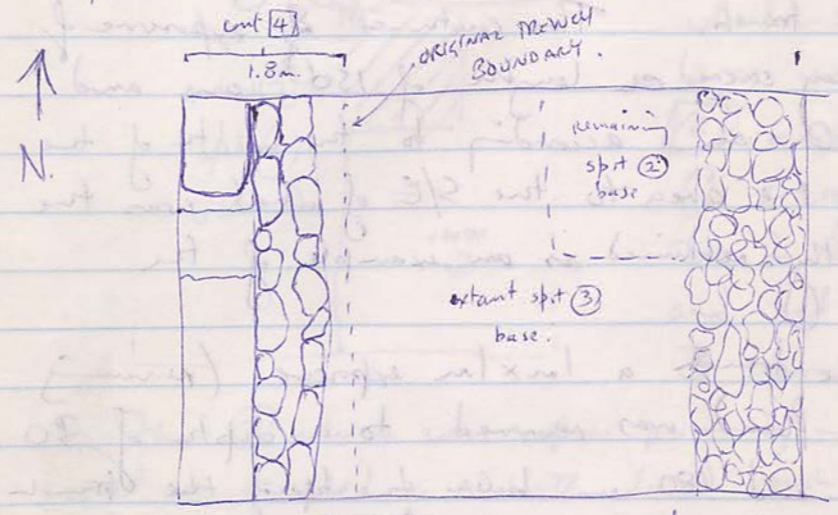

SEE REVISIONS OF CONTEXT 3 on 16/10/96.

178/9 15/10/96

The face of the trench looks quite different now.

Cont 7 was the removal of half the floor on the Western side of the trench as noted yesterday.

This revealed a 70cm stretch of stones at a depth of 190cm against the Nth wall of the trench. The continued exposure of these stones revealed that they covered a length of 150cm and up to a nominal width of 90cm according to the width of the area we excavated. (All of the area to the S/E of what was the Nth wall has been currently retained as an example of the previous floor level.

In the NE corner of the trench a 1m x 1m exposure (removing between the stones and the old floor) was removed to a depth of 30cm below the old floor level and 180cm below the top of the trench corner. This area has been referred to as context 8 spit 5.

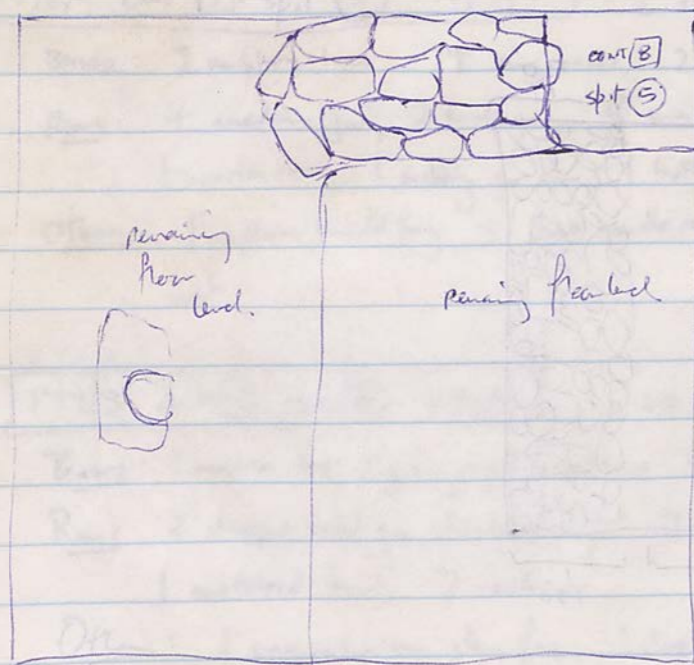

This area revealed that the upper floor was compacted to quite a depth (c. 20cm) and laying over the top of a loose layer of soil and pottery - the soil and pottery layer (thickness c. 10cm) lay over a (thin), lower level floor which was compacted, smooth, flat and had pebbles cemented into its matrix (sporadically). Red Brown coloured material

178/9 cont'd 15/10/96

An additional area was added to context 7 spit 4 (area marked as [E])

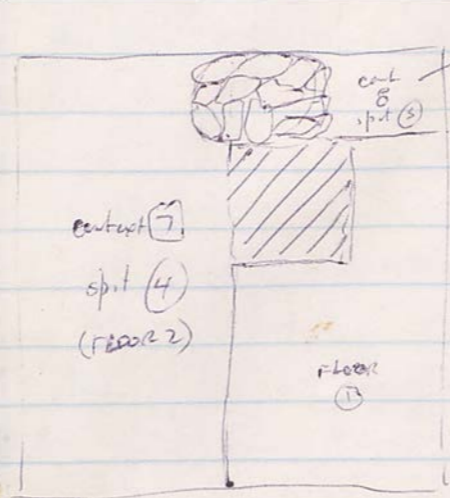

This area was excavated to establish whether the floor level in context 7 area was the same as that in context [E] area.

As it was this demonstrated to me that the 2 floor levels were not the same and that in fact we are looking at 3 separate flooring events.

Floor 2 which was exposed primarily in the context 7 area could be described as a white colored crust/slurry of a limey stone (quite chalky) (not unlike the road surfaces outside of the W boundary wall in trench 177/5). Like other floor levels, all 3 of these have pieces of pottery pressed into them but it is worth noting that there is a substantial increase in the amount of pottery which is below floor 2, above floor 3.

Floor 3 located at 180cm below surface in NE corner and 100cm below surface in SW corner, 123cm below surface mid Western wall.

CP4 frames 2-6. - Photos of the 3 floor levels all together plus the agglomeration of stones. At the completion of this photo session we commenced the removal of the stones.

SKETCH OF TANNOOR 2
178/9 CONT 7 spit 4
B. ROWNEY - 15/10/96.

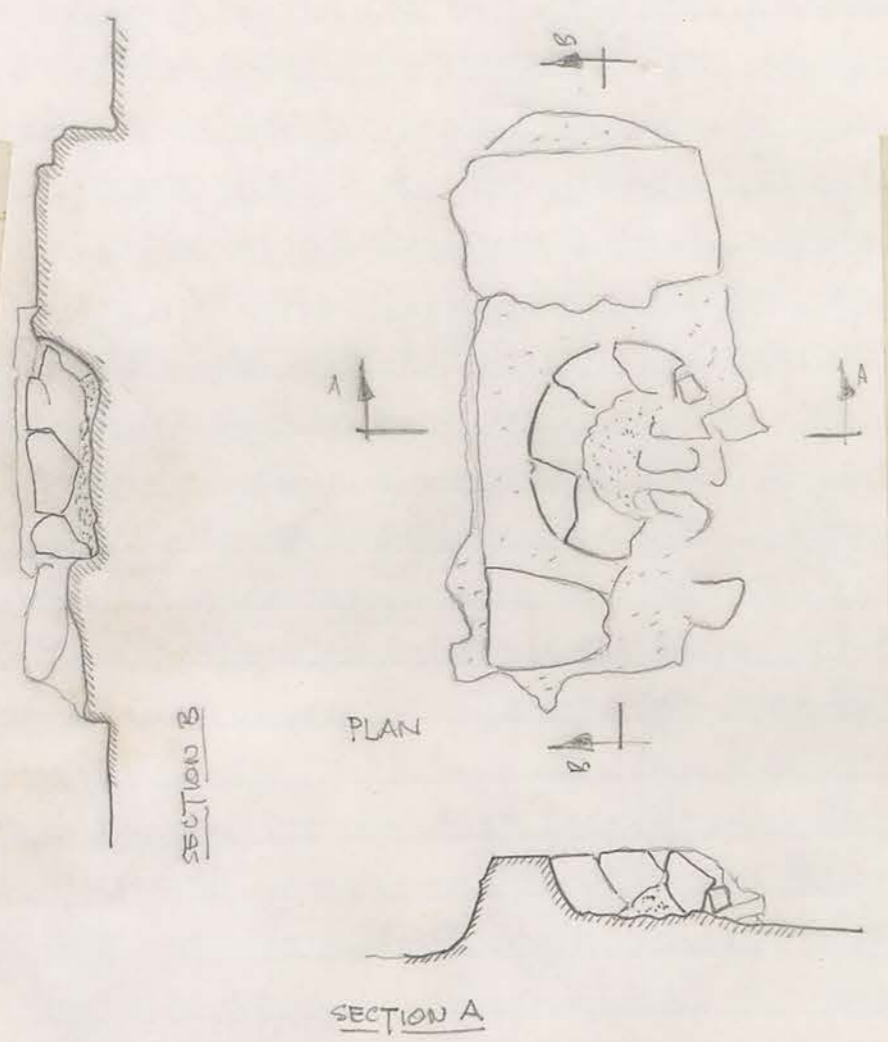

From sketch
wall 4 = 11-12
sp

CHECK 15/10/96 POTTERY LABEL -
SHOULD BE CONT 2 SPIT 2.

1773 16/10/96

Embarked upon the removal of context 3. This area was tackled in two spits to bring it to the same depth as the rest of the trench. Approximately 60-70cm from the Eastern side of the trench a N/S aligned wall was encountered. Because of the proximity of this wall to the edge of the trench (ie the width of the wall was 60-70cm from edge of trench i.e. old wall abuts the edge of the trench), we have decided ~~to delete context 3~~ that context 3 is now the wall itself and any deposits above it or included within it (with the exception of context 11 spit 1 which overlaps the top of this [and all] contexts).

Both walls have been cleaned up ~~at~~ wall 1 [context 3] requires a little more as it appears to have a door in it which requires full exposure. Commented that Wall 2 is the Western boundary wall which is in poor condition. Commenced on the excavation of context 2 spit 4. A strong harder and slightly browner soil type - compact.

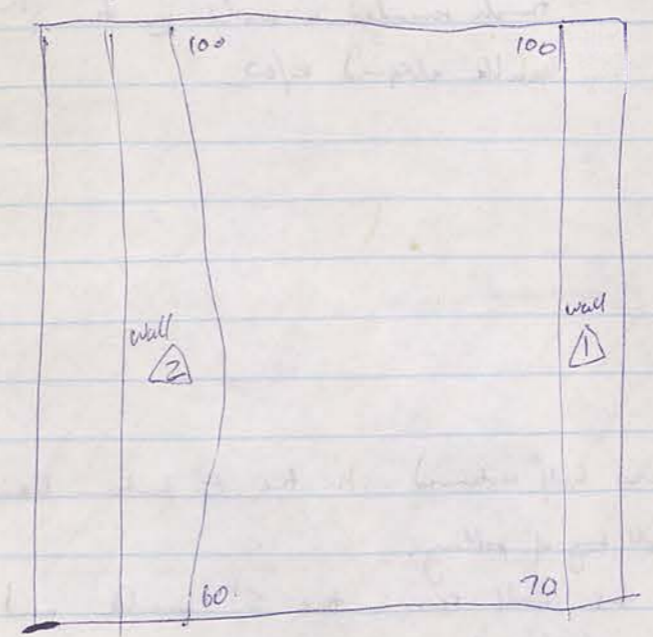

Depths at the end of ~~the~~
cont 2 spit 3

17/10/96
All day spent on the continuing removal of context 2 spit 4. The matrix is extremely tough and progress is slow. ~~However~~ This spit appears to be approx. 10cm in depth only - will be resumed later.

1789 11/10/96

M.A. MILARDEE

Having established the existence of 3 floors, excavation commenced with the removal of the group of clustered stones near the Nth wall. No pottery was revealed during this and floor 3 was not found under this area. These stones lay directly into bedrock, and appear to be rubble from a structural collapse rather than having a part in any known design. This collapse appears to have ~~removed~~ ^{destroyed} the remainder of floor 3 in this area. Also embarked upon the excavation of cut [9] spit 5. Cut [9] was the removal of the Sth half of floors 2 + 3 in the SW corner in order to determine the depths of the B/Rock in this area. This work was not completed today. This

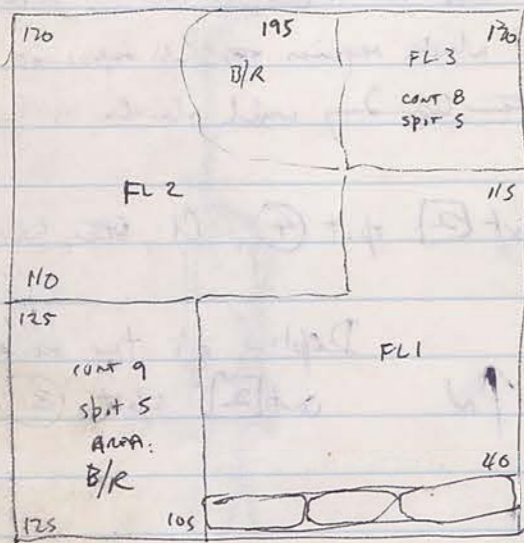

drawings.
Depths of bedrock at completion.
← + floors

NB Cleaning of the Sth wall of the trench revealed a wall in the Sth bank aligned E/W.

178/9 - Sth Bank This bank was half sectioned with the E portion being removed. Labeled as 178/9 Sth bank. - 1 small bag of pottery.

Here's why: The relationship between the wall seen in the Sth bank and the line of standing stones in the SE corner of the trench is not clear.

On this basis it was decided to remove the E half to establish whether the wall continues thru' the bank or not.

Result: It does. see ^{final} drawings of 178/9 which will include this.

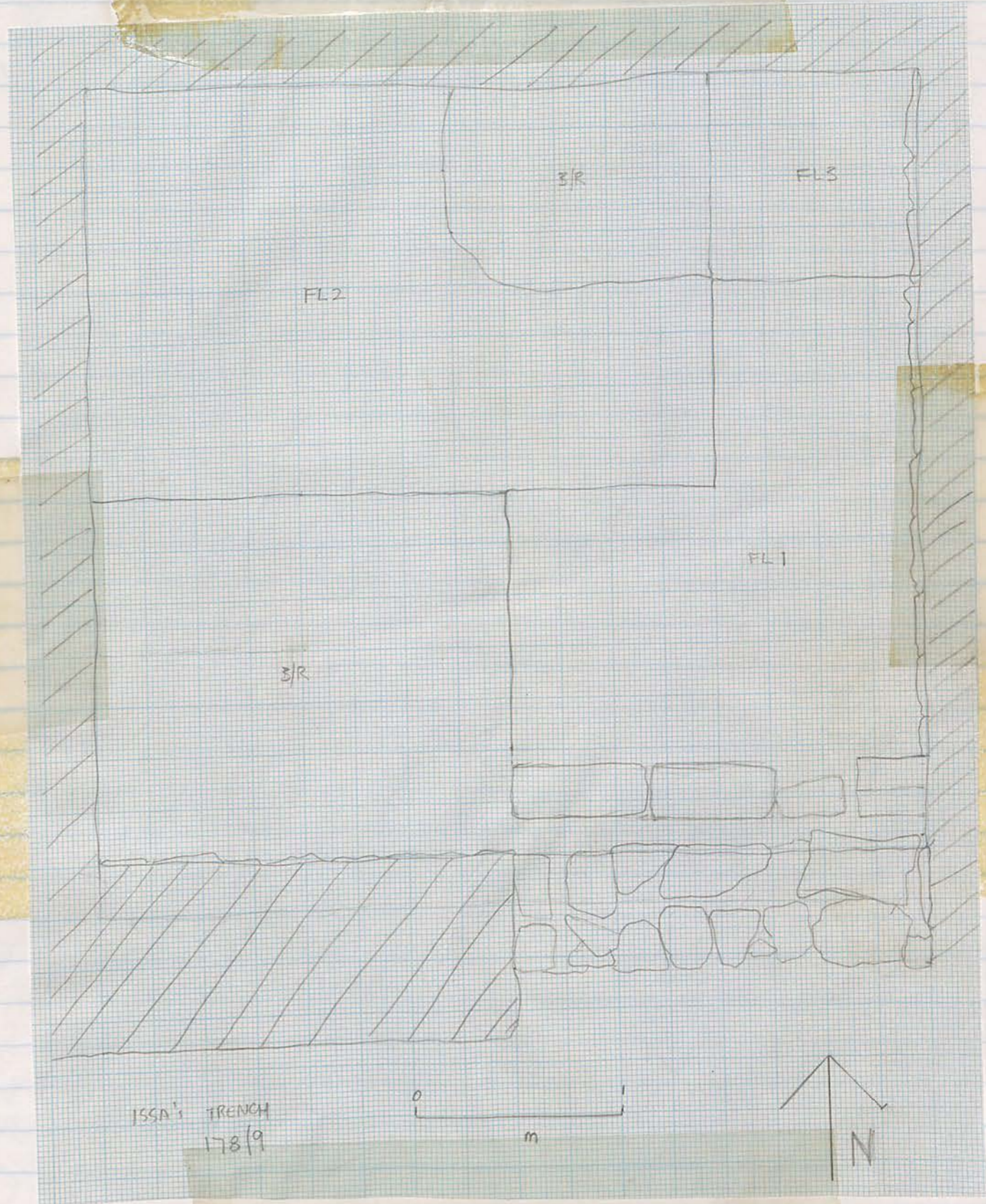

REFER TO TRENCH REPORT.

WEST SECTION 178/9

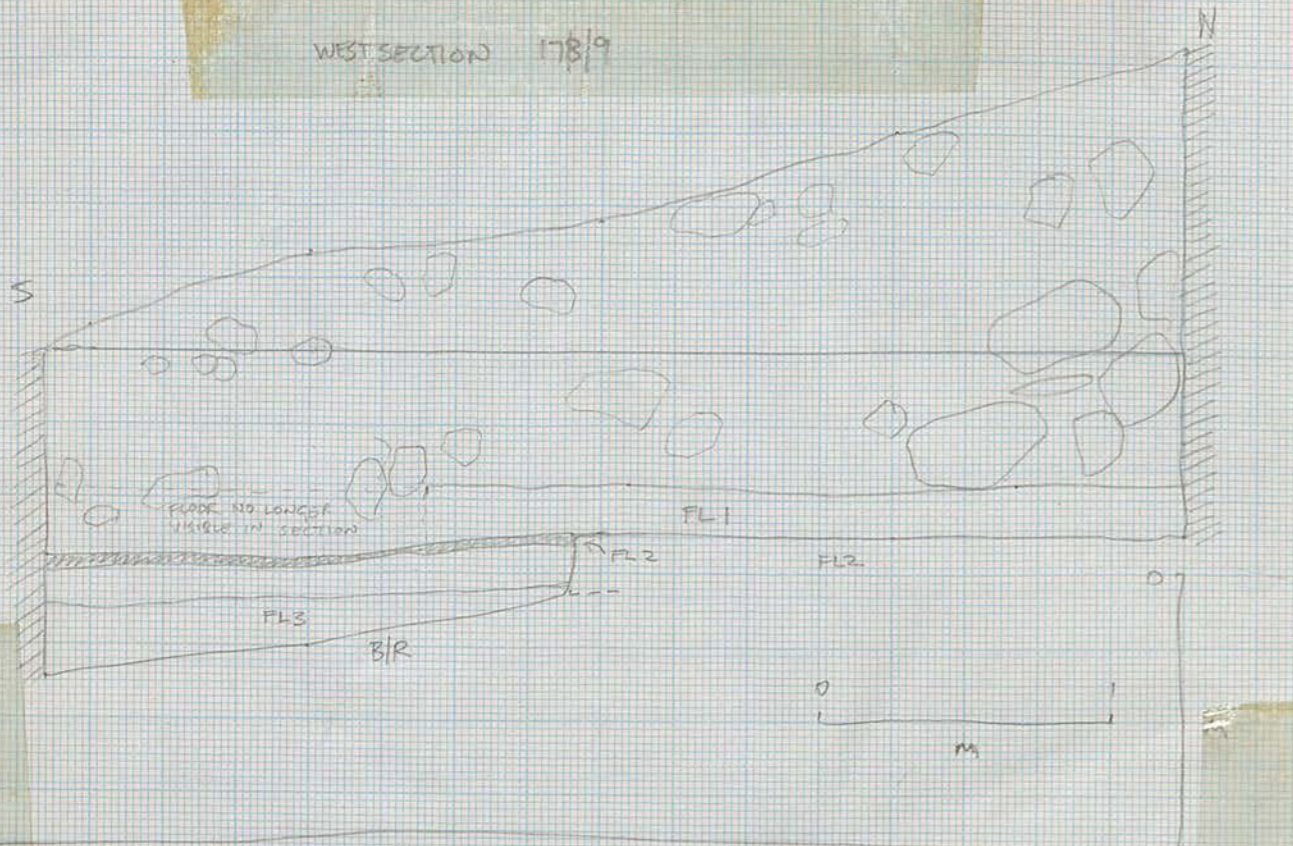

FLAKE NO LONGER VISIBLE IN SECTION

S/W SECTION

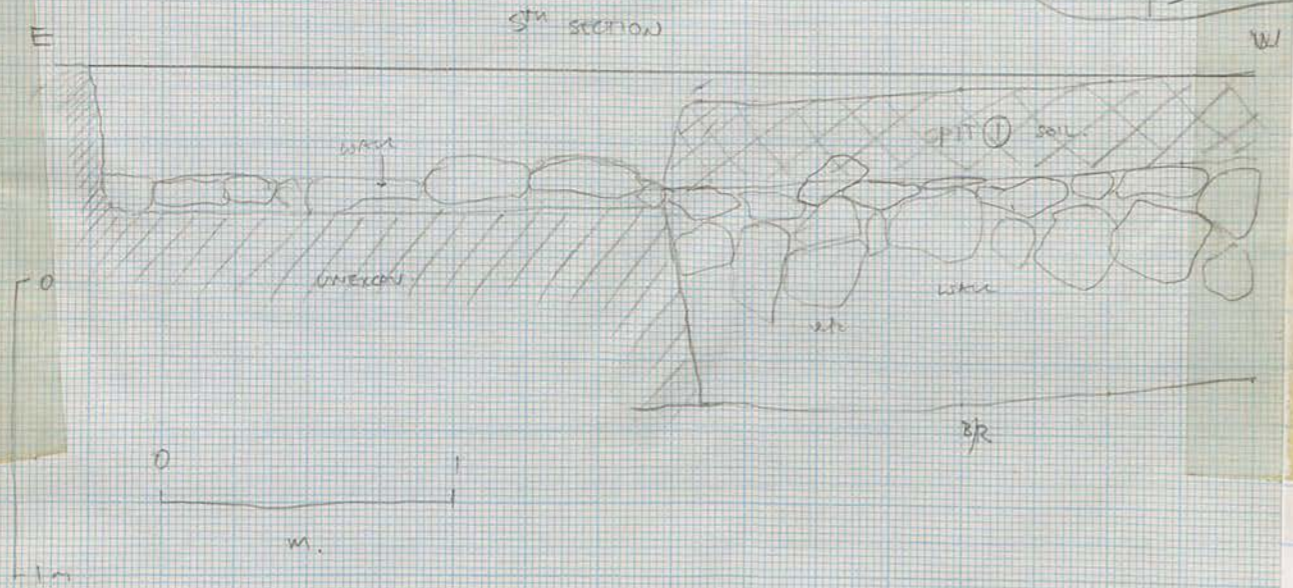

EAST WALL SKETCH ONLY

TOILETRY

1701/2 NEW TOWER ON 17/10/96

1701/2 out of 17/10/96 (17/10/96) at 17/10/96

1701/2 out of 17/10/96 (17/10/96) at 17/10/96

1701/2 out of 17/10/96 (17/10/96) at 17/10/96

1701/2 out of 17/10/96 (17/10/96) at 17/10/96

1701/2 out of 17/10/96 (17/10/96) at 17/10/96

1701/2 out of 17/10/96 (17/10/96) at 17/10/96

1701/2 out of 17/10/96 (17/10/96) at 17/10/96

1701/2 out of 17/10/96 (17/10/96) at 17/10/96

1701/2 out of 17/10/96 (17/10/96) at 17/10/96

1701/2 out of 17/10/96 (17/10/96) at 17/10/96

1701/2 out of 17/10/96 (17/10/96) at 17/10/96

1701/2 out of 17/10/96 (17/10/96) at 17/10/96

1701/2 out of 17/10/96 (17/10/96) at 17/10/96

1701/2 out of 17/10/96 (17/10/96) at 17/10/96

1701/2 out of 17/10/96 (17/10/96) at 17/10/96

1701/2 out of 17/10/96 (17/10/96) at 17/10/96

1701/2 out of 17/10/96 (17/10/96) at 17/10/96

1701/2 out of 17/10/96 (17/10/96) at 17/10/96

1701/2 out of 17/10/96 (17/10/96) at 17/10/96

1701/2 out of 17/10/96 (17/10/96) at 17/10/96

1701/2 out of 17/10/96 (17/10/96) at 17/10/96

1701/2 out of 17/10/96 (17/10/96) at 17/10/96

1701/2 out of 17/10/96 (17/10/96) at 17/10/96

1701/2 out of 17/10/96 (17/10/96) at 17/10/96

1701/2 out of 17/10/96 (17/10/96) at 17/10/96

1701/2 out of 17/10/96 (17/10/96) at 17/10/96

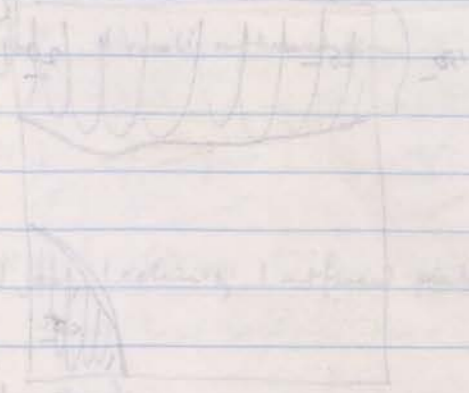

1701/2 out of 17/10/96 (17/10/96) at 17/10/96

1701/2 out of 17/10/96 (17/10/96) at 17/10/96

1701/2 out of 17/10/96 (17/10/96) at 17/10/96

1701/2 out of 17/10/96 (17/10/96) at 17/10/96

1701/2 out of 17/10/96 (17/10/96) at 17/10/96

1701/2 out of 17/10/96 (17/10/96) at 17/10/96

1701/2 out of 17/10/96 (17/10/96) at 17/10/96

150/2 NEW TRENCH ON 17/10/96

(44)

Began clearance of some spoil on top of two trenches although not all of the trench area has spoil.

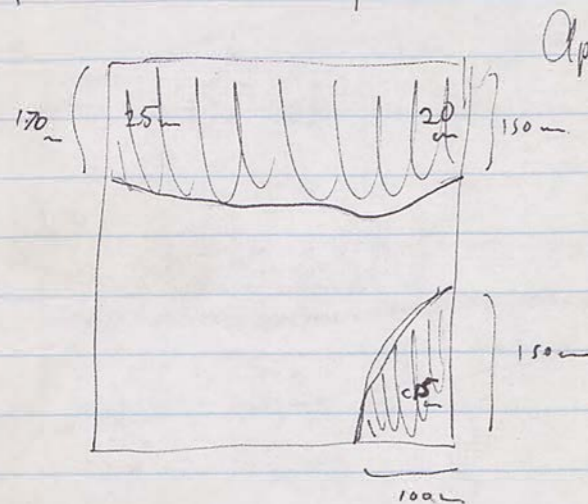

Some of cont. [1] spit ① was under-taken.

Spit depths checked.

19/10/96

Continuation of removal of content [1] spit ① across all of the trench area.

20/10/96

Cont [1] spit ① completed by 6:30 am

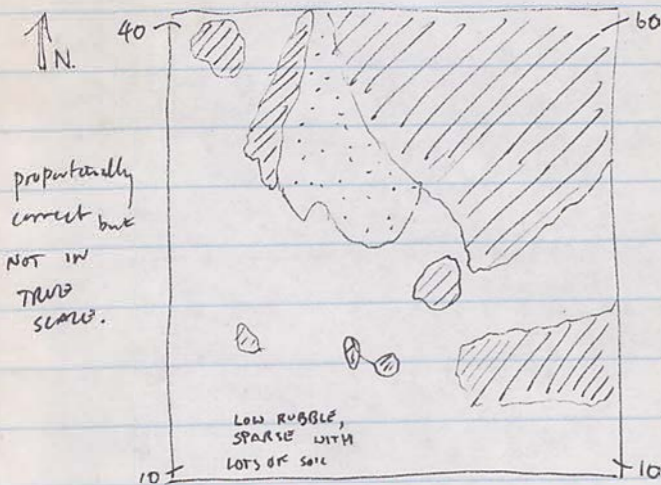

proportionally correct but NOT IN TRENCH SCALING.

- ▨ High rubble, dense
- ▤ decomposed stone

Note that the trench slopes steeply from the Nth to the south. Most of the large rubble is located in the Nth end and is generally ~~poor~~ located above patches of dirt rather than directly over other blocks of stone.

No structures were clearly visible at the end of the ~~previous~~ stage so cont [1] was continued although we started upon spit ②.

POTTERY

(45)

178/9 cont [7] spit ④ 15/10/96

12 body shreds, 1 ring base.

178/9 cont [9] spit ⑤ 15/10/96

c 25 body shreds.

Bases: 3 ring, 1 round Rims: 1 small jar, 1 small outflared rim.

178/9 cont [8] spit ⑤ 15/10/96

Bases: 5 ring

Rims: 3 mortarium, 1 straight sided bowl, 1 jar, 1 echinus, 1 outflared plate.

150/2 cont [1] spit ① 17/10/96

c 50 body shreds.

Bases: 1 flat, 3 ring.

Rims: 2 echinus, 1 jar, 1 jar w handle root, 1 small bowl.

Other: 1 unidentified rim/base, 1 handle (sharp).

✓ 177/3 cont [3] clean up 17/10/96

c. 20 body shreds

2 ring bases, 1 small exp rim (Ms).

✓ 177/3 cont [2] spit ④ 17/10/96

c 100 body shreds

Bases: 1 amphora toe, 2 ring bases.

Rims: 1 mortarium, 3 small bowls, 5 jar, 5 echinus, 1 outflared bowl.

Other: 1 black incised b/sherd, 1 red incised b/sherd, 1 small handle, 1 unguentarium stem frag, 1 amphora handle frag.

178/9 cont [9] spit ⑤ 16/10/96

c 40 b/sherds

Bases: 2 ring

Rims: 2 jar, 1 shallow bowl, 1 echinus.

✓ 177/3 cont [2] spit ③ 16/10/96

c 50 b/sherds

Bases: 3 ring, 1 flat.

Rims: 5 echinus, 2 small bowls, 1 mortarium, 6 jar, 1 shallow plate w incision, 1 fish plate, 1 outflared jar.

Other: 3 strap handles (1 as frag. only), 1 double need handle frag, 1 handle root.

POTTERY

178/9 5th Bank 16/10/96 c. 30 b/sheds.

2 jar rims, 1 ring base, 1 echinus rim.

177/3 cont 2 spt 4 16/10/96 c. 50 b/sheds.

Bases: 1 ingrain toe, 3 ring

Rims: 4 jar, 1 straight sided bowl, 1 deep plate, 9 echinus

Other: 1 amphora toe, 1 strap handle root, 1 raised b/shed.

150/2 cont 1 spt 1 19/10/96 c. 30 body sheds.

1 small outflared bowl rim.

177/3 cont 2 spt 4 19/10/96 c. 100 body sheds.

Bases: 8 ring, 1 amphora toe,

Rims: 7 jar, 1 shallow bowl, 4 echinus, 3 straight sided bowl.

150/2 cont 1 spt 2 20/10/96 c. 25 body sheds.

Bases: 1 ring

Other: 1 strap handle, 1 handle root.

Rims: 1 echinus, 2 outflared bowls.

177/3 cont 2 spt 5 20/10/96 BAG 1 c. 80 body sheds.

Bases: 2 ring, 2 flat

Rims: 10 jar (8 medium, 2 small), 1 echinus, 1 small bottle.

Other: 1 handle root

177/3 cont 2 spt 5 20/10/96 BAG 2 c. 100 body sheds.

Bases: 1 amphora toe, 1 ring base.

Rims: 9 jars (2 w handle roots), 1 large bowl, (small outflared bowl, 2 straight sided bowls, 8 echinus.

Other: 2 round handles.

177/3 cont 3 clean sp 16/10/96 c. 30 b/sheds.

Bases: 2 ring

Rims: 1 echinus, 1 large pot.

177/3

Row CP 4: 26-28.

Cont 2 Spt 4 and levels

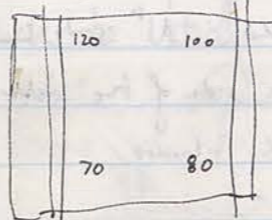

Completed Cont 2 spt 4 at a rough but visible "floor" level. Floor was obviously compacted and contained lime - quite a light colour - close to white. A few inconsistencies were apparent:

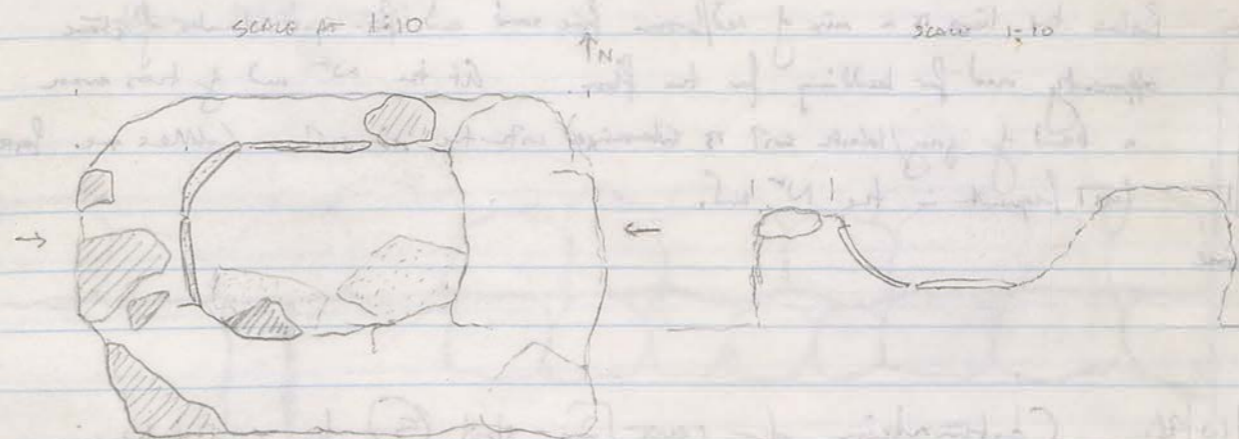
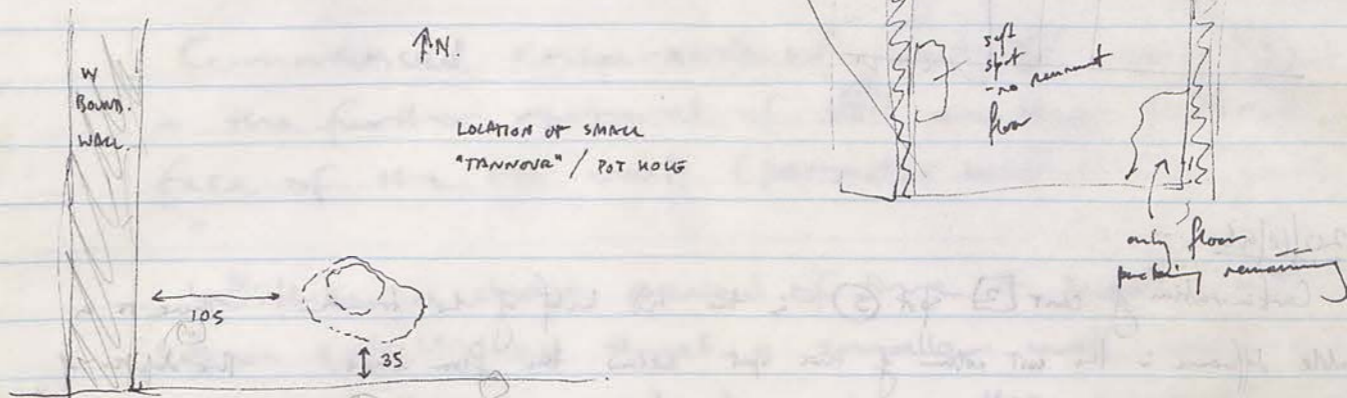

During removal of the "tannour" it was noted that the base contained dark grey soil ~~and a base red crust and a pottery base~~ inside a pottery base/case - this was set onto a base of hard crusted red soil. The unit was encased by very hard light brown soil in line and rocks. Pottery not as burnt or thin as other tannours.

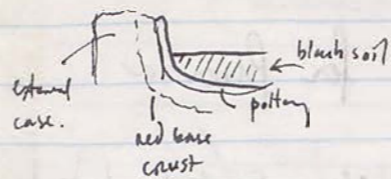

The completion of cont 2 spt 4 was photo'd with the tannour in place (CP 4: 26-28) and then work commenced on spt 5.

Cont 2 spt 5 is being cut only thru' the W half of the floor for a look at B/Rock.

48
177/3

Further notes from 19/10/96. Note that a door was found in the E wall yesterday. Located at: Constructed with a purple terracotta and a hard floor next to the terracotta. Nth side has a vertical stone block for the side of the door. Sth side retains the horizontal blocks.

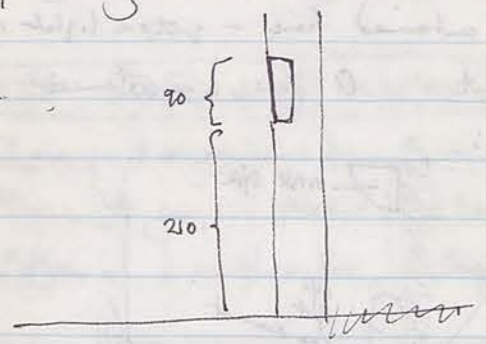

20/10/96

Continuation of cart. [2] spit (5) in the W half of the trench. There is a notable difference in the soil column of this spit below the floor area. The depth of this spit in the center is approx. 30 cm of which approx. 5 cm is a compacted lime floor.

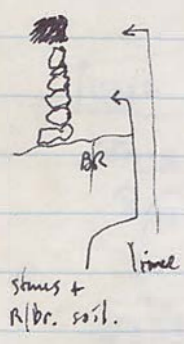

Below the lime is a mix of red/brown fine sand and fist-sized chunks of stone apparently used for bedding for the floor. At the Nth end of this area a band of grey/black soil is intermixed with the red soil. Colours are more less frequent in the Nth end.

21/10/96

Continuation of cart. [2] spit (5) to completion. Only in the W half of the trench. Completed just at the end of the day. Photographed Roll 5: 9-11. See trench report for measurements.

22/10/96

- (1) Clean up West side of west wall area looking for floor or rocks.
- (2) Investigate this area + make one decision - clean right to bedrock.
- (3) Record + photo.
- (4) Shift team to West half of Sth Baulk of trench 178/9

NOTE: 1 piece of red plaster was found embedded into the floor of the E side of this trench

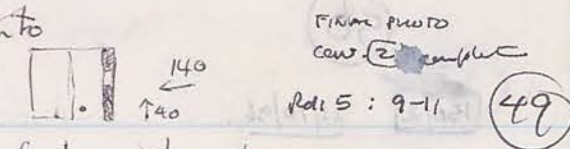

and complete excavate on per the East half of this baulk.

- (5) Take top of East baulk of 178/9 - remove dirt only - all rock to stay.

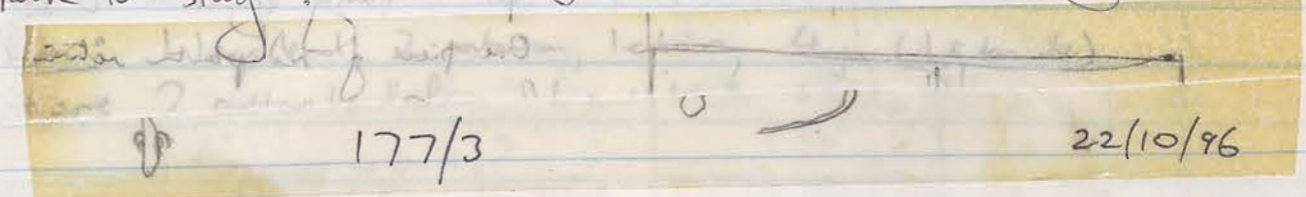

Commenced excavation of cart. [5], spit (3) - the further removal of soil on the W^{est} face of the NS wall. (perimeter wall)

Within a short period of time it had been established that a smaller wall, only 1 stone thick, protrudes along the base of the NS wall.

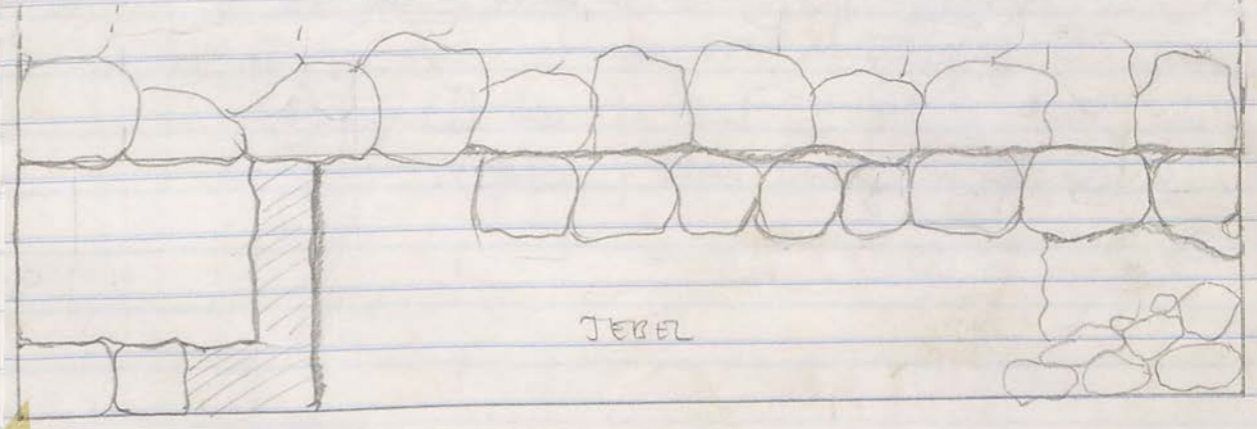

perimeter wall
excavation commenced on the wall of the

the further removal of soil on the west face of the NS wall

150/2 21/10/96

Continuation today of cont 1 spit 2

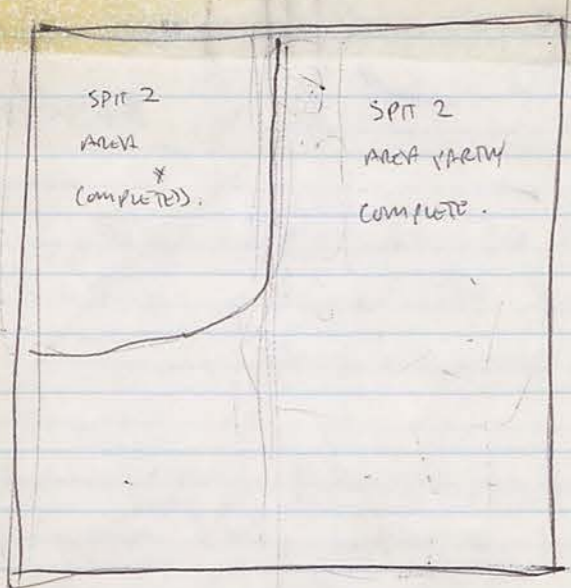

Cleared the NW corner to the base of the spit. Partly cleared the NE corner. One piece of red plaster retained from NE corner.

Spit to be completed tomorrow, after which the trench will be holed with spit 3 to be removed from the E half only. Issa suggests a N/S wall aligned from the centre of the trench. This decision to be qualified later.

22/10/96

- 1) continue context 1 - spit 2 in NE corner - measure or complete
- 2) Make trench - dig E half as cont 2 spit 3.
- 3) Make decision on central wall (optional).

POTTERY

177/3 cont 2 spit 5 21/10/96

Bases: 4 ring, 1 amphora toe, 2 flat, 1 fish plate.
 Rims: 1 large bowl, 2 metanion, 1 echinos, 4 jar (1 in handle)
 Others: 2 amphora handles/legs, 1 small handle, 1 b/sherd & 2 handle roots.

150/2 cont 1 spit 2 21/10/96

Bases: 3 ring, 1 ring base in red/black slip and acrisin.
 Rims: 1 plate in upturned rim, 1 plate in outflared rim, 1 large bowl, 5 echinos.

150/2 cont 1 spit 3 22/10/96

c 30 body sherds
 1 Ring base, 2 jar rims.

170/9 St Bank 22/10/96 - West end

1 unguentarium neck, 1 echinos rim. 6 body sherds.

177/3 cont 5 spit 3 22/10/96

3 ring bases, 1 jar rim. c 40 body sherds.

150/2 DQ 22/10/96.

Commenced work on East half [1] (3).
Plan: level spit consistent in NW corner depth.
Many bajars ∴ slow going.
Few shingles at this point.

New spit to commence once [1] (3) completed — search of wall of room to the East of trench ?? spit between East + West from NWL Boundary — Wall ?? to be cleared from East for determination, perhaps.

[1] (3) excavated to depth of 1m from bank at NE corner.

Central spit (wall) ^{being} cleared is not a feature wall — note like tumble, loosely packed.
At end 22/10/96.



150/2 23/10/96

Strengthened up the end of cent [1] spit (3) in preparation for spit (4).
Final depths for spit (3)

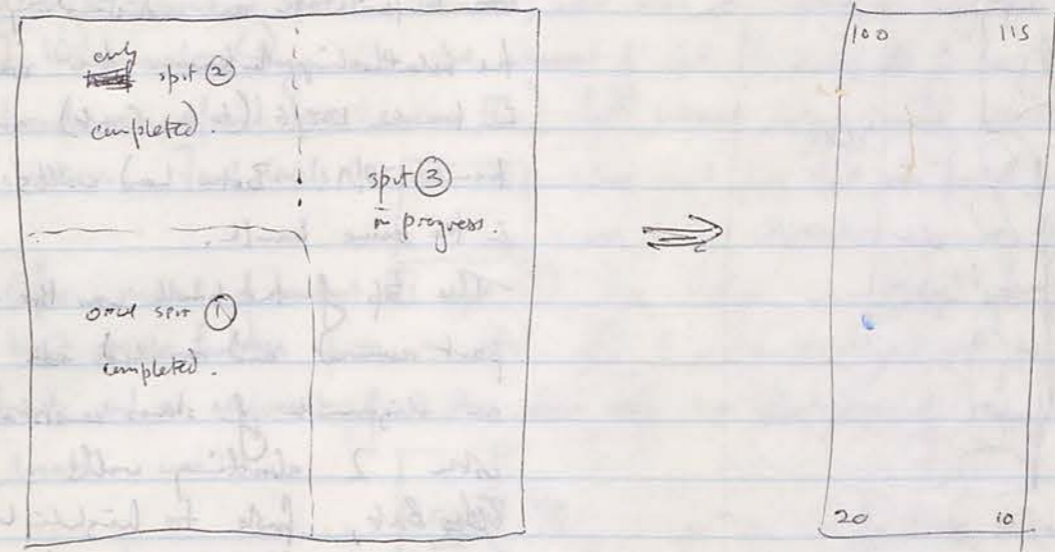

Embanked upon cent [1] spit (4) in E half only.

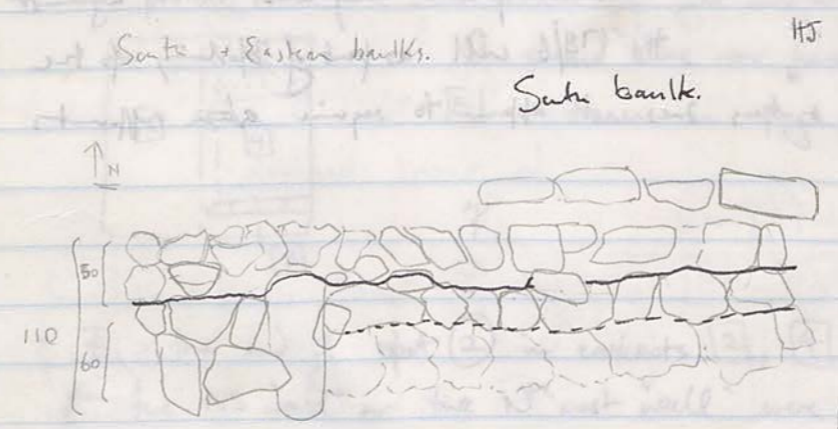

HS Is this 178/9? Must be.
So what the story:
2 possible walls. One on S^t side, 1 on N^t side.
Looks like are built against the other (black line defines the possible divide)

Order of walls not easy to determine but because the South wall is lower it is possible that it was built first — based only on the ease of building a wall against another with the weight down hill.

Dotted black line shows a very thick piece of wall — to the NW.

Both walls are primary. *

East bank + SE intersect

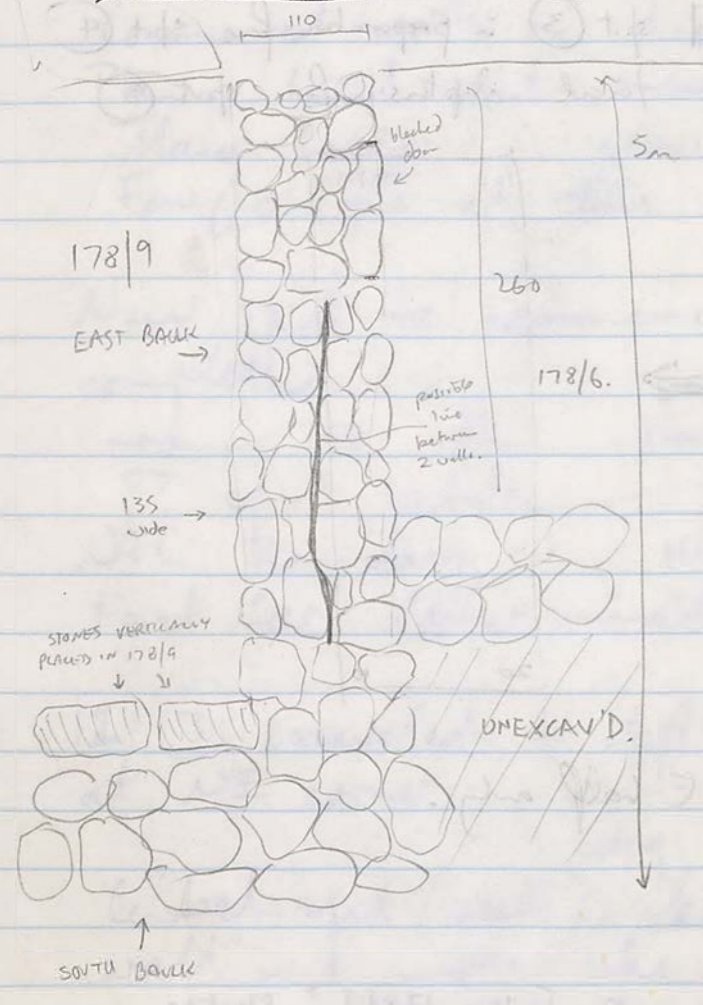

The excavation of the E bank was to facilitate an understanding of the relationship between the wall in trench 178/6 (to the East) and trench 178/9. Both had walls in the same bank.

The top of the bank was the only part removed and revealed an alignment of stones consistent with 2 abutting walls. Edo But, fresh to highlight the blacked up door in the side of 178/6.

A possible interpretation of this might be that the 178/9 wall which is secondary a building was built against the 178/6 wall as part of blacking up the door. 178/6 wall appears strong + this does not appear to require extra support.

178/9 TRENCH REPORT

ISSA: TRENCH

- Excavation began in this trench with the removal of up to ⁶⁵ 40 cm of spoil from previous seasons. Greatest spoil depth was in the centre of the trench. No pottery kept from this removal process although interesting finds (coins, etc) were kept and marked as from the spoil heap.

- Further excavation began with the removal of spit ① across all of the trench area (full trench area referred to as context ①). Soil removal only leaving all stones for consideration of structures. Final levels (cm)

60	25
6	8

 Note that this spit was particularly shallow as it was partly encroached upon by the spoil removal.

- After removal of context ① spit ① the trench was divided into 3 new contexts according to 2 possible features which were noted. ① A possible NS aligned wall thru the centre of the trench and an alignment of 4 stones EW along the SE corner of the trench. New context location was:



Soil in all of these contexts was a light brown/tan colour and of a fine silt consistency.

- During the removal of a single spit (spit ②) in all of these areas a second possible EW wall was noted towards the Nth end. The result of finding this possible wall was the creation of yet another context (context ⑤).



A dressed stone was found (possibly from a roof) in context ⑤ - drawn on page 11.

- By the end of spit ② in contexts ②, ④ + ⑤ it was noted that neither the NS wall or the Nth west wall were actually walls, thus, all of these contexts were subsumed within context ② as these constructions were removed.

- However, only part way into spit ③ another possible EW alignment of stones was noted across the Nth end of the trench in the same location as that "wall" dividing contexts ④ + ⑤. Thus far spit ③ only context ⑥ was created in the Nth section of the trench.

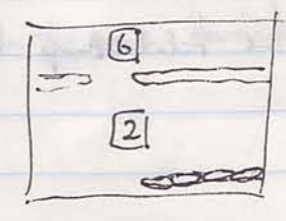

A hard, compacted material was found along the E side of the trench in areas (see location on page 14). This material marked the end of spit (3) and was pursued towards the W side on varying levels. All of spit (3) in contexts [2] + [6] rested on this compacted surface. It may be a floor and is tentatively interpreted as such although it is very uneven. Levels (cm) - below surface only.

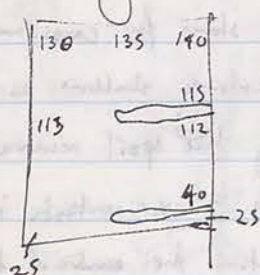

Although the levels do not demonstrate this clearly the approx. floor slope was:



Soils continue to be light brown/tan colour although some red/brown was noted against the Nth wall.

- Context [7] was created when the West half (only) of the trench was further excavated. This was spit (4) and revealed a small pot sized tannure which measured 23 cm in diameter. (see page 28 for dimensions and page 38 for sketch).
- A second floor level of crushed limestone slurry was found just below the tannure level at the following depths.

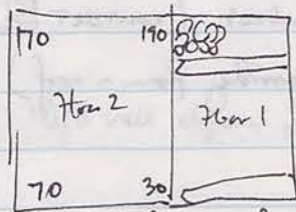

↑ below floor in E half (floor 1).

Also a group of stones was found in the centre of the Nth half of the trench. These were excavated to reveal bedrock.

- The removal of contexts [8] + [9] at spit (5) level revealed a third floor level. at 170 cm below surface in Cont [8] and 125 cm below surface in cont [9].

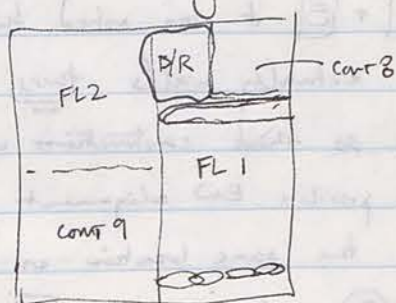

At this stage enough of the EW wall in the Nth end of the trench was revealed to determine that it was not a wall and it was removed.

- A small section of Floor 1 was removed to establish the relationship between all three floors.

Incidental to all this was the revealing of a NS aligned wall in the E bank and an EW aligned wall in the Sth bank.

Summary Summary: (also includes Sth bank)

Three phases of floor + wall visible in this trench:

Phase (1): Construction of an EW aligned wall (now in Sth bank) and a compacted and floor over all of trench area. Very smooth floor with a few small pebbles. Very hard and laid onto either bedrock or a loose mix of small rubble + brown soil (fine).



No distinguishable features found although only 1/4 of floor area revealed + excavated.

Phase (2): Construction of a NS aligned wall (now in E bank) and the laying of a second floor of limestone slurry over the top a mix of loose soil, sparse rubble and lots of pottery.

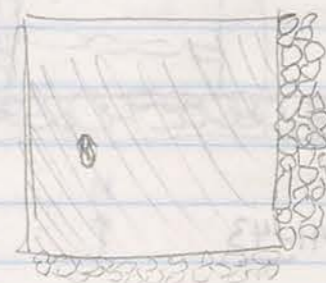

This floor had a tannure located on it. NB a small tannure only.

Phase (3): Laying of a third hard compacted floor - predominantly and a small amount of limestone and very rough and badly damaged by wall collapse. Into this floor were set 4 upright stones redeposited from elsewhere on the site as one contains architectural detail while the other three appear to have derived from door stones.



Context location:

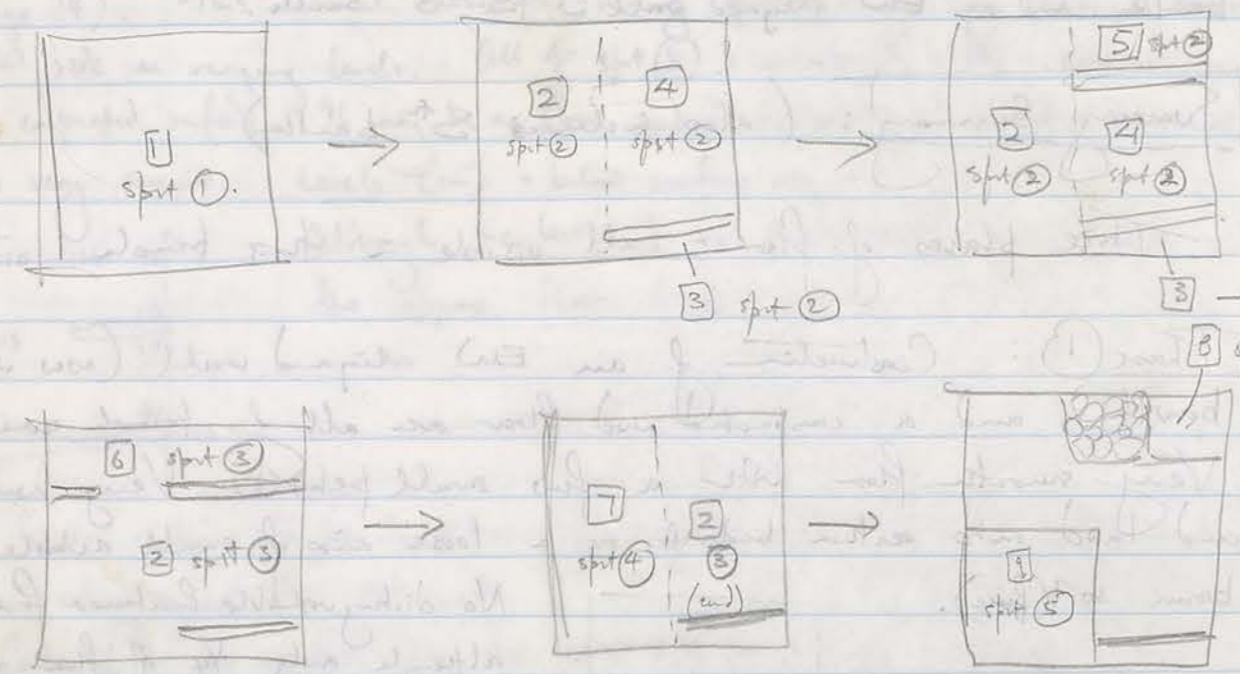

FINAL

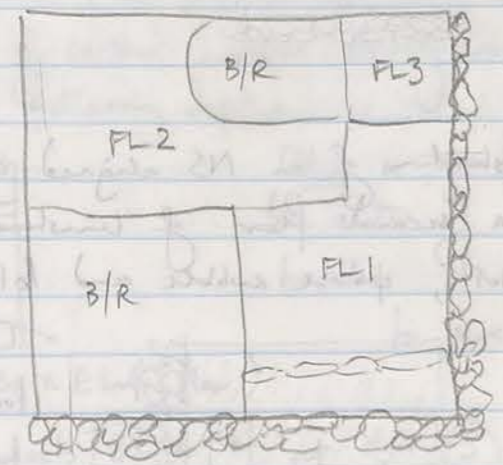

SEE DRAWINGS PAGES: 41-43

END

TRENCH SUMMARY

Final drawing:

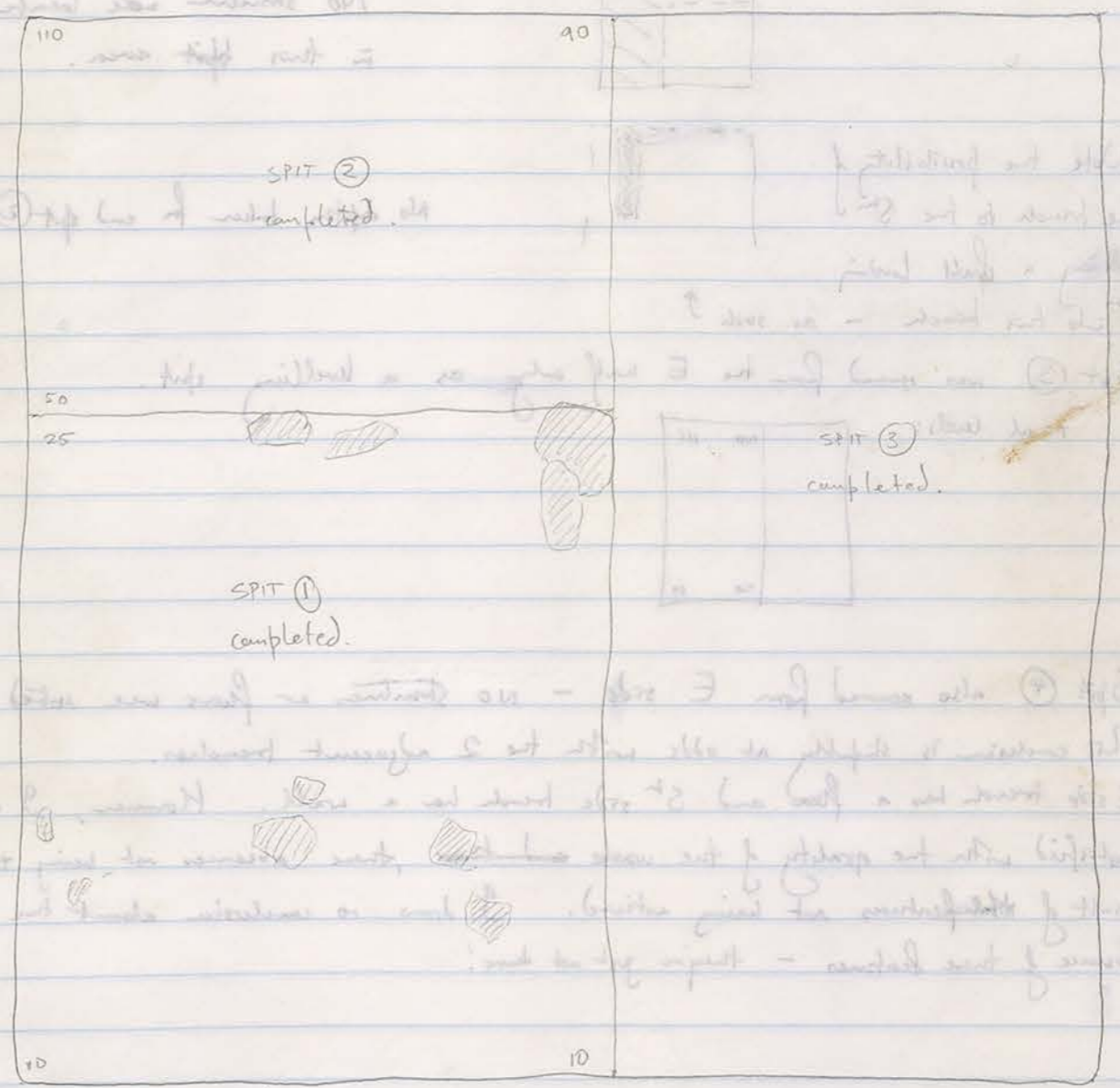

- Excavator began with the removal of up to 25 cm of spit 7 in the Nth end of the trench. Immediately followed by the removal of soil only for context 11 spit 1. All of trench labelled as context 11.
- The trench was characterised by low level rubble in the SW corner and larger, more dense rubble in the NE.
- No structures were apparent in this rubble.

Context 11
spit 1
final
depths

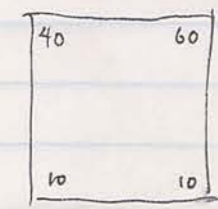

15/2

- Pending time constraints resulted in split ② being removed only from the N and W sides.

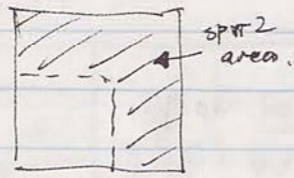

No structures were located in this split area.

- Note the possibility of the trench to the Sth having a wall leading Nth into this trench - as such ↑

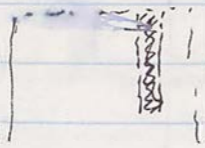

No depths taken for end split ②.

- Split ③ was removed from the E half only as a levelling spot.

Final levels:

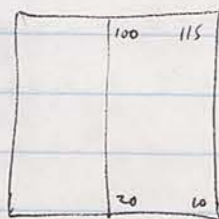

- Split ④ also removed from E side - NO structures or floors were noted.

This conclusion is slightly at odds with the 2 adjacent trenches.

E side trench has a floor and Sth side trench has a wall. However, I am satisfied with the quality of the work and these absences not being the result of ~~disturbances~~ not being noticed. I draw no conclusion about the absence of these features - they're just not there!

