



A4
NOTE BOOK

206/2
206/3
206/3 A (PJC)

No. 595

Anette Welkamp, Jebel Kolid
September - October 1991



weather
date
time.

photographs
in situ
waters.

soil quality + colour
process - direction - of digging

qty + nature of pottery find
draws of pottery

sentences.

time of find

depth of soil layers.

direction - of clearance

label - area, trench no, date, feature no, bag no.

10/9/91

10 meters

my new trench = 206/2

Peter's new trench = 207/5

Notes general: yesterday's pottery bags incorrectly dated

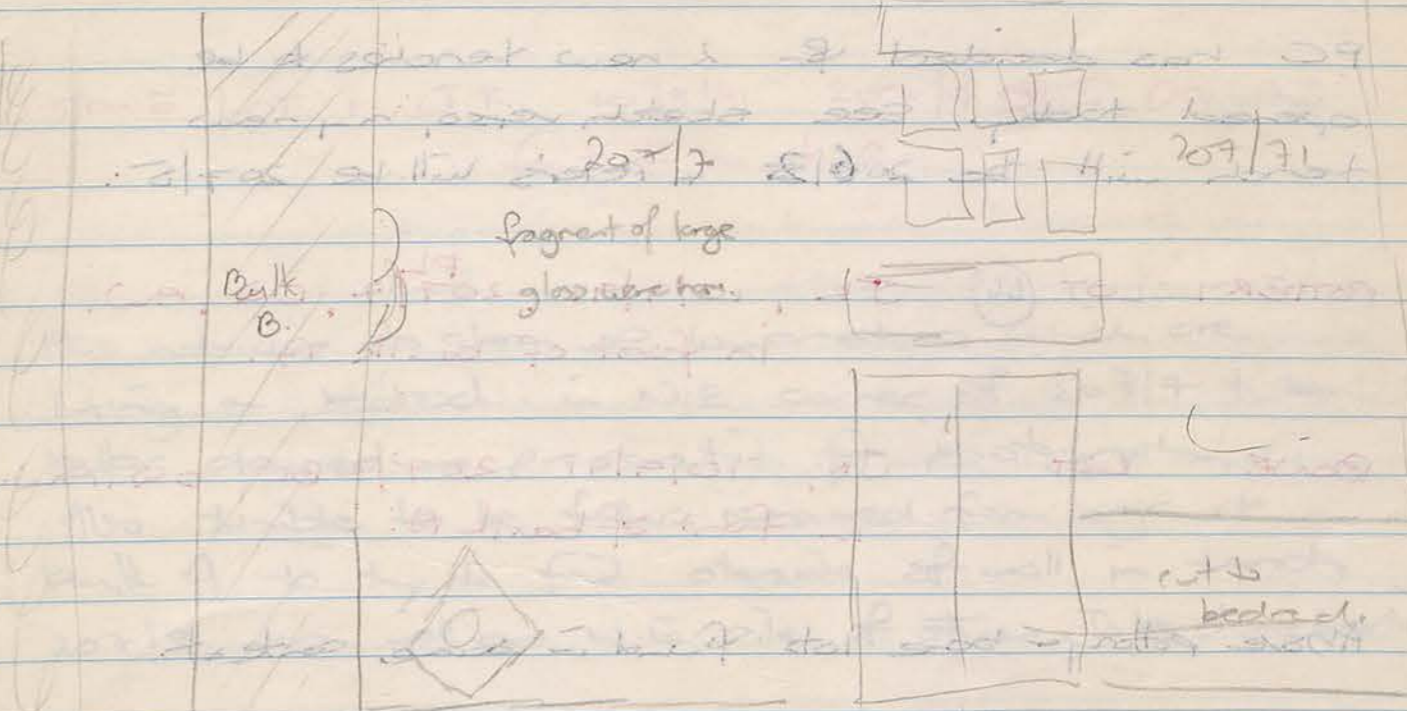
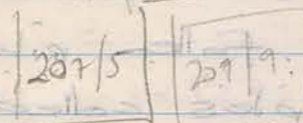
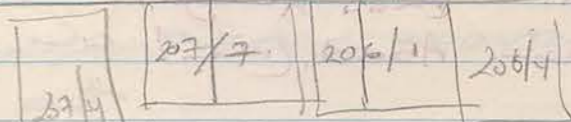

drawing copied
from PC's dug of
yesterday's status.

10/9/91

Workers

- Hamada Nassr. (old man)
- Fatima. (single girl)
- Nawira () husband
- A. Faisal () wife
- Isah. (man - younger)
- Hussain Abad. (man)

I think they are the same as yesterday!

Trench 207/7

Continuing to first remove soil in between what appears to be fallen pile of stones in north bulk ^{west side} stone pile is collected to left & right with larger quantity of soil b/w ^{the} 2 piles. Left side west pile removed first. Some pottery found in soil between the 2 piles of stone.

PC has decided for 2 new trenches to be opened today. See sketch verso, my new trench will be 206/2 + Peter's will be 207/5.

POTTERY LOT (44) JK, 10/9/91, 207/7, ^{PL} DQ, AW, in front of bulk A.

BONE LOT JK, 10/9/91, 207/7, BL, DQ, AW, in front of bulk A.

Above pottery + bone lots found in same context.

stones remaining in west bulk on a soil layer which continues round to north bulk + raised slightly higher under east pile of stones. Pottery ~~per~~ more prominent in this lower soil layer incl. large fragment complete with handle.

10/9/91

Uncertain if meant to remove stones in east pile as well P.C. to decide. To south of this east pile ~~are~~ still a few stones which ~~are~~ lie on the floor level.

Have removed soil in front of rock to floor level. Good clean fire soil. No burning apparent in soil where pottery coming out.

stones removed from surface in preparation for 207/5.

BONE LOT 2 J.K. 10/9/91, 207/7, BL II, DQ, AW in front of bulk A.

Swept out trench 206/1 west. to keep water away.

STONE LOT 1, J.K. 10/9/91, 207/7, BL I, DQ, AW, in front of bulk A.

PC. advises to clean up lower stones which are lying on bedrock in N.E. corner of 207/7 to be better cleaned in preparation for photography. Also rubble to be filter removed from against bulk A to try to find outside of wall in trench 207/8, as well as N.E. pile of stones. To be done over time.

to encourage better cleaning of finished areas. brushes on order.

4

10/9/91

~~206/2~~ Trench 206/2

Top layer of soil 1-3 inches removed as well as any loose stones, anything wedged in left

No apparent suggestion yet of anything at all, boulders seem scattered all over randomly.

A few potsherds only.

POTTERY LOT JK 10/9/91 PL 2 206/2
Feature 1 PA, AW.

FEATURE 1 = top soil all over between boulders + rocks in trench 206/2

Aziza

2 minutes to 1, head a upper torso of a figurine appears just below the surface. Find spot measurements to be taken next morning, will be only approximate as don't know precise location, square foot possibility. P.C. has figurine.

5

11/9/91

In Attendance: ...

Begin around 6:00 am. still day, barely a breeze.

- Hamada Nasr
- Fatma
- Naima
- Aziza (in place of Afiwal)
- Isah
- Hussein Abad.

TRENCH 206/2

Arrived to find all 8 sheets + string missing. Need to call Barry down again.

Proceeding to work down through soil across entire surface, leaving rocks in place. Working through F1

POTTERY LOT JK 10/9/91 PL 3 206/2
Feature 1 DQ A.W.

Sent a workman off to find Barry + ask him to come down some time today. No string here either, do it myself.

FEATURE 2 = possible corner of 2 walls in SE corner + N/S wall.

12/9/91

In ATTENDANCE

Hamada Nasr

Fatim

Naima

Aziza

Isah

Hussein Abad.

Windy day, making the cleaning up difficult, sand flying about everywhere.

Again arrived to find the stakes had been pulled up over night. One of which ended up in the trench.

POTTERY LOT 4 JK 12/9/91 DQ TRENCH 206/2. F1 (from north + west of F2)

POTTERY LOT 5 JK 12/9/91 DQ TRENCH 206/2 F2 (possible corner of 2 walls SE corner)

Directing clearing of soil to continue to north + west of feature 2, + collecting bags of pottery from the 2 areas separately. More soil needs to be exposed for the photos yet, working in + to south east of feature 2. Small amounts of pottery coming out all over.

Bushes we have are hopeless for cleaning, need brooms.

Need 2 more towels, 2 more hand shovels. + at least 6 more brushes.

PHOTOGRAPHS

IC 28-30.

PC

14/9/91

17/9/8 room behind wall

17/9/7 = pit in w. Hadi's work working. → out

17/8 = room to east of bank

Peter = 207/5

In ATTENDANCE AT 206/2

Hamada Nasr

Fatim

Naima

Aziza

Isah

Hussein Abad.

still windless morning, going to get hat. Peter ill, Rodi in thara, working their 2 trenches as well with Jeff Edwards's assistance.

206/2

Removing a section of the top tangle layer. + then following down by removing soil. Maybe



There will be more rocks, or more soil below.

POTTERY LOT 6 JK 14/9/91 DQ Trench 206/2 F1 (from east + west bank)

BONE LOT 3 JK 14/9/91 DQ Trench 206/2 F1 (from same source as PL6)

14/9/91
207/1 Trench.

Peter had removed the top layer of rubble in west quarter of trench. + we are continuing to go down through soil beneath it. Reasonably devoid of more rocks at this stage.

POTTERY LOT 7 JK 14/9/91 DQ Trench 207/1
AN/JE (from soil in west quarter)

BONE LOT 4 JK 14/9/91 OQ Trench 207/1
AN/JE (related to PL7)

Two objects found in soil.

1. small (3/4" x 1/3" diam) tube of terracotta
2. unidentified worked piece of stone

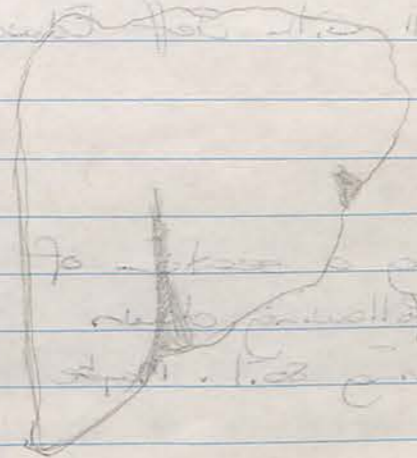

Trench 206/2

one of the workmen removed the third stone in the row in the SE corner - holes.

Finding more rocks under the section we cleared, unlike 207/1 where the soil layer is more distinct

stionna northeast

14/9/91

179/7
~~178/1~~

Digging through bank in n.e. corner down about 2 feet through some loose strata + orangey soil. Soil below changes to greyish, with fewer stones below. These people work particularly slowly.

206/2 Trench

Because the rocks below show no clear definition of direction or shape yet, decided to remove the top layer of rocks in NW quarter as well.

1 small black basalt - possibly unworked out of edge of west wall cante.

~~206/1~~ = 207/1

located small piece of glass (shell?) 150x150 South/East corner of trench floor level.



Continued to floor level + cleared small vacant area N of stone floor bowl.

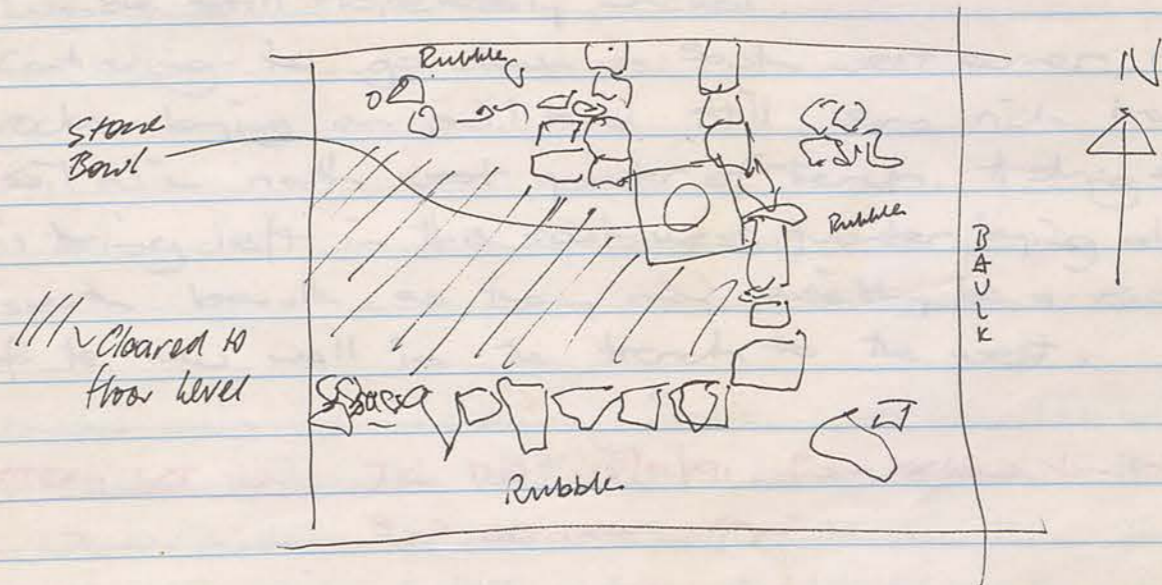

Pc won't take a photo till Peter looks at trench.

Heather Annette

4/19/91

206/2 Trench

Continuing to dig down through NW quarter of trench where rock fall random + meaningless. Closer to the center of the trench the rocks give way to rich reddish brown soil, rich smell. Dug through here to 80cm depth, at the deepest point. Looking south from this to the remaining boulders in the south west corner this area of boulders also seem to be lying on the same bed of soil. Decided to remove these rocks as they also suggest no definite pattern. Very little work done today on the eastern half. Want to see what this possible wall looks like from the soil level ~~west~~ in west.

Only 1 bag pottery + small bag bones + 1 brass 4 plbs.



15/9/91

Anette's trench 206/2
 Peter's trench 207/8b
 New trench north of 207/5 = 178/4

Trench 206/2

In attendance: Hamada Nasr, Fatima's mother, Naima, Aziz, Bah, Hussein Assad.

Peter still ill. Jeff also ill so looking after 2 old trenches + new one today.

Slight wind, cooler morning.
 Barry starts morning by drawing up a new trench to the north directing of 207/8. It is hoped that the north-south running wall in 207/8 will be more clearly defined by his new trench, as will the possible feature abutting the north bank.

Trench 206/2

Tumble still hopelessly unclear.
 Continuing to go down in south west corner, removing rocks lying on soil level. Still some rich brown/red soil as in north west quarter of trench. A string of boulders is being left in this south west quarter lying along south bank, as they may possibly be a continuation of the low wall in the trench to the west.

POTTERY LOT 10 JK DQ 15/9/91 from below rubble in SW corner AND is in low than grade

BONE LOT 7 Bones related to pottery lot 10.

15/9/91

Soil below big boulders in south west quarter containing a mixture of small + large boulders.

Trench 207/6

Clearing out of small soil channel directly north of bowl. Loose small stones, some pottery + bones coming out. Attempting to more clearly define sides of walls + baulks, clearing out soil b/w rocks. Soil continues through as rich brown. Bones + pottery coming from clearing. Still difficult to appreciate exact shape + position of stone pile in north west corner, have cleared out a few boulders on south of this pile which were resting on the soil. Uncertain as to how far to go back north here, but will clear those in the single layer resting on a bed of soil higher than the apparent floor level of south half of trench.

TRENCH 206/2

OBJECT LOT 1. JK DQ. TRENCH 206/2

From WEST WALL 70cm

From NORTH 80cm

deep. 79cm.

Small round (metal?) object, flat base

Small round object with flat base found in soil b/w rocks in north west corner. -> in small box

Changed directions now. Moving north in the north west corner. It was presumed that the pile of boulders along north wall in NW quarter not a wall as there was too much soil b/w the rocks. Still the rich reddish brown snelly soil. By the time we've cleared this, most of the western 1/3 to 1/2 of trench will be cleared down to soil

15/9/91

with a few boulders scattered on the ground. Presume we have not yet hit floor level, but considering the baulks in the trenches to west + east, we are probably not far off.

TRENCH 207/5b

Have decided to stop clearing + cleaning things out at about 10.00. Primarily to allow Peter to decide how he wants to finalise things. Needs to consider:

- lack of clarity in southern baulk lines,
- the south side of south wall
- floor level possibly not reached, still too uneven
- a number of boulders to NE of basin probably not a wall, but filler for one, too much soil below. This will clarify space currently to north of basin + width of wall along eastern baulk.

The area in NE corner cleared to baulk, stones in corner had to be more soil under them than possible feature abutting north wall. Of this possible feature the stones jutting out in its south east corner probably not a part of it.

DRAWING 1. 15/9/91 DQ JK. TRENCH 207/5 AV

NEW TRENCH (north of 207/5)

4 fragments found of a little figurine in the soil, head + neck, about in top inch of soil, in a square about foot x foot
245 SE pt 496 SW pt.

OBJECT LOT 2 JK DQ 15/9/91 4 pieces of the figurine top soil. 245cm from SE pt. 496cm SW pt.

15/9/91

TRENCH 206/2

OBJECT LOT 3 JK DQ TRENCH 206/2 15/9/91

FRAGMENT OF SHELL [MOTHER OF PEARL?]

From west bank 50cm from north bank 182cm depth. 93cm

at least its something colourful.

SAMPLE LOT 1 JK DQ TRENCH 206/2 15/9/91

Charcoal.

from west bank 153cm from south bank. 137cm

depth. 103cm

found in soil - small piece burnt pottery

found nearby - put in bag w. charcoal

OBJECT LOT 4 JK DQ TRENCH 206/2 15/9/91

Fragment of metal found in soil to south of sample lot 1.

~~TRENCH 206/2~~

16/9/91

TRENCH 206/2.

In Attendance: Tamada Naso, Fatima's mum, Naima, Isah, Hussein, Ahmad Aziza.

Windy cool morning. Peter back.

Beginning the morning's work by digging down south east. to the line suggested by the north south running wall (3 bricks on top layer in alignment). Similarly, not going further south than possible wall running east west along south bank. Area removed continues as further west with a large tangle of rocks surrounded by lots of rich reddish brown soil. will continue to go down as far as level already dug at in west of trench.

Have left western third of trench with boulders on ground level. The floor level may be underneath them in comparison with neighbouring east + west trenches floor levels.

POTTERY LOT 12 16/9/91 JK DQ TRENCH 206/2 Feature 1
Continuing on from pottery lot 10

BONE LOT 9 16/9/91 JK DQ
Trench 206/2 Feature 1
coming from same area as P112 + B17

SAMPLE LOT 2 16/9/91 JK DQ
Trench 206/2 Feature 1
Charcoal. coming from exactly
The same spot as yesterday's charcoal

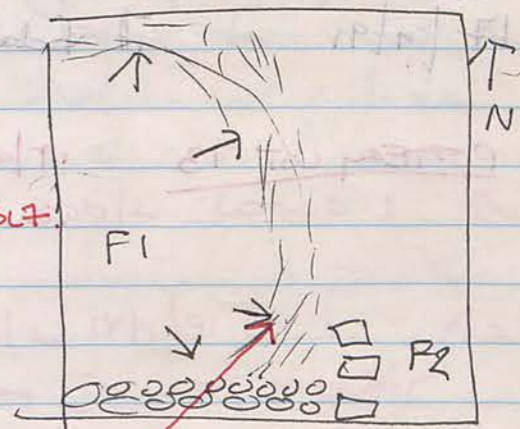

16/9/91

184 - 164.

OBJECT LOT 5 16/9/91 JK DQ Trench 206/2

Feature 1. coin? from some area on charcoal
184cm from south bank, 184cm from west bank

OBJECT LOT 6 16/9/91 JK DQ Trench 206/2

Feature 1. bead, dome shaped, outer facing
falling off. found near obj. lot 4.

Digging has proceeded to floor level in SE corner
abutting north/south wall, proceeding northwards
along wall from there. Rocks lying on floor level.

FEATURE 3A 16/9/91 JK DQ Trench 206/2

feature 3 = floor level.

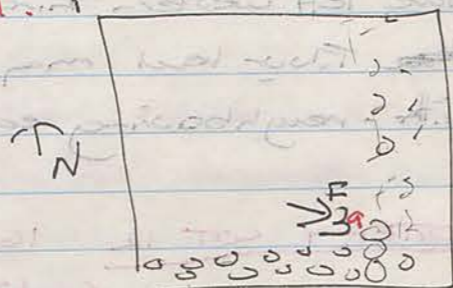

17/9/91

Today, very little work done in my trench.

POTTERY LOT 13

17/9/91 JK DQ Trench 206/2 F 1
very little pottery uncovered.

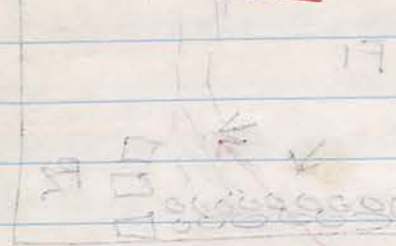

18/9/91

IN ATTENDANCE:

Hassada Nasr, Isah, Aziza, Fatima's mum, Naima
Guwana to replace Hossain-Abad.

Cool morning slight breeze. Workers swapping over again.
Only have 3 of the original ones chosen as well.

PC came to inspect again first thing, or tumble still unclear.
Cleared the last boulders thought to be abutting Feature 1 on
west side, but there still appears to be a definite soil level
under the 3 boulders originally thought to suggest a wall.
Further clearing around it will clarify this.
In meantime, the remaining rubble abutting the so-called F 1
in the north part of the trench will be cleared today to the
level above floor level.

The intention is to clear down to the last
scatter of boulders on the floor today at
least, clear this level & review the wall
situation.

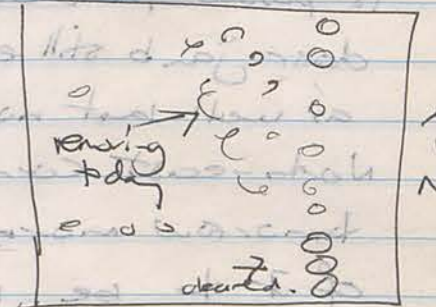

Discussions with PC yesterday regarding terminology
My features = his locs. will use locs from now on
instead of 'feature'

POTTERY LOT 14 18/9/91 JK DQ Trench 206/2 Locs 1. AW

OBJECT LOT 7 JK DQ Trench 206/2 18/9/91 Loc 1 AW

2 iron frags. originally joined together

from east bank 177m: from south bank 210m depth = 60cm approx

OBJECT LOT 8 JK DQ Trench 206/2 18/9/91 Loc 1 AW

1 bronze frag.
location as with object 1077

18/9/91

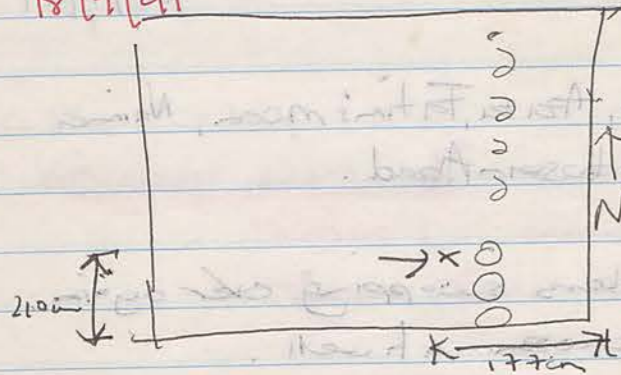

OBJECT LOT 9 JK DQ 18/9/91 Trench 206/2 Locus 1 AW
 small piece black glass
 20cm in from ~~south~~ bank; 177cm from east wall
 25cm deep.

Working eastward through the remaining rubble today. It seems that we are almost up to the north-south running wall. Its definition is still unclear. There is possibly a doorway partly remaining. Vertical door jamb still exists, possibly ~~at~~ threshold as well but northern jamb possibly absent. North-east corner of wall to be worked tomorrow morning, with a section of soil ^{vertically} in front of it to be removed. Tumble has consisted primarily of large to medium boulders, interspersed by the same reddish brown rich fine soil. Also to sort at still is the possibility east-west wall abutting the southern bank. Its pleasing to see something happen in this trench after so long.

OWNE LOT 10 JK DQ 18/9/91 Trench 206/2 Locus 1 AW

SAMPLE LOT 3 JK DQ 18/9/91 Trench 206/2 Locus 1 AW
 Charcoal.

19/9/91

In Attendance

Hamada Nasr, Fatima's mum, Naima, Isah, ~~Husse~~ Hussien
 A woman instead of Hussein - Ahmad.

Have cleared up to what appears to be the wall running from north to south at its west side. Quite clear on northern end, in middle of wall is probably the fallen doorway. Soil layer under threshold may be difficult to clear further without causing the doorway to collapse. Cleaning undertaken on wall (?) running east-west in front of bank. Still not convinced where it appears to abut the other wall, a rounded group of stones suggests a separate structure. Prettier to clear ^{last} off to see further here. Floor to be cleaned to expose rubble on floor.

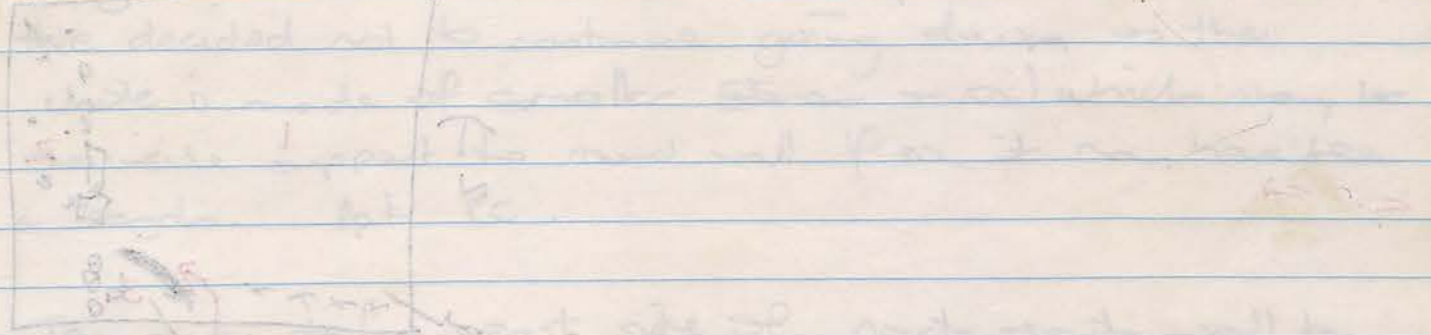

Small glass fragment about 10cm long and 5cm wide. Also a small piece of charcoal.

21/9/91

In attendance: Fatim, Naima, Isah, Fatim's mum, A. Zahara

still windless beginning to the day, have now lost the 2 old men, who were the only 2 competent diggers.

Arrived to find that Peter had begun to remove parts of the so-called 'wall' along the south bank. Western half of these stones removed but abutting the north-south masonry wall has appeared a rounded structure, what remains visible is lower than the north-south wall. Will be more clear about its precise shape when all stones cleared from the so-called 'wall' area. A number of small + quite large boulders coming out of the 'wall' area.

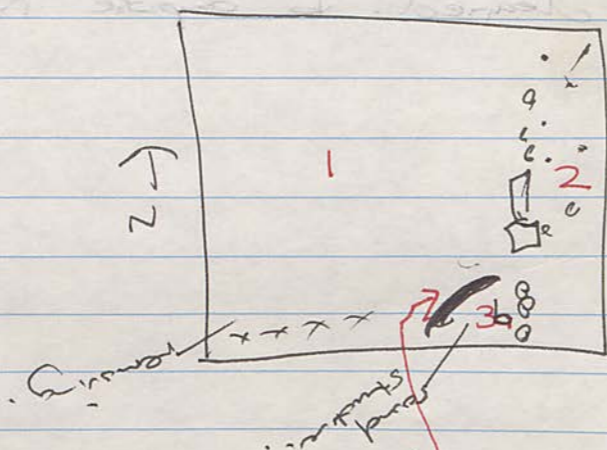

POTTERY LOT 16 JK DQ 21/9/91 Locus 1, Trench 206/2 PL 16

LOCUS 3b JK DQ 21/9/91 Locus 3b, Trench 206/2 rounded stone structure abutting Locus 2

OBJECT LOT 10 JK DQ 21/9/91 Locus 1 Trench 206/2 Obj 10 rim piece black glass for soil in front of L3. approx 40 cm from south wall + 140 cm from west wall

21/9/91

OBJECT LOT 11 JK DQ 21/9/91 Locus 2 Trench 206/2 Obj 11 small round bead, white, with central hole found dusting down of Locus 1 top surface

POTTERY LOT 17 JK DQ 21/9/91 Locus 3b Trench 206/2 PL 17 from inside ^{top} Locus 3b

STONE LOT 11 JK DQ 21/9/91 Locus 1 Trench 206/2 BL 11

SAMPLE LOT 5 JK DQ 21/9/91 Locus 1 Trench 206/2 Sample 5 charcoal, found same spot as object lot 10

Digging gently into what may be the inside of Locus 3b. A number of flat smaller stone frags in top levels. Uncertain if there is an inside. have decided not to continue going down as the whole is made of smaller stones + soil which may be the inside support to round wall. If so it may have been a bench. Ask PC.

Trying to define east side of north-south wall by clearing top stones from far north corner. This side of the wall seems clearly defined by the 3 northernmost stones on the east side. The small section of open area, I will call Locus 4.

LOCUS 4 JK DQ 21/9/91 Trench 206/2 Locus 4 area b/w east bank + west north south wall



21/9/91

POTTERY LOT 18 JK DQ 21/9/91 Locus 4 Trench 206/2 AW

pottery from Locus 4

22/9/91

no ATTENDANCE: Hamada Nasr, Aziza, Naima, Fatima Mun
(woman to replace Hussein-Abad), (woman to
replace Asah)

OBJECT LOT 15 JK DQ 22/9/91 Trench 206/2 Locus 1

clay figurine fragment
60 cm from south wall 80 cm from west wall
100 cm from deep

POTTERY LOT 19 JK DQ 22/9/91 Trench 206/2 Locus 1

southwest corner above floor level

POTTERY LOT 20 JK DQ 22/9/91 Trench 206/2 Locus 1

north sector above floor level

POTTERY LOT 21 JK DQ 22/9/91 Trench 206/2 Locus 4

north east corner besides baulk wall

Locus 5 JK DQ 22/9/91 Trench 206/2

round basin / depression in floor level SW corner

Coolish morning, slight breeze. Working in three sections
of trench now to try to clean up & make up for slow day
yesterday. Area 1 = locus 4, removing stones + soil, difficult to
work in because of narrowness of space + some large stones.

Area 2 = SW corner + Area 3 = north sector, both clearing
last 5 inches of soil above floor level. Still some fine
reddy brown rich soil found in rest of lower trench.
Will clear soil + leave stones at this stage.

A small round depression in southeast
corner, from floor level down, of ~~stone~~
earth ~~to~~ floor. Figurine found in top
of the soil in bowl.

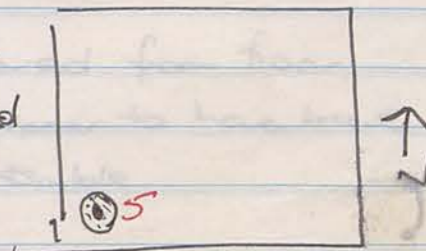

22/9/91

BONE LOT 12 JK DQ Trench 206/2 Locus 1 22/9/91
for last 5 inches of soil above floor level

Proceeded further down in Locus 4. A few large boulders cannot be moved without endangering the bank so have left them. Possible floor layer about 45cm down, which is about 10cm higher than what may be the same floor east of the bank already excavated. Will clear it up more tomorrow + then dig down

More pottery generally coming out of the last 5" of soil above the floor level - to be expected.

Accident occurred when one of the girls stood on a boulder in the south bank forcing it out of the wall + straight into the stone bowl on the floor. Some damage - cracks + chips.

The stone bowl has its lip level with the floor surface + is set quite solidly into the soil. Possibly plastered as well.

23/9/91

In attendance:

POTTERY LOT 22 JK DQ 23/9/91 Trench 206/2 Locus 4 AW
for small locus b/w east bank + N/S wall

POTTERY LOT 23 JK DQ 23/9/91 Trench 206/2 Locus 1 AW
for last 5" of soil primarily in NW corner of trench

In Locus 4 decided to remove a few of the big stones to make the extent of the possible floor clearer as it seemed less well defined north of the 2 stores. Unfortunately pulling them out has damaged the east bank a little + we have gone about 3 or 4 inches further out than we should have.

BONE LOT 13 JK DQ 23/9/91 Trench 206/2 Locus 1 AW
for same area as PL 23

Hoping to clear the last of the soil sitting on the floor in the NW corner. Still leaving larger stones on floor level.

POTTERY LOT 24 JK DQ 23/9/91 Trench 206/2 AW
for tidying up of north bank.

BONE LOT 14 JK DQ 23/9/91 Trench 206/2 AW
for same as PL 24

The final lot of fallen stones to be removed from floor west of Locus 2. = wall. They appear to have been randomly thrown with the rest of the rubble.

23/9/91

OBJECT LOT 13 JK DQ Trench 206/2 AW

near Locus 5, just below its outer surface
90 cm from south bank 110 cm from west bank
110 cm deep.

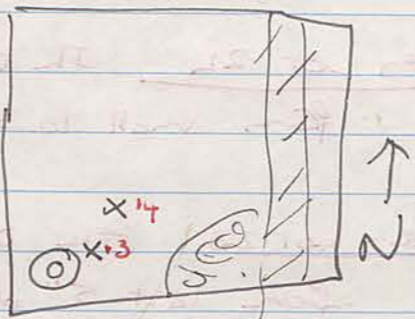
OBJECT LOT 14 JK DQ Trench 206/2 AW

small shell frag? maybe nothing
110 cm from south bank ~~200 cm~~ from ~~west~~ bank
115 cm deep.

Now clearing last remains of soil from above floor

OBJECT LOT 15 JK DQ Trench 206/2 AW Locus 1

shell frag. (bigger)
270 cm from south bank 20 cm from north bank
~~170~~¹²⁰ cm deep.

PC wants to take a photo of trench mid-morning so
will need to clear west bank, south bank, top of Locus 2
in south east corner, i.e. Locus 4, to floor.

24/9/91

Trench 206/2

In attendance: Hamada Nasr, Aziza, Fatim, Aïsa, Aziza's mum
(woman to replace Hussein Ahmad)

Cleaning up as suggested in final para. on previous page.

Once the photo has been taken will take bank out in
south, till as far as the wall which is evident from the
next trench south. Probably we will remove only about
2/3rds of it before we reach wall. It is hoped that
this will clarify the road structure in the south east corner.

Radu has suggested that maybe the stone hole in the south
west corner may be to support a large vase for water etc.
It is probably too close to the wall to be a post hole. Maybe it's
a grinding bowl.

Next trench I will be more concerned to clean the walls & banks as
wego, the mess of pottery that now comes out from final
cleaning is probably useless because it's coming from all different levels
& locations.

BONE LOT 15 JK DQ 24/9/91 Trench 206/2 Locus 4 BL 15.

from small locus s/w east bank & n/s wall

POTTERY LOT 26 JK DQ 24/9/91 Trench 206/2 Locus 4 PL 26.

from same context as BL 15

POTTERY LOT 25 JK DQ 24/9/91 Trench 206/2 Locus 1 PL 25

from cleaning of walls Locus 1

PHOTOS GC 3

from north, detail for west

*

24/9/91
207/6.

Some people working as yesterday

Trench 207/6
178/4

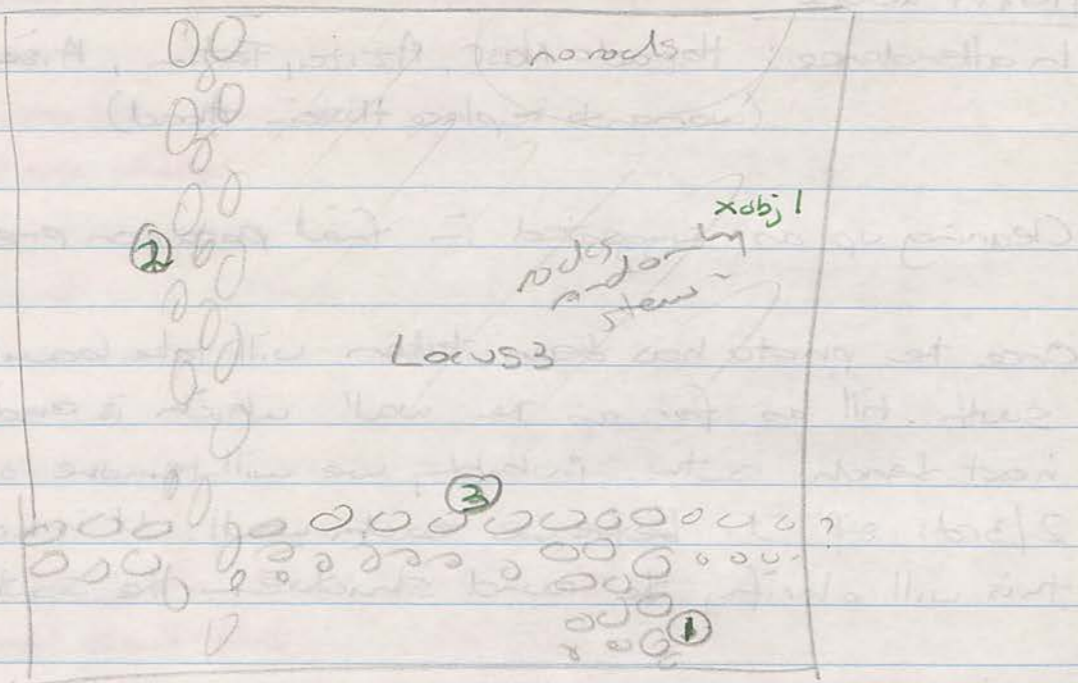

Peter ill today so I'm looking after his trench. Yesterday did so as well but that's in his book but I forgot it today. Will not enter his pottery sequence as part of mine but will continue in his series, yesterday's pottery was Locus 3 Bag 3. I have numbered the walls ② = north/south wall on east of baulk, ③ the east/west wall crossing ② in north of baulk. (which may or may not extend as far as the west baulk; may just complete a corner where it crosses ①), + ① the small wall extending from ③ in north west corner.

Yesterday the workers cleared around the stones to help in Locus 3 in order to try to make sense of the tumble at this level. ~~Despite~~ A small area against south baulk had no rocks in it (see diagram above) but the rest appeared to have been a random tumble. No ^{obj} features visible at this stage so I have decided to clear the tumble at this level. Too bad if that's not what I'm wants. If when some sense can be made of this locus I will begin going down into some of the other areas

24/9/91

contained by the walls. It is presumed at this stage that Locus 3 is the northern extension of the possible courtyard Peter Magee has already ~~excavated~~ excavated in 207/5. If so we should hit a floor level soon, & it may be as rough & ill-defined as it is to the south. These workers seem to be not particularly adept at finding objects, need to keep an eye on them.

POTTERY LIST JK DQ 24/9/91 Trench 207/6 Locus 3 Bag 4

BONE LOT JK DQ 24/9/91 Trench 207/6 Locus 3 Bag 4
bone lot from same context as pottery lot

The pottery + bones comes essentially from the soil level below & around the rock tumble so will call it Locus 4, on presumption that the tumble is Locus 3.

OBJECT LIST JK DQ 24/9/91 Trench 207/6 Locus 4 Object 1
rim frag of large stone bowl.
55 cm from west baulk, 85 cm from south baulk
55 cm deep.

OBJECT LIST JK DQ 24/9/91 Trench 207/6 Locus 4 Object 2
body frag. black glass.

Upon removal of the stones, the floor is evident in places, but there are also still some stones resting on the floor. They are removing the remaining soil to the floor + leaving the last stones for the moment.

24/9/91
Trench 206/2

POTTERY LOT 27 JK DQ Trench 206/2 24/9/91 Locus 1 AW
for south bank destruction

Removing the north face of the south bank to reach the wall contained in the bank & evident from trench south of 206/2.

BONE LOT 16 JK DQ Trench 206/2 Locus 1 24/9/91 AW
for south bank destruction

OBJECT LOT 16 JK DQ Trench 206/2 Locus 1 24/9/91 AW
for soil in south bank, small bronze pin with 2 nodules
40cm from west bank 40cm in in south bank
90cm deep

Have cleared bank between #3 (rounding) & west bank. I am clearing soil on top of bank further to east to try to distinguish b/w 2 abutting walls & rounding. It appears that the rounding is wedged between the 2 walls & built separately.

is still a little confusing. North end of locus has soil with pottery going down although in south part the floor has already been reached.

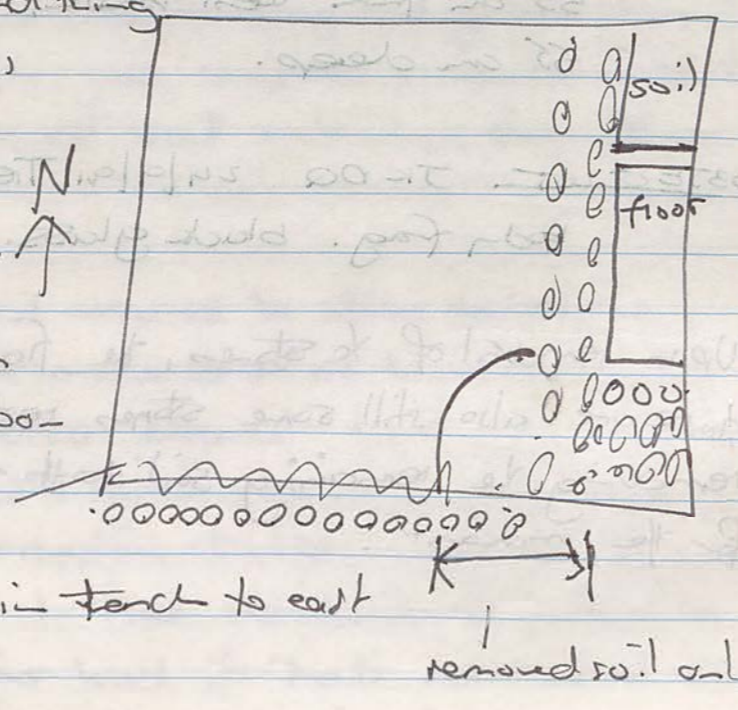

Floor level approximates that in trench to east

25/9/91

In Attendance:

Trench 206/2

OBJECT LOT 17 JK DQ 25/9/91 Trench 206/2 Locus 4 AW
2 metal fags = 1 nail
70cm from north bank, 40cm from east bank
75cm deep

Will finish this morning hopefully. Only really Locus 4 to complete, the northern square foot approx. which has not reached a floor yet. A number of large pottery fragments here as well as the 2 nail fags found this morning. It is the usual fine rich brown soil in this small part.

POTTERY LOT 28 JK DQ 25/9/91 Trench 206/2 Locus 4 AW
in northern sq. foot of soil.

BONE LOT 17 JK DQ 25/9/91 Trench 206/2 Locus 4 AW
as with PL 28.

SAMPLE LOT 6 JK DQ 25/9/91 Trench 206/2 Locus 4 AW
Charcoal in same area as PL 28 + BL 17.

POTTERY LOT 30 JK DQ 25/9/91 Trench 206/2 Locus 4 AW
in northern sq. foot of soil, companion for PL 28.

A lot of pottery coming out of v. small area. Ten will go down as far as they can.

~~POTTERY LOT 29~~ JK DQ 25/9/91

25/9/91

Trench 207/6

Same people working as on 23/9/91

Am still ill.

The last ^{few} stones lying on the floor have also been removed & we have cleared down to the floor.

Tried to clarify what may or may not be a corner b/w walls 2 & 3 or if wall 2 continues to west bank. There is a lot of soil b/w the stones & suggest it might be a corner here, but it is not distinct enough to decide to remove the stones here so I will wait till we have dug behind in the NW corner.

POTTERY LOT JK DQ 25/9/91 Trench 207/6 Locus 3 ^{Bag 5} AW
last of the pottery from the soil above the floor.

BONE LOT JK DQ 25/9/91 Trench 207/6 Locus 3 AW Bag 5
as with ~~bone~~ pottery lot above

LOUS 4 JK DQ 25/9/91 Trench 207/6 AW
area bounded by south bank, ^{east} bank, wall 2 & wall 3.

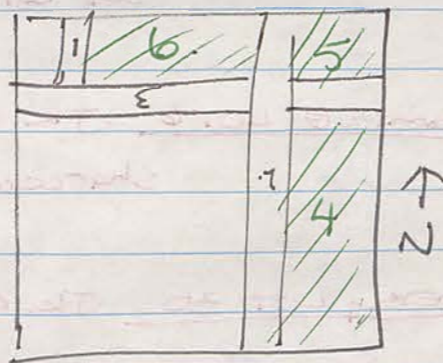

POTTERY LOT JK DQ 25/9/91 Trench 207/6 Locus 4 Bag 1 AW

BONE LOT JK DQ 25/9/91 Trench 207/6 Locus 4 Bag 1 AW

LOUS 5 JK DQ 25/9/91 Trench 207/6 AW
area bounded by east bank, north bank, wall 2 & wall 3

25/9/91

POTTERY LOT JK DQ 25/9/91 Trench 207/6 Locus 5 Bag 1 AW

BONE LOT JK DQ 25/9/91 Trench 207/6 Locus 5 Bag 1 AW

LOUS 6 JK DQ 25/9/91 Trench 207/6 ~~Locus 6~~ AW
area bounded by north bank, wall 2, wall 3 & wall 1

POTTERY LOT JK DQ 25/9/91 Trench 207/6 Locus 6 Bag 1 AW

BONE LOT JK DQ 25/9/91 Trench 207/6 Locus 6 Bag 1 AW

Have opened up Locus 4, Locus 5 & Locus 6, clearing down from under cleared top soil layer. Each are small spaces & it is easier to separate the workers into the 3 areas than have them knocking each other over in 1.

OBJECT LOT JK DQ 25/9/91 Trench 207/6 Locus 6 Object 1 AW
~~small~~ ~~fog~~ ~~black~~ ~~glas~~ small fog black glass

Locus 4 still maintains its original definition going down but there is a substantial amount of rock tumble in soil, difficult to remove in this narrow space, but what can be removed will be.

Locus 6 has ~~less~~ fewer large rocks in it, more soil with smaller rocks.

OBJECT LOT JK DQ 25/9/91 Trench 207/6 Locus 4 Object 1 AW
long thin metal pin bronze.
(worker's say its a kohl stick!)

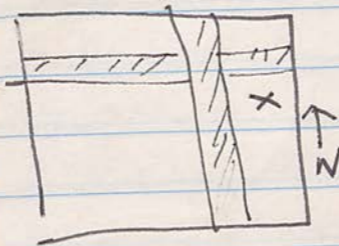

40 cm from east bank, 20 cm from north bank
60 cm deep

25/9/91

TRENCH 206/3

New trench pegged out by Barry yesterday & of course everything had been taken by this morning. He did it again.

Removed loose boulders on surface.

Removing top soil b/w embedded limestone.

POTTERY LOT 29 JK DQ 25/9/91 Trench 206/3 Locus 1 AW

from top soil.

BONE LOT 18 JK DQ 25/9/91 Trench 206/3 Locus 1 AW

from top soil

Locus 1 JK DQ 25/9/91 Trench 206/3 AW

= top soil!

OBJECT LOT 18 JK DQ 25/9/91 Trench 206/3 Locus 1

metal pin.

180 cm from south bulk, 105 cm from west bulk
approx 12 cm deep.

OBJECT LOT 19 JK DQ 25/9/91 Trench 206/3 Locus 1

stopper?



unguentarium base.

OBJECT LOT 20 JK DQ 25/9/91 Trench 206/3 Locus 1

stone handle?

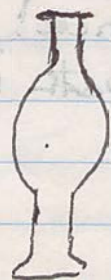

25/9/91

TRENCH 206/2

PC asked to clear top of Locus 3b (round thing) probably handle on top of it now, clearing down to same level as front rows.

POTTERY LOT 31 JK DQ 25/9/91 Trench 206/2 Locus 3b AW
from clearing of top of 3b.

BONE LOT 19 JK DQ 25/9/91 Trench 206/2 Locus 3b AW
from same place as PL 31

OBJECT LOT 21 JK DQ 25/9/91 Trench 206/2 Locus 3b AW
from same place as PL 31 & BL 19.

Square piece terracotta with central hole.

OBJECT LOT 22 JK DQ 25/9/91 Trench 206/2 Locus 3b AW
see OBL 21. shell fragment.

OBJECT LOT 23 JK DQ 25/9/91 Trench 206/2 Locus 4 AW
the figurine fragment. (neck + top?).
(collar + top?).

Need to clean up bowl again for a picture of new wall.

25/9/91
TRENCH 207/6

OBJECT LOT JK DQ Trench 207/6 25/9/91 Locus 6 ^{object 2} AW
black glass fragment.

26/9/91

In attendance: Hamada Nasr, Naima, Fatima's mama, Azzam's mama, Isah, Hussein Abadi's wife.

Trench 206/2

POTTERY LOT 32 JK DQ Trench 206/2 Locus 4
in northern sq. ft of soil, carry on from PL 30.

BONE LOT 20 JK DQ Trench 206/2 Locus 4
Same area as PL 32, carry on from BL 17.

Continuing down in northern square foot of Locus 4. Maybe we have gone through the floor in this area. A lot of pottery + bones have come from here in comparison with other areas. Now about 1 foot below floor surface in rest of Locus 4. PC asked to continue down as far as possible - more a problem of space as the area is very narrow b/w bank & wall - did not continue.

POTTERY LOT 34 JK DQ Trench 206/2 Locus 3b AW
cleaning inside the round wall.

BONE LOT 22 JK DQ Trench 206/2 Locus 3b AW
as with PL 34

OBJECT LOT 24 JK DQ Trench 206/3 Locus 1 AW
maybe just a river pebble, faint soil

~~OBJECT LOT 25 JK DQ Trench 206/6~~

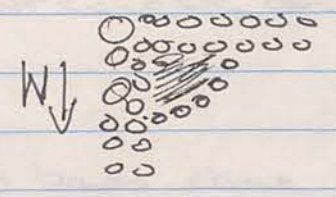

Photos: 7CB to 21, Blw 2-29.
Have completed the round wall. It appears to fit into the 2 walls, built later than they. The outside perimeter appears to be a single row of stones, with the inside primarily soil with a few large rocks. G.A. suggests maybe a garden, if so this may be a courtyard. ! (H.S.)

26/9/91

Trench 206/3

Continuing to remove top soil

33?

POTTERY LOT 32 JK OQ 26/9/91 Trench 206/3 Locus 1 AW.

BONE LOT 21 JK OQ 26/9/91 Trench 206/3 Locus 1 AW.

OBJECT LOT 25 JK OQ 26/9/91 Trench 206/3 Locus 1 AW.

small folded bronze ring

28/9/91

Trench 206/3

Continuing to remove top soil. Will retain rock tumble till photographed.

In Attendance: Hamada Nur, Naina, Fatim, Aisa, Azizis Mom

POTTERY LOT 35 JK OQ Trench 206/3 28/9/91 Locus 1 AW.

BONE LOT 23 JK OQ Trench 206/3 28/9/91 Locus 1 AW

The amount of rock tumble is almost identical to trench 206/2. + covers almost the whole trench. The scatter appears to be almost random. We are currently cleaning the soil out below the rocks + brushing them down for photos. There may be some continuation of the wall running north/south from trench 206/2 as there are a few larger, squarer boulders in this alignment. The wall which is in the trench to the east is less clear at the moment (the one running east-west is to the south of the baulk).

Supervised Radi's workers on his 2 trenches. No numbers known for them so have called them east + west. Only 2 object finds - black glass frag + almost complete cord shell.

Bone lot 23 has no finds in it. No bones come from top soil today

29/9/91

In attendance: Hanada Nasr, Fatima's mum, ^{Naima} ~~Asis~~ ^{Asis} father, Aziza's mum, Asis's mum, ~~Asis's~~ father.

Trench 206/3

Still clearing for early morning photo.

POTTERY LOT 35 Trench 206/3 locus 1 JK DQ AW 29/9/91
from top soil clearing

BONE LOT 24 Trench 206/3 locus 2 JK DQ AW 29/9/91
~~as it is from locus 2~~

PHOTOGRAPHS Film 8C-27-29

PC has taken photos agreeing that there is not much to look at so far.

Maybe in comparison with the trench 206/2 + trench to east there are 2 walls which can be expected to cross in S.E. corner. If the wall continues in from east (east/west line) it appears to ~~be~~ curve a little in the trench as it moves west.

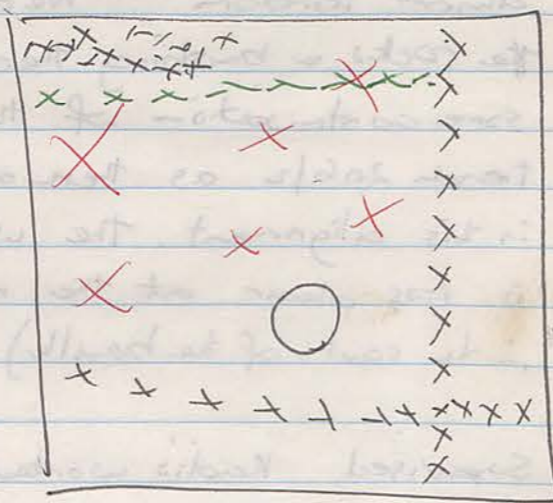

In the center of the trench may be a number of lag stones (3 maybe) which roughly form a circle, so will leave this for the moment.

In the NE corner a rough semi-circle of rocks might be there.

Am removing stones blue semi-circle + circle, + begin with = red crosses.

29/9/91

Trench 206/3

Locus 2 JK DQ Trench 206/3 29/9/91 AW.
layer of stones just beneath top soil.

POTTERY LOT 36 JK DQ Trench 206/3 29/9/91 AW locus 2
related to Bone lot 24

One of the workers ~~se~~ thinks he sees a wall going east west near the northern bank - leaving stones to check further down

OBJECT LOT 26 JK DQ Trench 206/3 29/9/91 AW Locus 2
2 small frags. white glass.

The boulders being cleared vary in size from the quite large to the small. The soil is generally fine, grained light brown soil.

Locus 3 JK DQ Trench 206/3 29/9/91 AW
layer of soil of below rocks (Locus 2)

30/9/91
Trench 206/3

In attendance: Hamada Nasr, Naima, Fatima Mun, Azizah Mun, Aisat Mun, Aisat father

POTTERY LOT 37 JK DQ 30/9/91 Trench 206/3 Locus 3 Aw
Same layout as PL 36 & lot 35

~~POTTERY LOT 25~~ JK DQ 30/9/91 Trench 206/3 Locus 3 Aw
as with PL 37. mixed locus

Continuing down as with late yesterday. Various size
sherds coming out again. This sequence almost seems a
complete repeat of Trench 206/2.

OBJECT LOT 27 Trench 206/3 Locus 3 30/9/91 JK DQ Aw
glass frags v. small + 1 rim frag.

Having gone down along the center area of the west
bank from the center it is all still quite unclear. We are
clearing slowly towards the north along the west bank
for there may be a wall running in front of the west bank.

Also have another worker opening up the area b/w the
east bank + what may be the north/south running
wall emanating from trench 206/2.

Locus 4 Trench 206/3 30/9/91 JK DQ Aw
area bounded by north bank, east bank + poss.
n/s running wall.

POTTERY LOT 38 JK DQ 30/9/91 JK DQ Aw Locus 4

30/9/91

have cleaned up the roughly
circular arrangement of stones in
center of trench + are convinced
that they have fallen there simply
by chance. If PC agrees will
clear them away + progress instead
towards the pierced wall running
north/south before the east bank. OK for PC.

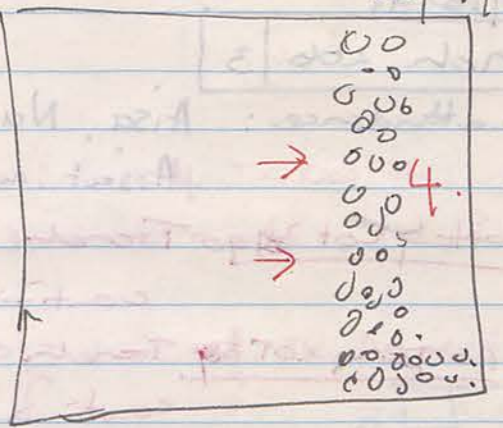

OBJECT LOT 28 JK DQ 30/9/91 Trench 206/3 Locus 4 Aw
1 frag white glass, maybe a rim frag.

OBJECT LOT 29 JK DQ 30/9/91 Trench 206/3 Locus 3 Aw
small basalt block, maybe a loom weight.

One of the workers accidentally putting locus 4 ~~shards~~ sherds
in pottery lot 37, probably not a lot though. Also bones
from both loci put in same bag.

* Locus 4 is incorrectly

1/10/91
Trench 206/3

Attendance: Aisa, Naima, Fertin's mum, Aziz's mum,
Aisa's mum, someone instead of Hamada Nassr.

Pottery Lot 3940 Trench 206/3 Locus 3 1/10/91 JK DQ AW
continuing from PL 37

Pottery Lot 39 Trench 206/3 Locus 4 1/10/91 JK DQ AW
continuing from PL 38

BONE LOT 26 Trench 206/3 Locus 4 1/10/91 JK DQ AW

BONE LOT 27 Trench 206/3 Locus 3 1/10/91 JK DQ AW.

Am now working in both Locus 3 + Locus 4.

In Locus 3, it appears that Hamada Nassr's insistence on their being an east/west wall near the north bank has proven to be correct, but will need to go down further to see how high it is. It seems to be stepped, though, although this may be the result of an excessive pulling away of top stones by PC yesterday. To the north of this wall + a building it is a very large flat worked block, extending out for the west bank. It is standing upright on its long side edge.

Cleared the top layer of stones just beyond this slab to the north we have found another flat worked block, also standing upright perpendicular to it + meeting at the corner of the 1st block. This 2nd block is coming from the north bank.

Will be digging towards it along the north bank for the east. A few large boulders lay randomly on the surface but clearing in NE corner showed a lot of soil below these so they it was considered that if there is a N/S running wall it does not go as far as the north bank

Doorway East here?

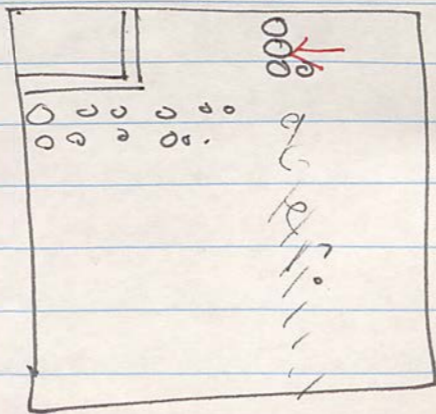

1/10/91
Trench 206/3

OBJECT LOT 30 1/10/91 Trench 206/3 Locus 4 JK DQ AW
terracotta figurine fragment, mould-made, id.?

OBJECT LOT 31 1/10/91 Trench 206/3 Locus 4 JK DQ AW
curved metal frag.

145cm from N. bank 80cm from east bank
65cm deep made alongside N/S wall

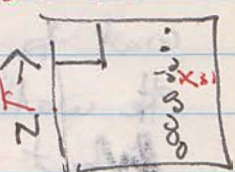

Soil in Locus 4 is fine grained, red brown soil, but as we move further westwards it is ~~is~~ has veins of medium-grey soil, ^{very} finely grained through it. Difficult to identify stratigraphically.

Soil in Locus 3 is same as in Locus 4, also with a deposit of grey soil near the center of the west bank.

A ring, 1/2 shell, + some white glass all found at red 'x' which is approximately same area as where grey soil is. Grey soil has few inclusions

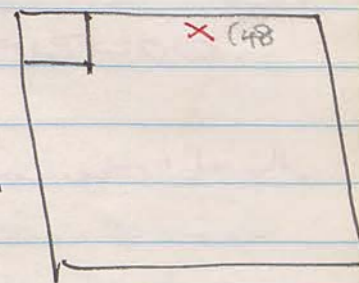

OBJECT LOT 32 JK DQ 1/10/91 Trench 206/3
whole 1/2 shell.

OBJECT LOT 33 JK DQ 1/10/91 Trench 206/3
folded ring band.

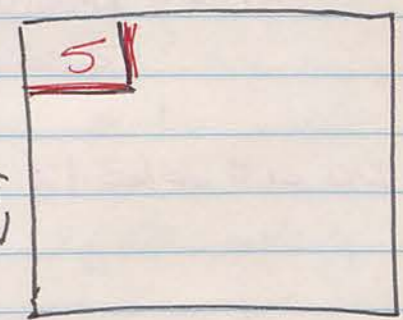

OBJECT LOT 34 JK DQ 1/10/91 Trench 206/3
white glass frags.

Locus 5 JK DQ 1/10/91 Trench 206/3 AW
a large worked ^{single} stone, 2 sides ardent in NW corner
later 3 sides.

1/10/91

Trench 206/3

Locus 6A JK DQ 1/10/91 Trench 206/3
wall in front of locus 5

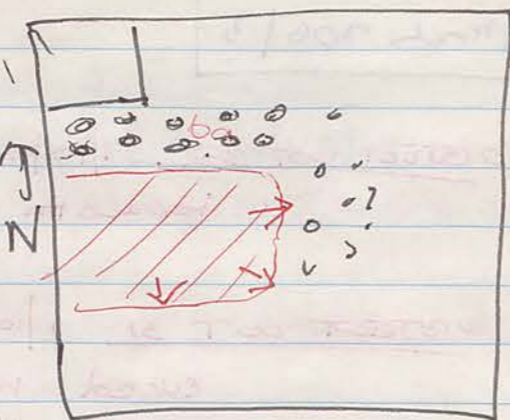

Have cleared red area abutting west wall to a virgin soil level. Reducing the wall ^{we expect} to the south has been difficult.

What was thought at surface level to be a curved wall is not a wall because there is far too much soil underneath rocks. It is presumed that if there is a wall it will be more squarely in alignment with the south wall & that from the trench to the east. Similarly, finding the west face of the possible wall running N/S. difficult.

2/10/91

Trench 206/3

In attendance: Hamada Nasr, Asa, Naima, Fatma's Mum. Anita's mum, Hussein-Abadi's wife.

POTTERY LOT 41 Trench 206/3 Locus 4 2/10/91 JK DQ
Locus 4 moving from east to west to Locus 5

BONE LOT 28 Trench 206/3 Locus 4 2/10/91 JK DQ
as with PL 41

POTTERY LOT 42 Trench 206/3 Locus 3 2/10/91 JK DQ
Locus 3 moving south.

BONE LOT 29 Trench 206/3 Locus 3 2/10/91 JK DQ
as with PL 42

OBJECT LOT 35 Trench 206/3 Locus 3 2/10/91 JK DQ
2 frags. lamp. t/c.
110 cm from south bank, 180 cm from west bank
50 cm deep.

OBJECT LOT 30 Trench 206/3 Locus 5 2/10/91 JK DQ
black glass frag, inside Locus 5.

POTTERY LOT 42^a Trench 206/3 Locus 5 2/10/91 JK DQ
inside Locus 5.

BONE LOT 30 Trench 206/3 Locus 5 2/10/91 JK DQ
inside Locus 5.

2/10/91

Working in 3 sections today. Loc 3, 4 + 5.

Locus 3. May have come to a floor level, but will concentrate on deciding this after we have determined the extent of the wall against the east bank. Similarly trying to find the west face of the wall ~~into~~ coming close to the east bank.

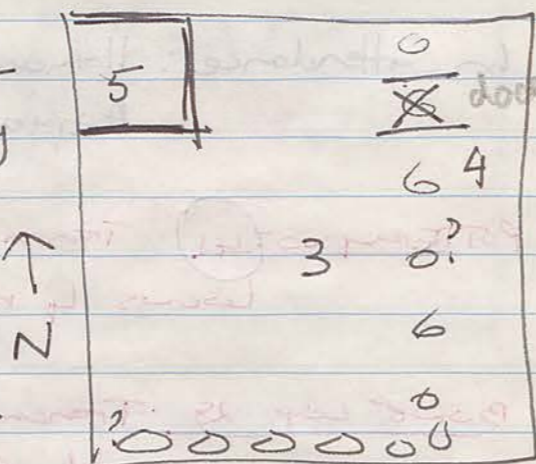

Locus 4. Appear to have gone almost clear through the wall at 'x' in the NE corner. Some A few rocks suggest the 2 sides of the wall, but the upper layers ~~are~~ were particularly unclear which is why we went through them. If the repaired rocks were indeed part of the wall then it was not a particularly definite structure. - perhaps the doorway.

Area 48
Locus 4 to Locus 5. Worked through from Locus 4 towards locus 5 along north bank. After the initial abundance of rocks (which may have been the wall) ~~there appears to be~~ ^{there} appears to be few rocks as we get closer to Locus 5. The soil is distinctly ^{fine} ~~grey~~ ^{grey} for where the ~~old~~ wall would have been to Locus 5. A lot of bones are coming out. Also a lot of pottery frags as well.

Area 48
Locus 5. Have cleared a number of large & medium stones from inside locus 5. Many of them are wedged in tight. Soil still brown fine grained. The fence 3rd wall up against the bank, but the 4th wall if it is there is probably in the west bank.

Vat

2/10/91

The walls are straight on both inside & outside & all 3 sides seem to have been cut from a single block. From about 6" to at least 12" down v. little pottery or bones coming out. Today's bag primarily containing that which came out in 1st 6".

Object Lot 36 Trench 206/3 Locus 4 2/10/91 DQ
metal pin with bent head.

6/10/91

Trench 206/3

In attendance: Atiza, Dama, Atiza's father, fatima's mom, Hussain's Abadi's replacement + 1 other. Honada Nurey's replacement

Late start today because of rain.

Locus 4: no joy going southward to find a wall. Too much soil under the rocks to suggest we still almost whole way to the bank. Maybe the wall if its there as suggested by trench to east, will be much lower down as that wall is about a rock or 2 lower than the level we are at now.

Locus 3. Decided to go down through the level we are in now because it is not convincingly a floor level. Too soft soil + base + pottery still poking out of it. The soil moves easily. Along west bank there appear to be 2 areas of light grey ash soil in the normal brown areas.

Moving south we may at last have come across a wall on the east side. So far 4 or 5 stones in a line on what is now the surface of the trench.

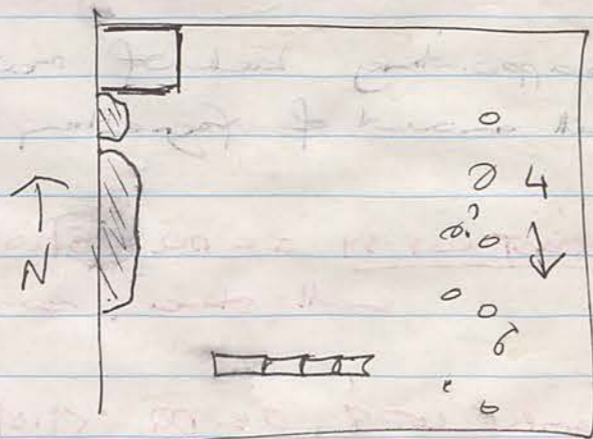

Locus 4: have cleared to some level all along. Locus 4 to almost the east bank. Stones randomly fallen have been cleared as well as the soil but the wall abutting the east bank is also unclear. Large tracts of soil still sit under the few remaining stones. Will go down another layer

Trench 206/3

6/10/91

POTTERY LOT 46 JK DA 6/10/91 Locus 3 Trench 206/3 AN
Locus 3 cleanup S. wall

BOWE LOT 32 JK DA 6/10/91 Locus 3 Trench 206/3 AN
as with PL 46

POTTERY LOT 47 JK DA 6/10/91 Locus 4 Trench 206/3 AN
moving south

BOWE LOT 33 JK DA 6/10/91 Locus 4 Trench 206/3 AN
as with PL 27

POTTERY LOT 48 JK DA 6/10/91 Locus 3 Trench 206/3 AN
floor cleanup

BOWE LOT 34 JK DA 6/10/91 Locus Trench 206/3 AN
as with PL 48

POTTERY LOT 49 JK DA 6/10/91 Locus 3 Trench 206/3 AN
cleanup east wall

BOWE LOT 35 JK DA 6/10/91 Locus 3 Trench 206/3 AN
as with PL 49

7/10/91

In attendance: Naima, Fatima's mum, Aziz, Hussein, Hussein Abadi's daughter, Hussein Abadi's wife
→ pay as lot employees not interchange trench.

Object Lot 39 JK DA Trench 206/3 Locus 4 AW
bead of stone, black w. hole in center.

150 cm from north bank
40 cm from east bank
50 cm deep

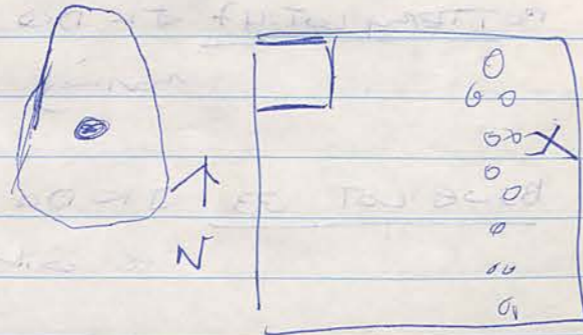

Pottery LOT 50 JK DA 7/10/91 Locus 4 Trench 206/3 AW
continuing from PL 47, next 5 inches down

Bowl LOT 36 JK DA 7/10/91 Locus 4 Trench 206/3 AW
as w. PL 50

Pottery LOT 51 JK DA 7/10/91 Locus 3 Trench 206/3 AW
clearing wall area along s. bank

SINE LOT 37 JK DA 7/10/91 Locus 3 Trench 206/3 AW
as w. PL 51

Pottery LOT 52 JK DA Trench 206/3 Locus 3 AW
from surface

Bowl LOT 38 JK DA Trench 206/3 Locus 3 AW
as with PL 52

OBJECT LOT 40 JK DA Trench 206/3 Locus 3 AW
fibulae? frag. from floor in front
front of Locus 6.

80 cm from south bank
207 cm from west bank
58 cm deep.



Object lot 41 JK DA Trench 206/3 Locus 4 AW.
round bead, white?
maybe just a stone.

Locus 6b JK DA Trench 206/3 AW
wall running east/west along south bank.
may or may not continue in SE corner.
may continue from trench
in east.

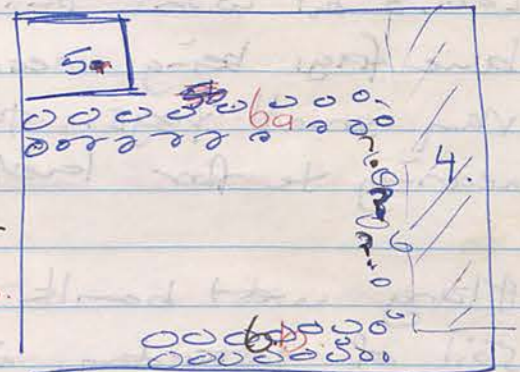

Finally found north face of east/west
running wall along south bank. 6b.
We are still at a level higher than
the east trench, but in a different room, so it may or may not
go at least another course deeper

Locus 3. will go down 3-4-5 cm today in search of
the floor

Locus 4: Have reached the floor level, which was about
3m below the level reached yesterday. It appears, without
exact measurements, to be approx. at the same level
as the floor reached. Trench to east. It is presumed
that Locus 4 is part of same room as trench to east's room
with wall

7/10/91

Object lot 42 7/10/91 Trench 206/3 Locus 4
metal frag.

Object lot 43 JK DO 7/10/91 Trench 206/3 Locus 4
basalt frag. w. not flat bp.

POTTERY LOT 53 JK DA 7/10/91 Trench 206/3 Locus 3
continuing from PL 52

BONE LOT 39 JK DO 7/10/91 Trench 206/3 Locus 3
continuing BL 38

Locus 3: Have gone down 3-5 m in most areas of
Locus 3 but won't finish today. A lot of pottery +
bone frags being unearthed, but ~~the~~ most are
very small frags. This suggests that we are probably
nearing the floor level. Also lots of v. little stones. Full?

Along west bank continued the grey, ash fine
soil of yesterday, in the middle of which is an
ill-formed piece of mudbrick ^{or baked clay} to be ~~now~~ completely
excavated tomorrow when we go down to the next level.

~~This mudbrick slab surrounded~~

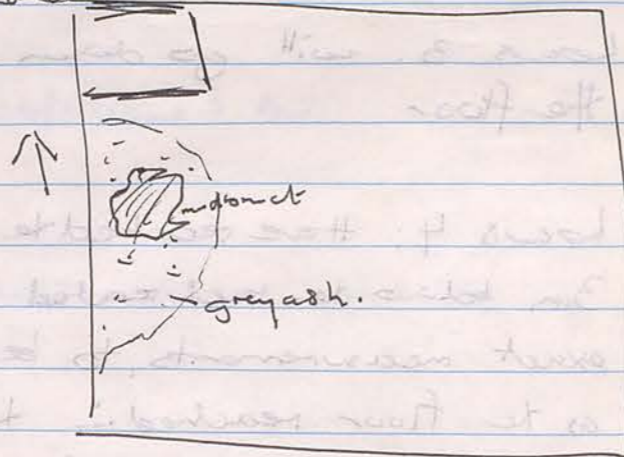

8/10/91

Trench 206/3

In attendance: same 4 as yesterday.

Locus 4: have not reached floor level as thought
yesterday & will go down now another 2-4". Trench 30m
deep at beg^s of day.

Locus 3: beginning by making the removed surface level
of yesterday is cleared down evenly to same level.

POTTERY LOT 54 JK DA 8/10/91 Trench 206/3 Locus 4
continuing PL 50, 2-4" ~~down~~ below

BONE LOT 40 JK DO 8/10/91 Trench 206/3 Locus 4
continuing BL 37 2-4" below.

POTTERY LOT 55 JK DA 8/10/91 Trench 206/3 Locus 3
continuing PL 52 same surface level

BONE LOT 41 JK DA 8/10/91 Trench 206/3 Locus 3
continuing BL 38 same surface level

Locus 3: have cleared all to same level. 2 ~~noted~~
small sections of baked mud reveal themselves now ~~are~~
nearer to the west bank. Poorly defined shapes.

The south west corner has
an especially large amount of
very small stones, + small
frags pottery + bones b/w
mudbrick + south wall.

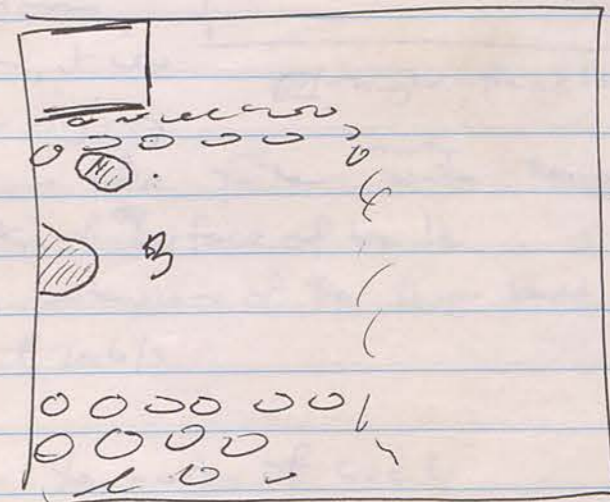

8/10/91

Trench 206/3

Object Lot 44 JK DQ 8/10/91 Trench 206/3 locus 3

small metal frag, unstratified

Object Lot 45 JK DQ 8/10/91 Trench 206/3 locus 4

white glass frag, or stone, unstratified

POTTERY LOT 56 JK DQ 8/10/91 Trench 206/3 locus 3

same level as PL55.

POTTERY LOT 57 JK DQ 8/10/91 Trench 206/3 locus 3

2-3" below PL55 + PL50

BONE LOT 42 JK DQ 8/10/91 Trench 206/3 locus 3

2-3" below BL 41 + BL 38.

Going down the next 2-3" + the whole of the soil surface in front of the south bank. Is filled with the very small frags of pottery + stone, akin to that recognised in the previous layer in the SW corner.

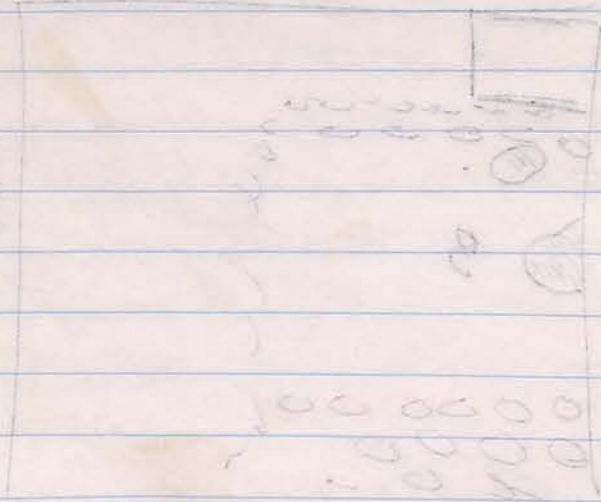

9/10/91

Trench 206/3

In attendance:

Locus 3: The final light clearing of soil (approx 2") yesterday + this morning, reveals a floor level around most of the locus. A small area in front of the northern east/west wall have no floor + are either small pits or weak spots ~~at~~ corner in front of walls

Locus 7: JK DQ Trench 206/3

2 mudbrick blobs in Locus 3.

Locus 4: still burrowing down. + am not convinced that they have not gone through a floor level in the north of locus 4. If so it is likely that there is at least a

2nd floor level because the wall which runs north/south + is the edge of locus 4 still goes down at least one row of boulders.

In south of loc. 4. is a ^{? later than what?} ^{= higher} floor level extending approx. 164cm from south bank. This floor level may not have extended ^{much} further north, it was not obvious at earlier levels of the digging of loc. 4. I do think it went a little further ^{north} ~~south~~ though. It is also approx 20cm from top of surface of bank which would suggest it was an extension of the floor level visible in the trench to the east of 206/3

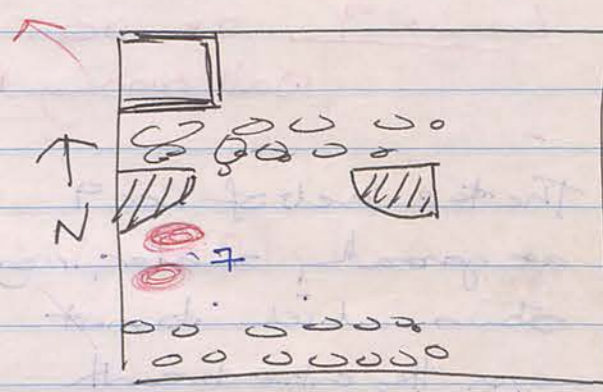

⊙ = weak spot
○ = mudbrick

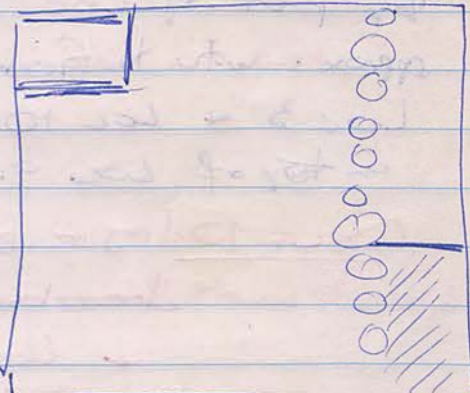

▨ = higher floor level

Having gone further down today in the north of locus 4

9/10/91
has clarified the line of the N/S running wall bounding Loc 4. The stone line is very definite now in the lower levels.

It is likely that there are at least 2, if not 3 ~~levels~~ phases to this wall. The bottom row or some of the blocks above this in the northern part of the wall (looking at the east face) are broad flatter, square stones. A few larger stones on the second row may suggest a second phase & relate to the bldg of the wall = Loc 6a. - This is done!

Locus 9 JK DQ 9/10/91 Trench 206/3
Wall running North/South dividing Loc 3 from Loc 4.

The top levels of Loc 9 are generally smaller, irregular stones which do not span the entire breadth of the ^{entire} wall. This rougher, top part of Loc 9 equates approx. with the floor levels in Loc 3 + Loc 10. Has remained some of the smaller stones on top of Loc 9.



Locus 10 JK DQ 9/10/91 Trench 206/3
area bounded by Loc 6a, north bank, Loc 5 + Loc 9
previously considered part of Loc 4.

Floor levels in Loc 10 + Loc 3 approx same, + approx same as ~~high~~ later level in Loc 4 (south). Northern part of Loc 4 is lower than all 3.

9/10/91

Trench 206/3

Clarified form of the 2 mudbrick blobs in Locus 3. They are poorly formed the southern blob being larger than the other (about 4 times the size). Behind a ~~second~~ ^{third} row these 2 was the layer (circ shape) of grey ash already noted. Did not work at proper shape till had gone down to floor level in Loc 3. Then removed excess soil, especially below each blob & the west bank. The following 2 ~~pottery~~ lots came from this cleanup

Pottery Lot 59 Trench 206/3 Loc 7 JK DQ 9/10/91
for cleanup of blobs

Base Lot 45 JK DQ Trench 206/3 Loc 7 9/10/91
as with PL 59

Cleaned up Loc 6b wall.

POTTERY LOT 60 JK DQ 206/3 Loc 6b 9/10/91
cleanup - Loc 6b wall

POTTERY LOT 61 JK DQ 206/3 Loc 9 9/10/91
cleanup + removal of top small stones of wall

Base Lot 46 JK DQ 206/3 Loc 9 9/10/91
as with PL 61

The 2 work spots noted on p 59. cleared more. The one in blw Loc

Pottery Lot 46 JK DQ 206/3 Loc 1 9/10/91

Domed bead with central hole
100m from south bank, 100m from east bank.

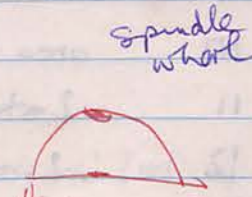

9/10/91

In attendance: Naima, Aisa, Fatima's Mum, Amara, Zahara, Hussein - Abadi's wife. (no real new people)

Locus 11 JK OQ 9/10/91 Trench 206/3. 2 stores + baked leben in an arc - maybe oven?

Locus 12 JK OQ 9/10/91 Trench 206/3. 2 stores at right angles on floor - maybe oven?

Trying to come to terms with walls in this trench. They vary in quality + position over time. There are 2 courses evident at this stage at the bottom of Loc 9 (from east face) which are larger + flatter + more strongly related to each other. This is from north bank to just past where 6a + 9 meet. These stones concur with the lower floor level evident in north of locus 4. It is possible that the top level of this original wall was knocked down or fell over + these courses retained. The next stage may be the wall

Schematic Drawing Page 63

- locus 1 Topsoil all over trench
- 2 Top layer of stone tumble
- 3 Soil level below loc 2, + later area b/w west bank, 6a, 9 + 6b.
- 4 Area b/w 6b, 9, east bank, thru 9 in north. North bank + 5 (later just area b/w 6b, 9, east bank + north bank)
- 5 Worked single stone, hollowed out, in west bank
- 6a East/west wall in front of locus 5 till loc. 9.
- 6b East/west wall abutting south bank
- 7 2 baked leben blobs
- 8 floor level, later, in loc 4. as south
- 9 north/south wall from south bank thru to north bank.
- 10 area b/w north bank, 5, 6a + 9 [old 4 when 9 identified]
- 11 2 stores + baked leben in an arc - maybe oven
- 12 2 " at right angles - maybe oven

10/10/91 Trench 206/3. approx 11:20.

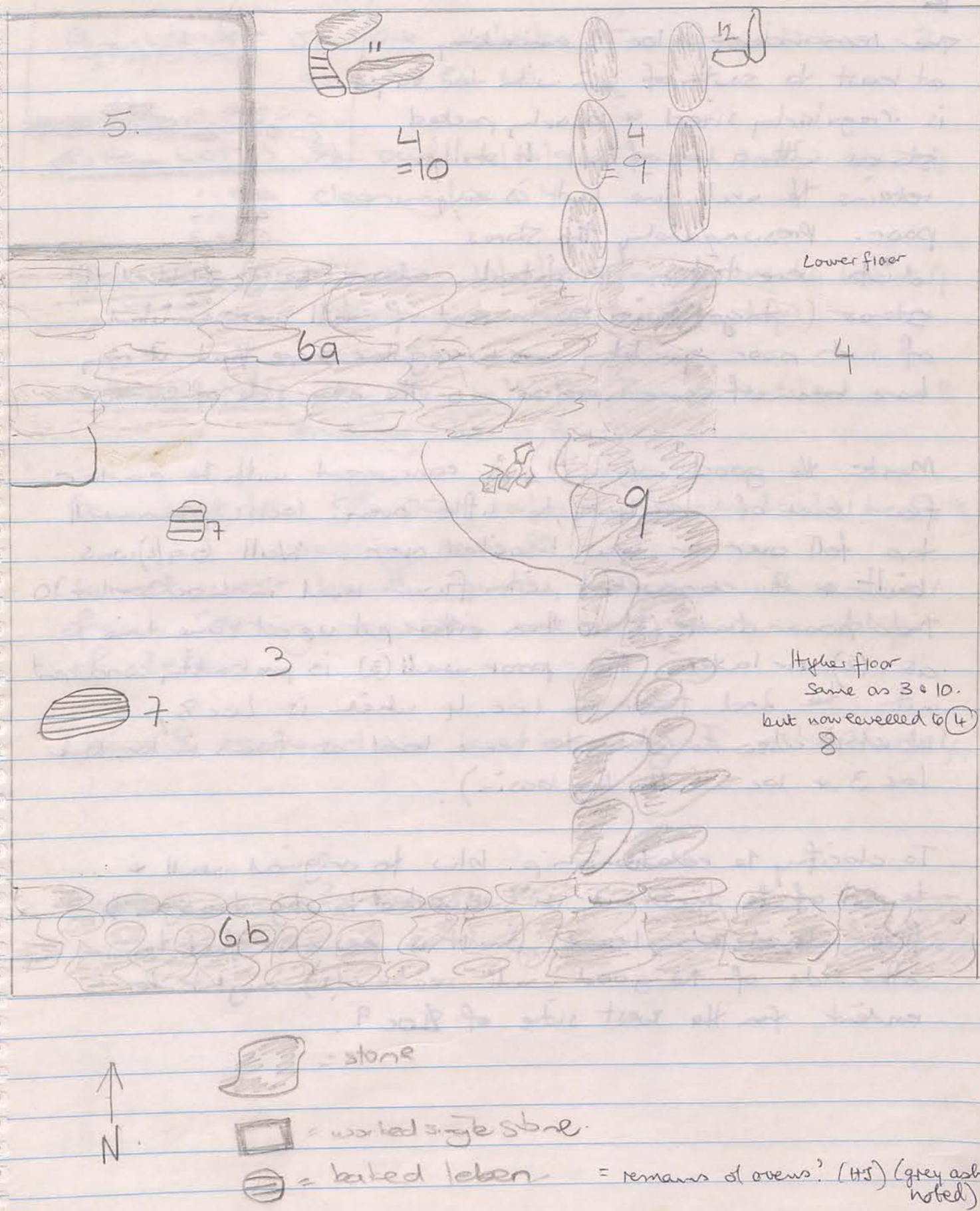

10/10/91

noted as locus 6a, which lies above & protrudes at right angles to this 1st level.

The

The remainder of loc 9, probably at least to south of join with loc 6a, is irregularly sized & poorly packed stones with a lot of soil. It still retains the wall line but is very poor. Presumably the stones which were taken mistakenly above the good level of stones (stage 1) in north part of wall were similarly of such poor quality & irregular shape that it may have been of same period as the other side of 6a.

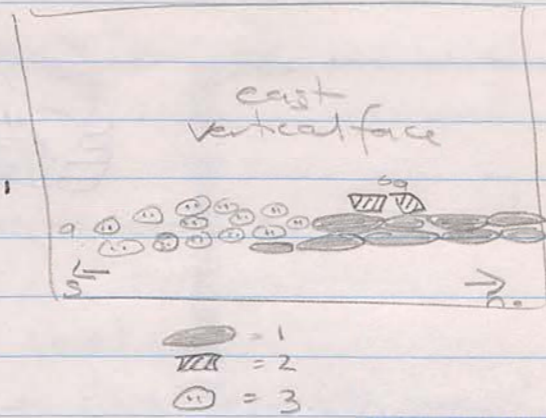

Maybe the good wall (1) is concurrent with the earlier floor level of loc 4 & the little oven? loc 12, the wall top fell over or was knocked over. Wall 6a(2) was built & is concurrent with floor level in loc 3 & loc 10. The poor wall (3) is then either put up at some time as (2) or later. The poor wall (3) is probably concurrent with the 2nd floor in loc. 4 which is loc 8, which is also roughly the same level as floors in loc. 10 & loc 3 & loc 5 (the big basin).

To clarify the relationship, b/w the original wall & the rest of the trench it is suggested to dig through the floor level in locus 3. It is presumed that the other side of the good wall section (1) might be evident from the west side of loc 9.

10/10/91

Pottery lot 62 JK DQ 10/10/91 Trench 206/3 locus 3
cleaning & defining bank west

Zone Lot 47 JK DQ 10/10/91 Trench 206/3 locus 3
as with PL 62

Pottery lot 63 JK DQ 10/10/91 Trench 206/3 locus 4
cleaning locus 4

Zone Lot 48 JK DQ 10/10/91 Trench 206/3 locus 4
cleaning locus 4 (empty)

Pottery lot 64 JK DQ 10/10/91 Trench 206/3 locus 8
removing locus 8

Zone Lot 49 JK DQ 10/10/91 Trench 206/3 locus 8
removing locus 8

Cleaned west bank, partly collapsed with removal of soil. Crushing boulders removed southern blob of leben.

Locus 8 removed to level equal with rest of locus 4.

Photos ?? ask PC.

10/10/91

Trench 206/2

- Loc 1 topsoil
- 2 corner of 2 walls
- 3a floor level
- 3b area of rubble + soil (garden?)
- 4 - area b/w east bank + north/south wall
- 5 limestone (amphora stud/hole)

1 wall running north/south between banks. Generally poorly constructed but with a ~~large~~ doorway in middle, there 4 worked stones (south door jamb, no lintel but 2 blocks higher, fallen north door jamb previously removed for general rubble). Wall top presumably collapsed into large area west of the wall. Small cavity in NE corner (Loc 4) which is presumably rest of room for trench to east. Unable to dissect SE corner due to smallness of space. In north of loc. 4 floor not found so it goes a substantial way down. A pit was dug as far as possible but confined to space, stopped us before we got to bedrock. Remained part of south bank to more precisely define loc 3b + loc 6. Loc 3b built into existing walls 2 + 6.

10/10/91

Trench 206/2

1:20

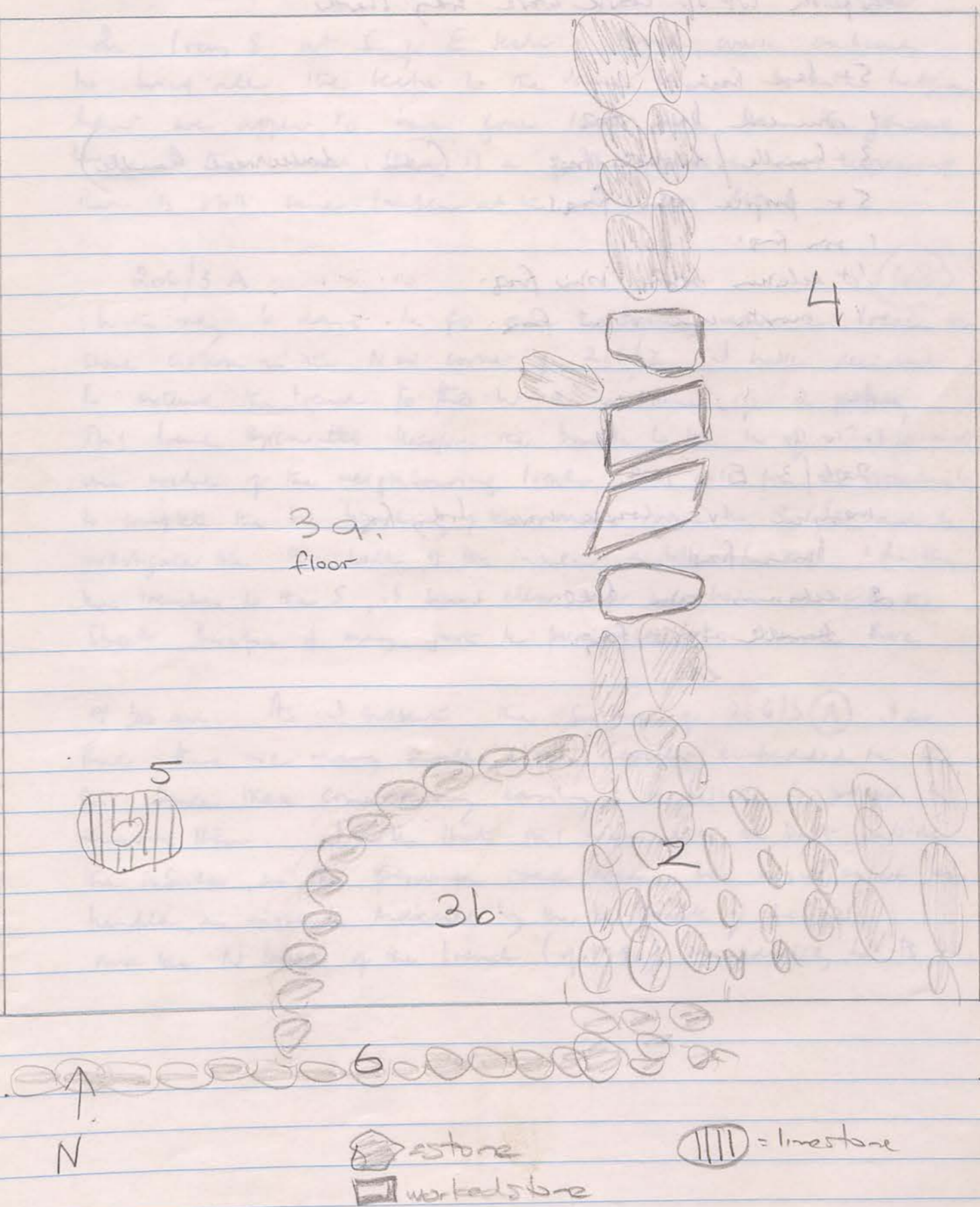

12.10.91

206/3 A (1)

largest lot of coarse ware body sherds

5+ base frags

1 rounded base frag.

3+ handle / h root frag (inc. double neck handle)

5+ purple rim frags

1 rim frag.

1+ echinus base rim frag.

1 mortarium rim frag.

12.10.91

206/3 E

medium lot coarse ware body frags

1 base frag.

2 echinus rim frag.

1 handle root frag.

etc

Saturday 12 October 1991

Weather cloudy at first, cool breeze from NW

Workers 6 as before.

(38)

In locus 8 at S of E sector of trench, work continues to bring all the sector to the same level. Within half an hour we appear to have gone lower here than the general level to the N and there is a filthy reddish soil appearing. There is still some trouble at the S of this locus.

206/3 A

(48)

With only 6 days to go and the seeming need to locate the stone cistern in the NW corner of 206/3, I have decided to extend the trench to the W a distance of 2 metres. This trench excavates therefore the handle to the W of 206/3 and one metre of the neighbouring trench. This will give the opportunity to complete the W boundary of the main room in 206/3 and to investigate the W wall of the insula a little further. In the two trenches to the S, it seems clear that we have exposed the street. Therefore it may just be permissible to operate here

9.30 am. As I inspect the surface of 206/3 (A) I see that there are many small stones loosely embedded in the soil. Since these come away easily, it is possible to proceed by removing them. I note that this area lies in part outside the insula, as the presumed road area. We might expect less trouble, as might be indicated by the W handle of 206/2 and the N handle of the trench (of 1990) immediately to its W.

12 October 1991

206/3 hour 8.

36

still difficult. There is an extremely hard clay deposit at the S end. I therefore proceed by straightening the S bank and cleaning all the rubble stones in the NS wall that defines this sector.

12:30 pm. 2 Btu ϕ = Roll 5 B 1-2 from N of the E sector of 206/3 showing progress. The line of the wall at the W is clear above the present soil level though the wall itself in the courts above is quite battered. It runs the whole NS length of the trench.

What is happening here is still unclear. Do we have a floor or not? According to the neighboring trench to E the bedrock is not far away. The flimsy wall of KB's trench does not (now!) continue W into 206/3.

Better contemplate a little more. The workers have gone to 206/3 A. where work progresses reasonably well.

206/3A (2) from the stone-cut basin

a few coarse ware body sherds

1 base frag.

1 rim frag

1 other rim frag



one bag

Sunday 13 October 1991

Weather: overcast, cool, slight breeze from N

Work: 6 as usual

206/3 A.

Work continues on the top soil which is grayish brown and very fine and powdery. In the centre west of the trench is a concentration of chips of limestone, beige but chips. This is W (outside) of the line of the wall that defines the W internal boundary. The line of the wall is emerging at the N.

The smallish stones of rubble are not heavily embedded in this powdery soil, they come away easily.

By 6.45 am there is half a central of pottery

8.15 am.

a frag of bronze wire: cosmetic equipment?

To the W of the N/S wall the deposit is still powdery but a different soil - a darker brown is appearing in the SW corner of the trench.

In the W bank of 206/3 (NW), the stratigraphy shows a deep layer of rubble surrounded by a gray brown soil, then a reddish layer with almost no deposit, a thick band of powdery dark gray. Although we seem to have a wall on the S side of 206/3 the gray band turns the corner to the E and in the very SW corner of the trench there appears to be no wall.

Beneath the gray (and above the floor) is a thin layer of small gritty pebbles and particles of limestone

13.10.91

206/3A (3)

Smallish lot c/w body sheds

3 base frags c/w brack jars

1 large rim frag

2 purple rim frags

1 frag with handle

1 rim frag flaring rim base

1 body frag by. with

1 echinus rim frag

1 tile frag

13.10.91

206/3A (1)

large wt gray-tinted coarse ware body sheds

1 + 6 handle or handle root frags

13 base frags

10 purple-rim frags

1 body frag impressed wavy decoration

1 rim frag fine of base

2 echinus rim frags

1 body frag graffiti BAP

1 frag glass

Monday

13.10.91

8.15 am.

We begin work also on the deposit with the stone basin on the S NW of 206/3. removing the tumble = 206/3A (3)

Within the basin the soil is a reddish brown below the tumble.

206/3 A

8.35 am we begin now to remove the upper layer of tumble (from within 206/3) and the dark soil around it. I wish to move towards the W, that is towards the inner face of the W boundary wall, stratum by stratum.

= 206/3 A (2)

10.15 am. The soil deposit in the basin is a quite fine red-brown soil. There is little pottery in it. Some large tumbled emerging at the W of the basin, and within it.

The full dimension of the basin has been revealed. It reaches as far as the NS wall, but it also has a structure to the S, it seems.

10.30 The tumble at NW of basin is cleared and the basin swept down but it requires a thorough cleaning of the surface before photography.

14.10.91

206/3 A W (1)

large bag coarse ware body sherds

10 purple rim frags

10 base frags

2+6+2 base frags rg

1 mortarium rim frag

1 base frag strong cut base

2 handle frags

8 rim frags flaring rim bowls

1 tile frag.

1 ~~mortarium~~ unguentarium base frag.

3 echinus bowl rim frags.

14.10.91

206/3

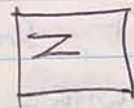

medium wt c/w body sherds

3 rim frags

1 base frag

1 rim frag (profile)

1 rim frag

1 rim frag

1 rim frag

1 base frag rg

1 base frag green glaze

'rotellae'

punched out Δ dec

flaring rim bowl

Monday

14 October 1991

Workers: 6 as usual.

206/3 A W (1)

Road.

We begin work today on the narrow sector W of the NS boundary wall. The soil as before is very fine and powdery. Towards the N there is a sign of a harder, reddish deposit.

There is a good deal of pottery emerging from 7m ($\frac{1}{2}$ cent). Round the centre of this sector a heavy concentration of fine-sized chips of limestone (as noticed previously).

7.50 am. Already a full zentbil of pottery. Change to Bag 2

The hard deposit at the N has been swept for about 50 m. Perhaps it could be the road. There is still plenty of soil towards the South. The fine powdery gray soil is confined now to the N half of this trend.

8.20 in the Southern half of this W sector (designated Y in the book with the supplementary notes), we are clearly beneath the stratum with the heavy concentration of limestone chips (and chunks!) The soil is a good light brown with very small inclusions. Since the pottery has been coming from this stratum I have changed the labels from (1) bag 2 to W (2). There is a greater depth than at the N end.

10.10.91

Water ...

...

...

...

...

...

...

...

...

10.10.91

Pottery wt 64 206/3 [8] 10.10.91
21 small body sherds
1 base frag
1 handle frag. One bag

Pottery wt 63 206/3 [4] 10.10.91
20 or so coarse ware body sherds
1 base frag.
2 profile rim frags One bag

Pottery wt 51 206/3 [3] 7.10.91
couple of doz small coarse ware body sherds
1 body frag rg.

...

Pottery wt 29 206/3 [2] 10.10.91
...

...

Pottery lot 56 206/3 [3] 9.10.91
 medium-small wt coarse ware body sherds
 3 rim frags profile rim
 1 rim frag flaring rim bowl
 4 base frags.
 1 rim frag echinus bowl.
 1 rim frag fine rg bowl
 4 rim frags small bowls.

Pottery lot 55 206/3 [3] 8.10.91
 medium wt very small coarse ware body sherds
 3 handle frags
 1 coarse ware body sherd w. pie crust dec.
 7 frags rim flaring bowl
 87 rim frags profile rim.
 7 base frags
 body frags rg.

Pottery lot 62 206/3 [3] West Bank 10.10.91
 small wt coarse ware body sherds
 1 rounded base frag.
 2 handle frags
 1 base frag. 2 rim frags. one bag

Pottery lot 59 206/3 [3] 9.10.91
 small wt coarse ware body sherds (small)
 1 base frag
 2 rim frags echinus bowl
 2 profile rim frags
 1 body frag with possible impressed decoration.
 1 stone ?

Pottery lot 60 206/3 [6b] 9.10.91
 11 body sherds 4 body frags rg. one bag.

Pottery lot 53 catalogued
 1 handle sherd, oval neck
 2 rim sherds, moulded ext. rim
 2 " " moulded ext rim
 1 rim sherd, incurving rim
 1 base sherd, ring base.
 1 rim sherd, incurving rim
 1 " " outflared rim
 1 base sherd, ring base
 1 rim sherd, plain rim
 1 " " slightly ledged rim

Pottery lot 49
 not sorted

Pottery lot 57 206/3 [4] 9.10.91
 not sorted

smaller wt coarse ware body sherds
 2 handle frags
 3 base frags
 2 profile rim frags
 3 flaring bowl rim frags.

Pottery lot 61 206/3 [9] 9.10.91
 tiny wt coarse ware body sherds
 1 handle frag
 1 worn base? frag.

Pottery Lot 52 continued

- 1 rim sherd, moulded ext rim
- 1 handle sherd, oval section
- 1 rim sherd, thickened ext. rim
- 1 " " , plain rim
- 2 " " , moulded ext. rim
- 1 " " , thickened rim
- 1 " " , incurving rim

Pottery Lot 50 Trench 200/3 Locus 4 7/10/91

- 8 handful body sherds
- 2 body sherds, red glaze int & ext
- 1 rim sherd, ledge rim, mending hole.
- 1 rim sherd, thickened ext rim
- 1 handle + body sherd, oval section
- 1 base sherd
- 1 rim sherd, bowl w. incurving rim
- 1 " " , depressed rim, plate
- 1 " " , moulded ext rim

Pottery Lot 53 Trench 200/3 Locus 3 7/10/91

- 7 handful body sherds.
- 1 handle sherd, oval section
- 1 handle + body sherd, oval section
- 9 body sherds, red glaze int & ext
- 1 base sherd, ring base central depression, fish plate
- 1 base sherd, ring base
- 1 handle + body sherd, oval section
- 4 rim sherds, moulded ext. rims
- 1 neck + handle sherd, vertical handle oval section
- 1 rim sherd, plate.
- 1 handle sherd, oval section
- 1 base sherd, ring base

Trench 200/3 Locus 4 Pottery Lot 47 6/10/91 Aw

- 4 handful body sherds
- 3 base sherds, ring bases
- 1 handle + body sherd, circular section
- 1 rim sherd, straight rim, red glaze int & ext
- 1 " " , thickened moulded rim
- 2 rim sherds (1 piece), ledge rim
- 1 " " , ledge rim
- 1 " " , depressed rim, plate frag.
- 1 " " , added plastic band on ext, pinched
- 1 " " , incurving rim
- 1 " " , ledge rim

Pottery Lot 46 6/10/91 Trench 200/3 Locus 3 Aw.

- 3 handful body sherds
- 1 rim sherd, bowl w. incurving rim
- 2 " " , slightly out-turned rim
- 1 " " , ledge rim

Pottery Lot 52 Trench 200/3 Locus 3 7/10/91 Aw

- 6 handful body sherds
- 1 base sherd, ring base, red glaze int & ext ~~lightly targeted~~
- 2 rim sherds, moulded ext rims.
- 1 base sherd, ring base, central depression fish plate
- 1 rim sherd, bowl w. incurving rim
- 2 handle + body sherds, oval sections.
- 1 base sherd, moulded base red glaze ext & int
- 1 rim sherd, impressed ext. rim
- 1 handle + body sherd, oval section
- 1 rim sherd, bowl w. incurving rim

Pottery Lot 37 JK DQ 30/9/91 Locus 3 Trench 206/3

- 8 handsful body sherds
- 1 roof tile frag.
- 4 ~~3~~ body sherds, red glaze int + ext
- 1 rim sherd, slightly flared rim, red glaze int + ext
- 5 ~~4~~ base sherds, ring bases
- 1 base + body sherd, fish plate
- 4 rim sherds, moulded ext rims
- 1 handle + body sherd, cooking pot
- 1 handle sherd, horizontal section
- 1 rim sherd
- 1 " " , thickened rim
- 1 " " , incurving rim
- 1 " " , plate #.
- 1 " " , ledged ext rim
- 1 " " , thickened ext. rim
- 1 handle sherd, oval section

Pottery Lot 48 6/10/91 Trench 206/3 Locus 3 AW.

- 2 handsful body sherd
- 2 rim sherd, moulded ext rim

Pottery Lot 54 Trench 206/3 Locus 4 8/10/91 AW

- 6 handsful body sherds
- 2 base sherds, ring bases
- 4 rim sherds, thickened ext. rim
- 1 " " , plain rim
- 1 base sherd, ring base

Pottery Lot 44 5/10/91 Trench 206/3 Locus 4 JK DQ

- handsful body sherds
- 1 handle sherd, thick circular section
- 5 ~~6~~ body sherds, red glaze int + ext, 2 w gauged fluting
- 2 rim sherds, moulded ext. rims
- 1 amphora toe base
- 1 rim sherd, thickened splaying rim
- 1 " " , moulded ext. rim
- 1 " " , shallow bowl, incurving rim
- 1 " " , depressed rim, plate
- 1 " " , upturned rim, plate
- 1 " " , red pt'd int + ext, straight rim
- 1 " " , blackish to brown glaze int + ext
- 1 " " , shallow bowl
- 1 " " , moulded ext. rim
- 1 base sherd, ring base
- 1 handle sherd, ventral depression, oval section
- 1 rim sherd, slightly outturned rim, red glaze int + ext

Pottery Lot 43 JK DQ 5/10/91 Trench 206/3

- 7 handsful body sherds
- 3 frags roof tiles
- 1 body sherd, red glaze int + ext
- 1 rim sherd, offset rim, shallow bowl
- 1 " " , ledge rim int + ext
- 3 body sherds, horizontal gouging ext
- 1 handle + body sherd, oval section
- 1 rim sherd, ledge rim ext
- 1 " " , thickened incurving red, pt'd red
- 1 handle + body sherd, circular section
- 1 rim sherd, thickened ext rim

Pottery Lot 34 Trench 206/2 Locus 3b 26/9/91 JK DQ

Pottery Lot 41 2/10/91 Trench 206/3 Locus 4 JK DQ

12 handful body sherds

1 base sherd, red glaze int & ext, bowl w. ~~convex~~ convex/concave profile

1 rim sherd, red glaze int & ext, flaring lip

3 base sherd, ring base shallow bowl

1 " " " " central depression, fish plate

1 rim sherd, shallow bowl, unevenly turned

2 " " " " "

1 " " " " ext. moulded rim

1 " " " " red glaze int & ext, subtle turned lip.

1 " " " " closed vessel, plain rim

1 handle sherd, bipartite section

1 " " " " oval

1 " + body sherd, hollow section in handle.

1 base sherd, ring base

2 rim " " bowls w. incurving rim

2 " " " " moulded ext. rim

1 " " " " obtuse rim

1 " " " " plate

Pottery Lot 42 2/10/91 Trench 206/3 Locus 5 JK DQ.

4 handful body sherd.

1 base sherd, ring base, shallow bowl

1 handle + body sherd,

1 rim sherd, plate w. downturned rim

1 rim sherd, incurving rim

1 " " " " "

Pottery Lot 35 28/9/91 JK DQ Locus 1 Trench 206/3 AW

3 handful body sherds.

1 base sherd, ring base, open vessel

1 rim sherd, ledge rim

1 body sherd, red glaze int & ext

1 rim sherd, ledge rim

1 handle sherd, oval section

2 base sherds, ring base

1 rim sherd, plate ~~sherd~~.

1 " " " " bowl w. incurving rim

1 handle + body sherd, vertical handle.

1 rim sherd, moulded

Pottery Lot 26 24/9/91 JK DQ Trench 206/2 Locus AW

6 handful of body sherds

1 body sherd, red glaze int & ext good quality

1 base sherd, rounded base

1 rim sherd, outturning rim

1 handle + body sherd, vertical handle.

Pottery Lot 35 Trench 206/3 Locus 1 29/9/91 Da

1 handful body sherd

1 rim frag, moulded ext rim

Pottery Lot 36 29/9/91 Trench 206/3 Locus 2 JK DQ

7 handful body sherd.

1 rim sherd, moulded ext rim

1 ring base sherd,

1 rim sherd, plain rim

1 rim sherd, plate w. downturned rim

Pottery Lot 28 25/9/91 Trench 206/2 Locus 4 AW DQ

- 8 handfuls of body sherds.
- 1 rim sherd, plain rim, rivet hole (repair)
- 1 " " , bowl w. incurving rim
- 2 " " , ptd int & ext, bowl w. incurving rim
- 1 " " , moulded ext rim
- 1 body sherd, red ptd
- 1 rim sherd, shallow bowl plain rim
- 1 body sherd, external rouletting

Pottery Lot 32 26/9/91 Trench 206/3 Locus 1 JK DQ AW

handful body sherds

- 1 body sherd, red glaze int & ext, dual incision
- 1 base sherd, ring base.
- 1 rim sherd, bowl w. incurving rim
- 1 " " , moulded ext. rim
- 2 rim sherds

Pottery Lot 29 25/9/91 Trench 206/3 Locus 1 JK DQ AW

handful body sherds

- 2 rim sherds, bowls w. incurving rims

Pottery Lot 32 26/9/91 Trench 206/2 Locus 4 JK DQ AW

2 handful body sherds

- 1 rim sherd, thickened rim, large closed vessel
- 1 rim sherd, plate w. downturned rim

Pottery Lot 34 26/9/91 Trench 206/2 Locus 3b

sherd = fragment

Terracotta

STONE LOT 1 27/10/91 Trench 207/7 DQ
in front of bank A. => actually terracotta

1 roof tile fragment

1 worked roof tile fragment

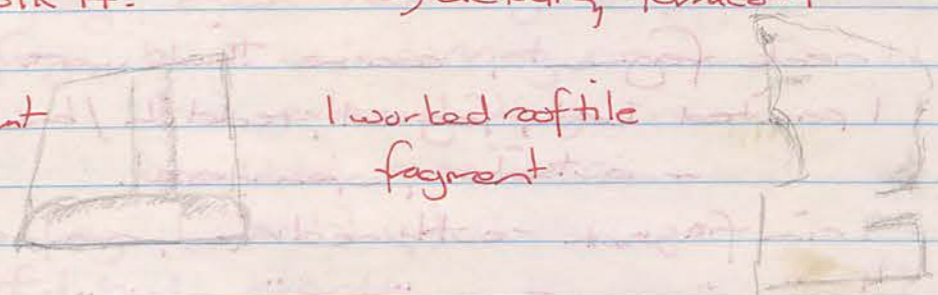

POTTERY LOT (Number) 9/9/91 207/7 DQ
in front of Bank A.

coarseware body ware - small to medium sized diagnostic - small cooking pot body sherds.

- large piece of pot w. handle for spherical shape, shoulder to rim, vertical straight rim, no foot/base (probably ~~two~~ body sherds from same pot)
- 3 rim sherds, vertical straight rim, coarseware
- 3 ring base sherds, different pots, coarseware
- 2 plain rim, slightly incurving, coarseware
- 1 plain rim, slightly sloping, with notch under outside rim
- 1 everted rim, horizontal rim stance
- 1 lamp frag, top section from side wall to central hole
- 1 body sherd, 3 inside ridges - horizontal plain outside.
- 1 round small disc.

large = broad

POTTERY LOT 3 10/9/91 206/2 F1

- 1 neck fragment, coarse thick ware
- 1 painted body fragment, reddish/brown paint inside + outside, open vessel.
- 1 rim fragment - outlined rim, open vessel
- 1 " " - " " " " (different)
- 1 " " - moulded rim
- 1 base fragment - plain ware, 2 incised concentric circles on tondo, open vessel.
- 1 " " - open vessel, plain ware, 2 raised moulded concentric circles on tondo
- 1 body sherd with ribbing
- 1 roof tile, no marks
- Medium pile body sherds

POTTERY LOT 4

206/2 Trench 12/9/91 Feature 1 DQ AW

- 1 base frag, ring base, shallow bowl?
- 1 plate frag, upturned rim
- 2 rim frags, bowl w. incurving rim
- 2 1/2 handful of body sherds

Pit north of furthest pit west 207/7 DQ 10/9/91 AW

- 1 handful body sherds
- 1 frag red glaze body sherd
- 1 " hard fired red ware body sherd, most finish

13/9/91 furthest pit west of 207/7

- 1 plate frag, brown-reddish glaze, rim
- 1 rim frag, bowl w. incurving rim
- 1 " " thick external ledge rim
- 1 " " moulded external rim
- 1 base frag (possibly)
- 1 handful body sherds

10/9/91 DQ JK pit west of 207/7 AW

- 1 base frag, (possibly moulded) with dimple in center
- 1 roof tile
- 1 handful body sherds

POTTERY LOT 2 206/2 F1 DQ 10/9/91 AW

- 2 handful of body sherds
- 1 body sherd, red glaze on one side & black glaze on other side
- 1 rim frag, plain ware bowl w. incurving rim
- 1 " " red painted both sides

POTTERY LOT 6 9/9/91 206/2 F1 DQ AW

- 5 handful body sherds
- 1 rim sherd, bowl w. incurving rim, red painted inside & out
- 1 rim sherd, bowl w. incurving rim
- 1 " " thickened rim, plain ware
- 1 " " moulded rim
- 1 body sherd, red glaze inside & out
- 1 base sherd, (fish plate?)

17/9/91 206/2 F1 DQ AW

- 1 rim sherd, bowl w. incurving rim, red painted inside & out
- 1 body sherd, red glaze inside & out
- 1 base sherd, (fish plate?)



POTTERY LOT 9 TRENCH 207/5 15/9/91 DQ.

- 1 rim frag, mortaria, ribbing exterior
- 1 base frag, fine reddish clay, fine reddish glaze, dished moulded base
- 1 rim frag, ledged rim overhanging on inside & slightly on outside, plain ware
- 1 base sherd, plain ware.
- 1 rim sherd, thickened rim,
- 1 handle frag & body sherd frag.
- 1 base frag, dimple base, plain ware
- 1 rim frag, bowl w. incurving rim
- 1 handle section
- 7 handful body sherds.

OBJECT LOT 2 JK DQ 15/9/91 Trench 207/6 Top soil AW

- 4 fragments of a figurine
- 3 from front = left side of head + headdress = face (eyes, nose, mouth, chin) & neck = right side of head, poss. long hair or shawl.
- 1 from back = joins parts, plain, makes up a 3-D figure top, hollow inside.

OBJECT LOT 6 JK DQ Trench 206/2 Feature 1 AW. 16/9/91

- 1 dome shaped bead, flat underside, possibly pearl, & fork jeweller's ring very poor condition, surface layer loose in cotton

OBJECT LOT 5 JK DQ 16/9/91 Trench 206/2 Feature 1 AW

- 1 round metal coin, good condition

OBJECT LOT 4 JK DQ 15/9/91 Trench 206/2 F1 AW

- 1 ~~metal~~ ^{bead} fragment, ~~pass. coin~~, square shape with a hole thru longways.

OBJECT LOT 3 JK DQ 15/9/91 Trench 206/2 F1 AW.

- slightly incurving
- partially transparent
- breaking off & flaking quite badly



OBJECT LOT 1 JK DQ 15/9/91 Trench 206/2 F1.

- 1 dome shaped bead, flat underside, possibly pearl or mother of pearl, for jeweller's ring condition good, surface layer intact, small raised dome nipple at top of dome

POTTERY LOT 10 JK DQ 15/9/91 Trench 206/2 F1 AW

- 17 handful of body fragments.
- 1 body sherd, green slip externally
- 1 " " ^{thin} orange painted decoration ⁱⁿ all over internally & banded broadly externally
- 1 body sherd, plain ware, ~~vertical~~ irregular vertical incisions
- 1 base frag, ring with external band
- 1 " " applied ring
- 1 flat base frag
- 1 " " (?)
- 1 amphora toe
- 1 handle frag, vertical, plain loop attached at top & bottom ~~to~~ body frag, bottom flattened
- 1 handle frag, vertical, plain loop broken, attached at top to rim plain, unarticulated rim
- 1 plain rim frag, sloping, unarticulated
- 1 " " " unarticulated ^{everted}
- 1 rim frag, inverted, slightly ^{symmetrically} thickened ^{with} angularly flattened rim edge
- 1 rim frag, slightly flared, angularly flattened rim edge

POTTERY LOT 19 22/9/91 JK DQ locus 1 s/a corner Trench 206/2

- 8 handful of body sherds.
- 2 rim frags, bowl w. incurving rim
- 1 " " internal overhanging rim
- 1 handle frag, vertical handle
- 1 body sherd, blue glaze int + ext
- 1 rim base sherd, ring base
- 1 rim sherd, plate frag
- 1 " " splayed rim
- 2 " " thickened ext rim
- 1 " " moulded ext. rim

POTTERY LOT 20 Trench 206/2 JK DQ locus 1 ^{22/9/91} AW.

- 4 handful of body sherds
- 2 body sherds, red glaze int + ext,
- 1 rim sherd, red ptd ext + rim zone
- 1 " " plate frag
- 1 handle + body frag, vertical handle
- 1 rim sherd
- 1 " " thickened ext. rim
- 1 " " plate
- 1 " " moulded
- 1 " " outturning rim
- 1 handle + body sherd, plain ware

Pottery Lot 22 Trench 206/2 locus 4 23/9/91 JK DQ AW

- 2 handful of body sherds
- 1 base frag, string out base.
- 1 body sherd, red glaze int + ext

Pottery Lot 23 Trench 206/2 locus 1 JK DQ 23/9/91 AW

- 6 handful body sherds.
- 3 body sherds, red glaze ext + int. (1 w. gouging)
- 1 roof tile frag.
- 1 rim sherd, outturning rim, red glaze int + ext.
- 1 " " bowl incurving rim, red glaze int + ext
- 1 base frag, ring base
- 1 handle frag, oval section
- 5 rim sherds, bowl w. incurving rim
- 2 " " moulded ext. rim
- 1 base sherd, ring base.
- 1 rim sherd, bowl w. outturned rim
- 1 " " outturned rim
- 1 " " plain rim
- 1 " " body sherd, gouging

Pottery Lot 24 JK DQ 23/9/91 Trench 206/2 north bank tidy

- 2 handful of body
- 1 rim sherd
- 1 " " moulded ext. rim

Pottery lot 21 JK DQ 23/9/91 Trench 206/2. Loc 4 AW

- 5 handful of body sherds
- 1 base, unglazed
- 1 rim sherd, bowl w. incurving rim, red glaze int + ext.
- 2 body sherd, red glaze int + ext.
- 1 rim sherd, plate, red glaze int + ext.
- 1 rim sherd, thickened rim, closed vessel
- 1 base sherd, internal gouging, red glazed int + ext
- 1 rim sherd, plate, plain
- 1 " " thickened ext rim
- 1 base sherd, ring base

POTTERY LOT 30 Trench 206/2 Locus 4 25/9/91 DQ

handsful body sherds.

6 rim sherds, shallow bowls, pointed ext rim

1 " " red ptd int + ext, bowl

1 " " plain ware

1 handle frag, oval section, green fabric

~~1 " " " " " "~~

1 base frag, + base

1 rim frag, outturned rim

1 " " shallow bowl, ptd int + ext.

1 " " deep bowl

POTTERY LOT 27 JK OQ 24/9/91 Trench 206/2 from S. bank.

7 handsful body sherds

1 base sherd, ring base, plain ware

1 rim sherd, shallow bowl, incurving rim

1 " " plain rim

1 handle frag, oval section

1 rim sherd, bowl, red ptd

POTTERY LOT 25 24/9/91 Trench 206/2 Locus 1 DQ

2 handsful body sherds

1 rim sherd

1 base sherd, ring base

1 rim sherd, shallow bowl

POTTERY LOT 31 JK OQ 25/9/91 Locus 3b

1 rim & body sherd, plate?

1 base sherd, ring base

1 rim sherd, thickened ext rim, coarseware

4 handsful body sherds

10/20/91	206/3	Locus 11	oven of 2 stones + mudbrick	loc 10
"	"	Locus 12	oven? of 2 stones.	loc 4
		Pottery lot 62		
		Bone lot 47		
		Pottery lot 63		
		Bone lot 48		
		Pottery lot 64		
		Bone lot 49		

7/10/91	206/3	Bone lot 37	Same as PL	PL 51 Locus 3
"	"	Pottery lot 52	from surface of locus 3	Locus 3
"	"	Bone lot 38	" " "	" PL 52
"	"	object lot 40	fibulae frag?	Locus 3
"	"	object lot 41	round bead?	Locus 4
"	"	Locus 6a	east/west wall abutting south wall	
"	"	object lot 42	metal frag.	Locus 4
"	"	object lot 43	basalt frag. w. flat top.	Locus 3
"	"	Pottery lot 53	continuation PL 52 in loc. 3	PL 52
"	"	Bone lot 39	" BL 38 "	"
8/10/91	"	Pottery lot 54	continuation PL 50 in Locus 4	Locus 4
"	"	Bone lot 40	" BL 37 in Locus 4	"
"	"	Pottery lot 55	continuation PL 52 in Locus 3	Locus 3
"	"	Bone lot 41	" BL 38 " " "	"
"	"	object lot 44	metal frag. small	"
"	"	" " 45	glass frag. on rock.	Locus 4
9/10/91	"	Pottery lot 56	continuation PL 55 in Locus 3.	Locus 3
"	"	Bone lot 42	" BL 41 " " "	"
"	"	Pottery lot 57	continuation PL 50 in Locus 4	Locus 4
"	"	Bone lot 43	" BL 37 " " "	"
"	"	Pottery lot 58	Loc. 3 blue mudbrick wall.	Locus 3
"	"	Bone lot 44	" " " " " "	"
"	"	Locus 7.	2 baked mud brick blocks	Locus 3
"	"	Locus 8.	superficial packed earth level, floor?	Locus 4
"	"	Locus 9	N/S wall blue Locus 3 + Locus 4.	
"	"	Locus 10	area blue Locus 9 + Locus 5 against north bank + Locus 65	
"	"	Pottery lot 59	Loc. 3 cleanup blue Locus 7 + west bank.	Locus 3
"	"	Bone lot 45	" " " " " "	Locus 3
"	"	Pottery lot 60	cleanup	Locus 6b
"	"	Pottery lot 61	" + removal of top small stones	Locus 9
"	"	Bone lot 46	" " " " " "	"
"	"	object lot 46	bead with hole	Locus 1

DATE	TRENCH	TYPE & NO	DETAILS	RELATED TO
1/10/91	206/3	object lot 32	shell, complete half.	Locus 4
"	"	" " 33	ring, folded band	"
"	"	" " 34	glass, white frags	"
"	"	Locus 5	2 sides of a large worked flint	-
2/10/91	"	Pottery lot 41	Locus 4 moving west	PL 39
"	"	Bone lot 28	" " " "	BL 26
"	"	Pottery lot 42	Locus 3 moving south	PL 40
"	"	Bone lot 29	" " " "	BL 27
"	"	Object lot 35	2 frags. lamp	Locus 3
"	"	Object lot 36	metal pin w. bent head	Locus 4
5/10/91	206/3	Pottery lot 43	moving west to Locus 5	"
"	"	Pottery lot 44	" south "	"
"	"	Bone lot 29	" " " "	"
"	"	Sample lot 7	charcoal	PL 44 + BL 29
"	"	Object lot 37	worked basalt blob	"
"	"	Bone lot 30	related to PL 43	PL 43
"	"	Pottery lot 45	inside 3 sided pit	Locus 5
"	"	Bone lot 31	" " " "	" PL 45
"	"	Object lot 37	bronze pin with head + frag.	Locus 4
"	"	" " 38	basalt frag, maybe worked	" "
"	"	Sample lot 8	charcoal	Locus 5
6/10/91	"	Pottery lot 46	Locus 3 cleanup wall	Locus 3+
"	"	Bone lot 32	" " " "	"
"	"	Pottery lot 47	Locus 4 moving south	Locus 4 PL 44
"	"	Bone lot 33	" " " "	"
"	"	Pottery lot 48	Locus 3 floor cleanup	Locus 3
"	"	Bone lot 34	" " " "	"
"	"	Pottery lot 49	Locus 3 cleanup east wall	"
"	"	Bone lot 35	" " " "	"
7/10/91	"	Obj lot 39	bead, black	Locus 4
"	"	Pottery lot 50	Locus 4, going down	PL 47
"	"	Bone lot 36	" " " "	"
"	"	Pottery lot 51	cleaning wall S. bank	Locus 6

DATE	TRENCH	TYPE & NO	DETAILS	RELATED TO
25/9/91	206/3	OBJECT LOT 19	stopper?	Locus 1
"	"	" " 20	stone handle?	Locus 1
"	206/2	" " 21	tlc square w. hole	Locus 3b
"	"	" " 22	shell fragment	"
"	"	" " 23	tlc figurine fragment	Locus 4
26/9/91	"	POTTERY LOT 32	from NE of locus (under floor?)	Locus 4
"	"	BONE LOT 20	" " " "	"
"	206/3	POTTERY LOT 33	to soil	Locus 1
"	"	BONE LOT 21	"	"
"	206/2	POTTERY LOT 34	from inside + top of round thing	Locus 3b
"	"	BONE LOT 22	" " " "	"
"	206/3	OBJECT 24	maybe just a river pebble	Locus 1
"	"	OBJECT LOT 25	small folded bronze ring - basal	Locus 1
28/9/91	206/3	POTTERY LOT 35	from soil	Locus 1
"	"	BONE LOT 23	" " " "	"
29/9/91	206/3	POTTERY LOT 35	" " " "	Locus 1
"	"	BONE LOT 24	from Locus 2.	Locus 2
"	"	Locus 2	stones from top layer	"
"	"	OBJECT LOT 26	2 small frags white glass	Locus 2
"	"	LOCUS 3	soil below Locus 2.	"
29/9/91	"	POTTERY LOT 36	" " " "	"
30/9/91	"	BONE LOT 25	" " " "	PL 37
"	"	POTTERY LOT 37	" " " "	PL 36 + BL 25
"	"	OBJECT LOT 27	glass frags, incl. rim frag.	Locus 3
"	"	OBJECT LOT 28	" frag. white	Locus 4
"	"	" " 29	small lump basalt, loam weight?	Locus 3
"	"	POTTERY LOT 38	" " " "	"
1/10/91	"	POTTERY LOT 39	from Locus 4.	Locus 4
"	"	BONE LOT 26	" " " "	"
"	"	POTTERY LOT 40	from Locus 3	Locus 3
"	"	BONE LOT 27	" " " "	"
"	"	OBJECT LOT 30	figurine fragment	Locus 4
"	"	" " 31	curved/hooked metal frag	"

DATE	TRENCH	TYPE + NO.	DETAILS	RELATED TO
22/9/91	206/2	POTTERY LOT 20	North sector west of wall	Locus 1
"	"	Pottery lot 21	North east corner east of wall	"
"	"	OBJECT LOT 12	figurine	Locus 5
"	"	LOCUS 5	small round earth depression	OBJECT 12
"	"	B	in floor	"
"	"	BONE LOT 12	in last 5" of soil above floor	Locus 1
23/9/91	"	POTTERY LOT 22	from NW/S wall + east bank	Locus 4
"	"	POTTERY LOT 23	in last 5" of soil above floor	Locus 1
"	"		in NW corner	"
"	"	BONE LOT 13	from same area as PL 23	Pottery lot 23
"	"	POTTERY LOT 24	North bank tidying up.	Bone lot 14
"	"	BONE LOT 14	" " " "	Pottery lot 24 near
"	"	OBJECT LOT 13	square metal frag. coin?	Locus 5
"	"	" " 14	shell frag?	Locus 1
"	"	" " 15	fragments (bigger)	"
24/9/91	"	POTTERY LOT 25	for cleaning of walls locus 1	"
"	"	" " 26	for clearing to floor locus 4	Locus 4
"	"	BONE LOT 15	" " " " " "	PL 26
"	"	POTTERY LOT 27	from south bank	BL 16
"	"	BONE LOT 16	" " " "	PL 27
"	"	OBJECT LOT 16	small bone pin	BL 16 + PL 27
25/9/91	"	" " 17	2 metal frags = 1 nail	Locus 4
"	"	POTTERY LOT 28	from NE of locus 4	BL 17
"	"	BONE LOT 17	" " " " " "	PL 28
"	"	SAMPLE LOT 13	Charcoal	Locus 4
"	206/3	POTTERY LOT 29	Topsoil, new trench	Locus 1
"	"	BONE LOT 18	" " " " " "	PL 29
"	206/2	POTTERY LOT 30	from NE of Locus 4	PL 28
"	206/3	OBJECT LOT 18	metal pin in top soil	Locus 1
"	206/2	POTTERY LOT 31	from top of Locus 3b	BL 19 Locus 3b
"	206/2	BONE LOT 19	" " " " " "	PL 31
"	206/3	LOCUS 1	top soil	"

Locus 3 written down twice
 so. Locus 3 16/9/91 = 3a
 Locus 3b 21/9/91 = 3b

DATE	TRENCH	TYPE + NO.	DETAILS	RELATED TO
15/9/91	207/5	DRAWING 1	drawing of trench to date	"
15/9/91	New trench	OBJECT LOT 2	4 pieces probably from same figurine	"
"	"	"	head, face + neck	"
15/9/91	206/2	OBJECT LOT 3	mother of pearl & glass	POTTERY LOT 10 BONE LOT 7.
15/9/91	206/2	SAMPLE LOT 1	charcoal? (+ 1 piece pottery burnt)	"
15/9/91	206/2	OBJECT LOT 4	small fragment metal	Sample lot 1
16/9/91	206/2	POTTERY LOT 12	Continuing on from Pottery lot 10	POTTERY LOT 10
16/9/91	"	BONE LOT 9	" " " Bone lot 7	POTTERY LOT 12
16/9/91	"	SAMPLE LOT 2	charcoal	SAMPLE LOT 1
16/9/91	"	OBJECT LOT 5	coin, bead	SAMPLE LOT 2 POTTERY LOT 12 etc.
"	"	" " 6	bead, doneshaped	"
"	"	LOCUS 5 FEATURE 3a	floor level, see corner.	"
17/9/91	206/2	POTTERY LOT 13	from F1.	"
18/9/91	"	POTTERY LOT 14	from F1 north quarter rubble.	"
18/9/91	"	OBJECT LOT 7	2 pieces of iron	object lot 5 object lot 6
"	"	OBJECT LOT 8	1 piece bronze	obj. lot 7
"	"	OBJECT LOT 9	1 piece black glass	"
"	"	BONE LOT 10	from same area as PL 14	PL 14
"	"	SAMPLE LOT 3	charcoal	"
19/9/91	206/2	POTTERY LOT 15	east-west cleanup from wall + up to north-south wall	PL 14
"	"	BONE LOT 11	" " " "	PL 15
"	"	SAMPLE LOT 4	charcoal	"
21/9/91	"	POTTERY LOT 16	from locus 1	PL 25
"	"	LOCUS 3b	Rounded stone structure abutting loc 2	"
"	"	OBJECT LOT 10	rim frag. black glass + 2 frags.	Locus 3
"	"	OBJECT LOT 11	round bead from top of loc 2 Locus 2	Locus 2
"	"	POTTERY OBJECT LOT 17	From inside Locus 3	Locus 3
"	"	BONE LOT 11	from locus 1	"
"	"	SAMPLE LOT 5	charcoal from Locus 1	"
"	"	LOCUS 4	area east of north-south wall	"
"	"	POTTERY LOT 18	pottery from Locus 4	Locus 4
22/9/91	"	POTTERY LOT 19	from SW corner	Locus 1

DATE	TRENCH	FEATURE	BAG TYPE
10/9/91	207/7	Top soil in front of baulk A + blow stones	POTTERY LOT 1
10/9/91	207/7	" " " "	BONES LOT 1
"	"	" " " "	BONE LOT 2
"	207/7	" " " "	STONE LOT 1
"	206/2	Top soil all over in Feature 1	✓ POTTERY LOT 2
"	206/2	Top soil all over trench 206/2	✓ POTTERY LOT 1
11/9/91	206/2	" " " "	✓ POTTERY LOT 3
12/9/91	206/2	Top soil from about 2-3 inches down - Feature 1, of F2. North-west	✓ POTTERY LOT 4
11/9/91	206/2	Soil taken	
		Possible corner of 2 walls in south east corner - NS wall	FEATURE 2
12/9/91	206/2	Pottery taken out of F2	POTTERY LOT 5
14/9/91	206/2	Pottery taken out of F1 middle west to east	✓ POTTERY LOT 6
14/9/91	206/2	Bone related to pottery lot 6	BONE LOT 3
14/9/91	207/5	Pottery from soil under top timber sw corner	POTTERY LOT 7
14/9/91	207/5	Bone related to pottery lot 7	BONE LOT 4
"	179/7	Bones in Radis baulk	✓ BONE LOT 5
"	"	Pottery " " " "	POTTERY LOT 8
15/9/91	207/5	Pottery from Peter's floor to north south of basin, incl. walls.	✓ POTTERY LOT 9
"	"	Bones related to pottery lot 9.	BONE LOT 6
"	206/2	Pottery from below stone timber in south west quarter	✓ POTTERY LOT 10
"	"	Bone lot related to pottery lot 10	BONE LOT 7
"	(New trench)	Pottery lot from new trench to north of 207/5, top soil	POTTERY LOT 11
"	"	Bones related to pottery lot 11	BONE LOT 8
"	206/2	Small round (metal?) object flat base	✓ OBJECT LOT 1

Harris matrix
schematic section

- Locus 1 = top soil
 2 = stones from top layer
 3 = soil level below 2 + top area
 below west baulk + south wall
 5 = worked block/well head?
 6a = east/west wall abutting baulk
 wall in front of loc 5 - east/west
 4 = area bounded by north baulk
 south baulk + up to loc 5.
 7 = 2 mudbricks
 8 = floor in loc 4
 6b = wall in front of ~~east~~ baulk
 running east/west.
 9 = n/s running wall
 on edge of loc 4.
 10 = area bounded by loc 6a
 n baulk, loc 5 + loc 9
 11 = oven.
 12 = oven?

13 lines W(2)?

14.10.91

medium wt c/w body sherds

1 amphora base

3 profile rim frags

1 rim c/w mortarium

1 rim frag semi coarse mortarium red paint

4 base frags c/w bowls/jars

1 handle frag

1 base frag by bowl

2 rim frags looking wax

1 rim frag flaring rim bowl

A E/D 28

↑

14 October 1991

206/3 (Z) or [Z]

11.15 am. Earlier I had investigated the wall at E of area Z (see previous sketch) and decided the too random set of stones could not be the stone W face of the Wall C. I removed some stones and found much soil beneath. Since 9.30 work has continued here removing the loosened stones and the soil (call it locus 2). At this time, the wall clearly shows at a level scarcely above the floor level of area Z and is therefore consonant with the level of wall C1.

Further, there is a great deal of soil above that level so more stones are removed and the soil later. The presence of the soil indicates that this wall is not a wall.

The lower level assumed of wall C indicates further that what we have of wall C1 is the genuine preserved height and that no wall blocks were removed. Work continues.

flat base

Tuesday 15 October 1991
Weather: clear, fine, slight breeze
Workers: 6 as usual

206/3A [10]

Red stratum E of boundary wall.
I find it difficult to sort out the various loci and
therefore designate the red locus 10 = 47

206/3A W(2)
This is the locus W of the insula boundary wall.

In this area a white powdered limestone stratum is
appearing. We scrape away the black soil Road.

7:15 am. I remove the rubble from within the rock-cut
basin 48

At the S end of 206/3A W(2) we are encountering a
hard deposit: small chips of stone, small (tiny) pieces of
pottery. Over it is a gray hard mud deposit and a reddish
brown clay with flecks of limestone. I don't think we
have yet found the friable floor at the S therefore we
continue; but first clearing the top of the wall and the wall-
stone so far cleared Road

206/3A [10] see further page

15.10.91

206/3A W (2)

small cut c/w body sherds

3 base frags

4 handle frags

3 profile rims

rim frags, echinus etc

15.10.91

206/3A

10

large lot c/w body sherds + tanour frags

2 handle frags

3 profile rims

1 rim frag flaring rim bowl

1 base frag firm plate

15.10.91

206/3A

10

many very large frags of coarse ware amphora

+ frags of a heavy clay filter

frags have pink tinge inside

frags of tanour

4 base frags c/w bowls

1 rim frag fine rg bowl

* placed in two bags

15 October 1991

206/3 etc.

206/2

The doorway in the N's wall at W of trench seems to be 90cm wide; the N doorjamb, which rested on two flatish stones is tilted slightly to the S; the S doorjamb is taller than the N and is in a good vertical position. Approx. 85 cm of the S doorjamb is showing above the floor level.

The doorway is filled with two blocks

38 x 22 x 22 nicely cut. They must have been part of the doorjamb resting on the two more or less the higher. Beneath these two well-cut blocks is a depth of soil. c. 37cm. Therefore this doorway was not blocked by a secondary or later occupation. The soil can be seen also on the E side: outside the main room. ~~is doorway itself a secondary structure?~~ Or just not debris. blocked? yes.

A small cut at the NE of 206/2 shows that the NS wall was built on bedrock. ∴

This wall continues N into 206/3, though we had problems defining it. Here the top of the wall appears preserved to a lower level, though at its first appearance at the S of the trench it maintains the height observed in 206/2. The top stone, which is quite large, does however seem to be tilted to the N.

It would be interesting to excavate the E end of area 2 and the tranche between 206/3 and the trench to the E (KB 1990). The ^{EW} wall in that trench continues the wall of 207/5^E; but this wall does not appear in 206/3 unless it has been mistakenly removed. I am sure however that great care was taken the S end of the E sector of 206/3

15 October 1991

206/3

Since we expected a wall. Further, there was nothing showing, nor is there now, the whole depth of the cut. There is no sign of wall, or even tangle, in the E bank of 206/3 at this point. Further again, the wall C (of my previous sketch/diagram) is clean cut at the S end. There has been no wall meeting it from the E.

15 October 1991

206/3A [10]

The red stratum [10] has yielded a great deal of pottery incl. very large fragments of coarse ware amphora. Towards the bottom of the red stratum appears a tangle in the corner of the two walls A + B.

This explains both the pottery and the layer of gray ash that lies beneath the red foil.

10.45 we are cleaning the rest of the red foil + then cleaning the tangle.

11.10

11.10 am. There is a gray deposit beneath the red - beneath the foil. We are finishing the red.

Wednesday 16 October 1991

Weather: very cool, cold breeze from NW breeze all round; we can see barely past the river E. perhaps fog.

The haze remained all day.

Workers: 6 as usual

206/3 A.

Wall cleaning continues on NS at the W: the insula boundary wall

206/3 A. [10]

There is still a little red soil at the S of the bank. This is to be removed first, and then commence on the gray from the S to the N where the tank is located.

6.50 am. we commence on the gray ash stratum = [11]

On conclusion of this we remove the red soil stratum = [12] and clean out the tank a little

The diameter of the tank is 0.57 m

its skin is four layers thick: a number of fragments of the layers was found inside the tank, and but a few coarse ware body fragments

11.20 clean a bit more.

11.45 am. we are well into stratum [13] which is very gritty with big tiny pebbles and tiny bags of pottery. This is the stratum just to the S of the tank. - sounds like fill

it seems to be about 9 cm deep.

Φ of newly cleaned rock-cut basin ^{trough} and R 16 + BTW
12 noon Φ of tank Roll C 16 → 17 also BTW from E, SE + S
Showing relation to rock-cut basin.

the gritty deposit is a soft version of the deposit of the street
exp at N of 206/3A W

NOTE

When the wall N of the tanour is cleaned, there is a trace of gray
discoloration on the stones, and obviously, now, the tanour was
built in relation to the N wall.

This could demolish the arguments about the later construction of the
E-W wall which separates the tanour from the rock cut basin

But note that this floor level is much higher than the floor
level of 206/2

At the W of the room with the tanour there does not seem to
be a wall.

Thursday October 17 1971

206/3A

Work continues on a little soil of deposit (13). We also
proceed with general cleaning for final photography

Element (13) is the floor found in 206/3.

We have the sides of the tanour above ground quite nicely

To get this room clear (or rooms) clear the tanks should
be removed to see if there is a wall to the S of 206/3.
Recall that it does not appear at the S of 206/3A.

In the inside boundary wall there is a gap between two
stones of the outer face and also (in the present state of the
cleaning which I hope represents things as they are / should be)
there is a hole through to the room inside. Inside the hole there
is a very soft powdery, damp, light brown soil which seems
to suggest that there was a hole in the wall here in which this
light brown powdery soil could lodge. = Doorway exc 1996

This hole might also explain an observation I made
previously. That there was a gritty deposit inside the wall very
similar to the gritty material (now hard packed) of the street
outside the wall. The gritty material could have entered the
room via the hole in the wall.

Φ 8.15 +

Roll 16C → end

Roll 17C → 8

↳ B+W → end