

Akropolis T13:1990 : T15:1990

T21 199:
(room 21, NE end.)



A4 NOTE BOOK

No. 595

G.W.C.



9 312828 005954

Arb. 2
o Coins: p. 11, 13, 15, 21, 37, 39, 41, 43,
47, 48, 56, 63, 65,
o also missing: 40, 44, 53 (Arb. ix)
o Plaster analysis p. 19

p. 17 small door

The first part of the paper is devoted to a discussion of the general principles of the theory of the structure of the atom. It is shown that the structure of the atom is determined by the laws of quantum mechanics, and that the energy levels of the atom are given by the solutions of the Schrödinger equation.

In the second part of the paper, the structure of the atom is discussed in more detail. It is shown that the structure of the atom is determined by the laws of quantum mechanics, and that the energy levels of the atom are given by the solutions of the Schrödinger equation.

The third part of the paper is devoted to a discussion of the general principles of the theory of the structure of the atom. It is shown that the structure of the atom is determined by the laws of quantum mechanics, and that the energy levels of the atom are given by the solutions of the Schrödinger equation.

In the fourth part of the paper, the structure of the atom is discussed in more detail. It is shown that the structure of the atom is determined by the laws of quantum mechanics, and that the energy levels of the atom are given by the solutions of the Schrödinger equation.

The fifth part of the paper is devoted to a discussion of the general principles of the theory of the structure of the atom. It is shown that the structure of the atom is determined by the laws of quantum mechanics, and that the energy levels of the atom are given by the solutions of the Schrödinger equation.

In the sixth part of the paper, the structure of the atom is discussed in more detail. It is shown that the structure of the atom is determined by the laws of quantum mechanics, and that the energy levels of the atom are given by the solutions of the Schrödinger equation.

The seventh part of the paper is devoted to a discussion of the general principles of the theory of the structure of the atom. It is shown that the structure of the atom is determined by the laws of quantum mechanics, and that the energy levels of the atom are given by the solutions of the Schrödinger equation.

In the eighth part of the paper, the structure of the atom is discussed in more detail. It is shown that the structure of the atom is determined by the laws of quantum mechanics, and that the energy levels of the atom are given by the solutions of the Schrödinger equation.

The ninth part of the paper is devoted to a discussion of the general principles of the theory of the structure of the atom. It is shown that the structure of the atom is determined by the laws of quantum mechanics, and that the energy levels of the atom are given by the solutions of the Schrödinger equation.

In the tenth part of the paper, the structure of the atom is discussed in more detail. It is shown that the structure of the atom is determined by the laws of quantum mechanics, and that the energy levels of the atom are given by the solutions of the Schrödinger equation.

AK. T13 24.4.90 Δ ③

- coarse ware body sherds (small bag)
- plus 1 grey ware rim, out-flaring
- 2 coarse ware rims, small open plates joining

Δ ①



Δ ②

AK. T1 + T9 Floor Clearance 22.4.90

- 2 shaped? stoppers
- 1 coarse ware handle (very coarse)
- 3 small rim frags., weak black, weak brown paint
- otherwise small collection of body sherds.

AK T13 23.4.90 Δ ① surface pottery

- a few coarse ware frags, body sherds
- 1 coarse ware base 'fish plate' circle
- 1? Islamic sherd



Δ ③

AK T13 28.4.90 Δ ⑩

- largish collection of coarse ware body frags.
- 1 amphorikos toe, coarse ware
- 1 body frag, grooved, brown paint, body frag.
- 1 flaring rim, weak red, groove on lip, smallish dish
- 1 plate frag, chocolate red glaze
- 1 weak brown echeirus rim
- 1 large rim, pie crust end of wavy lines incised on neck in bands.

Δ ② (4) (5) (6) plaster

AK T13. 26.4.90 Δ ⑩

- large collection of body sherds
- 1 coarse ware fish plate base
- 1 outturned footed bowl with ancient mend hole, weak red glaze wood sample
- 1 base frag. stronger red glaze, fine fabric (pinkish)
- 1 coarse ware bowl base, no foot, large vessel
- 2 very coarse ware rims
- 1 rim frag. black glaze, thick fabric, glossy glaze
- 4 echeirus bowl rims, 1 brown glaze
- 1 weak brown paint, rim frag., dish
- 1 rim frag, coarse ware, double rim

block T13. \square

Δ ⑦

Akropolis T.13 23/4/90

Started clearing a trench 5.0 m. deep (N.S. direction) but ~~4.0~~ ^{6.4} metres (approx) in the EW direction. This odd size was to keep the trench square with the others, while removing boulders as they tell us little information. The surface soil is being removed, light brown + very friable with broken stones but nothing apparently in situ. On the surface few cm. there is very little pottery but it does include an Islamic fragment with 'fern' decoration. White plaster is coming up in the NW corner, in very broken pieces just a few cm. below the surface. Otherwise it is clearing between the surface stones, many of which were once worked but are now beyond recall. At the moment I can't even detect the line of the wall between the 'megaron' and the long room ('promenade room')

24/4/90

Continued clearing around + lifting surface crushed stones. Some architectural pieces of ashlar masonry are appearing, but most are pretty smashed about. Some white plaster is emerging in the area where I suspect the division-wall with the 'promenade room' continues - that is, in the SE section of the trench. There is virtually no pottery at this stage. There is also white plaster coming up as yesterday in the NW corner of the trench. We have fewer workmen but there is a long way to go before any definition will become clear. It would appear that the trench is completely filled with tumble but plaster continues to come up in several areas + it looks as if we have the EW wall in parts right on the surface. I'll call the pottery from the entire trench - still tumble locus Δ bag ③; the plaster can be Δ ④, ⑤ and ⑥. One ashlar block measured 43cm x 31cm x 22cm. Otherwise it is stones so broken as to reveal little masonry definition. A patch of wood sample came up + was bagged as ⑦ Δ . A break of 3 days follow as Eid for Ramadan conclusion.

28/4/90

Very dusty + windy, with an horde of workers. Fragments of ashlar blocks are emerging but they are too fragmentary to be helpful + I'm rejecting them. One was 63cm long between worked faces, otherwise too battered for

AK T13 30/4/90 [3] (20)

Collection of coarse ware body sherds, including some large amphora pieces

- 1 amphora toe with pitch inside
- 1 body sherd, coarse ware, with handle base
- 2 joining rim frags?, coarse ware, double anterior rim
- 1 rim frag. $\left. \right\}$, pinkish coarse ware, large open neck.
- 1 base frag. coarse ware footed vessel.
- 1 rim frag. pie crust edge with incised bands of wavy lines $\triangle 2$ \oplus $\oplus 9$ plaster
(cf. earlier bags) $\triangle 2$ $\oplus 10$ pottery
- 1 rim frag, fine ware, open bowl, red glaze $\left. \right\}$ $\oplus 11$ wood
- 1 plate frag, very fine red glaze $\oplus 12$ charcoal
- 1 round base bowl frag., red glaze + further frag. $\triangle 2$ $\oplus 40$ figurine frag.
- 1 base frag., footed red glaze vessel

AK T13 30/4/90 [3] (22)

Smallish collection of body sherds

- 1 piece pie crust rim frag., coarse ware - cf. previous bags.
- 1 rounded base? frag., coarse ware + body frag. towards neck
- 1 " " frag., small vessel, coarse ware $\triangle 2$ $\oplus 13$ basalt
- 1 footed base, coarse ware
- 2 frags? very coarse ware - not tile but vessel?

AK T13 30/4/90 [3] (19)

1 very large foot of very coarse ware storage vessel plus associated frags.

AK T13 1/5/90 [5] (36)

Small collection coarse ware sherds

- 1 base frag. coarse ware; 1 rim frag. coarse ware, weak black paint, open bowl $\triangle 2$ $\oplus 14$ + $\oplus 15$ plaster
- 1 rim frag. shallow bowl, coarse ware $\oplus 16$ pottery
- $\oplus 17$ nail.

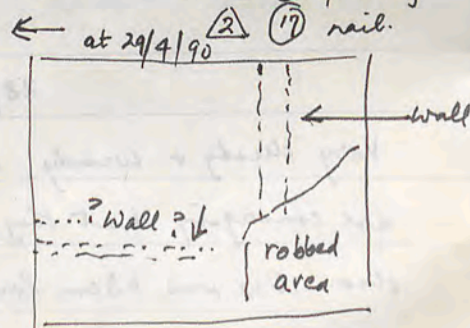

AK T13 1/5/90 [4] (34)

Not large collection coarse ware frags.

- 2 large open vessel rim frags., coarse ware, double open rim
- 1 body frag, with incised wavy lines 1 strap handle frag.
- 2 echinus bowl rim, weak black + red paint, joining frags

dimensions. Some plaster and pottery - but not very much - is also coming up. Another stone is 330 in length, but no other useful sides are surviving. I doubt whether we'll get any useful definition. It looks as if we'll still be within the one room in this trench. Some mortar on which the building blocks was bedded has also come up, visibly shaped where it squeezed between blocks. Otherwise there's a long way to go down. The pottery is so thin that I'll call it call the same locus, though it is coming from different levels down, according to the fall of building stones. The wind + dust are pretty impossible + we have to call a halt until it drops a little. $\triangle 2$ $\oplus 8$ + $\oplus 9$ will be plaster $\triangle 2$ $\oplus 10$ pottery, with a bag of wood sample as $\triangle 2$ $\oplus 11$ + charcoal as $\triangle 2$ $\oplus 12$. $\triangle 2$ $\oplus 13$ is a small glass blob come up in the NE corner. A figurine frag. found in bag $\oplus 10$ becomes $\triangle 2$ $\oplus 40$.

29/4/90

Cold + windy morning + lots of dust: a great deal of broken + crumbled stone but little further clear lines. Plenty of plaster, but white only from all over the trench. From the robber pit it is clear that we have one level only with a great deal of tumble over wind-blown soil on the floor before the building collapsed. A couple of pieces of worked basalt I'll make $\triangle 2$ $\oplus 13$. A stone with pitted worked surface has come up but still too shattered about as to provide useful measurements.

In the centre of the trench a shattered stone 30cm deep, 56cm wide 60cm long will need to be removed: it is too shattered + battered to shift in one piece. The length does not seem complete but the width seems complete. Another very shattered piece is 73cm long, 60cm wide + 39cm deep - no dimensions appearing complete. It too is being broken up for removal. Another in the NW sector of the trench is 70cm long, 50 wide, 30cm deep: we'll have to remove it eventually but in case it is standing on a wall we're leaving it pro temp.. Plaster will be $\triangle 2$ $\oplus 14$ and $\oplus 15$ and pottery $\triangle 2$ $\oplus 16$. A nail comes up as the first object of the day, $\triangle 2$ $\oplus 17$

AK T13 1.5.90 [4] (31)

- 5 small collection body sherds
- 2 echinus, coarse ware, rims, 1 large
- 1 open flaring bowl, rim frag. tile frag.
- 1 frag (? lamp) weak red paint

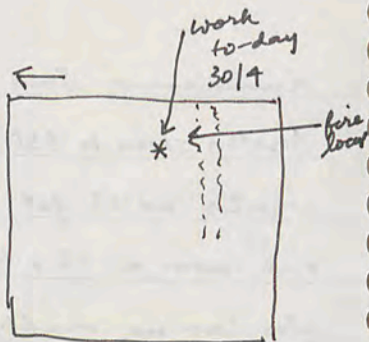

AK T13 [4] (35) 1.5.90

- Largish collection body frags.
- 1 amphora rim and base of handle
- 1 pie crust rim frag., bands of wavy lines (3) on neck, large vessel, coarse ware + body frag. of same.
- 1 coarse ware rim frag. - s¹ incised dashes, out-turned.
- 1 red glaze thickish ware bowl frag.
- 1 base frag., footed, drip red paint
- 1 large open mouth coarse ware rim
- 1 coarse ware rim, incurved

(3) (18) nail

(3) (19) storage vessel.

(3) (20) pottery

(3) (21) clamping? iron

(3) (22) pottery

(3) (23) basalt.

(3) (24) plaster

AK T13 [4] (39) 2.5.90

- Large collection of coarse ware body sherds
- 2 rim frags., pie crust with bands of incised wavy lines
- 1 amphora toe, inside pitch inside
- 1 base frag. coarse ware fish plate
- 1 body frag. grey ware
- 2 footed base frags., coarse ware.
- 1 coarse ware echinus rim
- 1 weak black body frag.
- 1 coarse ware rim frag. double rim

T13 30/4/90

Continuing to go down the trench: largely empty at this stage but we should soon hit the fallen roofing & then it'll be slow going. Haja Mauna continues to dig a large hole but it is clearly all of one locus. I'll call this level to-day - still heavily of crushed limestone + crumbled + decayed rock - mixed with light greyish soil / brownish dust - as locus (3) (18)

(3) (18) is a nail come up in the central E sector. The soil in sections is now becoming darkish brown: this appears to be the wind-blown light soil that filled the room before the stones collapsed on top. A small amount of bone, plaster + pottery, but not in great quantities, as well as charcoal. We are working largely in the SE corner, near the cross wall - itself very crumbled but distinct. Soon we'll have to have a chain gang to get out the gambel. The mammary toe of a large storage vessel has come up with some of the body, bagged separately as (3) (19): some parts may be in the other pottery bag (3) (20). A further nail has been bagged with (3) (18). A clamping(?) piece of metal has come up next to the cross wall, east end, bagged as (3) (21). A small fired area has emerged in the east end of the wall - apparently fired after the building was collapsed: nothing more significant, I'd say, than a shepherd's fireplace. More pottery is coming up as we go down lower, but little that appears significant: a second bag largely from the mid N of the trench will be (3) (22). The soil is noticeably browner + softer as we get closer to the floor. But we have a good way to go. A large piece of basalt has come up with a flat grinding surface = (3) (23) basalt. (3) (24) will be more (white only) plaster. We've begun to hit the floor unexpectedly. It's clear we're in another room, I'd say, from the megaron.

AK T13 [5] (39)

Small collection of body sherds

- 1 lamp nozzle, weak red paint
- 1 echinus bowl rim, weak red + black
- 3 coarse ware reins.

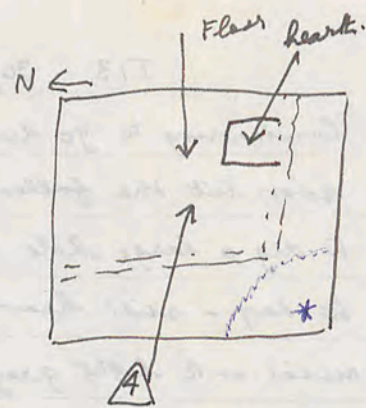

AK T13 [5] (45) 5/5/90

Collection of large + some v. coarse body sherds

- 2 v. large vessels, v. coarse ware reins, large frags., both out-turned
- 1 large frag. rim, coarse ware, light coloured ware, narrowish neck + 2 joining frags
- 1 coarse ware rim, shallow dish or plate
- 3 coarse ware, small footed bases, 1 with weak brown paint.
- 1 lamp frag.

4 (25) clamp

4 (26) nails

4 (27) metal

4 (28) glass

4 (29) wheel

4 (30) figurine

4 (31) pottery

4 (32) weight

4 (33) plaster

4 (34) pottery

4 (35) pottery

[5] (36) pottery

AK T13 6/5/90 [5] (46)

Not a large collection of body sherds

- 1 amphora toe
- 1 large coarse ware rim
- 1 flat plate or dish rim, ^{outer} inner groove, weak brown paint
- 1 body frag. red drip ware, bowl shape
- 1 weak black rim outturned, small vessel
- 1 ? ungentarium body frag. near foot, reddish fabric
- 6 frags. from bases, 5 prob. from same coarse greenish coarse ware
- 1 weak brown echinus rim, small vessel
- 1 metallic grey ? base fragment

AK T13 7/5/90 [5] (48)

Tiny bag includes body frag with weak brown paint inside, another with weak black + brown paint, a fluid reddish fabric. Nothing interesting.

1 May, 1990: T13

We are hitting a hard beaten clay floor in the Eastern sector of the trench + we're clearing along it. I'll call this locus 4. It is very noticeable that the floor has darker brown earth mixed with a little ashy coloured soil on it. We're also clearing at locus 2 level on the western side. At the floor level some charcoal + bone are emerging. A small metal clamp is 4 (25) and nails is 4 (26). Despite the light ashy soil there is no real sign of burning or the nails imply roofing timbers removed. A piece of decayed metal is 4 (27). It is becoming clear that we have where I thought was a shepherd's fire a shaped stone used as a hearth up against the plastered wall (white!): can it have been original? Can the room have been roofed? (Not much in the way of roof-tiles but enough nails). Glass piece becomes 4 (28) - dark glass. There is an unusual amount of charcoal + wood frags as we clear the floor. A stone spindle wheel becomes 4 (29) + a figurine frag. is 4 (30). A large fragment of storage pot with wavy lines (such as came up recently) has been bagged separately as 4 (31) - it was sitting on the floor. 4 (32) loom weight of clay. Little more definition is coming out - just a beaten earth floor and a hearth with apparently domestic objects. A zamboul of white plaster coming up in the vicinity of the west ? wall suggests it too is going to have been plastered. 4 (33) Certainly the amount of charcoal pieces is very large. Two pottery bags will be 4 (34) + (35). We're also clearing in the S.W. robbed area which being a different disturbed area I'm giving a new locus as [5] and the first lot of pottery as [5] (36). The hearth stone is 43 long, 37 wide, 13 high + was plastered with dark grey mud: there are layers of mud cover behind the fireplace against the wall. The floor is an extremely hard packed mud.

Bagged as T13 unidentified bag
 of coarse ware body frags (v. coarse), along with
 3 frags of pie crust rim + neck frags. of parallel lines
 between which is a wave pattern 

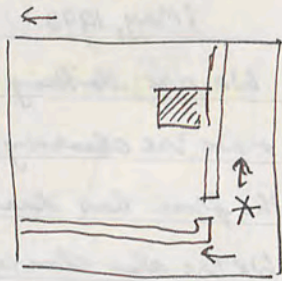

nail [5] (37)

plaster [5] (38)

[5] (39) Coin

NOTE THIS PAGE IS ONE DAY OUT OF ORDER.

3/5/90 T13

Clearing in locus [5] to-day through the doorway and along the S and W
 baulks. It'll be slow going. A little red plaster is coming up on the floor
 level in the doorway on the very fine threshold block. A nail from this
 area becomes [5] (37). I doubt whether we'll complete the trench to-day but
 even so we shouldn't get much new information. A stone 104cm x 24^{cm} x 15cm.
 has been lowered into the megaron: it is fairly broken about sitting on the surface
 soil. There is a great deal of decayed stone jammed between baulks and the walls.
 The threshold stone is beautifully smooth + plastered, apparently.
 Another stone 104cm x 24 x 15cm. also has been lowered into the megaron also
 There is some very scattered pieces of plaster coming up in the Western baulk ^{megaron}
 black-raised with white surround, Pompeian red etc.; these will be bagged as
 [5] (38). Little in the way of pottery to-day as other small finds. And by way
 of contrast with inside the hearth-room almost no charcoal + bone. A coin was
 found as we swept up around the doorway: it is an area that has been
 disturbed by robbing so it may not belong to the floor deposit: bagged
 as [5] (39)*

* unrecorded? maybe 90.119 T.13.5 Islamic

T13 2.5.90

Continued work in T13 at locus [4] against the Western wall, clearing to the floor.

59cm x 27 x 55cm stone removed from sitting on surface deposit on S wall in which a doorway appears to be emerging.

A nail from the floor becomes [4] (37). A coin from the deposit in the NW corner against the wall in the fill has come up, apparently imperial Roman, bagged as [4] (38); it was not on the floor deposit.

A broken bronze ring from the floor is [4] (39). 90.203 Demet.ii (145-140).

We're clearing the doorway in the S. wall which should go through into the promenade room: a clear threshold stone has emerged. An

Abbasid 90.192 arabic coin has come from the surface fill over this doorway as [4] (40) and a very fine glass rim fragment with double incised lines as [4] (41) off the floor Area [5] is over the dooring. A second nail has been also bagged with [4] (37). And now a solid coin right on the threshold at level [4] (38), on the floor stratum = 90.127 Const.ii (355-361).

20cm x 20cm x 11cm. incomplete block has had to be broken up to clear on W. side of wall. Area [5]

A bag of plaster has been taken - clearly the West wall was plastered on its east face at least. [4] (38)

A particularly large bag of wood sample + charcoal from the floor to-day. Pottery from the floor [4] (39)

We'll clear to the S of the EW wall + to the W of the NS wall to-morrow [4] (40) is a figurine frag. of 28.4.90 found in bag (10)

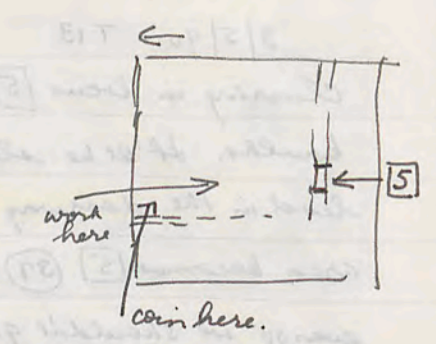

simulated 2.5.90 p11.09 adj part ?

AK T13 5/5/90

Continuing to clear in area [5] between the S+W baulks + the wall. The area in the S end is very disturbed + crumbly as the result of robbing and it will be hard to find an appropriate floor level. Some small pieces of coloured plaster are coming up in the robber fill. A

* coin has come up from floor level, near the continuation of the threshold of the big room bagged as [5] (40). A metal slug (? artifactual) came from the same floor area as [5] (41). Marbled (red/black/white/blue etc.) Pompeian-masonry-style wall painting is coming up in the western side of the N-S wall near the threshold. Very stuck with mud and broken into small pieces. I'll give this the new locus number of [6]. It is floating in the soil deposit at all levels - clearly having flaked off in intervals over time. The area [5] has been very disturbed by stone robbers and some of the stone threshold has gone. A small piece of what appears to be cornice moulding has come up in the robber fill of [6]: lightly incised  but generally we have very broken-up rubble. What the wall in [5] behind the hearth is well formed the material against it (between it + the baulk) seems fairly disturbed + full of crushed rubble. 5 nails have come up in the extreme SW corner of the trench: they are bagged as [5] (44) along with a further 1 in NW corner

* prob. = 90.096 (T13.5) City of Antioch 92-72

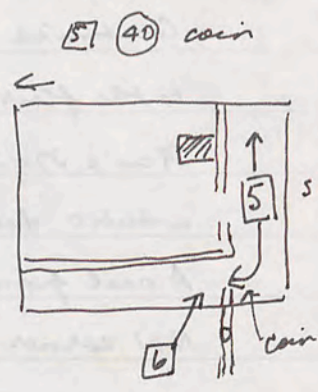

[5] (41) metal

[6] 42 + 43 plaster

[5] (44) nails

[5] (45) pottery

AK T13 6/5/90

Hope this may be the last day on this trench. We're clearing to floor level in areas [5] and [6]. It is largely rubble. The floor level in the big room (megaron) is clearly just below the first step and was not clear during excavation. That explains the megaron threshold adequately. We've had to remove 3 large surface stones in [6], one appearing to be a very battered column drum (split in half), another a grooved (roofing?) stone

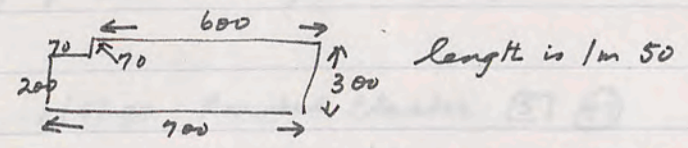

What has emerged surprisingly on the threshold is keying for a secondary doorway. Otherwise we're clearing [6] and [5] to completion and then taking pictures. 5 column drums observed last year in the baulk I'm leaving on a stand of earth as they are so fragile. They lie along the NW baulk. A nail from [5] clearance becomes [5] (45). Pottery becomes [5] (46) + painted plaster [5] (47). Final clearance was done on 7/5/90 in area [5] along the E. baulk producing a small bag of pottery, [5] (48). Measurement on the well-formed wall (the hearth wall) on the S side will be taken subsequently.

The small door into the megaron has a threshold stone measuring 32 long by 32 deep (broken at back) by 29 high. The keying hole is 12 x 14 and is 5 deep

The doorway into the hearth room is 104 wide and has its threshold stone 40 deep. It was covered with a hard concrete-like slurry. The large stone (also covered with hard white? plaster) is 120 at its longest (broken) is 68 wide and 25 deep. There is no obvious fitting for an actual door.

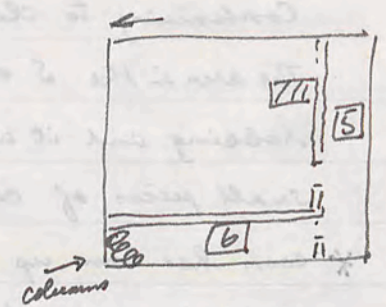

- [5] (45) nail
- [5] (46) pottery
- [5] (47)

AK T13 6/5/90

AK T13 3/5/90 Painted Plaster [5] (38)

- 12 frags of plain black plus one raised black with white edging (corner piece - with traces of red at end of white surround.
- eight frags of Pompeian red which appear to have dashes of white for marbling effect
- 2 frags ochre (plain)
- 5 frags of weaker red with white
- 1 frag of black + light red adjacent (no raised bevelling)

AK T13 6/5/90 Painted Plaster [5] (47)

- large collection of plain black frags., including four with black bevilled edging, one suggesting that a red surround followed.
- One black frag., white festoon dash - from the tendril painting?
- 4 frags of deep red with black + white marbling
- large collection of ochre with 4 showing bevilled edging and white surround
- large collection of marbled frags. basically white with light splashes of blue, red (pinkish), black giving speckled effect: two with bevilled edging indicating white surround.
- small collection of basically red frags. with splashing in blue, black
- Some plain white smooth plaster frags.

AK T13 5/5/90 [6] (42)

- Very large collection of black fragments with one edging of bevilling showing a white surround
- Collection of plain ochre with 3 bevilled edge pieces showing white surround
- Large collection of plain Pompeian red some with raised edging suggesting a white surround
- A few plain white frags.
- Some large frags of speckled blue + reddish pink with bevilled edge + white surround
- Notable collection of red with marbling with white + black swirling patterns + touches of blue
- 2 pieces with powder blue

T15 30/5/90 [3]

large box of scored plaster, maybe some attempts at human figure but largely scored lines at angles. No obvious lettering.

AK T5 3/6/90 [3]

largely red but some yellow + black, all plain
2 pieces of raised red, bevelled edge, white surround.

AK T21 4/6/90 [1]

plain black, very hard finish

AK T21 6/6/90 [2]

Just a sample of the very large bulk of plaster.
Solid colours of red, ochre and black.

There are ochre and red pieces with bevelled edges and white surround as well as black, similar

There are several moulded pieces for corners, one in particular is ochre for one wall joining with red on adjoining wall.

AK T15 7/5/90 [1] ①

Tiny bag including 1 battered rim frag. shallow coarse ware open

dish 

1 footed base frag.

1 body frag. weak red paint.

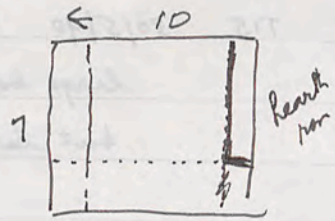

AK T15 9/5/90 [1] & [2] ⑤

Tiny bag including base frag of splotchy brown paint ware

~~AK T13 7/5/90 [5]~~

AK T15 8/5/90 [1] ③

Small bag

1 echeilus rim frag. weak brown paint

1 rim frag. shallow dish brown paint outturned rim

1 body frag of drip red paint

1 body frag cooking fabric

1 rim frag. coarse ware shallow open dish

1 coarse ware rim frag. 

[1] ① pottery

[1] ② & ③
plaster

AK T15 10/5/90 [1] + [2] ⑥

Small bag

3 large rim frags of reddish fabric mortarium

1 strap handle frag. (broken about)

1 weak red glaze body frag.

1 rim frag. unglazed open dish, groove inside rim

1 unglazed body frag. with misfired waster drip

3 coarse ware base frags.

AK T15 12/5/90 [3] ④ Tiny bag of nondescript sherds including one of weak red paint

AK T15 12/5/90 [2] ⑩ V. small bag of sherds including

1 rim frag. small dish weak black + red

1 rim frag. coarse ware open bowl 

1 body sherd cooking ware.

T15 7/5/90

Opened up a large 10m x 7m trench directly to the N. of T13. This is planned to take the rest of the season + should complete the megaron room and the adjoining room or rooms. I should be able to use Tom's workers when he leaves. I'm not leaving baulks. We'll be clearing to-day the top soil + grass: light-brown wind-blown dusty level. It is clear from the baulks that we go through a big layer of stones + fallen masonry before we get to a good meter of soil + then the floor. Already some white plaster is coming up in the vicinity of the presumed NS wall completing the megaron. I call the whole surface soil (producing little in the way of sherds) locus [1]. A cross wall running EW has come up completing the N end of the hearth room. The little pottery from to-day becomes [1] ①. Two bags of white plaster become [1] ② & ③.

AK T15 13/5/90 [7] (13)

- ✓ large collection of coarse ware body sherds, many with pitched inside
- one amphora toe
- one coarse ware base, large vessel
- one body sherd with ? pitch drips on exterior
- one ? islami? rim frag., light fired ware

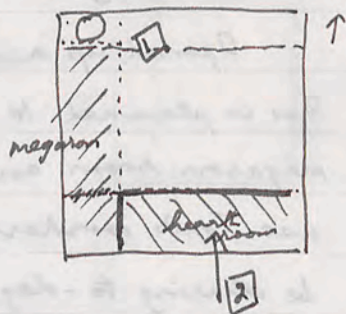

AK T15 13/5/90 [4] (14) cf. (13)

- ✓ large collection of coarse ware body sherds.
- two body sherds with light gauges as decoration
- 3 rim frags of same open mouth vessel
- 3 pieces of coarse ware vessel, foot of (13): very coarse
- 2 pieces of large open mouth rim, two joining
- 3 frags. of rim of large open mouth vessel, groove on exterior

[1] (4) architectural frag.

AK T15 13/5/90 [4] (19)

- ✓ Large collection of body sherds
- one frag. strap handle, coarse ware, joining with body frag. with handle base
- one small body frag + handle base
- one rim frag. open mouth coarse ware, shouldering early
- one large shoulder frag. of coarse ware? amphora

AK T15 13/5/90 [5] (20)

[1] (5) pottery

Collection of coarse ware body sherds

- 3 unglazed rims of small flatish dishes
- 1 body sherd, weak black, with 3 gauge parallel lines
- 1 coarse ware body rim + shoulder, double lines at base of neck exterior, cooking vessel.
- 1 rim, weak brown + black slip
- 1 large base frag. of red glaze dish with 3 stamped palmettes, 6 lines of redletting + interior concentric circles, bagged separately as object.

AK T15 8/5/90

First stone of the day removed: no demission complete. Sitting on surface soil.

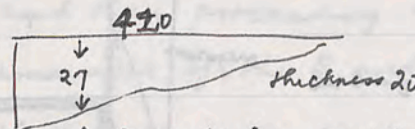

We'll continue doing surface clearance: a dull day all on locus [1]. At the moment the wall to the long room isn't clear at all - Can it be L shaped? and the column base of the megaron come from the room all the same? Going slowed by 2 broken wheelbarrows. Almost nothing in the dusty light brown top soil. Pottery is [1] (3)

AK T15 9/5/90

Continued clearing locus [1] in the NW corner. There is a surface few cm of white limestone crushed soil and then several cm. of quite brown top soil but everywhere there are shattered worked stones. I'm going down deliberately further in the hearth-room (T13) where the walls are clearly defined & a great deal of plaster is emerging from the walls. I'll give this a new locus no. [2]. Roof-tile fragments are emerging at this level in both [1] + [2] - not in great quantities. I've noticed in the mortar pile a piece of architrave moulding which I've assumed came from T13. It is complete underneath + on top (20 cm) and at its longest measures 23 cm. I've bagged it for drawing as [1] (4). I've decided, given the great volume of white (+ to a small extent pink) plaster to pile the plaster up on site + photograph + take samples there. It is coming up, as expected, in the walls of the hearth room that are in T15 and in the vicinity of the presumed magazine room. An E-W wall is apparently coming up in the trench to enclose this magazine room. It is possible a cross way NS may intersect it half-way along the trench but it is too early to tell.



AK T15 13/5/90 [2] (21)

- Small collection body sherds
- base + frag. of double handle, large vessel
- rim + body frag. of fine brown glaze, pinkish fabric
- 2 coarse ware footed bases, one red painted inside
- one rim of light pink painted open dish
- 3 coarse ware rims
- 1 frag. black cooking ware.

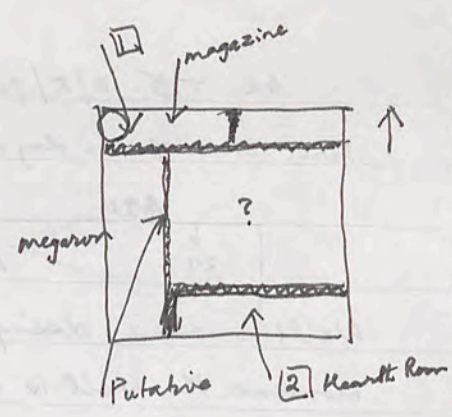

Remember Yahye's cream + bandage

AK T15 14/5/90 [4] (28)

- Big collection of body sherds, coarse ware
- one amphora toe, ringed
- 3 pieces from rim + neck of large open-mouthed coarse vessel
- 2 coarse ware rims, thickish fabric

AK T15 14/5/90 [4] (31)

Pottery [1] + [2] (6)

- Small bag of body sherds
- one complete strap handle and neck + shoulder, double grooves at base of handle, blackish exterior; jug?

AK T15 14/5/90 [2] (32)

- Tiny bag of body sherds
- one body frag. of grey ware
- one amphora stopper?
- one body frag. of brittle cooking ware
- one body frag. of intermittent red paint

AK T15 14/5/90 [5] (30)

- Small bag of body sherds
- one fine ware red glaze bowl frag. one body frag. red glaze, but not fine
- one coarse ware small strap handle
- one echinus rim weak red + black paint around rim
- two rims of cap or bowl, thin fine fabric but weak red paint

AK T15 10/5/90

Continuing to work in the NW corner clearing the final lot of surface fill and then proceeding downwards in locus [2], the lower fill of the remainder of the S end of the trench, the heart-room partition in T15. In the N bank, centre, a broken stone 49 long, 23 wide, 14 deep. There is a squared hole in the stone.



In area [2] a block sitting on the surface 69 long (complete) by 56 wide (broken), by 27 deep (complete) will have to be removed. White + pink plaster, as last year, are coming up in the magazine area. I'm laying this out on site.

In [2] a second dressed block (also on surface) is being removed: measurements are 59 x 29 x 29 (broken). 70 x 28 x 15 (but broken + shaped like a roofing piece) has also been removed. A roofing (guttering) piece - broken - has come up on

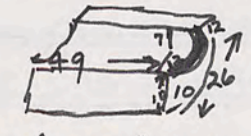

the West bank, similar to several recovered last year. Otherwise slow going among the broken stones. Pottery (non-descript) is easiest made [1] + [2] (6), with a small bag of charcoal.

AK T15 14/5/90 [5] (25)

largish collection of body sherds including cooking ware in some quantity.

- 3 body frags of ware with incised lines and two concentric grooves



- one neck + shoulder with rim of cooking pot, raised line at base of neck.

- one frag. coarse ware fish plate
- one fine coarse ware bases, footed

- One mouth of ? jug, shaped for pouring, coarse ware with handle base
- one very fine cup, red glaze, rim frag, glaze wearing off
- one echinus rim, weak black paint



- two coarse ware rims, small open mouthed vessels
- one body frag. with two sets of double incised grooves
- one body frag. of dark red glaze
- one rim of black (hooked), flatish dish
- one coarse ware body frag with base of handle
- one complete strap handle + body frag of weak red paint

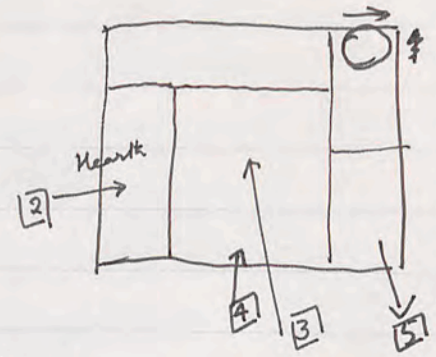

- nail [3] (7)
- bronze bangle [3] (8)
- Pottery [3] (9)
- Pottery [3] (10)

AK T15 14/5/90 [5] (23)

top half of double lug-handled cooking pot. Associated pieces will be in [5] bags of to-day.

- coin [3] (11)
- nail [3] (12)
- Pottery [4] (13)
- Pottery [4] (14)

AK T15 15/5/90 [4] (33)

Bag of 27 clay loom-weights - one added to inventory box 16/5/90

AK T15 15/5/90 [6] (40) inventoried 7 wicker whole lamp (used)

AK T15 14/5/90 [5] (29) " small juglet with single handle + cut-away spout, footed base, reddish fabric

AK T15 12/5/90

We're beyond the surface soil so I'll call in the general trench this level of light brown friable soil + crumbly limestone from decayed blocks locus [2]. We're continuing to go down in the fill of locus [2], the remainder of the heart room along the S. bank. We're still removing broken but once dressed surface stones but in [2] the broken blocks (from the remainder of the plastered wall? they have stippled surfaces) are deeper in the topsoil. One piece was 30 x 20 x 41 but very broken about. the N S wall of the megaron room is still not very well defined. 58 x 28 x 13 [incomplete] block (somewhat broken) has been removed from the topsoil in [3]. Broken Stone 52 x 66 x 16, with 14 wide groove: otherwise incomplete. A nail becomes [3] (7) and a ? bangle length of bronze becomes [3] (8). A small pottery collection is [3] (9) and [2] (10)

AK T15 13/5/90

After a family riot, continued to work down between the stones. A coin was located in the free fill around the stones in the central west bank. It is high up in the fill + can't be stratigraphically controlled. It may be contemporary with the building's collapse or robbing: bagged as [3] (11). An islamic looking sherd has turned up in the surface fill in the NE corner. It will be bagged with the day's pottery: it is a surface find only. 66 x 39 x 28 block fairly broken removed from surface level of E. bank. In the mid E bank an amphora + large water pot of coarse ware have come up in large fragments: in this context a nail was found as [3] (12). As the pottery is coming in such large quantities I'm giving this a special locus [4] and at least two bags will be [4] (13) + (14). A figurine frag. - very broken - from the same deposit becomes [4] (15) + a sample of bitumen lining of water jar becomes [4] (16). Further pottery is coming up some line on the outside with a cement render. We'll have to break up + remove a very large broken stone, incomplete in all dimensions, but at the largest it measures 87 x 65 x 39. 46 x 30 x 25 with pitted face, broken, also removed. 74 x 52 x 24 (broken) will be removed. 70 x 43 x 22 (16 groove) pretty well complete, will also be removed from surface NE corner. 69 x 67 x 26 will need to be broken up (on surface) to make space in central trench. 88 x 3

[4] (16) Stone removed: a roofing piece?

AK T15 [6] (37) 15/5/90

This consists of body sherds which come from half a pot found complete but broke up on extraction. Would fit together. With these are: Pot pitched inside

- One large amphora toe
- One body sherd with parallel double grooves.

Other frags. of the pot should be in [6] bags of to-day.

[5] (15) loom weight

[5] (16) glass

[5] (17) nail

[4] (18) ? mica

[4] (19)

[5] (20) } pottery

[2] (21)

AK T15 15/5/90 [2] (46)

Small bag body sherds

- One frag. coarse ware strap handle
- One base, footed, coarse ware
- one ? amphora stopper

AK T15 15/5/90 [6] (43)

NB this has fragments of the pot from [6] (37), large pieces

Has one fine ware red glaze cup frag.

- one coarse ware rim

AK T15 15/5/90 [4] (45)

Smallish bag body sherds

- One complete rim + neck of coarse ware open-mouthed vessel
- one rim frag. coarse ware
- One broken amphora toe
- one rounded base frag (no foot) weak red paint
- one neck frag., weak black paint

AK T15 15/5/90 [5] (42)

Largeish bag of body sherds

- 2 joining neck frags of coarse ware open-mouthed vessel
- 1 rim + handle frag. (handle turning), large coarse ware vessel
- 1 handle base of blackish vessel with incised lines on associated body plus body frag. of saddle vessel

- 3 frags of rim of coarse ware shallow open dish cont'd

A basalt grinding vessel (broken) also come up in [4] 56 x 49 x 21 stone (also broken) now removed from surface. In the NE corner next to the magazine room, plaster is still on the wall + a great deal of the roof-tiles are coming up as well as a piece of cornice moulding, marked as T15 [3]

This area I'm calling [5]: it has produced a loom-weight as [5] (15) and 3 pieces of white glass (joining) as [5] (16). Nail from [5] is (17) and a piece of mica? from [4] is (18). A third bag from [4] of pottery is [4] (19) and another bag for [5] is (20): area [2] has produced a small bag (21)

Area [5] is producing a surprising amount of detritus: can it have been dumped outside? There is much charcoal mix but so far no ash. Some very large tile fragments have been recovered. In area [4] in the mid-E baulk it is looking as if the roof fell down on a large collection of storage + water jars + coarse-ware vessels. In area [2] we are getting down close to the floor + recovering a little more pottery. I shall make the magazine room area [6]: pink plaster is coming up, as last year whereas in [5] it is predominately white.

- AK T15 15/5/90 [5] (42) cont'd.
- one foot frag of cooking pot
double grooves in body
 - one rim frag., open flaring dish
blackened exterior, reddish paint interior
 - 1 coarse ware base frag., small
 - 1 weak black/red paint cup or bowl rim, finish
 - 1 open turned coarse ware rim of large open dish

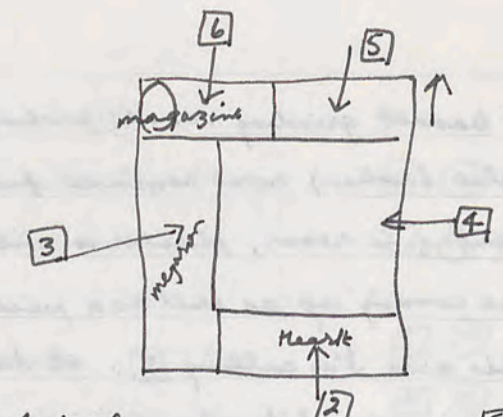

- AK T15 [2] (55) 16/5/90
- Small shard collection
- 1 simple rim open weak red glaze bowl
 - 1 base (round, unfooted) frag. of weak brown interior, beginning of small 'fish-plate' depression
 - 1 coarse ware rim, double-knob variety
 - 1 body frag of metallic grey ware, trace of wavy line decoration.

- [5] (22) nail.
- pot [5] (23)
- glas [5] (24)
- Pottery [5] (25)
- loom weight [5] (26)
- metal [5] (27)
- pattern [4] (28)
- whole Pot [6] (29)

- AK T15 16/5/90 [6] (53)
- Large pieces of coarse ware, amphora type + storage vessels including some roof-tile frags. Otherwise only
- rim (weak pink/brown blotchy paint) echinus bowl
 - body + base handle frag. coarse ware vessel.

- [5] (30)
- [4] (31)
- [2] (32)

- AK T15 17.5.90 [4] (63)
- V. large bag of coarse ware sherds
- 1 coarse ware strap handle
 - 1 double-knob outturned coarse ware open mouth rim, firing marks
 - 1 footed base frag., pinkish interior, largish coarse ware vessel

AK T15 17/5/90 Large frags (connecting) of large storage vessel [6] (61)
similar to one still in situ + found adjacent.

AK T15 14/5/90

From wall of [2] broken stone measuring 62 x 22 x 31 removed.

From surface of [6] 68 x 33 x 30 grooved but broken, removed.

" " " " (broken) 68 x 48 x 32 removed.
: a second one added later.

First find of the day from [5], a nail (22) Pattery is coming up in [4] as well as [5] and the crossing wall EW by the magazine is emerging well preserved.

A very large surface stone 74 x 112 x 35 (but broken) will have to be broken up: too large + shattered to move about: from area [4]

[5] has also produced a 2 lug-handled top-half of a round-bellied pot = [5] (23) and some black glass = [5] (24). [5] (25) will be the pottery associated with the pot. A broken loom weight becomes [5] (26), metal twist (once a ring?) [5] (27)

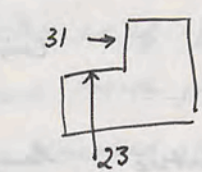

wide 58 x long 62 x deep 33 area [6] Surface stone has to be removed.

[4] (28) is the first large bag of pottery for the day from [4]: appear to be largely storage amphorae + coarse ware vessels. Some duck-egg blue plaster is coming up in small quantities from [6]. 54 x 57 x 29 (broken) has to be removed from [6]

A small single handled pot has come up from [6] as [5] (29). Plaster is still sticking to the walls of both [6] and [5] to a great extent. A broken length of guttering with grooved end has also come up from [6] as well as what appears to be two sides of a pilaster capital - but with raised stone on top (puzzling)

- Final Pottery from [5] is (30)
- [4] is (31)
 - " [2] is (32)

AK T15 17/5/90 [2] (64)

Smallish bag of coarse ware body sherds

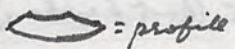
- one rounded amphora toe
- 1 echiinus bowl rim, unglazed exterior, pinkish inside
- 1 large rim frag. open mouthed vessel, coarseish red fabric
- 2 very fine body frags., red glazed, fine cups
- 1 strap handle frag.  = profile
- 2 frag. coarse ware rim, outturned shallow? plate
- 1 base frag. small coarse ware footed bowl
- 1 echiinus rim frag., unglazed

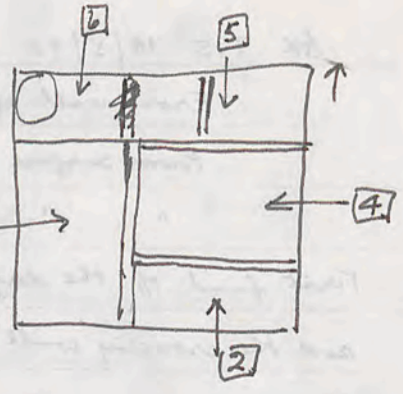

- loom weights [4] (33)
- glass [5] (34)
- percid shell [5] (35)
- nail [2] (36)

AK T15 17/5/90 [5] (81)

- Whole rim, stored separately of large open mouthed vessel, pie-crust rim, decorative wavy lines in two bands on neck, followed by 3 parallel concentric grooves, base of handles with apparently decorative knobs either side of bases

- (broken) pot [6] (37)
- coins { [6] (38), [6] (39) }
- lamp [6] (40)
- psueder [6] (41)
- pottery [5] (42)
- pottery [6] (43)
- bronze [2] (44)
- pottery [4] (45)
- pottery [2] (46)

AK T15 16/5/90 [4] (54)

- Smallish body-herd bag.
- One burnt toe of amphora, small base knob.
- 7 very fine red glaze frags including rim frags from same vessel + one thicker
- 3 joining echiinus bowl rim frags, coarseish red fabric
- 2 further echiinus rims, one pinkish fabric, one weak red + pink
- one clay stopper
- 7 coarse ware footed bases, one fish plate hard red interior, one with pair of part. grooves in interior, hard red colour,
- 4 coarse ware rims
- 1 body frag. + handle base, coarse ware

AK T15 15/5/90

Noise Sluice ~~15~~ (25) → up to (30) recovered by 21/5/90

Two loom weights from [6] = (33), clay, unbaked.

Glass from [5] = (34)

Percid shell from [5] = (35)

Nail from [2] = (36)

A large (broken) pot has come up against the wall in [6] which apparently contained the loom weights. it has come up in pieces.

A large dressed stone from [6] measured 27 x 46 x 31 (complete)

From [4] 27 x 45 x 24 (broken)

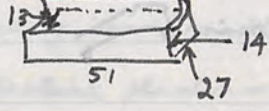
A guttering piece 51 long.  removed from [4] against the wall of [2]

It looks as if [6] was indeed a storage room whereas [5] has produced much pottery + roof-tiles

A fine dressed stone 48 x 54 x 27 from [6] will need to be removed.

I'll put a loom-weight from [5] with the 26 from [6]

The whole pot from [6] I'll take in a sambeel as [6] (37)

A coin from the floor of [6] is [6] (38), and a second one, also on the floor, is [6] (39) = 90.322 Alex.ii (128-3)

[5] has produced on the floor a stone basin 42 x 34 x

[6] has stone 66 x 56 x 30 (incomplete) to be removed.

[4] has a further broken piece (end section) of grooved guttering.

We appear to have reached the floor in [6], [5] and [4] - all much higher than the megaron room. The N + S walls in [4] as well as in [5] are showing a sort of step as base of the rooms' walls. It is hard to find the earth over the bedrock flooring: I suspect we'll really have to clear to this level.

(40) [6] has produced at floor level + fine 7-wicked lamp (complete) and a neat

(41) little psueder.

[5] has been cleared + produced a final bag of pottery (42). The wall plaster in situ appears blackish but this could be discolouring: white (+ pink) were recovered from the fill. The finds suggest domestic use.

[6] has produced much plaster as well as pottery bag (43). Plaster is pink + in great quantity white

Bronze frag. from near floor of [2] is (43)

AK T15 21/5/90

[4] [13] Bag 2

Large body frag. + small collection of coarse ware sherds, including cooking ware frags.

2 joining rim fragments common open mouth vessel double outside rim.

2 body frags. fine red glaze, different vessels
Body frag of rounded base fine red glaze vessel
1 rim frag. red glaze bowl.

1 eckenis rim, pinkish-black inside

1 weak black paint, outturned rim

AK T15 21/5/90 [6] [14]

Some very large body sherds from coarse storage vessels

- one neck frag., finish, of amphoriskos
- two joining frags of footed plate, concentric rings inside, weak red glaze
- one rim frag. v. fine red glaze cup or bowl.
- one lug handle, weak red paint
- one body frag. weak red exterior, parallel gouges.

AK T15 17/5/90 [6] [62]

Very large body sherds from coarse storage vessels, large collection

- 1 round amphora toe
- 2 ~~very~~ complete bases, coarse ware vessels
- 1 coarse ware base with hold central depression ('fish-plate style') interior.
- 1 base rim frag., footed.
- 1 strap handle frag., weak whitish exterior.
- 1 base frag. weak red glaze exterior
- 1 bowl profile rim to base, fine red glaze bowl - inventoried separately as [6] [62]

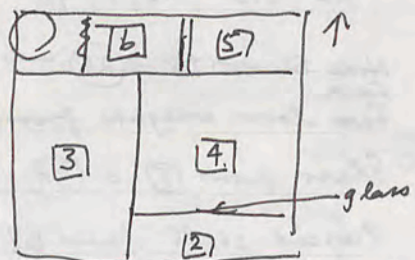

loom weight. [6] [47]

glass. [4] [48]

nails [4] [49]

? key [4] [50]

coin. [4] [51]

pin. [4] [52]

Pottery [6] [53]

[4] [54]

[2] [55]

? agate [4] [56]

AK T15 16/5/90

From [6] stone (broken but dressed) removed 57 x 40 x 25. It has a grooved cut. Already a loom weight (clay) has come up from [6], making the 28th.

A fine piece of glass rim has come up at floor level on the threshold of

* [4], making [4] [48]. There appears to have been a fire-place at this threshold point: a great deal of ashy soil is coming up? below floor level (as I imagine): it could be a storage pit, perhaps. Nails become [4] [49] from this level. And there is evidence of a primitive oven.

Clearing the flagstones in [5] suggests it is hollow underneath: we will have to lift one + see what gives. The threshold is clear + the doorway has been blocked. The blackish plaster is clinging to the original door post.

We are getting to the floor of [2] to-day + clearing along at floor level.

Not much is emerging except a pounder (round river stone).

From the threshold of [4] has come up iron, not nail but perhaps a key?

= [4] [50]

A stone with hatching came up from [4] - did it once have mosaic

I've not seen the like: 36 x 26 is the hatched surface.

A very fine engaged column base has emerged from the bank whilst clearing out the magazine square: Ionic type sensuous carving. Barry to draw.

* I've bagged with this further rim frag. (white) + a body frag. with grooved gouges, + several (black glass) body fragments: all from the threshold of [4]

A coin has come up in [4] on the threshold floor, in what appears to be below-floor deposit. It should clean up well. [4] [51] = 90.380 Ant. in 114/-95

The wind is impossible to-day: quite impossible.

Bronze pin from [4] is [4] [52]. A stone (river pebble) may be worked agate.

= [4] [56]: no holes, so may not be artefactual.

We are proceeding slowly along floor level in [4] and [6] + are just reaching the floor in [2].

AK T15 [2] (78) 22/5/90

- Smallish bag of coarse ware sherds
- 1 twisty coarse ware handle
- 1 fine red glaze rim
- 1 foot red glaze plate, base
- 1 base frag. coarse ware, footed
- 3 coarse ware rims, one with neck + shoulder, one small dish with weak red paint.

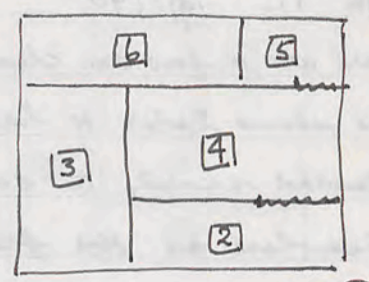

AK T15 23/5/90 [6] (89)

- Largely collection of large storage vessel body sherds
- 1 echinus rim, splotchy rim painted in red/brown. Large frag.
- 1 rim outturned open-mouthed vessel.
- 1 rim storage jar . Large, coarse: pitched interior

- [7] (76) glass
- [6] (77) "
- [2] (78) } pottery
- [4] (79) }
- [6] (80) }

whole rim 17/5/90 [5] (81)

- clamp [6] (82)
- whisk [6] (83)
- glass bowl [6] (84)
- nails [6] (85)
- [4]
- metal [4] (86)
- coin [6] (87)

AK T15 23/5/90 [4] (90)

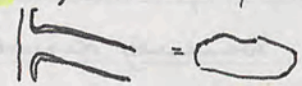
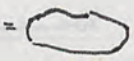
- Large collection of ? amphora body sherds, smallish pieces
- 1 base + broken large strap handle  = 
- 1 base + body sherd of handle, no actual handle, coarse ware
- 1 worn body sherd, weak brown paint, part grooves

AK T15 23/5/90 [2] (91)

- Basically coarse ware vessel frags.
- 1 rim coarse ware open mouth vessel  and base? of same vessel, reddish interior
- 1 echinus rim, splotchy pink paint interior, weak brown exterior
- 1 complete small footed base ring, coarse ware
- 1 fine ware, red glaze body frag., plate or dish
- 1 v. coarse gritty ware, outturned rim frag.



AK T15 24/5/90 [2] (95)

- Coarse ware body sherds, amphora?
- 1 amphoriskos leg frag., grey fabric, solid

AK T15 22/5/90

Few men (election day) + short hours (until 10) so not much progress will be made. Piece of black glass is [7] (76), Piece of white glass is [6] (77) with 2 part grooves. The floor has definitely been cut through in [7] and below the floor as in Judith's area several fireplaces have been found. White + pink ^{+ black} and some duck-egg blue plaster is coming up in [6]: one edging piece in white with a stripe of pink along the edge, otherwise all solid colours.

AK T15 23/5/90

From [6] a squared stone 60 x 62 x 27 and another 57 x 30 x 32 as well as a metal clamp (v. solid)  = [6] (82) and a stone bead (or spindle whirl) = [6] (83) . Plaster samples from [6] now include beside lots of pink duck-egg blue corner pieces with pink stripe along the edge. We should clear [6] and I should hope [2] to-day + then be able to concentrate on [4] and eventually [3] (which will be difficult)

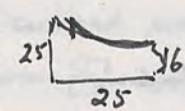
From [4] 38 x 32 x 34 a squared stone removed from surface fill and a further piece of broken guttering with grooved end 54 long broken  also from surface fill.

We'll try + keep to the floor level in the rest of [4] + clean up the first half to bedrock. [6] has produced a fine profile of moulded (white) glass bowl with gauged part grooves on side, bagged with another glass rim frag. = [6] (84). A further piece of basalt from [6] - rounded edge of grinding bowl? as well as another nail [6] (85). Roof tiles continue to come up but not adding any more definition than those found previously. Another piece of worked basalt from [2]. It has become very HOT.

Two nails from the floor of [2] I've bagged with [6] (85), and metal piece from [4] is (86). A coin from the floor of [6] near the magazine is [6] (87). Otherwise we worked painfully slowly towards the West wall of [4]. In [6] it is clear there were panels of duck-egg blue in blocks adjacent to white

90.469 vs

AK T15 24/5/90 [4] (99)

Large collection of coarse ware body sherds including cooking ware Plaster [6] (88)

- 1 frag. base ring, thick fabric, red glaze, burnt interior, traces of rouletting Pottery [6] (89)
- 1 coarse ware (half) stopper, cooking ware from burnt seigns? [4] (10)
- 1 echenus rim + body frag, fairly fine, pink / grayish firing [2] (91)
- 1 coarse thin-walled handle frag., rounded
- 1 coarse ware rim, dish, open, groove on interior lip
- 1 base frag., large base, whitish-pink coarse ware
- 3 coarse ware rim frags. (small), 1 reddish
- 1 base frag. orange/red glaze, 5 lines of rouletting
- 1 body frag. dark brown glaze, FINE
- 1 body frag, FINE, red glaze, 7 par^L grooves
- 1 rim frag, FINE, red glaze, (), cup
- 1 coarse ware body frag. with par^L grooves 

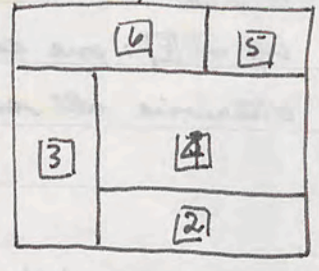

AK T15 [4] (98) 26/5/90

Small collection of coarse ware body sherds

- 2 outturned coarse-ware rim frags., one with weak red paint the other weak brown
- 1 footed base frag. ? blackish exterior nails [4] (92)
- 1 body frag. coarse ware with handle base pin [4] (93)
- 1 rim frag. FINE cup, red glaze wearing off buff fabric [4] (94)
- 1 (unusual) rim frag. of open STONE bowl [2] (95) protruding lug handle, hard grey stone. 

- one piece of division line with blue one side, white the other came up: red along turn. Some samples bagged as [6] (88). Pottery from [6] - final bag - = [6] (89). Pottery from [4] is (90) and from [2] is (91). A coin from [2], right on floor by doorstep, is [2] (92) = 90.456 v3

AK T15 24/5/90

It turns out that [6] had a beaten pebbled floor, largely lost, just as in the 'kitchen' area to the west of the megaron. I'm clearing out [6] and [2] finally for photographing to-day. Against the wall of [3], N end, white plaster has come off with graffiti, 3 pieces

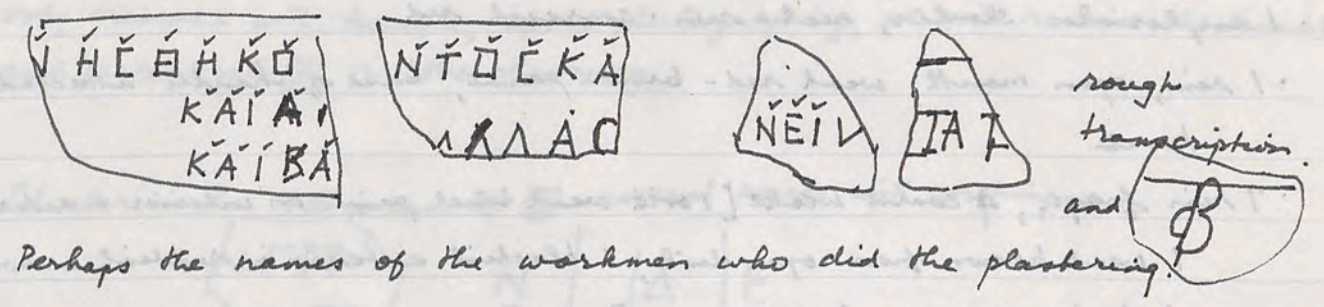

Perhaps the names of the workmen who did the plastering.

In [3] a dressed stone  48 x 23 x 24 has been removed from the surface deposit.

Two nails from [4] is (92) and a cosmetic/surgical bronze pin is [4] (93). A broken curved piece of stone with central cut appears to be a broken quern from [4], also a broken end of guttering (with groove) and a very large grinding surface of vesicular basalt. [2] (95) is final piece bag of pottery from [2]

AK T15 28/5/90 [3] (107)

- large bag of sherds, coarse ware body
- Ramp frag. bagged separately as [3] (110)
- 13 echius bowl rims (some from same bowl [5]?), mostly red drip ware but two weak brown drip ware)
- collection of body sherds of these bowls vel sim.
- greasy grey metallic ware body frag.
- fair amount of cooking ware frags.
- 5 bases, dbk footed, one weak black exterior, ^{three} red interior, one weak black interior [complete base], fish-plate depression.
- 1 rounded amphora toe + body frag close to toe, coarse ware
- 1 amphoriskos shoulder, neck + rim: coarseish red
- 1 rim, open mouth, weak red-brown paint, base of handle attached to rim
- 7 rim frags., 4 coarse ware [1 with weak black paint on interior + exterior]
 - 1 weak brown from open dish, 1 blackish exterior in reddish brown interior,
 - 1 finer ware, pinkish interior [cup?]

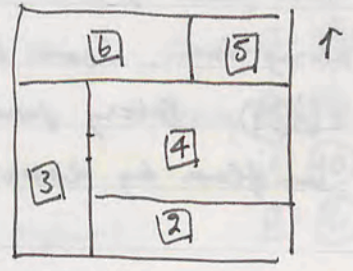

- nails [4] (96)
- coin [4] (97)
- pottery [4] (98)

AK T15 29/5/90 [3] (109)

- Small collection of body frags., coarse ware
- 23 (!) rim pieces, many probably from same vessel, open dish, coarse ware, groove on inside rim
- 1 rim, weak red glaze, ridge at base of rim on interior
- 1 red glaze base, footed, rouletting in interior, good quality
- 6 coarse ware footed base frags.
- 3 coarse ware fish plate bases (2 adjoining)

AK T15 30/5/90 [3] (119)

- Small collection body frags, coarse ware
- 1 base frag., footed coarse ware
- 1 broken, rounded, amphora toe
- 2 body frags., brownish black, one on both sides, one on exterior only
- 2 outturned coarse ware rim frags, one largish mouth-gritty green ware
- 2 plaster frags., joining, one with rim, blotchy brown + black paint, weak part: gauges on exterior, rim outturned, interior shows beginning of central groove

AK T15 26/5/90

We are doing a blast on [4] to-day to clear to the floor level. I'm sure we've cut the floor so I'm clearing to below floor instead. We'll spend the morning on this & then concentrate on [3] for the rest of the dig. It'll be difficult clearing that area.

A surface stone over the doorway in [4] 56 x 27 x 59 (appears complete). A second one 54 x 25 x 31 will also be removed: not complete. Nail (part) from [4] is (96) + further samples. 97 x 65 x 33 stone measured (on surface) + lowered into [4].

* A coin from the floor adjacent to the blocked doorway on the W side of [4] has become [4] (97) in solid condition. The doorway is not blocked, only crammed with tumble; after photographing, we will remove the tumble and proceed into [3] via the doorway.

Plaster in the NE corner of [3] several pieces with writing

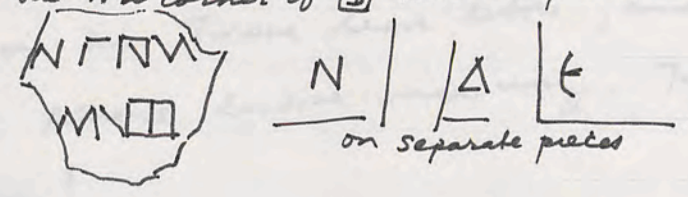

very fragmentary: appears to come from the underside of a large fallen block in [3] the plaster from which has flaked off in hundreds of small fragments.

[4] (99) will be the plaster with graffiti lines + letters.

= 90.453 City of Antioch 92-72
* coin missing on record.

9/2/75 27

The one thing I think is that the fragments
are not in the same order as they are in the
list. It is possible that some of the fragments
are from a different fragment than others.

A surface area of the fragment is 24 x 24 x 24
cm. The fragment is 24 x 24 x 24 cm.



A one fragment from the fragment is the fragment
of the fragment. The fragment is not clear.



Plaster in the fragment is the fragment
of the fragment. The fragment is not clear.

very fragmenting; appear to come from the fragment
of the fragment. The fragment is not clear.

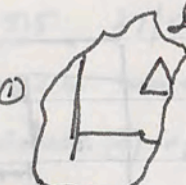
fragments from the fragment are the fragment
of the fragment. The fragment is not clear.

fragments from the fragment are the fragment
of the fragment. The fragment is not clear.

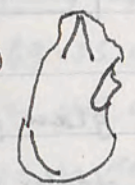
Inscribed Plaster, Area 3, T15
frag ①  delta is clear
frag ②  nu is clear

frag ③  faint scratches
lambda?
frag ④ 

two clear lines reading:

N Γ M X
M N □

maybe signs of third line

frag ⑤ appears to have ←

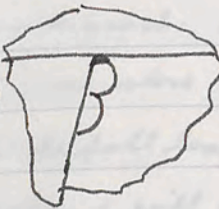
frag ⑥ 

frag ⑦ 

one line reading:

N E T break

frag ⑧ 

one line reading:

I A break

frag ⑨ large piece, ^{top edge} corner moulding

N Γ □ C K A

Δ Δ X Δ A C

frag ⑩ large piece, also has
top edge moulding

V J C B H K D

K A I A

K A T B A

AK T15 27/5/90

Stones in tumble of doorway 31 x 70 x 32, 68 x 35 x 39 removed between [4] + [3]. Against the NW corner of [4] some pink + white plaster is coming up with some indication of raised decorative plaster-work.* stone 69 x 55 x 31 also removed from tumble in doorway. Some fragments of glass also in NW corner of [4] as (100). Plaster in NW is predominately white, however - could be derived from tumble from the adjoining [3].

stones 92 x 64 x 37 : 70 x 48 x 25 - removed from doorway into [3]
68 x 43 x 37 (very broken) - also " " " " , broken up
It looks as if in the NW corner of [4] a large stone served as a sitting or work bench: 107 x 60 x 21: but it could just as easily fallen into the corner.
A grooved stone 79 x 42 + 19 x 21 : 7 is the depth of the groove but its full length is broken. Another 53 x 39 x 31 is dressed but very broken + will need to be destroyed. All these stones sit on very fine brown/yellow powdered dust - up to 0.5 metre. They clearly come from wall + roofing tumble.

88 x 60 x 29 : 107 x 65 x 24 : both large blocks sitting on much fill will be shifas.

* so far two pieces only: white with traces of red
could these merely be the wrong side as the plaster along to the pecked wall-face?

Another, fairly battered, stone measured 60 x 22 x 89
a further one 62 x 31 x 52

The going is extremely difficult with very large tumble on the surface from walls/roofs elements

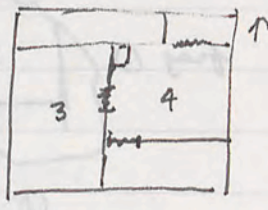

glass [4] (100)
plaster [3] (101)

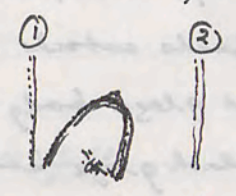

AK T15 31/5/90 [3] (119)

No great collection of body sherds: includes some tile frags. + v. coarse ware body sherds.

- 1 footed base frag., weak red + brown paint, largish
- 1 rim frag. coarse ware, small vessel, outturned lip
- 1 body frag., fine red glaze, buff fabric, plate

nail [3] (102)

loom weight [3] (103)

glass [3] (104)

coin [3] (105)

AK T15 2/6/90 [3] (123)

Smallish bag of coarse ware body frags.: includes some roof-tile frags. + cooking-ware body frags.

- 1 amphora toe: complete
- 2 unfooted coarse ware bases, 1 large, 1 small
- 1 large mortarium coarse ware rim
- 4 coarse ware rim frags.
- 1 ungatum foot frag.
- 1 cooking ware rim frag, outturned, smallish vessel
- 3 weak red/brown paint rim frags., small cups or bowls, one with 2 bands outside followed by pas: gouges
- 2 FINE red glaze body frags.
- 1 FINE black glaze body frag., glaze partly worn off
- 1 strap handle frag., weak red
- 3 body frags., 1 coarse ware with black drips, 1 weak brown exterior, 1 weak red/brown

glass bead [3] (106)

[3] (107)

nail [2] (108)

AK T15 3/6/90 [3] (125) final bag.

Small bag of coarse ware body sherds only.

one bag of pottery

[3] (109)

AK T15 A sample bag taken of the thick plaster esp. red, duck-egg blue with tags of plaster bags taken.

lamp frag. [3] (110) bagged separately from [3] (107)

28/5/90 AK T15

70 x 50 x 12 stuck with mortar to 65 x 56 x 20

Very difficult going in [3]. Heavy stones, largely intact, fallen in great tumble. Pretty awkward. At? below floor level we are getting pottery and a loom weight (103) and nails (102) and glass (104). A coin from floor of [3] - clear head - is (105): found in fill by doorway ^{90.515} missing

82 x 70 x 45 broken about but with rusticated edging, partly broken up but good section retained: 58 x 30 x 30 also removed-sitting on surface fill. We are proceeding along the floor, clearing some space for the very large stones.

A roofing piece 105 x 70 x 36 with groove [9] 22

Another 65 x 36 x 30 removed.

The one under which - 94 x 67 x 34 - the written plaster was found

Another - broken by the door - 65 x 48 x 35 -

A glass bead is (106)

A small amount of plaster (white) with scratch lines, the odd coloured piece (black)

One bag of pottery [3] (109)

29/5/90

97 x 69 x 35 also removed sitting on surface fill.

90 x 70 x 32 " " " " " (badly battered)

We'll proceed slowly, as Ambassador expected to-day: [2] (108) is a nail from floor clearance. In [3] the going is very slow with so many large walling blocks which appear to interlock

We may get more wall-writing as we're spot where other pieces came from.

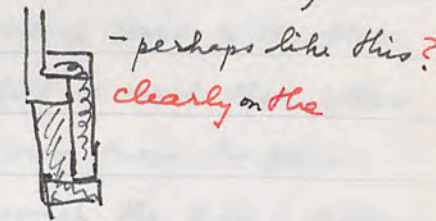

104 x 37 x 75 } stones removed sitting on soil.
70 x 38 x 25 }

We are digging to-day exclusively in the N. end of [3]

AK T15 30/5/90

To-day stone 94 x 25 x 70

as well as 104 x 27 x 70

and 75 x 55 x 30 complete

and 60 x 30 x 60

all sitting on top soil are being shifted.

In the N. end of [3] there is a great deal of white plaster with what appears to be scratched-graffiti - but no writing discerned. The floor was so weak as to be lost + we have bedrock cleared instead, including foundation trench for the N wall of [3]. It will remain to be seen how any step worked down into [3]. Nails become [3] (112); and a tiny bronze earring [3] (113). Much mortar + white plaster (with occasional red) is also coming up, and a half a rather battered column, a further one being visible in the fill and what may be a pilaster capital with white plaster adhering - but so far no ^{plinth} base to large column base sitting on soil

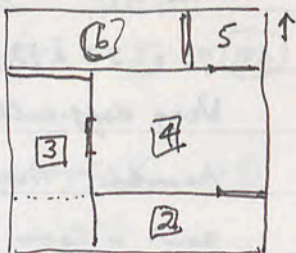

[3] (111) nail head

nails [3] (112)

earring [3] (113)

pottery [3] (114)

AK T15 31/5/90

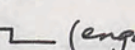
71 x 32 x 27, much battered, removed sitting on surface deposit by the doorway steps(?), into [3]. The East Wall, to the S of the doorway, is taking a battering being damaged as stones are removed adjacent to it. I expect a matching pilaster  (engaged) projection to be found to-day.

A length of stone on the surface deposit at the S end of [3], measured 60 x 26 x 20, probably one of the guttering lengths: broken at both ends. First nail of the day [3] (115). A coin in the lowest deposit getting close to the floor but not on the floor i.e. floating in the dusty fill of soil that filled the room before its collapse is [3] (116). A second nail from the floor added to (115). We are picking our way slowly through the fill + fallen stones. A third nail added to (115). It looks as if a very battered column so decayed as to be nearly beyond recognition, sitting on top of several other stones (of good quality finish) will need to be crumbled up.

90.563 vs chink-seal

- 72 x 33 x 20
- 71 x 35 x 38

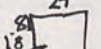

both finely dressed + close to the pilaster projection sitting on top of each other  on top of a column drum. A very decayed but manifest column drum has radius of 30. Glass frag. is [3] (117).

[3] (115) nails

[3] (116) coin

[3] (117) glass

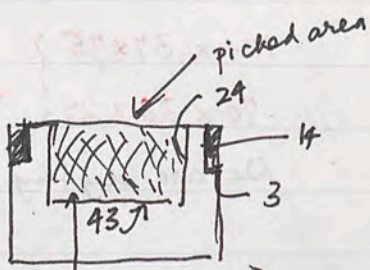

2cm approx deep. Fine plaster still clings as well as mortar at back, particularly choice finish

31/5/90

A fine length of stone with white plaster still adhering will have to be moved from top soil, broken at one end but otherwise complete. It measures 30 deep x 68 wide x 134 long (+ incomplete!), picked on inside. A spindle-whirl becomes [3] (118) [stone]. Two missing sections of the broken base or plinth have emerged from the floor underneath a column drum.

Pottery will be [3] (119)

2/6/90

Continuing in the Sand of [3] trying to preserve the columns on their side (6 drums) - with difficulty. First nails of day [3] (119).

A lamp was found jammed in the dirt on the N end of the stone? seat in [7], bagged as [7] (120). In the Sand by the blocked door of [7] I have decided to clear the foundation trench: it has proved surprisingly deep - no wonder the floor was difficult, as it appears to have been built up on several layers of rubble + dirt from bedrock, which we are still to reach.

104 x 70 x 26 large block sitting complete on top of wall on W side of [7] removed, otherwise largely removing dirt.

From the floor of [37] a piece of glass rim with two grooves on interior (black glass) is [3] (121), and deep in fill of the foundation trench in [7] has come a large spindle whirl, [7] (122)

Plain red + yellow + white plaster is emerging in the Sand of [3] as we clear along, but not in great quantities.

The dressed stone on 3 sides comes from the central pilasters, I now realize. It still has fine white plaster clinging to it.

Pottery will be [3] (123)

Spindle whirl [3] (118)

[4] nails [3] (119)

Whole lamp [4] (120)

Glass [3] (121)

S. whirl [3] (122)

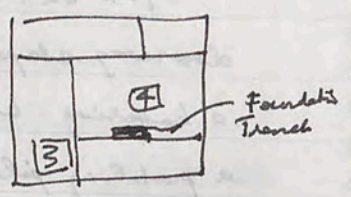

[3] (123)



[3] (124)
glass? beads

[3] (125)
pottery

[4] (126)
spindle wheel.

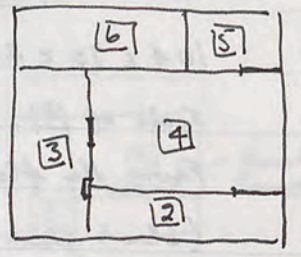

The red plaster shows that it was in masonry style: there are bevelled pieces showing that it had a white surround.

AK T15 3/6/90

Continuing in two areas + hope to finish to-day. In area [4] we are continuing to seek bedrock: the floor is clearly built up with largely virgin rubble (some bone, some charcoal, almost no pottery) over a metre deep so far. The bedrock must slope away quickly — as it does visibly in the 'long room' adjacent to the colonnade. The other area in which we're working is [3], trying to preserve the 6 column drums on their wind-blown fill. What is puzzling is no plinth for the second carved column base. On observation it looks as the one still on its plinth was damaged + patched up in antiquity — plastering-over concealed the fairly crude joints. V. little is coming up in the floor of [3], even of pottery: it was clearly looted entirely of its contents. Some, basically red, plaster fragments have come up in the fill.

The foundation fill of room [4] is a metre + a half deep. v

Spindle wheel found in the bottom of the foundation trench in [4] is, finally, [4] (126).

Of the areas opened by T15, area [3] is merely the completion of the 'megaron' room, revealing part features on the east wall to the west, viz. an engaged pilaster and a high doorway — this time not blocked but there aren't steps into the room, merely two conveniently placed blocks but clearly not original: they may have been placed there as a temporary, later measure. The threshold shows features part to the west side, and it appears to have had a door. The floor is basically not altogether smoothed over bedrock. The plaster was basically white at the northern end until the pilaster (itself apparently in white as on the west side), further south of the pilaster solid red + a little yellow plaster also came up. When T13 was cleared in this area, these colours also came up along with various marbling combinations. An interesting find were 3 broken off pieces of the plinth column base found on the floor underneath

9 drums

tumbled column drums. 3 further drums were found along with the 6 left lying on their fill of dirt (about .75 m.). The graffitied plaster all came from the NE corner of the room, high up in the debris deposit.

02/11/5 217, 4A

Excavation in the area of the hearth (T13) has revealed a doorway & neat threshold, with the doorway blocked. Good sections of white plaster still cling to the wall over a terre-plâtre backing, otherwise the prepared pocked surface of the wall is only left. More of the room is yet to be excavated to the east.

[4] is a fairly featureless room with three doorways: it looks as if the stone bench in the NW corner of the room was roughly there in situ - otherwise an unusually large block of stone. The floor is built up with 3 courses of foundation blocks over bedrock, 1 1/2 metres below present floor level: the rubble fill was largely without artefactual material but produced charcoal & bone - as did the floor itself - apart from a couple of spindle whorls. It produced of all the rooms much amphora-type pottery.

[5] has a floor built up of a series of blocks - the first of the laid floors: clearly bedrock is far underneath as it slopes away. Cooking & storage seem to be its function to judge from the abundance of coarse ware pottery. Black plaster is still affixed to the SW corner of the walls. A small part of the room only has so far been uncovered.

[6] with the pitthos in situ at the W. end, is manifestly storage in function +/or food preparation, with the remains of other vessels of storage type - large - also found, plus a stack of loom weights & an unusually large number of grinders & pounders (basalt surfaces & pounders as well as river stone weights & pounders). It was plastered in panels of solid colours, white, pink, black, duck-egg blue, some of white still remain on the walls. The floor for the most part consists of tiny pebbles but towards the west they become small stones neatly laid. Much of the room still remains to be uncovered.

The final clearance of [2] - the remainder of the room revealed by T13 (the 'hearth room') has a doorway & neat threshold, with the doorway blocked. Good sections of white plaster still cling to the wall over a terre-plâtre backing, otherwise the prepared pocked surface of the wall is only left. More of the room is yet to be excavated to the east.

[4] is a fairly featureless room with three doorways: it looks as if the stone bench in the NW corner of the room was roughly there in situ - otherwise an unusually large block of stone. The floor is built up with 3 courses of foundation blocks over bedrock, 1 1/2 metres below present floor level: the rubble fill was largely without artefactual material but produced charcoal & bone - as did the floor itself - apart from a couple of spindle whorls. It produced of all the rooms much amphora-type pottery

[5] has a floor built up of a series of blocks - the first of the laid floors: clearly bedrock is far underneath as it slopes away. Cooking & storage seem to be its function to judge from the abundance of coarse ware pottery. Black plaster is still affixed to the SW corner of the walls. A small part of the room only has so far been uncovered.

[6] with the pitthos in situ at the W. end, is manifestly storage in function +/or food preparation, with the remains of other vessels of storage type - large - also found, plus a stack of loom weights & an unusually large number of grinders & pounders (basalt surfaces & pounders as well as river stone weights & pounders). It was plastered in panels of solid colours, white, pink, black, duck-egg blue, some of white still remain on the walls. The floor for the most part consists of tiny pebbles but towards the west they become small stones neatly laid. Much of the room still remains to be uncovered.

61

AK T21 4/4/90 [1] ⑤

Biggish coarse sherd collection

- 4 coarse ware rim bases
- 2 coarse ware strap handle frags.
- 22 " " rims, including one cooking ware, one weak red paint, one weak brown paint, plates + bowls, not large vessels
- 2 body frags fine ware red glaze
- 3 pieces of part gauges body frags, one coarse, two weak red
- 4 body frags. of weak brown, weak dark red, pink/black etc.

[1] ① glass rim

[1] ③ coin

[1] ③ nails

[1] ④ agate

[1] ⑤ pottery

[1] ⑥ plaster

[1] ⑦ gold leaf frag

AK T21 4/6/90 [2] ⑪

Large body sherd collection

- 1 base rim frag., weak brown paint
- 3 body frags 2 hardish red interior, 1 bowl with brownish black interior
- 1 FINE black glaze rim frag. outturned rim of bowl.
- 7 rim frags, some weak red paint
- 1 ungentarium lip, coarse ware

AK T21 6/6/90 [2] ⑬

Largeish body sherd collection

- 3 coarse ware footed bases
- 1 smallish amphora base
- 1 ungentarium base frag.
- 4 rim frags, 2 coarse ware (small), 1 weak red cup (small), 1 largeish variety weak brown on exterior
- 1 coarse ware body frag. with mend hole
- 5 fine red glaze body frags., one a rim of shallow bowl
- 1 thick red glaze body frag.
- 2 rounded bases, coarse ware, one fine cup

AK T21 3/6/90

A new trench opened 5.5 (EW) x 5m ⁵ over the purported doorway to the E of Ed's trench (2nd) + S of this first. We should at least hit the large 'exterior' stylobate following on from Judith's trench if nothing else.

A brown glass rim fragment is [1] ①, [1] being the surface soil.

4/6/90

Continuing removing the surface fill all over the trench after the start yesterday was aborted by the wind + dust. [1] ② is a small coin found in the first few cm. of the topsoil on the mid-west bank. The topsoil is very stony but otherwise consists of the usual dusty light brown wind-blown fill. There are a few roof-tile frags but not that much in the way of pottery frags. [1] ③ nail from same context, and an agate fragment [1] ④ (worked). Several more nails have come up, bagged with ③. Black plaster is also coming up in some quantity - solid black.

We appear to have several walls emerging

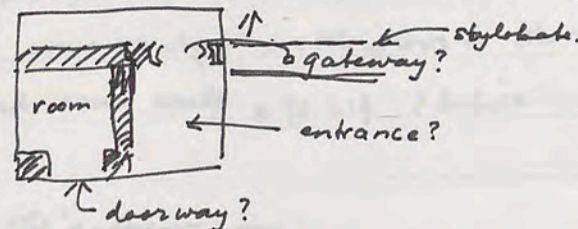

But, surprisingly, the large outer stylobate does not continue to the other side of the presumed gateway.

Could the agate be rock-crystal? There are an unusual no. of frags. We are getting to the floor in the S end of the 'doorway' + will work through from there. After the surface fill ~~the~~ crushed stone the room is basically full of soft dirt. The pottery for the day will be [1] ⑤, plus a bag of plaster ⑥, bone (v. little) + charcoal (v. little) [1] ⑦ frag. of gold leaf (tiny) from 'room'

The plaster bag ⑥ is of a very hard black (only) plaster. Not in great quantities.

AK T21 7/6/90 [2] (8)

not a great deal of body sherds

- 1 amphora toe (found stuck in ground)
- 2 coarse ware footed base frags.
- 1 drip ware body frag.
- 1 body frag. gauge ware with weak red on exterior

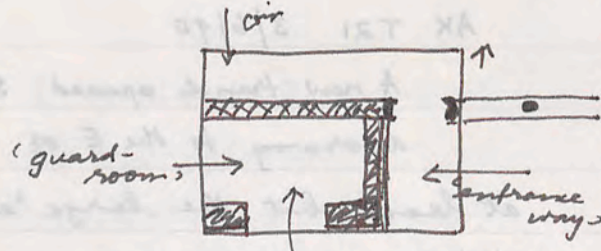

- (8) crystal [2] (8)
- nail [2] (9)
- glass [2] (10)
- pottery [2] (11)
- coin [2] (12)

IV. 128.07



- [2] (13) nails
- [2] (14) rock crystal
- [2] (15) metal

AK T21 4/6/90

I'll call getting down to the floor locus [2] to-day, starting with bag (8)
 (8) is continuing collection of rock-crystal. Nail becomes [2] (9), [2] (10) glass frag.
 The 'guard-room' is remarkably short on pottery & small finds on the floor: it is looking as if it doesn't continue beyond this point as a building.
 The room is full of nearly 2m. of soft soil + rock fill. A few, but not many, roof tiles. The entrance way is producing almost nothing.
 The doorway into the 'guard-room' is unusual. 3 large blocks on top of each other on either side.

57 x 35 x 34 dressed stone removed from entrance way: heavily broken about but appears to have a worked hole.

The guard-room is odd: on the west side of the doorway it is built up of packed field stones — the first time this sort of wall on the acropolis.
 cf. toilet/bathroom of Sub-division wall? 83 x 51 x 30 with an unusual worked groove also removed from the doorway entrance from which white + black plaster has come up in quantity
 [2] (11) is pottery for the day
 [2] (12) is a coin come up right on the floor in the NW corner of the trench outside the guard-room wall. = 90.619 ? Ant. ix

8/6/90

Clearing to-day the 'entrance-way'

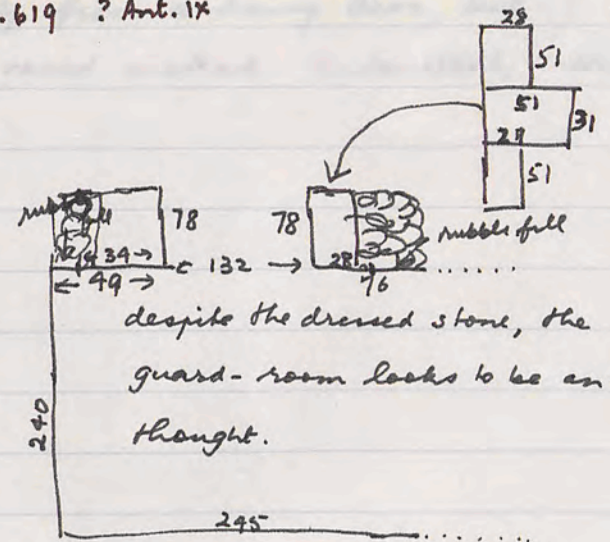
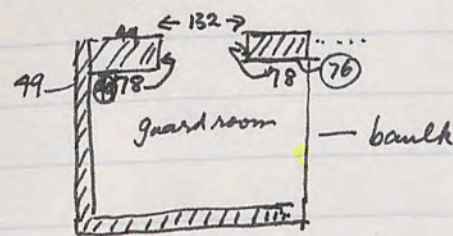

Plaster is coming up in the entrance-way: white, yellow, black in solid colours, in great quantity. Nails are [2] (13) from this entrance area clearance, more rock crystal [2] (14). A stone removed from the N end of the trench 30 wide but broken at other dimensions (62 x 45 approx.)

3 pieces of worked marble have come up in the entrance way — perhaps a working vessel? fine quality material.

2 (16) pottery

6/6/90

I'm taking samples of the plaster back to see the sequence of colours. The plaster is in great quantities.

7/6/90

58 x 50 x 21 } Stones removed
52 x 39 x 14 }

We're clearing the entrance way by shovel: the plaster has basically finished.

35 x 24 x 20 broken worked stone: 55 x 55 x 30 a further one in the fill

A stone with mason's marks  also come up + a broken piece of doric capital: 3 necking rings + two flutes.

2 (17) nail

2 (18) pottery

2 (19) ring

A small piece of gold fleck left in one piece of plaster. Only tiny.

The 5 pieces of marble are possibly from a heavy door, but could be from a slightly curved vessel instead. Undoubtedly worked.

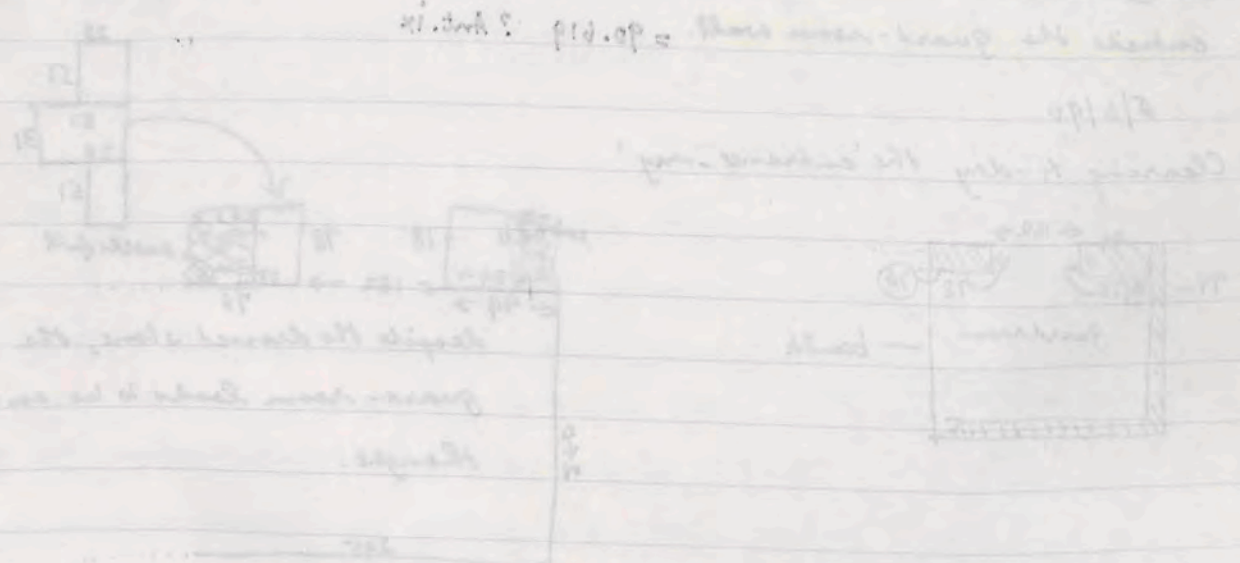

	ahad 22/4	ahad 23/4	Talate 24/4	Eeid 25/4	Sabat 28/4	Ahad 29/4	Itmen 30/4	Talate 1/5	2/5	3/5
✓ Yahia	✓	✓	✓	✓	✓	✓	✓	✓	✓	✓
✓ Haja jama ✓ Hammadi Nasser	✓	✓	✓	✓	✓	✓	✓	✓	✓	✓
✓ Hussein Jamedi	✓	✓	✓	✓	✓	✓	✓	✓	✓	✓
✓ Mikerky	✓	✓	✓	✓	✓	✓	✓	✓	✓	✓
? ✓ Omar	✓	✓	✓	✓	✓	✓	✓	✓	✓	✓
✓ Hadija Yahia	✓	✓	✓	✓	✓	✓	✓	✓	✓	✓
✓ Haja Adoula	✓	✓	✓	✓	✓	✓	✓	✓	✓	✓
✓ Fatouma	✓	✓	✓	✓	✓	✓	✓	✓	✓	✓
✓ Ahmed Yahia	✓	✓	✓	✓	✓	✓	✓	✓	✓	✓
✓ Haja Moua	✓	✓	✓	✓	✓	✓	✓	✓	✓	✓
✓ Mahamad M'hamed	✓	✓	✓	✓	✓	✓	✓	✓	✓	✓
✗ Mahamad Nasser	✓	✓	✓	✓	✓	✓	✓	✓	✓	✓
✓ Zukriye Haja Moua	✓	✓	✓	✓	✓	✓	✓	✓	✓	✓
✓ Mousa Allowe	✓	✓	✓	✓	✓	✓	✓	✓	✓	✓
✓ Ibrahim Mousa	✓	✓	✓	✓	✓	✓	✓	✓	✓	✓
✓ Sahab Mousa	✓	✓	✓	✓	✓	✓	✓	✓	✓	✓
✓ Halid Mousa	✓	✓	✓	✓	✓	✓	✓	✓	✓	✓
✗ Smale Aziz	✓	✓	✓	✓	✓	✓	✓	✓	✓	✓
✓ Hannan Hussein	✓	✓	✓	✓	✓	✓	✓	✓	✓	✓
✓ Fakou Muhammad	✓	✓	✓	✓	✓	✓	✓	✓	✓	✓
✗ Aziz	✓	✓	✓	✓	✓	✓	✓	✓	✓	✓
✗ Nazika	✓	✓	✓	✓	✓	✓	✓	✓	✓	✓
✗ Rakiba	✓	✓	✓	✓	✓	✓	✓	✓	✓	✓
✗ Allowe	✓	✓	✓	✓	✓	✓	✓	✓	✓	✓
✗ Ahmed Allowe	✓	✓	✓	✓	✓	✓	✓	✓	✓	✓
✓ Smale al Hassan	✓	✓	✓	✓	✓	✓	✓	✓	✓	✓
✓ Haja Yahia	✓	✓	✓	✓	✓	✓	✓	✓	✓	✓
✓ Adli Hussein	✓	✓	✓	✓	✓	✓	✓	✓	✓	✓
✗ Mahmoud Allowe	✓	✓	✓	✓	✓	✓	✓	✓	✓	✓
✓ Muhammad al Hussein				960	✓	✓	✓	✓	✓	✓
✓ Hadie al Hussein				✓	✓	✓	✓	✓	✓	✓
✓ Yousa rahim Ibrahim				✓	✓	✓	✓	✓	✓	✓
✓ Ibrahim				✓	✓	✓	✓	✓	✓	✓
✓ Ali Ali Mahamad				✓	✓	✓	✓	✓	✓	✓

double pay

	28/4	ahad 29/4	30/4	1/5	2/5	3/5	4/5	5/5	6/5	7/5	8/5	9/5	10/5	Fri 9/60
✓ Sarah Ahmed	✓	✓	✓	✓	✓	✓	✓	✓	✓	✓	✓	✓	✓	960
✓ Hussein Nasser	✓	✓	✓	✓	✓	✓	✓	✓	✓	✓	✓	✓	✓	960
✓ Fausa	✓	✓	✓	✓	✓	✓	✓	✓	✓	✓	✓	✓	✓	900
✓ Zakia Hussein	✓	✓	✓	✓	✓	✓	✓	✓	✓	✓	✓	✓	✓	960
✓ Hassan al Hassan														480
✗ Hussein al Abd														720
✗ Hafid al Hassan														
✓ Aida al Hassan	✓	✓	✓	✓	✓	✓	✓	✓	✓	✓	✓	✓	✓	960
✓ Ahmed Shilash	✓	✓	✓	✓	✓	✓	✓	✓	✓	✓	✓	✓	✓	960
✗ Hadie Awad	✓	✓	✓	✓	✓	✓	✓	✓	✓	✓	✓	✓	✓	960
✗ Abdul Hussein	✓	✓	✓	✓	✓	✓	✓	✓	✓	✓	✓	✓	✓	960
✗ Hadija Allowe	✓	✓	✓	✓	✓	✓	✓	✓	✓	✓	✓	✓	✓	960

(46)

15
x 60
900

- ✓ Hammadi Yasser
- ✓ Hussein Yamedi
- ✓ Yahya Ali
- ✓ M. Kerby
- ✓ Omar
- ✓ Hadija Yah
- ✓ * Hajj Tahd
- ✓ * Amour Tah
- ✓ * Turkiye Ta
- ✓ Haja Ado
- ✓ Fatouma
- ✓ Hadija
- ✓ Ahmed
- ✓ * Douma
- ✓ Haja M
- ✓ Mahmou
- ✓ * Amour
- ✓ Zurky
- ✓ Mous
- ✓ Ibrahim
- ✓ Sahab
- ✓ Hale
- ✓ Smal
- ✓ Han
- ✓ Zur
- ✓ Kre
- ✓ Me
- ✓ Fatta
- ✓ Az
- ✓ Naziha
- ✓ Naha
- ✓ Eunice (Botus)

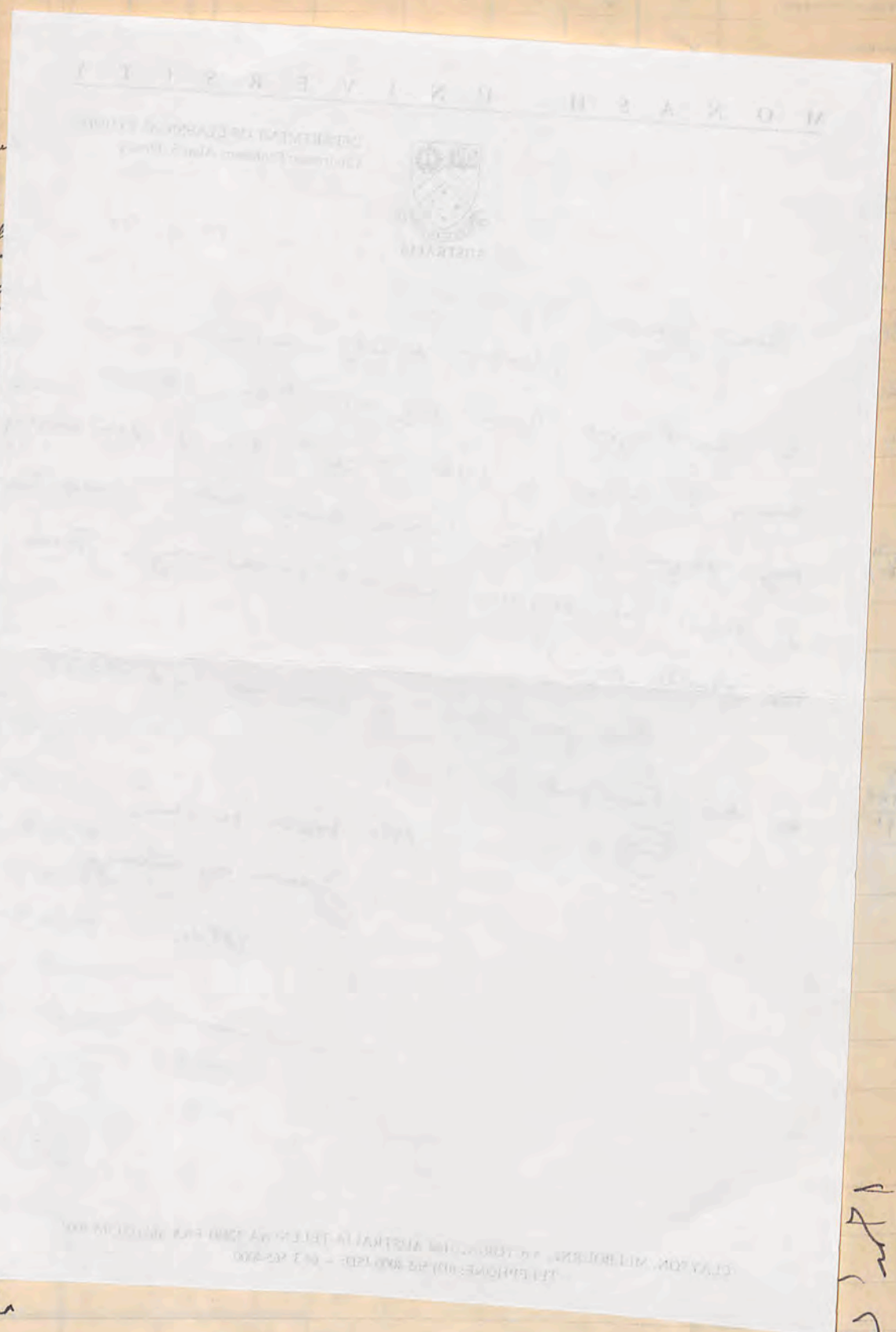

ACROPOLIS - DUMPY LEVELS. (10.6.90)
(In Cons)

DATUM = NW Corner of Stylobate. (= 296.3 cms)

	Reading	Datum= 0	Datum= 100	Description
1	216.9	+79.4	179.4	T2015 Rm 1 Floor
2	216.0	+80.3	180.3	T2015 Rm 2 Floor
3	199.8	+96.5	196.5	" " Threshold
4	234.6	+61.7	161.7	" Rm 3 Floor
5	200.6	+95.7	195.7	" Rm 3 Threshold
6	203.5	+92.8	192.8	T2015 Rm 3 South threshold
6a	370.8	+74.5	23.3	Rm 3 Bedrock (Foundatn. Trench)
7	221.0	+75.3	175.3	T2015 Rm 4 Floor
8	184.5	+111.8	211.8	T2015 Rm 4 platform
9	217.5	+78.8	178.8	T2015 Rm 4 threshold
10	236.3	+60.0	160.0	T2015 Rm 5 threshold.
11	252.0	+44.3	144.3	T20 Threshold
12	268.5	+27.8	127.8	T20 Floor 1
13	299.0	-2.7	97.3	" Floor 2
14	302.0	-5.7	94.3	" Foundation Trench Wall
15	319.5	-23.3	76.7	" Foundation Trench s. of stylob.
15	295.0	-7.3	76.7	" Foundation Trench s. of stylob.
16	321.0	-15.7	84.3	" F. Trench n. of stylobate
17	337.5	-80.2	19.8	" Bedrock pit
17	307.0	-80.2	19.8	" Bedrock pit
18	295.0	-1.3	98.7	" S. E corner of stylobate
19	295.0	-1.3	98.7	" W. end of stylobate
20	307.0	-10.7	89.3	" Corner of cistern & bedrock
21	245.0	+51.3	151.3	T17 Floor 1a
22	272.0	24.3	124.3	" Foundation Trench south
23	251.0	45.3	145.3	" Stylobate
24	271.0	25.3	125.3	" Floor 2
25	292.0	4.3	104.3	" Foundation Trench north
26	252.9	43.4	143.4	T21 Floor 1
27	230.0	66.3	166.3	Threshold 1
28	242.0	54.3	154.3	Floor 3
29	246.0	30.3	130.3	Floor 4
30	241.0	55.3	155.3	Threshold 2

- ✓ Hammadi Yasser
- ✓ Hussein Yamedi
- ✓ Yahike Ali
- ✓ Mherby
- ✓ Omar
- ✓ Hadije Yahike
- ✓ * Hajj Taha
- ✓ * Amour Taha
- ✓ * Turkiye Taha
- ✓ Haja Adaha
- ✓ Fatouma Yamedi
- ✓ Hadija
- ✓ Ahmed Yahike
- ✓ * Douma
- ✓ Haja Mouna
- ✓ Mahmoud.
- ✓ * Amouna.
- ✓ Turkiye Haja Mouna
- ✓ Mouna Abdou
- ✓ Ibrahim Mouna
- ✓ Sahab Mouna
- ✓ Halid Mouna
- ✓ Smale al Hassan
- ✓ Hannan Hussein
- ✓ Turkiye Hussein (Botrus)
- ✓ Krema Meherdi. (Botrus)
- ✓ Naya Yahike
- ✓ Fatam. Fausa
- ✓ Azis
- ✓ Nazika
- ✓ Naha
- ✓ Eunice (Botrus).

left out

عليه

عليه السلام
عليه السلام

عليه السلام

M O N A S H U N I V E R S I T Y



DEPARTMENT OF CLASSICAL STUDIES
Chairman: Professor Alan S. Henry

19 2 91

Dear James,
Photos safely received, and I shall give them my attention. But may I have a little time? A.C. is demanding my paper on the Torone lead letters, and I have the Athens lecture under way. Term too starts soon!

I'll see what I can do, but don't be too hopeful!

All best wishes
James as always,
Alan.

	Ready	Datum=0	Datum=100	Description
31	237.0	59.3	159.3	T18 Floor 1
32	258.5	37.8	137.8	" Floor 2
33	263.0	33.3	133.3	" Floor 4
34	274.5	21.8	121.8	" Floor 5
35	270.0	26.3	126.3	" Floor 3
36	280.0	16.3	116.3	" Foundatn. Trench North
37	252.0	44.3	144.3	" Threshold
38	260.0	36.3	136.3	T19 Floor 1
39	278.0	18.3	118.3	Floor 2
40	285.0	11.3	111.3	Bedrock
41	288.5	7.8	107.8	Bedrock 2

Sketch of Locations:

