

Rankov T9
J-K Acropolis 1989



1989
 T-K Acropolis
 1989



AK T9 Loci

Locus 1 represents topsoil and fill of trench 1 (the two
 being indistinguishable), commenced 8/5/89

N. of back wall of peristyle

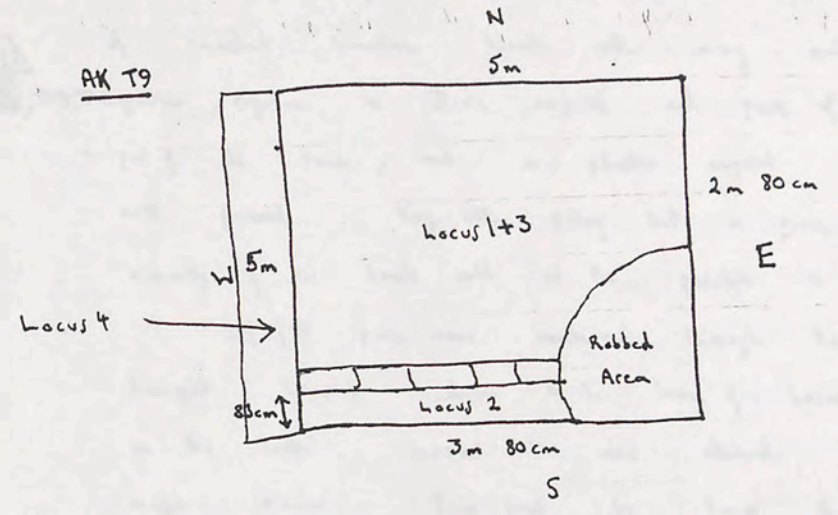

Locus 2 represents topsoil and fill of trench 5 of back wall of peristyle,
 commenced 10/5/89

Locus 3 represents the floor level below Locus 1, reached 16/5/89

Locus 4 represents demolition of the bank between T9 and T8 to
 the west, commenced 21/5/89

AK T9 Work Diary

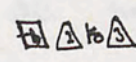
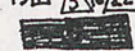
Locus 1 commenced 8/5/89 with pick runs through topsoil in producing several smashed blocks, two guttae and a regula
T9  northern portion of trench to level with southern portion. A great deal of smashed limestone block with many architectural fragments found, including 9/5/89
, T93, T92 guttae, regulae, a Doric capital and piece of entablature in the north-western

T9-14 part of the trench, and a pilaster capital on the east side, all three well preserved. Very little pottery but a piece of gypsum discovered in the vicinity of the back wall of the peristyle in the southern portion of the trench.

10/5/89 pick runs continued through topsoil and fill, revealing further architectural fragments and smashed blocks and, having brought Locus 1 down to the level of Locus 2, pick runs were begun in the latter. Locus 1 was cleared and levels taken for the major blocks. Pick runs in Locus 2 revealed mainly earth fill with

T9- few stones and little pottery, except for a lion-headed water spout found at the eastern end. The trench was then planned.

11/5/89 The top layer of stones and smashed blocks was cleared from Locus 1 and pick runs continued there, producing fewer small stones and more earth fill with more pottery than before, and also a small quantity of bone at the E end of the trench.

13/5/89 After the rest day, pick runs continued in Locus 1 further revealing the tangle of large blocks in the central portion of the trench, including one marked with two lines and another with moulding round two sides. On the eastern side of the trench there were no large blocks only earth fill containing some pottery and a quantity of bone towards the bottom. On the western side of the trench there were large blocks and some pottery with small quantities of charcoal, bone and glass towards the bottom.

T9  14/5/89 Pick runs in the southern portion of Locus 1 were completed producing a little pottery and a small moulded architectural fragment and pick runs then continued in Locus 2 and to define the trench edges in the rolled area producing slightly more pottery, a fragment of bone and some charcoal in the central portion of the Locus. Locus 1 was then photographed and the whole trench planned.

15/5/89 After completion of the trench plan, all the planned large stones were removed from Locus 1 apart from the wall blocks and pick runs continued in the remaining soil including a large pillar

of earth left under T9-5 on the west side. Some pottery, charcoal and bone was produced and a small fragment of white wall plaster with black and red painted lines.

T9 27

16/5/89 Pick was continued through the last six inches of fill down to the natural limestone (Locus 3) to floor level in the northern part of the trench so as to determine the position of the floor before coming down to floor level over the foundation track of the wall. The fill contained some stones, rather more pottery than before, some pieces of plaster, a piece of gypsum, a bronze coin (?), a ring bezel, and

T9 28 29

Three detached-over nails in the north-eastern corner, towards floor level more bone and charcoal, the fill just on top of the floor tending to be slightly blackened. The floor (Locus 3) also produced some pottery lying directly upon it. Approximately two-thirds of the north-eastern part of the trench was brought down to the floor level

17/5/89 Clearing of Floor (Locus 3) including removal of stones on the floor completed & producing bone,

T9 30

charcoal and some pottery on the floor as well as further iron nails, a The foundation track of the wall was however left intact.

T9 31 to 32

pebble scraper and a bronze coin. Burning including burnt pottery was noted very clearly on the floor in the eastern bank at c. 1m from the north-east corner of the trench. T9-46 was left on the floor of the trench, Locus 3 was cleaned, and it was then photographed.

18/5/89 Locus 2 was cleaned to floor level and trench T10 was then marked out. Work on T10 was begun with clearance of part

of a rubble spoil heap encroaching on the north-eastern corner

21/5/89 The bank between T9 and T3 to the west was demolished (Locus 4)

22/5/89 The bank (Locus 4) was further demolished and cleared

T9 33

producing bone, basalt and pottery, and also a large nail and other nails

[Faint, illegible handwritten text on the left page]

2.

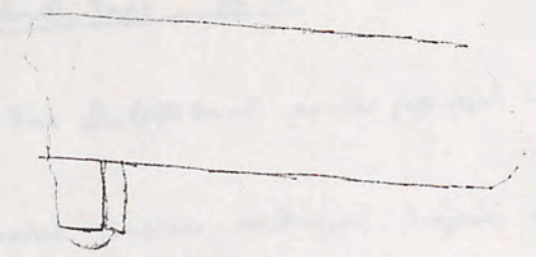

① ② △ 8/5/89 limestone architectural fragment

3.



① ③ △ 8/5/89 Two limestone guttae

7.

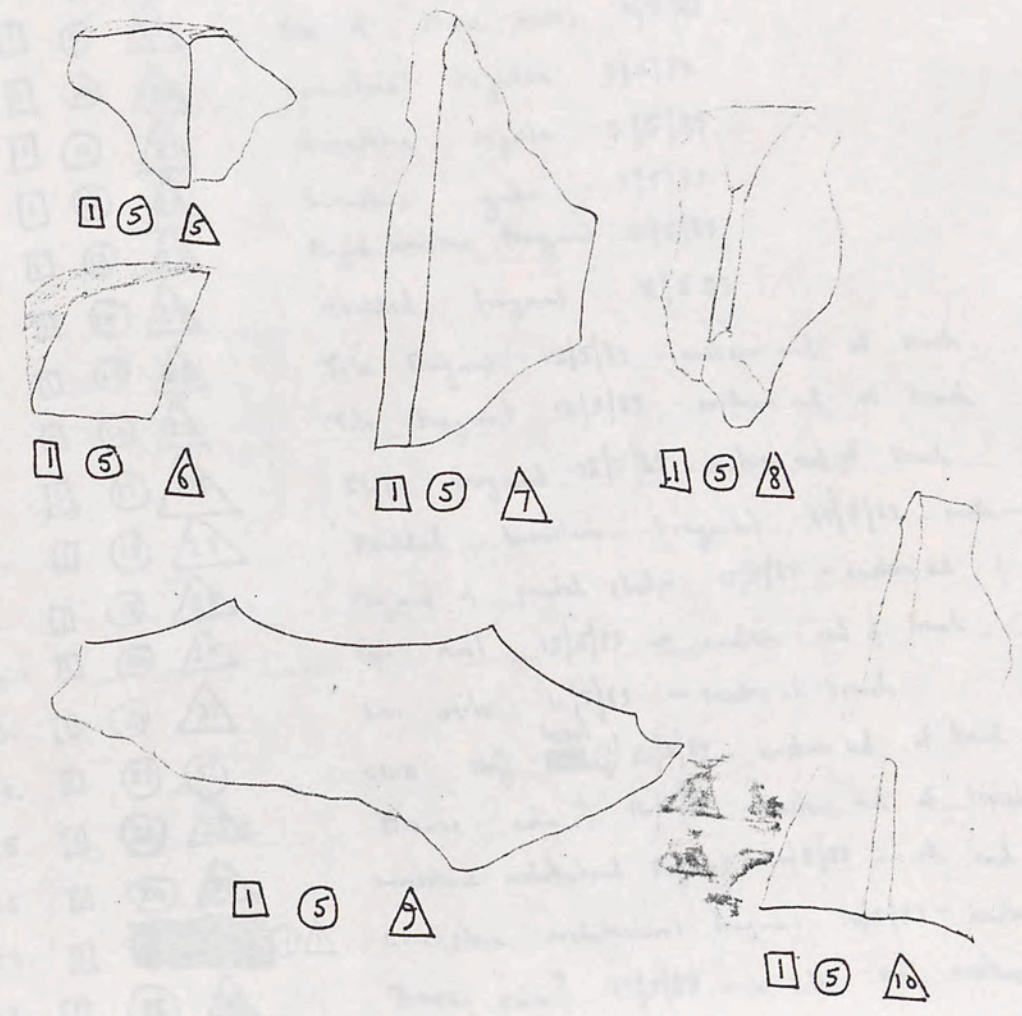

① ⑤ △ 9/5/89 Pieces of fluting

①
①

Small Finds AK T9

1. Locus II Bag ① Find \triangle 8/5/89 Small circular glass-object Found in topsoil on west side of trench.
2. \square ② \triangle 8/5/89 - worked limestone architectural fragment in topsoil on north side of trench
3. \square ③ \triangle Two limestone guttae in topsoil on south side of trench 8/5/89
4. \square ④ \triangle Small iron fragment in topsoil in middle of trench 9/5/89
5. \square ① \triangle Small pebble counter? in topsoil at west end of trench 10/5/89
6. \square ② \triangle Iron nail in fill at west end of trench 10/5/89
7. \square ⑤ \triangle Pieces of fluting 9/5/89
8. \square ⑥ \triangle 11-13 Angled limestone architectural fragments 9/5/89
9. \square ⑦ \triangle 14-17 Roulded limestone architectural fragments 9/5/89
10. \square ⑧ \triangle Cornice moulding 9/5/89
11. \square ⑨ \triangle Toe of stone vessel 9/5/89
12. \square ⑩ \triangle Limestone regulae 9/5/89
13. \square ⑪ \triangle Limestone regula 9/5/89
14. \square ⑫ \triangle Limestone gutta 9/5/89
15. \square ⑬ \triangle Angled limestone fragment 11/5/89
16. \square ⑭ \triangle Roulded fragment 11/5/89
17. \square ⑮ \triangle Tile fragment 13/5/89 - eastern end of trench
18. \square ⑯ \triangle Tile fragment 13/5/89 - southern end of trench
19. \square ⑰ \triangle Glass fragment 13/5/89 - western end of trench
20. \square ⑱ \triangle Roulded limestone fragment 14/5/89 - south-west end of trench
21. \square ⑲ \triangle Fragment of painted plaster 15/5/89 - eastern end of trench
22. \square ⑳ \triangle Iron nail 15/5/89 - eastern end of trench
23. \square ㉑ \triangle Iron nails 16/5/89 - centre of trench
24. \square ㉒ \triangle Glass ring bezel (?) 16/5/89 - eastern end of trench
25. \square ㉓ \triangle Bronze coin? 16/5/89 - eastern end of trench
26. \square ㉔ \triangle Limestone architectural fragment 16/5/89 - north end of trench
27. \square ㉕ \triangle Limestone architectural fragment 16/5/89 - centre of trench
28. \square ㉖ \triangle Bronze coin? 17/5/89 - in fill on western side of trench
28. \square ② \triangle Pebble scraper 17/5/89 - on floor on south side of trench
29. \square ③ \triangle Iron nails 17/5/89 - on floor on eastern side of trench
30. \square ① \triangle Iron nails 22/5/89 - on southern side of trench
31. \square ㉗ \triangle Stamped amphora handle 16/5/89
32. \square ㉘ \triangle Beaded limestone fragment - found in spoil 23/5/89

17. 18. 1887

1887/10/10
 1887/10/11
 1887/10/12
 1887/10/13
 1887/10/14
 1887/10/15
 1887/10/16
 1887/10/17
 1887/10/18
 1887/10/19
 1887/10/20
 1887/10/21
 1887/10/22
 1887/10/23
 1887/10/24
 1887/10/25
 1887/10/26
 1887/10/27
 1887/10/28
 1887/10/29
 1887/10/30
 1887/10/31
 1887/11/1
 1887/11/2
 1887/11/3
 1887/11/4
 1887/11/5
 1887/11/6
 1887/11/7
 1887/11/8
 1887/11/9
 1887/11/10
 1887/11/11
 1887/11/12
 1887/11/13
 1887/11/14
 1887/11/15
 1887/11/16
 1887/11/17
 1887/11/18
 1887/11/19
 1887/11/20
 1887/11/21
 1887/11/22
 1887/11/23
 1887/11/24
 1887/11/25
 1887/11/26
 1887/11/27
 1887/11/28
 1887/11/29
 1887/11/30
 1887/12/1
 1887/12/2
 1887/12/3
 1887/12/4
 1887/12/5
 1887/12/6
 1887/12/7
 1887/12/8
 1887/12/9
 1887/12/10
 1887/12/11
 1887/12/12
 1887/12/13
 1887/12/14
 1887/12/15
 1887/12/16
 1887/12/17
 1887/12/18
 1887/12/19
 1887/12/20
 1887/12/21
 1887/12/22
 1887/12/23
 1887/12/24
 1887/12/25
 1887/12/26
 1887/12/27
 1887/12/28
 1887/12/29
 1887/12/30
 1888/1/1
 1888/1/2
 1888/1/3
 1888/1/4
 1888/1/5
 1888/1/6
 1888/1/7
 1888/1/8
 1888/1/9
 1888/1/10
 1888/1/11
 1888/1/12
 1888/1/13
 1888/1/14
 1888/1/15
 1888/1/16
 1888/1/17
 1888/1/18
 1888/1/19
 1888/1/20
 1888/1/21
 1888/1/22
 1888/1/23
 1888/1/24
 1888/1/25
 1888/1/26
 1888/1/27
 1888/1/28
 1888/1/29
 1888/1/30
 1888/1/31
 1888/2/1
 1888/2/2
 1888/2/3
 1888/2/4
 1888/2/5
 1888/2/6
 1888/2/7
 1888/2/8
 1888/2/9
 1888/2/10
 1888/2/11
 1888/2/12
 1888/2/13
 1888/2/14
 1888/2/15
 1888/2/16
 1888/2/17
 1888/2/18
 1888/2/19
 1888/2/20
 1888/2/21
 1888/2/22
 1888/2/23
 1888/2/24
 1888/2/25
 1888/2/26
 1888/2/27
 1888/2/28
 1888/2/29
 1888/2/30
 1888/3/1
 1888/3/2
 1888/3/3
 1888/3/4
 1888/3/5
 1888/3/6
 1888/3/7
 1888/3/8
 1888/3/9
 1888/3/10
 1888/3/11
 1888/3/12
 1888/3/13
 1888/3/14
 1888/3/15
 1888/3/16
 1888/3/17
 1888/3/18
 1888/3/19
 1888/3/20
 1888/3/21
 1888/3/22
 1888/3/23
 1888/3/24
 1888/3/25
 1888/3/26
 1888/3/27
 1888/3/28
 1888/3/29
 1888/3/30
 1888/3/31
 1888/4/1
 1888/4/2
 1888/4/3
 1888/4/4
 1888/4/5
 1888/4/6
 1888/4/7
 1888/4/8
 1888/4/9
 1888/4/10
 1888/4/11
 1888/4/12
 1888/4/13
 1888/4/14
 1888/4/15
 1888/4/16
 1888/4/17
 1888/4/18
 1888/4/19
 1888/4/20
 1888/4/21
 1888/4/22
 1888/4/23
 1888/4/24
 1888/4/25
 1888/4/26
 1888/4/27
 1888/4/28
 1888/4/29
 1888/4/30
 1888/4/31
 1888/5/1
 1888/5/2
 1888/5/3
 1888/5/4
 1888/5/5
 1888/5/6
 1888/5/7
 1888/5/8
 1888/5/9
 1888/5/10
 1888/5/11
 1888/5/12
 1888/5/13
 1888/5/14
 1888/5/15
 1888/5/16
 1888/5/17
 1888/5/18
 1888/5/19
 1888/5/20
 1888/5/21
 1888/5/22
 1888/5/23
 1888/5/24
 1888/5/25
 1888/5/26
 1888/5/27
 1888/5/28
 1888/5/29
 1888/5/30
 1888/5/31
 1888/6/1
 1888/6/2
 1888/6/3
 1888/6/4
 1888/6/5
 1888/6/6
 1888/6/7
 1888/6/8
 1888/6/9
 1888/6/10
 1888/6/11
 1888/6/12
 1888/6/13
 1888/6/14
 1888/6/15
 1888/6/16
 1888/6/17
 1888/6/18
 1888/6/19
 1888/6/20
 1888/6/21
 1888/6/22
 1888/6/23
 1888/6/24
 1888/6/25
 1888/6/26
 1888/6/27
 1888/6/28
 1888/6/29
 1888/6/30
 1888/6/31
 1888/7/1
 1888/7/2
 1888/7/3
 1888/7/4
 1888/7/5
 1888/7/6
 1888/7/7
 1888/7/8
 1888/7/9
 1888/7/10
 1888/7/11
 1888/7/12
 1888/7/13
 1888/7/14
 1888/7/15
 1888/7/16
 1888/7/17
 1888/7/18
 1888/7/19
 1888/7/20
 1888/7/21
 1888/7/22
 1888/7/23
 1888/7/24
 1888/7/25
 1888/7/26
 1888/7/27
 1888/7/28
 1888/7/29
 1888/7/30
 1888/7/31
 1888/8/1
 1888/8/2
 1888/8/3
 1888/8/4
 1888/8/5
 1888/8/6
 1888/8/7
 1888/8/8
 1888/8/9
 1888/8/10
 1888/8/11
 1888/8/12
 1888/8/13
 1888/8/14
 1888/8/15
 1888/8/16
 1888/8/17
 1888/8/18
 1888/8/19
 1888/8/20
 1888/8/21
 1888/8/22
 1888/8/23
 1888/8/24
 1888/8/25
 1888/8/26
 1888/8/27
 1888/8/28
 1888/8/29
 1888/8/30
 1888/8/31
 1888/9/1
 1888/9/2
 1888/9/3
 1888/9/4
 1888/9/5
 1888/9/6
 1888/9/7
 1888/9/8
 1888/9/9
 1888/9/10
 1888/9/11
 1888/9/12
 1888/9/13
 1888/9/14
 1888/9/15
 1888/9/16
 1888/9/17
 1888/9/18
 1888/9/19
 1888/9/20
 1888/9/21
 1888/9/22
 1888/9/23
 1888/9/24
 1888/9/25
 1888/9/26
 1888/9/27
 1888/9/28
 1888/9/29
 1888/9/30
 1888/9/31
 1888/10/1
 1888/10/2
 1888/10/3
 1888/10/4
 1888/10/5
 1888/10/6
 1888/10/7
 1888/10/8
 1888/10/9
 1888/10/10
 1888/10/11
 1888/10/12
 1888/10/13
 1888/10/14
 1888/10/15
 1888/10/16
 1888/10/17
 1888/10/18
 1888/10/19
 1888/10/20
 1888/10/21
 1888/10/22
 1888/10/23
 1888/10/24
 1888/10/25
 1888/10/26
 1888/10/27
 1888/10/28
 1888/10/29
 1888/10/30
 1888/10/31
 1888/11/1
 1888/11/2
 1888/11/3
 1888/11/4
 1888/11/5
 1888/11/6
 1888/11/7
 1888/11/8
 1888/11/9
 1888/11/10
 1888/11/11
 1888/11/12
 1888/11/13
 1888/11/14
 1888/11/15
 1888/11/16
 1888/11/17
 1888/11/18
 1888/11/19
 1888/11/20
 1888/11/21
 1888/11/22
 1888/11/23
 1888/11/24
 1888/11/25
 1888/11/26
 1888/11/27
 1888/11/28
 1888/11/29
 1888/11/30
 1888/11/31
 1888/12/1
 1888/12/2
 1888/12/3
 1888/12/4
 1888/12/5
 1888/12/6
 1888/12/7
 1888/12/8
 1888/12/9
 1888/12/10
 1888/12/11
 1888/12/12
 1888/12/13
 1888/12/14
 1888/12/15
 1888/12/16
 1888/12/17
 1888/12/18
 1888/12/19
 1888/12/20
 1888/12/21
 1888/12/22
 1888/12/23
 1888/12/24
 1888/12/25
 1888/12/26
 1888/12/27
 1888/12/28
 1888/12/29
 1888/12/30
 1888/12/31

8.

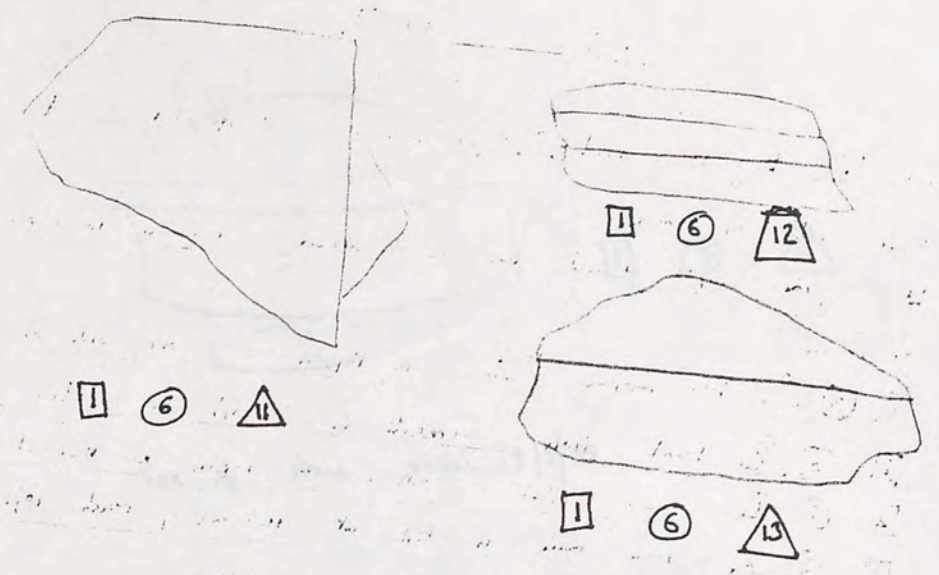

Angled limestone fragments 9/5/89

9.

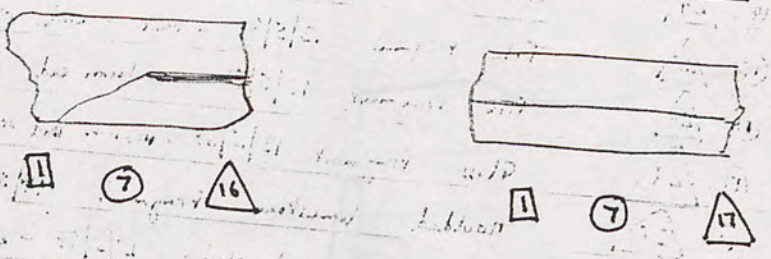
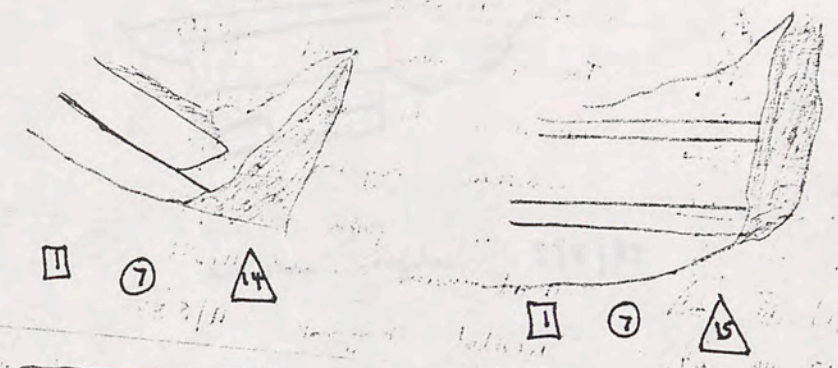

Modded limestone architectural fragments 9/5/89

10.

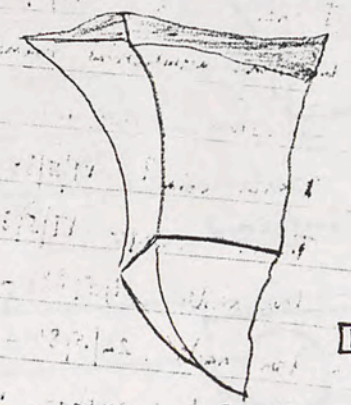

Corbel moulding 9/5/89

11.

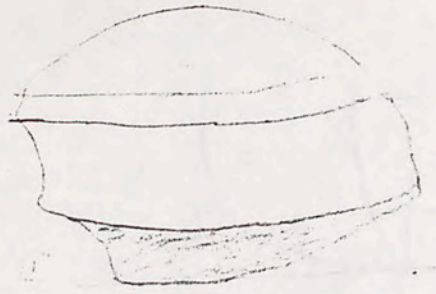

□ 9 △ 17

Toe of stone vessel 9/5/89

12.

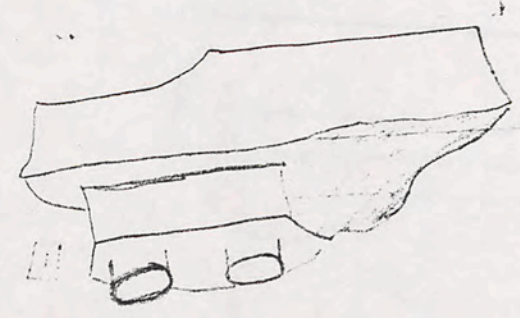

□ 10 △ 20

Limestone regulae 9/5/89

13.

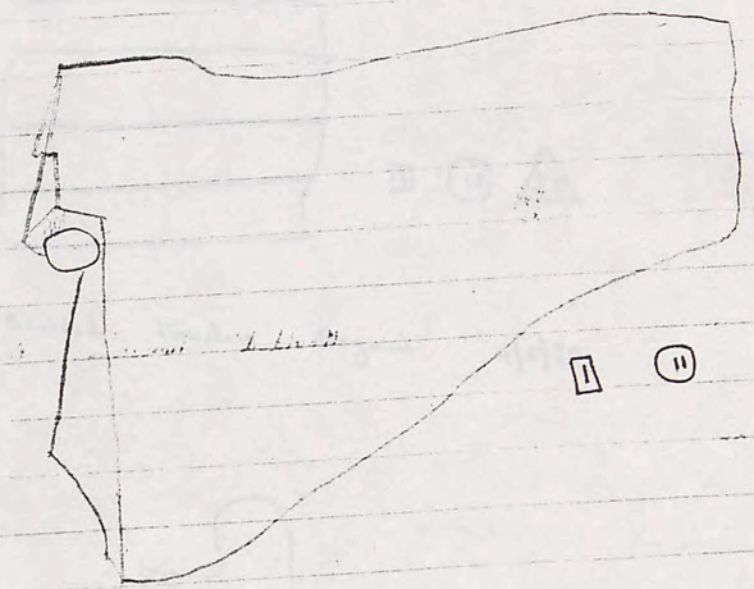

□ 11 △ 21

Limestone Regula 9/5/89

14.

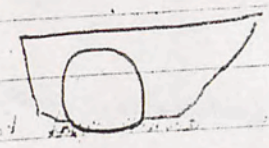

□ 12 △ 22

Limestone gutta 9/5/89



□ 13 △ 23

Angled limestone fragment 11/5/89

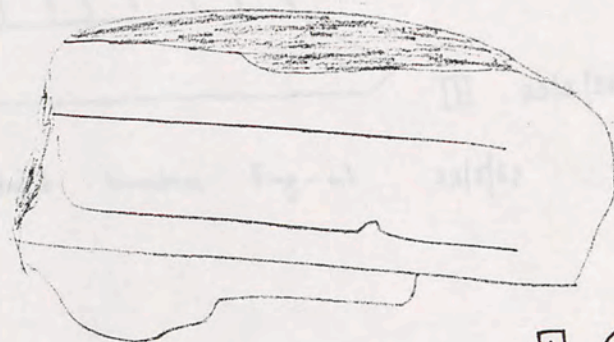

□ 14 △ 24

Moulded limestone fragment 11/5/89

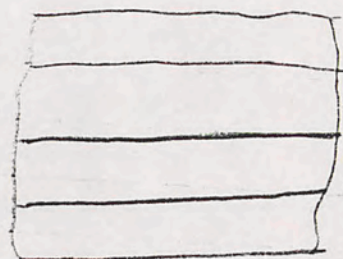

□ 18 △ 28

Moulded limestone fragment 4/5/89



□ 24 △ 34

Limestone architectural fragment 16/5/89



16/5/89

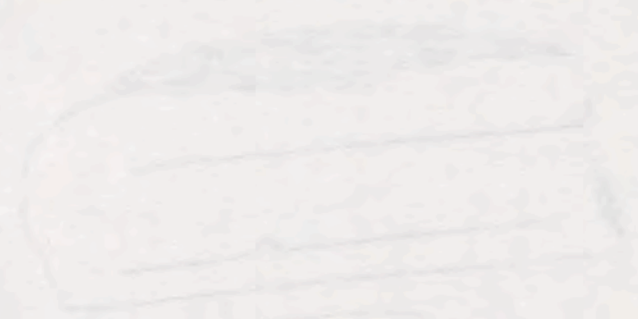

16/5/89

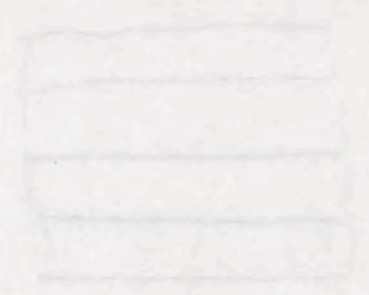

16/5/89

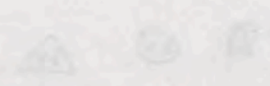

16/5/89

27.

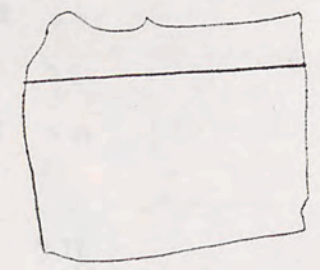

Limestone architectural fragment



16/5/89

28.

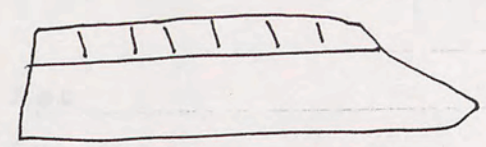

Beaded limestone fragment

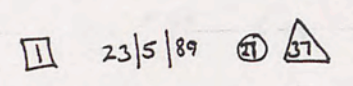

23/5/89



T9-5

	N	S			
	3.20	3.25			
	2.75	3.91		12	4.73 5.10
	2.88	3.24			4.62 5.34
	2.25	4.02		15	5.22 6.96
1	1.62	4.72			5.25 7.38
	1.38	4.77			4.96 6.79
	1.58	4.50			4.95 7.18
	2.00	4.24		13	4.90 5.76
2	1.73	5.04			4.49 6.19
	1.87	5.50		14	4.70 5.91
	2.15	5.30			4.91 6.57
4	2.42	4.56			5.30 6.05
3	2.42	4.82			5.32 <u>6.562</u>
	2.22	5.56			12.35
	1.51	5.56		17	5.55 5.45
	2.08	4.80			6.10 5.80
21	6.30	3.63		16	5.62 4.86
26	2.39	5.39			6.06 5.22
10	2.91	4.31		8	3.76 4.90
	3.12	3.87			3.63 4.00
9	3.60	5.95		7	3.99 4.95
	4.14	6.20			3.05 4.70
	3.67	5.68			2.88 4.06
11	4.02	4.57			N 4.38 3.71
	4.50	4.80			5.85 4.51
	4.35	5.23			6.08 4.79
	3.82	4.99			6.92 4.66
					6.27 4.93
					4.50 2.12

↑
N

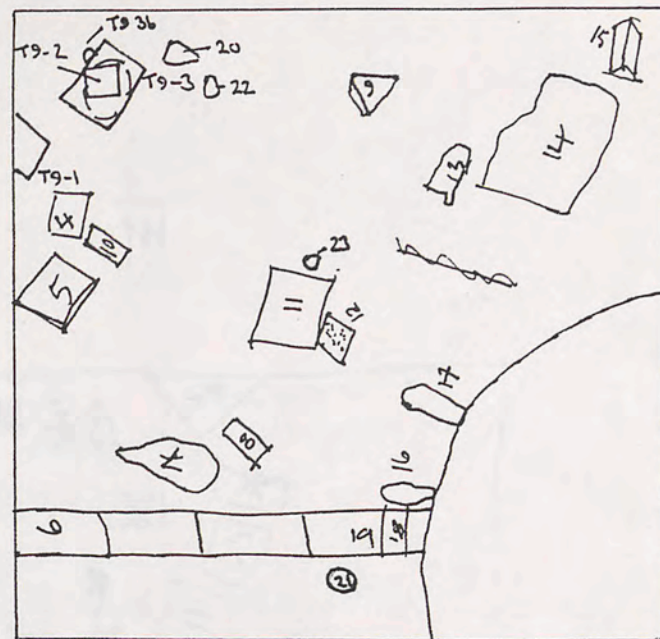

Trench T2



HEIGHT OF INSTRUMENT RE: T2 DATUM

			2583	2559
T9-1	Building block - height above T2 Datum - 1828	8/5/89	0855	
T9-2	Cornice block - 1575	9/5/89	1008	
T9-3	Doric capital A - 1325 T9-3b Fragment of moulded echinus lying against it; T9-3c abacus fragment found on E side of trench	9/5/89	1258	
T9-4	Building block - 1356	9/5/89	1227	
T9-5	Building block - 1636	8/5/89	0947	
T9-6	Wall block - 1235	9/5/89	1348	1317
T9-7	Building block - 1246	9/5/89	1337	
T9-8	Building block - 1220	9/5/89	1363	
T9-9	Building block - 1075	9/5/89	1377	1484
T9-10	Building block with beam slot? - 1186 - guttering	9/5/89	1377	
T9-11	Building block - 1109	9/5/89		1450
T9-12	Fragment of building block with part-picked surface - 1330	9/5/89		1229
T9-13	Architectural fragment - 1304	9/5/89		1255
T9-14	Pilaster capital - 1546 - with inscribed Δ	8/9/5/89		1013
T9-15	Building block - 1479	8/5/89		1080
T9-16	Shattered column? - 1819	9/5/89		1440
T9-17	Shattered column - 1380	9/5/89		1249
T9-18	Wall block - 1255	9/5/89		1304
T9-19	Wall block - 1253	9/5/89		1306
T9-20	Building block - 1123 with striations	9/5/89		1436

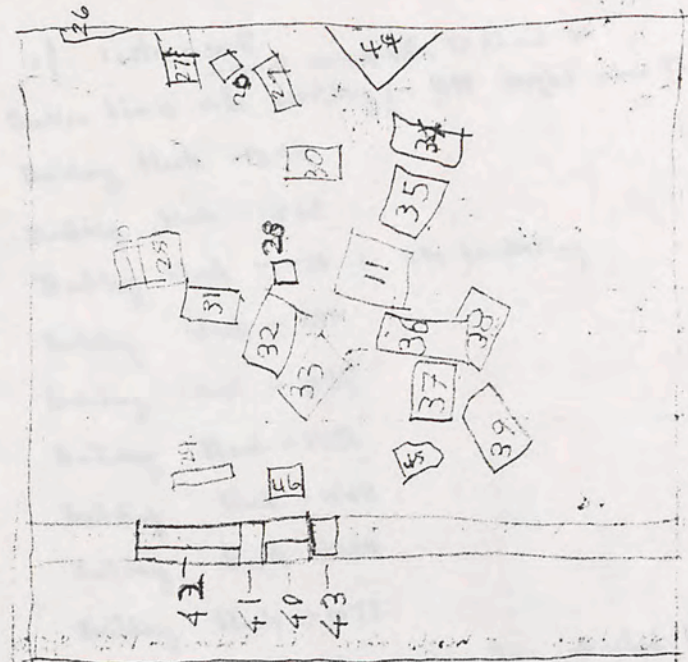

	S	N	S	N	S	N	S	N	
24	297	317	28	440	366	33	363	442	
	277	407		455	385		781	468	
	252	450		435	403		211 468		
	309	395	29	546	326		455	450	
25	393	362		553	309		434	429	
	311	326		566	289	34	565	370	
	447	340		502	225		592	364	
	456	385	30	459	340		592	422	
26	552	128		509	384		676	420	
	571	161		477	309	35	594	575	
	562	113		511	322		586	342	
27	574	221		31	352	388		527	429
	593	234		364	359			519	389
	577	181		417	365	36	701	502	
28	585	242		408	393		520	492	
	542	240		32	379	436		492	450
	548	278		426	430		477	460	
				122	403				

T9-21 Lion-headed waterspout — c. 1193
 T9-22 curved stone found near end on same level as T9-3 — unplanned 8/5/89
 T9-23 Moulded fragment from middle of trench 11/5/89

10/5/89

LEVELS 14/5/89 T9

Height of instrument - part of cornice with T9 23 and 45 - part of T9-24 + 45 cornice middle of trench 11/5/89		Datum Ready 2396
T9-24 Broken block with moulding	- 1189 height above T2	1207
25 Building block	- 1284	1112
26 Building block	- 1042	1354
27 Building block	- 978 — with bracketing	1425
28 Building block	- 890	1506
29 Building block	- 1126	1270
30 Building block	- 1251	1145
31 Building block	- 1002	1314
32 Building block	- 1264	1132
33 Building block	- 1071	1325
34 Building block, broken, originally attached to 39		1349
35 Building block	- 1047	1215
36 Building block	- 1183 — with pitted surface	1323
37 Building block	- 1073	1452
38 Building block	- 944	1367
39 Building block	- broken, originally attached to 44 — 1029	1693
40 Wall block — stretcher	- 703	1711
41 Wall block — header	- 685	1695
42 Wall block — stretcher	- 701	1268
43 Wall block — decayed header	- 1128	

CONSTRUCTION BLOCKS MEASURED 16/5/89

- T9-38 59 x 31 x 31
- T9-36 58 x 24 x 31.5
- T9-31 61 x 39 x 29.5
- T9-15 57 x 63.0 x 27.5
- T9-32 44 x 61 x 30.5

LEVELS 17/5/89

HOI	-	2385
T9-44		1132
T9-45		1745
T9-46		1756

- Δ 1253 - Building block
- Δ 640 - cornice moulding - the other side of T9-27
- Δ 629 - Building block

44	5	N
	632	311
	602	279
	624	370
	602	321

45	430	459
	447	449
	457	457
	464	464

46	300	439
	337	465
	337	359
	365	427

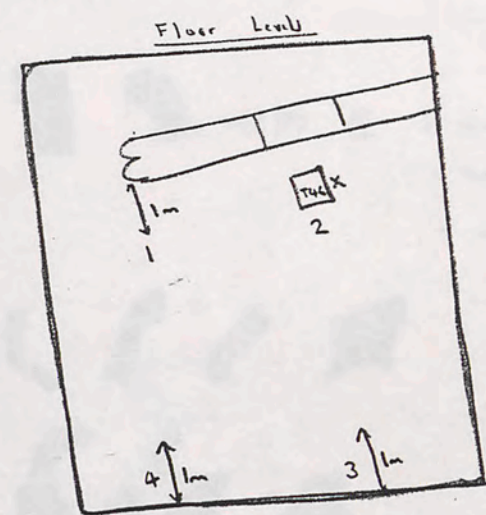

Height of Instrument above 2 = 3.33		
1	3-00	1. 0.33
2	3-00	2. 0.33
3	3-03	3. 0.30
4	3-01	4. 0.32

AK T9 Pottery

- 8/5/89 [1] 1 piece amphora handle
 2 coarseware rims
 1 gorged coarseware bodysherd
 9 bodysherds

- 9/5/89 [1] 1 bodysherd sieve pot
 1 rouletted bodysherd
 1 coarseware handle
 1 local red glaze rim
 18 bodysherds







- 10/5/89 [2] 2 coarseware rims
 1 white clay handle
 1 bodysherd

- 10/5/89 [1] 1 coarseware base
 1 local fineware base
 4 coarseware bodysherds







- 11/5/89 [1] 4 coarseware rims
 2 coarseware handle-bases
 2 local red glaze rims
 4 coarseware bases
 1 ribbed bodysherd
 1 white clay bodysherd
 1 fine red glaze bodysherd
 2 tile fragments
 2 blackened cooking-ware bodysherds
 56 bodysherds



- 13/5/89 1 amphora handle
 2 unguentaria toes
 1 amphora rim
 1 local red slip base
 1 drip painted rim
 1 coarseware water jar rim
 1 circular coarseware base



- 1 local red slip rim 
- 1 blackened cooking ware rim 
- 1 coarseware rim 
- 1 fine red slip rim 
- 1 dark red slip base 
- 1 fragmentary dark red slip base
- 3 dark red slip bodysheds
- 1 coarse dark gritty bodyshed
- 1 coarseware base 
- 1 black burnished echinus bowl rim 
- 1 painted coarseware bodyshed red on black?
- 1 grooved coarseware bodyshed
- 1 decorated grooved coarseware bodyshed
- 88 coarseware bodysheds

- 14/5/89 Locus 11 9 coarseware bodysheds
- 14/5/89 Locus 2 12 coarseware bodysheds

- 15/5/89 Locus 11 1 water-jar rim 
- 1 coarseware rim 
- 1 painted rim 
- 1 coarseware rim 
- 1 coarseware base 
- 1 coarseware base centre 
- 1 coarseware handle 
- 2 cooking ware bodysheds with blackened interiors
- 1 internally ribbed coarseware bodyshed
- 1 fragmentary local red-slip base
- 2 local red-slip bodysheds
- 35 coarseware bodysheds

- 16/5/89 3 coarseware handles   
- 1 coarseware bodyshed with incised line
- 6 coarseware bodysheds

16/5/89

1

- 1 large pic-cant water-jar rim and bodysherd
- 1 local red slip rim
- 4 bodysherds of a large gouge-decorated water jar
- 1 coarseware fish-plate base
- 1 rouletted red-slip bodysherd
- 3 coarseware rims
- 1 abraded decorated (?) red-slip bodysherd
- 2 coarseware handles
- 2 fragments of amphora handle
- 2 fragmentary handle bases
- 1 painted base fragment
- 3 coarseware echinus foot rims
- 1 black slip (?) rim
- 1 local red slip bodysherd
- 1 mortarium rim?
- 2 coarseware rims
- 1 ribbed coarseware base

10 tile fragments
 123 bodysherds (coarseware)



17/5/89

3

- 1 amphora rim
- 1 mortarium rim
- 3 coarseware rims
- 2 coarseware rims
- 1 painted rim
- 1 coarseware rim
- 1 clinky ware bevelled sherd
- 2 coarseware handles
- 1 amphora toe
- 2 coarseware bases
- 2 ground painted bodysherds
- 2 gouged bodysherds
- 1 coarseware rim

84 coarseware bodysherds

22/5/89

- 1 gogged bodyshed
- 1 coarseware handle
- 5 coarseware rims - 
- 1 painted ethnic bowl rim - 
- 1 coarseware base - 

45 coarseware bodyshed

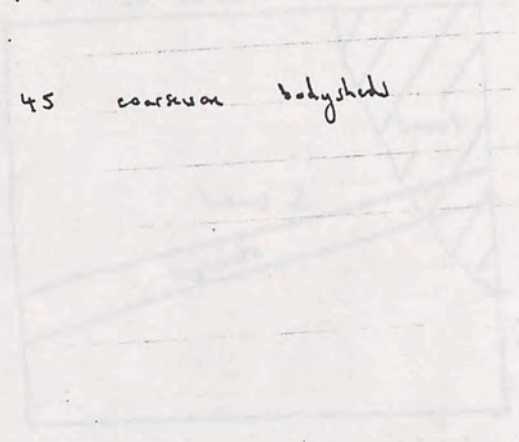

DD

AK T10 Loci

Locus 1 represents the rubber spoil heap in the north-eastern corner of the track

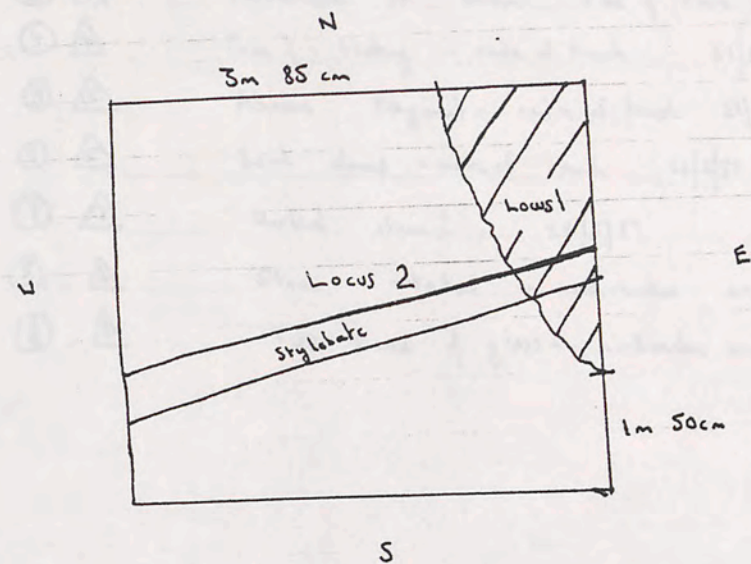

Locus 2 represents the topsoil and fill of the track (the two being indistinguishable), and covers the whole area of the track including that beneath locus 1

Locus 3 represents the floor level of the track, bedrock to the north of the stylobate and foundation track fill to the south, commenced 23/5/89



AK T10 Small Finds

1. [2] ① ▲ Limestone architectural fragment in N-E corner of trench 20/5/89
2. [2] ② ▲ Glass fragment on northern side of trench 20/5/89
3. [2] ③ ▲ Unidentified on western side of trench 20/5/89
4. [2] ④ ▲ Piece of fluting - centre of trench 21/5/89
5. [2] ⑤ ▲ Abacus fragment - centre of trench 21/5/89
6. [2] ⑥ ▲ Lead clamp - centre of trench 21/5/89
7. [2] ⑦ ▲ Worked stone? 22/5/89
8. [2] ⑧ ▲ Stone artefact - north-eastern corner of trench 22/5/89
9. [2] ⑨ ▲ Two pieces of glass - northwestern corner 23/5/89

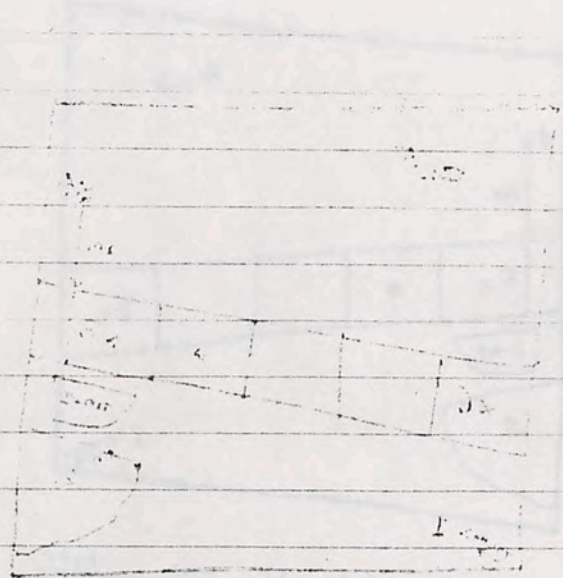

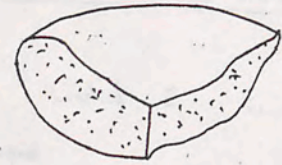

Stone artifact 22/5/83

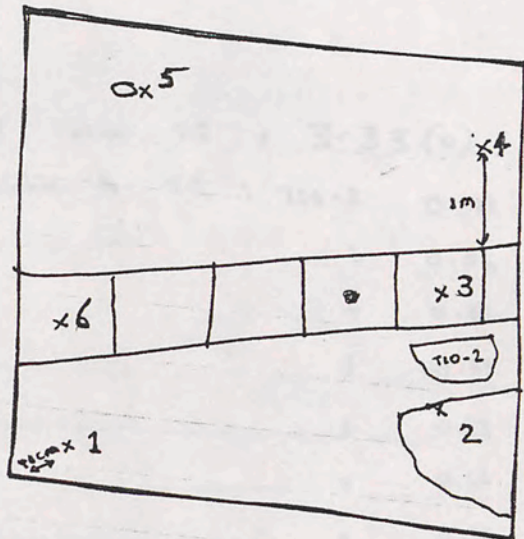
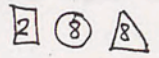

Levels	above	T2	datum:
1	3.37		
2	3.40	1.	- 0.04
3	3.33	2.	- 0.07
4	3.37	3.	0.00
5	3.38	4.	- 0.04
6	3.32	5.	- 0.05
		6.	0.00



AK T10 Large Stones



- T10-1 Fragment of block marked E in north-eastern corner of trench 23/5/8
- T10-2 Lion headed water-spout
- T10-3 Building Block
- T10-4 Building Block
- T10-5 Building Block with bracket
- T10-6 Block with semicircular recess on one side and raised border on other
- T10-7 Building Block
- T10-8a+b Triglyph and Metope with red and blue paint
- T10-9 Building Block
- T10-10 Building Block
- T10-11 Building Block
- T10-12 Building Block
- T10-13 Building Block

Height of lintel above T2 = 3.33(0)

Height of stone relative to T2	T10-2		
	0.01		3.32(4)
	3	0.56	2.77(0)
	4	0.48	2.85(0)
	5	0.49	2.84(0)
	6	0.33	3.00
	7	0.62	2.71(5)
	8	0.56	2.77(5)
	9	0.33	3.00(0)
	10	0.54	2.79
	11	0.55	2.78(5)
	12	0.55	2.78(5)
	13	0.71	2.62(0)

AK TLO Pottery

17/5/89 II
offer from rubber
spoil heap

- 2 coarseware bases - 
- 1 coarseware rim - 
- 1 pottery toe
- 3 local red slip bodysheds
- 11 coarseware bodysheds

18/5/89 II

- 1 piece of tile
- 1 local red slip rim - 
- 1 fragment Parthian green glaze

20/5/89 II





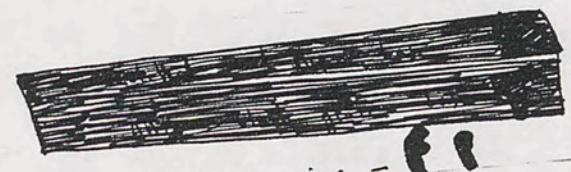





- 1 gougled coarseware bodysherd
- 1/5 piece of tile
- 1 coarseware bodysherd



21/5/89 II



- 2 coarseware rims - 
- 1 coarseware bodysherd
- 1 painted echinus bowl rim - 
- 1 red slip rim - 
- 1 red slip base - 
- 1 local red slip bodysherd



22/5/89 II

- 2 red slip bases - 
- 2 local red slip bases - 
- 1 red slip rim - 
- 1 red slip bodysherd
- 1 local red slip bodysherd
- 1 large pottery toe
- 1 coarseware fish bowl base - 
- 2 coarseware bases - 
- 1 painted rim - 
- 1 water jar rim - 
- 2 black slip echinus bowl rims - 
- 1 amphora toe
- 1 black burnished rim - 
- 1 painted rim - 
- 4 coarseware rims - 



- 1 coarseware rim - 
- 2 gougled bodysherds - 
- 2 coarseware bases - 

80 coarseware bodysherds

23/5/39 [3]

- 7 coarseware base - 
- 5 coarseware rims - 
- 1 coarseware handle
- 1 painted bodysherd
- 1 amphora toe
- 2 local red slip bodysherd
- 1 gougled black slip bodysherd
- 3 gougled bodysherds
- 1 black slip echeus bowl rim 
- 1 coarseware handle base
- 1 mouthed coarseware bodysherd
- 100 coarseware bodysherds

24/5/39 [3]

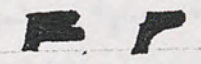
- 1 coarseware base 
- 1 coarseware ring base 
- 2 coarseware rims 
- 1 painted bodysherd
- 1 local red slip bodysherd
- 4 coarseware bodysherds

[]

127

AK T10 Work Diary

18/5/89 Work on T10 commenced with clearance of part of the rubble spoil heap encroaching on the north-eastern corner of the trench (Locus 1). This produced a little pottery. Pick runs were then begun from the northern end of the trench southwards (Locus 2).

20/5/89 Pick runs continued in the northern end of the trench (Locus 2)

T10 [2] [C] [A] revealing a bundle of large stones including an architectural fragment, a piece of glass, but very little pottery
T10 [2] [A] of glass, but very little pottery

21/5/89 Pick runs continued in the northern half of the trench (Locus 2) These

T10 [2] [4] [5] [A] revealed a considerable bundle of large stones, some small architectural fragments
T10 [2] [A] and a lead clamp, but very little pottery.

22/5/89 Pick runs continued throughout Locus 2 further revealing the large stones and architectural fragments including a decorated triglyph and metope with red and blue paint still adhering, some black plaster, basalt, two stone artefacts and a relatively large amount of pottery. The stylobate of the peristyle courtyard was also uncovered.

T10-8a+b

23/5/89 Pick runs continued to clear the floor level of the trench both sides of the stylobate (Locus 3) These produced some pottery and

T10-2

revealed a lion-headed water spout lying on the floor of the courtyard just south of the eastern end of the stylobate and a small broken block in the north-east corner marked with an E

T10-1

24/5/89 The cleaning of the floor of the trench (Locus 3) was completed revealing a prehistoric(?) circular stone-cut feature in the bedrock of the north-west of the trench and producing a little more pottery, and the whole trench was then swept and photographed

28/5/89 The trench was planned.

[Faint, illegible handwritten text on the left page]

1.

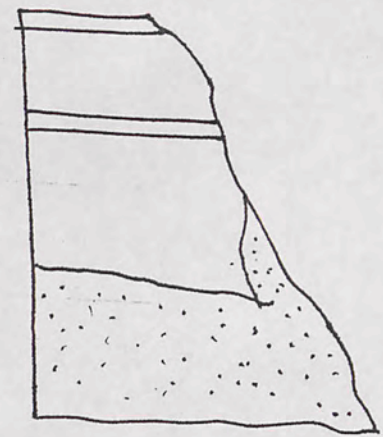

2 ① 1

Limestone architectural fragment 20/5/89

3.



2 ④ 4

Piece of fluting 21/5/89

5.

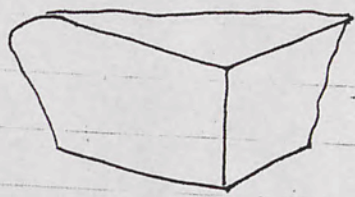

2 ⑤ 5

Abacus fragment 21/5/89



2 ⑦ 7

Worked stone? 22/5/89

7.

Fig. 1



Fig. 2



Fig. 3



Fig. 4

