

ANNA C.

[MAIN
GATE



MG
1988
Curnow

STUDENTS NOTE BOOK

elencas MG1 p.26-27
MG2 p.27
MG3 No. 593
Cocip.35

marker p.37

ANNA CURNOW
JEBEL KHALID

[Faint handwritten text at the bottom left corner]

Elevation

E stake - 153.105 m

(top of wood)

153.807 m

(point)

Plan of trenches p. 23

Page 1
AC

SATURDAY
~~SUNDAY~~

MG.

21-5-88

Laid out 5m x 5m trench in main gate area - trench to be called main gate I (MG I) Trench is designed to come at right angle to the architecture to attempt to get a face to the architecture - looking Trying to get an idea of the gate area - there is too big a space between the 2 huge towers - this trench is laid out at right angles at the possible furthest south extension of the northern tower.

① Surface sherds - Bag I

Roll 1 No 6 + following - photos taken by Peter 8.10 am photo

1st photo taken looking north + 2nd + 3rd photo 4th photo taken looking south.

WORKERS.

also Michael

TURKEA

HAJI

AMINA

Now taking off the topsoil - 5cm. taking some elevations from east stake. So, topsoil is Locus 1 pottery bag

②

MG1 BAG 1 SURFACE SHERDS 21-5-88

- 1 tiny frag of black glaze
- 1 tiny frag of red glaze
- 1 sherd with stripe of red paint on outside and on inside all red
- the other sherds coarse & pinkish in colour weight = 150 g. very few sherds

Diagnostics - on accompanying graph paper

1 base - pinkish clay, coarse
base diameter 4 cm.

1 rim sherd - greenish in colour
diameter 21 cm
with a bump on the rim that could
be a lug handle or else a mistake
also grooved rim

Page 2
AC

Elevations
for surface of
trench before
excavation, so
at top of
locus 1

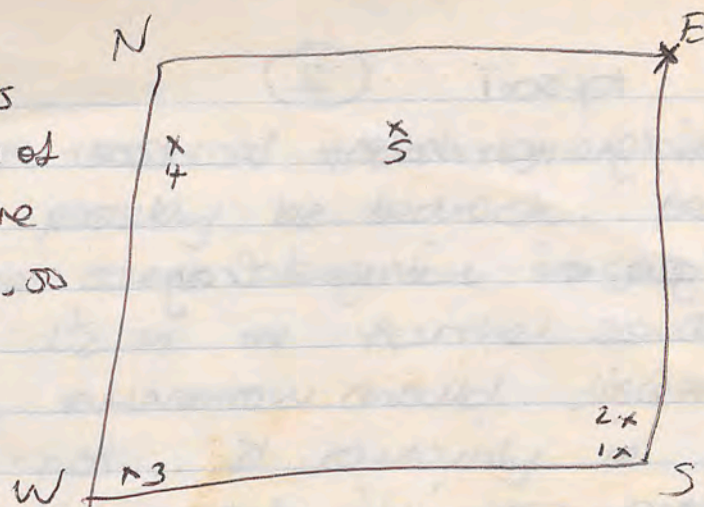

3 = 176 cm from E

4 = 100 cm from E

5 = 65 cm from E

2 = 142 cm from E
1 = 144 cm

Locus 1 - The topsoil is locus 1 - it is dry grey in colour, fine in particle but with lots of little stones but hardly any pottery. Several large stones appearing underneath - the next strata is appearing underneath the topsoil - more brown in colour but perhaps that is just moisture. At this stage anyway I will keep taking off the topsoil in the whole trench. I do not think a trial trench is valid in MG1 because of all the large stones (the architecture) & the probable shallowness of the strata.

Beneath the topsoil in various patches there is fine yellow/white powder - possibly from stone blocks but I'm not sure. Still very little pottery. The whole trench is beginning to be totally filled with large blocks of stone at various elevations

20-2-15

MG1

1

topsoil

2

21-5-88

rough body sherds - coarse - pinky

1 red glaze - tiny frag.

Diagnostics:

1 handle - pinky - no paint, wonky

one horizontal side, one curved.

2 rims - weak red/black glaze

diam = 27 cm.

Page 3
AC.

MG-1
21-5-88

At the south-west of trench there is a massive stone that could possibly be bedrock. Bedrock is visible at roughly the same elevation in the modern drain only ~~at~~ 1 1/2 m ~~so~~ further south. Further excavation tomorrow should discern whether this is bedrock or not. It certainly is regularly horizontal so even if bedrock it was worked.

By the end of the day nearly all the topsoil had been removed. Tomorrow the final strip of topsoil will be taken off, then I shall go down further in the trench. This next strata, locus 2, is mixed, it is just below the topsoil, some of it is still loose and grey, but some is the yellow powdery material mentioned above. This yellow material is patchy and as I believe from stereo I have included it in locus 2.

I wanted to do a detailed plan in the afternoon today but I have a cold so I'm staying in.

1-04
22-5-88

Page 4
AL

SUN
HOLIDAY

22-5-88
MG-1

at the west of trench there is a massive stone
that could possibly be a block. I was
digging the same elevation as the massive stone
only for 15 m or further south. Further
excavation showed a different material
or not. It contained a red clay horizontal
to ground level. It was worked
by the end of the trench and north of the
trench. The trench was first dug
of level will be taken off. I will go down
further in the trench. The next level
is mixed. It is just below the surface, some of it
is still grey and some is yellow.
The yellow material is probably
material in patches and as I believe from stones
I have included it in locus 3.
I worked to a standard depth in the
afternoon but I have a cold so in starting

Page 4
AL

continuing to take off topsoil in north-west of trench.
even more stones appearing.

Between two large blocks of stone is a different
patch of material - it is beige in colour & of large
particle size - I think it is just the material lodged
between two stones but as it is different, I am
digging it as a separate locus. - [3]

elevation [3] 142 on from E.

WORKERS:

- Kaji
- Aminda
- Hadija
- Michael

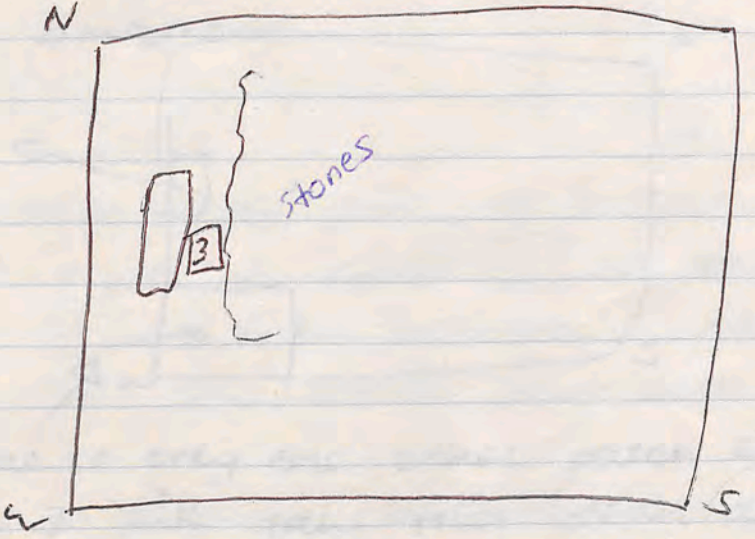

however it is
too windy to be
accurate &
impossible to
take the rest
of the elevation
Very frustrating

Nearly the whole trench is stones - there are two
particular areas that are very flat - this afternoon
I will take elevations with the level to make this
clear.

All the topsoil is now off - the few sherds
of pottery are locus [1] bag [3]

There is no pottery from [3]

The next bag is (4) from locus [2], the
strata below the topsoil - mixed - some very like
topsoil, also yellow patches.

22-5-88

1-54
MG 1

1 3

22-5-88

All body sherds - coarse ware

1 large chunky sherd - the rest are

relatively thin - some pinky ware - some buff

weight 150g

weight 150g

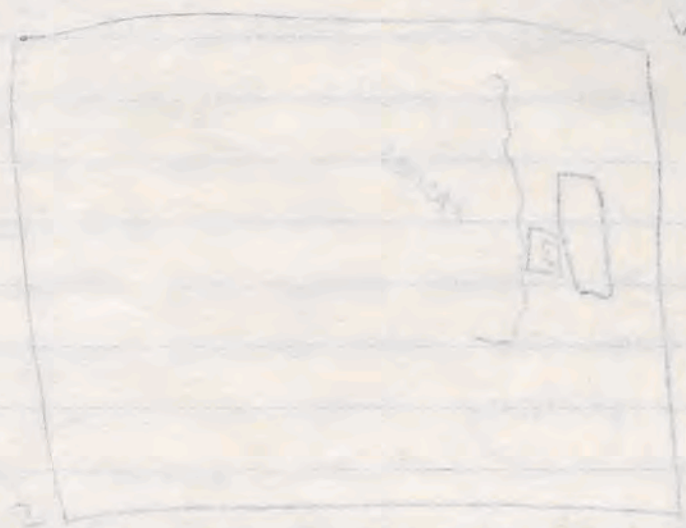

Page 5
AE

22-5-88

MG-1

No pottery came from 2 4 but a piece of metal did, object 1 1

Upon reflection locus 3 is merely a sub-locus of 2, that is the material below the topsoil that has patches of yellow material with stones.

There is one patch of yellow material that is coarser & is perhaps a fill. I will investigate it further tomorrow.

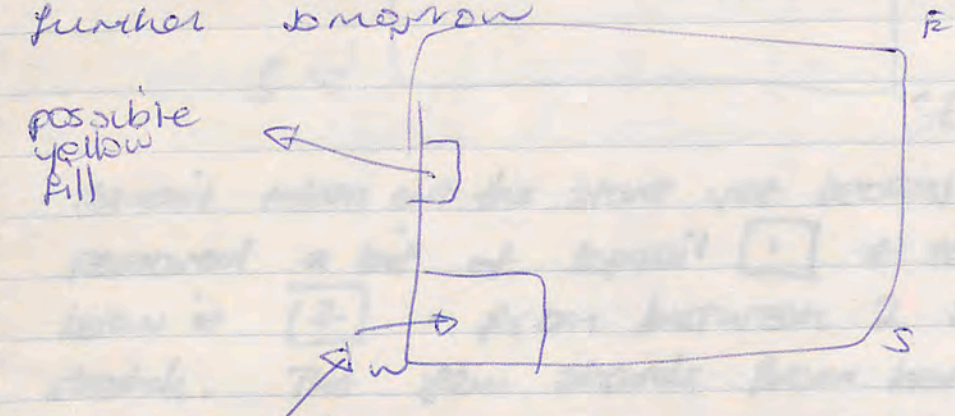

There is only one other patch of dirt left in the trench. I will take this down as far as I can tomorrow.

The rest of the trench is stones, possibly in 3 levels that appear to be the same distance apart. According to Peter this was how levels were built up. The lowest stones in the trench are in the south-west of the trench and if the patch of soil goes down a bit more then this might suggest a jutting out

narrowing of the case the same the south gate to indicate a gate. If this were the area where Michael opens tomorrow.



MG 1

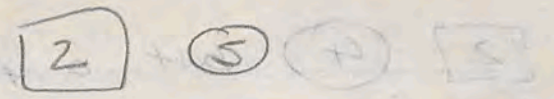

Only body sherds
 clay - pinky
 coarse ware

weight = 100g

23-5-88

Page 6

AR

~~FRIDAY~~

23-5-88

MG 1

Calling all the stones in the trench [4], the different levels of the tower/gate in MG 1

Taking out a large fallen stone

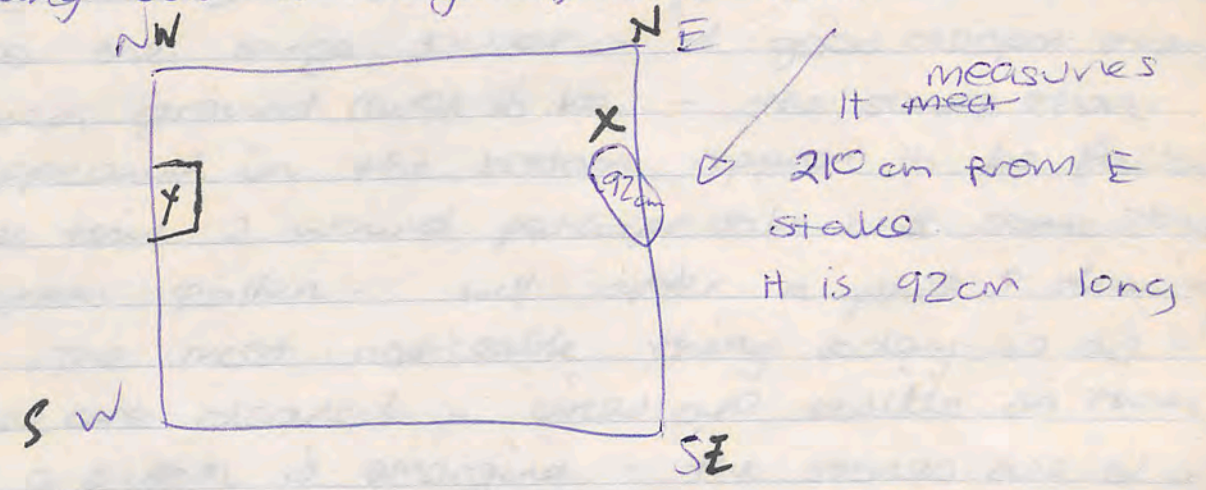

Haven't taken out the stone yet because no Shebab arrived. Removed a bit of topsoil [1] & the material just below it [2] - from between 2 stones from x on sketch. The few sherds from here are bag [5]

y is a pocket of material in the west of the trench between stones & the west bank - I have given it a separate locus [5], even though it is similar to [3], because they are not connected, they are in different parts of the trench - all on the west side but all separated by stones. The material of [5] is yellow, coarse particles, bits of limestone etc - no pottery - the material goes down deeper but it is too narrow to work there. Some large, nicely cut rectangular blocks are appearing. Perhaps the material is a fill or perhaps it is the soil of [1].

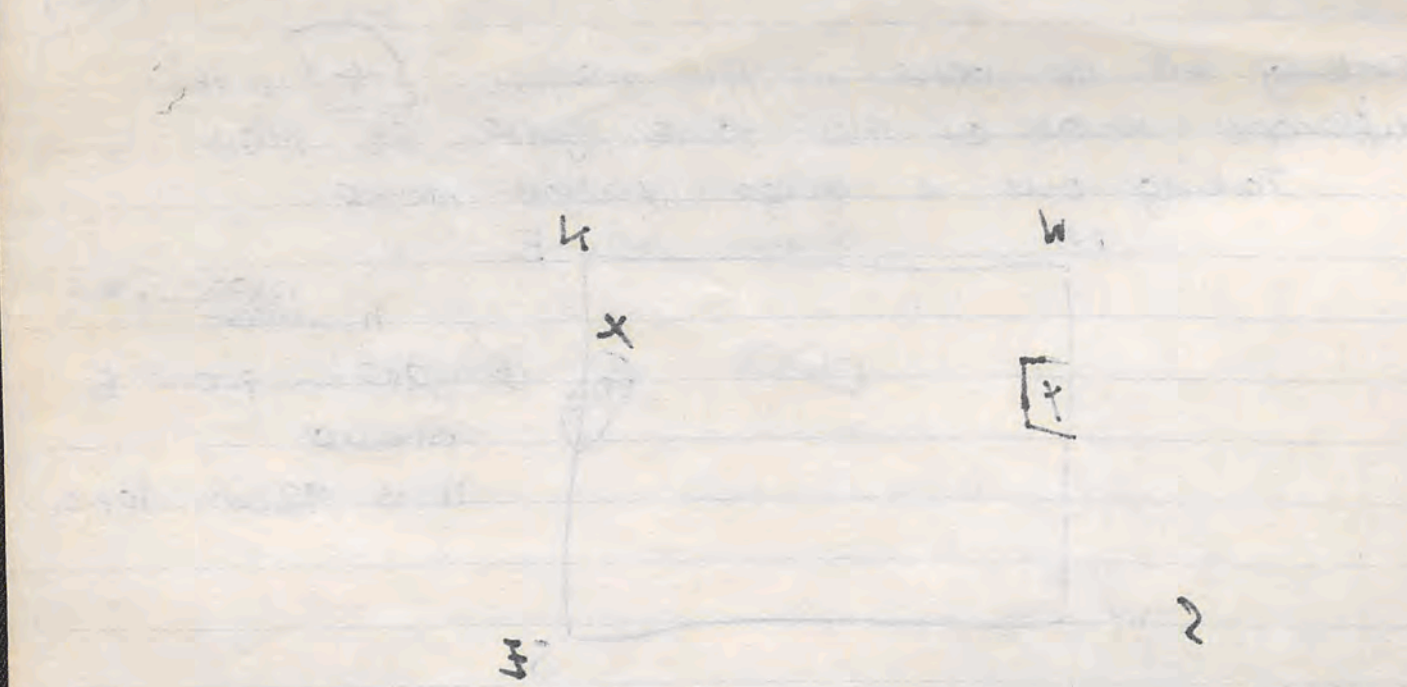

There's taken out the stone yet because no sherd found just removed a bit of stone & the material just below it - from between 2 stones, from X on the floor. The few sherd from here are good.

It is a pocket of material in the west of the trench between stones & the west bank. I think given a separate level. It is a pocket of material, but one in different part of the trench - all the west side but all separated by stone. The material is yellow, coarse particles, bit of numbers etc - no pattern - the material given some pocket but it is so narrow to work there, some large, nicely cut rectangular blocks of appearing. Perhaps the material is full or perhaps it is the soil of the

Another new locus [6] is in the SW corner of M61. It is the same yellow, coarse & sandy material of [5] - it goes down - perhaps it is a foundation trench for the large tower - it goes deeper than I expected ground level to be - the stones that have appeared in the bottom appear to be fallen. To check this I would perhaps take out some stone that appear fallen - but after a photo & drawing.

The most noticeable thing today is as the stones are cleared - lines are visible on them, that is a pattern is emerging - the stones are of a regular size & height. Blocks are placed on top of lower blocks in a position of max. strength - that

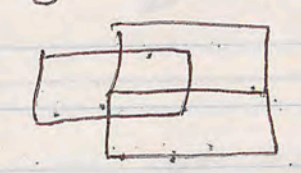

is right on the joint join. [Peter - sorry about the notebook today I feel really sick & awful.]

WORKERS

- Haji
- Amina
- Hadija
- Michael

Bag (6) is locus [6] - a few sherds only.

MG 1

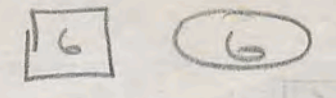

23-5-88

a few body sherds only
 pinkish colour
 coarse ware
 weight = 125g



Page 8
AL

TUES
~~WEDNESDAY~~

24-5-88
MG 2

WORKERS

- Haji
- AMINA
- HASIJX

Michael is opening up his own trench MG3 ^{5m south} from
 MG 1. I am digging 2m of MG 2 - leaving a
 50cm bank b/n MG 1 + MG 2 - it is not possible
 to dig all of MG 2 because of the modern road
 so digging all that is possible. Perhaps I will
 clean down the road with a broom.
 I have one sherd from the surface collection
 of MG 2 (2m only) Bag ⑦

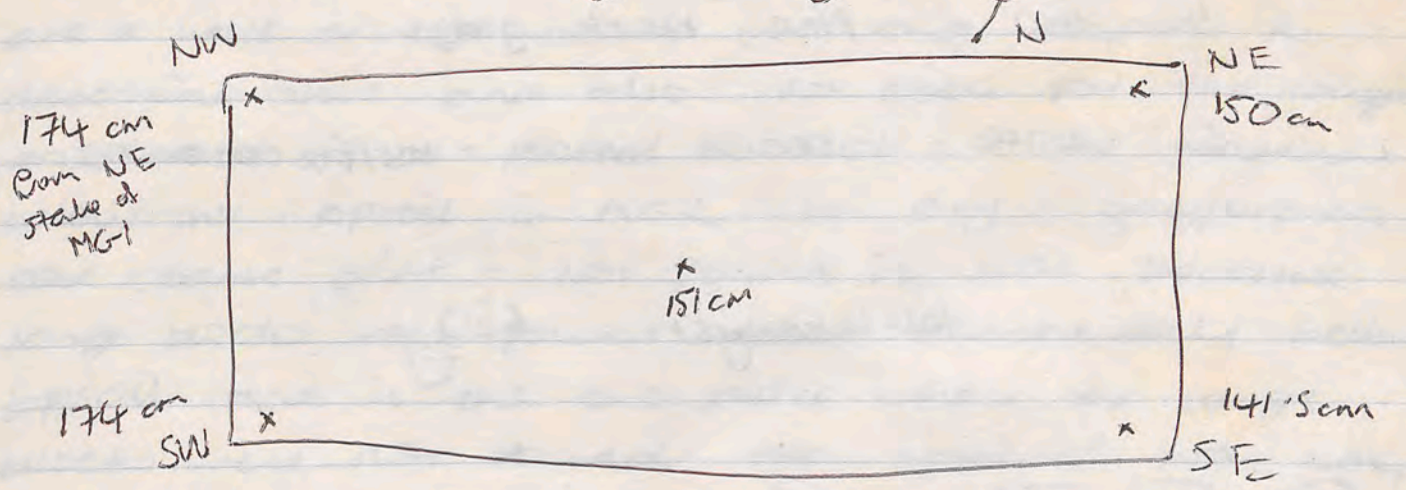

Taking off the topsoil ① - more pottery
 sherds from here than in MG 1. Basket ⑧
 A group of small stones has appeared in a
 line it looks like a wall. It is not what I was
 expecting - I was expecting a jutting out of the
 solid type blocks from MG 1 - this small stone
 wall is a totally different construction

BASKET (8)

Body sherds - coarse ware
red painted frag
- 1 body sherd - light ware
ribbed - drawn on graph page.

Diagnostics

- 1. rim - poor red glaze
- 2. rim - coarse ware - no paint - buff.
- 3. handle - greenish buff.
- 4. rim - fine, black glaze.
- 5. base - coarse ware - buff colour.

total weight 680g

MG-1

Wednesday 25-5-88

Cleaning up MG-1 for a photo again today. A piece of metal has turned up in the cleaning process - (object 2) - locus [3] - no basket.

WORKERS

Haji

Amina

Hadijah

MG-2

After cleaning will continue to work in MG-2. I have not decided if the small stones in a line are a wall or not - I will dig deeper to determine this and also to look for the larger constructed stones found in MG-1. The material below the soil in MG-2 is dry - grey/brown coarse dirt - Not found in MG-1 because large blocks were found almost immediately below soil and in the one place where the large blocks were not found the material was not dirt but fine limestone [locus [3], [5] + [6]]
New locus is [7] below [1] in MG-2

Bag is (9)

Photos - Peter 11:20 am - Roll 2

looking north 14 - 19

looking west	20, 21, 22,
looking south	23, 24, 25
looking east	26, 27

In west of MG2 in [7] (material below
level [1]) is small stones in no apparent
order - ie no wall is discernible

The possible wall in the middle of MG2
running NW-S-E I shall give a locus
no. 10, although I am not yet convinced
that it is a wall or just rubble.
= [8]

In east of MG2 - no stones as in
west - instead there is a beige coarse
soil with no pottery - a few stones appearing
it is a new locus = [9] - below [7]

At the very end of the day the yellow/white
limestone crumble material found in MG1, appeared
in the north-east corner of MG2. In MG1 this material
had locus [3], [5], [6] - Here it has a new locus
= [10] - its elevation is 80m from the top
of the S.E. stall of MG1.

workers

- HAJI
- AMINA
- HADITA

MG-2

Working in MG-2 - in the west of MG-2 - west of [8] - the shada is [7] - pottery bag (10)

MG-1

- has been cleared up for photo yesterday - I will attempt to draw it today.

measurements of blocks

length	width	
130 cm	52 cm	} bottom course
130 cm	53 cm	
130 cm	48 cm	}
?	54 cm	
possibly chipped 109 cm	53 cm	} middle
109 cm	51 cm	
	50 cm	} top course
	54 cm	

The stones are placed so as the next block is over the join



one big block is shaped NW corner of MG-1

I think this odd shaped block is the west edge of projection

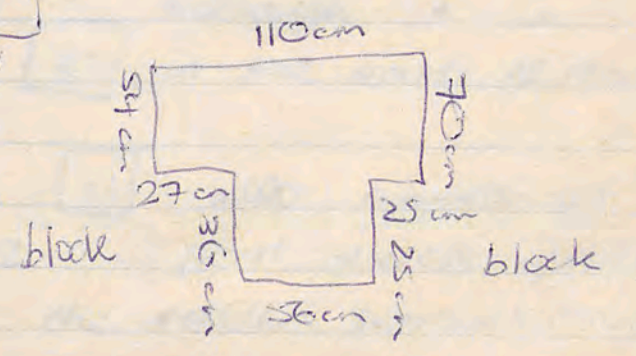

[7] Basket (10) 26-5-88
5 Body sherds only - buff + pink
weight = 200g

Page 12
AL.

MG2

SATURDAY 28th MAY 1988

WORKERS

Haji
AMINA
HADIJA
HALAF

Elevation
↓

Working in MG2 - west of [8] (the small stones that might be a wall or fall).

The dirt is still the material [7] below bpsoil [1] - basket (11)

A new strata has appeared - gravel - tiny stones - pebbles in with fine dirt - I took 2 elevations of it from the SW stake of MG1, both 60cm from the nail on the top of the stake. The new gravel strata is [11]

bag (12) - no pottery kept - 1 body sherd - seen - discarded.

Cliff has given me a height on large rock to these elevations - height = 151.46m.

A strata below [11] has appeared - the yellow - limestone chip material - it has a new locus no - [12] - although it is probably the same as [10] in the east of MG2 but this is in the west.

The gravel material [11] also appeared in east half of MG2 - East & West of MG2 are separated by [8] - the fallen stones - that

MG2

28-5-88

[7] Basket (11)

5 body shards - no diagnostics

buff only

weight = 100g

Page 13

do not go down - there is dirt underneath them

MG2 dug

EAST

[8]

WEST

fallen stones

[1]

topsoil -> [1]

[7]

←

coarse - brown - pebbles →

[7]

[9]

lighter brown below [7]

gravelly - pebbles & fine dirt →

[11]

[11]

- gravel layers as in west

[10]

limestone patches

but at same elevation as the yellow

limestone patches [12]

MG4 Basket (13) surface shards 29-5-88

4 body shards
buff & pink

1 very bashed base

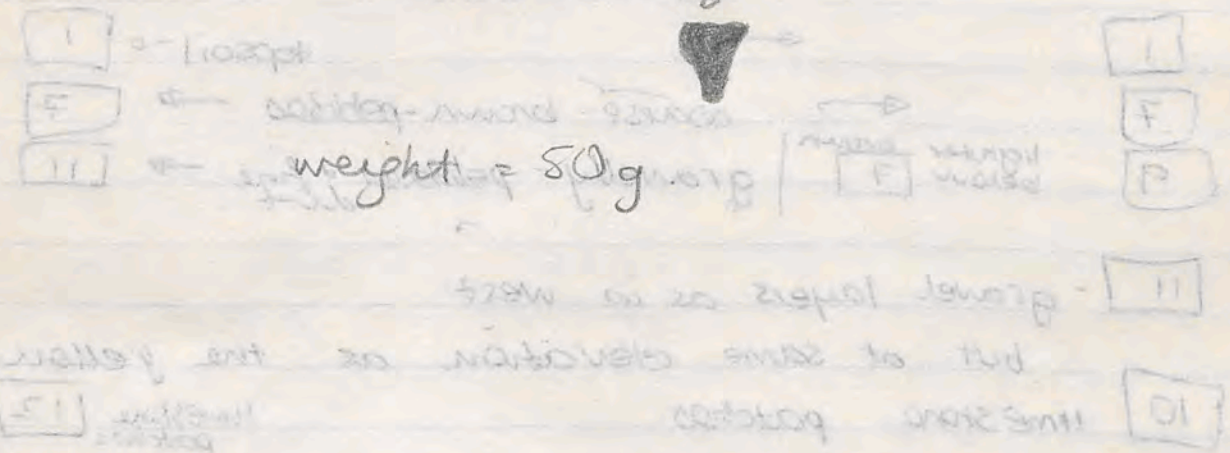

AC workers SUNDAY 29th MAY 1988

- HAJI
- AMINA
- HADIJA
- HALAF
- NAIMA AL HAJ ALI AL AISA

SER Surface Shards MG4 - (13)

opened a new trench - MG4 - It is situated west of MG1 with a 50cm bank separating the two. The size of the trench actually being dug is 4m x 5m.

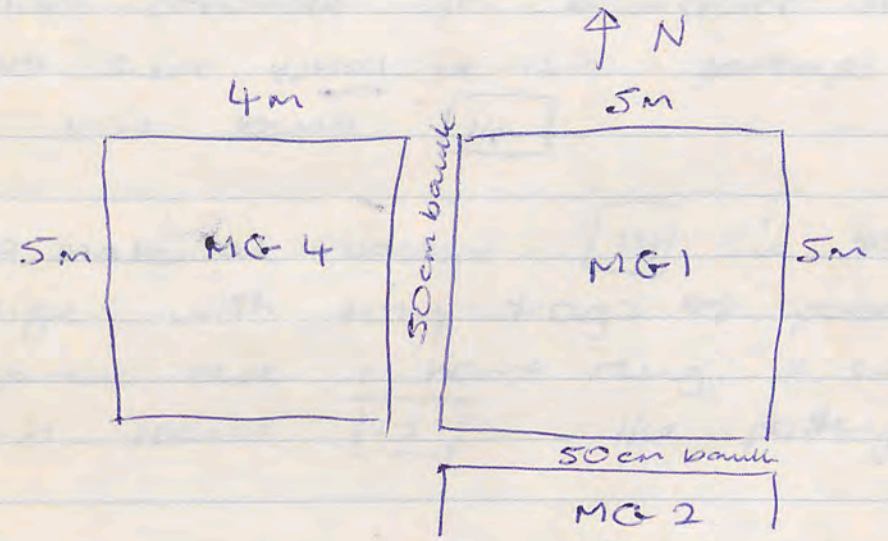

So from the west stakes of ~~MG-2~~ to the west stake of MG4 is 4.5 m.

Taking off the ppsoil - [1] - only a few shards - basket (14)

Below the ^{initial} ppsoil in the south of the trench is more dirt - probably more ppsoil - In the middle east part of trench is more yellowish material - probably wirestone chips like the material from MG-1. MG-4 - yellow stony - new locus = [13]

1

Basket 14

18 sherds - 1 Pine red, the rest buff

1 diagnostic

red glazed pine - rim

weight = 200g

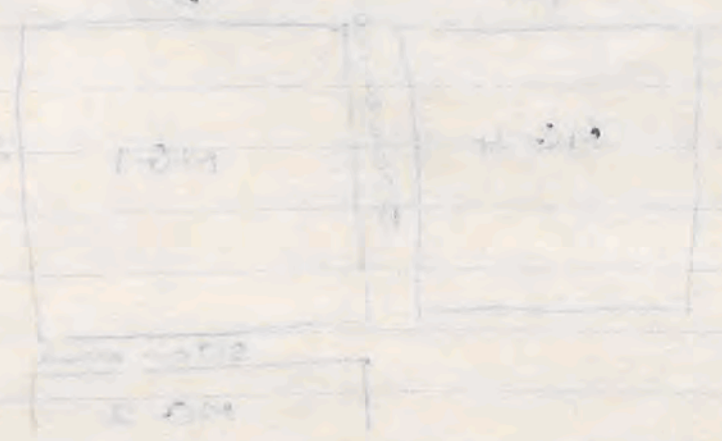

AC

29-5-88

Not all the spoil has been removed - I will remove the rest -

MG2

Had another look at MG2 today - in the west of the trench there appear to be large stones - or I thought bedrock - but this seems to chip away - I now realize that this is not stone but a very hard surface - like concrete - in a distinct flat level - I'm not sure what it is - perhaps it is a floor.

It is locus 14

The material below 14 is soft - coarse beige with tiny frags of pottery - more than anywhere else I have dug - small stones - it is locus 15 - the pottery bag 15

[15]

BASKET

(15)

29-5-88

sherds - very tiny + beaten about possibly because locus [15] might be near the old street level → gate area. locus [15] is below a hard thin level [14] that had hardly any pottery - if any.

Body sherds 22 - all tiny - 1 to 3 cm
1 handle chipped on all sides so no point in drawing it.
pink buff ware

weight = 50g

Page 16
AC

MG

MONDAY 30th MAY 88

Working in MG-4 -

Workers

- HAJI
- AMINA
- HADIJA
- NAIMA
- HALAF

→ continuing to remove the topsoil locus [1] basket (16) - below the topsoil is the white yellow-chipped limestone - [16] = [13]

MG-2

Difficult to understand still - [14] - scrapes away - even though hard as concrete. - a most definite level but why there I don't know.

Elevations

from SW stake of MG-1

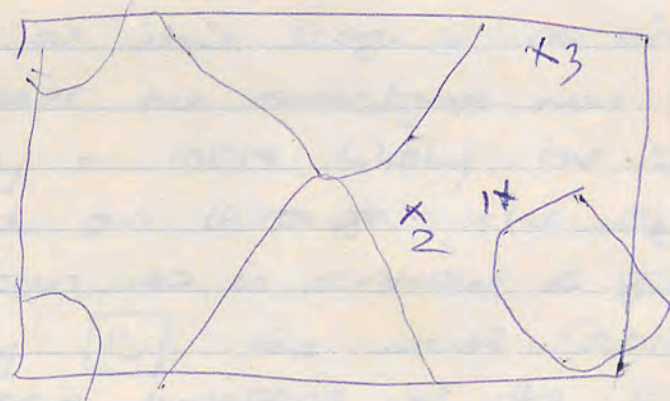

elevation of locus [14]

1 = 91 cm

2 = 87 cm

[15] = 3 = 107 cm

MG4

[1] Basket (16)

30-5-88

Body sherds 7 - buff + pink

weight 150g



Page 17

TUESDAY 31ST MAY '88

TURKEA (HATI)

AMINA

HADIJA

NAIMA AL HAJ

HAFAT

ZURKEA AL HUSSEIN

MG4.

continuing to remove the topsoil [1] - yesterday the locus below [1] - the white unestone material [16] was dug into a bit - but the pottery all came from topsoil [1] so the bag remained uncontaminated - [1] (17)

what is appearing in MG4 is a mess just like Michael's MG3 - there appear to be only fallen stones at this stage - no line of the tower - perhaps the tower/gate was destroyed in antiquity - more likely the stones have been robbed out through the ages.

All that I can do is continue to go down - now digging [16] - the white (abiad) unestone "dirt" + chipped limestone of the locus below topsoil - many fallen stones - all at odd angles.

[16] (18)

Basket (17) [1]

31-5-88

7 body sherds only - pinkish clay

weight = 50g

Basket (18) [16]

31-5-88

3 body sherds

buff

pink

grey

weight = 75g

Wednesday 1st June 1988

Workers

Haji

Amira

Hadija

Halaf

Naima Al Haj

Zurka

Continuing in MG4 - [16] (19) - locus [16]

the limestone chips in dirt is either broken up old stones - decayed or a rubble fill but I don't think it is a fill because of the decayed nature of the trench - the only line of bones I have in the trench is the very north line that is in line with the very north line of stones in MG1. The rest is all fall & all over the place.

I am turning in a sample of limestone or lime that appears to be moulded - unware perhaps only from limestone blocks

[16] (19) 51

Basket (19) [16] 1-6-88

5 body sherds
pink clay & buff clay
one sherd with incised lines

weight = 75g

Page 19

AC

Thursday 2nd June 1988

MG

Workers

Haji
Amira
Hadija
Halaf
Naima
Zurka

working in MG4 - attempting to remove as much of the soil/limestone material of [16] basket (20) - without removing stones - difficult to work - stones get undermined
object from basket (20) - \triangle - black glaze incised lines tiny vase 88-152

in the very south-west corner of MG4 is the only dirt - not the limestone "soil" it has locus [17] - this is the only spot that pottery is coming from - I now realize that object \triangle comes from this locus bag (21) - [17] reminds me of locus [15] from MG2 - I shall check their elevations but both are beige - soil with pottery & stones.

The only difference between [15] & [17] is that [17] (21) has larger, not as broken or broken pieces of pottery, also the delicate object \triangle so perhaps the material is not

Basket (20) Locus [16] 2-6-88
body sherds = 9

buff, pinkish
one - weak black/red glaze

1 rim - weak black glaze - glaze
nearly all gone.

weight = 100g.

Basket (21) [17] 2-6-88

8 body sherds.

buff colour

slight incisions on 2 sherds

1 very large sherd probably

neck of large storage jar - also slight
incised lines

weight = 100g

Page 20

AE

MG

2-6-88

the same. I realize that I dug some
of locus [17] as locus [16] - there were bits
of the limestone material in it but I ~~now~~ now see
they are separate loci - I have put a tag
in West bank where I changed - the bank

shows that in this particular SW corner

there was topsoil [11]

then dirt [17]

the rest of the trench is topsoil [11]

then limestone [16]

Saturday 4th June 1988

WORKERS

- HATI
- AMINA
- HADIJA
- HALAF
- NAINA
- ZURKEA

Attempting to clean up MG4 for a photo - very frustrating work. The more one sweeps the more dirt one creates.

Attempted to draw section in MG2 but dust from cleaning operation in MG4 frustrated this. Also attempted to lay out a new wrench but couldn't get it accurate enough so will ask Cliff for help - altogether having a very bad day.

Photos.

MG4 Roll 5 No1 - looking north

MG2 No. 9, 10 - looking east
11, 12 looking west

MG2 - cleaning up MG2 - 15 22
- 3 sherds - object - metal pin 4
- seen + discarded

AC

MG

4-6-88

clearing up MG4, 116 23 - no sherds but a bone sample 52.

New trench laid out by cliff -
~~to surface sherds~~

Name of trench	NMG 1
surface sherds	24
topsoil	1 25

Having trouble with the workers - 4 girls are too many to employ -

25 21

big area - days -

4-6-88

Basket (24) Surface Shards NMG-1
4 body shards (3 buff, 1 red/brown)

3 diagnostics:

- 1 base, red burnish
- 1 rim - coarse, gritty, brown
- 1 rim - pinky - chipped - not

possible to draw but also a chipped band



weight = 50g

Basket (25) [1] topsoil NMG-1 4-6-88

24 body shards - some large, some small
 1 is possibly a tile frag being very chunky
 & not very curved
 all buff ware
 except for one brown
 gritty shard perhaps cooking ware



diagnostics

5 rims, 3 buff, 1 red glaze, 1 black & gritty

1 base in 2 frags - buff/pinky ware
1 possible handle, also chipped to draw

weight = 1 kilo

grid so far at MG - 5m x 5m here



1:100

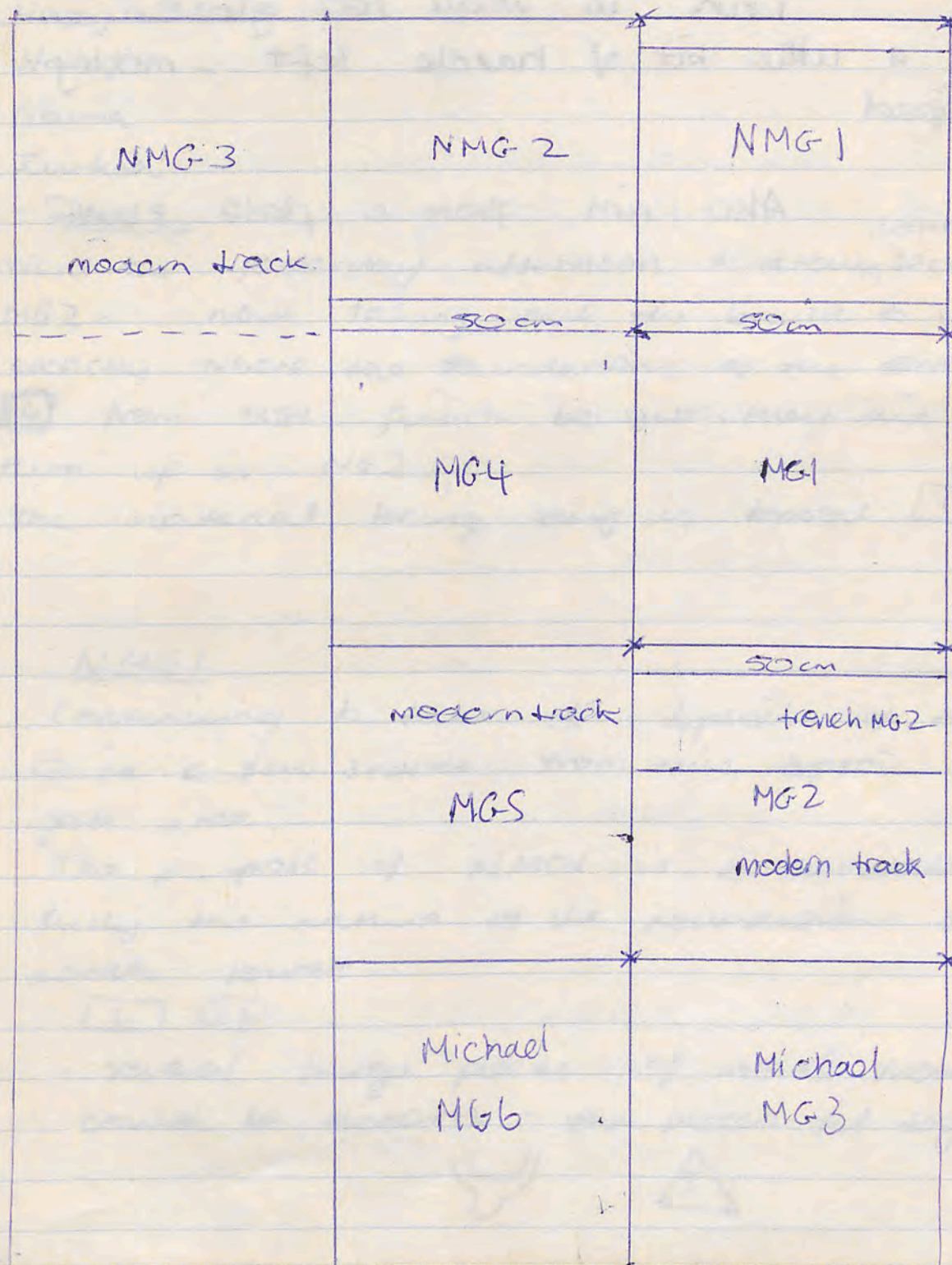

MG2 [1] Basket (26) 5-6-88

2 sherds, both diagnostic

1 rim in weak red glaze
with a little bit of handle left - mostly
chipped

Also rim from a plate - buff

Page 24

AC

Sunday 5th ~~May~~ June 1988

MG

Workers

Turkea (Haji)

Amir

Hadija

Halaf

Naima

Zurkea

MG2

Went out yesterday afternoon & drew ^{north} section of
MG2 - now taking out the bank to establish
exactly where the foundations of the sewer/gate
[4] from MG1 finish because they did not
turn up in MG2.

The material being dug is topsoil [1] (26)

NMG1

Continuing to take off topsoil of NMG1
Quite a few sherds from this topsoil for the
gate area.

The purpose of NMG1 is to establish more
fully the nature of the foundations of the
north tower.

[1] (27)

several large pieces of metal from topsoil
could be modern - the pieces fit together



NMG-1

[1]

Basket

(27)

5-6-88

*

- * 1 huge heavy tile
- x 134 buff body sherds including a few black burnt cooking ware sherds
- x 5 good red glaze body sherds
- * 1 good red glazed body sherd with rings
- x 3 weak red glaze body sherd
- x 2 weak black red glaze body sherds
- x 3 weak red/black glaze

Rims

- 1 black glaze
- 3 good fine red glaze
- 2 buff + chunky
- 1 weak red glaze

Bases

- 1 pinky clay, coarse
- 1 weak red glaze
- 1 black glaze
- 2 buff coarse

Handles

- 1 huge chunky buff
- 1 "normal" size buff

total weight = 2 kilos + 500g

AE

5-6-88

MG

NMG-1

[1]

(27)

- also a sample of bone S3 + a sample of kerisat S4.

Object $\triangle 6$ from [1] (26) - tiny grey "vase" very similar \downarrow $\triangle 3$

88.151

Monday 6th June 1988

AC

Workers

- HAJI
- TURKEA
- HADIJA
- HALAF
- ZURKIA

NMGI

[1] (23) - continuing to remove soil [1]
 - not as much pottery as day before - basket (27) from S4-55 was the south-east corner of trench - that is where all the pottery came from

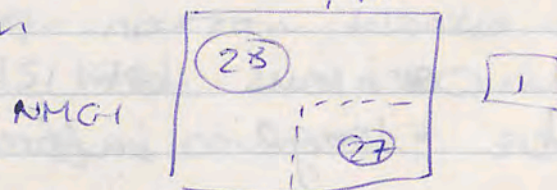

[1] (27) SS Turning in a sample discovered previous day because P.C says he has dug up a similar object a piece of clay with grit slightly moulded.

Taking elevations

MG1 - levels of the remaining foundation point on lowest level from cliff 151.46m
 Height Instrument 151.46 + 1.61 = 153.07
 2nd course of foundation = 153.07 + 1.01 = 152.06 m
 ie 60 cm difference b/w courses.

NMGI 1 Basket 28 6-6-88.

- 29 buff sherds
- 1 weak red glaze
 - 1 strong/fine black glaze - tiny frag
 - 2 odd black - weak cooking ware sherds, 1 possibly incised lines.
 - 1 buff sherd with incised lines

DIAGNOSTICS

- 3 bases - buff
- 2 handles - buff

- 1 echinus bowl rim - weak red glaze
- 1 large buff rim

weight = 1 kilo

elevations

* height of narrow "orthostat" type blocks in very west of MG1. that are the possible west boundary of this protrusion of the lower to form the gate

$$= 153.07 - 1.31 = 151.76 \text{ m}$$

* height of bp course of MG1 (2 readings)

$$= 153.07 - 0.41 = 152.66$$

$$153.07 - 0.43 = 152.64$$

∴ diff b/n 2 bp courses also 60 cm (one of the readings taken from a stone slightly worn away - 58 cm diff).

* elevation of narrow blocks in west of MG1 - 151.76m is 30 cm above the lower main course + 30 cm below the above main course

2nd course below these west blocks

$$\Rightarrow 153.07 - 1.83 \text{ m} = 151.24 \text{ m}$$

⇒ 50 cm below bp course of narrow blocks + 18 cm below 1st main course of projection

* East in MG1 - blocks on diff elevation to main courses in centre of trench

top block - $153.07 - 1.27 = 151.80 \text{ m}$
 next block (worn) - $153.07 - 1.46 = 151.61 \text{ m}$
 next level - $153.07 - 1.68 = 151.39 \text{ m}$

MG
6.6.88

the difference in elevations b/n top Ae
& middle = 21cm, b/n middle & bottom
= 22cm.

Height of flat stone in SW corner of MG1
that might be in situ - lowest flat stone
= 153.07 - 2.15 = 150.92m

MG2 - elevation of locus 14 - hard
concrete like layer - possible "floor"
= 153.07 - 2.47 = 150.60m.

MG4 - elevation of only course remaining
in north of trench = 153.07 - 1.60
= 151.47m.

Elevations for Michael - MG3

Michael's courses: top 153.07 - .49 = 152.58
middle 153.07 - 1.08 = 151.99
153.07 - 1.07 = 152.00
bottom 153.07 - 1.56 = 151.51
(fallen) possible lowest 153.07 - 2.00 = 151.07

diff b/n courses 55 & 59 cm
52 & 48 cm
46 cm

Michael's MG6

only level course remaining in south
bank 153.07 + 1 = 152.07m

6.6.88

AC

[1] (28) S6 - A sample from NMG-1 S6 of another odd shaped piece of plaster or limestone - similar to S1

Objectives for the remaining 9 days:

- * keep remaining bpsol in NMG1 to check on lower construction - I don't really know why there is so much pottery coming out of this trench, which is higher up the hill & not ^{out} of MG1 + MG4
- * Remove bank b/n MG1 + MG4 to check of "face" of projection & the same for bank b/n MG1 + MG2
- * To look at the visible line of blocks west of NMG-2 + MG4 in areas that would be NMG-3 + MG-7 perhaps this would just be wall clearing as I may run out of time but hopefully a trench.

Tuesday 7th June 1988 AR

Workers

- Haji
- Turnea
- Hadjja
- Halaf
- Zurhea

NMG-1

Removing more soil [1] (29)

MG-4

Removing bank b/n MG4 + MG-1
 The bank is in MG4.
 Hard going - a lot of big stones to remove

MG-1

Removing large fallen stone to
 check east extension of projection
 A line of nicely made blocks
 appearing on a different
 elevation to the main courses
 in the centre of the trench.
 There also appears to be a gap
 between the different courses
 and in that gap rubble + some
 brown clay type material that
 was perhaps used in construction

NMG1

[1]

Basket (29)

7-6-88

14 body sherds only - buff + pink buff - coarse
 1 is much more coarse with grits probably cooking ware
 weight = 1 kilo 250 grams
 some of the sherds are very large - perhaps from same vessel but I can't piece them together

Wednesday 8th June 1988

Workers

- Haji
- Turkea
- Hadija
- Halaf
- Zurkea

MG4

Continuing to take out topsoil from bank
 [1] [30] - slightly mixed with [16] - material below topsoil with limestone chips + stones

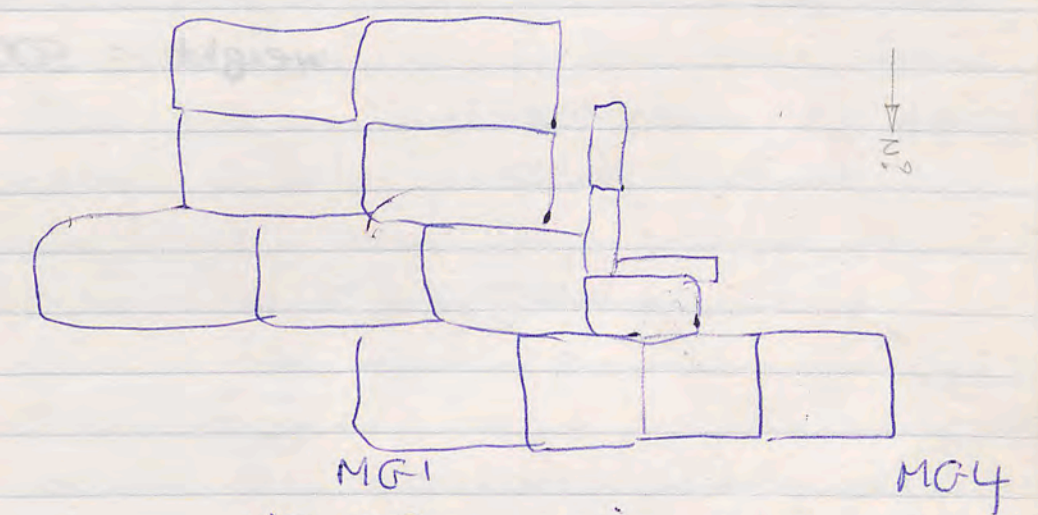

tower main part of large stones 50 cm x 130 cm
 by taking out the east bank of MG4 we have revealed a second course of the narrow "orthostat" type stones
 I still think they are a "face" to west face of the projection of the tower to form the gate.

MG4

1 30

8-6-88

12 buff coarse body shards

diagnostics

* tiny body frag of good black glaze with stamped palmette - upgraded to object no 9 88.288

♂ buff rim
buff base

weight = 500g

MG

8-6-88

AE
dirt

16 31 - the limestone chips below
1 - a sample of basalt S7
also a sample of odd shaped lime
or plaster S8

Also a sample of either a piece of
plaster floor with scraping marks or else
it is from a piece of stone with pick
marks - I think it is plaster - S9.
S8 & S9 in same bag.

MG4 east bank [116] (31) 8-6-88

6 buff coarse body shards

1 good red glaze base

weight = 200g.

MG4 east bank [116] (32) 9-6-88

39 body sherds - coarse ware

diagnostics = 4 buff rims
= 1 coarse base.

weight = 900g.

Page 33

Thursday 9th June 1988

MG

AC

Workers

Haji

Turkea

Hadija

Halaf

Zurkea

MG4

Again working in MG4 in bank area - going down further than the limestone dirt, chip & fallen stone [116] to determine whether there is a further course to the nice facing of on the projection of tower - I think this must just about all be fall - I don't think it is a packing because the orthostat stones can only be a facing and that makes [116] outside the building

[116] (32)

There is very little pottery & never has been from [116] -

does this suggest that the fall & consequent fill happened very quickly & hence no pottery or any other ^{sort} of material did not have time to enter [116] b/c it is very "clean".

MG4 & MG1 are in contrast to ~~the~~ NMGI that has a lot of pottery

JK MG4

[19] (33)

9-6-88

21 body sherds - coarse ware
mostly buff - some blackened cooking
ware

diagnostics

1 good red glaze body sherd

1 drip red painted rim

weight = 300g

9-6-88

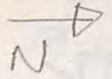

* Stones taken out - fallen
these big stones must be fallen from
superstructure - they are nicely
shaped but obviously out
of place.

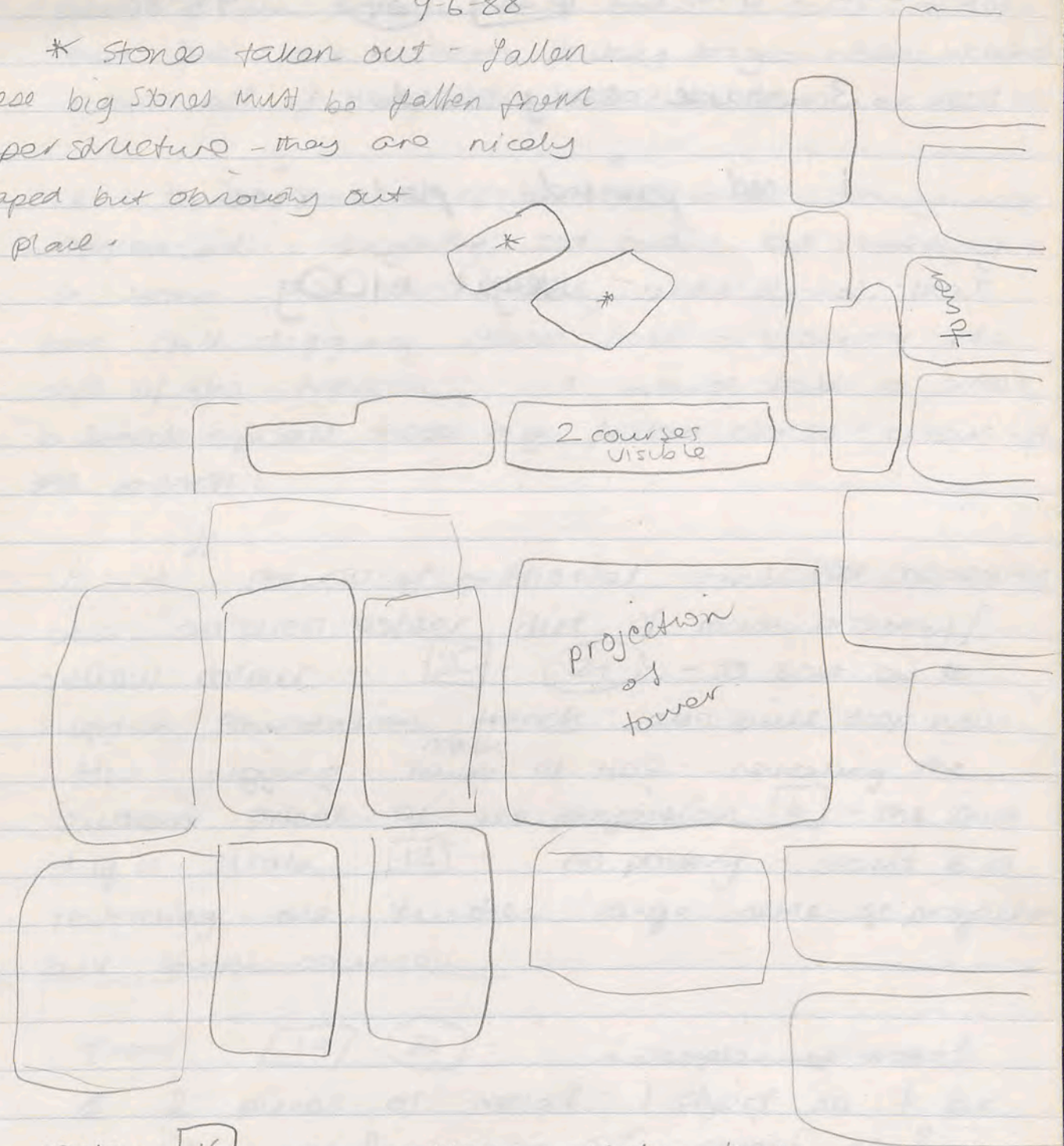

Below [16] a softer strata has
appeared - it is basically yellowish in colour
with streaks of darker soil - the chips of
limestone have disappeared - the strata is not
dirt - I still think it is soft limestone but
different to [16] it is [19] (33)

JK MG4 [20] (34) 9-6-88

3 coarse body sherds

1 red painted plate rim.

weight = 100g

also a few fragments of bone & some stones that are put in with pottery bag - when washed I can tell if they have wear on them or not.

A third course of the orthostat stones has appeared - slightly set out but missing a stone - I don't really understand that but still digging down here - leaving the rest of the trench - it would take a week to break up all those big fallen stones & clean up the trench.

A 4th course of orthostat stones has appeared also an even softer dirt of more brownish/yellow colour - [20] (34) - so soft as to suggest foundation trench - also quite deep now.

Also digging ^{north} bank of MG2 - revealing the southern extent of the projection [4] - the lower dug in strata [12] - no pottery - seems to be revealing one further large stone of projection but lower course.

From [19] (33) - 2 samples of metal

& 2 pieces of metal - 1 object no 7 for

coin
88.292
vs | pin like metal - the 2nd object no 8
for green - with slight curve - maybe silver!

Also samples of plaster S10

the same as sample 8 + 9 - this tells me that perhaps there was a floor or at least a

16

plaster floor here similar to Michaels but that
the fallen stones destroyed it - i am only pending
fragments - the other suggestion that Michaels
plaster 16 is a mortar type material b/n
courses should also be kept in mind.

511 Also a sample of here from 119 23

7100
88-215
2v

Saturday 11th JuneWorkers

Haji

Turkea

Hadija

Halaf

Zurkea

I am so excited - whilst brushing down the stones this morning I discovered some mortar in situ. It is exactly the material I have been turning in as plaster samples - that I thought might have been a floor but now seeing it in situ I know it to be mortar. It is exactly the same as Michael's boxes [6] - his is horizontal between 2 courses of large blocks on his south projection - mine is between 2 vertical blocks - it is very white - plaster like material - It also varies in size - obviously designed to fill the spaces b/n the blocks - the variance in thickness explains the thick & thin pieces I turned in as samples - all have been flat. It is my [21]

JK MG4 east bank

[19]

(35)

11-6-88

35 body sherds - some absolutely
tiny - just about all coarse ware

diagnostics - 1 red painted
body sherd
1 buff rim - fine

weight = 250 g

Page 33

MG
AE
Digging in [19] (35) - removing the rest
of the slightly harder material [19]
to bring it level with [20] - the
softer material that I believe might
be foundation trench -

Also sweeping down the area that
was north bank of MG-2 - to clean
up the southern extension of the
projection - at this stage only working
in the west.

An unusual thing. One of the blocks
of the solid built projection [4] - was
hollowed out - I always thought it
was more evidence of the way the
limestone decayed - however this stone
has collapsed and I can see that the
stone behind it has the same hollowed
out appearance - either more decay
or perhaps a drain. I am trying to
dry out some of the material that I
am digging out of the collapse & from
the "cave" - It looks like dirt but
could easily be damp decayed limestone
It is The material is [22] - A
charcoal sample has just come out
indicating to me it is not decayed
limestone from the stone b/c how would

Page 39

charcoal
limestone get into limestone - perhaps it is a drain
as Hamido from the museum suggested - charcoal
sample = [22] S 12. - The only problem
with the drain suggestion is that there is no wear
marks. I have just remembered that when
removing the bpsol [1] + [2] that the
stone below the cave ~~was~~ was burnt grey with
a little bit of ash above it - I didn't take
a sample b/c it was so close to the surface & I
thought it would be contaminated - perhaps the
stone became hollowed out + there was a "late"
fine here - radio-carbon analysis is probably
the only way to check whether these hollowed out
stones were in use in antiquity or not.

MGLX [119] (35) - boro sample S 13

A large stone out of position is appearing
Also a charcoal sample from here S 14

The plaster/mortar [21] b/n the 2
blocks is situated as the most western
extension of the projection - there is a
bit of a space filled with dirt, chips
stones - [23] - then the orthostat
facing stones begin.

This [23] is very soft + easy to
dig out. I think it must have been
filled in - this gap b/n the solid
built projection + the facing/cladding

JK MG-1 [23] (36) 11-6-88

2 body sherds - coarse

- weight = negligible

MG-4 east bank [20] (37) 11-6-88

9 body sherds

2 painted - weak black red.

1 coarse black cooking ware.

weight = ~20g

Page 40

Digging out [123] - (36) - a few tiny chips of pottery - also a metal object [10] shaped in T is this a T clamp?

Digging out the softer material [20] (37) - more large stones - more & larger than expected - how can this be a foundation trench if there are large fallen cut blocks here? I don't know - it's bloody hot.

Also having a look in MG-2 west again at southern extension of projection something very strange going on - again that hard level [114] - might it be a hard sludge used to level the ground for the foundation of the solid built projection - the large solid built stones are decayed here but they seem to run into the hard [114] - below [14] in the small pocket that has gone below it, [15], some large stones are appearing also - some pieces of the mortar / plaster found b/n stones. It is not entirely clear to me what is going on here.

JK

MG-4 east bank [20] (38) 12-6-88
18 body sherds - coarse ware
possibly one a piece of roof tile

diagnostics

- | body sherd red/black glaze
- | body sherd drip red paint
- | possible chipped base
- | chipped rim red paint
- | red/black rim
- | large coarse buff rim
- | red echinus bowl rim

weight = 500g

Page 41

MG AC
Sunday 12th June 1988

Workers

- Haji
- Turkha
- Hadija
- Halaf
- Zurka

2	42	7
158.19	153.19	153.19
2.45	3.45	2.98
<u>150.74</u>	<u>149.74</u>	<u>150.21</u>

Elevations

H.I = 151.46 + 1.7.3 = 153.19

- 4th course 29.8
- 3rd course 24.5

Digging [20] (38) - the softer strata with dots of charcoal - this material is exactly next to the facing wall at the level of the 4th course - the rest of the level is lodes like yellow limestone broken blocks

5 th course 34.5	=	149.74 m	53cm
4 th course 29.8	=	150.21 m	53cm
3 rd course 24.5	=	150.74 m	
2 nd course	=	151.24 m	
1 st course	=	151.76 m	

A sample of bone from [20] (38) SLS



MG4
east
baule

[24] (39)

12-6-88

Diagnostics

1 large pink base

2 red glaze fine rims

1 parthian ware base + 1 body shard

parthian ware green glaze

34 body sherds

1 very coarse black cooking ware

mostly coarse buff ware

1 red glaze shard

weight = 750g

NMG3

[1] (40)

12-6-88

1 diagnostics - black glaze rim ^{too} chipped ^{to draw}

14 body sherds - coarse

weight = 250g

Page 42

12th June 1988

MG
AC

material below [20] is full of charcoal
brown clayey bits still bits of limestone
very mixed material - it starts at the
5th course elevation = 149.73m

It is [124] (39)

An object from here - a piece of iron
- with no distinguishable shape

- An object - [12] - metal ~~pin~~ pin

Wall cleaning - [1] (40) - trench would
be NMG3 +

A bone sample [124] (39) 516 bone

Interesting pottery coming out - 2 green
glaze Parthian sherds - one very nice black
glaze embossed sherd [13] 88.255

frag relief br. MG4 [24]
Also charcoal sample 5/7

JK MG4 [125] (41) 13-6-88

32 body sherds

a couple of chunky coarse tile like sherds but mostly tiny frags - 1 burnt black cooking ware

diagnostics

- 1 body sherd good fine red glaze
 - 1 weak red glaze echinus bowl rim
 - 1 buff fine rim with red/black paint
 - 1 cm on interior at top of rim + 2cm on exterior
 - 1 very chipped base with weak red
 - 1 base with weak red
 - 1 burnt black rim
- weight = 500g

NMG3 [1] (42) 13-6-88

36 body sherds - mostly coarse

diagnostics

- 1 good black glaze body sherd - tiny
- 1 weak black glaze rim

weight = 800g

Monday 13th June 1988

Workers

- Haji
- TURKEA
- HADIJA
- HALAF
- ZURKEA

Digging down at 5th course in east bank area of MG4 of fewing blades - New locus - soil is more hard packed - a lot of specks of charcoal - different coloured soil - yellow, + brown - the brown patches are clay-like - not mud bricks but ~~so~~ something - they appear to have a bit of + most definitely g. + small stones in it
New locus is [125] (41) here sample S18 charcoal sample S19

NMG3
Also continuing wall clearing [1] (42)

Excavating [125] - parts of a broken pot appearing - PJC took photo - making it a separate bag - (43) - that is the pieces of pot

NMG3 [1] (42) object $\triangle 14$ frag of lamp 88.362
NMG3 [125] (41) $\triangle 15$ - metal frag

JK MG4

25

43

13-6-88

All from one pot

- 3 parts of the base

- 4 body sherds

- should join up

burnt black in places - from

strata of burnt with charcoal
weight = 100g

NMG-3

1

44

22 buff coarse body sherds

2 very chipped bases

- 1 buff

weight = 400g

page 44

MG
AR

WORKERS

Tuesday 14th June 1988

Haji

TURKEA (FAZA)

HADISA

HALAF

ZURKEA

still wall cleaning in area of NMG3

1 44 - Incredibly windy

Huge big blocks of the tower appearing
attempting to find an edge to it -
would also like to find where the city
wall joins the tower but may run out
of time - these blocks are the biggest I
have seen so far, & a few have
remnants of the mortar/plaster gleaming
whitely between the cracks - Its purpose
I think is to fill the gaps between the
blocks - There is also evidence of the
plaster on top of a block - perhaps to
level it for the course on top - the two
functions would strengthen the construction
Turning in more samples of the
mortar for analysis S 20.

?

width of projection 4m 35
that is from facing stone to internal
"not so fine" facing stones. Actually top
course of facing blocks chipped -

MG-7 1 45 15-6-88
 26 body shards
 mostly buff & pink buff - 1 weak red paint
 1 diagnostic - 1 rim - pink buff

pid agut.

MG-4 east bank 26 46 15-6-88

17 buff & pink buff body shard.
 1 weak red paint
 1 blackened cooking ware

diagnostic:

1 chunky base with weak
 red/black glaze
 1 fine weak red/black glaze rim

probably from echinus bowl.

Page 45

14-6-88

MG
 A-0

width of 2nd course = 28 cm
 width of east 'facing' blocks = 30 cm
 - not all blocks the same - another = 50 cm

In the east bank of MG-4 - where I have been digging down the facing blocks - I think I have reached the bottom - there is a 6th course set out further than the rest of the courses & it is not regular the way the others have been regular. Also there is some very hard packed brown earth here - suggesting the bottom - It is so windy to work down there today but tomorrow I will investigate further & check that this is the bottom.

$$\begin{array}{r} 154.94 \\ .63 \\ \hline 154.31 \end{array}$$

$$\begin{array}{r} 154.94 \\ 2.23 \\ \hline 152.71 \end{array}$$

$$\begin{array}{r} 154.84 \\ 1.18 \\ \hline 153.76 \end{array}$$

$$\begin{array}{r} 154.84 \\ .85 \\ \hline 154.09 \end{array}$$

$$\begin{array}{r} 154.84 \\ 1.76 \\ \hline 153.18 \end{array}$$

$$\begin{array}{r} 154.94 \\ 1.81 \\ \hline 153.13 \end{array}$$

$$\begin{array}{r} 153.80 \\ 1.14 \\ \hline 154.94 \end{array}$$

$$\begin{array}{r} 153.80 \\ 1.67 \\ \hline 151.57 \end{array}$$

$$\begin{array}{r} 153.80 \\ 2.23 \\ \hline 151.57 \end{array}$$

$$\begin{array}{r} 154.94 \\ 2.02 \\ \hline 152.92 \end{array}$$

Page 46

Wednesday 15th June 1988

MG

AE

Workers

Haji
Turnea
Hadiga
Halaf
Zurua

Elevations at Michael's
SMG1

$$\begin{aligned} \text{H.I} &= 153.80 + 1.14 \\ &= 154.94 \\ \text{NW C. } & \text{E} \\ & \text{NW} = 2.23 = 152.71 \\ & \text{SW} = 1.67 = 153.27 \\ \text{1st surface} &= .63 = 154.31 \\ \text{2nd surface} &= .90 = 154.04 \\ \text{3rd surface} &= 1.18 = 153.76 \\ \text{4th surface} &= 1.76 = 153.18 \\ \text{4 a} &> 1.75 = 153.19 \\ \text{4 b} &= 2.02 = 152.92 \\ \text{5} &= 1.81 = 153.13 \\ \text{NW stones is} &= 1.76 = 153.18 \end{aligned}$$

NMG3 - still wall clearing here
now in what would be trench MG 7
clearing right up to modern road to
obtain face 1 45

Also ~~clear~~ working in MG4 east bank to
check on foundation
6th ~~course~~ course of facing stones - only on
east face - (west face continues down
a normal sized block of 5th course)
east face has a smaller sized block
for its fifth course - then the sixth

Page 47

course is uneven + not joined together + some of the uneven blocks jut out from 10cm to 16cm + some have up to a 5cm gap b/w blocks

This 6th uneven course made me think that it was the bottom course + would be resting on bedrock. The strata at the very edge of the blocks is reasonably soft while the material 5cm out from the blocks is very hard packed. The soft material is 126 the hard packed material 127. I didn't dig out the hard packed material but I dug out a section of 126 (46) - I was expecting bedrock but I dug out 40cm of the red/brown soil that had bone + pottery frags in it, so obviously not on top of bedrock - there is no stone under 6th course - 6th course is sitting on 126 - the area is very difficult to work in + I am really not so sure as to what to do next here. Talk to Peter.
bone sample 126 (46) S21.

Working on wall clearing MG7 - still unclear - no beautiful big blocks appearing rather a fallen jumble at both the south + west face of the tower construction reminiscent of the whole trench MG4 indicating that this is fall from above - I will clean a bit more tomorrow to check on this edge.

$\begin{array}{r} 152.37 \\ 3.52 \\ \hline 148.85 \\ 152.37 \\ 2.05 \\ \hline 150.32 \end{array}$	$\begin{array}{r} 152.37 \\ 3.11 \\ \hline 149.26 \\ 152.37 \\ .09 \\ \hline 152.28 \end{array}$	$\begin{array}{r} 151.46 \\ .91 \\ \hline 152.37 \\ 3.00 \\ \hline 149.37 \\ 152.37 \\ 1.45 \\ \hline 150.92 \end{array}$
$\begin{array}{r} 152.37 \\ 2.04 \\ \hline 150.33 \end{array}$	$\begin{array}{r} 152.37 \\ 151.42 \\ \hline 15.47 \end{array}$	$\begin{array}{r} 152.37 \\ 1.94 \\ \hline 150.43 \end{array}$

Page 48

MG
AC

Workers Thursday 16th June 1988
Haji

Turkea
Hadija
Halad
Zurkea,

Elevations

MG1	H.I	151.46 m	+ .91 =	152.37 m
MG2	6 th course	=	- 3 m =	149.37 m
	hard	[27]	= - 3.11 =	149.26 m
	depth dug	[26]	= - 3.52 =	148.85 m

MG5	NMG3 MG7	} lower levels.		151.47
				151.42
			1.	09 = 152.28
			2	1.45 = 150.92
	3	2.05 = 150.32		

MG2 - below hard [114] - [115] - stone 1.94
- stones + dirt 2.04

Below hard surface [114] I dug out some of the soft material [115] - I stopped at a large stone that has an elevation of 150.43 m - adjacent to that stone I dug a bit lower and stopped at an elevation of 150.33 m.

No.	Plant	Height	Location	Date
1	HO1	1	...	21-5-58
2	HO1	1	...	22-5-58
3	HO1	2	...	23-5-58
4	HO1	3	...	24-5-58
5	HO1	4	...	25-5-58
6	HO1	5	...	26-5-58
7	HO1	6	...	27-5-58
8	HO1	7	...	28-5-58
9	HO1	8	...	29-5-58
10	HO1	9	...	30-5-58
11	HO1	10	...	31-5-58
12	HO1	11	...	1-6-58
13	HO1	12	...	2-6-58
14	HO1	13	...	3-6-58
15	HO1	14	...	4-6-58
16	HO1	15	...	5-6-58
17	HO1	16	...	6-6-58
18	HO1	17	...	7-6-58
19	HO1	18	...	8-6-58
20	HO1	19	...	9-6-58
21	HO1	20	...	10-6-58
22	HO1	21	...	11-6-58
23	HO1	22	...	12-6-58
24	HO1	23	...	13-6-58
25	HO1	24	...	14-6-58
26	HO1	25	...	15-6-58
27	HO1	26	...	16-6-58
28	HO1	27	...	17-6-58
29	HO1	28	...	18-6-58
30	HO1	29	...	19-6-58
31	HO1	30	...	20-6-58
32	HO1	31	...	21-6-58
33	HO1	32	...	22-6-58
34	HO1	33	...	23-6-58
35	HO1	34	...	24-6-58
36	HO1	35	...	25-6-58
37	HO1	36	...	26-6-58
38	HO1	37	...	27-6-58
39	HO1	38	...	28-6-58
40	HO1	39	...	29-6-58
41	HO1	40	...	30-6-58
42	HO1	41	...	1-7-58
43	HO1	42	...	2-7-58
44	HO1	43	...	3-7-58
45	HO1	44	...	4-7-58
46	HO1	45	...	5-7-58
47	HO1	46	...	6-7-58
48	HO1	47	...	7-7-58
49	HO1	48	...	8-7-58
50	HO1	49	...	9-7-58
51	HO1	50	...	10-7-58
52	HO1	51	...	11-7-58
53	HO1	52	...	12-7-58
54	HO1	53	...	13-7-58
55	HO1	54	...	14-7-58
56	HO1	55	...	15-7-58
57	HO1	56	...	16-7-58
58	HO1	57	...	17-7-58
59	HO1	58	...	18-7-58
60	HO1	59	...	19-7-58
61	HO1	60	...	20-7-58
62	HO1	61	...	21-7-58
63	HO1	62	...	22-7-58
64	HO1	63	...	23-7-58
65	HO1	64	...	24-7-58
66	HO1	65	...	25-7-58
67	HO1	66	...	26-7-58
68	HO1	67	...	27-7-58
69	HO1	68	...	28-7-58
70	HO1	69	...	29-7-58
71	HO1	70	...	30-7-58
72	HO1	71	...	31-7-58
73	HO1	72	...	1-8-58
74	HO1	73	...	2-8-58
75	HO1	74	...	3-8-58
76	HO1	75	...	4-8-58
77	HO1	76	...	5-8-58
78	HO1	77	...	6-8-58
79	HO1	78	...	7-8-58
80	HO1	79	...	8-8-58
81	HO1	80	...	9-8-58
82	HO1	81	...	10-8-58
83	HO1	82	...	11-8-58
84	HO1	83	...	12-8-58
85	HO1	84	...	13-8-58
86	HO1	85	...	14-8-58
87	HO1	86	...	15-8-58
88	HO1	87	...	16-8-58
89	HO1	88	...	17-8-58
90	HO1	89	...	18-8-58
91	HO1	90	...	19-8-58
92	HO1	91	...	20-8-58
93	HO1	92	...	21-8-58
94	HO1	93	...	22-8-58
95	HO1	94	...	23-8-58
96	HO1	95	...	24-8-58
97	HO1	96	...	25-8-58
98	HO1	97	...	26-8-58
99	HO1	98	...	27-8-58
100	HO1	99	...	28-8-58
101	HO1	100	...	29-8-58
102	HO1	101	...	30-8-58
103	HO1	102	...	31-8-58
104	HO1	103	...	1-9-58
105	HO1	104	...	2-9-58
106	HO1	105	...	3-9-58
107	HO1	106	...	4-9-58
108	HO1	107	...	5-9-58
109	HO1	108	...	6-9-58
110	HO1	109	...	7-9-58
111	HO1	110	...	8-9-58
112	HO1	111	...	9-9-58
113	HO1	112	...	10-9-58
114	HO1	113	...	11-9-58
115	HO1	114	...	12-9-58
116	HO1	115	...	13-9-58
117	HO1	116	...	14-9-58
118	HO1	117	...	15-9-58
119	HO1	118	...	16-9-58
120	HO1	119	...	17-9-58
121	HO1	120	...	18-9-58
122	HO1	121	...	19-9-58
123	HO1	122	...	20-9-58
124	HO1	123	...	21-9-58
125	HO1	124	...	22-9-58
126	HO1	125	...	23-9-58
127	HO1	126	...	24-9-58
128	HO1	127	...	25-9-58
129	HO1	128	...	26-9-58
130	HO1	129	...	27-9-58
131	HO1	130	...	28-9-58
132	HO1	131	...	29-9-58
133	HO1	132	...	30-9-58
134	HO1	133	...	1-10-58
135	HO1	134	...	2-10-58
136	HO1	135	...	3-10-58
137	HO1	136	...	4-10-58
138	HO1	137	...	5-10-58
139	HO1	138	...	6-10-58
140	HO1	139	...	7-10-58
141	HO1	140	...	8-10-58
142	HO1	141	...	9-10-58
143	HO1	142	...	10-10-58
144	HO1	143	...	11-10-58
145	HO1	144	...	12-10-58
146	HO1	145	...	13-10-58
147	HO1	146	...	14-10-58
148	HO1	147	...	15-10-58
149	HO1	148	...	16-10-58
150	HO1	149	...	17-10-58
151	HO1	150	...	18-10-58
152	HO1	151	...	19-10-58
153	HO1	152	...	20-10-58
154	HO1	153	...	21-10-58
155	HO1	154	...	22-10-58
156	HO1	155	...	23-10-58
157	HO1	156	...	24-10-58
158	HO1	157	...	25-10-58
159	HO1	158	...	26-10-58
160	HO1	159	...	27-10-58
161	HO1	160	...	28-10-58
162	HO1	161	...	29-10-58
163	HO1	162	...	30-10-58
164	HO1	163	...	31-10-58
165	HO1	164	...	1-11-58
166	HO1	165	...	2-11-58
167	HO1	166	...	3-11-58
168	HO1	167	...	4-11-58
169	HO1	168	...	5-11-58
170	HO1	169	...	6-11-58
171	HO1	170	...	7-11-58
172	HO1	171	...	8-11-58
173	HO1	172	...	9-11-58
174	HO1	173	...	10-11-58
175	HO1	174	...	11-11-58
176	HO1	175	...	12-11-58
177	HO1	176	...	13-11-58
178	HO1	177	...	14-11-58
179	HO1	178	...	15-11-58
180	HO1	179	...	16-11-58
181	HO1	180	...	17-11-58
182	HO1	181	...	18-11-58
183	HO1	182	...	19-11-58
184	HO1	183	...	20-11-58
185	HO1	184	...	21-11-58
186	HO1	185	...	22-11-58
187	HO1	186	...	23-11-58
188	HO1	187	...	24-11-58
189	HO1	188	...	25-11-58
190	HO1	189	...	26-11-58
191	HO1	190	...	27-11-58
192	HO1	191	...	28-11-58
193	HO1	192	...	29-11-58
194	HO1	193	...	30-11-58
195	HO1	194	...	1-12-58
196	HO1	195	...	2-12-58
197	HO1	196	...	3-12-58
198	HO1	197	...	4-12-58
199	HO1	198	...	5-12-58
200	HO1	199	...	6-12-58

Pottery List.

BAG	TRENCH	LOCUS	STRATA	DATE
✓ 1	✓ MG 1	SURFACE SHERDS	SURFACE SHERDS	21-5-88
✓ 2	✓ MG 1	1	topsoil	21-5-88
✓ 3	✓ MG 1	1	topsoil	22-5-88
✓ 4	no pottery MG 1	2	mixed/below topsoil	22-5-88
✓ 5	✓ MG 1	2	mixed/below topsoil	23-5-88
✓ 6	✓ MG 1	6	yellow, coarse, stony	23-5-88
✓ 7	missing 1 sherd only MG 2	SURFACE SHERD	1 sherd only	24-5-88
✓ 8	✓ MG 2	1	topsoil	24-5-88
✓ 9	MISSING MG 2	7	dirt below topsoil	25-5-88
✓ 10	✓ MG 2	7	dirt below topsoil	26-5-88
✓ 11	✓ MG 2	7	dirt below topsoil	28-5-88
✓ 12	no pottery MG 2	11	gravel - small stones & dirt	28-5-88
✓ 13	✓ MG 4	4	surface sherds	29-5-88
✓ 14	✓ MG 4	1	topsoil	29-5-88
✓ 15	✓ MG 2	15	soft beige dirt	29-5-88
✓ 16	✓ MG 4	1	topsoil	30-5-88
✓ 17	✓ MG 4	1	topsoil	31-5-88
✓ 18	✓ MG 4	16	limestone dirt & chips below	31-5-88
✓ 19	✓ MG 4	16	"	1-6-88
✓ 20	✓ MG 4	16	"	2-6-88
✓ 21	✓ MG 4	17	dirt below	2-6-88
✓ 22	✓ MG 2	15	soft dirt	4-6-88
✓ 23	no sherds MG 4	16	limestone chips	4-6-88
✓ 24	✓ MG 4 NMG 1	surface sherds	surface sherds	4-6-88
✓ 25	✓ NMG 1	1	topsoil	4-6-88
✓ 26	✓ N bank MG 2	1	topsoil	5-6-88
✓ 27	✓ NMG 1	1	topsoil	5-6-88
✓ 28	✓ NMG 1	1	topsoil	6-6-88

[Faint handwritten notes and a vertical list of numbers (1-20) on the left page.]

Pottery Bags

Bag No	Trench	Locus	Strata	Date
✓ 29	NMG-1	1	bpsoil	7-6-88
✓ 30	MG4 east bank	1	bpsoil	8-6-88
✓ 31	MG4 bank	16	embryo chips + dirt	8-6-88
✓ 32	MG4	16	limestone dust + chips	9-6-88
✓ 33	MG4	19	softer limestone dust	9-6-88
✓ 34	MG4	20	even softer yellow/brown	9-6-88
✓ 35	MG4	19		11-6-88
✓ 36	MG-1	23	dirt / stones blm	11-6-88
✓ 37	MG4 bank	20	+ cladding	11-6-88
✓ 38	MG4 "	20	soft / brown / charcoal	12-6-88
✓ 39	MG4 "	24	charcoal / brown	12-6-88
✓ 40	Wall Cleaning NMG3	1	topsoil surface	12-6-88
✓ 41	MG4	25	hard brown / yellow	13-6-88
✓ 42	Wall Cleaning NMG3	1	bpsoil	13-6-88
✓ 43	MG4	25		13-6-88
✓ 44	NMG3 wall cleaning	1	bpsoil	14-6-88
✓ 45	MG 7	1	bpsoil	15-6-88
✓ 46	MG 4 east bank	26	soft adj 6 th course	15-6-88
✓ 47	NMG3	1	bpsoil	16-6-88

SAMPLE LIST

NO	TRENCH	LOCUS	Basket	DATE
1	MG4	16	19	lime 1-6-88
2	MG4	16	23	bone 4-6-88
3	NMG1	1	27	bone 5-6-88
4	NMG1	1	27	basalt 5-6-88
5	NMG1	1	27	clay mould
6	NMG1	1	28	like 51 lime/odd plaster
7	MG4 bank	16	31	basalt
8	MG4 bank	16	31	like 51 + 56 odd plaster
9	MG4 bank	16	31	possible plaster
10	MG4 bank	19	33	plaster
11	MG4 bank	19	33	bone
12	MG1	22		charcoal
13	MG4	19	35	bone
14	MG4	19	35	charcoal
15	MG4	20	38	bone
16	MG4	24	39	bone charcoal
17	MG4	24	39	charcoal
18	MG4	25	41	bone
19	MG4	25	41	charcoal
20	NMG3	1	44	mortar
21	MG4	26	46	bone

same bag

both plaster

LOCUS LIST

NO.	TRENCH	DESCRIPTION	PAGE	DATE
1	MG1	TOPSOIL	1,2	21-5-88
2	MG1	grey, patches of yellow	3	21-5-88
3	MG1	Patch of yellow	4,5	22-5-88
4	MG1	All stones in MG1 ^{representing} built up layers of tower.	6	23-5-88
5	MG1	similar to 3 but ^{separated} by blocks		28-5-88
6	MG1	same as 5 but larger stones in SW corner of trench		23-5-88
7	MG2	brown dirt coarse me below topsoil	1	25-5-88
8	MG2	small stones - ^{possible} wall	p10	25-5-88
9	MG2	east of 8 - beige soil	p10	25-5-88
10	MG2	yellow limestone ^{crumble}	p10	25-5-88
11	MG2	gravel	p12	28-5-88
12	MG2	west - below 11 - yellow - limestone		28-5-88
13	MG4	yellowish - chips - limestone		29-5-88
14	MG2	hard - concrete level	p15	29-5-88
15	MG2	- soft - beige, coarse dirt	p15	29-5-88
16	MG4	- white/yellow limestone chips	below 11	30-5-88
17	MG4	dirt - below topsoil - SW corner		2-6-88
18	MG1	brown clay - b/n diff. ^{east} courses		8-6-88
19	MG4/1	soft - limestone-ish -	below p34	9-6-88
20	MG4/1	softer yellow/brown	below 19 p35	9-6-88
21	MG1	mortar b/n blocks	p37	11-6-88
22	MG1	^{dirt} material from collapsed stone	p38	11-6-88
23	MG1	dirt/stones b/n 4 cladding	p39	11-6-88
24	MG4/1 (bank)	charcoal / brown limestone chips	p42	12-6-88
25	MG4	harder packed	24 p43	13-6-88
26	MG4 east	= soft adjacent s th 6 th course	p47	15-6-88
27	MG4 bank	- hard packed adj	126 p47	15-6-88

DATE	PAGE	DESCRIPTION	NO.
83-2-18	15		1
81-2-28	8	yellow & yellow	2
			3
			4
			5
			6
			7
			8
			9
			10
			11
			12
			13
			14
			15

NO.	LOCUS	BASKET	Object	DESCRIPTION	ELEVATION	DATE
1	2	(4)		metal, curved		22-5-88
2	3	-		metal, broken		25-5-88
3	16	(20)		tiny black glaze incised "vase"		2-6-88
4	15	(22)		metal pin		4-6-88
5	1	(27)		metal pieces		5-6-88
6	1	(26)	MG2	tiny grey vase like 		5-6-88
7	19	(33)	MG4	metal pin		9-6-88
8	19	(33)	MG4	green-curved frag		9-6-88
9	1	(30)	MG4	* body frag good black glaze with stamped palmette		8-6-88
10	23	(36)	MG1	T-shaped metal		11-6-88
11	24	(39)	MG4	iron		12-6-88
12	24	(39)	MG4	bronze pin		12-6-88
13	24	(39)	MG4	black glaze embossed		12-6-88
14	1	(42)	NMG3	frag lamp		13-6-88
15	25	(41)	MG4	metal frag		13-6-88

2008

MON 30-5-88
 TUE 31-5-88
 WED 1-6-88
 T 2
 F 3
 S 4
 SUN 5-12-88 **25** **25**
 M 6
 T 7
 W 8
 T 9
 F 10
 S 11
 S 12
 M 13
 T 14
 W 15
 T 16
 F 17
 S 18
 S 19
 M 20
 T 21
 W 22
 23
 24
 25
 26
 27

25
 25

LL
 LL
 LL

wall