

NWT
PJC: 1987



STUDENTS NOTE BOOK

No. 593

P.J. CONNOR
JEBEL KHALID 1987
NORTH WEST TOWER TRENCH 1/2.

Wednesday 29 April 1987 Beginning 7.30 am.

NW Tower Jebel Khalid.

Weather: sunny, but hazy

Workmen: 4. Hamad Muzc; Hassam Hassam;
Jum'ia Ibrahim; Younis M. Hamad.

Work is planned to continue the unfinished trench of 1986. Initially B+W photographs taken of upper section with platform of squared blocks: from the S and E. This section is W of tower wall

Photographs B+W taken from S and N of tumble to E of inner wall of tower.

Work continues on W section from S → N clearing the top soil down to level of platform of blocks. The aim here is to complete this section of the trench, uncover all the blocks of the platform and to investigate what if anything lies beneath this platform, to be seen perhaps where this level of blocks is missing at the NW corner of the platform within this area.

In the section E of the tower wall, after the photographs, work begins on removing the heavy tumble which was cleaned in 1986 but was not intended to be removed.

However ..

See stretcher from Tr 1 W
2 May 87 p. 2
small ends left fairly rough
1.00 m x 0.55

JK NW
tower

29.4.87

However, during study between seasons the question of the relationship of the plaster floor leading to the entrance (see 1986 Diary) and the part of the wall to the S that had already been cleared down two courses...

The plaster flooring has a smooth surface but it is hard to interpret this as the entrance floor into the tower since it seems too friable for foot traffic. Is there perhaps a ramp just below the plaster floor? Is there perhaps a retaining wall at the S of the entrance way?

These sorts of problems seem to make it imperative to expose the whole of the wall face from the entrance way S to the join with the curtain wall at the S.

To begin with 3 large wall blocks are removed. These blocks are not worked smooth on all sides: each is a header rather than a stretcher. The headers in situ are very roughly cut ^{except for} beyond the outer face and a small section adjacent the stretcher on either side. Tumble large blocks and smaller beneath = locus ^E 4

Work then continues on light brown soil beneath the large blocks of tumble. This soil is quite loose; it has small chips of limestone in it. No fragments of pottery. This tumble and soil with chips is cleared down to the same level reached at the S of the trench in 1986. At this point the 'soil' becomes quite light, almost white, and is full of chips of limestone. This stratum is presumed to be where limestone chips fall from the finishing trenches to the wall blocks.

29.4.87 Tr 1 E [4]
6 frags coarse ware

JK
NW tower.

29.4.87

11 am, in the W section work continues clearing the platform especially close to the wall. Within the extension of the entrance to the W of the wall face, there is huge tumble. But it looks at the moment as if the edge of the platform to the N, in line with the S face of the entrance, can be uncovered without removing that tumble. A decision will have to be made later whether or not to excavate that area of the entrance that falls within the trench boundaries, after removing the large wall blocks (tumble).

12 noon. Stiff warm breeze blowing. weak sun - haze remains and has thickened if anything.

Work continues well in both sections.

E of wall we approach another set of large tumble which perhaps by chance abuts the tower wall. Beneath the large block second from the wall is a pack of larger stones. This would not really seem to be an ancient structure but the soil will be cleared to these blocks in order to ascertain what has happened. I note that further N of said blocks is more large tumble right up to the S edge of the entrance way. Perhaps all is tumble. The depth of the trench is still at the bottom of the second preserved course. A piece of pottery, quite damp, will come from the white layer. This end has more tumble below. Will give a quick brush and photograph.

Photographs. One bag of half-a-dozen sheds from E trench.

Tuesday 30 April 1987

Jebel Khaleid North West Tower.

Weather sunny, clear, light breeze, cool

Work begins at 7 am at foot of JK.

Workmen: 4 Hamad Muza; Hassan Hassan;
Juma'a Ibrahim; Younis M Hamad.

Trench 1 E

Work begins with inspection of state of play. There are large blocks of tumble and other smaller blocks beneath. See photographs of end of work yesterday. Initially soil is further cleared around and under the blocks. At 8 am. photographs (Roll 1 14-16) from S. As discussed previously, the large tumble left now, after removal of some large blocks to the S at the beginning of work yesterday, has assumed a configuration which resembles a structure ~~case~~ in an arc towards the wall.

Work this morning has rather confirmed that this configuration is accidental and shaped by the way it fell from the wall and by our work of excavation. The small stones beneath the blocks are surrounded by the fine light-brown soil which has been typical in this stratum of tumble (= Stratum 2), a further indication that we are dealing with random tumble. Some stones are inclined to the wall rather than placed horizontally. It was therefore decided to remove these blocks. At first, those close to the wall ^{approx 60 cms} moving from S → N. Soil is first removed in order to reveal the size of the large block and to assist removal without breaking equipment. This work continues from 8-15 am.

JK NW Tower.

30.4 87

Trench 1 W

Work continues here close to the wall, removing the soil from the platform of blocks. Indications are that the platform continues beyond the S edge of the entrance way. At this point some soil is free of the large tangle, so work continues here from S → N where possible. If the platform continues, the tangle will be cleared at removal for further examination of the structure.

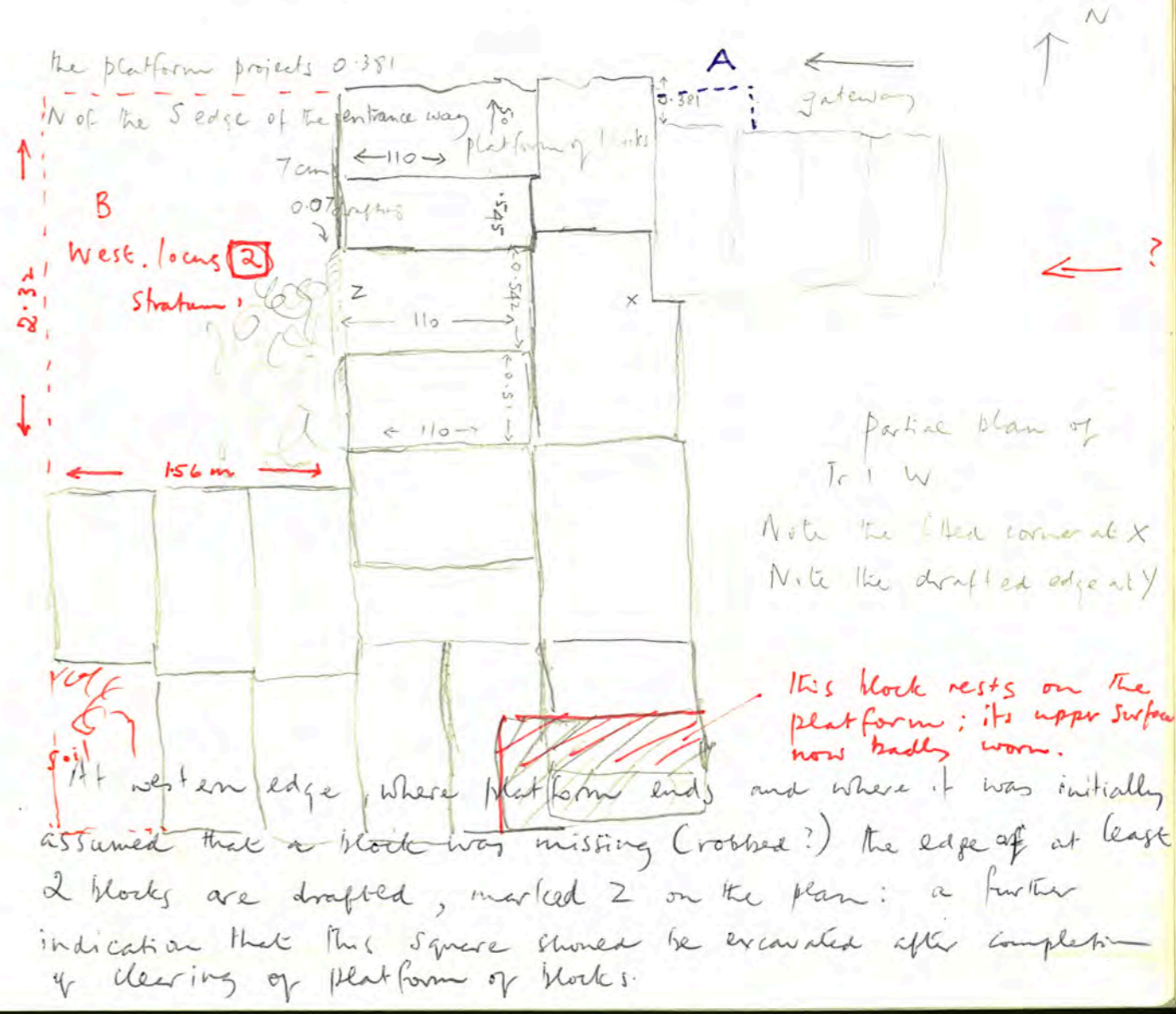

JK NW tower.

30.4.87

10 am. Tr 1 E. Difficulty in removing large tumble with equipment. Soil carefully removed around before removal of stone. Work continues. The space being cleared is irregular but approx 60 cms E of the wall. Further E is large tumble which may not need to be removed. For the moment, I decide to leave it as is.

10.15 am. beneath tumble, level with second course down, there appears to be a laid flat stone or block. Work however continues on tumble. This flat block belongs to the next stratum.

Tr 1 W.

The edge of the platform to N has been uncovered but large tumble prevents easy continuation here. Anyway it is not necessary to continue immediately.

A small tongue of soil stands at point A on plan on previous page: 55 cms long. 22 cms at W edge of entrance blocks; 35 cms at E edge. Work proceeds on this. The N boundary of this tongue of soil is formed by a large tumbled block. This work should show whether or not the platform overhangs a little round the entrance gate.

12 noon. Photographs of cleared platform (from E) roll 1 nos 17-22, showing N edge of platform, with drafted edges along W. Photograph from W of small tongue of soil now removed and made level with present state of entrance way as excavated in 1986 (there is however some soil and stone covering still over the plaster floor: this will be removed soon; The protection

30.4.87

is still useful at the moment

After photography, work commences on locus 2 of the NW trench that is soil over the area within the NW of the platform enclosing or covering the space where the blocks of the platform do not continue. The drafted edge of the blocks may mean that the blocks as we have them formed the upper surface of this section within the walls.

Within locus [2] we work on stratum ①, which is a topsoil of light brown colour in which there are a few chips of limestone. This will be brought to the level of the platform blocks where the soil appears to be lighter in colour with white chips of limestone.

Tr 1 E. work continues slowly scraping soil around large tumble; at 12.50 photograph of state of things. Large blocks will be removed next working day.

A very few fragments of pottery, only from Tr 1 E.

Jabal Khalid
North West Tower

Saturday 2 May 1987

Weather: sunny, cool, light breeze
Workmen 5: Abu Ibrahim, Hamad Muza, Hassan Hassan,
Chamis Mahnūd; Türkē Muza. Abu Ibrahim went
home ill about 10.30 am.

Work begins at 6.15 at foot of JK.

Trench 1 E

Work commences immediately on removal of large blocks of
fumble photographed at the end of work on Thursday.
The soil beneath is loose with chips of quite white limestone.
The soil is brown (light brown) as before, but appears more
mixed with the white powdery material which forms the
lower stratum still to be excavated, lower than the second
preserved course. There appear to be smoothed but not square
blocks at the bottom of this stratum level with the bottom of
the second course. Beneath the fumble there is an accumulation
of soil and chips to a depth of a full course of wall blocks.
The junction with the plaster floor is not at all clear.

Photograph of stall at 7.15 from S. 3 or 4 photographs
Roll 1, 26f. from S. one photograph in colour.

Immediately after photographs I probed the rough face of
the trench at this point and revealed a square block
which showed from the face of a ramp or steps at
the entrance. We continue work to clear this block, removing
all soil to the S of it but leaving the soil on top.
No pottery emerges so far.

JK NW tower.

2
2.5.87

Trench 1 W locus 2

Work continues on stratum 1, equals the top for 1, revealed small blocks of tumble. This will be cleaned and photographed before work is continued.

The large block to N of platform loosened and fell over as work began today. It is roughly cut at level of the thinner ends; 4 sides are reasonably squared. It measures $\approx 1.00\text{ m} \times 0.55\text{ m}$.

Trench 1 E

Block on floor of trench seems substantial, perhaps this is bedrock. There is a small gap between it and the wall, at present filled with the white powdery material and limestone chips. Bedrock close to the wall is approx 1.20m from the top present course.

8.10 am Sun becoming warmer.

The blocks in the trench face at N are not continuously placed. A block below the one I located after the photograph is squared and projects a little to the S. There seems nothing to the E of these blocks, but clearing is not yet completed.

9.05 am

becoming cloudy, wind freshening

Having reached the corner of the gateway and exposed the full E face as far as the corner, it is not clear what the situation is at the gateway. It seems we have cleared to bedrock but at the N face of the trench the blocks are too random

2.5.87

Tr 1 E (3)

Small LF 2 doz coarse ware wall frags.
buff or buff-orange clay.

2 small pieces black glaze Attic clay
1 has traces of redletting

2 rim frags small bowls weak light-brown/red paint
1 small coarse ware handle frag.

JK NW tower

2 May 1987

to be a deliberate structure. After cleaning and photographing I shall continue on the limestone chip stratum of Tr 1 E beginning again from the south end and working towards the gateway. Bed rock may be close to the present surface which is level with the bottom of the second preserved course I shall later remove the soil and rock covering from the plaster floor at the entrance way and then decide how best to proceed.

Tr 1 W locus 2 9.20 am.

Clearing proceeds. At the south end of locus 2 there is not so much tumble and the soil is quite pale and dusty therefore this is left for the moment since it is clearly part of stratum 2 which should lie beneath the larger stones to the N of locus 2. Red soil will perhaps persist a little below the tumble.

Photographs taken at 9.45 end of roll 1

Clouds covering the sun.

Photographs from S and E during rewinding, some sort of malfunction. Camera opened before roll fully rewound. Some frames probably lost!

2 small pieces fine black glaze →

JK NW tower

2.5.87

Trench 1 East

10.30 am.

Photographs of N face of trench with bed rock. Roll 2, 1-9

overcast!

We begin on stratum 3 at the S edge of the trench working towards the N. 3 sherds found immediately. Hope there is more to come! Coarse ware.

The trench walls, crumbled from last year, are in a real mess. The whitish stratum appears to be only a few centimetres deep. There is a very fine light brown soil beneath that. We work on the whitish layer only. - stratum (3)

11.50 2 small pieces fine black glaze found in deposit of chips just above bed rock which is very rough at this point ^{see opp. p.2}

12.15 Saw 4 tiny pieces of carbon in stratum (3) near join of tower to curtain wall.

1 small lot of fragments

Trench 1 West locus 2

11 am. Light brown soil round the tumbler. The whitish layer has not yet been excavated.

12.25 almost completed stratum around tumbler, with light brown soil

sky has been overcast for some time. Stiff and coldish wind blowing

JK NW Tower.

5.

2.5.87

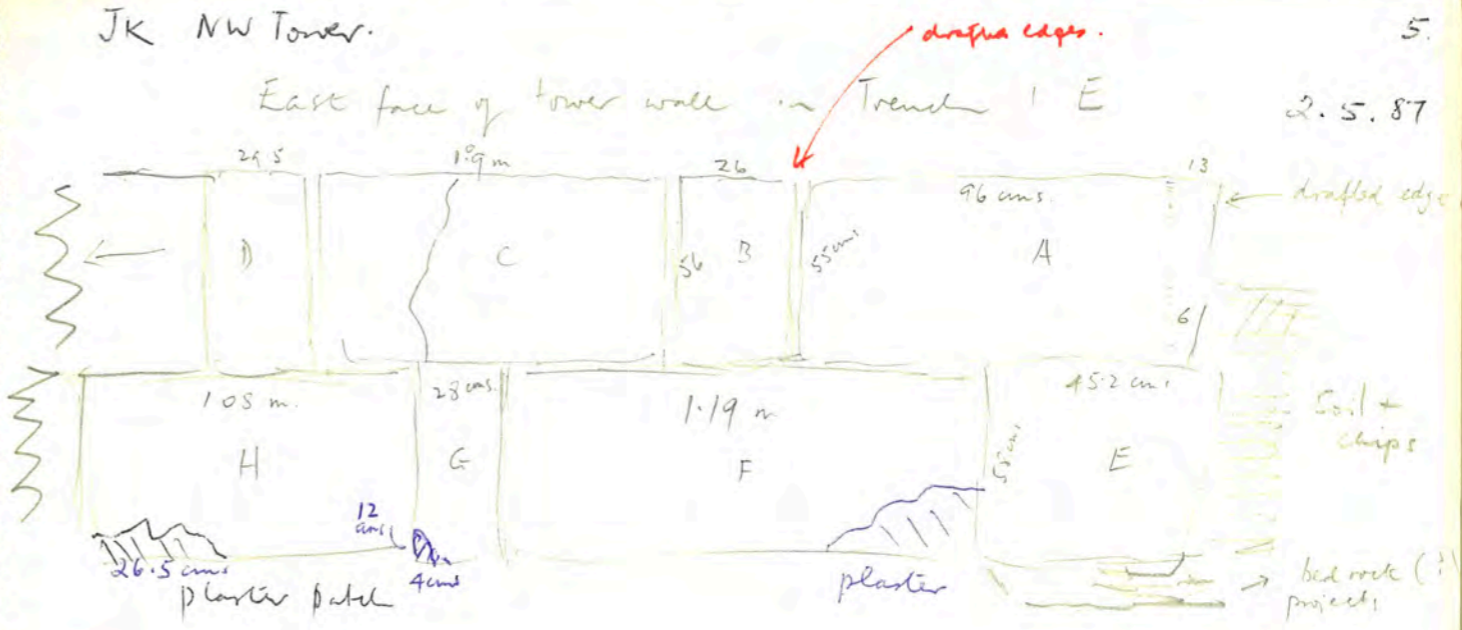

* the front edges of block B are drafted at sides and at bottom.

- Block C has a crack on its face
- Block E has diagonal cuttings from chisel
- Block F has a very rough face

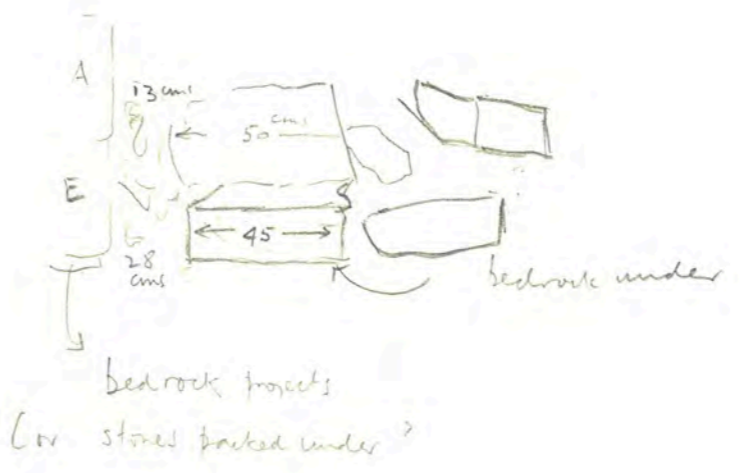

Jebel Khalid

Sunday 3 May 1987

North West Tower

Weather, sunny, slightly hazy, no wind at fort
Workmen are ready to work at 6. After roundup begin 6.30 am
Workpersons: 6 : Hassan Hassan; Jum'ia Ibrahim.
Dūma Nasr (F); Turkié Tatalta (F); Mahmūd M Hamad,
Turkié Musa.

Trench 1 E (3)

Work continues on stratum 3 removing the whitish powdery
stratum full of limestone chips. Work had progressed from
the irregular S face of the trench to a point just N of the
join between tower wall and curtain wall. Immediately
more tiny specks of carbon are discovered.

8 am. *Marker
patch* Inspection of the corner of the gateway, on the E face
of the tower wall reveals that the bottom right hand corner
of the large block has been completed in plaster to repair a
defective corner. Does this mean that these blocks were visible

Trench 1 W locus 2

Work begins on stratum 3 of locus 2. This a white
powdery deposit mixed with limestone chips. It contains only a
few large stones of limestone. Its upper surface lies only a little
below the level of the platform of stone blocks to the E and S.
The depth varies depending on mixture of large blocks but generally
it is c. 8 cms.

At S boundary the light brown fine soil appears at c. 18 cms.
The light brown soil appears slightly damp.

JK NW tower

3.5.87

Trench 1 N.

With two workmen, we began to uncover again the plaster surface or floor. We do this as carefully as possible.

8.30 am. The plaster floor appears to continue inside the entrance way - but that was uncovered as four W or two large blocks of tumble

Trench 1 E

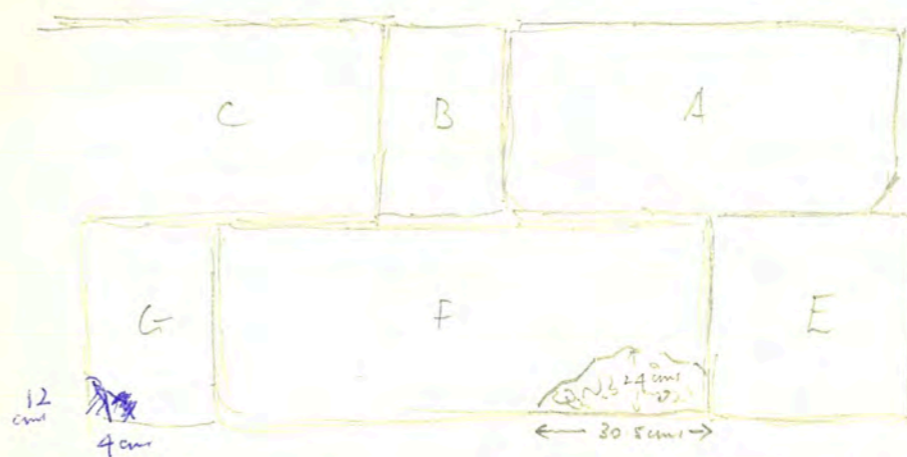

See sketch
2.5.87

The present measurable height of the plaster patch is 24 cms. but there is a narrow gap between between bedrock and wall, where the foundation trench was dug.

The bedrock in this corner has strange shapes on its surface but it is worn and smoothed as if walked on regularly in antiquity.

The surface of the plaster patch is roughened, similar to the rough surface of the block.

9.25 two B+W photos of plaster patch from E (in shade)
one colour. → phot 2, 10-11.

JK NW tower

3.
3.5.87

Trench 1 E (3)

9.30 am. Within stratum 3 (whitish with limestone chips)
a series of rough stones begins to appear. They form perhaps
the corner of a square. There are larger blocks on the outside
with smaller stones in the middle.



These blocks are cleared a little for the moment and work
proceeds.

10.40 am. Tr 1 E (3) a small bronze pin or needle.
slightly bent in stratum (3); 30-40 cm N of the corner
of blocks sketched above. 87.002

No wind. Sun blazing hot

I take a small sample of white powdery deposit of (3). might be
possible to determine whether this is limestone stone or gypsum or
plaster for binding blocks. No evidence for plaster between blocks

small bronze pin or needle
87.002

4 frags coarse pottery

JK NW tower

3.5.87

Tr 1 W (cont 2)

Work continues slowly on stratum 3 (which is perhaps 6-7 cms deep) It is very white and powdery on the surface when walked on. Only 4 fragments of coarse pottery to date - the first greeted with wild acclamation. This is not however the same as the plaster floor in the gateway.

Tr 1 N

11 am. Work has continued on uncovering the plaster floor (extending to the southern boundary of this section). When this section is properly cleared, photographs

What to do then? I am considering making out a line ~~about 80 cms~~ running EW about 80 cms to 1 metre N of the south face of the entrance, and excavating through the plaster floor to expose the S ~~side~~ face of the gateway; to see the relationship between the plaster floor ~~and~~ the foundation block with the plaster patch plus the bedrock in Tr 1 E which is below the preserved height of the E tower wall.

80 cms or 1 metre should give plenty of room for excavation though at least one large block will need to be moved.
of rubble

3.5.87

Tr 1 W [2] (3)

7 course ware frags.

JK NW tower

3.5.87

Tr 1 W locus 2

Limestone rock.

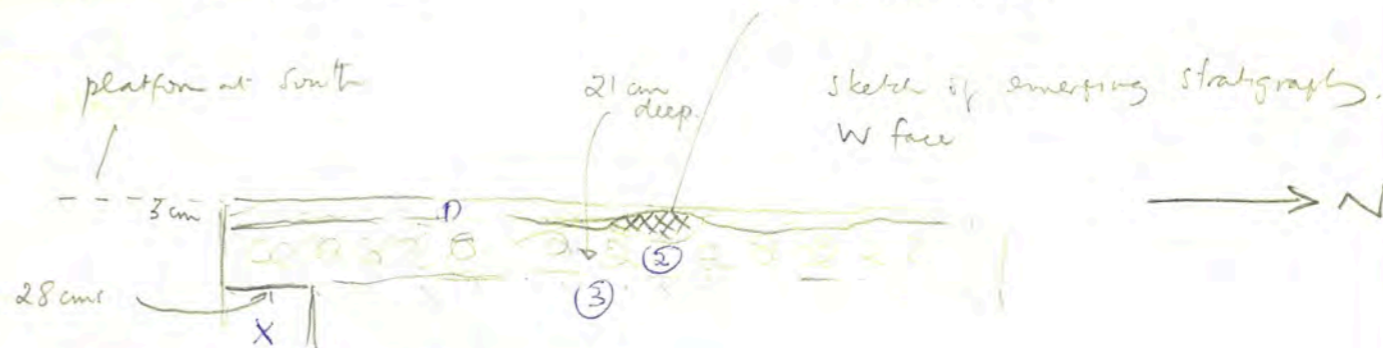

- (1) is a thin layer of top soil
- (2) is a fine brown soil with much larger blocks of limestone
- (3) is a whitish powdery deposit with small chips of limestone

a large block of tumbled W of the wall, which has been struck with a pick has a bright white powdery substance now in the pick holes. A small sample of this stratum taken from Tr 1 E (3)

At the spot marked X, for 28 cm next to the platform block at the W of locus 2, is light brown soil. The whitish powdery deposit does not reach as far as the wall. This is true also on E side of locus 2. Something similar happens in Tr 1 E where there is a fine light brown soil against the wall. I assumed here that it was below the whitish deposit but some of light brown soil lies beside the lower parts of the whitish powdery deposit.

JK NW tower.

3.5.87

Tr 1 N

12 noon photographs of cleaned area in gateway showing plaster floor. This is smooth only near the two large stones at the E end of Tr 1 N. The remainder is (as it has brushed and cleaned out) a rough conglomerate of plaster and stones. Now it has a very rough surface. It is not clear whether it has a formed boundary at the S, since the blocks that lie beneath it are rather roughly placed one on top of another. Furthermore close to the wall corner, there is no solid block. The space is filled with loose soil and small stones mixed.

87 004 not identifiable

Tr 1 W loc 2 ^{corroded.}

12.20 pm. a worn, encrusted half a coin found in stratum ③
 the white powder + chips stratum. **87.004**

1 bag of half a dozen coarse ware frags (+ half coin)

TR 1 E ⑤ 1 bag c. dozen coarse ware frags
 (+ bronze needle)

Jebel Khalid NW Tower

Monday 4 May 1987

Weather sunny, cold wind
work begins at 6.15 at foot of Jebel

Workpersons 6: Hamad Musa; Turkiya Tataha (F)
Bounaniya (F); Duma (F), Junia Ibrahim
Turkie Musa (?)

Trench 1 E (3)

Work continues on the limestone chip stratum in the area of the rough squared structure. These blocks do not have squared surfaces, so are not fully contiguous. In the interstices is the loose whitish powdery loam with limestone chips. This might indicate that the stones were laid before the construction of the tower wall and the falling chips etc. filled the spaces. But the squared construction is very unsubstantial and I can't see what it is. It is perhaps not random tumble.

A plaster patch also on the second large block N of the join of curtain wall and NW tower, at the bottom left corner. See p. 5 of 2.5.87 (= Block 14)

More fragments of carbon - near middle of the section of curtain wall, in the fine light-brown soil

JK NW Tower.

4.5.87

Tr 1 W locus 2

Work continues on stratum 3 - whitish with limestone chips
working from N to S.

2 persons work on cleaning the wall capping of the wall
structure.

Tr 1 W locus 2

a chunk of plaster (small chunk) found at N end
of locus 2. still in the whitish deposit mixed with chips; below
that is a deposit of fine light brown soil which we are
leaving for the moment (I hope). The light brown soil
appears to be 35 cms down from the top of the 'platform'.
Why the light brown soil is beneath the whitish/chip
deposit is a puzzle to me at the moment.

JIC NW tower

4.5.87

Trench 1 E

9.15 am Cleaning round tangle at S of this section. Preparatory to photography. We have probably reached the foundation block of the curtain wall; it is very rough on the outer face.

11.50 after much cleaning, photographs Roll 2, 26 → end from E. S. W.

also 2 or 3 colour photographs including "structure" of rough blocks at S end of trench. where soil still clings round blocks but if cleaned further the stones could loosen and debris disturb the configuration as we have it now.

There is clear sign of vertical cutting for foundation trench especially against the curtain wall, but this is left for the moment. Beneath the final block of the tower at S lies a very smooth and flat slab of stone to build up the lower level. From here in a SE direction along the curtain wall the remaining space of the foundation trench is quite wide; small blocks of tangle were found in the topmost stratum.

In the rest of the trench, bed rock has been reached but not properly cleaned. This will be done after the foundation trenches have been cleared.

After photography, clearance of foundation trenches.

(4)

4.5.87 NWT Tr 1 W (3)

- Small wt coarse ware sherds
- 1 very heavy base frag. coarse ware
- 1 rim frag small bowl, curved rim, pale buff clay greenish tinge on outside
- 1 wall frag partially painted light buff clay dark brown interior. pp. exterior
- 1 frag with hole in centre - but not piercing fabric rough conical very shattered.
- 1 small frag. dark brown dull weak glaze.

4.5.87 NWT Tr 1 E (4)

- Small wt coarse ware frags
- one pale orange clay large jar.
- 3/2 rim frags partially painted ware: bowls, small
- 1 wall frag
- rim frag semi-coarse bowl weak red-brown paint
- Small notches

rim frag bowl, dull weak brown black glaze.



- 4.5.87 Tr 1 E (3) 2 dozen coarse ware frags.
- one rim frag thin bowl weak dull red glaze, notch b. rim exterior
- 1 small rim frag small bowl weak light brown paint broad notch below rim * 2 doz small pieces carbon.

JK NW tower

4.5.87

Tr 1 W locus 2 (3)

12.10 work continues very slowly more small blocks of tumble appear at S of locus 2 below (3), the whitish powdery deposit. More fragments of coarse ware are revealed today (at least 2 doz.) The tumble is the only feature of locus 2.

Jebel Khalid North West Tower

Tuesday 5 May 1987

Weather sunny, cool breeze at first.

6:15 at foot of Jebel.

Workpersons, 4: Jumai Ibrahim, Dūma (F); Turkiya
Tataha (F); Hamad Mūsā.

Trench 1 E.

Work continues on stratum (4) which is the gap between
the foundation trench and the curtain wall. This space is quite
wide (wider than elsewhere in this trench) and seems to be quite
deep. The soil is fine, light-brown. There are some large
chunks of limestone. The gap widens towards SW and
perhaps cuts back NW. There are some small specks of
carbon. The 'square' of rough blocks lies on bed rock, which
might mean it was constructed at the same time as the
foundation trench was cut for the wall. (?)

9:30 am. Difficult work in the foundation trench: the space
is narrow and deep.

Trench 1 W (ous [2] ③)

Work continues slowly on stratum 3 (with a bit of stratum 4
mixed in unfortunately) see over page for photos →

7:45 B+W photographs of newly cleaned capping of tower
wall Roll 3, 4-10

8:05 am. Roll 3, 11-12 photos SW and S of tomb robbing
areas, from NW tower

5.5.87

JK NW Tr 1 W [2] (3)

Very small lot coarse ware frags (1 doz)

1 wall frag partially painted exterior, bi-dark brown weak paint on interior. thin, hard fired, crisp; ochre clay

* 1 hard fired wall frag deep orange clay.

1 rim frag small bowl with notch exterior just below rim partially painted interior (+ exterior)

1 coarse ware shoulder frag. parallel ribbing (slight) near rise of neck. ochre clay.

1 handle frag 3 vertical shallow ribbing

5.5.87

Tr 1 W [2] (4)

numerous small pieces semi coarse ware

* 1 rim frag greenish vitreous glaze (weak) small bowl. light buff clay

2 frags semi-coarse ware wall frags with thin band of red/brown paint across

* 1 wall frag partially painted ware

1 other wall frag ditto

1 base frag small coarse ware skyphos.

1 bronze head

1 piece bronze

JK NW tower

5.5.87

8:15 photograph of small plaster patch on Block G. from E.

Tr 1 W locus 2

8:50 Work begins on stratum 4, a deposit of fine light brown soil. Immediately a lower course becomes obvious with some small tumble within the soil deposit. The depth of this stratum is approximately 40 cms below the drafted edge of the platform blocks

Although the platform has this drafted edge at the W side this need not mean that the preserved platform was the upper surface. The surface of the platform does not appear worn, as it would if it had been some sort of pedestrian surface.

9:25 as excavation progresses it becomes clear that there is not much fine, light-brown soil. The soil is harder and has a reddish tinge. This might be the result of contact with the upper surface of bedrock which has rotted with the soil on top of this it. There do seem to be several small blocks of tumble in it however, which are not removed at this stage.

The large wall block that has loosened and collapsed on to the platform at N end has been removed (in several pieces)

11:30 am. The soil below the whitish powdery deposit is very dark brown mottled with reddish patches.

* a small rim fragment, ^{yellow-green glazed ware} and two small frags of bronze from this stratum (or combination of (3) and (4))

5.5.87

Trench 1 E.

10:45 am. The foundation trench against the circuit wall has been cleaned and brushed down to bedrock. The depth of the vertical cut from top of bedrock is 69 cms. The depth from the lower preserved block in the centre of the curtain wall section is 1.75 m.

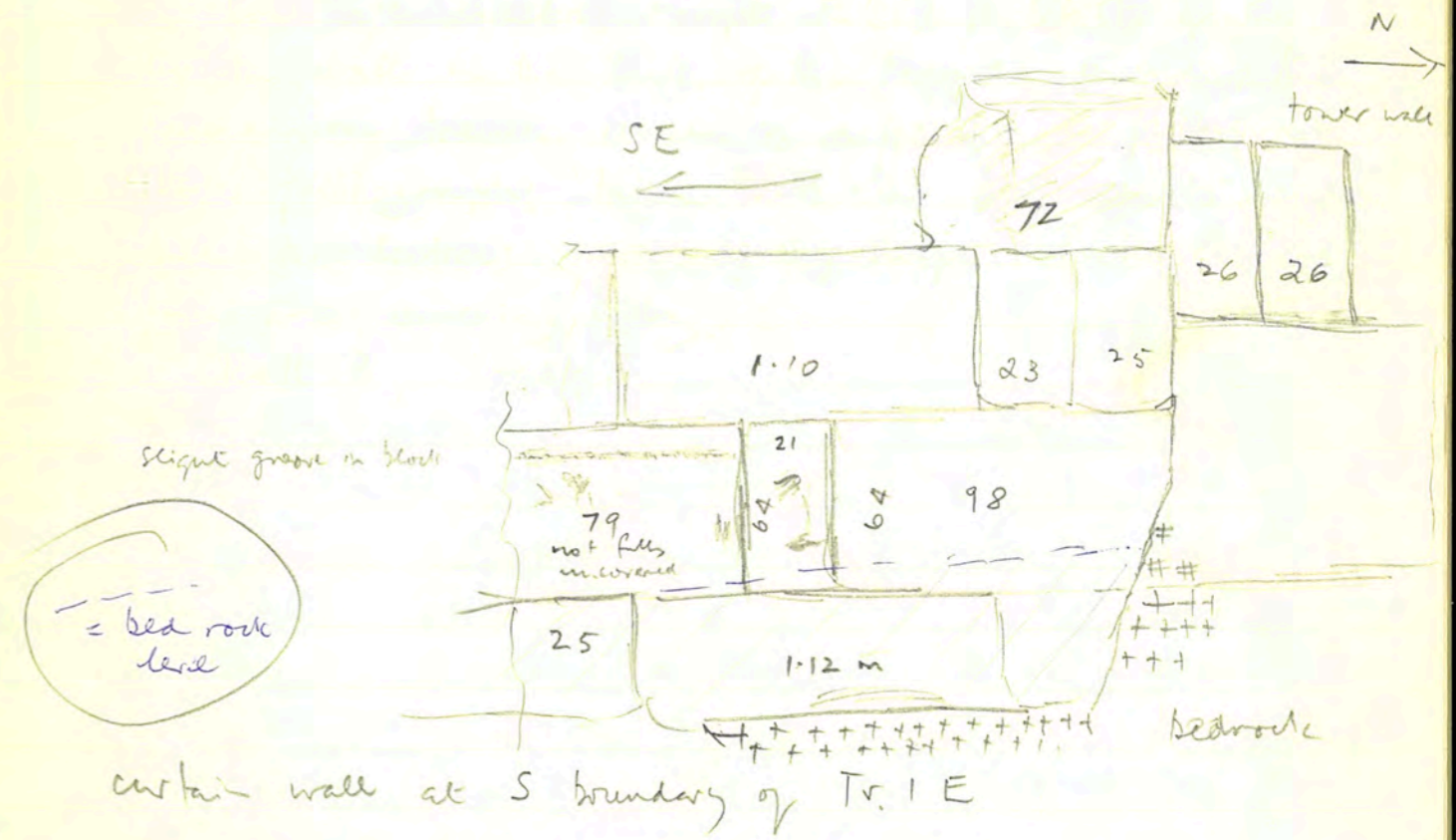

11 am. begin cleaning removing soil and limestone chips immediately above bedrock in centre part of trench near block H (see 2.5.87) and working S toward foundation trench.

JIC NW tower.

4
5.5.87

Tr. 1 E.

The 'square' foundation of rough blocks does not sit on bedrock but on a few centimetres of soil = 9 cms.

12.40pm. several shots of the 'square' foundation from all directions except E (?). Shots of the curtain wall on the south of the trench, including the foundation trench which is difficult to photograph. These photographs taken with the sun at its height but the sections were newly swept. Perhaps some tomorrow morning early.

Roll 3, -24.

Wednesday 6 May 1987

Jebel Khalid North West Tower.
Work being 6.15 at foot of Jebel.

Work persons 4: (Gillian also 4) Dūma (F); Jumāa Ibrahim; Hamad Musa; Turkiya Ta'aha.

Weather sunny, no breeze at first quite warm already.

Trench 1 E.

Another bout of sweeping along bed rock throughout the trench preparatory to photography whilst floor and lower blocks still in shade

Numerous photographs taken from all directions; comprehensive view, detailed views of rock-cut foundation trench, as best as can be taken in such a confined space

Roll 3 25-36, Roll 4, 1-

The foundation course of the curtain wall lies a full course deeper, perhaps because the bedrock slopes away quickly after the higher bluff upon which the tower itself is placed. For example the south block of the tower wall is levelled by being placed on ² smoothed blocks of different heights to cope with different levels of bedrock. Since the bedrock within Tr. 1 at this point is very deeply cut, it may also be possible that the curtain wall was considered to require deeper and stronger foundations. The bottom of the foundation trench is not flat right up to the vertical cut; it rises a little in two uneven steps. Perhaps finishing levels were achieved as the wall

JK NW tower

6.5.87

proper came to be built. The bedrock seems worn; note especially the strange protrusion at the N end of the trench which has a smoothed upper edge. Note also the squared construction of small stones packed inside a perimeter of larger stones (though not built on bedrock) seems to show that it was exposed. Bedrock however could be naturally smoothed as far as I know.

Tr 1 N locus 3.

Measuring from the N edge of the gateway 80 cms a string is placed EW to indicate the limits of locus 3 where excavation will continue beneath the plaster floor. This 80cm strip (EW) should give enough room to work against the N edge of the gateway and it also preserves intact the smoothed section of plaster towards the E of Tr 1 N.

Immediately the large and probably random large blocks of tumble are removed light brown soil (fine) is in abundance behind and below. Some pieces of pottery including a rim fragment of a bowl comes from the

6.5.87

fine light brown soil. It might be difficult to keep completely separate material from the upper stratum which seems to have large packed stones with white deposit around and the brown soil, since we are coming from stratigraphy from the side rather than from the top.

The light brown will be stratum ③

- top soil (removed 1986) = ①
- white powdery stratum also called plaster floor. = ②

9.15 am, rocks appear within stratum 3. Not yet quite clear. after a quick brush I thought it might be bedrock; the workers think it is a worked block. The fine red soil seems to continue W round the corner of the gateway.

Tr 1 W locus 2.

Work continues here in very hard packed soil of stratum 4 cleaning round tumbler which lies mainly on the S half of the locus. The soil is thick and dark brown. Its hardness around the tumbler is not something encountered elsewhere on the NW tower. There are some fragments of coarse ware pottery in this stratum.

9.40 in the SE corner of locus 2 the soil is fine, light brown, and loose. This is left, to be excavated later after cleaning of

6.5.87

JK NWT Tr 1 W 2 (4)

Small Lt semi-coarse frags

inc. orange clay, orange inside. buff exterior.

w/ strokes diff. direction as putting on slip

3 rim frags small bowls, weak red or brown glaze

1 coarse ware body frag w. stripe of weak dark brown paint across it

1 wall and handle frag: coarse ware stammas

J.K NW tower

6.5.87

Tr 1 W locus 2

10.40 am. photographs from all directions of exposed and cleaned tumble in locus 2. Tumble lies in S part of locus. It is level with, approximately the bottom of blocks that form the platform. From the edge of drafted block, the depth to the next course which projects a little is 44 cms

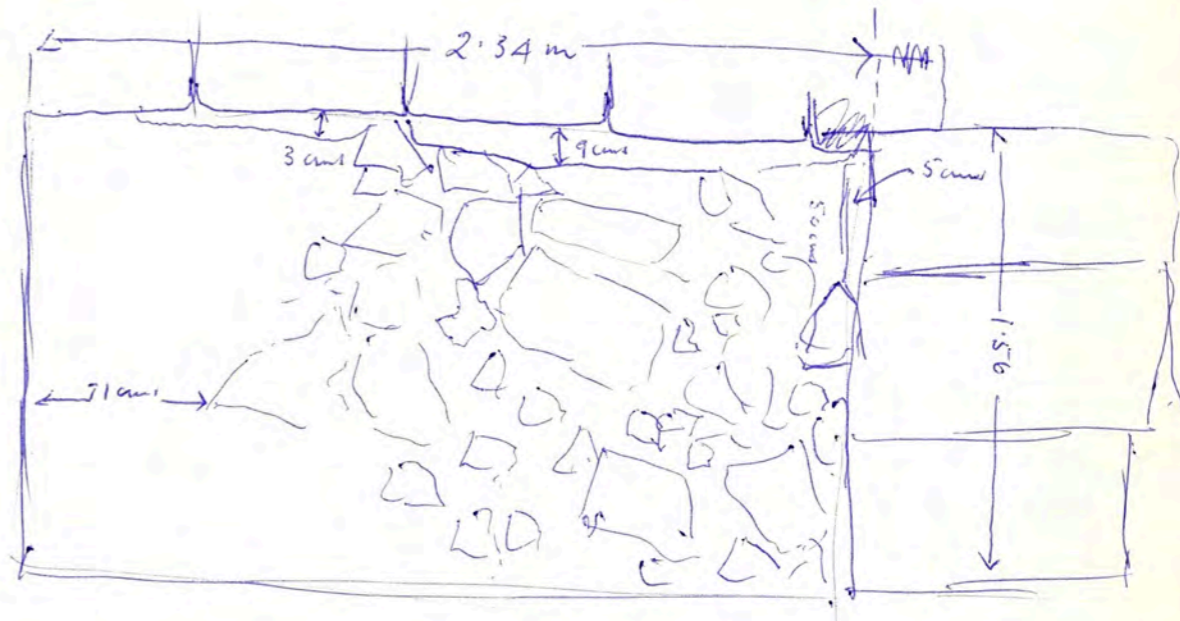

Tr 1 W locus 2.

After photography, work continues in the N section of the locus to see if there is tumble a little further down.

The pottery is kept with the rest of today's meagre finds as stratum (4). The tumble stratum will be called (5)

Some pieces of coarse ware immediately from (4) at N. Some limestone chips mixed in soil

JK NW tower.

6.5.87

Trench 1 N [3]

Though work is still proceeding and no clear trench face is yet achieved, the stratigraphy does not so much show a plaster floor as the familiar thickish stratum of white powdery deposit mixed with limestone chips. It would be as much as 43 cm deep though there are some large stones.

At the top the whitish layer is fine and powdery and perhaps 17 cm deep. It has no soil mixed with it

↳ 20-17 cm deep.

At about 20 cm, there is some admixture of a light brown colour, this is just above the larger worked rocks on the trench face

Closer to the S wall of the gateway there are some limestone chips but the soil is brown to a distance of approx. 34 cm N of the S edge of the gateway. N of this the fine white powder is again observable

11:35 am

No pottery since the first few pieces at start of work on this section.

12:20 pm Work has continued. Red rock appearing at bottom of second course. Sweep for photographs of N wall of tower 3 including white powdery substance which is not yet cleared back to the string marking the end of the tower at N.

Roll 4, 24-25

6.5.87 MWT Tr 1 N [3] (3)

doz fine frags

1 rim frag semi-coarse bowl

slight ribs exterior

light buff clay

1 tiny frag weak red glaze int

and ext

1 larger frag with weak red & black glaze



JIK
NW tower.

6.5.87

Tr 1 W locus 2 (4)

Work continues on NW corner. Dark brown soil small stones; more timber appearing at slightly lower depth than S section of [2]. Some small pieces of bones in (4) in NE corner c. 11.30 am. at a depth of approximately 66 cms from top of platform at this point.

12.15 pm. locus 2 NE corner: bed rock begins to appear. in dark soil just above bed-rock, handle with wall of coarse ware pot. Work continues.



Thursday 7 May 1987

Jebel Khalid North West Tower.

Weather, fine; overcast Sun appears 7.30 am.
Workmen, 4 Hamad Musa; Duma (F); Turkiya
Tatahar; Jumaa Ibrahim.

Tr 1 W locus 2

Work continues on N section of locus 2 - where there is no
tumble. This stratum I call (4). Dark brown soil, hard
packed; a few pieces of pottery. We are reaching bedrock.
This stratum is quite deep below the level of the tumble
in the S section of locus 2: 79 cms from top of platform
to bedrock. There is also a foundation trench where the
deposit is quite loose: a mixture of limestone chips with
limestone powder, and soil, to give a light yellowy colour.
This deposit is left for the moment. The remaining width
of the foundation trench is from 6 cm to 8 cm wide
widening a bit more at the N. of the locus. *PKM see over*

11.10 am Work progresses slowly. Some tiny fragments of bone in
(4). We are just reaching the N boundary of the tumble.

11.25. Commence work on area with tumble. The pottery will be
kept separate. I call this stratum (5) though it is equal in
depth with (4). Perhaps the finds need to be kept separate.

The bedrock at the SW is cut into strange shapes. One
looks to be a squared block almost carved out of bedrock

7.5.87

Tr 1 W [2] (4)

- 1 body frag 'partially painted' ware
- 1 frag weak red glaze - orange brown clay
- 1 lid knob, black at surface, core black surrounded by red



Leat on top.

= unguentarium toe.
fWC

2 coarse ware base frags.

- 1 coarse ware handle frag - small.
- 1 rim frag. gray. Made on top + inside underside reserved. reserved at inside lip. light orange clay.

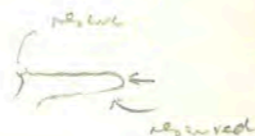

coarse ware sherds: orange-brown clay, buff clay.

7.5.87

Tr 1 N Locus 3.

Work continues, clearing the two strata: 1. white powdery deposit ~~at~~ there = stratum (2)
 2. the brown soil below it = stratum (3)
 by 8.10 am. 2 pieces of coarse ware from brown soil.

It is becoming increasingly difficult to see this as a plaster floor, since the deposit is so thick, since it must lie outdoors. The smoothed section is (perhaps) fortuitous. Water on the powdery limestone smoothed by pedestrian activity, that is people walking on it, or perhaps sweeping it. Beneath the powder lie rough, random blocks. At the construction of the tower the whole area must have been cleared to bedrock. As the building went on, it is possible that the entrance way was filled with rubble in order to create a more suitable level for walking through. The white powdery substance may then be a deposit from the finishing touches to the construction blocks. Feet on it could easily crush chips into dust. We have found that the limestone is in fact very powdery it struck with a sharp point like a pick. It is clear at this stage that the vertical cutting in the door jamb goes the full length of the present preserved top course of the wall, but does not continue into the foundation block. That is the full length of the socket (or whatever it is) is below the upper surface of the white powdery deposit.

8.30 am. while work is still in progress I am preparing

7.5.87

to photograph work in progress to show the large
rocks below the powdery deposit. These protrude into level
3 from the N face. I will need to consider whether they
are to be removed or should stay. To leave them all
would be to cramp the space available to reveal the full
S wall of the gateway.

photos 8:45 am. from S etc. E also colour
Roll 4, 26-36.

9:30 work continues.

North West Tower

At the S of the trench are two non-contiguous construction
blocks. One stands on the platform, giving clear indication
that the platform as we have was the base for further
courses above. To the SW of that lies another block, 40
cms. distant, and sited diagonally to it. I consider that
this block is in situ and is one course where the outer
face of the curtain touches the S wall of the tower. It
looks then important enough to excavate S of the join
of the inner face of the curtain with the inner face of the
tower to see what remains of the outer wall and its join to
the tower. This may perhaps be done simply by
measuring out the trench as laid down in 1986
This gives a width of about 1.10 m

JIC NWE

7.5.87

Tr 1 W [2] (5)

12 noon.

Beneath the tumbler is the same red-brown close packed soil.
We remove the tumbler first. Yes we do.

Weather clouding over slightly from time to time.

Beneath the tumbler, several coarse ware fragments appear.

12.35 pm two small frags of bone + some more.

The soil is dark

Tr 1 N [3] Work continues along S face of gateway

The drafting on the edge of each block is quite wide

The drafting continues along the base of the block where it meets the foundation course. These seem to me now to

be merely drafting and not sockets for fixing a door.

Some decorative element is added to the face of the gateway, perhaps.

Only 4 frags of pottery so far from the soil stratum, and these early in the morning.

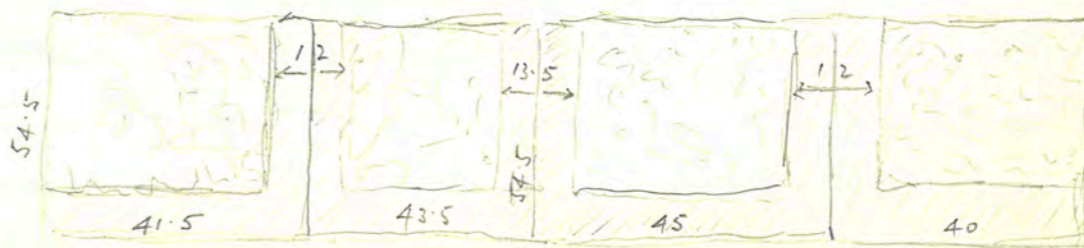

9.5.87 JK NWT Tr 1 W [2] (6)

- 1 heavy coarse ware base, orange-brown clay
- * half dozen fine ware frags.
- * 1 fine coarse ware rim frag with notch below rim outside
- 1 tiny rim frag of small bowl, weak red paint
- 1 base free coarse ware.

Small lot coarse ware frags.

[buff clay; light orange-brown clay.]

9 May 1987

Jebel Khalid
North West Tower

Weather overcast; wind, strong and cold.

Workmen 4; Jumia Ibrahim, Duma (F); Hassan Hassan; Hamed ^{Musa}
Trench 1 W [2] stratum (5) and (6)

At the end of work on Thursday 7 May, several pieces of pottery were discovered grouped together. Some fragments were clearly from the same pot; other fragments could also belong. These were kept together in a small plastic bag. These pieces were associated with a dark stratum beneath the tumble (and just above bed rock. This stratum I should call (6); but it is more likely to be the same as (4) in the N section of the trench where there was no tumble.

Some small pieces of bone also come immediately this morning from (6)

All the pottery comes from (6) this was kept separate in a bag and removed. Work continues only on (5) which is a soil of a reddish colour mixed with white limestone chips. A good number of pottery fragments come from this stratum also. Some fragments have traces of red paint. There is a rim fragment of a bowl with dark paint outside and a stripe of brown at the rim on the inside. Since this stratum is contemporary with the construction of the tower, this piece can perhaps be dated by it and can perhaps in turn help to date other non-stratified material. Small pieces of bone come from both (6) and (5)

JIC NWC

9.5.87

Trend 1 N 3

Work continues on clearing the S face of the gateway
7.45 am. a large wall block is removed from the SW face of the
locus 3 in order to continue clearance along the 80m line
marked out previously, to proceed as far as the platform
of Tr 1 W. We could perhaps now continue locus 3 to the
W edge of the platform of Tr 1 W.

9.30 am. The locus is extended past the large tumbled wall
block to the W, to expose the N face of the platform

9.5.87 Tr 1 N [3] 5 coarse ware wall frags.

9.5.87 Tr 1 W [2] (6)

doz frags coarse ware sherds light buff clay.
rim frag. red brown coarse ware



3 rim frags small bowls weak red or brown glaze
1 wall frag partially painted ware

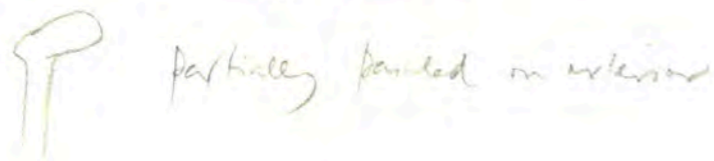

9.5.87 Tr 1 W [2] (5)

generous lot of coarse ware pottery
light buff, light orange clay
reasonably well levigated

- * 6 rim frags small partially painted bowls
- * 2 body frags of the hard orange clay fabric
- 1 fine cut base frag. semi coarse ware
pale red inside, + fabric; pale ochre slip, exterior
- 4 body frags. red paint int. red stripes, exterior
- 1 thickish coarse ware rim frag.

JK NW tower.

9.5.87

Trench 1 W [2] (6)

11.30 am. The stratum of tumble has been cleared and the pottery and bones collected. Against the wall at the E of the locus is a dark brown soil, previously mentioned. It is fine and loose. This is stratum 6. Some coarse ware frags. appear immediately including two reasonably thin and elegant rim fragments

The bedrock in this locus continues to be cut in rough ways.

W? (2.4.88)

On the N wall of the locus the stratigraphy shows beneath the tumble a stratum of fine powdered limestone; a stratum of light coloured soil mixed with limestone chips then alternately red, black, red in thin layers

Jebel Khalid
North West Tower.

10 May 1987

Weather, sunny; a cold, stiff wind.

Workpersons 3: Duma (F); Hamad Musa; Juma' Ibrahim
Gilliam, 2: Hassan Hassan, Boumaniya (F).

Trench 1 N 3

Work continues in the gateway clearing the South face of the gateway. The bedrock rises steeply. 7.30 am the large block of tumbled near the NW corner of the gateway has to be removed because of danger to workmen in Trench 1 W. At the moment I am considering taking Tr. 1 N only as far as the corner of the gateway in order to preserve the stratigraphy in the N wall of Tr 1 W 2 and to avoid having to remove further large blocks of tumbled.

7.30 am. a spindle whorl from locus 3, within the gateway in stratum of powdery white limestone, not far above bed rock. This stratum is very thick all along the N wall of locus 3. There is top soil ^①; then some blocks of tumbled ^②; then white powdery substance ^③.

* The bedrock is much higher in the gateway than in Tr 1 W 2 where it seems to have been cut

Spindle-whorl
87.003

Tr 1 W [2]

One man works in here cleaning the bedrock which has a rough channel cut in it, and a squared shaped. Work is difficult because of the swirling dust. The surface of the bedrock also seems to be very worn, especially to the E of the channel.

Tr 1 N [3]

Roll 5, 15-

9.30 am. Photographs from E, N, W and directly above from S of two blocks of tumble immediately to the E of the bedrock opposite the 'platform' of Tr 1 W. The bedrock opposite the 'platform' is higher than elsewhere. Though work has not yet been completed here, the bedrock appears to be cut to coincide with the E and W boundaries of the platform. **Spindle whorl 87.003**

The small blocks of tumble just photographed lie on bedrock which can be seen clearly just to the E. They appear to be tumble which has been abandoned at beginning of construction proper because they lie at the bottom of the deep white powdery deposit. These blocks will now be removed into to clean down to bedrock.

The continuation of this locus (3) as it blocked a little to W of the platform by large and small blocks of tumble. It proceeds however a little to W of 'platform' where the soil (as in [2]) is dark brown loosely packed. Some frags of pottery come from this area.

JK. NWT

10.5.87

Tr 1 W [2]

The bedrock appears to be blackened at a point near the W face of the platform. However no amounts of carbon have been discovered here

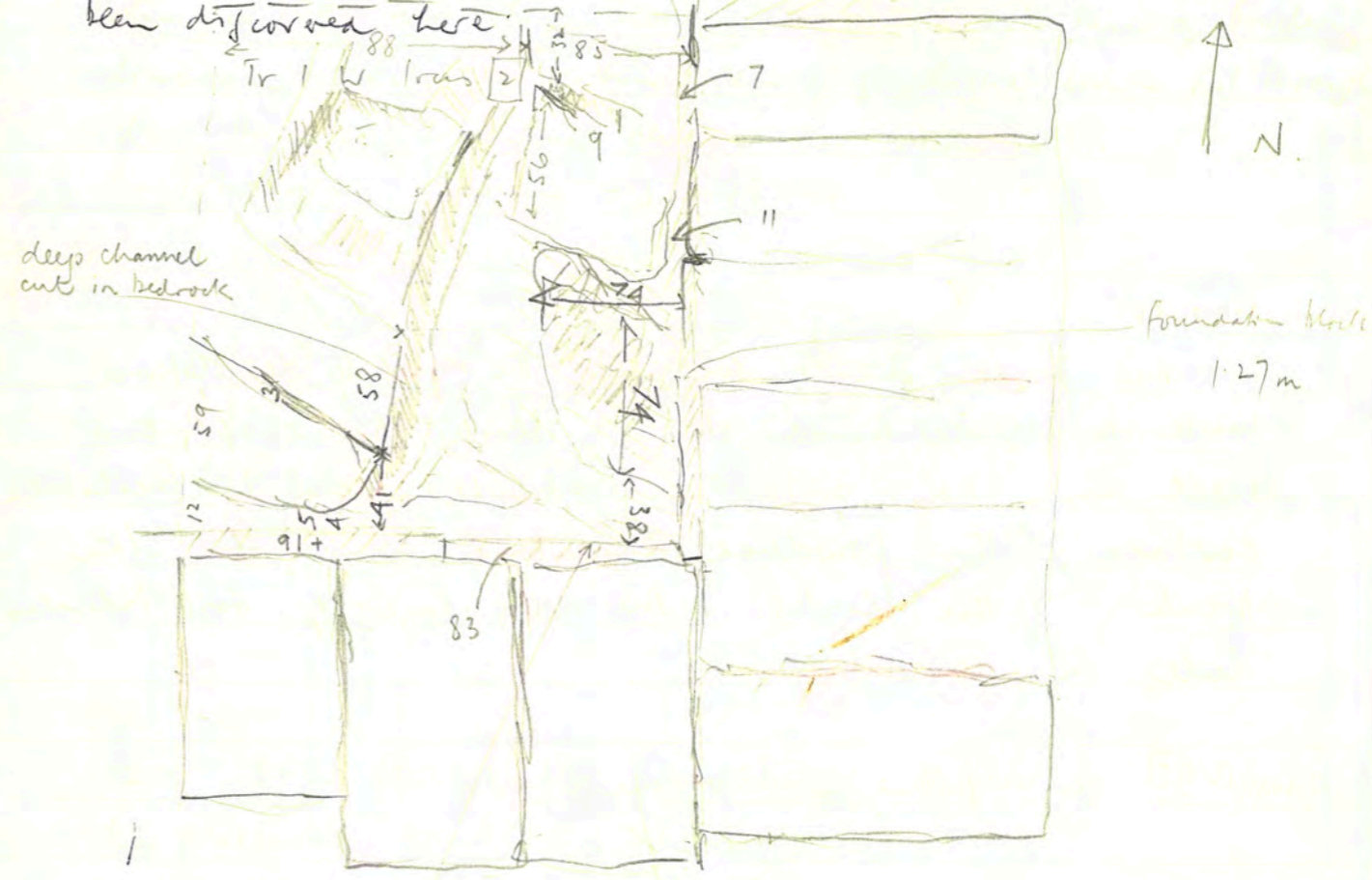

blackened area.
 Beneath the platform on both the E and S side of the focus, the foundations are consist of 2 large blocks on each side

This foundation continues beyond its join with the E face of [2]

10.5.87 Tr 1 N [3] (3)

11 coarse ware frags.

12.3.88

The powdery deposits could be the result of demolition work in quite modern times: blocks prised off the wall and then broken into smaller pieces to facilitate cartage; the powdered limestone coming from the breaking of the blocks. The inter-layers of soil indicates lull in demolition.

NB no pottery in limestone strata.

NB over next page "layer of white powder does not begin close to the wall."

JK. NWT

10.5.87

Tr 1 N

What I had supposed to be bedrock at the N of the platform are actually several more foundation blocks which look as though they could span the whole distance of the gateway. Immediately above these blocks is a thick stratum of powdery limestone which has a thin deposit of light brown soil through it. There are limestone chips in the brown soil. The total of the stratum is 49 cms.



12.15 B+W photographs of this section = N wall of [3] opposite the platform = Roll 5, 23-25
also colour photographs also from S = end of Roll dated 10.5.87

Tr 1 W [2] 12.35 pm photographs in B+W from all directions also colour B+W = Roll 5, -33.
showing cuttings in bed rock. cleaned and dusted as best as possible on a most windy day.

Jebel Khalid

Monday 11 May 1987

North West Tower

Weather: sunny, a slight breeze. home 9:30, mid side.

Workers 3: Juma' Ibrahim; Duma (F); Hamad Musa

Collin 4: Hassan Hassan; Branixya; Hadi Moma; _____

Work begins about 7 am because of car malfunction. We arrive in a tractor.

Trench 1 S. The S boundary of Tr 1 has been repegged and work began here this morning removing the top soil. The intention of opening this section of the trench is to discover the join of the outside face of the curtain wall with the tower. It seems that we have a block in situ which forms the join on the topmost preserved level. The W boundary is to be the W edge of the 'platform'.

Tr 1 E, W, and N. Work is all but completed here. After two very windy days there is still an appreciable amount of dust over the blocks and bedrock, but this can now wait for a final clean up.

Tr 1 W. [2]

The stratigraphy of the W wall of locus [2] shows, as appears to happen elsewhere, that the layer of white powder does not begin close to the wall. Here there is a light brown soil mixed with some limestone chips.

JIC NWT
Tr. 1 W

11.5.87
13 cm tumbler

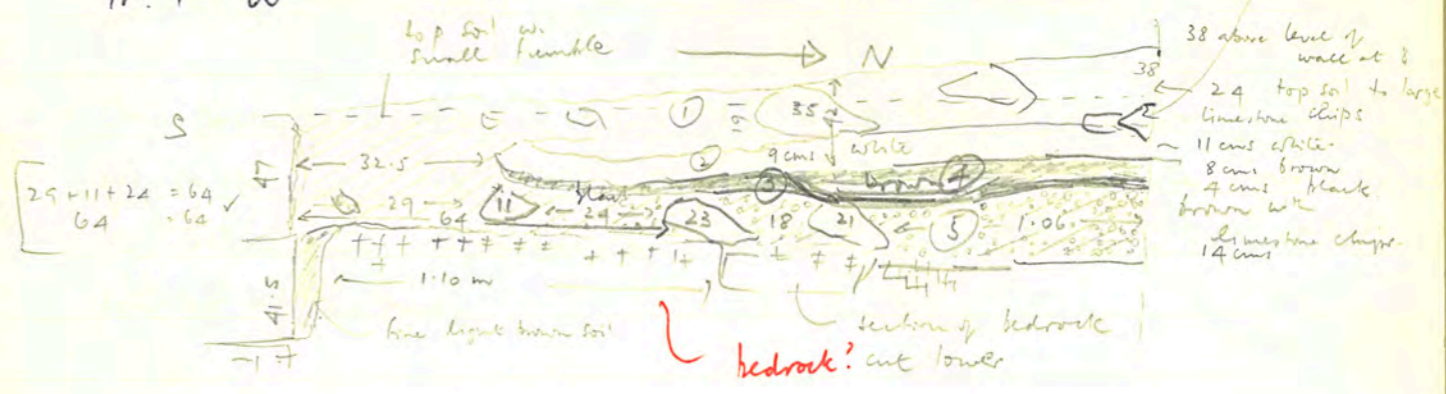

Note that the foundation blocks, whilst not smooth are carved vertical in distinction to the cushions of the wall blocks proper.

Close to blocks at the S of the loam, no concentration of white powdery deposit

- ① top soil
- ② powdery white
- ③ thin line dark gray or black.
- ④ light brown appears above blocks at N of loam.
- ⑤ light brown mixed with white, including limestone chips

The white powdery deposit can also be found in Tr 2 NWT on each side (S and N) of the platform as it is being exposed. In patches the powdery stratum is very concentrated and not mixed with soil etc.

In the N section of Tr 2 (beyond the platform) are quite distinct small chips of limestone. Perhaps these have not been crushed because work was conducted from the inside of the tower and trimmed limestone beyond the wall was not trodden on.

The E face of the tower wall with its plaster patches shows that plaster was mixed (from the crushed limestone). Perhaps this powder comes from plaster being made for

JK NWI

11.5.87

Marking inside walls, as we find on the acropolis

On present evidence, it could be that there were two phases of construction, both following the same method: white powder down the bottom, then light ~~brown~~ brown fine soil, then more white powder above that

Jebel Khalid
North West Tower

Tuesday 12 May 1987

Weather, sunny; a slight breeze, cool at first.

Work begins at 6.15 at foot of Jebel.

Workpersons 6: Jumaa Ibrahim, Dūma (F); Hamad Mowa,
Abd al-Nasr; Fā'ida^(F); Zekiya (F).

Tr 1 S

Work continues on clearing ground tumbled preparing to
photography. Work can then continue on the outside face
of the wall and tower.

The joint of the outside face of the curtain wall with the
tower has come to light. It abuts the S end of the platform
but the block that touches, which is cut diagonally to fit
against the tower, covers the joint of the platform blocks.

The S block of the platform has a slight cut EW to receive the
N edge of the next highest course of the outside face of the
curtain wall (now missing); but this can hardly be called
bonding.

The South wall of the Tr 1 S is very ragged because of
surface blocks coming loose in the face of the Trench.

8.15 Photography from E N S W section by section, and
overall views of Tr 1 S. Roll 6, 1-14

Work then continues on clearing tumbled at W of platform
before continuing with the rest of the outside of the wall face
at S and W.

12.5.87

J1C NW

North West Tower.

3 workpersons are cleaning the rock cuttings at the W of the tower, preparing to final photography.

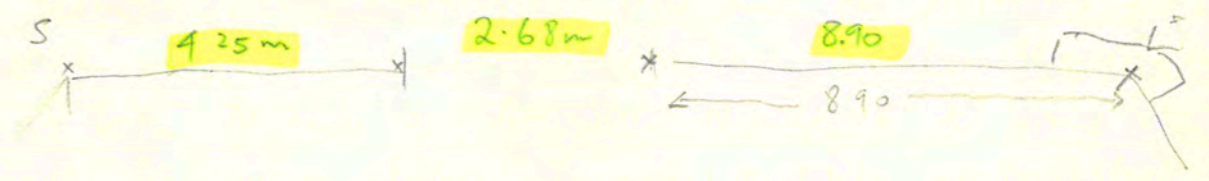
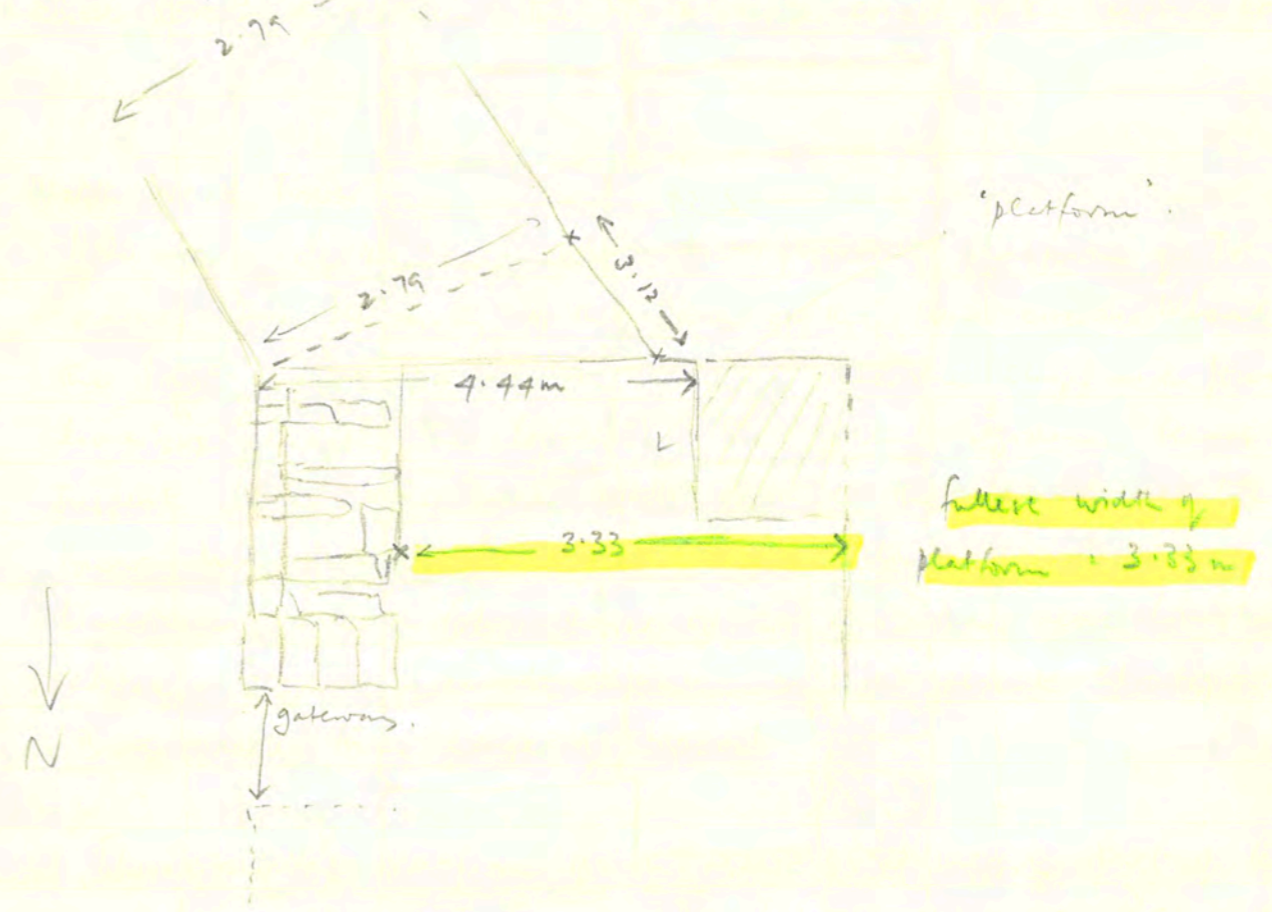

East Face of NW Tower.

Note the gateway is not in the cut

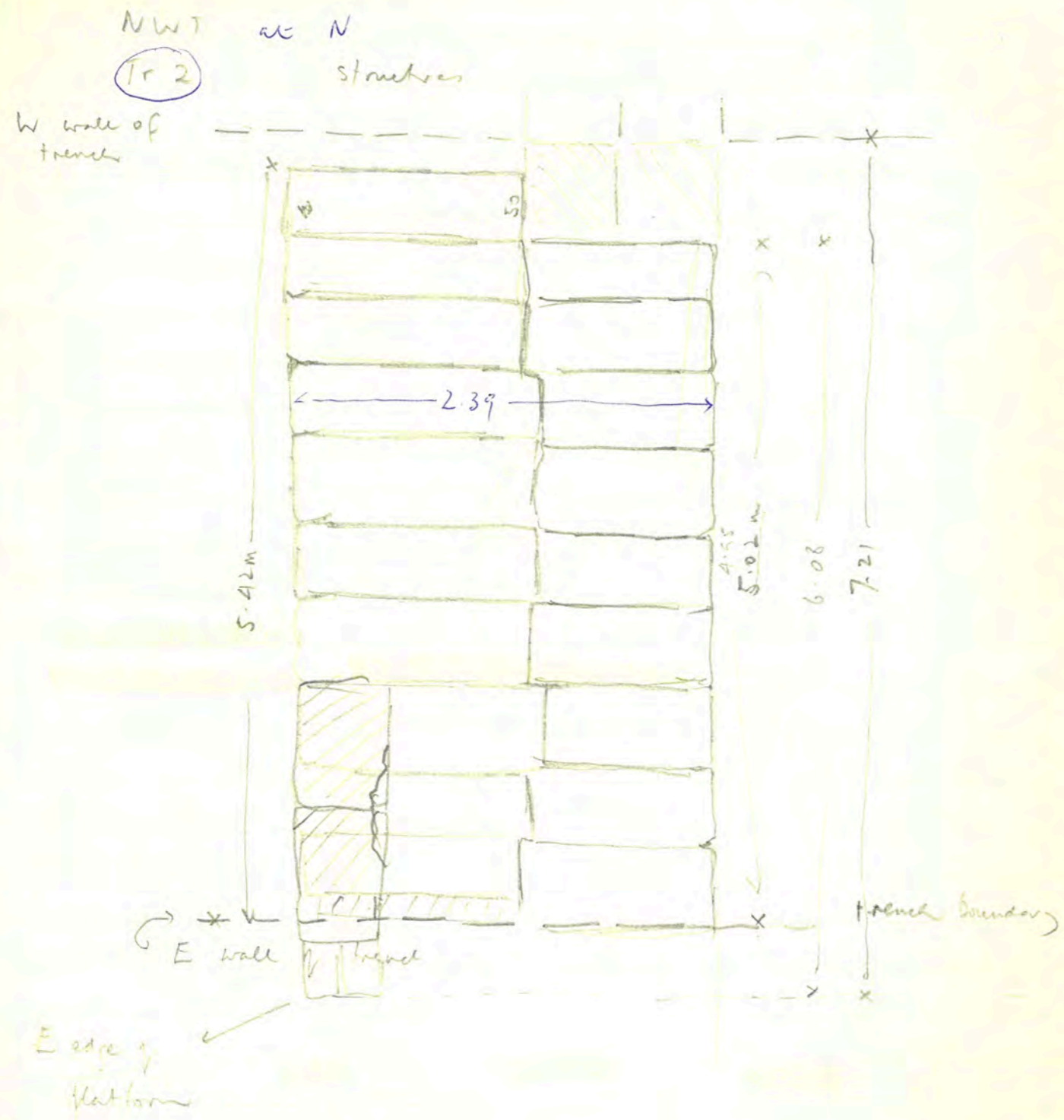

The platform is two blocks wide. Therefore resembles the EW platform in Tr 1 which is also two blocks wide. In Tr 1 the width is 2.34m; in Tr 2 the width is 2.39m.

JK NWT

12.5.87

Tr 1 S

11.15 am

32 cms down from lowest preserved course of platform is the dark red brown stratum mixed with limestone chips, that is about 85 cms down from the top preserved course of the curtain wall.

North West Tower.

11.20 am. In the area where the projecting platform of Tr 2 reaches the beginning of the turn of the semi circular Wharf of the tower, there is a thin layer of limestone chips and powdered limestone beneath the top soil. The present evidence seems to suggest that there were walls around the perimeter of the tower but packed floor of limestone chips and powdered limestone with a floor layer of soil and then more limestone above. Beyond, or above that, in the present stratigraphy is a quite thin layer of topsoil.

The so-called platform is in reality, I suggest part of the perimeter wall of the tower. The total width of the coppera-wall and the platform to the W of it, both N and S, of the gateway, is 3.49m. Note that the projecting platform, which may be continued W in Tr 1, is two blocks wide at both N and S. At both N and S it forms the outer face of the tower. Towards the W, at the start of the semicircle at both N + S, the 'platform' merges into the cuttings in the bedrock which in turn provide the foundation for the wall. This construction of wall should be stronger

12.5.87 Tr 1 S (2)

- 1 coarse ware frag.
- 1 small frag fine red glaze
- 1 rim frag partially painted brown, pale pink, pale clay

12.5.87

than the normal construction of the curtain wall — though in places it is quite clear that blocks are laid contiguously to form a strong base for further building.

The join of the curtain wall to the tower is not the same at N as it is at S.

At N the diagonal curtain, at its outer face does not touch the tower immediately, it turns through 135° and runs parallel for a short space to the axis of the NS copped wall at the point marked Z on the sketch.



The gateway is indicated on the plan and on the previous sketch is placed off centre towards the S. This is reasonable because the approach to it from the citadel or the rest of the city must be from the south. Note that to the E of the tower is a deep quarry with steep sides on the S and N and the caves on the W. In fact at the N of the quarry the rock cuttings indicate that the curtain wall was placed immediately above the vertically cut face of the quarry. Therefore the only approach to the tower from the E would have been on top of the fortification wall.

At the S the join of curtain wall to tower seems rather a jumble. In the sketch on p. 2 (12.5.87) I have indicated a triangle which is a space where perhaps the copping, the

JK NWT

12.5.87

normal structure of the wall, cannot be employed. At the N end the final two cappings seem to be segment shaped rather than rectangular to cope with the turn to the short stretch of wall (Z). The larger areas are towards the outer face at NW.

At the S. in the trench as we have it there is nothing but a rough jumble of blocks some of which protrude higher than the blocks of the cappings in the wall to the N. Practically the whole of the wall here is taken up with fill (if it is indeed fill). It might be best to assume that these blocks are fill and to leave them cleared as they are, rather than removing them to investigate if there is some measure of capping below.

Note too that the block which was showing above the surface and which seemed itself to be the join of the curtain wall to the 'platform' is a stretcher approximately one stretcher width back from the outside face; it is cut a little at its SW corner where the block at the outer face was fitted; it may well have been another stretcher since above the newly exposed courses (stretcher, header, stretcher), a stretcher very likely met the projecting platform.

12.5.87

Jebel Khaid
North West Tower.

Wednesday 13 May 1987

Weather, sunny, cool breeze at first.

Work begins at 6:15 at foot of Jebel.

Workmen 4: Juma'a Ibrahim, Duma (F); Hamad Nussa;
Abd a Nassir

Tr 1 S.

Work continues cleaning to bedrock in a very small area
at outer face of curtain wall and tower. This is stratum (3)
below white chips (2) and top soil (1)

North West Tower.

Work continues on cleaning the rock cuttings at the W of the
tower.

Roll 6, 15-16

6:30 am. Photography in B+W and colour on approaches
from NE and SE taken each side from the join of
curtain wall and tower. NE should indicate the N
edge of the quarry and the cuttings in the rock. The SE
to show the available passages, from the citadel area, between
the quarry and the curtain wall to the SW.

North West Tower. Whether to open new trenches in the
centre of the Tower! To the NE there are two limestone blocks
which appear to be in situ. These seem to indicate that there
could be a structure within the perimeter walls. The other

13.5.87

pits within the perimeter do not seem to show anything. A cut block has been disturbed in the pit near the survey marker (to S of survey marker) but this is in line with the NS platform.

The cuttings in bedrock at W of NW tower, from inside at E to the far edge of block at W is c. 2.39. Exactly 2.39 m at one point. This is the width of the EW platform projections of Tr 1 and Tr 2.

NW tower at W within top soil are distinct limestone chips.

Tr 1 S

11.30 After thorough sweeping B+W photographs from several angles of outside face of wall and tower. Shots to show parallel stretches at beginning of curtain wall; the slight cutting in tower block to receive edge of curtain wall block; bed-rock; tumble of wall blocks at bottom of trench: presumably blocks that fell from the wall early in construction and were not retrieved.

NW Tower: it occurs to me today, considering the thick layer of unadulterated limestone powder in Gillian's Tr 2 that the limestone has been purposely pulverized to form a floor. The soil could have been strewed over that — then more pulverized limestone.

Jebel Khalid
North West Tower.

Thursday 14 May

Weather, fine sunny, slight cool breeze.

Work begins at 6:15 at foot of Jebel.

Workmen 4: Juma' Ibrahim, Duma (F); Hamid Musa;
Abd al Nasr.

Tr 2, quick clean of bedrock and wall face at N of Tr 2
then photographs from numerous directions, overall shots from
E and W; close ups of wall blocks and bedrock; detail of
foundation trench at E which shows that the EW
was prepared before the NS join at the N because the
EW foundation trench continues below the NS wall.

* The curtain wall abuts the tower.

NW Tower, cleaning of rock cuttings on curved W boundary
continues in the hope of concluding today. On Saturday I
intend to measure out a trench in the domestic quarter
~~perhaps~~ and more operations there. Bryce Raworth can begin
drawing, plans, sections.

4:30 pm. Pay distributed including today and Friday holiday
tomorrow.

12 noon, during cleaning, inspection of the rubble pit more
or less in the centre of the tower shows that bedrock
lies at the bottom. It is smooth but sloping and
therefore seems not to be a construction block.

Jebel Khalid

Sunday 17 May

North West Tower

7.30 am. final photographs in B&W and colour

Tr 1, rock cuttings and Tr 2

also on Roll

Gillian's photos of Tr 2.

Roll 9.

1987

Tr 1

locus 2 is the spit in Tr 1 W at NW of platform where
no blocks are laid.

locus 3 is the spit in Tr 1 N x 80 cms
where a part of the "plaster floor" is excavated, against
the S edge of the gateway.